



# Rogers

## Assessment Property Record Card for Tax Year 2026

Data provided by LISA DELOZIER County Assessor

Date 04/17/2026  
Time 02:09:04  
Page 1

Assessment Data					Primary Image																																																																																																																				
<b>Account</b> 660000718 <b>Parcel ID</b> 000000-00-0-00072-001-0004 <b>Cadastral ID</b> 01-22-15-02040 <b>Property Type</b> REAL - Real Property <b>Property Class</b> RRP VI Area 4 <b>Tax Area</b> 11 - SEQUOYAH/NW FIRE <b>Name ID</b> 341988 WILLIAMS, SAVANNAH & BRUCE  9783 E MESA DR CLAREMORE OK 74017-0000  <b>Parcel Location</b> <b>Situs</b> 09783 E MESA DR <b>Subdivision</b> BRIARCLIFF ESTATES <b>Lot/Block</b> 0004 / 0001 <b>Parcel Size</b> 1 - Lots <b>Sec/Twn/Rng</b> 1 / 22 / 15 / 5 <b>Neighborhood</b> 1085 - R-V04-NW SEQUOYAH <b>School District</b> S006 - SEQUOYAH SCHOOLS																																																																																																																									
<b>Legal Description</b> Lot/Long: 36.41552731 -95.65489513																																																																																																																									
<b>Building Permits</b>					<table border="1"> <thead> <tr> <th>Number</th> <th>Description</th> <th>Opened</th> <th>Closed</th> <th>Amount</th> </tr> </thead> <tbody> <tr> <td colspan="5" style="height: 100px;"> </td> </tr> </tbody> </table>					Number	Description	Opened	Closed	Amount																																																																																																											
Number	Description	Opened	Closed	Amount																																																																																																																					
<b>Exemptions</b>					<b>Sale History</b>																																																																																																																				
<table border="1"> <thead> <tr> <th>Code</th> <th>Type</th> <th>Active</th> <th>Maximum</th> <th>Exemption</th> </tr> </thead> <tbody> <tr> <td>H</td> <td>Homestead</td> <td>No</td> <td>1,000</td> <td></td> </tr> </tbody> </table>					Code	Type	Active	Maximum	Exemption	H	Homestead	No	1,000		<table border="1"> <thead> <tr> <th>Bk/Pg</th> <th>Grantor</th> <th>Date</th> <th>Price</th> <th>Code</th> </tr> </thead> <tbody> <tr> <td>/</td> <td>STAMPS, ILA JEAN</td> <td>07/06/2023</td> <td>232,000</td> <td>YES</td> </tr> <tr> <td>2705/54</td> <td>STAMPS, JASPER P &amp; ILA JEAN</td> <td>01/22/2018</td> <td>0</td> <td>4</td> </tr> <tr> <td>2687/500</td> <td>STAMPS, JASPER P &amp; ILA JEAN</td> <td>12/06/2017</td> <td>0</td> <td>4</td> </tr> <tr> <td>2650/313</td> <td>RUNYON, JOYCE MAXINE</td> <td>07/28/2017</td> <td>118,000</td> <td>YES</td> </tr> </tbody> </table>					Bk/Pg	Grantor	Date	Price	Code	/	STAMPS, ILA JEAN	07/06/2023	232,000	YES	2705/54	STAMPS, JASPER P & ILA JEAN	01/22/2018	0	4	2687/500	STAMPS, JASPER P & ILA JEAN	12/06/2017	0	4	2650/313	RUNYON, JOYCE MAXINE	07/28/2017	118,000	YES																																																																													
Code	Type	Active	Maximum	Exemption																																																																																																																					
H	Homestead	No	1,000																																																																																																																						
Bk/Pg	Grantor	Date	Price	Code																																																																																																																					
/	STAMPS, ILA JEAN	07/06/2023	232,000	YES																																																																																																																					
2705/54	STAMPS, JASPER P & ILA JEAN	01/22/2018	0	4																																																																																																																					
2687/500	STAMPS, JASPER P & ILA JEAN	12/06/2017	0	4																																																																																																																					
2650/313	RUNYON, JOYCE MAXINE	07/28/2017	118,000	YES																																																																																																																					
<b>Parcel Valuation</b>																																																																																																																									
<table border="1"> <thead> <tr> <th>Source</th> <th>REAL</th> <th>Fair Cash</th> <th>Capped</th> <th>Asmnt Level</th> <th>Assessed</th> <th>Levy Rate</th> <th>102.332</th> <th>Current Tax</th> </tr> </thead> <tbody> <tr> <td>Remove Cap</td> <td>2024</td> <td>Land Value</td> <td>112,000</td> <td>112,000</td> <td>11%</td> <td>12,320</td> <td>Assessed</td> <td>24,826</td> <td>2,540.48</td> </tr> <tr> <td>Year Frozen</td> <td>0</td> <td>Improvements</td> <td>113,690</td> <td>113,690</td> <td></td> <td>12,506</td> <td>Penalty</td> <td>0</td> <td></td> </tr> <tr> <td>Uncapped Value</td> <td>0</td> <td>Mobile Home</td> <td>0</td> <td>0</td> <td></td> <td>0</td> <td>Exemption</td> <td>0</td> <td>0.00</td> </tr> <tr> <td>TIF Project ID</td> <td>0</td> <td>Total Value</td> <td>225,690</td> <td>225,690</td> <td></td> <td>24,826</td> <td>Total Taxable</td> <td>24,826</td> <td>2,540.00</td> </tr> </tbody> </table>		Source	REAL	Fair Cash	Capped	Asmnt Level	Assessed	Levy Rate	102.332	Current Tax	Remove Cap	2024	Land Value	112,000	112,000	11%	12,320	Assessed	24,826	2,540.48	Year Frozen	0	Improvements	113,690	113,690		12,506	Penalty	0		Uncapped Value	0	Mobile Home	0	0		0	Exemption	0	0.00	TIF Project ID	0	Total Value	225,690	225,690		24,826	Total Taxable	24,826	2,540.00																																																																							
Source	REAL	Fair Cash	Capped	Asmnt Level	Assessed	Levy Rate	102.332	Current Tax																																																																																																																	
Remove Cap	2024	Land Value	112,000	112,000	11%	12,320	Assessed	24,826	2,540.48																																																																																																																
Year Frozen	0	Improvements	113,690	113,690		12,506	Penalty	0																																																																																																																	
Uncapped Value	0	Mobile Home	0	0		0	Exemption	0	0.00																																																																																																																
TIF Project ID	0	Total Value	225,690	225,690		24,826	Total Taxable	24,826	2,540.00																																																																																																																
<b>Assessment History</b>																																																																																																																									
<table border="1"> <thead> <tr> <th>Tax Year</th> <th>Statement Number</th> <th>Billed Owner</th> <th>Tax Area</th> <th>Total Value</th> <th>Exemptions</th> <th>Taxable Value</th> <th>Billed Tax</th> </tr> </thead> <tbody> <tr><td>2025</td><td>2025-660000718</td><td>WILLIAMS, SAVANNAH &amp;</td><td>11</td><td>224,394</td><td>0</td><td>24,683</td><td>2,526.00</td></tr> <tr><td>2024</td><td>2024-660000718</td><td>WILLIAMS, SAVANNAH &amp;</td><td>11</td><td>232,378</td><td>0</td><td>25,562</td><td>2,625.00</td></tr> <tr><td>2023</td><td>2023-660000718</td><td>WILLIAMS, SAVANNAH &amp;</td><td>11</td><td>121,499</td><td>1000</td><td>12,365</td><td>1,309.00</td></tr> <tr><td>2022</td><td>2022-660000718</td><td>STAMPS, ILA JEAN</td><td>11</td><td>119,535</td><td>1000</td><td>12,149</td><td>1,295.00</td></tr> <tr><td>2021</td><td>2021-660000718</td><td>STAMPS, ILA JEAN</td><td>11</td><td>124,970</td><td>1000</td><td>12,747</td><td>1,311.00</td></tr> <tr><td>2020</td><td>2020-660000718</td><td>STAMPS, ILA JEAN</td><td>11</td><td>122,956</td><td>1000</td><td>12,525</td><td>1,330.00</td></tr> <tr><td>2019</td><td>2019-660000718</td><td>STAMPS, ILA JEAN</td><td>11</td><td>119,850</td><td>1000</td><td>12,184</td><td>1,277.00</td></tr> <tr><td>2018</td><td>2018-660000718</td><td>STAMPS, ILA JEAN</td><td>11</td><td>121,217</td><td>0</td><td>13,334</td><td>1,397.00</td></tr> <tr><td>2017</td><td>2017-660000718</td><td>STAMPS, JASPER P &amp; ILA JEAN</td><td>11</td><td>139,775</td><td>1000</td><td>11,684</td><td>1,209.00</td></tr> <tr><td>2016</td><td>2016-660000718</td><td>RUNYON, JOYCE MAXINE</td><td>11</td><td>136,110</td><td>1000</td><td>11,314</td><td>1,178.00</td></tr> <tr><td>2015</td><td>2015-660000718</td><td>RUNYON, JOYCE MAXINE</td><td>11</td><td>132,123</td><td>1000</td><td>10,955</td><td>1,151.00</td></tr> <tr><td>2014</td><td>2014-660000718</td><td>RUNYON, JOYCE MAXINE</td><td>11</td><td>133,176</td><td>1000</td><td>10,607</td><td>1,115.00</td></tr> <tr><td>2013</td><td>2013-660000718</td><td>RUNYON, JOYCE MAXINE</td><td>11</td><td>123,350</td><td>1000</td><td>10,269</td><td>1,061.00</td></tr> </tbody> </table>										Tax Year	Statement Number	Billed Owner	Tax Area	Total Value	Exemptions	Taxable Value	Billed Tax	2025	2025-660000718	WILLIAMS, SAVANNAH &	11	224,394	0	24,683	2,526.00	2024	2024-660000718	WILLIAMS, SAVANNAH &	11	232,378	0	25,562	2,625.00	2023	2023-660000718	WILLIAMS, SAVANNAH &	11	121,499	1000	12,365	1,309.00	2022	2022-660000718	STAMPS, ILA JEAN	11	119,535	1000	12,149	1,295.00	2021	2021-660000718	STAMPS, ILA JEAN	11	124,970	1000	12,747	1,311.00	2020	2020-660000718	STAMPS, ILA JEAN	11	122,956	1000	12,525	1,330.00	2019	2019-660000718	STAMPS, ILA JEAN	11	119,850	1000	12,184	1,277.00	2018	2018-660000718	STAMPS, ILA JEAN	11	121,217	0	13,334	1,397.00	2017	2017-660000718	STAMPS, JASPER P & ILA JEAN	11	139,775	1000	11,684	1,209.00	2016	2016-660000718	RUNYON, JOYCE MAXINE	11	136,110	1000	11,314	1,178.00	2015	2015-660000718	RUNYON, JOYCE MAXINE	11	132,123	1000	10,955	1,151.00	2014	2014-660000718	RUNYON, JOYCE MAXINE	11	133,176	1000	10,607	1,115.00	2013	2013-660000718	RUNYON, JOYCE MAXINE	11	123,350	1000	10,269	1,061.00
Tax Year	Statement Number	Billed Owner	Tax Area	Total Value	Exemptions	Taxable Value	Billed Tax																																																																																																																		
2025	2025-660000718	WILLIAMS, SAVANNAH &	11	224,394	0	24,683	2,526.00																																																																																																																		
2024	2024-660000718	WILLIAMS, SAVANNAH &	11	232,378	0	25,562	2,625.00																																																																																																																		
2023	2023-660000718	WILLIAMS, SAVANNAH &	11	121,499	1000	12,365	1,309.00																																																																																																																		
2022	2022-660000718	STAMPS, ILA JEAN	11	119,535	1000	12,149	1,295.00																																																																																																																		
2021	2021-660000718	STAMPS, ILA JEAN	11	124,970	1000	12,747	1,311.00																																																																																																																		
2020	2020-660000718	STAMPS, ILA JEAN	11	122,956	1000	12,525	1,330.00																																																																																																																		
2019	2019-660000718	STAMPS, ILA JEAN	11	119,850	1000	12,184	1,277.00																																																																																																																		
2018	2018-660000718	STAMPS, ILA JEAN	11	121,217	0	13,334	1,397.00																																																																																																																		
2017	2017-660000718	STAMPS, JASPER P & ILA JEAN	11	139,775	1000	11,684	1,209.00																																																																																																																		
2016	2016-660000718	RUNYON, JOYCE MAXINE	11	136,110	1000	11,314	1,178.00																																																																																																																		
2015	2015-660000718	RUNYON, JOYCE MAXINE	11	132,123	1000	10,955	1,151.00																																																																																																																		
2014	2014-660000718	RUNYON, JOYCE MAXINE	11	133,176	1000	10,607	1,115.00																																																																																																																		
2013	2013-660000718	RUNYON, JOYCE MAXINE	11	123,350	1000	10,269	1,061.00																																																																																																																		



# Rogers

## Assessment Property Record Card for Tax Year 2026

Data provided by LISA DELOZIER County Assessor

Date 04/17/2026  
Time 02:09:04  
Page 2

Lot Data	Square-Foot - NBHD 1085 #1	Primary Image
Lot Size		
Lot Count		
Units Buildable	27300	
Non-Ag Acres	0.6032	
Topography		
Street Access		
Utilities		
Amenities	LAND QUALITY	
	0	
	0	
Method	Square-Foot	
Base Lot Value	26,275.00 x 3.15 = 82,766	
Factor Value		
Adjustments	1.3532	
Lot Value	112,000	

Residential Data	
Type	1 Single Family Residence
Condition	3 - Average
Quality	2.5 - Fair
Architecture	
Style	100% One Story
Exterior Wall	80% Veneer, Masonry 20% Frame, Siding, Wood
Base/Total Area	1,592 / 1,592
Style	100% One Story
HVAC	100% Warmed & Cooled Air
Roof Cover	1 Composition Shingle
Area on Slab	1,592
Fixture/RghIn	13 /
Bed/F/H Bath	3 / 2.0 /
Basement Area	
Garage Type	621 Attached Garage - Unfinished
Remodel	
Year/Eff Age	1977 / 37

GRM Approach	
GRM Code	
Gross Rent	0.00
Indicated Value	

Multiple Regression	
MRA Code	1 Test
Adjusted R	0.8445
Indicated Value	177,088 111.24 Per SqFt

Direct Comparables	
Selection Model	A Adam Test
Adjustment Model	1 2022 Residential
Comparables	5
Indicated Value	173,000 Per SqFt

Cost Approach		Manual : 01/2025	
Base Cost	101.43	Total Misc Impr	+ 5,677
Roofing Adj	+ 4.37	Garage Cost	+ 16,270
Subfloor Adj	+ -1.15	Total RCN	= 223,303
Heat/Cool Adj	+ 11.47	Depreciation ( 50%)	- 111,652
Plumbing Adj	+ 10.36	Lump Sums	+ 2,039
Basement Adj	+ 0.00	RCNLD	= 113,690
Adj Base Cost	= 126.48	Lot Value	+ 112,000
Total Area	x 1,592	Indicated Value	= 225,690
Adjusted Cost	= 201,356	Value Per SqFt	141.77

Value Reconciliation	
Selected Approach	Cost Approach
Improvements	113,690
Lot Value	112,000
Indicated Value	225,690 141.77 Per SqFt
Agland Value	
Site Improvements	
Total Value	225,690 141.77 Total Value Per SqFt

Miscellaneous Improvements								
Code	Description	Sketch ID	Size	Year	Units	Unit Cost	Depr	Value
FPR1	FIREPLACE - RESIDENTIAL 1 STORY	0		1	1	5,095.98		5,096
PRCH	SLAB PORCH - COVERED	2097	6x4		24	24.19		581
WODO	WOOD DECK - OPEN	2098	16x12		192	21.24	50%	2,039



# Rogers

## Assessment Property Record Card for Tax Year 2026

Data provided by LISA DELOZIER County Assessor

Date 04/17/2026  
 Time 02:09:04  
 Page 3

### Sketch Image

660000718

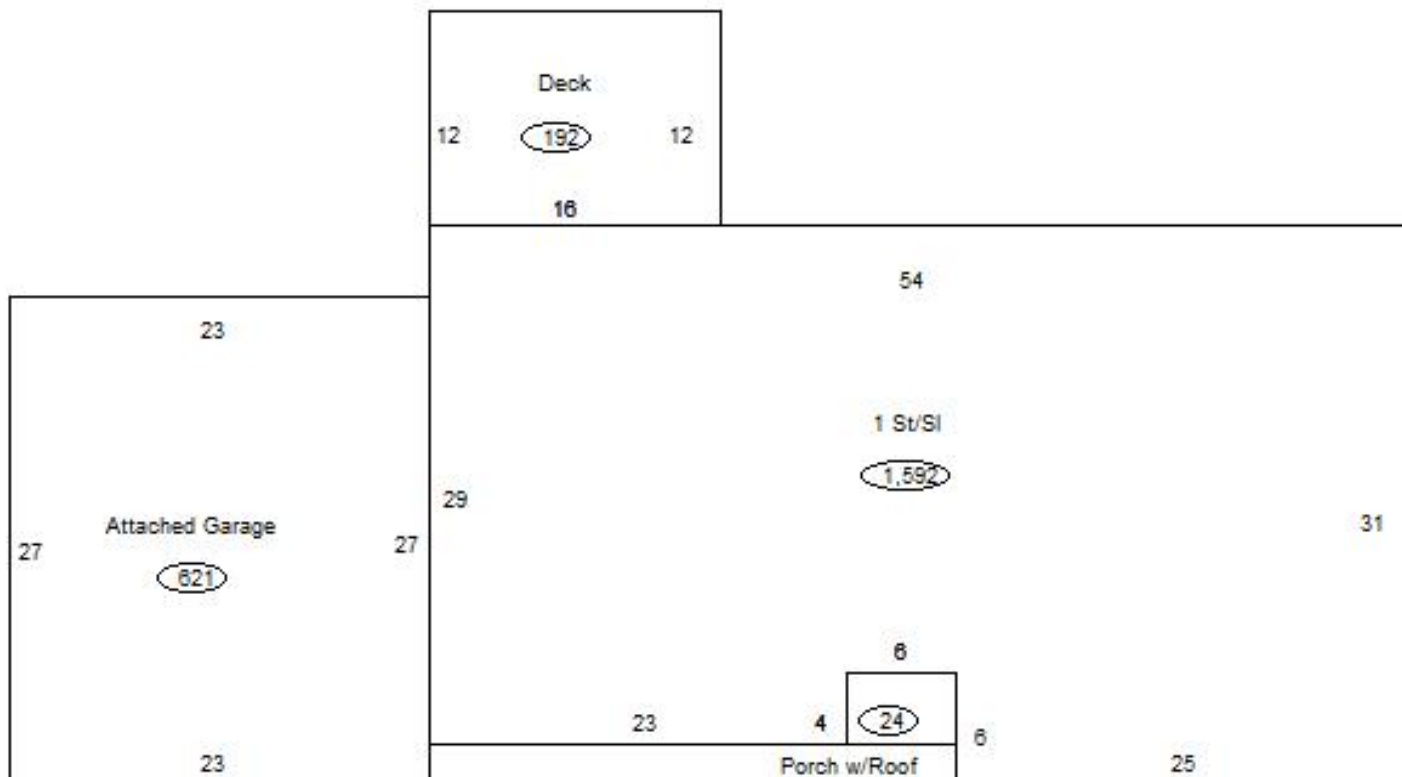

### Sketch Vector Information

Sequence	Code	Type	Built Over	Scale	Section Label	Base Area	Multiplier	Total Area
1	R	1	Slab	13	1 St/Sl	1,592	1.000	1,592
2	G	1		13	Attached Garage	621	1.000	621
3	M	PRCH		13	SLBC	24	1.000	24
4	M	WODO		13	WODO	192	1.000	192
<b>Total Building Area</b>						1,592		1,592