



Rogers

Assessment Property Record Card for Tax Year 2026

Data provided by LISA DELOZIER County Assessor

Date 04/17/2026
Time 02:09:15
Page 1

Assessment Data					Primary Image																																																	
Account 660000730 Parcel ID 000000-00-0-00072-004-0001 Cadastral ID 01-22-15-02170 Property Type REAL - Real Property Property Class RRP VI Area 4 Tax Area 11 - SEQUOYAH/NW FIRE Name ID 303390 PRATHER, MARK A & SHERRY L 9801 E MESA DR CLAREMORE OK 74017-0000																																																						
Parcel Location Situs 09801 E MESA DR Subdivision BRIARCLIFF ESTATES Lot/Block 0001 / 0004 Parcel Size 1 - Lots Sec/Twn/Rng 1 / 22 / 15 / 5 Neighborhood 1085 - R-V04-NW SEQUOYAH School District S006 - SEQUOYAH SCHOOLS																																																						
Legal Description Lot/Long: 36.41545865 -95.65408438					Building Permits																																																	
LOT 1 BLOCK 4 BRIARCLIFF ESTATES					<table border="1"> <thead> <tr> <th>Number</th> <th>Description</th> <th>Opened</th> <th>Closed</th> <th>Amount</th> </tr> </thead> <tbody> <tr> <td> </td> <td> </td> <td> </td> <td> </td> <td> </td> </tr> </tbody> </table>					Number	Description	Opened	Closed	Amount																																								
Number	Description	Opened	Closed	Amount																																																		
Exemptions					Sale History																																																	
Code	Type	Active	Maximum	Exemption	Bk/Pg	Grantor	Date	Price	Code																																													
HV	Veteran	Yes	999,999	15,178	2121/558	MITCHELL, CLIFFORD L &	08/16/2010	136,000	YES																																													
					997/341	JACKSON, MICHAEL P &	07/01/1995	85,000	Yes																																													
					954/241	SELLER	04/18/1994	0	No																																													
					922/740	RUNYON, JOYCE MAXINE	07/22/1993	7,000	Yes																																													
Parcel Valuation					<table border="1"> <thead> <tr> <th>Source</th> <th>REAL</th> <th>Fair Cash</th> <th>Capped</th> <th>Asmnt Level</th> <th>Assessed</th> <th>Levy Rate</th> <th>102.332</th> <th>Current Tax</th> </tr> </thead> <tbody> <tr> <td>Remove Cap</td> <td>2011</td> <td>Land Value 69,199</td> <td>41,748</td> <td>11%</td> <td>4,592</td> <td>Assessed</td> <td>15,178</td> <td>1,553.19</td> </tr> <tr> <td>Year Frozen</td> <td>2014</td> <td>Improvements 159,513</td> <td>96,236</td> <td> </td> <td>10,586</td> <td>Penalty</td> <td>0</td> <td> </td> </tr> <tr> <td>Uncapped Value</td> <td>0</td> <td>Mobile Home 0</td> <td>0</td> <td> </td> <td>0</td> <td>Exemption</td> <td>15,178</td> <td>-1,340.00</td> </tr> <tr> <td>TIF Project ID</td> <td>0</td> <td>Total Value 228,712</td> <td>137,984</td> <td> </td> <td>15,178</td> <td>Total Taxable</td> <td>0</td> <td>213.00</td> </tr> </tbody> </table>					Source	REAL	Fair Cash	Capped	Asmnt Level	Assessed	Levy Rate	102.332	Current Tax	Remove Cap	2011	Land Value 69,199	41,748	11%	4,592	Assessed	15,178	1,553.19	Year Frozen	2014	Improvements 159,513	96,236		10,586	Penalty	0		Uncapped Value	0	Mobile Home 0	0		0	Exemption	15,178	-1,340.00	TIF Project ID	0	Total Value 228,712	137,984		15,178	Total Taxable	0	213.00
Source	REAL	Fair Cash	Capped	Asmnt Level	Assessed	Levy Rate	102.332	Current Tax																																														
Remove Cap	2011	Land Value 69,199	41,748	11%	4,592	Assessed	15,178	1,553.19																																														
Year Frozen	2014	Improvements 159,513	96,236		10,586	Penalty	0																																															
Uncapped Value	0	Mobile Home 0	0		0	Exemption	15,178	-1,340.00																																														
TIF Project ID	0	Total Value 228,712	137,984		15,178	Total Taxable	0	213.00																																														
Assessment History																																																						
Tax Year	Statement Number	Billed Owner	Tax Area	Total Value	Exemptions	Taxable Value	Billed Tax																																															
2025	2025-660000730	PRATHER, MARK A &	11	225,209	15178	213.00																																																
2024	2024-660000730	PRATHER, MARK A &	11	242,387	15178	213.00																																																
2023	2023-660000730	PRATHER, MARK A &	11	180,230	15178	213.00																																																
2022	2022-660000730	PRATHER, MARK A &	11	182,164	15179	208.00																																																
2021	2021-660000730	PRATHER, MARK A &	11	162,390	15178	206.00																																																
2020	2020-660000730	PRATHER, MARK A &	11	161,181	15178	213.00																																																
2019	2019-660000730	PRATHER, MARK A &	11	152,951	15178	214.00																																																
2018	2018-660000730	PRATHER, MARK A &	11	157,078	15178	215.00																																																
2017	2017-660000730	PRATHER, MARK A &	11	155,699	1000	14,179	1,465.00																																															
2016	2016-660000730	PRATHER, MARK A &	11	151,520	1000	14,178	1,474.00																																															
2015	2015-660000730	PRATHER, MARK A &	11	148,016	1000	14,178	1,486.00																																															
2014	2014-660000730	PRATHER, MARK A &	11	149,495	1000	14,178	1,487.00																																															
2013	2013-660000730	PRATHER, MARK A &	11	138,204	1000	13,736	1,415.00																																															



Rogers

Assessment Property Record Card for Tax Year 2026

Data provided by LISA DELOZIER County Assessor

Date 04/17/2026
 Time 02:09:15
 Page 2

Lot Data		Square-Foot - NBHD 1085 #1	
Lot Size			
Lot Count			
Units Buildable	21840		
Non-Ag Acres	0.5043		
Topography			
Street Access			
Utilities			
Amenities	LAND QUALITY	0	
		0	
Method	Square-Foot		
Base Lot Value	21,968.00 x 3.15 = 69,199		
Factor Value			
Adjustments	1.0000		
Lot Value	69,199		



\\tsclient\T\TOMMY DUNLAP\New folder (34)\IMG_0007.JPG 3/29/2022

Residential Data	
Type	1 Single Family Residence
Condition	3 - Average
Quality	2.5 - Fair
Architecture	
Style	100% One Story
Exterior Wall	70% Frame, Siding, Vinyl 30% Veneer, Masonry
Base/Total Area	1,583 / 1,583
Style	100% One Story
HVAC	100% Warmed & Cooled Air
Roof Cover	1 Composition Shingle
Area on Slab	1,583
Fixture/RghIn	11 /
Bed/F/H Bath	3 / 2.0 /
Basement Area	
Garage Type	504 Attached Garage - Unfinished
Remodel	
Year/Eff Age	1994 / 24

GRM Approach

GRM Code	
Gross Rent	0.00
Indicated Value	

Multiple Regression

MRA Code	1 Test
Adusted R	0.8445
Indicated Value	183,378 115.84 Per SqFt

Direct Comparables

Selection Model	A Adam Test
Adjustment Model	1 2022 Residential
Comparables	3
Indicated Value	178,730 Per SqFt

Value Reconciliation

Selected Approach	Cost Approach
Improvements	159,513
Lot Value	69,199
Indicated Value	228,712 144.48 Per SqFt
Agland Value	
Site Improvements	
Total Value	228,712 144.48 Total Value Per SqFt

Cost Approach Manual : 01/2025

Base Cost	99.13	Total Misc Impr	+	23,900
Roofing Adj	+ 4.46	Garage Cost	+	13,810
Subfloor Adj	+ -1.15	Total RCN	=	232,102
Heat/Cool Adj	+ 11.47	Depreciation (32%)	-	74,273
Plumbing Adj	+ 8.89	Lump Sums	+	1,684
Basement Adj	+ 0.00	RCNLD	=	159,513
Adj Base Cost	= 122.80	Lot Value	+	69,199
Total Area	x 1,583	Indicated Value	=	228,712
Adjusted Cost	= 194,392	Value Per SqFt		144.48

Miscellaneous Improvements

Code	Description	Sketch ID	Size	Year	Units	Unit Cost	Depr	Value
FPR1	FIREPLACE - RESIDENTIAL 1 STORY	0		1	1	5,095.98		5,096
PRCH	SLAB PORCH - COVERED	2156	6x4		24	24.19		581
EPSW	ENCLOSED PORCH - SOLID WALL	2157	298		298	61.15		18,223
WODO	WOOD DECK - OPEN	2158	16x7		112	25.06	40%	1,684



Rogers
Assessment Property Record Card for Tax Year 2026
 Data provided by LISA DELOZIER County Assessor

Date 04/17/2026
 Time 02:09:15
 Page 3

Sketch Image

660000730

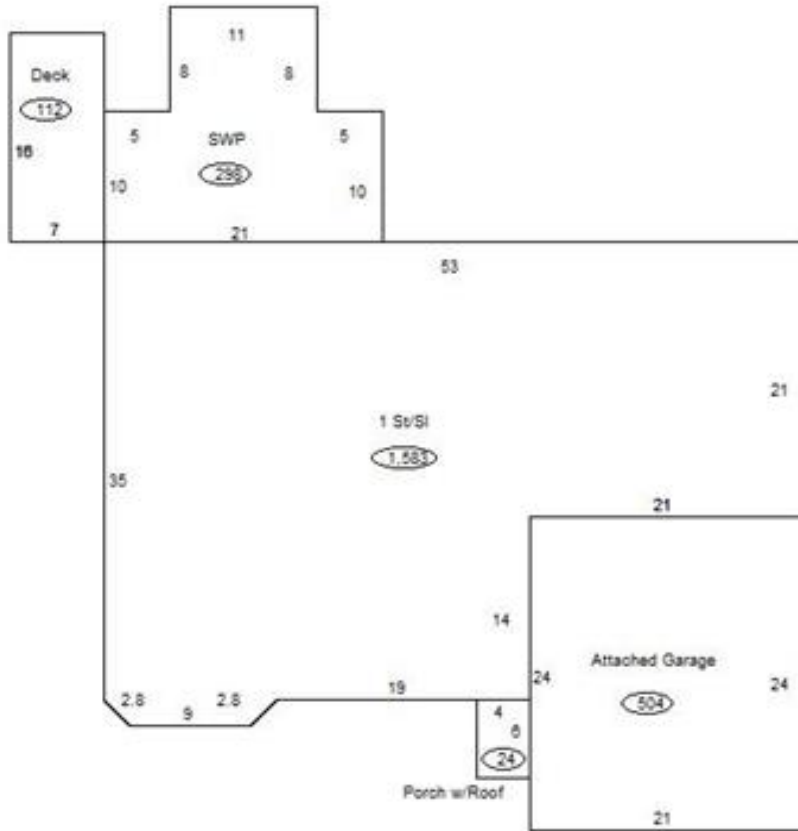

Sketch Vector Information

Sequence	Code	Type	Built Over	Scale	Section Label	Base Area	Multiplier	Total Area
1	R	1	Slab	13	1 St/SI	1,583	1.000	1,583
2	G	1		13	Attached Garage	504	1.000	504
3	M	PRCH		13	SLBC	24	1.000	24
4	M	EPSW		13	EPSW	298	1.000	298
5	M	WODO		13	WODO	112	1.000	112
Total Building Area						1,583		1,583