



Rogers

Assessment Property Record Card for Tax Year 2026

Data provided by LISA DELOZIER County Assessor

Date 04/17/2026
Time 02:09:22
Page 1

Assessment Data					Primary Image																																																																																																																				
Account 660000735 Parcel ID 000000-00-0-00072-005-0001 Cadastral ID 01-22-15-02220 Property Type REAL - Real Property Property Class RRP VI Area 4 Tax Area 11 - SEQUOYAH/NW FIRE Name ID 341630 OFFILL, DONALD & MONYA 13554 S ROCKHILL RD CLAREMORE OK 74017-0000 Parcel Location Situs 13554 S ROCKHILL RD Subdivision BRIARCLIFF ESTATES Lot/Block 0001 / 0005 Parcel Size 1 - Lots Sec/Twn/Rng 1 / 22 / 15 / 5 Neighborhood 1085 - R-V04-NW SEQUOYAH School District S006 - SEQUOYAH SCHOOLS					<p>\\tsclient\T\TOMMY DUNLAP\New folder (34)\IMG_0030.JPG 3/29/2022</p>																																																																																																																				
Legal Description Lot/Long: 36.41386627 -95.65582357 LOT 1 BLOCK 5 BRIARCLIFF ESTATES																																																																																																																									
Exemptions <table border="1"> <thead> <tr> <th>Code</th> <th>Type</th> <th>Active</th> <th>Maximum</th> <th>Exemption</th> </tr> </thead> <tbody> <tr> <td>H</td> <td>Homestead</td> <td>Yes</td> <td>1,000</td> <td>1,000</td> </tr> <tr> <td>H</td> <td>Homestead</td> <td>No</td> <td>1,000</td> <td></td> </tr> </tbody> </table>					Code	Type	Active	Maximum	Exemption	H	Homestead	Yes	1,000	1,000	H	Homestead	No	1,000		Building Permits <table border="1"> <thead> <tr> <th>Number</th> <th>Description</th> <th>Opened</th> <th>Closed</th> <th>Amount</th> </tr> </thead> <tbody> <tr> <td>R19</td> <td>R20-RMA TO INSID PER OWNER</td> <td>03/2018</td> <td>04/2019</td> <td></td> </tr> </tbody> </table>					Number	Description	Opened	Closed	Amount	R19	R20-RMA TO INSID PER OWNER	03/2018	04/2019																																																																																								
Code	Type	Active	Maximum	Exemption																																																																																																																					
H	Homestead	Yes	1,000	1,000																																																																																																																					
H	Homestead	No	1,000																																																																																																																						
Number	Description	Opened	Closed	Amount																																																																																																																					
R19	R20-RMA TO INSID PER OWNER	03/2018	04/2019																																																																																																																						
Parcel Valuation <table border="1"> <thead> <tr> <th>Source</th> <th>REAL</th> <th>Fair Cash</th> <th>Capped</th> <th>Asmnt Level</th> <th>Assessed</th> <th>Levy Rate</th> <th>102.332</th> <th>Current Tax</th> </tr> </thead> <tbody> <tr> <td>Remove Cap</td> <td>2024</td> <td>Land Value</td> <td>131,535</td> <td>131,535</td> <td>11%</td> <td>14,469</td> <td>Assessed</td> <td>32,158 3,290.78</td> </tr> <tr> <td>Year Frozen</td> <td>2010</td> <td>Improvements</td> <td>160,811</td> <td>160,811</td> <td></td> <td>17,689</td> <td>Penalty</td> <td>0</td> </tr> <tr> <td>Uncapped Value</td> <td>0</td> <td>Mobile Home</td> <td>0</td> <td>0</td> <td></td> <td>0</td> <td>Exemption</td> <td>1,000 -89.00</td> </tr> <tr> <td>TIF Project ID</td> <td>0</td> <td>Total Value</td> <td>292,346</td> <td>292,346</td> <td></td> <td>32,158</td> <td>Total Taxable</td> <td>31,158 3,202.00</td> </tr> </tbody> </table>					Source	REAL	Fair Cash	Capped	Asmnt Level	Assessed	Levy Rate	102.332	Current Tax	Remove Cap	2024	Land Value	131,535	131,535	11%	14,469	Assessed	32,158 3,290.78	Year Frozen	2010	Improvements	160,811	160,811		17,689	Penalty	0	Uncapped Value	0	Mobile Home	0	0		0	Exemption	1,000 -89.00	TIF Project ID	0	Total Value	292,346	292,346		32,158	Total Taxable	31,158 3,202.00	Sale History <table border="1"> <thead> <tr> <th>Bk/Pg</th> <th>Grantor</th> <th>Date</th> <th>Price</th> <th>Code</th> </tr> </thead> <tbody> <tr> <td>/</td> <td>WESSEL, JIMMY J & ROBIN</td> <td>05/22/2023</td> <td>300,000</td> <td>YES</td> </tr> <tr> <td>/</td> <td>LOCKHART, LORA MAE</td> <td>01/15/2021</td> <td>195,000</td> <td>YES</td> </tr> <tr> <td>2672/761</td> <td>DOUCETTE, REBECCA S-TRUSTEE</td> <td>10/27/2017</td> <td>100,000</td> <td>7</td> </tr> <tr> <td>2655/625</td> <td>BAINES, JERRY B & LEONA GWYNN</td> <td>08/17/2017</td> <td>0</td> <td>4</td> </tr> <tr> <td>2634/637</td> <td>BAINES, JERRY B & LEONA G</td> <td>05/19/2017</td> <td>0</td> <td>4</td> </tr> </tbody> </table>					Bk/Pg	Grantor	Date	Price	Code	/	WESSEL, JIMMY J & ROBIN	05/22/2023	300,000	YES	/	LOCKHART, LORA MAE	01/15/2021	195,000	YES	2672/761	DOUCETTE, REBECCA S-TRUSTEE	10/27/2017	100,000	7	2655/625	BAINES, JERRY B & LEONA GWYNN	08/17/2017	0	4	2634/637	BAINES, JERRY B & LEONA G	05/19/2017	0	4																																					
Source	REAL	Fair Cash	Capped	Asmnt Level	Assessed	Levy Rate	102.332	Current Tax																																																																																																																	
Remove Cap	2024	Land Value	131,535	131,535	11%	14,469	Assessed	32,158 3,290.78																																																																																																																	
Year Frozen	2010	Improvements	160,811	160,811		17,689	Penalty	0																																																																																																																	
Uncapped Value	0	Mobile Home	0	0		0	Exemption	1,000 -89.00																																																																																																																	
TIF Project ID	0	Total Value	292,346	292,346		32,158	Total Taxable	31,158 3,202.00																																																																																																																	
Bk/Pg	Grantor	Date	Price	Code																																																																																																																					
/	WESSEL, JIMMY J & ROBIN	05/22/2023	300,000	YES																																																																																																																					
/	LOCKHART, LORA MAE	01/15/2021	195,000	YES																																																																																																																					
2672/761	DOUCETTE, REBECCA S-TRUSTEE	10/27/2017	100,000	7																																																																																																																					
2655/625	BAINES, JERRY B & LEONA GWYNN	08/17/2017	0	4																																																																																																																					
2634/637	BAINES, JERRY B & LEONA G	05/19/2017	0	4																																																																																																																					
Assessment History <table border="1"> <thead> <tr> <th>Tax Year</th> <th>Statement Number</th> <th>Billed Owner</th> <th>Tax Area</th> <th>Total Value</th> <th>Exemptions</th> <th>Taxable Value</th> <th>Billed Tax</th> </tr> </thead> <tbody> <tr><td>2025</td><td>2025-660000735</td><td>OFFILL, DONALD & MONYA</td><td>11</td><td>289,923</td><td>1000</td><td>30,892</td><td>3,175.00</td></tr> <tr><td>2024</td><td>2024-660000735</td><td>OFFILL, DONALD & MONYA</td><td>11</td><td>300,542</td><td>1000</td><td>32,060</td><td>3,306.00</td></tr> <tr><td>2023</td><td>2023-660000735</td><td>OFFILL, DONALD & MONYA</td><td>11</td><td>195,000</td><td>1000</td><td>20,450</td><td>2,157.00</td></tr> <tr><td>2022</td><td>2022-660000735</td><td>WESSEL, JIMMY J & ROBIN</td><td>11</td><td>195,105</td><td>0</td><td>21,462</td><td>2,264.00</td></tr> <tr><td>2021</td><td>2021-660000735</td><td>WESSEL, JIMMY J & ROBIN</td><td>11</td><td>169,467</td><td>1000</td><td>17,004</td><td>1,745.00</td></tr> <tr><td>2020</td><td>2020-660000735</td><td>LOCKHART, LORA MAE</td><td>11</td><td>166,616</td><td>1000</td><td>16,479</td><td>1,746.00</td></tr> <tr><td>2019</td><td>2019-660000735</td><td>LOCKHART, LORA MAE</td><td>11</td><td>151,720</td><td>1000</td><td>14,879</td><td>1,557.00</td></tr> <tr><td>2018</td><td>2018-660000735</td><td>LOCKHART, LORA MAE</td><td>11</td><td>140,154</td><td>1000</td><td>14,417</td><td>1,525.00</td></tr> <tr><td>2017</td><td>2017-660000735</td><td>DOUCETTE, REBECCA S-TRUSTEE</td><td>11</td><td>138,987</td><td>1000</td><td>10,168</td><td>1,054.00</td></tr> <tr><td>2016</td><td>2016-660000735</td><td>BAINES, JERRY B & LEONA G</td><td>11</td><td>135,381</td><td>1000</td><td>10,169</td><td>1,061.00</td></tr> <tr><td>2015</td><td>2015-660000735</td><td>BAINES, JERRY B & LEONA G</td><td>11</td><td>134,334</td><td>1000</td><td>10,169</td><td>1,069.00</td></tr> <tr><td>2014</td><td>2014-660000735</td><td>BAINES, JERRY B & LEONA G</td><td>11</td><td>136,943</td><td>1000</td><td>10,169</td><td>1,069.00</td></tr> <tr><td>2013</td><td>2013-660000735</td><td>BAINES, JERRY B & LEONA G</td><td>11</td><td>127,303</td><td>1000</td><td>10,169</td><td>1,051.00</td></tr> </tbody> </table>										Tax Year	Statement Number	Billed Owner	Tax Area	Total Value	Exemptions	Taxable Value	Billed Tax	2025	2025-660000735	OFFILL, DONALD & MONYA	11	289,923	1000	30,892	3,175.00	2024	2024-660000735	OFFILL, DONALD & MONYA	11	300,542	1000	32,060	3,306.00	2023	2023-660000735	OFFILL, DONALD & MONYA	11	195,000	1000	20,450	2,157.00	2022	2022-660000735	WESSEL, JIMMY J & ROBIN	11	195,105	0	21,462	2,264.00	2021	2021-660000735	WESSEL, JIMMY J & ROBIN	11	169,467	1000	17,004	1,745.00	2020	2020-660000735	LOCKHART, LORA MAE	11	166,616	1000	16,479	1,746.00	2019	2019-660000735	LOCKHART, LORA MAE	11	151,720	1000	14,879	1,557.00	2018	2018-660000735	LOCKHART, LORA MAE	11	140,154	1000	14,417	1,525.00	2017	2017-660000735	DOUCETTE, REBECCA S-TRUSTEE	11	138,987	1000	10,168	1,054.00	2016	2016-660000735	BAINES, JERRY B & LEONA G	11	135,381	1000	10,169	1,061.00	2015	2015-660000735	BAINES, JERRY B & LEONA G	11	134,334	1000	10,169	1,069.00	2014	2014-660000735	BAINES, JERRY B & LEONA G	11	136,943	1000	10,169	1,069.00	2013	2013-660000735	BAINES, JERRY B & LEONA G	11	127,303	1000	10,169	1,051.00
Tax Year	Statement Number	Billed Owner	Tax Area	Total Value	Exemptions	Taxable Value	Billed Tax																																																																																																																		
2025	2025-660000735	OFFILL, DONALD & MONYA	11	289,923	1000	30,892	3,175.00																																																																																																																		
2024	2024-660000735	OFFILL, DONALD & MONYA	11	300,542	1000	32,060	3,306.00																																																																																																																		
2023	2023-660000735	OFFILL, DONALD & MONYA	11	195,000	1000	20,450	2,157.00																																																																																																																		
2022	2022-660000735	WESSEL, JIMMY J & ROBIN	11	195,105	0	21,462	2,264.00																																																																																																																		
2021	2021-660000735	WESSEL, JIMMY J & ROBIN	11	169,467	1000	17,004	1,745.00																																																																																																																		
2020	2020-660000735	LOCKHART, LORA MAE	11	166,616	1000	16,479	1,746.00																																																																																																																		
2019	2019-660000735	LOCKHART, LORA MAE	11	151,720	1000	14,879	1,557.00																																																																																																																		
2018	2018-660000735	LOCKHART, LORA MAE	11	140,154	1000	14,417	1,525.00																																																																																																																		
2017	2017-660000735	DOUCETTE, REBECCA S-TRUSTEE	11	138,987	1000	10,168	1,054.00																																																																																																																		
2016	2016-660000735	BAINES, JERRY B & LEONA G	11	135,381	1000	10,169	1,061.00																																																																																																																		
2015	2015-660000735	BAINES, JERRY B & LEONA G	11	134,334	1000	10,169	1,069.00																																																																																																																		
2014	2014-660000735	BAINES, JERRY B & LEONA G	11	136,943	1000	10,169	1,069.00																																																																																																																		
2013	2013-660000735	BAINES, JERRY B & LEONA G	11	127,303	1000	10,169	1,051.00																																																																																																																		



Rogers

Assessment Property Record Card for Tax Year 2026

Data provided by LISA DELOZIER County Assessor

Date 04/17/2026
 Time 02:09:23
 Page 2

Lot Data		Square-Foot - NBHD 1085 #1	
Lot Size			
Lot Count			
Units Buildable	22000		
Non-Ag Acres	0.5154		
Topography			
Street Access			
Utilities			
Amenities	LAND QUALITY	0	
		0	
Method	Square-Foot		
Base Lot Value	22,450.00 x 3.15 = 70,718		
Factor Value			
Adjustments	1.8600		
Lot Value	131,535		

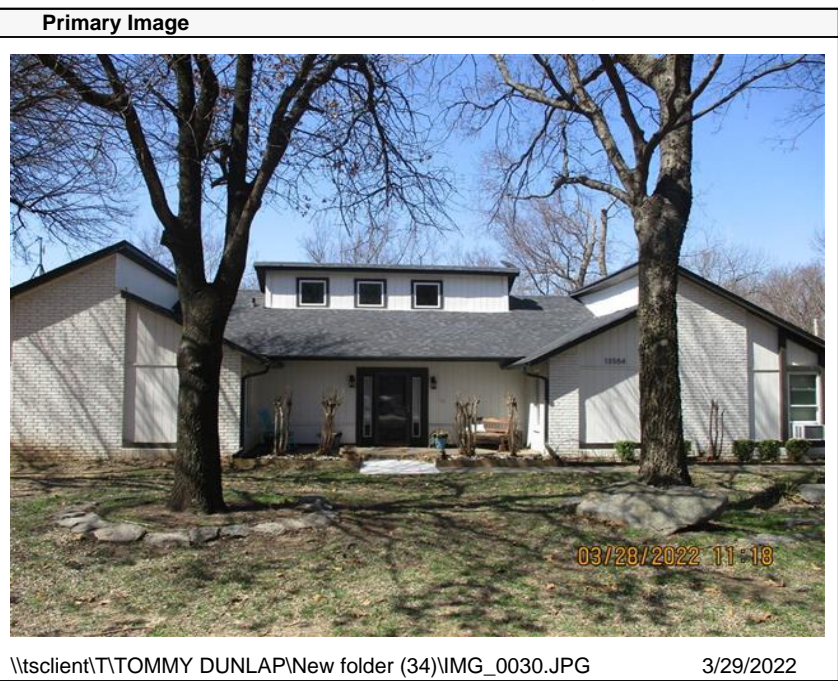

\\tsclient\T\TOMMY DUNLAP\New folder (34)\IMG_0030.JPG 3/29/2022

Residential Data	
Type	1 Single Family Residence
Condition	3 - Average
Quality	3.5 - Average
Architecture	
Style	100% One Story
Exterior Wall	80% Veneer, Masonry 20% Frame, Siding, Wood
Base/Total Area	1,891 / 1,891
Style	100% One Story
HVAC	100% Warmed & Cooled Air
Roof Cover	1 Composition Shingle
Area on Slab	1,891
Fixture/RghIn	11 /
Bed/F/H Bath	3 / 2.0 /
Basement Area	
Garage Type	504 Attached Garage - Unfinished
Remodel	
Year/Eff Age	1976 / 38

GRM Approach

GRM Code	
Gross Rent	0.00
Indicated Value	

Multiple Regression

MRA Code	1 Test
Adjusted R	0.8445
Indicated Value	230,461 121.87 Per SqFt

Direct Comparables

Selection Model	A Adam Test
Adjustment Model	1 2022 Residential
Comparables	4
Indicated Value	219,490 Per SqFt

Value Reconciliation

Selected Approach	Cost Approach
Improvements	160,811
Lot Value	131,535
Indicated Value	292,346 154.60 Per SqFt
Agland Value	
Site Improvements	
Total Value	292,346 154.60 Total Value Per SqFt

Cost Approach		Manual : 01/2025	
Base Cost	109.73	Total Misc Impr	+ 16,527
Roofing Adj	+ 5.32	Garage Cost	+ 20,024
Subfloor Adj	+ -3.62	Total RCN	= 292,384
Heat/Cool Adj	+ 14.47	Depreciation (45%)	- 131,573
Plumbing Adj	+ 9.39	Lump Sums	+ 0
Basement Adj	+ 0.00	RCNLD	= 160,811
Adj Base Cost	= 135.29	Lot Value	+ 131,535
Total Area	x 1,891	Indicated Value	= 292,346
Adjusted Cost	= 255,833	Value Per SqFt	154.60

Miscellaneous Improvements

Code	Description	Sketch ID	Size	Year	Units	Unit Cost	Depr	Value
FPR1	FIREPLACE - RESIDENTIAL 1 STORY	0		1	1	6,429.63		6,430
PRCH	SLAB PORCH - COVERED	2165	16x10		160	28.96		4,634
PATO	SLAB PORCH - OPEN	2166	17x10		170	12.20		2,074
PATO	SLAB PORCH - OPEN	2167	11x10		110	12.82		1,410
PATO	SLAB PORCH - OPEN	2168	23x7		161	12.29		1,979



Rogers
Assessment Property Record Card for Tax Year 2026
 Data provided by LISA DELOZIER County Assessor

Date 04/17/2026
 Time 02:09:23
 Page 3

Sketch Image

660000735

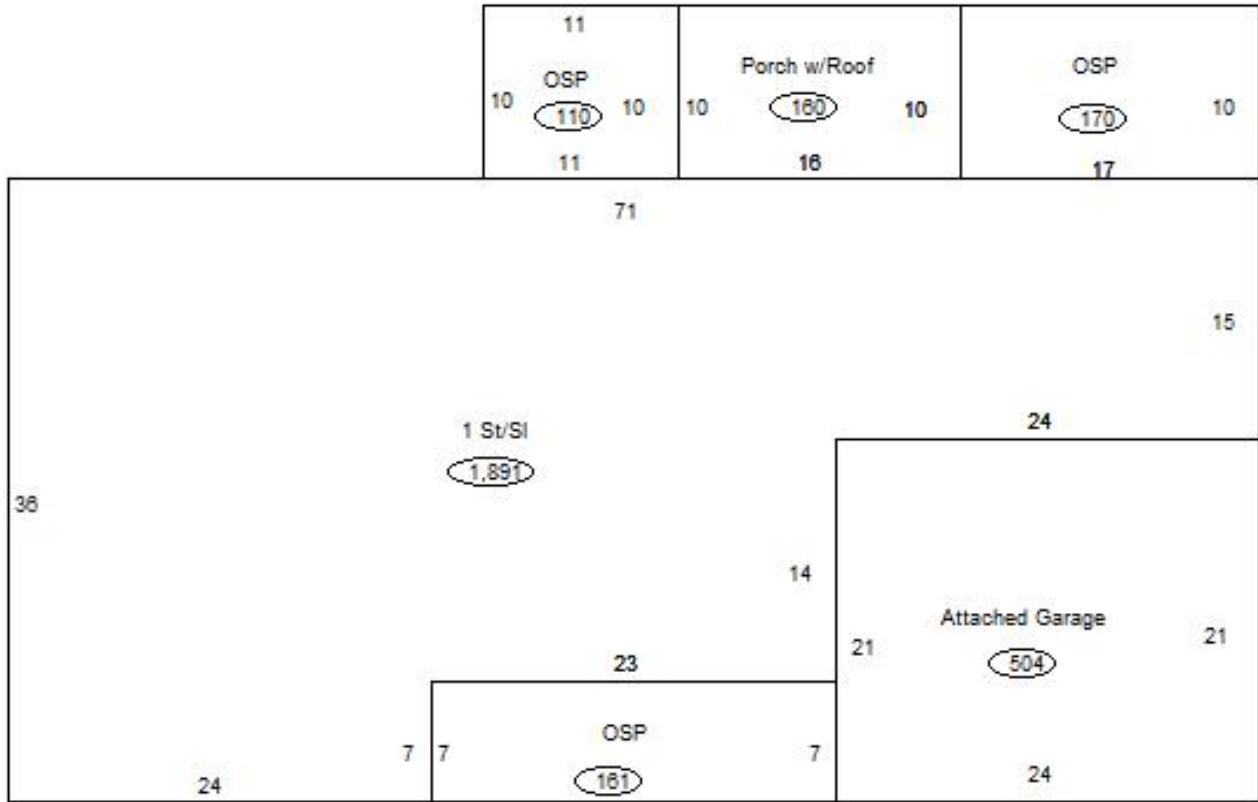

Sketch Vector Information

Sequence	Code	Type	Built Over	Scale	Section Label	Base Area	Multiplier	Total Area
1	R	1	Slab	13	1 St/Sl	1,891	1.000	1,891
2	G	1		13	Attached Garage	504	1.000	504
3	M	PRCH		13	SLBC	160	1.000	160
4	M	PATO		13	Open Slab	170	1.000	170
5	M	PATO		13	Open Slab	110	1.000	110
6	M	PATO		13	Open Slab	161	1.000	161
Total Building Area						1,891		1,891