



Rogers

Assessment Property Record Card for Tax Year 2026

Data provided by LISA DELOZIER County Assessor

Date 04/17/2026
 Time 02:09:28
 Page 1

Assessment Data					Primary Image																																																																																																																				
Account 660000740 Parcel ID 000000-00-0-00072-005-0006 Cadastral ID 01-22-15-02270 Property Type REAL - Real Property Property Class RRP VI Area 4 Tax Area 11 - SEQUOYAH/NW FIRE Name ID 269378 SMITH, VIRGLE L & THE SMITH FAMILY REVOCABLE LIVING TRUST 9764 E CANYON RD CLAREMORE OK 74017-0000					<p>\\tsclient\C\Users\rln\Pictures\2018-01-25\IMG_0023.JPG 1/29/2018</p>																																																																																																																				
Parcel Location Situs 09764 E CANYON RD Subdivision BRIARCLIFF ESTATES Lot/Block 0006 / 0005 Parcel Size 1 - Lots Sec/Twn/Rng 1 / 22 / 15 / 5 Neighborhood 1085 - R-V04-NW SEQUOYAH School District S006 - SEQUOYAH SCHOOLS																																																																																																																									
Legal Description Lat/Long: 36.41304015 -95.65455697 LOT 6 BLOCK 5 BRIARCLIFF ESTATES					Building Permits <table border="1"> <thead> <tr> <th>Number</th> <th>Description</th> <th>Opened</th> <th>Closed</th> <th>Amount</th> </tr> </thead> <tbody> <tr> <td colspan="5" style="height: 100px;"> </td> </tr> </tbody> </table>					Number	Description	Opened	Closed	Amount																																																																																																											
Number	Description	Opened	Closed	Amount																																																																																																																					
Exemptions <table border="1"> <thead> <tr> <th>Code</th> <th>Type</th> <th>Active</th> <th>Maximum</th> <th>Exemption</th> </tr> </thead> <tbody> <tr> <td>H</td> <td>Homestead</td> <td>Yes</td> <td>1,000</td> <td>1,000</td> </tr> </tbody> </table>					Code	Type	Active	Maximum	Exemption	H	Homestead	Yes	1,000	1,000	Sale History <table border="1"> <thead> <tr> <th>Bk/Pg</th> <th>Grantor</th> <th>Date</th> <th>Price</th> <th>Code</th> </tr> </thead> <tbody> <tr> <td>1133/597</td> <td>STAUFFER, HELEN (LIFE EST)</td> <td>09/18/1998</td> <td>125,000</td> <td>Yes</td> </tr> </tbody> </table>					Bk/Pg	Grantor	Date	Price	Code	1133/597	STAUFFER, HELEN (LIFE EST)	09/18/1998	125,000	Yes																																																																																												
Code	Type	Active	Maximum	Exemption																																																																																																																					
H	Homestead	Yes	1,000	1,000																																																																																																																					
Bk/Pg	Grantor	Date	Price	Code																																																																																																																					
1133/597	STAUFFER, HELEN (LIFE EST)	09/18/1998	125,000	Yes																																																																																																																					
Parcel Valuation <table border="1"> <thead> <tr> <th>Source</th> <th>REAL</th> <th>Fair Cash</th> <th>Capped</th> <th>Asmnt Level</th> <th>Assessed</th> <th>Levy Rate</th> <th>102.332</th> <th>Current Tax</th> </tr> </thead> <tbody> <tr> <td>Remove Cap</td> <td>1999</td> <td>Land Value 73,827</td> <td>26,485</td> <td>11%</td> <td>2,913</td> <td>Assessed</td> <td>21,343</td> <td>2,184.06</td> </tr> <tr> <td>Year Frozen</td> <td>0</td> <td>Improvements 167,542</td> <td>167,542</td> <td></td> <td>18,430</td> <td>Penalty</td> <td>0</td> <td></td> </tr> <tr> <td>Uncapped Value</td> <td>0</td> <td>Mobile Home 0</td> <td>0</td> <td></td> <td>0</td> <td>Exemption</td> <td>1,000</td> <td>-88.00</td> </tr> <tr> <td>TIF Project ID</td> <td>0</td> <td>Total Value 241,369</td> <td>194,027</td> <td></td> <td>21,343</td> <td>Total Taxable</td> <td>20,343</td> <td>2,096.00</td> </tr> </tbody> </table>										Source	REAL	Fair Cash	Capped	Asmnt Level	Assessed	Levy Rate	102.332	Current Tax	Remove Cap	1999	Land Value 73,827	26,485	11%	2,913	Assessed	21,343	2,184.06	Year Frozen	0	Improvements 167,542	167,542		18,430	Penalty	0		Uncapped Value	0	Mobile Home 0	0		0	Exemption	1,000	-88.00	TIF Project ID	0	Total Value 241,369	194,027		21,343	Total Taxable	20,343	2,096.00																																																																			
Source	REAL	Fair Cash	Capped	Asmnt Level	Assessed	Levy Rate	102.332	Current Tax																																																																																																																	
Remove Cap	1999	Land Value 73,827	26,485	11%	2,913	Assessed	21,343	2,184.06																																																																																																																	
Year Frozen	0	Improvements 167,542	167,542		18,430	Penalty	0																																																																																																																		
Uncapped Value	0	Mobile Home 0	0		0	Exemption	1,000	-88.00																																																																																																																	
TIF Project ID	0	Total Value 241,369	194,027		21,343	Total Taxable	20,343	2,096.00																																																																																																																	
Assessment History <table border="1"> <thead> <tr> <th>Tax Year</th> <th>Statement Number</th> <th>Billed Owner</th> <th>Tax Area</th> <th>Total Value</th> <th>Exemptions</th> <th>Taxable Value</th> <th>Billed Tax</th> </tr> </thead> <tbody> <tr><td>2025</td><td>2025-660000740</td><td>SMITH, VIRGLE L &</td><td>11</td><td>238,889</td><td>1000</td><td>19,722</td><td>2,032.00</td></tr> <tr><td>2024</td><td>2024-660000740</td><td>SMITH, VIRGLE L &</td><td>11</td><td>250,602</td><td>1000</td><td>19,118</td><td>1,978.00</td></tr> <tr><td>2023</td><td>2023-660000740</td><td>SMITH, VIRGLE L &</td><td>11</td><td>177,564</td><td>1000</td><td>18,532</td><td>1,956.00</td></tr> <tr><td>2022</td><td>2022-660000740</td><td>SMITH, VIRGLE L &</td><td>11</td><td>180,484</td><td>1000</td><td>18,853</td><td>2,003.00</td></tr> <tr><td>2021</td><td>2021-660000740</td><td>SMITH, VIRGLE L &</td><td>11</td><td>192,557</td><td>1000</td><td>20,181</td><td>2,068.00</td></tr> <tr><td>2020</td><td>2020-660000740</td><td>SMITH, VIRGLE L &</td><td>11</td><td>189,262</td><td>1000</td><td>19,652</td><td>2,079.00</td></tr> <tr><td>2019</td><td>2019-660000740</td><td>SMITH, VIRGLE L & SUZANNE L</td><td>11</td><td>182,275</td><td>1000</td><td>19,050</td><td>1,989.00</td></tr> <tr><td>2018</td><td>2018-660000740</td><td>SMITH, VIRGLE L & SUZANNE L</td><td>11</td><td>188,158</td><td>1000</td><td>18,542</td><td>1,956.00</td></tr> <tr><td>2017</td><td>2017-660000740</td><td>SMITH, VIRGLE L & SUZANNE L</td><td>11</td><td>186,531</td><td>1000</td><td>17,972</td><td>1,852.00</td></tr> <tr><td>2016</td><td>2016-660000740</td><td>SMITH, VIRGLE L & SUZANNE L</td><td>11</td><td>181,470</td><td>1000</td><td>17,420</td><td>1,807.00</td></tr> <tr><td>2015</td><td>2015-660000740</td><td>SMITH, VIRGLE L & SUZANNE L</td><td>11</td><td>175,357</td><td>1000</td><td>16,884</td><td>1,768.00</td></tr> <tr><td>2014</td><td>2014-660000740</td><td>SMITH, VIRGLE L & SUZANNE L</td><td>11</td><td>176,639</td><td>1000</td><td>16,363</td><td>1,713.00</td></tr> <tr><td>2013</td><td>2013-660000740</td><td>SMITH, VIRGLE L & SUZANNE L</td><td>11</td><td>163,764</td><td>1000</td><td>15,857</td><td>1,633.00</td></tr> </tbody> </table>										Tax Year	Statement Number	Billed Owner	Tax Area	Total Value	Exemptions	Taxable Value	Billed Tax	2025	2025-660000740	SMITH, VIRGLE L &	11	238,889	1000	19,722	2,032.00	2024	2024-660000740	SMITH, VIRGLE L &	11	250,602	1000	19,118	1,978.00	2023	2023-660000740	SMITH, VIRGLE L &	11	177,564	1000	18,532	1,956.00	2022	2022-660000740	SMITH, VIRGLE L &	11	180,484	1000	18,853	2,003.00	2021	2021-660000740	SMITH, VIRGLE L &	11	192,557	1000	20,181	2,068.00	2020	2020-660000740	SMITH, VIRGLE L &	11	189,262	1000	19,652	2,079.00	2019	2019-660000740	SMITH, VIRGLE L & SUZANNE L	11	182,275	1000	19,050	1,989.00	2018	2018-660000740	SMITH, VIRGLE L & SUZANNE L	11	188,158	1000	18,542	1,956.00	2017	2017-660000740	SMITH, VIRGLE L & SUZANNE L	11	186,531	1000	17,972	1,852.00	2016	2016-660000740	SMITH, VIRGLE L & SUZANNE L	11	181,470	1000	17,420	1,807.00	2015	2015-660000740	SMITH, VIRGLE L & SUZANNE L	11	175,357	1000	16,884	1,768.00	2014	2014-660000740	SMITH, VIRGLE L & SUZANNE L	11	176,639	1000	16,363	1,713.00	2013	2013-660000740	SMITH, VIRGLE L & SUZANNE L	11	163,764	1000	15,857	1,633.00
Tax Year	Statement Number	Billed Owner	Tax Area	Total Value	Exemptions	Taxable Value	Billed Tax																																																																																																																		
2025	2025-660000740	SMITH, VIRGLE L &	11	238,889	1000	19,722	2,032.00																																																																																																																		
2024	2024-660000740	SMITH, VIRGLE L &	11	250,602	1000	19,118	1,978.00																																																																																																																		
2023	2023-660000740	SMITH, VIRGLE L &	11	177,564	1000	18,532	1,956.00																																																																																																																		
2022	2022-660000740	SMITH, VIRGLE L &	11	180,484	1000	18,853	2,003.00																																																																																																																		
2021	2021-660000740	SMITH, VIRGLE L &	11	192,557	1000	20,181	2,068.00																																																																																																																		
2020	2020-660000740	SMITH, VIRGLE L &	11	189,262	1000	19,652	2,079.00																																																																																																																		
2019	2019-660000740	SMITH, VIRGLE L & SUZANNE L	11	182,275	1000	19,050	1,989.00																																																																																																																		
2018	2018-660000740	SMITH, VIRGLE L & SUZANNE L	11	188,158	1000	18,542	1,956.00																																																																																																																		
2017	2017-660000740	SMITH, VIRGLE L & SUZANNE L	11	186,531	1000	17,972	1,852.00																																																																																																																		
2016	2016-660000740	SMITH, VIRGLE L & SUZANNE L	11	181,470	1000	17,420	1,807.00																																																																																																																		
2015	2015-660000740	SMITH, VIRGLE L & SUZANNE L	11	175,357	1000	16,884	1,768.00																																																																																																																		
2014	2014-660000740	SMITH, VIRGLE L & SUZANNE L	11	176,639	1000	16,363	1,713.00																																																																																																																		
2013	2013-660000740	SMITH, VIRGLE L & SUZANNE L	11	163,764	1000	15,857	1,633.00																																																																																																																		



Rogers

Assessment Property Record Card for Tax Year 2026

Data provided by LISA DELOZIER County Assessor

Date 04/17/2026
 Time 02:09:28
 Page 2

Lot Data	Square-Foot - NBHD 1085 #1	Primary Image
Lot Size Lot Count Units Buildable 23359 Non-Ag Acres 0.538 Topography Street Access Utilities Amenities LAND QUALITY 0 0 Method Square-Foot Base Lot Value 23,437.00 x 3.15 = 73,827 Factor Value Adjustments 1.0000 Lot Value 73,827		 <p>\\tsclient\C\Users\rln\Pictures\2018-01-25\IMG_0023.JPG 1/29/2018</p>

Residential Data	
Type	1 Single Family Residence
Condition	3 - Average
Quality	2.5 - Fair
Architecture	
Style	100% 1 1/2 Story Finished
Exterior Wall	100% Veneer, Masonry
Base/Total Area	1,668 / 2,532
Style	100% 1 1/2 Story Finished
HVAC	100% Warmed & Cooled Air
Roof Cover	1 Composition Shingle
Area on Slab	1,668
Fixture/RghIn	14 /
Bed/F/H Bath	3 / 2.5 /
Basement Area	
Garage Type	600 Attached Garage - Unfinished
Remodel	
Year/Eff Age	1977 / 37

GRM Approach	
GRM Code	
Gross Rent	0.00
Indicated Value	

Multiple Regression			
MRA Code	1	Test	
Adusted R	0.8445		
Indicated Value	232,876	91.97	Per SqFt

Direct Comparables			
Selection Model	A	Adam Test	
Adjustment Model	1	2022 Residential	
Comparables	2		
Indicated Value	252,770		Per SqFt

Cost Approach				Manual : 01/2025			
Base Cost	87.91	Total Misc Impr	+	10,769			
Roofing Adj	+ 2.91	Garage Cost	+	15,792			
Subfloor Adj	+ -0.76	Total RCN	=	301,384			
Heat/Cool Adj	+ 11.47	Depreciation (46%)	-	138,637			
Plumbing Adj	+ 7.01	Lump Sums	+	4,795			
Basement Adj	+ 0.00	RCNLD	=	167,542			
Adj Base Cost	= 108.54	Lot Value	+	73,827			
Total Area	x 2,532	Indicated Value	=	241,369			
Adjusted Cost	= 274,823	Value Per SqFt		95.33			

Value Reconciliation			
Selected Approach	Cost Approach		
Improvements	167,542		
Lot Value	73,827		
Indicated Value	241,369	95.33	Per SqFt
Agland Value			
Site Improvements			
Total Value	241,369	95.33	Total Value Per SqFt

Miscellaneous Improvements								
Code	Description	Sketch ID	Size	Year	Units	Unit Cost	Depr	Value
FPR1	FIREPLACE - RESIDENTIAL 1 STORY	0		1	1	5,095.98		5,096
PATO	SLAB PORCH - OPEN	2191	6x2		12	10.86		130
PATO	SLAB PORCH - OPEN	2192	32x12		384	8.18		3,141
PATO	SLAB PORCH - OPEN	2193	272		272	8.83		2,402
WODO	WOOD DECK - OPEN	2194	24x12		288	16.65		4,795



Rogers
Assessment Property Record Card for Tax Year 2026

Data provided by LISA DELOZIER County Assessor

Date 04/17/2026
 Time 02:09:28
 Page 3

Sketch Image

660000740

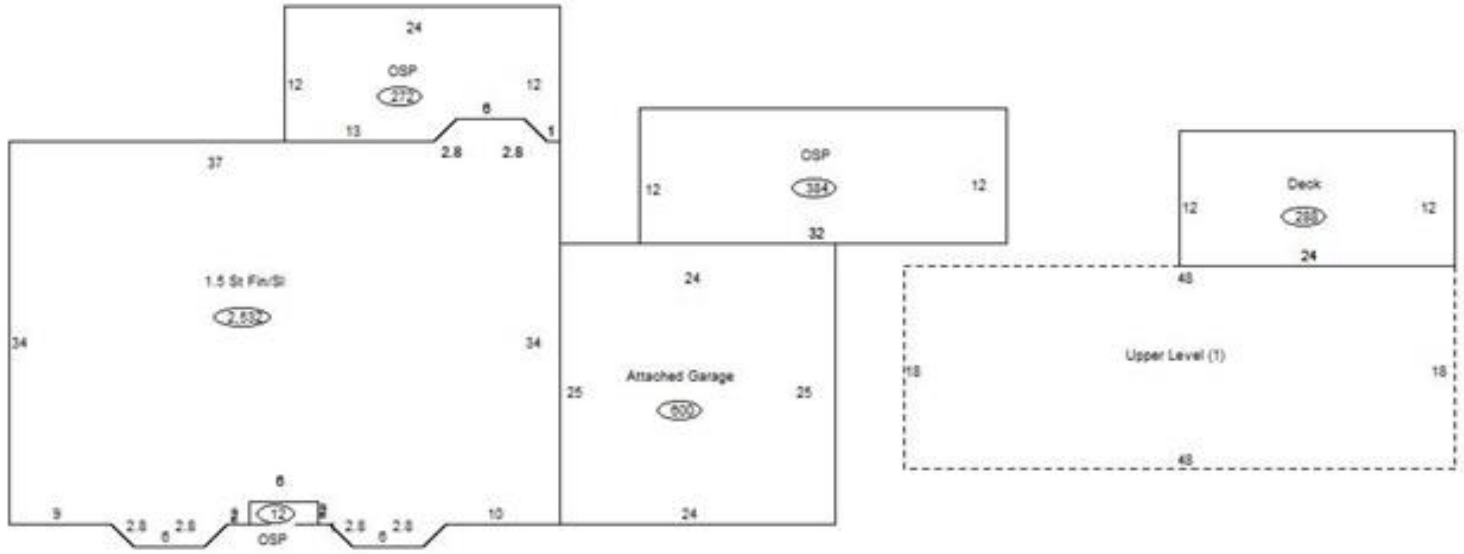

Sketch Vector Information

Sequence	Code	Type	Built Over	Scale	Section Label	Base Area	Multiplier	Total Area
1	R	5	Slab	13	1.5 St Fin/SI	1,668	1.518	2,532
2	G	1		13	Attached Garage	600	1.000	600
3	M	PATO		13	Open Slab	12	1.000	12
4	M	PATO		13	Open Slab	384	1.000	384
5	M	PATO		13	Open Slab	272	1.000	272
6	M	WODO		13	WODO	288	1.000	288
7	U	^UL		13	Upper Level (1)	864	1.000	864
Total Building Area						1,668		2,532