



Rogers

Assessment Property Record Card for Tax Year 2026

Data provided by LISA DELOZIER County Assessor

Date 04/18/2026
Time 05:14:31
Page 1

Assessment Data					Primary Image									
Account	660000838				<p>\\tsclient\S\Employees\Randy\2018-02-08\003.JPG 2/9/2018</p>									
Parcel ID	000000-00-0-00807-003-0003													
Cadastral ID	01-22-15-03280													
Property Type	REAL - Real Property													
Property Class	RRP	VI Area 4												
Tax Area	11 - SEQUOYAH/NW FIRE													
Name ID	283484													
YOUNG, STEPHEN E &														
LISA K														
9705 E DOGWOOD														
CLAREMORE OK 74017-0000														
Parcel Location														
Situs	09705 E DOGWOOD ST													
Subdivision	TACORA HILLS													
Lot/Block	0003 / 0003	Parcel Size 1 - Lots												
Sec/Twn/Rng	1 / 22 / 15 / 5													
Neighborhood	1085 - R-V04-NW SEQUOYAH													
School District	S006 - SEQUOYAH SCHOOLS													
Legal Description														
Lot/Long: 36.41943230 -95.65579103														
LOT 3 BLOCK 3 TACORA HILLS														
Building Permits														
<table border="1"> <thead> <tr> <th>Number</th> <th>Description</th> <th>Opened</th> <th>Closed</th> <th>Amount</th> </tr> </thead> <tbody> <tr> <td> </td> <td> </td> <td> </td> <td> </td> <td> </td> </tr> </tbody> </table>					Number	Description	Opened	Closed	Amount					
Number	Description	Opened	Closed	Amount										
Exemptions														
Code	Type	Active	Maximum	Exemption										
H	Homestead	Yes	1,000	1,000										
Sale History														
Bk/Pg	Grantor	Date	Price	Code										
1520/692	WEILERT, JASON & KERRIE	08/28/2003	102,000	YES										
1142/72	WOODY, CHARLES F JR	11/13/1998	72,500	No										
Parcel Valuation														
Source	REAL	Fair Cash	Capped	Asmnt Level	Assessed	Levy Rate	102.332	Current Tax						
Remove Cap	2004	Land Value	25,014	17,093	11%	1,880	Assessed	15,534 1,589.62						
Year Frozen	0	Improvements	131,559	124,128		13,654	Penalty	0						
Uncapped Value	0	Mobile Home	0	0		0	Exemption	1,000 -89.00						
TIF Project ID	0	Total Value	156,573	141,221		15,534	Total Taxable	14,534 1,501.00						
Assessment History														
Tax Year	Statement Number	Billed Owner	Tax Area	Total Value	Exemptions	Taxable Value	Billed Tax							
2025	2025-660000838	YOUNG, STEPHEN E &	11	154,450	1000	14,081	1,455.00							
2024	2024-660000838	YOUNG, STEPHEN E &	11	164,150	1000	13,642	1,415.00							
2023	2023-660000838	YOUNG, STEPHEN E &	11	129,238	1000	13,216	1,399.00							
2022	2022-660000838	YOUNG, STEPHEN E &	11	127,308	1000	13,004	1,386.00							
2021	2021-660000838	YOUNG, STEPHEN E &	11	130,366	1000	12,897	1,326.00							
2020	2020-660000838	YOUNG, STEPHEN E &	11	128,172	1000	12,492	1,327.00							
2019	2019-660000838	YOUNG, STEPHEN E &	11	124,974	1000	12,099	1,269.00							
2018	2018-660000838	YOUNG, STEPHEN E &	11	115,616	1000	11,718	1,242.00							
2017	2017-660000838	YOUNG, STEPHEN E &	11	114,643	1000	11,611	1,202.00							
2016	2016-660000838	YOUNG, STEPHEN E &	11	111,637	2000	10,280	1,086.00							
2015	2015-660000838	YOUNG, STEPHEN E &	11	112,193	1000	11,313	1,189.00							
2014	2014-660000838	YOUNG, STEPHEN E &	11	111,897	1000	10,954	1,151.00							
2013	2013-660000838	YOUNG, STEPHEN E &	11	106,575	1000	10,606	1,095.00							



Rogers

Assessment Property Record Card for Tax Year 2026

Data provided by LISA DELOZIER County Assessor

Date 04/18/2026
Time 05:14:31
Page 2

Lot Data	Square-Foot - NBHD 1085 #1	Primary Image
Lot Size Lot Count Units Buildable 1 Non-Ag Acres 0.1823 Topography Street Access Utilities Amenities LAND QUALITY 0 0 Method Square-Foot Base Lot Value 7,941.00 x 3.15 = 25,014 Factor Value Adjustments 1.0000 Lot Value 25,014		

Residential Data	
Type	1 Single Family Residence
Condition	3 - Average
Quality	2.5 - Fair
Architecture	
Style	100% One Story
Exterior Wall	100% Veneer, Stone
Base/Total Area	1,730 / 1,730
Style	100% One Story
HVAC	100% Warmed & Cooled Air
Roof Cover	1 Composition Shingle
Area on Slab	0
Fixture/RghIn	4 /
Bed/F/H Bath	3 / 1.0 /
Basement Area	
Garage Type	400 Attached Garage - Unfinished
Remodel	
Year/Eff Age	1977 / 37

GRM Approach
GRM Code Gross Rent 0.00 Indicated Value

Multiple Regression	
MRA Code	1 Test
Adusted R	0.8445
Indicated Value	165,803 95.84 Per SqFt

Direct Comparables	
Selection Model	A Adam Test
Adjustment Model	1 2022 Residential
Comparables	
Indicated Value	

Cost Approach				Manual : 01/2025	
Base Cost	109.56	Total Misc Impr	+	7,391	
Roofing Adj	+ 4.39	Garage Cost	+	11,700	
Subfloor Adj	+ 1.15	Total RCN	=	243,628	
Heat/Cool Adj	+ 11.47	Depreciation (46%)	-	112,069	
Plumbing Adj	+ 3.22	Lump Sums	+	0	
Basement Adj	+ 0.00	RCNLD	=	131,559	
Adj Base Cost	= 129.79	Lot Value	+	25,014	
Total Area	x 1,730	Indicated Value	=	156,573	
Adjusted Cost	= 224,537	Value Per SqFt		90.50	

Value Reconciliation			
Selected Approach	Cost Approach		
Improvements	131,559		
Lot Value	25,014		
Indicated Value	156,573	90.50	Per SqFt
Agland Value			
Site Improvements			
Total Value	156,573	90.50	Total Value Per SqFt

Miscellaneous Improvements								
Code	Description	Sketch ID	Size	Year	Units	Unit Cost	Depr	Value
FPR1	FIREPLACE - RESIDENTIAL 1 STORY	0		1	1	5,095.98		5,096
PATO	SLAB PORCH - OPEN	2453	25x10		250	9.18		2,295



Rogers

Assessment Property Record Card for Tax Year 2026

Data provided by LISA DELOZIER County Assessor

Date 04/18/2026
 Time 05:14:31
 Page 3

Sketch Image

660000838

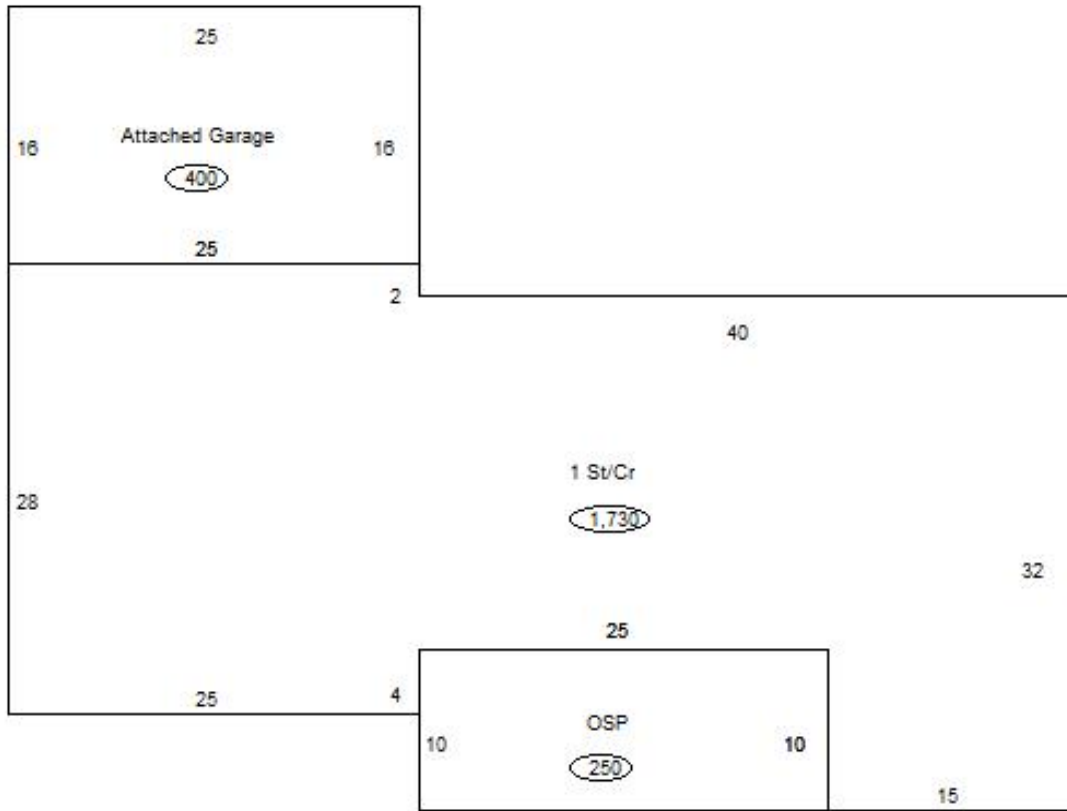

Sketch Vector Information

Sequence	Code	Type	Built Over	Scale	Section Label	Base Area	Multiplier	Total Area
1	R	1	Crawl	13	1 St/Cr	1,730	1.000	1,730
2	G	1		13	Attached Garage	400	1.000	400
3	M	PATO		13	Open Slab	250	1.000	250
Total Building Area						1,730		1,730