



Rogers

Assessment Property Record Card for Tax Year 2026

Data provided by LISA DELOZIER County Assessor

Date 04/17/2026
 Time 15:27:13
 Page 1

Assessment Data					Primary Image																																																																																																															
Account 660000863 Parcel ID 000000-00-0-00807-004-0025 Cadastral ID 01-22-15-03530 Property Type REAL - Real Property Property Class RRP VI Area 4 Tax Area 11 - SEQUOYAH/NW FIRE Name ID 260608 STROBLE, JOHN ANTHONY & YOLANDA BEATRICE 13122 S WALNUT CLAREMORE OK 74017-0000 Parcel Location Situs 13122 S WALNUT RD Subdivision TACORA HILLS Lot/Block 0025 / 0004 Parcel Size 2 - Lots Sec/Twn/Rng 1 / 22 / 15 / 5 Neighborhood 1085 - R-V04-NW SEQUOYAH School District S006 - SEQUOYAH SCHOOLS					<p>03/23/2022 14:01</p> <p>\\tsclient\T\TOMMY DUNLAP\New folder (30)\IMG_0098.JPG 3/24/2022</p>																																																																																																															
Legal Description Lot/Long: 36.41829750 -95.65528228 LOTS 24 & 25 BLOCK 4 TACORA HILLS																																																																																																																				
Exemptions <table border="1"> <thead> <tr> <th>Code</th> <th>Type</th> <th>Active</th> <th>Maximum</th> <th>Exemption</th> </tr> </thead> <tbody> <tr> <td>H</td> <td>Homestead</td> <td>Yes</td> <td>1,000</td> <td>1,000</td> </tr> </tbody> </table>					Code	Type	Active	Maximum	Exemption	H	Homestead	Yes	1,000	1,000	Building Permits <table border="1"> <thead> <tr> <th>Number</th> <th>Description</th> <th>Opened</th> <th>Closed</th> <th>Amount</th> </tr> </thead> <tbody> <tr> <td></td> <td></td> <td></td> <td></td> <td></td> </tr> </tbody> </table>					Number	Description	Opened	Closed	Amount																																																																																												
Code	Type	Active	Maximum	Exemption																																																																																																																
H	Homestead	Yes	1,000	1,000																																																																																																																
Number	Description	Opened	Closed	Amount																																																																																																																
Parcel Valuation <table border="1"> <thead> <tr> <th>Source</th> <th>REAL</th> <th>Fair Cash</th> <th>Capped</th> <th>Asmnt Level</th> <th>Assessed</th> <th>Levy Rate</th> <th>102.332</th> <th>Current Tax</th> </tr> </thead> <tbody> <tr> <td>Remove Cap</td> <td>2009</td> <td>Land Value 63,605</td> <td>23,926</td> <td>11%</td> <td>2,632</td> <td>Assessed</td> <td>14,731</td> <td>1,507.45</td> </tr> <tr> <td>Year Frozen</td> <td>0</td> <td>Improvements 117,461</td> <td>109,995</td> <td></td> <td>12,099</td> <td>Penalty</td> <td>0</td> <td></td> </tr> <tr> <td>Uncapped Value</td> <td>0</td> <td>Mobile Home 0</td> <td>0</td> <td></td> <td>0</td> <td>Exemption</td> <td>1,000</td> <td>-88.00</td> </tr> <tr> <td>TIF Project ID</td> <td>0</td> <td>Total Value 181,066</td> <td>133,921</td> <td></td> <td>14,731</td> <td>Total Taxable</td> <td>13,731</td> <td>1,419.00</td> </tr> </tbody> </table>					Source	REAL	Fair Cash	Capped	Asmnt Level	Assessed	Levy Rate	102.332	Current Tax	Remove Cap	2009	Land Value 63,605	23,926	11%	2,632	Assessed	14,731	1,507.45	Year Frozen	0	Improvements 117,461	109,995		12,099	Penalty	0		Uncapped Value	0	Mobile Home 0	0		0	Exemption	1,000	-88.00	TIF Project ID	0	Total Value 181,066	133,921		14,731	Total Taxable	13,731	1,419.00	Sale History <table border="1"> <thead> <tr> <th>Bk/Pg</th> <th>Grantor</th> <th>Date</th> <th>Price</th> <th>Code</th> </tr> </thead> <tbody> <tr> <td>1935/899</td> <td>DEUTSCHE BANK NATL TRUST-CO</td> <td>02/07/2008</td> <td>65,000</td> <td>3</td> </tr> <tr> <td>1909/253</td> <td>BARBEE, JASON &</td> <td>10/11/2007</td> <td>0</td> <td>10</td> </tr> <tr> <td>1655/205</td> <td>DIDLOT, D R</td> <td>02/04/2005</td> <td>104,500</td> <td>YES</td> </tr> <tr> <td>1136/219</td> <td>TAYLOR, ELMER L & BETTY J</td> <td>10/08/1998</td> <td>75,000</td> <td>Yes</td> </tr> </tbody> </table>					Bk/Pg	Grantor	Date	Price	Code	1935/899	DEUTSCHE BANK NATL TRUST-CO	02/07/2008	65,000	3	1909/253	BARBEE, JASON &	10/11/2007	0	10	1655/205	DIDLOT, D R	02/04/2005	104,500	YES	1136/219	TAYLOR, ELMER L & BETTY J	10/08/1998	75,000	Yes																																					
Source	REAL	Fair Cash	Capped	Asmnt Level	Assessed	Levy Rate	102.332	Current Tax																																																																																																												
Remove Cap	2009	Land Value 63,605	23,926	11%	2,632	Assessed	14,731	1,507.45																																																																																																												
Year Frozen	0	Improvements 117,461	109,995		12,099	Penalty	0																																																																																																													
Uncapped Value	0	Mobile Home 0	0		0	Exemption	1,000	-88.00																																																																																																												
TIF Project ID	0	Total Value 181,066	133,921		14,731	Total Taxable	13,731	1,419.00																																																																																																												
Bk/Pg	Grantor	Date	Price	Code																																																																																																																
1935/899	DEUTSCHE BANK NATL TRUST-CO	02/07/2008	65,000	3																																																																																																																
1909/253	BARBEE, JASON &	10/11/2007	0	10																																																																																																																
1655/205	DIDLOT, D R	02/04/2005	104,500	YES																																																																																																																
1136/219	TAYLOR, ELMER L & BETTY J	10/08/1998	75,000	Yes																																																																																																																
Assessment History <table border="1"> <thead> <tr> <th>Tax Year</th> <th>Statement Number</th> <th>Billed Owner</th> <th>Tax Area</th> <th>Total Value</th> <th>Exemptions</th> <th>Taxable Value</th> <th>Billed Tax</th> </tr> </thead> <tbody> <tr><td>2025</td><td>2025-660000863</td><td>STROBLE, JOHN ANTHONY &</td><td>11</td><td>177,219</td><td>1000</td><td>13,302</td><td>1,375.00</td></tr> <tr><td>2024</td><td>2024-660000863</td><td>STROBLE, JOHN ANTHONY &</td><td>11</td><td>185,859</td><td>1000</td><td>12,886</td><td>1,338.00</td></tr> <tr><td>2023</td><td>2023-660000863</td><td>STROBLE, JOHN ANTHONY &</td><td>11</td><td>122,558</td><td>1000</td><td>12,481</td><td>1,322.00</td></tr> <tr><td>2022</td><td>2022-660000863</td><td>STROBLE, JOHN ANTHONY &</td><td>11</td><td>120,856</td><td>1000</td><td>12,294</td><td>1,310.00</td></tr> <tr><td>2021</td><td>2021-660000863</td><td>STROBLE, JOHN ANTHONY &</td><td>11</td><td>131,331</td><td>1000</td><td>13,446</td><td>1,382.00</td></tr> <tr><td>2020</td><td>2020-660000863</td><td>STROBLE, JOHN ANTHONY &</td><td>11</td><td>130,555</td><td>1000</td><td>13,072</td><td>1,388.00</td></tr> <tr><td>2019</td><td>2019-660000863</td><td>STROBLE, JOHN ANTHONY &</td><td>11</td><td>124,199</td><td>1000</td><td>12,662</td><td>1,327.00</td></tr> <tr><td>2018</td><td>2018-660000863</td><td>STROBLE, JOHN ANTHONY &</td><td>11</td><td>130,190</td><td>1000</td><td>13,288</td><td>1,406.00</td></tr> <tr><td>2017</td><td>2017-660000863</td><td>STROBLE, JOHN ANTHONY &</td><td>11</td><td>129,138</td><td>1000</td><td>12,872</td><td>1,331.00</td></tr> <tr><td>2016</td><td>2016-660000863</td><td>STROBLE, JOHN ANTHONY &</td><td>11</td><td>125,824</td><td>1000</td><td>12,468</td><td>1,298.00</td></tr> <tr><td>2015</td><td>2015-660000863</td><td>STROBLE, JOHN ANTHONY &</td><td>11</td><td>124,058</td><td>1000</td><td>12,076</td><td>1,268.00</td></tr> <tr><td>2014</td><td>2014-660000863</td><td>STROBLE, JOHN ANTHONY &</td><td>11</td><td>126,201</td><td>1000</td><td>11,695</td><td>1,228.00</td></tr> <tr><td>2013</td><td>2013-660000863</td><td>STROBLE, JOHN ANTHONY &</td><td>11</td><td>119,888</td><td>1000</td><td>11,325</td><td>1,170.00</td></tr> </tbody> </table>					Tax Year	Statement Number	Billed Owner	Tax Area	Total Value	Exemptions	Taxable Value	Billed Tax	2025	2025-660000863	STROBLE, JOHN ANTHONY &	11	177,219	1000	13,302	1,375.00	2024	2024-660000863	STROBLE, JOHN ANTHONY &	11	185,859	1000	12,886	1,338.00	2023	2023-660000863	STROBLE, JOHN ANTHONY &	11	122,558	1000	12,481	1,322.00	2022	2022-660000863	STROBLE, JOHN ANTHONY &	11	120,856	1000	12,294	1,310.00	2021	2021-660000863	STROBLE, JOHN ANTHONY &	11	131,331	1000	13,446	1,382.00	2020	2020-660000863	STROBLE, JOHN ANTHONY &	11	130,555	1000	13,072	1,388.00	2019	2019-660000863	STROBLE, JOHN ANTHONY &	11	124,199	1000	12,662	1,327.00	2018	2018-660000863	STROBLE, JOHN ANTHONY &	11	130,190	1000	13,288	1,406.00	2017	2017-660000863	STROBLE, JOHN ANTHONY &	11	129,138	1000	12,872	1,331.00	2016	2016-660000863	STROBLE, JOHN ANTHONY &	11	125,824	1000	12,468	1,298.00	2015	2015-660000863	STROBLE, JOHN ANTHONY &	11	124,058	1000	12,076	1,268.00	2014	2014-660000863	STROBLE, JOHN ANTHONY &	11	126,201	1000	11,695	1,228.00	2013	2013-660000863	STROBLE, JOHN ANTHONY &	11	119,888	1000	11,325	1,170.00
Tax Year	Statement Number	Billed Owner	Tax Area	Total Value	Exemptions	Taxable Value	Billed Tax																																																																																																													
2025	2025-660000863	STROBLE, JOHN ANTHONY &	11	177,219	1000	13,302	1,375.00																																																																																																													
2024	2024-660000863	STROBLE, JOHN ANTHONY &	11	185,859	1000	12,886	1,338.00																																																																																																													
2023	2023-660000863	STROBLE, JOHN ANTHONY &	11	122,558	1000	12,481	1,322.00																																																																																																													
2022	2022-660000863	STROBLE, JOHN ANTHONY &	11	120,856	1000	12,294	1,310.00																																																																																																													
2021	2021-660000863	STROBLE, JOHN ANTHONY &	11	131,331	1000	13,446	1,382.00																																																																																																													
2020	2020-660000863	STROBLE, JOHN ANTHONY &	11	130,555	1000	13,072	1,388.00																																																																																																													
2019	2019-660000863	STROBLE, JOHN ANTHONY &	11	124,199	1000	12,662	1,327.00																																																																																																													
2018	2018-660000863	STROBLE, JOHN ANTHONY &	11	130,190	1000	13,288	1,406.00																																																																																																													
2017	2017-660000863	STROBLE, JOHN ANTHONY &	11	129,138	1000	12,872	1,331.00																																																																																																													
2016	2016-660000863	STROBLE, JOHN ANTHONY &	11	125,824	1000	12,468	1,298.00																																																																																																													
2015	2015-660000863	STROBLE, JOHN ANTHONY &	11	124,058	1000	12,076	1,268.00																																																																																																													
2014	2014-660000863	STROBLE, JOHN ANTHONY &	11	126,201	1000	11,695	1,228.00																																																																																																													
2013	2013-660000863	STROBLE, JOHN ANTHONY &	11	119,888	1000	11,325	1,170.00																																																																																																													



Rogers

Assessment Property Record Card for Tax Year 2026

Data provided by LISA DELOZIER County Assessor

Date 04/17/2026
 Time 15:27:13
 Page 2

Lot Data		Square-Foot - NBHD 1085 #1	
Lot Size			
Lot Count			
Units Buildable	1		
Non-Ag Acres	0.4635		
Topography			
Street Access			
Utilities			
Amenities	LAND QUALITY	0	0
Method	Square-Foot		
Base Lot Value	20,192.00 x 3.15 = 63,605		
Factor Value			
Adjustments	1.0000		
Lot Value	63,605		



\\tsclient\T\TOMMY DUNLAP\New folder (30)\IMG_0098.JPG 3/24/2022

Residential Data	
Type	1 Single Family Residence
Condition	3 - Average
Quality	2.5 - Fair
Architecture	
Style	100% One Story
Exterior Wall	75% Frame, Siding, Wood 25% Veneer, Stone
Base/Total Area	1,382 / 1,382
Style	100% One Story
HVAC	100% Warmed & Cooled Air
Roof Cover	1 Composition Shingle
Area on Slab	0
Fixture/RghIn	11 /
Bed/F/H Bath	3 / 2.0 /
Basement Area	
Garage Type	624 Attached Garage - Unfinished
Remodel	
Year/Eff Age	1982 / 33

GRM Approach

GRM Code	
Gross Rent	0.00
Indicated Value	

Multiple Regression

MRA Code	1 Test
Adusted R	0.8445
Indicated Value	169,197 122.43 Per SqFt

Direct Comparables

Selection Model	A Adam Test
Adjustment Model	1 2022 Residential
Comparables	
Indicated Value	

Value Reconciliation

Selected Approach	Cost Approach
Improvements	117,461
Lot Value	63,605
Indicated Value	181,066 131.02 Per SqFt
Agland Value	
Site Improvements	
Total Value	181,066 131.02 Total Value Per SqFt

Cost Approach		Manual : 01/2025	
Base Cost	101.45	Total Misc Impr	+ 5,946
Roofing Adj	+ 4.52	Garage Cost	+ 16,336
Subfloor Adj	+ 1.20	Total RCN	= 200,325
Heat/Cool Adj	+ 11.47	Depreciation (43%)	- 86,140
Plumbing Adj	+ 10.19	Lump Sums	+ 3,276
Basement Adj	+ 0.00	RCNLD	= 117,461
Adj Base Cost	= 128.83	Lot Value	+ 63,605
Total Area	x 1,382	Indicated Value	= 181,066
Adjusted Cost	= 178,043	Value Per SqFt	131.02

Miscellaneous Improvements

Code	Description	Sketch ID	Size	Year	Units	Unit Cost	Depr	Value
CPDT	CARPORT - DETACHED	2495	513		513	10.74		5,510
PRCH	SLAB PORCH - COVERED	2496	6x3		18	24.21		436
WODO	WOOD DECK - OPEN	2497	51x8		408	16.06	50%	3,276



Rogers

Assessment Property Record Card for Tax Year 2026

Data provided by LISA DELOZIER County Assessor

Date 04/17/2026
 Time 15:27:13
 Page 3

Sketch Image

660000863

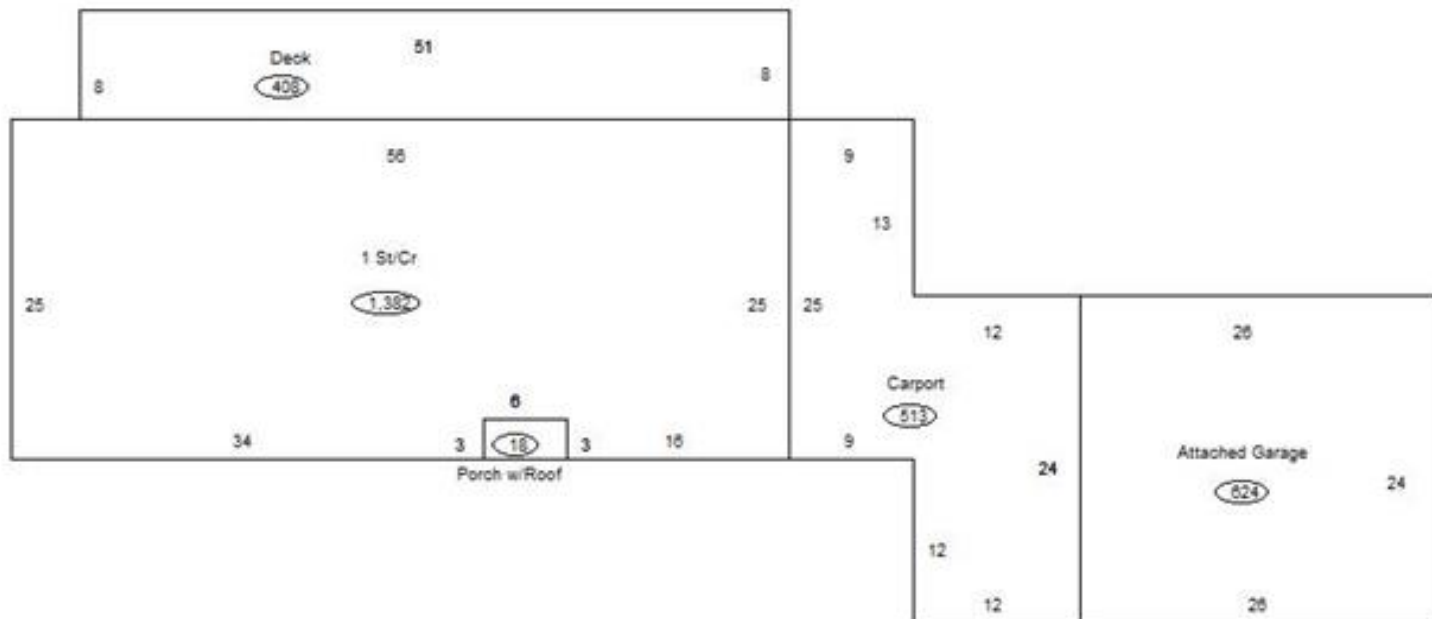

Sketch Vector Information

Sequence	Code	Type	Built Over	Scale	Section Label	Base Area	Multiplier	Total Area
1	R	1	Crawl	13	1 St/Cr	1,382	1.000	1,382
2	G	1		13	Attached Garage	624	1.000	624
3	M	CPDT		13	Carport	513	1.000	513
4	M	PRCH		13	SLBC	18	1.000	18
5	M	WODO		13	WODO	408	1.000	408
Total Building Area						1,382		1,382