



Rogers

Assessment Property Record Card for Tax Year 2026

Data provided by LISA DELOZIER County Assessor

Date 04/17/2026
Time 14:41:51
Page 1

Assessment Data					Primary Image																																																																																																																				
Account 660001356 Parcel ID 000000-00-0-00501-003-0004 Cadastral ID 02-20-16-03490 Property Type REAL - Real Property Property Class RRP VI Area 3 Tax Area 5 - JUSTUS RURAL/NO FIRE Name ID 295478 RUSH, GERALD 25095 S HACKAMORE RD CLAREMORE OK 74019-0000 Parcel Location Situs 25095 S HACKAMORE RD E Subdivision MEADOWRANCH III Lot/Block 0004 / 0003 Parcel Size 1 - Lots Sec/Twn/Rng 2 / 20 / 16 / 5 Neighborhood 1127 - R-V01,3,4-SE JUSTUS School District S009 - JUSTUS-TIAWAH SCHOOLS																																																																																																																									
D:\Appraisers\JAYSON\JAYSON RESIDENTIAL VI\2021-8-31\IMG 8/31/2021																																																																																																																									
Legal Description					Building Permits																																																																																																																				
Lat/Long: 36.24811247 -95.56965859 LOT 4 BLOCK 3 MEADOWRANCH 3					<table border="1"> <thead> <tr> <th>Number</th> <th>Description</th> <th>Opened</th> <th>Closed</th> <th>Amount</th> </tr> </thead> <tbody> <tr> <td>6674</td> <td>NEW HOME</td> <td>03/2001</td> <td>09/2001</td> <td>55,620</td> </tr> </tbody> </table>					Number	Description	Opened	Closed	Amount	6674	NEW HOME	03/2001	09/2001	55,620																																																																																																						
Number	Description	Opened	Closed	Amount																																																																																																																					
6674	NEW HOME	03/2001	09/2001	55,620																																																																																																																					
Exemptions					Sale History																																																																																																																				
<table border="1"> <thead> <tr> <th>Code</th> <th>Type</th> <th>Active</th> <th>Maximum</th> <th>Exemption</th> </tr> </thead> <tbody> <tr> <td>H</td> <td>Homestead</td> <td>Yes</td> <td>1,000</td> <td>1,000</td> </tr> </tbody> </table>					Code	Type	Active	Maximum	Exemption	H	Homestead	Yes	1,000	1,000	<table border="1"> <thead> <tr> <th>Bk/Pg</th> <th>Grantor</th> <th>Date</th> <th>Price</th> <th>Code</th> </tr> </thead> <tbody> <tr> <td>1882/286</td> <td>TMX-OK LLC</td> <td>07/06/2007</td> <td>112,000</td> <td>YES</td> </tr> <tr> <td>1433/119</td> <td>WRX JOINT VENTURE</td> <td>11/26/2002</td> <td>0</td> <td>16</td> </tr> <tr> <td>1433/110</td> <td>GILSON, WILLARD G &</td> <td>11/18/2002</td> <td>0</td> <td>16</td> </tr> <tr> <td>1415/426</td> <td>YORK, DICK CO-TRUSTEE &</td> <td>10/18/2002</td> <td>0</td> <td>11</td> </tr> <tr> <td>1277/805</td> <td>BASLER, J D & ASSOCIATES-INC</td> <td>03/26/2001</td> <td>0</td> <td>No</td> </tr> <tr> <td>1277/803</td> <td>YORK, DICK TRUSTEE OF LYLE-& LEI</td> <td>03/19/2001</td> <td>66,000</td> <td>No</td> </tr> </tbody> </table>					Bk/Pg	Grantor	Date	Price	Code	1882/286	TMX-OK LLC	07/06/2007	112,000	YES	1433/119	WRX JOINT VENTURE	11/26/2002	0	16	1433/110	GILSON, WILLARD G &	11/18/2002	0	16	1415/426	YORK, DICK CO-TRUSTEE &	10/18/2002	0	11	1277/805	BASLER, J D & ASSOCIATES-INC	03/26/2001	0	No	1277/803	YORK, DICK TRUSTEE OF LYLE-& LEI	03/19/2001	66,000	No																																																																			
Code	Type	Active	Maximum	Exemption																																																																																																																					
H	Homestead	Yes	1,000	1,000																																																																																																																					
Bk/Pg	Grantor	Date	Price	Code																																																																																																																					
1882/286	TMX-OK LLC	07/06/2007	112,000	YES																																																																																																																					
1433/119	WRX JOINT VENTURE	11/26/2002	0	16																																																																																																																					
1433/110	GILSON, WILLARD G &	11/18/2002	0	16																																																																																																																					
1415/426	YORK, DICK CO-TRUSTEE &	10/18/2002	0	11																																																																																																																					
1277/805	BASLER, J D & ASSOCIATES-INC	03/26/2001	0	No																																																																																																																					
1277/803	YORK, DICK TRUSTEE OF LYLE-& LEI	03/19/2001	66,000	No																																																																																																																					
Parcel Valuation																																																																																																																									
<table border="1"> <thead> <tr> <th>Source</th> <th>REAL</th> <th>Fair Cash</th> <th>Capped</th> <th>Asmnt Level</th> <th>Assessed</th> <th>Levy Rate</th> <th>83.050</th> <th>Current Tax</th> </tr> </thead> <tbody> <tr> <td>Remove Cap</td> <td>2008</td> <td>Land Value 76,030</td> <td>24,622</td> <td>11%</td> <td>2,708</td> <td>Assessed</td> <td>17,686</td> <td>1,468.82</td> </tr> <tr> <td>Year Frozen</td> <td>0</td> <td>Improvements 142,442</td> <td>136,165</td> <td></td> <td>14,978</td> <td>Penalty</td> <td>0</td> <td></td> </tr> <tr> <td>Uncapped Value</td> <td>0</td> <td>Mobile Home 0</td> <td>0</td> <td></td> <td>0</td> <td>Exemption</td> <td>1,000</td> <td>-83.00</td> </tr> <tr> <td>TIF Project ID</td> <td>0</td> <td>Total Value 218,472</td> <td>160,787</td> <td></td> <td>17,686</td> <td>Total Taxable</td> <td>16,686</td> <td>1,386.00</td> </tr> </tbody> </table>		Source	REAL	Fair Cash	Capped	Asmnt Level	Assessed	Levy Rate	83.050	Current Tax	Remove Cap	2008	Land Value 76,030	24,622	11%	2,708	Assessed	17,686	1,468.82	Year Frozen	0	Improvements 142,442	136,165		14,978	Penalty	0		Uncapped Value	0	Mobile Home 0	0		0	Exemption	1,000	-83.00	TIF Project ID	0	Total Value 218,472	160,787		17,686	Total Taxable	16,686	1,386.00																																																																											
Source	REAL	Fair Cash	Capped	Asmnt Level	Assessed	Levy Rate	83.050	Current Tax																																																																																																																	
Remove Cap	2008	Land Value 76,030	24,622	11%	2,708	Assessed	17,686	1,468.82																																																																																																																	
Year Frozen	0	Improvements 142,442	136,165		14,978	Penalty	0																																																																																																																		
Uncapped Value	0	Mobile Home 0	0		0	Exemption	1,000	-83.00																																																																																																																	
TIF Project ID	0	Total Value 218,472	160,787		17,686	Total Taxable	16,686	1,386.00																																																																																																																	
Assessment History																																																																																																																									
<table border="1"> <thead> <tr> <th>Tax Year</th> <th>Statement Number</th> <th>Billed Owner</th> <th>Tax Area</th> <th>Total Value</th> <th>Exemptions</th> <th>Taxable Value</th> <th>Billed Tax</th> </tr> </thead> <tbody> <tr><td>2025</td><td>2025-660001356</td><td>RUSH, GERALD</td><td>5</td><td>214,235</td><td>1000</td><td>16,172</td><td>1,343.00</td></tr> <tr><td>2024</td><td>2024-660001356</td><td>RUSH, GERALD</td><td>5</td><td>224,221</td><td>1000</td><td>15,671</td><td>1,308.00</td></tr> <tr><td>2023</td><td>2023-660001356</td><td>RUSH, GERALD</td><td>5</td><td>155,142</td><td>1000</td><td>15,186</td><td>1,265.00</td></tr> <tr><td>2022</td><td>2022-660001356</td><td>RUSH, GERALD</td><td>5</td><td>158,408</td><td>1000</td><td>14,714</td><td>1,224.00</td></tr> <tr><td>2021</td><td>2021-660001356</td><td>RUSH, GERALD</td><td>5</td><td>138,699</td><td>1000</td><td>14,257</td><td>1,209.00</td></tr> <tr><td>2020</td><td>2020-660001356</td><td>RUSH, GERALD</td><td>5</td><td>136,463</td><td>1000</td><td>13,832</td><td>1,171.00</td></tr> <tr><td>2019</td><td>2019-660001356</td><td>RUSH, GERALD</td><td>5</td><td>130,912</td><td>1000</td><td>13,400</td><td>1,160.00</td></tr> <tr><td>2018</td><td>2018-660001356</td><td>RUSH, GERALD</td><td>5</td><td>134,507</td><td>1000</td><td>13,796</td><td>1,196.00</td></tr> <tr><td>2017</td><td>2017-660001356</td><td>RUSH, GERALD</td><td>5</td><td>133,413</td><td>1000</td><td>13,624</td><td>1,111.00</td></tr> <tr><td>2016</td><td>2016-660001356</td><td>RUSH, GERALD</td><td>5</td><td>129,965</td><td>1000</td><td>13,198</td><td>1,126.00</td></tr> <tr><td>2015</td><td>2015-660001356</td><td>RUSH, GERALD</td><td>5</td><td>127,017</td><td>1000</td><td>12,785</td><td>1,080.00</td></tr> <tr><td>2014</td><td>2014-660001356</td><td>RUSH, GERALD</td><td>5</td><td>128,013</td><td>1000</td><td>12,383</td><td>1,063.00</td></tr> <tr><td>2013</td><td>2013-660001356</td><td>RUSH, GERALD</td><td>5</td><td>120,437</td><td>1000</td><td>11,994</td><td>1,045.00</td></tr> </tbody> </table>										Tax Year	Statement Number	Billed Owner	Tax Area	Total Value	Exemptions	Taxable Value	Billed Tax	2025	2025-660001356	RUSH, GERALD	5	214,235	1000	16,172	1,343.00	2024	2024-660001356	RUSH, GERALD	5	224,221	1000	15,671	1,308.00	2023	2023-660001356	RUSH, GERALD	5	155,142	1000	15,186	1,265.00	2022	2022-660001356	RUSH, GERALD	5	158,408	1000	14,714	1,224.00	2021	2021-660001356	RUSH, GERALD	5	138,699	1000	14,257	1,209.00	2020	2020-660001356	RUSH, GERALD	5	136,463	1000	13,832	1,171.00	2019	2019-660001356	RUSH, GERALD	5	130,912	1000	13,400	1,160.00	2018	2018-660001356	RUSH, GERALD	5	134,507	1000	13,796	1,196.00	2017	2017-660001356	RUSH, GERALD	5	133,413	1000	13,624	1,111.00	2016	2016-660001356	RUSH, GERALD	5	129,965	1000	13,198	1,126.00	2015	2015-660001356	RUSH, GERALD	5	127,017	1000	12,785	1,080.00	2014	2014-660001356	RUSH, GERALD	5	128,013	1000	12,383	1,063.00	2013	2013-660001356	RUSH, GERALD	5	120,437	1000	11,994	1,045.00
Tax Year	Statement Number	Billed Owner	Tax Area	Total Value	Exemptions	Taxable Value	Billed Tax																																																																																																																		
2025	2025-660001356	RUSH, GERALD	5	214,235	1000	16,172	1,343.00																																																																																																																		
2024	2024-660001356	RUSH, GERALD	5	224,221	1000	15,671	1,308.00																																																																																																																		
2023	2023-660001356	RUSH, GERALD	5	155,142	1000	15,186	1,265.00																																																																																																																		
2022	2022-660001356	RUSH, GERALD	5	158,408	1000	14,714	1,224.00																																																																																																																		
2021	2021-660001356	RUSH, GERALD	5	138,699	1000	14,257	1,209.00																																																																																																																		
2020	2020-660001356	RUSH, GERALD	5	136,463	1000	13,832	1,171.00																																																																																																																		
2019	2019-660001356	RUSH, GERALD	5	130,912	1000	13,400	1,160.00																																																																																																																		
2018	2018-660001356	RUSH, GERALD	5	134,507	1000	13,796	1,196.00																																																																																																																		
2017	2017-660001356	RUSH, GERALD	5	133,413	1000	13,624	1,111.00																																																																																																																		
2016	2016-660001356	RUSH, GERALD	5	129,965	1000	13,198	1,126.00																																																																																																																		
2015	2015-660001356	RUSH, GERALD	5	127,017	1000	12,785	1,080.00																																																																																																																		
2014	2014-660001356	RUSH, GERALD	5	128,013	1000	12,383	1,063.00																																																																																																																		
2013	2013-660001356	RUSH, GERALD	5	120,437	1000	11,994	1,045.00																																																																																																																		



Rogers

Assessment Property Record Card for Tax Year 2026

Data provided by LISA DELOZIER County Assessor

Date 04/17/2026
Time 14:41:51
Page 2

Lot Data	Square-Foot - NBHD 1127 #1	Primary Image
Lot Size		
Lot Count		
Units Buildable	1	
Non-Ag Acres	1.6699	
Topography		
Street Access		
Utilities		
Amenities	LAND QUALITY	
	0	
	0	
Method	Square-Foot	
Base Lot Value	72,739.00 x 1.05 = 76,030	
Factor Value		
Adjustments	1.0000	
Lot Value	76,030	

Residential Data	
Type	1 Single Family Residence
Condition	3 - Average
Quality	2.5 - Fair
Architecture	TRAD TRADITIONAL
Style	100% One Story
Exterior Wall	80% Frame, Siding, Vinyl 20% Veneer, Masonry
Base/Total Area	1,294 / 1,294
Style	100% One Story
HVAC	100% Warmed & Cooled Air
Roof Cover	1 Composition Shingle
Area on Slab	1,294
Fixture/RghIn	11 /
Bed/F/H Bath	3 / 2.0 /
Basement Area	
Garage Type	440 Attached Garage - Finished
Remodel	
Year/Eff Age	2001 / 19



D:\Appraisers\JAYSON\JAYSON RESIDENTIAL VI\2021-8-31\IMG 8/31/2021

GRM Approach	
GRM Code	
Gross Rent	0.00
Indicated Value	

Multiple Regression			
MRA Code	1	Test	
Adjusted R	0.8445		
Indicated Value	168,388	130.13	Per SqFt

Direct Comparables			
Selection Model	A	Adam Test	
Adjustment Model	1	2022 Residential	
Comparables	6		
Indicated Value	191,200		Per SqFt

Value Reconciliation			
Selected Approach	Cost Approach		
Improvements	142,442		
Lot Value	76,030		
Indicated Value	218,472	168.83	Per SqFt
Agland Value			
Site Improvements			
Total Value	218,472	168.83	Total Value Per SqFt

Cost Approach				Manual : 01/2025			
Base Cost	102.39	Total Misc Impr	+	1,802			
Roofing Adj	+ 4.66	Garage Cost	+	15,646			
Subfloor Adj	+ -1.21	Total RCN	=	183,326			
Heat/Cool Adj	+ 11.47	Depreciation (24%)	-	43,998			
Plumbing Adj	+ 10.88	Lump Sums	+	3,114			
Basement Adj	+ 0.00	RCNLD	=	142,442			
Adj Base Cost	= 128.19	Lot Value	+	76,030			
Total Area	x 1,294	Indicated Value	=	218,472			
Adjusted Cost	= 165,878	Value Per SqFt		168.83			

Miscellaneous Improvements								
Code	Description	Sketch ID	Size	Year	Units	Unit Cost	Depr	Value
WODO	WOOD DECK - OPEN	3680	19x12		228	19.51	30%	3,114
PRCH	SLAB PORCH - COVERED	3681	15x5		75	24.03		1,802



Rogers

Assessment Property Record Card for Tax Year 2026

Data provided by LISA DELOZIER County Assessor

Date 04/17/2026
 Time 14:41:51
 Page 3

Sketch Image

660001356

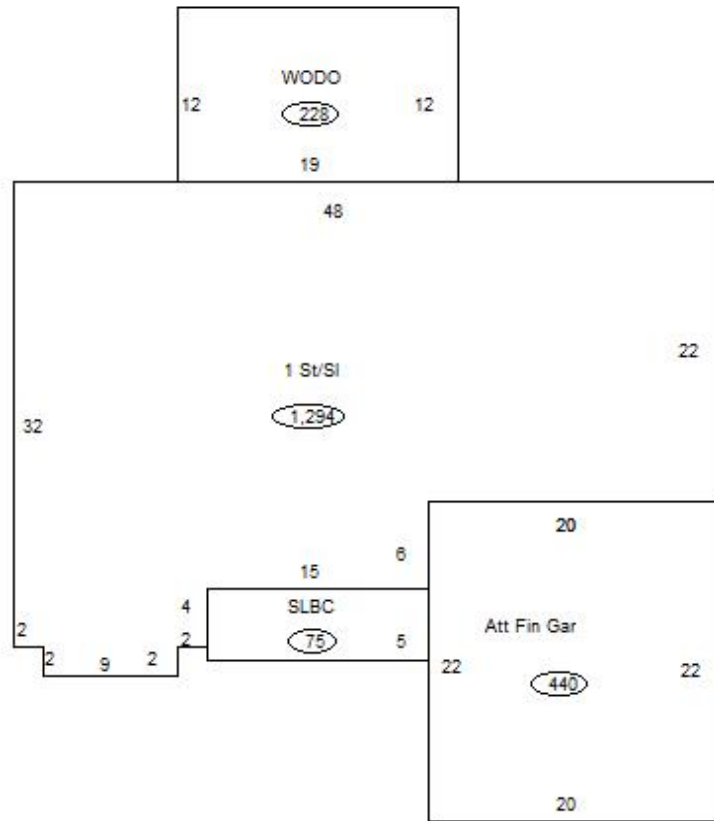

Sketch Vector Information

Sequence	Code	Type	Built Over	Scale	Section Label	Base Area	Multiplier	Total Area
1	R	1	Slab	13	1 St/SI	1,294	1.000	1,294
2	G	5		13	Att Fin Gar	440	1.000	440
3	M	WODO		13	WODO	228	1.000	228
4	M	PRCH		13	SLBC	75	1.000	75
Total Building Area						1,294		1,294