



Rogers

Assessment Property Record Card for Tax Year 2026

Data provided by LISA DELOZIER County Assessor

Date 04/17/2026
 Time 02:06:04
 Page 1

Assessment Data					Primary Image																																																	
Account 660001397 Parcel ID 000000-00-0-00366-001-0005 Cadastral ID 02-21-14-02350 Property Type REAL - Real Property Property Class RRP VI Area 4 Tax Area 7 - OWASSO/LIMESTONE FIRE Name ID 266701 MEARS, RICK 17219 E 120TH ST N COLLINSVILLE OK 74021-0000 Parcel Location Situs 17219 E 120TH ST N Subdivision HENRI-EDDA Lot/Block 0005 / 0001 Parcel Size 1 - Lots Sec/Twn/Rng 2 / 21 / 14 / 5 Neighborhood 1082 - R-V04-SW OWASSO School District S021 - OWASSO SCHOOLS					<p>\\tsclient\T\LOGAN\LOGAN RESIDENTIAL VI\2022-5-10\IMG_002 5/13/2022</p>																																																	
Legal Description Lat/Long: 36.32874972 -95.78139684																																																						
LOT 5 BLOCK 1 HENRI-EDDA					Building Permits <table border="1"> <thead> <tr> <th>Number</th> <th>Description</th> <th>Opened</th> <th>Closed</th> <th>Amount</th> </tr> </thead> <tbody> <tr> <td> </td> <td> </td> <td> </td> <td> </td> <td> </td> </tr> </tbody> </table>					Number	Description	Opened	Closed	Amount																																								
Number	Description	Opened	Closed	Amount																																																		
Exemptions					Sale History																																																	
Code	Type	Active	Maximum	Exemption	Bk/Pg	Grantor	Date	Price	Code																																													
					1081/437	OGLE, ROBERTA M	09/12/1997	76,500	Yes																																													
					814/719			69,000	No																																													
					864/777			0	No																																													
Parcel Valuation					<table border="1"> <thead> <tr> <th>Source</th> <th>REAL</th> <th>Fair Cash</th> <th>Capped</th> <th>Asmnt Level</th> <th>Assessed</th> <th>Levy Rate</th> <th>108.538</th> <th>Current Tax</th> </tr> </thead> <tbody> <tr> <td>Remove Cap</td> <td>1999</td> <td>Land Value 116,613</td> <td>34,750</td> <td>11%</td> <td>3,823</td> <td>Assessed</td> <td>11,652</td> <td>1,264.68</td> </tr> <tr> <td>Year Frozen</td> <td>0</td> <td>Improvements 100,099</td> <td>71,172</td> <td> </td> <td>7,829</td> <td>Penalty</td> <td>0</td> <td> </td> </tr> <tr> <td>Uncapped Value</td> <td>0</td> <td>Mobile Home 0</td> <td>0</td> <td> </td> <td>0</td> <td>Exemption</td> <td>0</td> <td>0.00</td> </tr> <tr> <td>TIF Project ID</td> <td>0</td> <td>Total Value 216,712</td> <td>105,922</td> <td> </td> <td>11,652</td> <td>Total Taxable</td> <td>11,652</td> <td>1,265.00</td> </tr> </tbody> </table>					Source	REAL	Fair Cash	Capped	Asmnt Level	Assessed	Levy Rate	108.538	Current Tax	Remove Cap	1999	Land Value 116,613	34,750	11%	3,823	Assessed	11,652	1,264.68	Year Frozen	0	Improvements 100,099	71,172		7,829	Penalty	0		Uncapped Value	0	Mobile Home 0	0		0	Exemption	0	0.00	TIF Project ID	0	Total Value 216,712	105,922		11,652	Total Taxable	11,652	1,265.00
Source	REAL	Fair Cash	Capped	Asmnt Level	Assessed	Levy Rate	108.538	Current Tax																																														
Remove Cap	1999	Land Value 116,613	34,750	11%	3,823	Assessed	11,652	1,264.68																																														
Year Frozen	0	Improvements 100,099	71,172		7,829	Penalty	0																																															
Uncapped Value	0	Mobile Home 0	0		0	Exemption	0	0.00																																														
TIF Project ID	0	Total Value 216,712	105,922		11,652	Total Taxable	11,652	1,265.00																																														
Assessment History																																																						
Tax Year	Statement Number	Billed Owner	Tax Area	Total Value	Exemptions	Taxable Value	Billed Tax																																															
2025	2025-660001397	MEARS, RICK	7	213,470	0	11,096	1,204.00																																															
2024	2024-660001397	MEARS, RICK	7	210,325	0	10,568	1,166.00																																															
2023	2023-660001397	MEARS, RICK	7	91,501	0	10,065	1,087.00																																															
2022	2022-660001397	MEARS, RICK	7	93,000	0	10,230	1,148.00																																															
2021	2021-660001397	MEARS, RICK	7	93,582	0	10,294	1,143.00																																															
2020	2020-660001397	MEARS, RICK	7	94,709	0	10,418	1,155.00																																															
2019	2019-660001397	MEARS, RICK	7	94,244	0	10,367	1,150.00																																															
2018	2018-660001397	MEARS, RICK	7	99,494	0	10,944	1,175.00																																															
2017	2017-660001397	MEARS, RICK	7	98,810	0	10,869	1,177.00																																															
2016	2016-660001397	MEARS, RICK	7	96,730	0	10,640	1,154.00																																															
2015	2015-660001397	MEARS, RICK	7	94,280	0	10,371	1,131.00																																															
2014	2014-660001397	MEARS, RICK	7	96,997	0	10,670	1,173.00																																															
2013	2013-660001397	MEARS, RICK	7	94,264	0	10,369	1,119.00																																															



Rogers

Assessment Property Record Card for Tax Year 2026

Data provided by LISA DELOZIER County Assessor

Date 04/17/2026
Time 02:06:05
Page 2

Lot Data	Square-Foot - NBHD 1082 #1	Primary Image
Lot Size		
Lot Count		
Units Buildable	1	
Non-Ag Acres	2.2708	
Topography		
Street Access		
Utilities		
Amenities	LAND QUALITY	
	0	
	0	
Method	Square-Foot	
Base Lot Value	98,914.00 x 1.18 = 116,613	
Factor Value		
Adjustments	1.0000	
Lot Value	116,613	

\\tsclient\T\LOGAN\LOGAN RESIDENTIAL VI\2022-5-10\IMG_002 5/13/2022

Residential Data	
Type	1 Single Family Residence
Condition	3 - Average
Quality	2.5 - Fair
Architecture	
Style	100% One Story
Exterior Wall	100% Veneer, Masonry
Base/Total Area	1,296 / 1,296
Style	100% One Story
HVAC	100% Warmed & Cooled Air
Roof Cover	1 Composition Shingle
Area on Slab	1,296
Fixture/RghIn	8 /
Bed/F/H Bath	3 / 2.0 /
Basement Area	
Garage Type	484 Attached Garage - Unfinished
Remodel	
Year/Eff Age	1974 / 39

GRM Approach	
GRM Code	
Gross Rent	0.00
Indicated Value	

Multiple Regression			
MRA Code	1	Test	
Adusted R	0.8445		
Indicated Value	143,967	111.09	Per SqFt

Direct Comparables	
Selection Model	A Adam Test
Adjustment Model	1 2022 Residential
Comparables	
Indicated Value	

Cost Approach				Manual : 01/2025	
Base Cost	108.21	Total Misc Impr	+	9,168	
Roofing Adj	+ 4.56	Garage Cost	+	13,373	
Subfloor Adj	+ -1.16	Total RCN	=	192,498	
Heat/Cool Adj	+ 11.47	Depreciation (48%)	-	92,399	
Plumbing Adj	+ 8.06	Lump Sums	+	0	
Basement Adj	+ 0.00	RCNLD	=	100,099	
Adj Base Cost	= 131.14	Lot Value	+	116,613	
Total Area	x 1,296	Indicated Value	=	216,712	
Adjusted Cost	= 169,957	Value Per SqFt		167.22	

Value Reconciliation			
Selected Approach	Cost Approach		
Improvements	100,099		
Lot Value	116,613		
Indicated Value	216,712	167.22	Per SqFt
Agland Value			
Site Improvements			
Total Value	216,712	167.22	Total Value Per SqFt

Miscellaneous Improvements								
Code	Description	Sketch ID	Size	Year	Units	Unit Cost	Depr	Value
FPR1	FIREPLACE - RESIDENTIAL 1 STORY	0		1	1	5,095.98		5,096
PRCH	SLAB PORCH - COVERED	3828		7x3	21	24.20		508
PRCH	SLAB PORCH - COVERED	3829		15x10	150	23.76		3,564



Rogers
Assessment Property Record Card for Tax Year 2026

Data provided by LISA DELOZIER County Assessor

Date 04/17/2026
 Time 02:06:05
 Page 3

Sketch Image

660001397

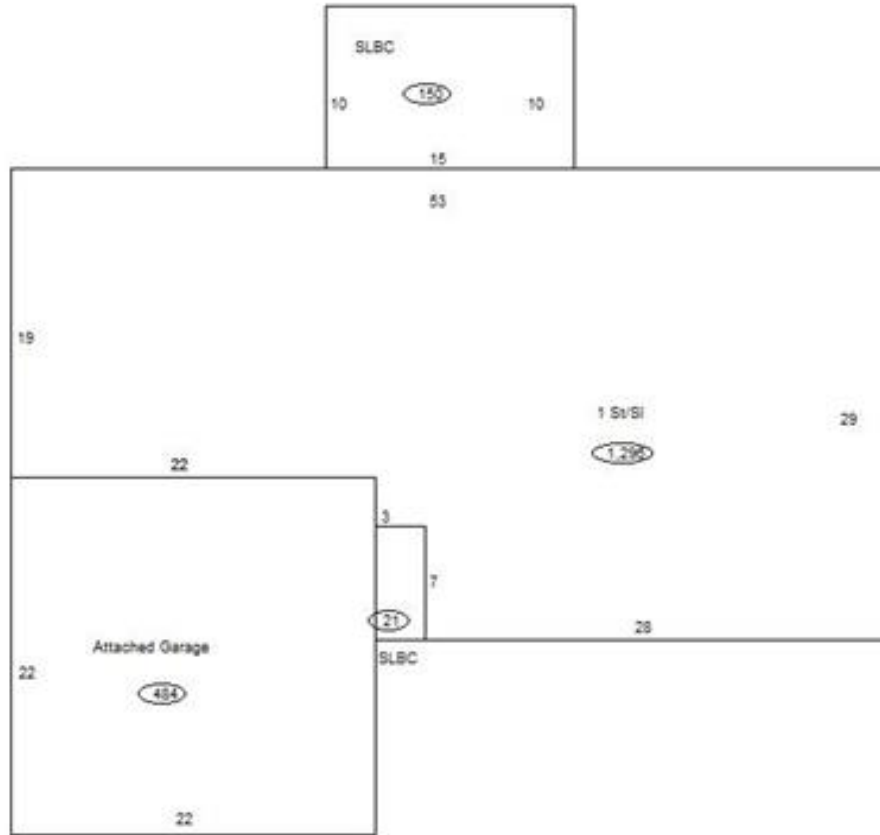

Sketch Vector Information

Sequence	Code	Type	Built Over	Scale	Section Label	Base Area	Multiplier	Total Area
1	R	1	Slab	10	1 St/SI	1,296	1.000	1,296
2	G	1		10	Attached Garage	484	1.000	484
3	M	PRCH		10	SLBC	21	1.000	21
4	M	PRCH		10	SLBC	150	1.000	150
Total Building Area						1,296		1,296



Rogers



Assessment Property Record Card for Tax Year 2026

Data provided by LISA DELOZIER County Assessor

Date 04/17/2026
Time 02:06:05
Page 4

660001397

Outbuildings/Site Improvements

Building Image	Code	Description	Dimensions	Floor	Roofing	Total Units
	STF	STG FAIR	0x0x0			
	Qual	Cond	Year	Eff Age		
	Valuation Summary		Modifier Total	RCN	Depr (100% Phys/ % Func)	RCNLD
	Base Cost (4.68 x)					
	STF	STG FAIR	0x0x0			
	Qual	Cond	Year	Eff Age		
	Valuation Summary		Modifier Total	RCN	Depr (100% Phys/ % Func)	RCNLD
	Base Cost (4.68 x)					