



# Rogers

## Assessment Property Record Card for Tax Year 2026

Data provided by LISA DELOZIER County Assessor

Date 04/18/2026  
Time 06:44:08  
Page 1

Assessment Data					Primary Image																																																																																																																				
<b>Account</b> 660001417 <b>Parcel ID</b> 000000-00-0-00366-003-0007 <b>Cadastral ID</b> 02-21-14-02550 <b>Property Type</b> REAL - Real Property <b>Property Class</b> RRP VI Area 4 <b>Tax Area</b> 7 - OWASSO/LIMESTONE FIRE <b>Name ID</b> 296016 LARSEN, KATHY A  11851 N 171ST E AVE COLLINSVILLE OK 74021-5139  <b>Parcel Location</b> <b>Situs</b> 11851 N 171ST E AVE <b>Subdivision</b> HENRI-EDDA <b>Lot/Block</b> 0007 / 0003 <b>Parcel Size</b> 1 - Lots <b>Sec/Twn/Rng</b> 2 / 21 / 14 / 5 <b>Neighborhood</b> 1082 - R-V04-SW OWASSO <b>School District</b> S021 - OWASSO SCHOOLS																																																																																																																									
<b>Legal Description</b> Lot/Long: 36.32513021 -95.78244307																																																																																																																									
<b>Building Permits</b>					<table border="1"> <thead> <tr> <th>Number</th> <th>Description</th> <th>Opened</th> <th>Closed</th> <th>Amount</th> </tr> </thead> <tbody> <tr> <td>R2014 06 28</td> <td>R15-NEW 13.6 X 15 204 SQ FT ROOM</td> <td>06/2014</td> <td>11/2014</td> <td>48,000</td> </tr> </tbody> </table>					Number	Description	Opened	Closed	Amount	R2014 06 28	R15-NEW 13.6 X 15 204 SQ FT ROOM	06/2014	11/2014	48,000																																																																																																						
Number	Description	Opened	Closed	Amount																																																																																																																					
R2014 06 28	R15-NEW 13.6 X 15 204 SQ FT ROOM	06/2014	11/2014	48,000																																																																																																																					
<b>Exemptions</b>					<b>Sale History</b>																																																																																																																				
<table border="1"> <thead> <tr> <th>Code</th> <th>Type</th> <th>Active</th> <th>Maximum</th> <th>Exemption</th> </tr> </thead> <tbody> <tr> <td>HVS</td> <td>Veteran</td> <td>Yes</td> <td>999,999</td> <td>27,310</td> </tr> </tbody> </table>					Code	Type	Active	Maximum	Exemption	HVS	Veteran	Yes	999,999	27,310	<table border="1"> <thead> <tr> <th>Bk/Pg</th> <th>Grantor</th> <th>Date</th> <th>Price</th> <th>Code</th> </tr> </thead> <tbody> <tr> <td>2605/550</td> <td>LARSEN, BERT L &amp;</td> <td>12/21/2016</td> <td>0</td> <td>4</td> </tr> <tr> <td>1861/710</td> <td>SWINGLE, LORI ANN</td> <td>03/29/2007</td> <td>34,000</td> <td>YES</td> </tr> <tr> <td>1762/461</td> <td>POL, ROSARIO</td> <td>03/21/2006</td> <td>57,500</td> <td>11</td> </tr> <tr> <td>823/398</td> <td></td> <td></td> <td>20,000</td> <td>No</td> </tr> </tbody> </table>					Bk/Pg	Grantor	Date	Price	Code	2605/550	LARSEN, BERT L &	12/21/2016	0	4	1861/710	SWINGLE, LORI ANN	03/29/2007	34,000	YES	1762/461	POL, ROSARIO	03/21/2006	57,500	11	823/398			20,000	No																																																																													
Code	Type	Active	Maximum	Exemption																																																																																																																					
HVS	Veteran	Yes	999,999	27,310																																																																																																																					
Bk/Pg	Grantor	Date	Price	Code																																																																																																																					
2605/550	LARSEN, BERT L &	12/21/2016	0	4																																																																																																																					
1861/710	SWINGLE, LORI ANN	03/29/2007	34,000	YES																																																																																																																					
1762/461	POL, ROSARIO	03/21/2006	57,500	11																																																																																																																					
823/398			20,000	No																																																																																																																					
<b>Parcel Valuation</b>																																																																																																																									
<table border="1"> <thead> <tr> <th>Source</th> <th>REAL</th> <th>Fair Cash</th> <th>Capped</th> <th>Asmnt Level</th> <th>Assessed</th> <th>Levy Rate</th> <th>108.538</th> <th>Current Tax</th> </tr> </thead> <tbody> <tr> <td>Remove Cap</td> <td>2008</td> <td>Land Value</td> <td>116,182</td> <td>39,954</td> <td>11%</td> <td>4,395</td> <td>Assessed</td> <td>27,310</td> <td>2,964.17</td> </tr> <tr> <td>Year Frozen</td> <td>0</td> <td>Improvements</td> <td>249,228</td> <td>208,318</td> <td></td> <td>22,915</td> <td>Penalty</td> <td>0</td> <td></td> </tr> <tr> <td>Uncapped Value</td> <td>0</td> <td>Mobile Home</td> <td>0</td> <td>0</td> <td></td> <td>0</td> <td>Exemption</td> <td>27,310</td> <td>-2,675.00</td> </tr> <tr> <td>TIF Project ID</td> <td>0</td> <td>Total Value</td> <td>365,410</td> <td>248,272</td> <td></td> <td>27,310</td> <td>Total Taxable</td> <td>0</td> <td>289.00</td> </tr> </tbody> </table>		Source	REAL	Fair Cash	Capped	Asmnt Level	Assessed	Levy Rate	108.538	Current Tax	Remove Cap	2008	Land Value	116,182	39,954	11%	4,395	Assessed	27,310	2,964.17	Year Frozen	0	Improvements	249,228	208,318		22,915	Penalty	0		Uncapped Value	0	Mobile Home	0	0		0	Exemption	27,310	-2,675.00	TIF Project ID	0	Total Value	365,410	248,272		27,310	Total Taxable	0	289.00																																																																							
Source	REAL	Fair Cash	Capped	Asmnt Level	Assessed	Levy Rate	108.538	Current Tax																																																																																																																	
Remove Cap	2008	Land Value	116,182	39,954	11%	4,395	Assessed	27,310	2,964.17																																																																																																																
Year Frozen	0	Improvements	249,228	208,318		22,915	Penalty	0																																																																																																																	
Uncapped Value	0	Mobile Home	0	0		0	Exemption	27,310	-2,675.00																																																																																																																
TIF Project ID	0	Total Value	365,410	248,272		27,310	Total Taxable	0	289.00																																																																																																																
<b>Assessment History</b>																																																																																																																									
<table border="1"> <thead> <tr> <th>Tax Year</th> <th>Statement Number</th> <th>Billed Owner</th> <th>Tax Area</th> <th>Total Value</th> <th>Exemptions</th> <th>Taxable Value</th> <th>Billed Tax</th> </tr> </thead> <tbody> <tr><td>2025</td><td>2025-660001417</td><td>LARSEN, KATHY A</td><td>7</td><td>355,604</td><td>26515</td><td></td><td>280.00</td></tr> <tr><td>2024</td><td>2024-660001417</td><td>LARSEN, KATHY A</td><td>7</td><td>361,349</td><td>25743</td><td></td><td>368.00</td></tr> <tr><td>2023</td><td>2023-660001417</td><td>LARSEN, KATHY A</td><td>7</td><td>248,206</td><td>24993</td><td></td><td>357.00</td></tr> <tr><td>2022</td><td>2022-660001417</td><td>LARSEN, KATHY A</td><td>7</td><td>250,740</td><td>24265</td><td></td><td>347.00</td></tr> <tr><td>2021</td><td>2021-660001417</td><td>LARSEN, KATHY A</td><td>7</td><td>214,164</td><td>23558</td><td></td><td>336.00</td></tr> <tr><td>2020</td><td>2020-660001417</td><td>LARSEN, KATHY A</td><td>7</td><td>212,659</td><td>22933</td><td></td><td>327.00</td></tr> <tr><td>2019</td><td>2019-660001417</td><td>LARSEN, KATHY A</td><td>7</td><td>202,414</td><td>22266</td><td></td><td>318.00</td></tr> <tr><td>2018</td><td>2018-660001417</td><td>LARSEN, KATHY A</td><td>7</td><td>207,297</td><td>22803</td><td></td><td>326.00</td></tr> <tr><td>2017</td><td>2017-660001417</td><td>LARSEN, KATHY A</td><td>7</td><td>205,620</td><td>22363</td><td></td><td>319.00</td></tr> <tr><td>2016</td><td>2016-660001417</td><td>LARSEN, BERT L &amp;</td><td>7</td><td>200,334</td><td>21711</td><td></td><td>310.00</td></tr> <tr><td>2015</td><td>2015-660001417</td><td>LARSEN, BERT L &amp;</td><td>7</td><td>196,176</td><td>21079</td><td></td><td>301.00</td></tr> <tr><td>2014</td><td>2014-660001417</td><td>LARSEN, BERT L &amp;</td><td>7</td><td>187,378</td><td>19361</td><td></td><td>276.00</td></tr> <tr><td>2013</td><td>2013-660001417</td><td>LARSEN, BERT L &amp;</td><td>7</td><td>176,475</td><td>18798</td><td></td><td>268.00</td></tr> </tbody> </table>										Tax Year	Statement Number	Billed Owner	Tax Area	Total Value	Exemptions	Taxable Value	Billed Tax	2025	2025-660001417	LARSEN, KATHY A	7	355,604	26515		280.00	2024	2024-660001417	LARSEN, KATHY A	7	361,349	25743		368.00	2023	2023-660001417	LARSEN, KATHY A	7	248,206	24993		357.00	2022	2022-660001417	LARSEN, KATHY A	7	250,740	24265		347.00	2021	2021-660001417	LARSEN, KATHY A	7	214,164	23558		336.00	2020	2020-660001417	LARSEN, KATHY A	7	212,659	22933		327.00	2019	2019-660001417	LARSEN, KATHY A	7	202,414	22266		318.00	2018	2018-660001417	LARSEN, KATHY A	7	207,297	22803		326.00	2017	2017-660001417	LARSEN, KATHY A	7	205,620	22363		319.00	2016	2016-660001417	LARSEN, BERT L &	7	200,334	21711		310.00	2015	2015-660001417	LARSEN, BERT L &	7	196,176	21079		301.00	2014	2014-660001417	LARSEN, BERT L &	7	187,378	19361		276.00	2013	2013-660001417	LARSEN, BERT L &	7	176,475	18798		268.00
Tax Year	Statement Number	Billed Owner	Tax Area	Total Value	Exemptions	Taxable Value	Billed Tax																																																																																																																		
2025	2025-660001417	LARSEN, KATHY A	7	355,604	26515		280.00																																																																																																																		
2024	2024-660001417	LARSEN, KATHY A	7	361,349	25743		368.00																																																																																																																		
2023	2023-660001417	LARSEN, KATHY A	7	248,206	24993		357.00																																																																																																																		
2022	2022-660001417	LARSEN, KATHY A	7	250,740	24265		347.00																																																																																																																		
2021	2021-660001417	LARSEN, KATHY A	7	214,164	23558		336.00																																																																																																																		
2020	2020-660001417	LARSEN, KATHY A	7	212,659	22933		327.00																																																																																																																		
2019	2019-660001417	LARSEN, KATHY A	7	202,414	22266		318.00																																																																																																																		
2018	2018-660001417	LARSEN, KATHY A	7	207,297	22803		326.00																																																																																																																		
2017	2017-660001417	LARSEN, KATHY A	7	205,620	22363		319.00																																																																																																																		
2016	2016-660001417	LARSEN, BERT L &	7	200,334	21711		310.00																																																																																																																		
2015	2015-660001417	LARSEN, BERT L &	7	196,176	21079		301.00																																																																																																																		
2014	2014-660001417	LARSEN, BERT L &	7	187,378	19361		276.00																																																																																																																		
2013	2013-660001417	LARSEN, BERT L &	7	176,475	18798		268.00																																																																																																																		



# Rogers

## Assessment Property Record Card for Tax Year 2026

Data provided by LISA DELOZIER County Assessor

Date 04/18/2026  
Time 06:44:09  
Page 2

Lot Data	Square-Foot - NBHD 1082 #1	Primary Image
Lot Size		
Lot Count		
Units Buildable	1	
Non-Ag Acres	2.1716	
Topography		
Street Access		
Utilities		
Amenities	LAND QUALITY	
	0	
	0	
Method	Square-Foot	
Base Lot Value	94,595.00 x 1.23 = 116,182	
Factor Value		
Adjustments	1.0000	
Lot Value	116,182	

Residential Data	
Type	1 Single Family Residence
Condition	3 - Average
Quality	3 - Average
Architecture	
Style	100% One Story
Exterior Wall	90% Frame, Siding, Wood 10% Veneer, Stone
Base/Total Area	2,084 / 2,084
Style	100% One Story
HVAC	100% Warmed & Cooled Air
Roof Cover	1 Composition Shingle
Area on Slab	2,084
Fixture/RghIn	11 /
Bed/F/H Bath	3 / 2.0 /
Basement Area	
Garage Type	440 Attached Garage - Unfinished
Remodel	
Year/Eff Age	2010 / 12



\\tsclient\T\LOGAN\LOGAN RESIDENTIAL VI\2022-5-10\IMG\_011' 5/13/2022

GRM Approach	
GRM Code	
Gross Rent	0.00
Indicated Value	

Multiple Regression			
MRA Code	1	Test	
Adusted R	0.8445		
Indicated Value	255,300	122.50	Per SqFt

Direct Comparables			
Selection Model	A	Adam Test	
Adjustment Model	1	2022 Residential	
Comparables	6		
Indicated Value	244,010		Per SqFt

Value Reconciliation			
Selected Approach	Cost Approach		
Improvements	249,228		
Lot Value	116,182		
Indicated Value	365,410	175.34	Per SqFt
Agland Value			
Site Improvements			
Total Value	365,410	175.34	Total Value Per SqFt

Cost Approach				Manual : 01/2025			
Base Cost	99.65	Total Misc Impr	+	14,072			
Roofing Adj	+ 4.65	Garage Cost	+	14,498			
Subfloor Adj	+ -2.19	Total RCN	=	283,214			
Heat/Cool Adj	+ 12.64	Depreciation ( 12%)	-	33,986			
Plumbing Adj	+ 7.44	Lump Sums	+	0			
Basement Adj	+ 0.00	RCNLD	=	249,228			
Adj Base Cost	= 122.19	Lot Value	+	116,182			
Total Area	x 2,084	Indicated Value	=	365,410			
Adjusted Cost	= 254,644	Value Per SqFt		175.34			

Miscellaneous Improvements								
Code	Description	Sketch ID	Size	Year	Units	Unit Cost	Depr	Value
FPR1	FIREPLACE - RESIDENTIAL 1 STORY	0		1	1	5,615.40		5,615
PATO	SLAB PORCH - OPEN	3899		286	286	9.10		2,603
PRCH	SLAB PORCH - COVERED	3901	29x7		203	26.29		5,337
PATO	SLAB PORCH - OPEN	121427	15x3		45	11.48		517



**Rogers**  
**Assessment Property Record Card for Tax Year 2026**

Data provided by LISA DELOZIER County Assessor

Date 04/18/2026  
 Time 06:44:09  
 Page 3

Sketch Image

660001417

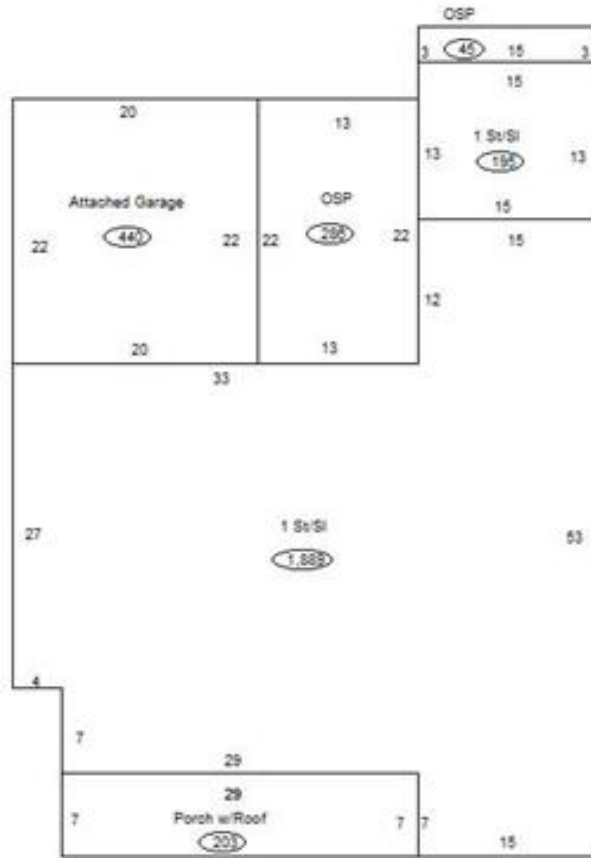

**Sketch Vector Information**

Sequence	Code	Type	Built Over	Scale	Section Label	Base Area	Multiplier	Total Area
1	R	1	Slab	13	1 St/Sl	1,889	1.000	1,889
2	M	PATO		13	Open Slab	286	1.000	286
3	G	1		13	Attached Garage	440	1.000	440
4	M	PRCH		13	SLBC	203	1.000	203
5	R	1	Slab	13	1 St/Sl	195	1.000	195
6	M	PATO		13	Open Slab	45	1.000	45
<b>Total Building Area</b>						<b>2,084</b>		<b>2,084</b>



# Rogers

## Assessment Property Record Card for Tax Year 2026

Data provided by LISA DELOZIER County Assessor

Date 04/18/2026  
Time 06:44:09  
Page 4

660001417

### Outbuildings/Site Improvements

Building Image	Code	Description	Dimensions	Floor	Roofing	Total Units
	STF	STG FAIR	0x0x0			
	Qual	Cond	Year	Eff Age		
Valuation Summary		Modifier Total	RCN	Depr (100% Phys/ % Func)	RCNLD	
Base Cost (4.68 x )						