



Rogers

Assessment Property Record Card for Tax Year 2026

Data provided by LISA DELOZIER County Assessor

Date 04/17/2026
Time 02:06:32
Page 1

| Assessment Data | | | | | Primary Image | | | | | | | | | | | | | | |
|--|-------------------------|---------------------------|-----------------------------|------------------|--|--------------------|----------------------|----------------------|--------------------|--------|-------------|--------|--------|--------|------|--|---------|---------|--|
| Account 660001425 Parcel ID 000000-00-0-00366-004-0004 Cadastral ID 02-21-14-02630 Property Type REAL - Real Property Property Class RRP VI Area 4 Tax Area 7 - OWASSO/LIMESTONE FIRE Name ID 327447 RAMIREZ-DIAZ, ELIZABETH & MIGUEL ANGEL DIAZ 5765 E HWY 20 CLAREMORE OK 74019-0000 Parcel Location Situs 11715 N 174TH E AVE Subdivision HENRI-EDDA Lot/Block 0004 / 0004 Parcel Size 1 - Lots Sec/Twn/Rng 2 / 21 / 14 / 5 Neighborhood 1082 - R-V04-SW OWASSO School District S021 - OWASSO SCHOOLS | | | | | <p>\\tsclient\C\TOMS PC PICS\2018-02-12 02-12-2018\02-12-2018 05 2/12/2018</p> | | | | | | | | | | | | | | |
| Legal Description Lot/Long: 36.32327309 -95.77907688 | | | | | | | | | | | | | | | | | | | |
| LOT 4 BLOCK 4 HENRI-EDDA | | | | | Building Permits <table border="1"> <thead> <tr> <th>Number</th> <th>Description</th> <th>Opened</th> <th>Closed</th> <th>Amount</th> </tr> </thead> <tbody> <tr> <td>5047</td> <td></td> <td>01/1998</td> <td>01/2000</td> <td></td> </tr> </tbody> </table> | | | | | Number | Description | Opened | Closed | Amount | 5047 | | 01/1998 | 01/2000 | |
| Number | Description | Opened | Closed | Amount | | | | | | | | | | | | | | | |
| 5047 | | 01/1998 | 01/2000 | | | | | | | | | | | | | | | | |
| Exemptions | | | | | Sale History | | | | | | | | | | | | | | |
| Code | Type | Active | Maximum | Exemption | Bk/Pg | Grantor | Date | Price | Code | | | | | | | | | | |
| H | Homestead | Yes | 1,000 | 1,000 | / | WOOD, PATSY R | 04/22/2019 | 130,000 | YES | | | | | | | | | | |
| H | Homestead | No | 1,000 | | | | | | | | | | | | | | | | |
| Parcel Valuation | | | | | | | | | | | | | | | | | | | |
| Source | REAL | | Fair Cash | Capped | Asmnt Level | Assessed | Levy Rate | 108.538 | Current Tax | | | | | | | | | | |
| Remove Cap | 2020 | | Land Value 116,783 | 33,608 | 11% | 3,697 | Assessed | 15,912 | 1,727.06 | | | | | | | | | | |
| Year Frozen | 0 | | Improvements 126,333 | 111,048 | | 12,215 | Penalty | 0 | | | | | | | | | | | |
| Uncapped Value | 0 | | Mobile Home 0 | 0 | | 0 | Exemption | 1,000 | -97.00 | | | | | | | | | | |
| TIF Project ID | 0 | | Total Value 243,116 | 144,656 | | 15,912 | Total Taxable | 14,912 | 1,630.00 | | | | | | | | | | |
| Assessment History | | | | | | | | | | | | | | | | | | | |
| Tax Year | Statement Number | Billed Owner | | | Tax Area | Total Value | Exemptions | Taxable Value | Billed Tax | | | | | | | | | | |
| 2025 | 2025-660001425 | RAMIREZ-DIAZ, ELIZABETH & | | | 7 | 233,426 | 1000 | 14,449 | 1,578.00 | | | | | | | | | | |
| 2024 | 2024-660001425 | RAMIREZ-DIAZ, ELIZABETH & | | | 7 | 230,729 | 1000 | 13,999 | 1,559.00 | | | | | | | | | | |
| 2023 | 2023-660001425 | RAMIREZ-DIAZ, ELIZABETH & | | | 7 | 132,382 | 1000 | 13,562 | 1,479.00 | | | | | | | | | | |
| 2022 | 2022-660001425 | RAMIREZ-DIAZ, ELIZABETH & | | | 7 | 130,464 | 1000 | 13,351 | 1,513.00 | | | | | | | | | | |
| 2021 | 2021-660001425 | RAMIREZ-DIAZ, ELIZABETH & | | | 7 | 128,918 | 1000 | 13,181 | 1,478.00 | | | | | | | | | | |
| 2020 | 2020-660001425 | RAMIREZ-DIAZ, ELIZABETH & | | | 7 | 129,768 | 1000 | 13,274 | 1,486.00 | | | | | | | | | | |
| 2019 | 2019-660001425 | RAMIREZ-DIAZ, ELIZABETH & | | | 7 | 137,931 | 1000 | 12,208 | 1,369.00 | | | | | | | | | | |
| 2018 | 2018-660001425 | WOOD, PATSY R | | | 7 | 142,227 | 1000 | 11,823 | 1,283.00 | | | | | | | | | | |
| 2017 | 2017-660001425 | WOOD, PATSY R | | | 7 | 141,157 | 1000 | 11,450 | 1,255.00 | | | | | | | | | | |
| 2016 | 2016-660001425 | WOOD, PATSY R | | | 7 | 138,041 | 1000 | 11,088 | 1,217.00 | | | | | | | | | | |
| 2015 | 2015-660001425 | WOOD, PATSY R | | | 7 | 134,186 | 1000 | 10,736 | 1,186.00 | | | | | | | | | | |
| 2014 | 2014-660001425 | WOOD, PATSY R | | | 7 | 142,744 | 1000 | 10,394 | 1,158.00 | | | | | | | | | | |
| 2013 | 2013-660001425 | WOOD, PATSY R | | | 7 | 136,042 | 1000 | 10,062 | 1,101.00 | | | | | | | | | | |



Rogers

Assessment Property Record Card for Tax Year 2026

Data provided by LISA DELOZIER County Assessor

Date 04/17/2026
 Time 02:06:32
 Page 2

| Lot Data | Square-Foot - NBHD 1082 #1 | Primary Image |
|--|----------------------------|---------------|
| Lot Size Lot Count Units Buildable 1 Non-Ag Acres 2.3096 Topography Street Access Utilities Amenities LAND QUALITY 0 0 Method Square-Foot Base Lot Value 100,606.00 x 1.16 = 116,783 Factor Value Adjustments 1.0000 Lot Value 116,783 | | |

| Residential Data | |
|------------------------|----------------------------------|
| Type | 1 Single Family Residence |
| Condition | 3 - Average |
| Quality | 2.5 - Fair |
| Architecture | |
| Style | 100% One Story |
| Exterior Wall | 100% Veneer, Masonry |
| Base/Total Area | 1,384 / 1,384 |
| Style | 100% One Story |
| HVAC | 100% Warmed & Cooled Air |
| Roof Cover | 1 Composition Shingle |
| Area on Slab | 1,384 |
| Fixture/RghIn | 8 / |
| Bed/F/H Bath | 3 / 2.0 / |
| Basement Area | |
| Garage Type | 440 Attached Garage - Unfinished |
| Remodel | |
| Year/Eff Age | 1974 / 39 |



\\tsclient\C\TOMS PC PICS\2018-02-12 02-12-2018\02-12-2018 05 2/12/2018

| GRM Approach | |
|------------------------|------|
| GRM Code | |
| Gross Rent | 0.00 |
| Indicated Value | |

| Multiple Regression | | | |
|------------------------|---------|--------|----------|
| MRA Code | 1 | Test | |
| Adusted R | 0.8445 | | |
| Indicated Value | 168,194 | 121.53 | Per SqFt |

| Direct Comparables | | | |
|-------------------------|---------|------------------|----------|
| Selection Model | A | Adam Test | |
| Adjustment Model | 1 | 2022 Residential | |
| Comparables | 2 | | |
| Indicated Value | 256,180 | | Per SqFt |

| Cost Approach | | | | Manual : 01/2025 | | | |
|----------------------|-----------|----------------------------|-----------|------------------|--|--|--|
| Base Cost | 106.50 | Total Misc Impr | + 8,402 | | | | |
| Roofing Adj | + 4.52 | Garage Cost | + 12,487 | | | | |
| Subfloor Adj | + -1.21 | Total RCN | = 199,176 | | | | |
| Heat/Cool Adj | + 11.47 | Depreciation (48%) | - 95,604 | | | | |
| Plumbing Adj | + 7.54 | Lump Sums | + 0 | | | | |
| Basement Adj | + 0.00 | RCNLD | = 103,572 | | | | |
| Adj Base Cost | = 128.82 | Lot Value | + 116,783 | | | | |
| Total Area | x 1,384 | Indicated Value | = 220,355 | | | | |
| Adjusted Cost | = 178,287 | Value Per SqFt | 159.22 | | | | |

| Value Reconciliation | | | |
|--------------------------|---------------|--------|----------------------|
| Selected Approach | Cost Approach | | |
| Improvements | 103,572 | | |
| Lot Value | 116,783 | | |
| Indicated Value | 220,355 | 159.22 | Per SqFt |
| Agland Value | | | |
| Site Improvements | 22,761 | | |
| Total Value | 243,116 | 175.66 | Total Value Per SqFt |

| Miscellaneous Improvements | | | | | | | | |
|----------------------------|---------------------------------|-----------|-------|------|-------|-----------|------|-------|
| Code | Description | Sketch ID | Size | Year | Units | Unit Cost | Depr | Value |
| FPR1 | FIREPLACE - RESIDENTIAL 1 STORY | 0 | | 1 | 1 | 5,095.98 | | 5,096 |
| PRCH | SLAB PORCH - COVERED | 3924 | | 44 | 44 | 24.13 | | 1,062 |
| PATO | SLAB PORCH - OPEN | 3925 | 20x12 | | 240 | 9.35 | | 2,244 |



Rogers

Assessment Property Record Card for Tax Year 2026

Data provided by LISA DELOZIER County Assessor

Date 04/17/2026
 Time 02:06:33
 Page 3

Sketch Image

660001425

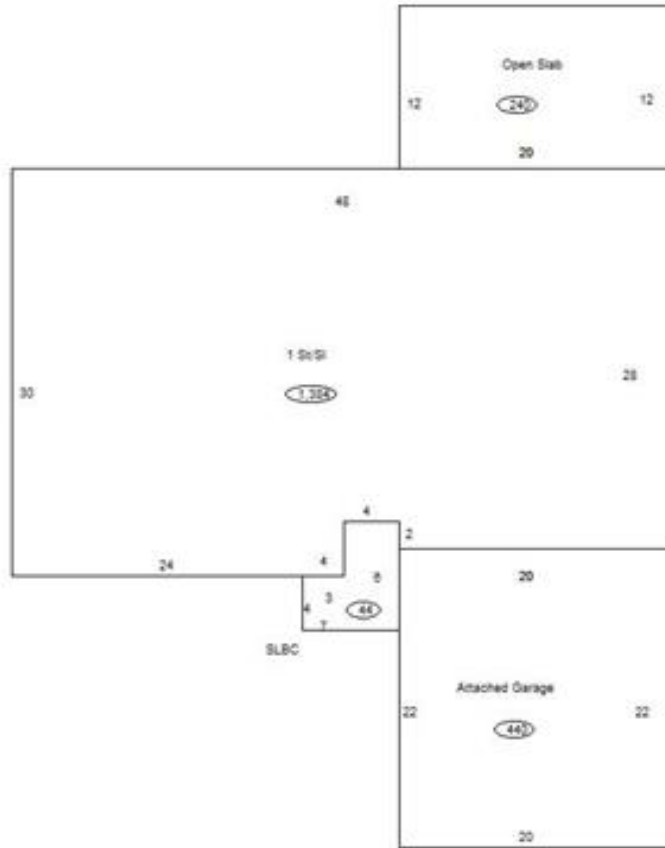

Sketch Vector Information

| Sequence | Code | Type | Built Over | Scale | Section Label | Base Area | Multiplier | Total Area |
|----------------------------|------|------|------------|-------|-----------------|--------------|------------|--------------|
| 1 | R | 1 | Slab | 10 | 1 St/Sl | 1,384 | 1.000 | 1,384 |
| 2 | G | 1 | | 10 | Attached Garage | 440 | 1.000 | 440 |
| 3 | M | PRCH | | 10 | SLBC | 44 | 1.000 | 44 |
| 4 | M | PATO | | 10 | Open Slab | 240 | 1.000 | 240 |
| Total Building Area | | | | | | 1,384 | | 1,384 |



Rogers



Assessment Property Record Card for Tax Year 2026

Data provided by LISA DELOZIER County Assessor

Date 04/17/2026
 Time 02:06:33
 Page 4

660001425

Outbuildings/Site Improvements

| Building Image | Code | Description | Dimensions | Floor | Roofing | Total Units |
|--|--|---------------|-----------------------|-------------------|---------------------------------------|---------------------|
|  | LT | LEAN-TO | 0x0x0 | | | 560 |
| | Qual | 3 | Cond 3 | Year | Eff Age | |
| | Valuation Summary Base Cost (2.92 x 560) 1,635 | | Modifier Total | RCN 1,635 | Depr (40% Phys/ % Func) 654 | RCNLD 981 |
|  | UTIL | SHOP BUILDING | 0x0x0 | | | 1,200 |
| | Qual | 2 | Cond 3 | Year | Eff Age | |
| | Valuation Summary Base Cost (30.25 x 1,200) 36,300 | | Modifier Total | RCN 36,300 | Depr (40% Phys/ % Func) 14,520 | RCNLD 21,780 |