



Rogers

Assessment Property Record Card for Tax Year 2026

Data provided by LISA DELOZIER County Assessor

Date 04/18/2026
 Time 06:43:03
 Page 1

Assessment Data					Primary Image																																																	
Account 660001435 Parcel ID 000000-00-0-00366-006-0001 Cadastral ID 02-21-14-02720 Property Type REAL - Real Property Property Class RRP VI Area 4 Tax Area 7 - OWASSO/LIMESTONE FIRE Name ID 133684 CAMP, ROSE ANN TRUSTEE 11602 N 174TH E AVE COLLINSVILLE OK 74021-0000 Parcel Location Situs 11602 N 174TH E AVE Subdivision HENRI-EDDA Lot/Block 0001 / 0006 Parcel Size .86 - Lots Sec/Twn/Rng 2 / 21 / 14 / 5 Neighborhood 1082 - R-V04-SW OWASSO School District S021 - OWASSO SCHOOLS					<p>\\tsclient\T\LOGAN\LOGAN RESIDENTIAL VI\2022-5-11\IMG_007! 5/13/2022</p>																																																	
Legal Description Lat/Long: 36.32241843 -95.78027905																																																						
LOT 1 BLOCK 6 HENRI-EDDA AMD LESS S'ERLY STRIP DEEDED TO ODOT FOR HWY 20 DESC AS BEG SW/C THEREOF; TH N01-2926W 40 28'; TH N89-1503E 95.96'; TH N88-55-57E 209.05'; TH S01-2926E 39.69'; TH S88-5518W 305.01' TO POB.					Building Permits <table border="1"> <thead> <tr> <th>Number</th> <th>Description</th> <th>Opened</th> <th>Closed</th> <th>Amount</th> </tr> </thead> <tbody> <tr> <td> </td> <td> </td> <td> </td> <td> </td> <td> </td> </tr> </tbody> </table>					Number	Description	Opened	Closed	Amount																																								
Number	Description	Opened	Closed	Amount																																																		
Exemptions					Sale History																																																	
Code	Type	Active	Maximum	Exemption	Bk/Pg	Grantor	Date	Price	Code																																													
H	Homestead	Yes	1,000	1,000																																																		
Parcel Valuation					<table border="1"> <thead> <tr> <th>Source</th> <th>REAL</th> <th>Fair Cash</th> <th>Capped</th> <th>Asmnt Level</th> <th>Assessed</th> <th>Levy Rate</th> <th>108.538</th> <th>Current Tax</th> </tr> </thead> <tbody> <tr> <td>Remove Cap</td> <td>0</td> <td>Land Value 108,711</td> <td>27,709</td> <td>11%</td> <td>3,048</td> <td>Assessed</td> <td>31,959</td> <td>3,468.77</td> </tr> <tr> <td>Year Frozen</td> <td>0</td> <td>Improvements 292,069</td> <td>262,822</td> <td> </td> <td>28,911</td> <td>Penalty</td> <td>0</td> <td> </td> </tr> <tr> <td>Uncapped Value</td> <td>0</td> <td>Mobile Home 0</td> <td>0</td> <td> </td> <td>0</td> <td>Exemption</td> <td>1,000</td> <td>-98.00</td> </tr> <tr> <td>TIF Project ID</td> <td>0</td> <td>Total Value 400,780</td> <td>290,531</td> <td> </td> <td>31,959</td> <td>Total Taxable</td> <td>30,959</td> <td>3,371.00</td> </tr> </tbody> </table>					Source	REAL	Fair Cash	Capped	Asmnt Level	Assessed	Levy Rate	108.538	Current Tax	Remove Cap	0	Land Value 108,711	27,709	11%	3,048	Assessed	31,959	3,468.77	Year Frozen	0	Improvements 292,069	262,822		28,911	Penalty	0		Uncapped Value	0	Mobile Home 0	0		0	Exemption	1,000	-98.00	TIF Project ID	0	Total Value 400,780	290,531		31,959	Total Taxable	30,959	3,371.00
Source	REAL	Fair Cash	Capped	Asmnt Level	Assessed	Levy Rate	108.538	Current Tax																																														
Remove Cap	0	Land Value 108,711	27,709	11%	3,048	Assessed	31,959	3,468.77																																														
Year Frozen	0	Improvements 292,069	262,822		28,911	Penalty	0																																															
Uncapped Value	0	Mobile Home 0	0		0	Exemption	1,000	-98.00																																														
TIF Project ID	0	Total Value 400,780	290,531		31,959	Total Taxable	30,959	3,371.00																																														
Assessment History																																																						
Tax Year	Statement Number	Billed Owner	Tax Area	Total Value	Exemptions	Taxable Value	Billed Tax																																															
2025	2025-660001435	CAMP, ROSE ANN	7	391,620	1000	30,028	3,270.00																																															
2024	2024-660001435	CAMP, ROSE ANN	7	401,305	1000	29,124	3,228.00																																															
2023	2023-660001435	CAMP, ROSE ANN	7	310,492	1000	28,246	3,065.00																																															
2022	2022-660001435	CAMP, ROSE ANN	7	313,742	1000	27,395	3,089.00																																															
2021	2021-660001435	CAMP, ROSE ANN	7	338,854	1000	26,568	2,964.00																																															
2020	2020-660001435	CAMP, ROSE ANN	7	340,281	1000	25,765	2,871.00																																															
2019	2019-660001435	CAMP, ROSE ANN	7	322,238	1000	24,986	2,786.00																																															
2018	2018-660001435	CAMP, ROSE ANN	7	332,947	1000	24,228	2,615.00																																															
2017	2017-660001435	CAMP, ROSE ANN	7	329,708	1000	23,494	2,560.00																																															
2016	2016-660001435	CAMP, ROSE ANN	7	328,835	1000	22,780	2,485.00																																															
2015	2015-660001435	CAMP, ROSE ANN	7	318,269	1000	22,088	2,425.00																																															
2014	2014-660001435	CAMP, ROSE ANN	7	311,925	1000	21,416	2,370.00																																															
2013	2013-660001435	CAMP, ROSE ANN	7	295,907	1000	20,762	2,256.00																																															



Rogers

Assessment Property Record Card for Tax Year 2026

Data provided by LISA DELOZIER County Assessor

Date 04/18/2026
Time 06:43:03
Page 2

Lot Data	Square-Foot - NBHD 1082 #1	Primary Image
Lot Size		
Lot Count		
Units Buildable	0.86	
Non-Ag Acres	1.6913	
Topography		
Street Access		
Utilities		
Amenities	LAND QUALITY	
	0	
	0	
Method	Square-Foot	
Base Lot Value	73,674.00 x 1.48 = 108,711	
Factor Value		
Adjustments	1.0000	
Lot Value	108,711	

Residential Data	
Type	1 Single Family Residence
Condition	3 - Average
Quality	3.5 - Average
Architecture	
Style	100% 1 1/2 Story Finished
Exterior Wall	100% Veneer, Masonry
Base/Total Area	2,460 / 4,060
Style	100% 1 1/2 Story Finished
HVAC	100% Warmed & Cooled Air
Roof Cover	1 Composition Shingle
Area on Slab	2,460
Fixture/RghIn	16 /
Bed/F/H Bath	3 / 3.5 /
Basement Area	
Garage Type	528 Attached Garage - Unfinished
Remodel	
Year/Eff Age	1977 / 37

\\tsclient\T\LOGAN\LOGAN RESIDENTIAL VI\2022-5-11\IMG_007! 5/13/2022

GRM Approach	
GRM Code	
Gross Rent	0.00
Indicated Value	

Multiple Regression			
MRA Code	1	Test	
Adusted R	0.8445		
Indicated Value	429,805	105.86	Per SqFt

Direct Comparables			
Selection Model	A	Adam Test	
Adjustment Model	1	2022 Residential	
Comparables	6		
Indicated Value	463,810		Per SqFt

Cost Approach				Manual : 01/2025			
Base Cost	93.89	Total Misc Impr	+	13,146			
Roofing Adj	+ 3.14	Garage Cost	+	20,766			
Subfloor Adj	+ -2.05	Total RCN	=	503,695			
Heat/Cool Adj	+ 14.47	Depreciation (44%)	-	221,626			
Plumbing Adj	+ 6.26	Lump Sums	+	0			
Basement Adj	+ 0.00	RCNLD	=	282,069			
Adj Base Cost	= 115.71	Lot Value	+	108,711			
Total Area	x 4,060	Indicated Value	=	390,780			
Adjusted Cost	= 469,783	Value Per SqFt		96.25			

Value Reconciliation			
Selected Approach	Cost Approach		
Improvements	282,069		
Lot Value	108,711		
Indicated Value	390,780	96.25	Per SqFt
Agland Value			
Site Improvements	10,000		
Total Value	400,780	98.71	Total Value Per SqFt

Miscellaneous Improvements								
Code	Description	Sketch ID	Size	Year	Units	Unit Cost	Depr	Value
FPR1	FIREPLACE - RESIDENTIAL 1 STORY	0		1	1	6,429.63		6,430
PRCH	SLAB PORCH - COVERED	3968	41x4		164	28.95		4,748
PATO	SLAB PORCH - OPEN	3970	160		160	12.30		1,968



Rogers

Assessment Property Record Card for Tax Year 2026

Data provided by LISA DELOZIER County Assessor

Date 04/18/2026

Time 06:43:03

Page 3

Sketch Image

660001435

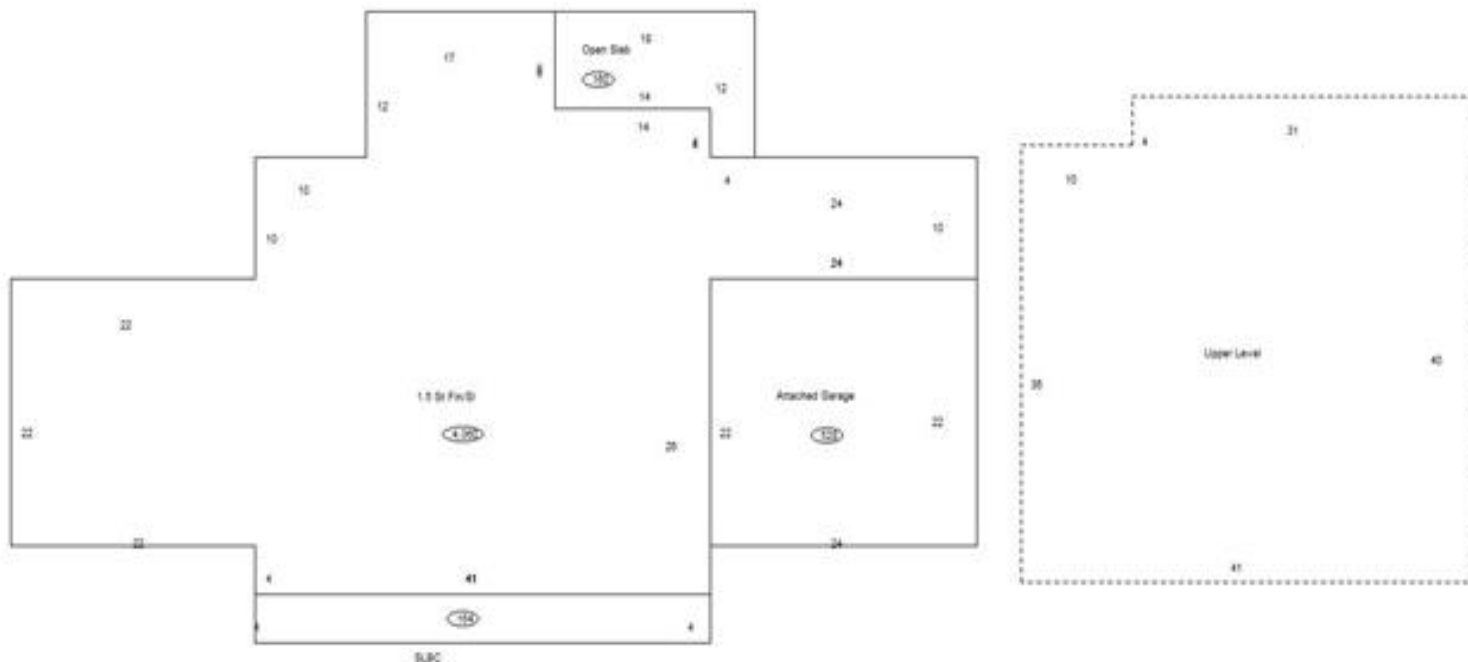

Sketch Vector Information

Sequence	Code	Type	Built Over	Scale	Section Label	Base Area	Multiplier	Total Area
1	R	5	Slab	10	1.5 St Fin/SI	2,460	1.650	4,060
2	G	1		10	Attached Garage	528	1.000	528
3	M	PRCH		10	SLBC	164	1.000	164
4	U	^UL		10	Upper Level	1,600	1.000	1,600
5	M	PATO		10	Open Slab	160	1.000	160
Total Building Area						2,460		4,060



Rogers

Assessment Property Record Card for Tax Year 2026

Data provided by LISA DELOZIER County Assessor

Date 04/18/2026
Time 06:43:03
Page 4

660001435

Outbuildings/Site Improvements

Building Image	Code	Description	Dimensions	Floor	Roofing	Total Units
	SV	SWIM VINYL	0x0x0			1
	Qual	Cond	Year	Eff Age		
		Valuation Summary	Modifier Total	RCN	Depr (60% Phys/ % Func)	RCNLD
		Base Cost (25,000.00 x 1)	25,000	25,000	15,000	10,000