



# Rogers

## Assessment Property Record Card for Tax Year 2026

Data provided by LISA DELOZIER County Assessor

Date 04/17/2026  
Time 02:10:52  
Page 1

Assessment Data					Primary Image																																																																																																																				
<b>Account</b> 660001489 <b>Parcel ID</b> 21N15E-02-4-00000-000-0000 <b>Cadastral ID</b> 02-21-15-01000 <b>Property Type</b> REAL - Real Property <b>Property Class</b> RA VI Area 4 <b>Tax Area</b> 8 - CLAREMORE/ NW FIRE <b>Name ID</b> 336489 LACKEY, SCOTT H II & LYNSE F  8505 E 480 RD CLAREMORE OK 74017-0000  <b>Parcel Location</b> <b>Situs</b> 08505 E 480 RD <b>Subdivision</b> <b>Lot/Block</b> / <b>Parcel Size</b> 1 - Acres <b>Sec/Twn/Rng</b> 2 / 21 / 15 / 4 <b>Neighborhood</b> 6080 - UNPLATTED <b>School District</b> S001 - CLAREMORE SCHOOLS																																																																																																																									
<b>Legal Description</b> Lat/Long: 36.32238318 -95.67546647																																																																																																																									
<b>Building Permits</b>					<table border="1"> <thead> <tr> <th>Number</th> <th>Description</th> <th>Opened</th> <th>Closed</th> <th>Amount</th> </tr> </thead> <tbody> <tr> <td colspan="5"> </td> </tr> </tbody> </table>					Number	Description	Opened	Closed	Amount																																																																																																											
Number	Description	Opened	Closed	Amount																																																																																																																					
<b>Exemptions</b>					<b>Sale History</b>																																																																																																																				
<table border="1"> <thead> <tr> <th>Code</th> <th>Type</th> <th>Active</th> <th>Maximum</th> <th>Exemption</th> </tr> </thead> <tbody> <tr> <td colspan="5"> </td> </tr> </tbody> </table>					Code	Type	Active	Maximum	Exemption						<table border="1"> <thead> <tr> <th>Bk/Pg</th> <th>Grantor</th> <th>Date</th> <th>Price</th> <th>Code</th> </tr> </thead> <tbody> <tr> <td>/</td> <td>LAGERS, MICHAEL G &amp;</td> <td>08/11/2021</td> <td>0</td> <td>4</td> </tr> <tr> <td>/</td> <td>LAGERS, BRENDA FAYE</td> <td>08/11/2021</td> <td>200,000</td> <td>4</td> </tr> <tr> <td>1464/755</td> <td>BAKER, JOHN A &amp; J FAYE</td> <td>04/07/2003</td> <td>90,000</td> <td></td> </tr> <tr> <td>1324/372</td> <td>MOODY, LARRY &amp; BRENDA</td> <td>10/12/2001</td> <td>587,500</td> <td>11</td> </tr> <tr> <td>964/628</td> <td>SELLER</td> <td>04/26/1994</td> <td>0</td> <td>No</td> </tr> </tbody> </table>					Bk/Pg	Grantor	Date	Price	Code	/	LAGERS, MICHAEL G &	08/11/2021	0	4	/	LAGERS, BRENDA FAYE	08/11/2021	200,000	4	1464/755	BAKER, JOHN A & J FAYE	04/07/2003	90,000		1324/372	MOODY, LARRY & BRENDA	10/12/2001	587,500	11	964/628	SELLER	04/26/1994	0	No																																																																								
Code	Type	Active	Maximum	Exemption																																																																																																																					
Bk/Pg	Grantor	Date	Price	Code																																																																																																																					
/	LAGERS, MICHAEL G &	08/11/2021	0	4																																																																																																																					
/	LAGERS, BRENDA FAYE	08/11/2021	200,000	4																																																																																																																					
1464/755	BAKER, JOHN A & J FAYE	04/07/2003	90,000																																																																																																																						
1324/372	MOODY, LARRY & BRENDA	10/12/2001	587,500	11																																																																																																																					
964/628	SELLER	04/26/1994	0	No																																																																																																																					
<b>Parcel Valuation</b>																																																																																																																									
<table border="1"> <thead> <tr> <th>Source</th> <th>REAL</th> <th>Fair Cash</th> <th>Capped</th> <th>Asmnt Level</th> <th>Assessed</th> <th>Levy Rate</th> <th>106.442</th> <th>Current Tax</th> </tr> </thead> <tbody> <tr> <td>Remove Cap</td> <td>2002</td> <td>Land Value 224</td> <td>224</td> <td>11%</td> <td>25</td> <td>Assessed</td> <td>12,159</td> <td>1,294.22</td> </tr> <tr> <td>Year Frozen</td> <td>0</td> <td>Improvements 186,289</td> <td>110,309</td> <td></td> <td>12,134</td> <td>Penalty</td> <td>0</td> <td></td> </tr> <tr> <td>Uncapped Value</td> <td>0</td> <td>Mobile Home 0</td> <td>0</td> <td></td> <td>0</td> <td>Exemption</td> <td>0</td> <td>0.00</td> </tr> <tr> <td>TIF Project ID</td> <td>0</td> <td>Total Value 186,513</td> <td>110,533</td> <td></td> <td>12,159</td> <td>Total Taxable</td> <td>12,159</td> <td>1,294.00</td> </tr> </tbody> </table>		Source	REAL	Fair Cash	Capped	Asmnt Level	Assessed	Levy Rate	106.442	Current Tax	Remove Cap	2002	Land Value 224	224	11%	25	Assessed	12,159	1,294.22	Year Frozen	0	Improvements 186,289	110,309		12,134	Penalty	0		Uncapped Value	0	Mobile Home 0	0		0	Exemption	0	0.00	TIF Project ID	0	Total Value 186,513	110,533		12,159	Total Taxable	12,159	1,294.00																																																																											
Source	REAL	Fair Cash	Capped	Asmnt Level	Assessed	Levy Rate	106.442	Current Tax																																																																																																																	
Remove Cap	2002	Land Value 224	224	11%	25	Assessed	12,159	1,294.22																																																																																																																	
Year Frozen	0	Improvements 186,289	110,309		12,134	Penalty	0																																																																																																																		
Uncapped Value	0	Mobile Home 0	0		0	Exemption	0	0.00																																																																																																																	
TIF Project ID	0	Total Value 186,513	110,533		12,159	Total Taxable	12,159	1,294.00																																																																																																																	
<b>Assessment History</b>																																																																																																																									
<table border="1"> <thead> <tr> <th>Tax Year</th> <th>Statement Number</th> <th>Billed Owner</th> <th>Tax Area</th> <th>Total Value</th> <th>Exemptions</th> <th>Taxable Value</th> <th>Billed Tax</th> </tr> </thead> <tbody> <tr><td>2025</td><td>2025-660001489</td><td>LACKEY, SCOTT H II &amp;</td><td>8</td><td>183,920</td><td>0</td><td>11,805</td><td>1,256.00</td></tr> <tr><td>2024</td><td>2024-660001489</td><td>LACKEY, SCOTT H II &amp;</td><td>8</td><td>175,432</td><td>0</td><td>11,461</td><td>1,220.00</td></tr> <tr><td>2023</td><td>2023-660001489</td><td>LACKEY, SCOTT H II &amp;</td><td>8</td><td>162,405</td><td>0</td><td>11,127</td><td>1,175.00</td></tr> <tr><td>2022</td><td>2022-660001489</td><td>LACKEY, SCOTT H II &amp;</td><td>8</td><td>161,807</td><td>0</td><td>10,803</td><td>1,148.00</td></tr> <tr><td>2021</td><td>2021-660001489</td><td>LAGERS, BRENDA FAYE</td><td>8</td><td>168,322</td><td>0</td><td>10,489</td><td>1,069.00</td></tr> <tr><td>2020</td><td>2020-660001489</td><td>LAGERS, MICHAEL G &amp;</td><td>8</td><td>165,163</td><td>0</td><td>10,183</td><td>1,075.00</td></tr> <tr><td>2019</td><td>2019-660001489</td><td>LAGERS, MICHAEL G &amp;</td><td>8</td><td>161,072</td><td>0</td><td>9,887</td><td>1,056.00</td></tr> <tr><td>2018</td><td>2018-660001489</td><td>LAGERS, MICHAEL G &amp;</td><td>8</td><td>171,738</td><td>0</td><td>9,599</td><td>1,023.00</td></tr> <tr><td>2017</td><td>2017-660001489</td><td>LAGERS, MICHAEL G &amp;</td><td>8</td><td>170,051</td><td>0</td><td>9,319</td><td>977.00</td></tr> <tr><td>2016</td><td>2016-660001489</td><td>LAGERS, MICHAEL G &amp;</td><td>8</td><td>164,957</td><td>0</td><td>9,048</td><td>975.00</td></tr> <tr><td>2015</td><td>2015-660001489</td><td>LAGERS, MICHAEL G &amp;</td><td>8</td><td>159,676</td><td>0</td><td>8,785</td><td>904.00</td></tr> <tr><td>2014</td><td>2014-660001489</td><td>LAGERS, MICHAEL G &amp;</td><td>8</td><td>161,182</td><td>0</td><td>8,529</td><td>891.00</td></tr> <tr><td>2013</td><td>2013-660001489</td><td>LAGERS, MICHAEL G &amp;</td><td>8</td><td>152,383</td><td>0</td><td>8,280</td><td>853.00</td></tr> </tbody> </table>										Tax Year	Statement Number	Billed Owner	Tax Area	Total Value	Exemptions	Taxable Value	Billed Tax	2025	2025-660001489	LACKEY, SCOTT H II &	8	183,920	0	11,805	1,256.00	2024	2024-660001489	LACKEY, SCOTT H II &	8	175,432	0	11,461	1,220.00	2023	2023-660001489	LACKEY, SCOTT H II &	8	162,405	0	11,127	1,175.00	2022	2022-660001489	LACKEY, SCOTT H II &	8	161,807	0	10,803	1,148.00	2021	2021-660001489	LAGERS, BRENDA FAYE	8	168,322	0	10,489	1,069.00	2020	2020-660001489	LAGERS, MICHAEL G &	8	165,163	0	10,183	1,075.00	2019	2019-660001489	LAGERS, MICHAEL G &	8	161,072	0	9,887	1,056.00	2018	2018-660001489	LAGERS, MICHAEL G &	8	171,738	0	9,599	1,023.00	2017	2017-660001489	LAGERS, MICHAEL G &	8	170,051	0	9,319	977.00	2016	2016-660001489	LAGERS, MICHAEL G &	8	164,957	0	9,048	975.00	2015	2015-660001489	LAGERS, MICHAEL G &	8	159,676	0	8,785	904.00	2014	2014-660001489	LAGERS, MICHAEL G &	8	161,182	0	8,529	891.00	2013	2013-660001489	LAGERS, MICHAEL G &	8	152,383	0	8,280	853.00
Tax Year	Statement Number	Billed Owner	Tax Area	Total Value	Exemptions	Taxable Value	Billed Tax																																																																																																																		
2025	2025-660001489	LACKEY, SCOTT H II &	8	183,920	0	11,805	1,256.00																																																																																																																		
2024	2024-660001489	LACKEY, SCOTT H II &	8	175,432	0	11,461	1,220.00																																																																																																																		
2023	2023-660001489	LACKEY, SCOTT H II &	8	162,405	0	11,127	1,175.00																																																																																																																		
2022	2022-660001489	LACKEY, SCOTT H II &	8	161,807	0	10,803	1,148.00																																																																																																																		
2021	2021-660001489	LAGERS, BRENDA FAYE	8	168,322	0	10,489	1,069.00																																																																																																																		
2020	2020-660001489	LAGERS, MICHAEL G &	8	165,163	0	10,183	1,075.00																																																																																																																		
2019	2019-660001489	LAGERS, MICHAEL G &	8	161,072	0	9,887	1,056.00																																																																																																																		
2018	2018-660001489	LAGERS, MICHAEL G &	8	171,738	0	9,599	1,023.00																																																																																																																		
2017	2017-660001489	LAGERS, MICHAEL G &	8	170,051	0	9,319	977.00																																																																																																																		
2016	2016-660001489	LAGERS, MICHAEL G &	8	164,957	0	9,048	975.00																																																																																																																		
2015	2015-660001489	LAGERS, MICHAEL G &	8	159,676	0	8,785	904.00																																																																																																																		
2014	2014-660001489	LAGERS, MICHAEL G &	8	161,182	0	8,529	891.00																																																																																																																		
2013	2013-660001489	LAGERS, MICHAEL G &	8	152,383	0	8,280	853.00																																																																																																																		



# Rogers

## Assessment Property Record Card for Tax Year 2026

Data provided by LISA DELOZIER County Assessor

Date 04/17/2026  
Time 02:10:52  
Page 2

Lot Data	Units-Buildable - UNPLATTED (UNITS BUILDABLE)	Primary Image
Lot Size		
Lot Count		
Units Buildable		
Non-Ag Acres	0	
Topography		
Street Access		
Utilities		
Amenities	LAND QUALITY	
Method	Units-Buildable	
Base Lot Value		
Factor Value		
Adjustments		
Lot Value		

Residential Data	
Type	1 Single Family Residence
Condition	3 - Average
Quality	3 - Average
Architecture	
Style	100% One Story
Exterior Wall	60% Veneer, Stone 40% Frame, Siding, Wood
Base/Total Area	2,860 / 2,860
Style	100% One Story
HVAC	100% Warmed & Cooled Air
Roof Cover	3 Built-up Rock
Area on Slab	2,860
Fixture/RghIn	8 /
Bed/F/H Bath	3 / 2.0 /
Basement Area	
Garage Type	576 Attached Garage - Unfinished
Remodel	
Year/Eff Age	1965 / 46



\\tsclient\C\Users\Randy Necessary\Pictures\102\_0323\IMG\_0053. 3/24/2022

GRM Approach	
GRM Code	
Gross Rent	0.00
Indicated Value	

Multiple Regression	
MRA Code	
Adjusted R	
Indicated Value	

Direct Comparables	
Selection Model	1 Res
Adjustment Model	A2 AO Test
Comparables	
Indicated Value	

Cost Approach				Manual : 01/2025			
Base Cost	100.99	Total Misc Impr	+ 19,082	Roofing Adj	+ 3.95	Garage Cost	+ 17,775
Subfloor Adj	+ -2.06	Total RCN	= 378,741	Heat/Cool Adj	+ 12.64	Depreciation ( 51%)	- 193,158
Plumbing Adj	+ 4.02	Lump Sums	+ 0	Basement Adj	+ 0.00	RCNLD	= 185,583
Adj Base Cost	= 119.54	Lot Value	+ 185,583	Total Area	x 2,860	Indicated Value	= 185,583
Adjusted Cost	= 341,884	Value Per SqFt	64.89				

Value Reconciliation			
Selected Approach	Cost Approach		
Improvements	185,583		
Lot Value			
Indicated Value	185,583	64.89	Per SqFt
Agland Value	224		
Site Improvements	706		
Total Value	186,513	65.21	Total Value Per SqFt

Miscellaneous Improvements								
Code	Description	Sketch ID	Size	Year	Units	Unit Cost	Depr	Value
PRCH	SLAB PORCH - COVERED	4138	30x20		600	25.21		15,126
PATO	SLAB PORCH - OPEN	4139	23x20		460	8.60		3,956



# Rogers

## Assessment Property Record Card for Tax Year 2026

Data provided by LISA DELOZIER County Assessor

Date 04/17/2026  
 Time 02:10:52  
 Page 3

Sketch Image

660001489

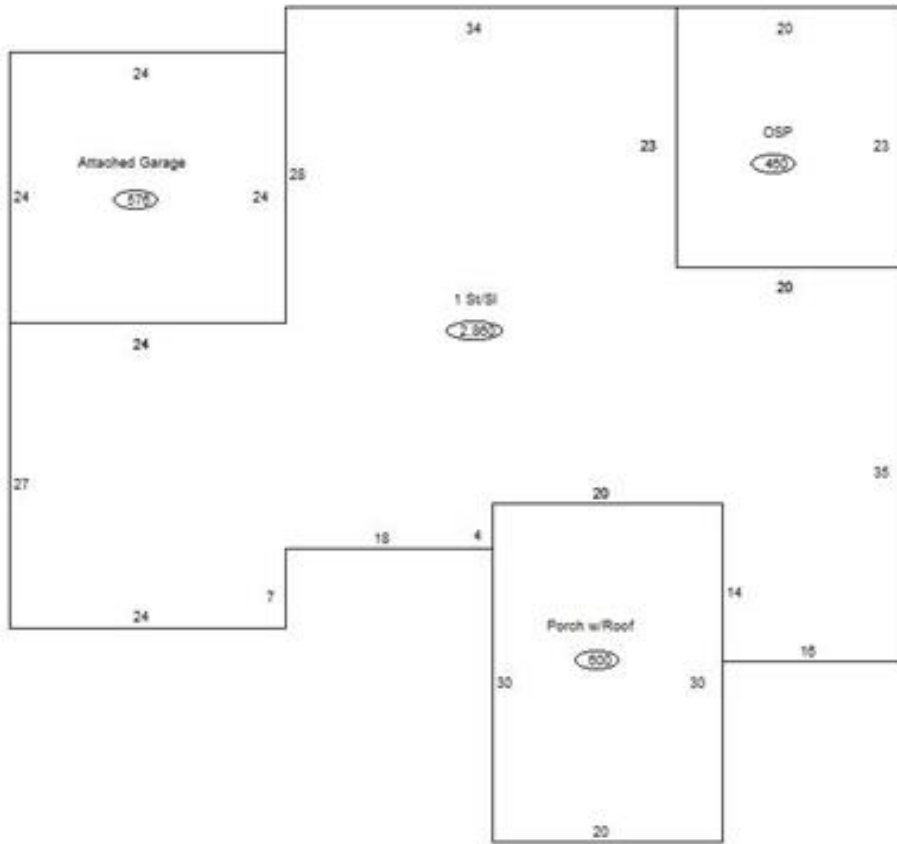

### Sketch Vector Information

Sequence	Code	Type	Built Over	Scale	Section Label	Base Area	Multiplier	Total Area
1	R	1	Slab	13	1 St/Sl	2,860	1.000	2,860
2	G	1		13	Attached Garage	576	1.000	576
3	M	PRCH		13	SLBC	600	1.000	600
4	M	PATO		13	Open Slab	460	1.000	460
<b>Total Building Area</b>						<b>2,860</b>		<b>2,860</b>



# Rogers

## Assessment Property Record Card for Tax Year 2026

Data provided by LISA DELOZIER County Assessor

Date 04/17/2026  
 Time 02:10:52  
 Page 4

660001489

### Outbuildings/Site Improvements

Building Image	Code	Description	Dimensions	Floor	Roofing	Total Units
	STF	STG FAIR	0x0x0			
	Qual	Cond	Year	Eff Age		
	Valuation Summary		Modifier Total	RCN	Depr (100% Phys/ % Func)	RCNLD
	Base Cost (4.68 x )					
	CP	Carport Dirt	14x24x0			336
	Qual	Cond	Year	Eff Age		
	Valuation Summary		Modifier Total	RCN	Depr (40% Phys/ % Func)	RCNLD
	Base Cost (3.50 x 336)		1,176	1,176	470	706



# Rogers

## Assessment Property Record Card for Tax Year 2026

Data provided by LISA DELOZIER County Assessor

Date 04/17/2026  
Time 02:10:52  
Page 5

### Agland Inventory

660001489

Soi	Description	Land Use	LPI	Adj Type	Adj Code	Acres	Use/Acre	Mkt/Acre	Use Value	Market Value
NAB	NEWTONIA SILT LOAM 1-3% S	IMP PST	80			1.000	224	224	224	224
<b>IMP PST Totals</b>						1.000			224	224
<b>Total Agland</b>						1.000			224	224