



# Rogers

## Assessment Property Record Card for Tax Year 2026

Data provided by LISA DELOZIER County Assessor

Date 04/17/2026  
 Time 00:13:23  
 Page 1

Assessment Data					Primary Image																																																																																																																				
<b>Account</b> 660001511 <b>Parcel ID</b> 000000-00-0-00285-001-0009 <b>Cadastral ID</b> 02-21-16-00180 <b>Property Type</b> REAL - Real Property <b>Property Class</b> RRP VI Area 1 <b>Tax Area</b> 5 - JUSTUS RURAL/NO FIRE <b>Name ID</b> 322911 BAILEY, MILDRED  19952 S 4180 RD CLAREMORE OK 74017-0000  <b>Parcel Location</b> <b>Situs</b> 19952 S 4180 RD <b>Subdivision</b> EASTLAND ACRES <b>Lot/Block</b> 0009 / 0001 <b>Parcel Size</b> 1 - Lots <b>Sec/Twn/Rng</b> 2 / 21 / 16 / 5 <b>Neighborhood</b> 1029 - R-V01-NE SEQUOYAH <b>School District</b> S009 - JUSTUS-TIAWAH SCHOOLS																																																																																																																									
<b>Legal Description</b> Lot/Long: 36.32226481 -95.56145811																																																																																																																									
<b>Legal Description</b> LOT 9 BLOCK 1 EASTLAND ACRES					<b>Building Permits</b> <table border="1"> <thead> <tr> <th>Number</th> <th>Description</th> <th>Opened</th> <th>Closed</th> <th>Amount</th> </tr> </thead> <tbody> <tr> <td colspan="5"> </td> </tr> </tbody> </table>					Number	Description	Opened	Closed	Amount																																																																																																											
Number	Description	Opened	Closed	Amount																																																																																																																					
<b>Exemptions</b> <table border="1"> <thead> <tr> <th>Code</th> <th>Type</th> <th>Active</th> <th>Maximum</th> <th>Exemption</th> </tr> </thead> <tbody> <tr> <td>H</td> <td>Homestead</td> <td>No</td> <td>1,000</td> <td></td> </tr> </tbody> </table>					Code	Type	Active	Maximum	Exemption	H	Homestead	No	1,000		<b>Sale History</b> <table border="1"> <thead> <tr> <th>Bk/Pg</th> <th>Grantor</th> <th>Date</th> <th>Price</th> <th>Code</th> </tr> </thead> <tbody> <tr> <td>/</td> <td>WOODALL, ANDY J</td> <td>07/17/2023</td> <td>0</td> <td>4</td> </tr> <tr> <td>2305/818</td> <td>ALLEN, ROY &amp; SHERI</td> <td>02/15/2013</td> <td>140,000</td> <td>YES</td> </tr> <tr> <td>1472/445</td> <td>SEC OF HOUSING &amp; URBAN DEV</td> <td>04/25/2003</td> <td>0</td> <td>1</td> </tr> <tr> <td>1446/138</td> <td>HART, JAMES W</td> <td>09/24/2002</td> <td>0</td> <td>10</td> </tr> <tr> <td>957/232</td> <td>RAGLAND, BILLIE D &amp;</td> <td>05/19/1994</td> <td>76,000</td> <td>Yes</td> </tr> <tr> <td>906/715</td> <td>CLIFTON, SUSAN KAY</td> <td>02/19/1993</td> <td>64,000</td> <td>Yes</td> </tr> </tbody> </table>					Bk/Pg	Grantor	Date	Price	Code	/	WOODALL, ANDY J	07/17/2023	0	4	2305/818	ALLEN, ROY & SHERI	02/15/2013	140,000	YES	1472/445	SEC OF HOUSING & URBAN DEV	04/25/2003	0	1	1446/138	HART, JAMES W	09/24/2002	0	10	957/232	RAGLAND, BILLIE D &	05/19/1994	76,000	Yes	906/715	CLIFTON, SUSAN KAY	02/19/1993	64,000	Yes																																																																			
Code	Type	Active	Maximum	Exemption																																																																																																																					
H	Homestead	No	1,000																																																																																																																						
Bk/Pg	Grantor	Date	Price	Code																																																																																																																					
/	WOODALL, ANDY J	07/17/2023	0	4																																																																																																																					
2305/818	ALLEN, ROY & SHERI	02/15/2013	140,000	YES																																																																																																																					
1472/445	SEC OF HOUSING & URBAN DEV	04/25/2003	0	1																																																																																																																					
1446/138	HART, JAMES W	09/24/2002	0	10																																																																																																																					
957/232	RAGLAND, BILLIE D &	05/19/1994	76,000	Yes																																																																																																																					
906/715	CLIFTON, SUSAN KAY	02/19/1993	64,000	Yes																																																																																																																					
<b>Parcel Valuation</b> <table border="1"> <thead> <tr> <th>Source</th> <th>REAL</th> <th>Fair Cash</th> <th>Capped</th> <th>Asmnt Level</th> <th>Assessed</th> <th>Levy Rate</th> <th>83.050</th> <th>Current Tax</th> </tr> </thead> <tbody> <tr> <td>Remove Cap</td> <td>2014</td> <td>Land Value</td> <td>63,893</td> <td>52,826</td> <td>11%</td> <td>5,811</td> <td>Assessed</td> <td>20,710 1,719.97</td> </tr> <tr> <td>Year Frozen</td> <td>0</td> <td>Improvements</td> <td>135,447</td> <td>135,447</td> <td></td> <td>14,899</td> <td>Penalty</td> <td>0</td> </tr> <tr> <td>Uncapped Value</td> <td>0</td> <td>Mobile Home</td> <td>0</td> <td>0</td> <td></td> <td>0</td> <td>Exemption</td> <td>0 0.00</td> </tr> <tr> <td>TIF Project ID</td> <td>0</td> <td>Total Value</td> <td>199,340</td> <td>188,273</td> <td></td> <td>20,710</td> <td>Total Taxable</td> <td>20,710 1,720.00</td> </tr> </tbody> </table>										Source	REAL	Fair Cash	Capped	Asmnt Level	Assessed	Levy Rate	83.050	Current Tax	Remove Cap	2014	Land Value	63,893	52,826	11%	5,811	Assessed	20,710 1,719.97	Year Frozen	0	Improvements	135,447	135,447		14,899	Penalty	0	Uncapped Value	0	Mobile Home	0	0		0	Exemption	0 0.00	TIF Project ID	0	Total Value	199,340	188,273		20,710	Total Taxable	20,710 1,720.00																																																																			
Source	REAL	Fair Cash	Capped	Asmnt Level	Assessed	Levy Rate	83.050	Current Tax																																																																																																																	
Remove Cap	2014	Land Value	63,893	52,826	11%	5,811	Assessed	20,710 1,719.97																																																																																																																	
Year Frozen	0	Improvements	135,447	135,447		14,899	Penalty	0																																																																																																																	
Uncapped Value	0	Mobile Home	0	0		0	Exemption	0 0.00																																																																																																																	
TIF Project ID	0	Total Value	199,340	188,273		20,710	Total Taxable	20,710 1,720.00																																																																																																																	
<b>Assessment History</b> <table border="1"> <thead> <tr> <th>Tax Year</th> <th>Statement Number</th> <th>Billed Owner</th> <th>Tax Area</th> <th>Total Value</th> <th>Exemptions</th> <th>Taxable Value</th> <th>Billed Tax</th> </tr> </thead> <tbody> <tr><td>2025</td><td>2025-660001511</td><td>BAILEY, MILDRED</td><td>5</td><td>194,730</td><td>0</td><td>19,724</td><td>1,638.00</td></tr> <tr><td>2024</td><td>2024-660001511</td><td>BAILEY, MILDRED</td><td>5</td><td>197,714</td><td>0</td><td>18,785</td><td>1,568.00</td></tr> <tr><td>2023</td><td>2023-660001511</td><td>BAILEY, MILDRED</td><td>5</td><td>189,046</td><td>0</td><td>17,891</td><td>1,490.00</td></tr> <tr><td>2022</td><td>2022-660001511</td><td>WOODALL, ANDY J</td><td>5</td><td>154,895</td><td>0</td><td>17,038</td><td>1,417.00</td></tr> <tr><td>2021</td><td>2021-660001511</td><td>WOODALL, ANDY J</td><td>5</td><td>156,989</td><td>0</td><td>17,269</td><td>1,465.00</td></tr> <tr><td>2020</td><td>2020-660001511</td><td>WOODALL, ANDY J</td><td>5</td><td>154,423</td><td>0</td><td>16,987</td><td>1,438.00</td></tr> <tr><td>2019</td><td>2019-660001511</td><td>WOODALL, ANDY J</td><td>5</td><td>148,259</td><td>0</td><td>16,308</td><td>1,412.00</td></tr> <tr><td>2018</td><td>2018-660001511</td><td>WOODALL, ANDY J</td><td>5</td><td>152,715</td><td>0</td><td>16,799</td><td>1,456.00</td></tr> <tr><td>2017</td><td>2017-660001511</td><td>WOODALL, ANDY J</td><td>5</td><td>151,449</td><td>0</td><td>16,659</td><td>1,359.00</td></tr> <tr><td>2016</td><td>2016-660001511</td><td>WOODALL, ANDY J</td><td>5</td><td>147,499</td><td>0</td><td>16,225</td><td>1,384.00</td></tr> <tr><td>2015</td><td>2015-660001511</td><td>WOODALL, ANDY J</td><td>5</td><td>142,913</td><td>0</td><td>15,720</td><td>1,328.00</td></tr> <tr><td>2014</td><td>2014-660001511</td><td>WOODALL, ANDY J</td><td>5</td><td>145,572</td><td>0</td><td>16,013</td><td>1,374.00</td></tr> <tr><td>2013</td><td>2013-660001511</td><td>WOODALL, ANDY J</td><td>5</td><td>129,730</td><td>1000</td><td>10,339</td><td>901.00</td></tr> </tbody> </table>										Tax Year	Statement Number	Billed Owner	Tax Area	Total Value	Exemptions	Taxable Value	Billed Tax	2025	2025-660001511	BAILEY, MILDRED	5	194,730	0	19,724	1,638.00	2024	2024-660001511	BAILEY, MILDRED	5	197,714	0	18,785	1,568.00	2023	2023-660001511	BAILEY, MILDRED	5	189,046	0	17,891	1,490.00	2022	2022-660001511	WOODALL, ANDY J	5	154,895	0	17,038	1,417.00	2021	2021-660001511	WOODALL, ANDY J	5	156,989	0	17,269	1,465.00	2020	2020-660001511	WOODALL, ANDY J	5	154,423	0	16,987	1,438.00	2019	2019-660001511	WOODALL, ANDY J	5	148,259	0	16,308	1,412.00	2018	2018-660001511	WOODALL, ANDY J	5	152,715	0	16,799	1,456.00	2017	2017-660001511	WOODALL, ANDY J	5	151,449	0	16,659	1,359.00	2016	2016-660001511	WOODALL, ANDY J	5	147,499	0	16,225	1,384.00	2015	2015-660001511	WOODALL, ANDY J	5	142,913	0	15,720	1,328.00	2014	2014-660001511	WOODALL, ANDY J	5	145,572	0	16,013	1,374.00	2013	2013-660001511	WOODALL, ANDY J	5	129,730	1000	10,339	901.00
Tax Year	Statement Number	Billed Owner	Tax Area	Total Value	Exemptions	Taxable Value	Billed Tax																																																																																																																		
2025	2025-660001511	BAILEY, MILDRED	5	194,730	0	19,724	1,638.00																																																																																																																		
2024	2024-660001511	BAILEY, MILDRED	5	197,714	0	18,785	1,568.00																																																																																																																		
2023	2023-660001511	BAILEY, MILDRED	5	189,046	0	17,891	1,490.00																																																																																																																		
2022	2022-660001511	WOODALL, ANDY J	5	154,895	0	17,038	1,417.00																																																																																																																		
2021	2021-660001511	WOODALL, ANDY J	5	156,989	0	17,269	1,465.00																																																																																																																		
2020	2020-660001511	WOODALL, ANDY J	5	154,423	0	16,987	1,438.00																																																																																																																		
2019	2019-660001511	WOODALL, ANDY J	5	148,259	0	16,308	1,412.00																																																																																																																		
2018	2018-660001511	WOODALL, ANDY J	5	152,715	0	16,799	1,456.00																																																																																																																		
2017	2017-660001511	WOODALL, ANDY J	5	151,449	0	16,659	1,359.00																																																																																																																		
2016	2016-660001511	WOODALL, ANDY J	5	147,499	0	16,225	1,384.00																																																																																																																		
2015	2015-660001511	WOODALL, ANDY J	5	142,913	0	15,720	1,328.00																																																																																																																		
2014	2014-660001511	WOODALL, ANDY J	5	145,572	0	16,013	1,374.00																																																																																																																		
2013	2013-660001511	WOODALL, ANDY J	5	129,730	1000	10,339	901.00																																																																																																																		



# Rogers

## Assessment Property Record Card for Tax Year 2026

Data provided by LISA DELOZIER County Assessor

Date 04/17/2026  
 Time 00:13:24  
 Page 2

Lot Data		Square-Foot - NBHD 1029 #1	
Lot Size			
Lot Count	1		
Units Buildable	1		
Non-Ag Acres	0.9779		
Topography			
Street Access			
Utilities			
Amenities	LAND QUALITY	0	
		0	
Method	Square-Foot		
Base Lot Value	42,595.00 x 1.50 = 63,893		
Factor Value			
Adjustments	1.0000		
Lot Value	63,893		



\\tsclient\TLOGAN\LOGAN RESIDENTIAL VI\2023-3-7\IMG\_0037. 3/8/2023

Residential Data	
Type	1 Single Family Residence
Condition	3 - Average
Quality	3 - Average
Architecture	
Style	100% One Story
Exterior Wall	100% Veneer, Masonry
Base/Total Area	1,637 / 1,637
Style	100% One Story
HVAC	100% Warmed & Cooled Air
Roof Cover	1 Composition Shingle
Area on Slab	1,637
Fixture/RghIn	8 /
Bed/F/H Bath	3 / 2.0 /
Basement Area	
Garage Type	682 Attached Garage - Unfinished
Remodel	
Year/Eff Age	1973 / 40

GRM Approach	
GRM Code	
Gross Rent	0.00
Indicated Value	

Multiple Regression			
MRA Code	1	Test	
Adusted R	0.8445		
Indicated Value	201,777	123.26	Per SqFt

Direct Comparables			
Selection Model	A	Adam Test	
Adjustment Model	1	2022 Residential	
Comparables	2		
Indicated Value	277,850		Per SqFt

Cost Approach		Manual : 01/2025	
Base Cost	109.55	Total Misc Impr	+ 14,770
Roofing Adj	+ 4.78	Garage Cost	+ 20,480
Subfloor Adj	+ -2.31	Total RCN	= 250,827
Heat/Cool Adj	+ 12.64	Depreciation ( 46%)	- 115,380
Plumbing Adj	+ 7.03	Lump Sums	+ 0
Basement Adj	+ 0.00	RCNLD	= 135,447
Adj Base Cost	= 131.69	Lot Value	+ 63,893
Total Area	x 1,637	Indicated Value	= 199,340
Adjusted Cost	= 215,577	Value Per SqFt	121.77

Value Reconciliation			
Selected Approach	Cost Approach		
Improvements	135,447		
Lot Value	63,893		
Indicated Value	199,340	121.77	Per SqFt
Agland Value			
Site Improvements			
Total Value	199,340	121.77	Total Value Per SqFt

Miscellaneous Improvements								
Code	Description	Sketch ID	Size	Year	Units	Unit Cost	Depr	Value
FPR1	FIREPLACE - RESIDENTIAL 1 STORY	0		1	1	5,615.40		5,615
PRCH	SLAB PORCH - COVERED	4208	18x6		108	26.59		2,872
PRCH	SLAB PORCH - COVERED	4209	20x12		240	26.18		6,283



# Rogers

## Assessment Property Record Card for Tax Year 2026

Data provided by LISA DELOZIER County Assessor

Date 04/17/2026  
 Time 00:13:24  
 Page 3

### Sketch Image

660001511

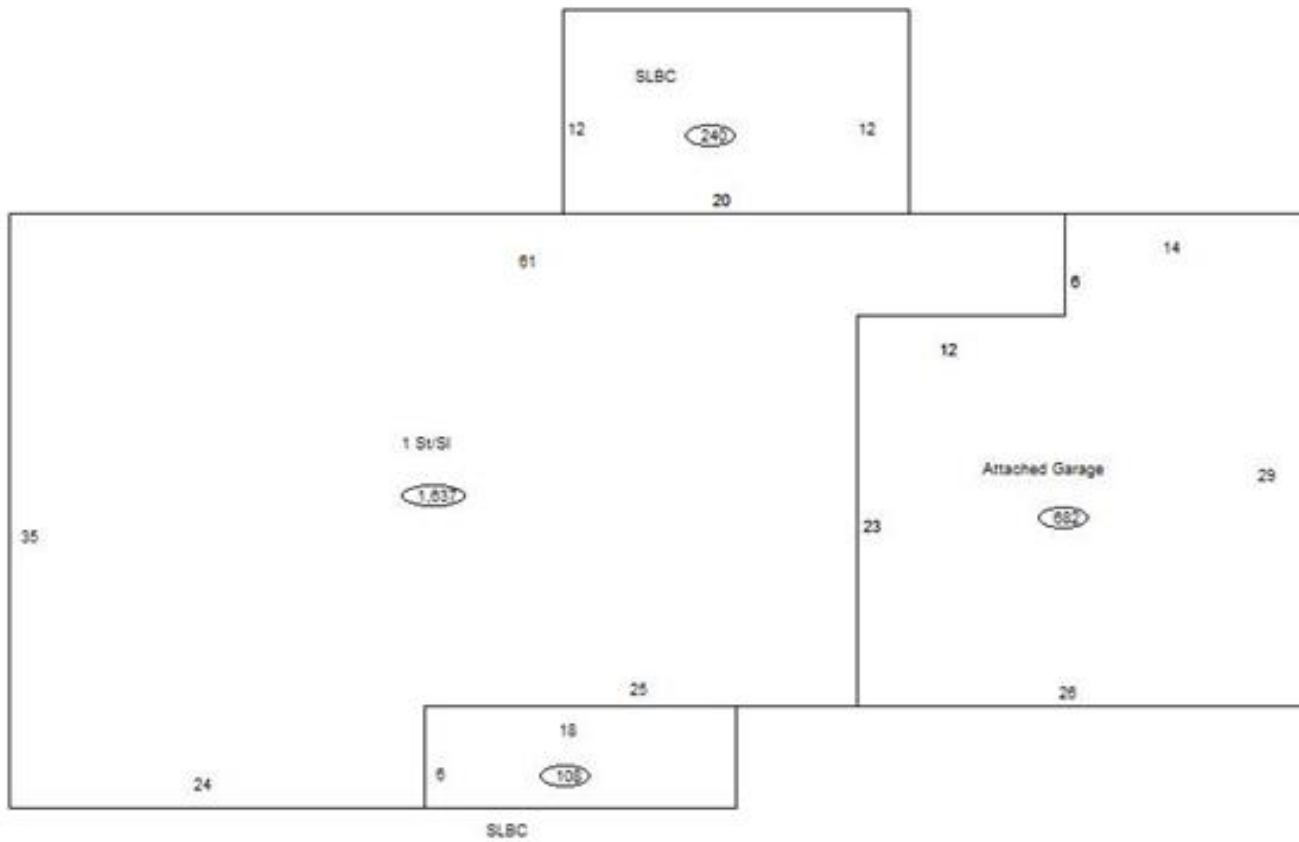

### Sketch Vector Information

Sequence	Code	Type	Built Over	Scale	Section Label	Base Area	Multiplier	Total Area
1	R	1	Slab	10	1 St/SI	1,637	1.000	1,637
2	G	1		10	Attached Garage	682	1.000	682
3	M	PRCH		10	SLBC	108	1.000	108
4	M	PRCH		10	SLBC	240	1.000	240
<b>Total Building Area</b>						1,637		1,637



# Rogers



## Assessment Property Record Card for Tax Year 2026

Data provided by LISA DELOZIER County Assessor

Date 04/17/2026  
Time 00:13:24  
Page 4

660001511

### Outbuildings/Site Improvements

Building Image	Code	Description	Dimensions	Floor	Roofing	Total Units
	STF	STG FAIR	0x0x0			
	Qual	2	Cond	Year	2019	Eff Age
	<b>Valuation Summary</b>		<b>Modifier Total</b>	<b>RCN</b>	<b>Depr (0% Phys/ % Func)</b>	<b>RCNLD</b>
	Base Cost (4.68 x )					
	STF	STG FAIR	0x0x0			
	Qual		Cond	Year		Eff Age
	<b>Valuation Summary</b>		<b>Modifier Total</b>	<b>RCN</b>	<b>Depr (100% Phys/ % Func)</b>	<b>RCNLD</b>
	Base Cost (4.68 x )					