



# Rogers

## Assessment Property Record Card for Tax Year 2026

Data provided by LISA DELOZIER County Assessor

Date 04/17/2026  
 Time 03:16:59  
 Page 1

Assessment Data					Primary Image																																																																																																																				
<b>Account</b> 660001532 <b>Parcel ID</b> 21N16E-02-3-00000-000-0000 <b>Cadastral ID</b> 02-21-16-01400 <b>Property Type</b> REAL - Real Property <b>Property Class</b> RR VI Area 1 <b>Tax Area</b> 5 - JUSTUS RURAL/NO FIRE <b>Name ID</b> 348826 LEIGH, VIRGINIA A REVOCABLE TRUST  14445 E 480 RD CLAREMORE OK 74017-0000  <b>Parcel Location</b> <b>Situs</b> 14445 E 480 RD <b>Subdivision</b> <b>Lot/Block</b> / <b>Parcel Size</b> 2.65 - Acres <b>Sec/Twn/Rng</b> 2 / 21 / 16 / 3 <b>Neighborhood</b> 2116 - UNPLATTED <b>School District</b> S009 - JUSTUS-TIAWAH SCHOOLS																																																																																																																									
<b>Legal Description</b> Lat/Long: 36.32270493 -95.57105076 BEG: 168' W OF SE/C SE SE SW; N 325'; W 80'; N 335'; W 175'; S 510'; E 175'; S 150'; E 80' TO POB																																																																																																																									
<b>Exemptions</b> <table border="1"> <thead> <tr> <th>Code</th> <th>Type</th> <th>Active</th> <th>Maximum</th> <th>Exemption</th> </tr> </thead> <tbody> <tr> <td>H</td> <td>Homestead</td> <td>Yes</td> <td>1,000</td> <td>1,000</td> </tr> </tbody> </table>					Code	Type	Active	Maximum	Exemption	H	Homestead	Yes	1,000	1,000	<b>Building Permits</b> <table border="1"> <thead> <tr> <th>Number</th> <th>Description</th> <th>Opened</th> <th>Closed</th> <th>Amount</th> </tr> </thead> <tbody> <tr> <td></td> <td></td> <td></td> <td></td> <td></td> </tr> </tbody> </table>					Number	Description	Opened	Closed	Amount																																																																																																	
Code	Type	Active	Maximum	Exemption																																																																																																																					
H	Homestead	Yes	1,000	1,000																																																																																																																					
Number	Description	Opened	Closed	Amount																																																																																																																					
<b>Parcel Valuation</b> <table border="1"> <thead> <tr> <th>Source</th> <th>REAL</th> <th>Fair Cash</th> <th>Capped</th> <th>Asmnt Level</th> <th>Assessed</th> <th>Levy Rate</th> <th>83.050</th> <th>Current Tax</th> </tr> </thead> <tbody> <tr> <td>Remove Cap</td> <td>0</td> <td>Land Value 65,616</td> <td>26,601</td> <td>11%</td> <td>2,926</td> <td>Assessed</td> <td>6,868</td> <td>570.39</td> </tr> <tr> <td>Year Frozen</td> <td>2011</td> <td>Improvements 88,401</td> <td>35,838</td> <td></td> <td>3,942</td> <td>Penalty</td> <td>0</td> <td></td> </tr> <tr> <td>Uncapped Value</td> <td>0</td> <td>Mobile Home 0</td> <td>0</td> <td></td> <td>0</td> <td>Exemption</td> <td>1,000</td> <td>-83.00</td> </tr> <tr> <td>TIF Project ID</td> <td>0</td> <td>Total Value 154,017</td> <td>62,439</td> <td></td> <td>6,868</td> <td>Total Taxable</td> <td>5,868</td> <td>487.00</td> </tr> </tbody> </table>					Source	REAL	Fair Cash	Capped	Asmnt Level	Assessed	Levy Rate	83.050	Current Tax	Remove Cap	0	Land Value 65,616	26,601	11%	2,926	Assessed	6,868	570.39	Year Frozen	2011	Improvements 88,401	35,838		3,942	Penalty	0		Uncapped Value	0	Mobile Home 0	0		0	Exemption	1,000	-83.00	TIF Project ID	0	Total Value 154,017	62,439		6,868	Total Taxable	5,868	487.00	<b>Sale History</b> <table border="1"> <thead> <tr> <th>Bk/Pg</th> <th>Grantor</th> <th>Date</th> <th>Price</th> <th>Code</th> </tr> </thead> <tbody> <tr> <td>/</td> <td>LEIGH, VIRGINIA A</td> <td>11/17/2025</td> <td></td> <td>4</td> </tr> </tbody> </table>					Bk/Pg	Grantor	Date	Price	Code	/	LEIGH, VIRGINIA A	11/17/2025		4																																																									
Source	REAL	Fair Cash	Capped	Asmnt Level	Assessed	Levy Rate	83.050	Current Tax																																																																																																																	
Remove Cap	0	Land Value 65,616	26,601	11%	2,926	Assessed	6,868	570.39																																																																																																																	
Year Frozen	2011	Improvements 88,401	35,838		3,942	Penalty	0																																																																																																																		
Uncapped Value	0	Mobile Home 0	0		0	Exemption	1,000	-83.00																																																																																																																	
TIF Project ID	0	Total Value 154,017	62,439		6,868	Total Taxable	5,868	487.00																																																																																																																	
Bk/Pg	Grantor	Date	Price	Code																																																																																																																					
/	LEIGH, VIRGINIA A	11/17/2025		4																																																																																																																					
<b>Assessment History</b> <table border="1"> <thead> <tr> <th>Tax Year</th> <th>Statement Number</th> <th>Billed Owner</th> <th>Tax Area</th> <th>Total Value</th> <th>Exemptions</th> <th>Taxable Value</th> <th>Billed Tax</th> </tr> </thead> <tbody> <tr><td>2025</td><td>2025-660001532</td><td>LEIGH, VIRGINIA A</td><td>5</td><td>146,660</td><td>1000</td><td>5,869</td><td>487.00</td></tr> <tr><td>2024</td><td>2024-660001532</td><td>LEIGH, JOHNNIE</td><td>5</td><td>150,255</td><td>1000</td><td>5,868</td><td>490.00</td></tr> <tr><td>2023</td><td>2023-660001532</td><td>LEIGH, JOHNNIE</td><td>5</td><td>105,414</td><td>1000</td><td>5,868</td><td>489.00</td></tr> <tr><td>2022</td><td>2022-660001532</td><td>LEIGH, JOHNNIE</td><td>5</td><td>105,522</td><td>1000</td><td>5,868</td><td>488.00</td></tr> <tr><td>2021</td><td>2021-660001532</td><td>LEIGH, JOHNNIE</td><td>5</td><td>100,974</td><td>1000</td><td>5,869</td><td>498.00</td></tr> <tr><td>2020</td><td>2020-660001532</td><td>LEIGH, JOHNNIE</td><td>5</td><td>98,992</td><td>1000</td><td>5,869</td><td>497.00</td></tr> <tr><td>2019</td><td>2019-660001532</td><td>LEIGH, JOHNNIE</td><td>5</td><td>95,757</td><td>1000</td><td>5,868</td><td>508.00</td></tr> <tr><td>2018</td><td>2018-660001532</td><td>LEIGH, JOHNNIE</td><td>5</td><td>100,153</td><td>1000</td><td>5,868</td><td>509.00</td></tr> <tr><td>2017</td><td>2017-660001532</td><td>LEIGH, JOHNNIE</td><td>5</td><td>99,371</td><td>1000</td><td>5,869</td><td>479.00</td></tr> <tr><td>2016</td><td>2016-660001532</td><td>LEIGH, JOHNNIE</td><td>5</td><td>97,658</td><td>1000</td><td>5,868</td><td>501.00</td></tr> <tr><td>2015</td><td>2015-660001532</td><td>LEIGH, JOHNNIE</td><td>5</td><td>93,475</td><td>1000</td><td>5,868</td><td>496.00</td></tr> <tr><td>2014</td><td>2014-660001532</td><td>LEIGH, JOHNNIE</td><td>5</td><td>94,128</td><td>1000</td><td>5,868</td><td>504.00</td></tr> <tr><td>2013</td><td>2013-660001532</td><td>LEIGH, JOHNNIE</td><td>5</td><td>91,859</td><td>1000</td><td>5,868</td><td>511.00</td></tr> </tbody> </table>										Tax Year	Statement Number	Billed Owner	Tax Area	Total Value	Exemptions	Taxable Value	Billed Tax	2025	2025-660001532	LEIGH, VIRGINIA A	5	146,660	1000	5,869	487.00	2024	2024-660001532	LEIGH, JOHNNIE	5	150,255	1000	5,868	490.00	2023	2023-660001532	LEIGH, JOHNNIE	5	105,414	1000	5,868	489.00	2022	2022-660001532	LEIGH, JOHNNIE	5	105,522	1000	5,868	488.00	2021	2021-660001532	LEIGH, JOHNNIE	5	100,974	1000	5,869	498.00	2020	2020-660001532	LEIGH, JOHNNIE	5	98,992	1000	5,869	497.00	2019	2019-660001532	LEIGH, JOHNNIE	5	95,757	1000	5,868	508.00	2018	2018-660001532	LEIGH, JOHNNIE	5	100,153	1000	5,868	509.00	2017	2017-660001532	LEIGH, JOHNNIE	5	99,371	1000	5,869	479.00	2016	2016-660001532	LEIGH, JOHNNIE	5	97,658	1000	5,868	501.00	2015	2015-660001532	LEIGH, JOHNNIE	5	93,475	1000	5,868	496.00	2014	2014-660001532	LEIGH, JOHNNIE	5	94,128	1000	5,868	504.00	2013	2013-660001532	LEIGH, JOHNNIE	5	91,859	1000	5,868	511.00
Tax Year	Statement Number	Billed Owner	Tax Area	Total Value	Exemptions	Taxable Value	Billed Tax																																																																																																																		
2025	2025-660001532	LEIGH, VIRGINIA A	5	146,660	1000	5,869	487.00																																																																																																																		
2024	2024-660001532	LEIGH, JOHNNIE	5	150,255	1000	5,868	490.00																																																																																																																		
2023	2023-660001532	LEIGH, JOHNNIE	5	105,414	1000	5,868	489.00																																																																																																																		
2022	2022-660001532	LEIGH, JOHNNIE	5	105,522	1000	5,868	488.00																																																																																																																		
2021	2021-660001532	LEIGH, JOHNNIE	5	100,974	1000	5,869	498.00																																																																																																																		
2020	2020-660001532	LEIGH, JOHNNIE	5	98,992	1000	5,869	497.00																																																																																																																		
2019	2019-660001532	LEIGH, JOHNNIE	5	95,757	1000	5,868	508.00																																																																																																																		
2018	2018-660001532	LEIGH, JOHNNIE	5	100,153	1000	5,868	509.00																																																																																																																		
2017	2017-660001532	LEIGH, JOHNNIE	5	99,371	1000	5,869	479.00																																																																																																																		
2016	2016-660001532	LEIGH, JOHNNIE	5	97,658	1000	5,868	501.00																																																																																																																		
2015	2015-660001532	LEIGH, JOHNNIE	5	93,475	1000	5,868	496.00																																																																																																																		
2014	2014-660001532	LEIGH, JOHNNIE	5	94,128	1000	5,868	504.00																																																																																																																		
2013	2013-660001532	LEIGH, JOHNNIE	5	91,859	1000	5,868	511.00																																																																																																																		



# Rogers

## Assessment Property Record Card for Tax Year 2026

Data provided by LISA DELOZIER County Assessor

Date 04/17/2026  
 Time 03:16:59  
 Page 2

Lot Data		Square-Foot - NBHD 2116 #1	
Lot Size			
Lot Count			
Units Buildable	1		
Non-Ag Acres	2.9316		
Topography			
Street Access			
Utilities			
Amenities	LAND QUALITY	0	0
Method	Square-Foot		
Base Lot Value	127,702.00 x .51 = 65,616		
Factor Value			
Adjustments	1.0000		
Lot Value	65,616		



\\tsclient\T\LOGAN\LOGAN RESIDENTIAL VI\2023-3-27\IMG\_004I 3/28/2023

Residential Data	
Type	1 Single Family Residence
Condition	3 - Average
Quality	2 - Fair
Architecture	
Style	100% One Story
Exterior Wall	100% Frame, Siding, Vinyl
Base/Total Area	1,248 / 1,248
Style	100% One Story
HVAC	100% Warmed & Cooled Air
Roof Cover	1 Composition Shingle
Area on Slab	0
Fixture/RghIn	4 /
Bed/F/H Bath	3 / 1.0 /
Basement Area	
Garage Type	
Remodel	
Year/Eff Age	1963 / 47

GRM Approach	
GRM Code	
Gross Rent	0.00
Indicated Value	

Multiple Regression			
MRA Code	1 Test		
Adusted R	0.8445		
Indicated Value	101,185	81.08	Per SqFt

Direct Comparables	
Selection Model	A Adam Test
Adjustment Model	NewTest
Comparables	
Indicated Value	

Cost Approach				Manual : 01/2025			
Base Cost	87.38	Total Misc Impr	+ 2,345				
Roofing Adj	+ 3.96	Garage Cost	+ 0				
Subfloor Adj	+ 2.31	Total RCN	= 137,092				
Heat/Cool Adj	+ 10.30	Depreciation ( 56%)	- 76,772				
Plumbing Adj	+ 4.02	Lump Sums	+ 0				
Basement Adj	+ 0.00	RCNLD	= 60,320				
Adj Base Cost	= 107.97	Lot Value	+ 65,616				
Total Area	x 1,248	Indicated Value	= 125,936				
Adjusted Cost	= 134,747	Value Per SqFt	100.91				

Value Reconciliation			
Selected Approach	Cost Approach		
Improvements	60,320		
Lot Value	65,616		
Indicated Value	125,936	100.91	Per SqFt
Agland Value			
Site Improvements	28,081		
Total Value	154,017	123.41	Total Value Per SqFt

Miscellaneous Improvements							
Code	Description	Sketch ID	Size	Year	Units	Unit Cost	Depr Value
PRCH	SLAB PORCH - COVERED	4238	14x8		112	20.94	2,345



# Rogers

## Assessment Property Record Card for Tax Year 2026

Data provided by LISA DELOZIER County Assessor

Date 04/17/2026

Time 03:16:59

Page 3

### Sketch Image

660001532

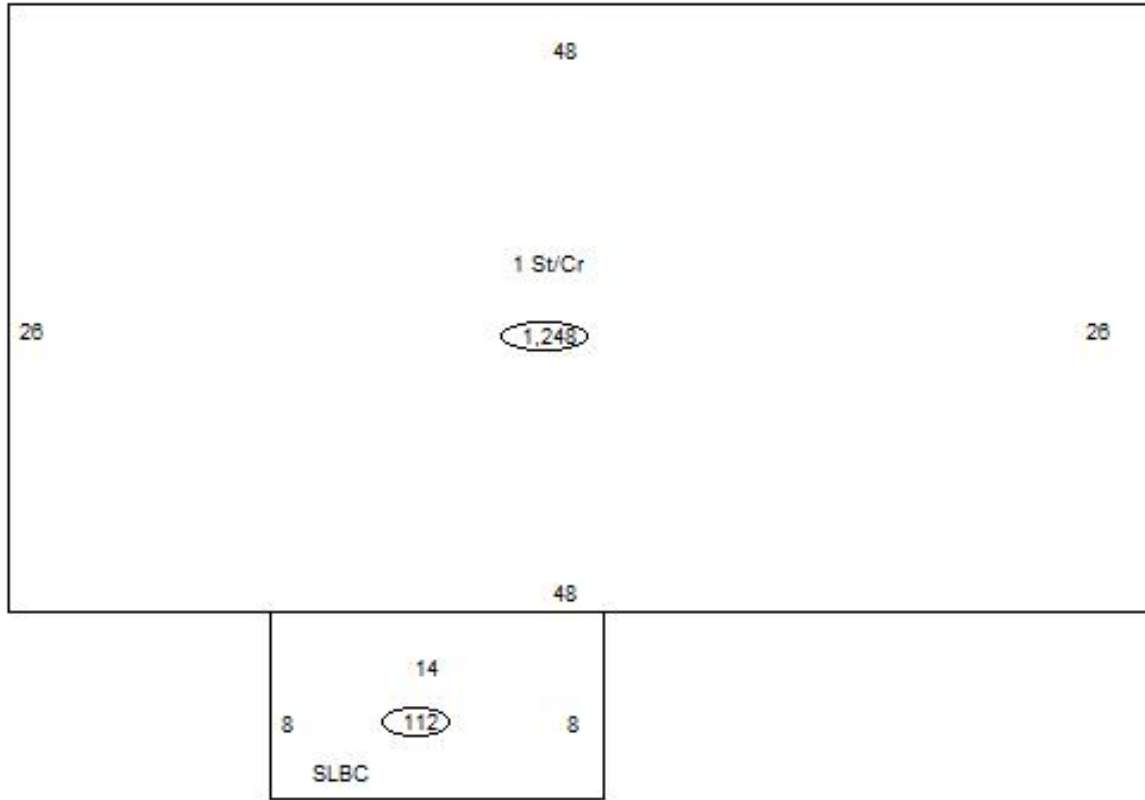

### Sketch Vector Information

Sequence	Code	Type	Built Over	Scale	Section Label	Base Area	Multiplier	Total Area
1	R	1	Crawl	10	1 St/Cr	1,248	1.000	1,248
2	M	PRCH		10	SLBC	112	1.000	112
<b>Total Building Area</b>						1,248		1,248



# Rogers



## Assessment Property Record Card for Tax Year 2026

Data provided by LISA DELOZIER County Assessor

Date 04/17/2026  
 Time 03:16:59  
 Page 4

660001532

### Outbuildings/Site Improvements

Building Image	Code	Description	Dimensions	Floor	Roofing	Total Units	
	UTIL	SHOP BUILDING	0x0x0			900	
	Qual	2	Cond 3	Year	Eff Age		
	<b>Valuation Summary</b>		<b>Modifier Total</b>		<b>RCN</b>	<b>Depr (40% Phys/ % Func)</b>	<b>RCNLD</b>
	Base Cost (31.28 x 900)		28,152		28,152	11,261	16,891
	BARN	BARN	30x50x0			1,500	
	Qual	3	Cond 3	Year	Eff Age		
	<b>Valuation Summary</b>		<b>Modifier Total</b>		<b>RCN</b>	<b>Depr (30% Phys/ % Func)</b>	<b>RCNLD</b>
	Base Cost (9.80 x 1,500)		14,700		14,700	4,410	10,290
	LF	LOAFING SHED	16x22x0			352	
	Qual	3	Cond 3	Year	Eff Age		
	<b>Valuation Summary</b>		<b>Modifier Total</b>		<b>RCN</b>	<b>Depr (40% Phys/ % Func)</b>	<b>RCNLD</b>
	Base Cost (4.26 x 352)		1,500		1,500	600	900