



# Rogers

## Assessment Property Record Card for Tax Year 2026

Data provided by LISA DELOZIER County Assessor

Date 04/17/2026  
Time 05:06:57  
Page 1

Assessment Data					Primary Image																																																																																																											
<b>Account</b> 660001647 <b>Parcel ID</b> 22N17E-02-1-00000-000-0000 <b>Cadastral ID</b> 02-22-17-01600 <b>Property Type</b> REAL - Real Property <b>Property Class</b> RA VI Area 2 <b>Tax Area</b> 71 - CHELSEA RURAL/FOYIL FIRE <b>Name ID</b> 27234 MORTON, BOBBY D & ALICE LOUISE TRUSTEES  20544 E 410 RD CHELSEA OK 74016-0000  <b>Parcel Location</b> <b>Situs</b> 20544 E 410 RD <b>Subdivision</b> <b>Lot/Block</b> / <b>Parcel Size</b> 20 - Acres <b>Sec/Twn/Rng</b> 2 / 22 / 17 / 1 <b>Neighborhood</b> 4070 - FOYIL SEQUOYAH AREA <b>School District</b> S003 - CHELSEA SCHOOLS					<p>660001647_007.JPG 12/10/2024</p>																																																																																																											
<b>Legal Description</b> Lat/Long: 36.42143425 -95.46136617																																																																																																																
W2 OF LOT 2					<b>Building Permits</b>																																																																																																											
					<table border="1"> <thead> <tr> <th>Number</th> <th>Description</th> <th>Opened</th> <th>Closed</th> <th>Amount</th> </tr> </thead> <tbody> <tr> <td>R5</td> <td>ROLL WOD &amp; SFR ADD-ON PER V5-JC</td> <td>12/2004</td> <td>12/2004</td> <td></td> </tr> </tbody> </table>	Number	Description	Opened	Closed	Amount	R5	ROLL WOD & SFR ADD-ON PER V5-JC	12/2004	12/2004																																																																																																		
Number	Description	Opened	Closed	Amount																																																																																																												
R5	ROLL WOD & SFR ADD-ON PER V5-JC	12/2004	12/2004																																																																																																													
<b>Exemptions</b>					<b>Sale History</b>																																																																																																											
<table border="1"> <thead> <tr> <th>Code</th> <th>Type</th> <th>Active</th> <th>Maximum</th> <th>Exemption</th> </tr> </thead> <tbody> <tr> <td>H</td> <td>Homestead</td> <td>Yes</td> <td>1,000</td> <td>1,000</td> </tr> </tbody> </table>	Code	Type	Active	Maximum	Exemption	H	Homestead	Yes	1,000	1,000	<table border="1"> <thead> <tr> <th>Bk/Pg</th> <th>Grantor</th> <th>Date</th> <th>Price</th> <th>Code</th> </tr> </thead> <tbody> </tbody> </table>					Bk/Pg	Grantor	Date	Price	Code																																																																																												
Code	Type	Active	Maximum	Exemption																																																																																																												
H	Homestead	Yes	1,000	1,000																																																																																																												
Bk/Pg	Grantor	Date	Price	Code																																																																																																												
<b>Parcel Valuation</b>																																																																																																																
<table border="1"> <thead> <tr> <th>Source</th> <th>REAL</th> <th>Fair Cash</th> <th>Capped</th> <th>Asmnt Level</th> <th>Assessed</th> <th>Levy Rate</th> <th>95.740</th> <th>Current Tax</th> </tr> </thead> <tbody> <tr> <td>Remove Cap</td> <td>0</td> <td>Land Value 3,840</td> <td>3,840</td> <td>11%</td> <td>422</td> <td>Assessed</td> <td>12,084</td> <td>1,156.92</td> </tr> <tr> <td>Year Frozen</td> <td>0</td> <td>Improvements 113,671</td> <td>106,020</td> <td></td> <td>11,662</td> <td>Penalty</td> <td>0</td> <td></td> </tr> <tr> <td>Uncapped Value</td> <td>0</td> <td>Mobile Home 0</td> <td>0</td> <td></td> <td>0</td> <td>Exemption</td> <td>1,000</td> <td>-83.00</td> </tr> <tr> <td>TIF Project ID</td> <td>0</td> <td>Total Value 117,511</td> <td>109,860</td> <td></td> <td>12,084</td> <td>Total Taxable</td> <td>11,084</td> <td>1,074.00</td> </tr> </tbody> </table>	Source	REAL	Fair Cash	Capped	Asmnt Level	Assessed	Levy Rate	95.740	Current Tax	Remove Cap	0	Land Value 3,840	3,840	11%	422	Assessed	12,084	1,156.92	Year Frozen	0	Improvements 113,671	106,020		11,662	Penalty	0		Uncapped Value	0	Mobile Home 0	0		0	Exemption	1,000	-83.00	TIF Project ID	0	Total Value 117,511	109,860		12,084	Total Taxable	11,084	1,074.00																																																																			
Source	REAL	Fair Cash	Capped	Asmnt Level	Assessed	Levy Rate	95.740	Current Tax																																																																																																								
Remove Cap	0	Land Value 3,840	3,840	11%	422	Assessed	12,084	1,156.92																																																																																																								
Year Frozen	0	Improvements 113,671	106,020		11,662	Penalty	0																																																																																																									
Uncapped Value	0	Mobile Home 0	0		0	Exemption	1,000	-83.00																																																																																																								
TIF Project ID	0	Total Value 117,511	109,860		12,084	Total Taxable	11,084	1,074.00																																																																																																								
<b>Assessment History</b>																																																																																																																
<table border="1"> <thead> <tr> <th>Tax Year</th> <th>Statement Number</th> <th>Billed Owner</th> <th>Tax Area</th> <th>Total Value</th> <th>Exemptions</th> <th>Taxable Value</th> <th>Billed Tax</th> </tr> </thead> <tbody> <tr><td>2025</td><td>2025-660001647</td><td>MORTON, BOBBY D &amp; ALICE LOUISE</td><td>71</td><td>125,703</td><td>1000</td><td>10,732</td><td>1,040.00</td></tr> <tr><td>2024</td><td>2024-660001647</td><td>MORTON, BOBBY D &amp; ALICE LOUISE</td><td>71</td><td>75,128</td><td>1000</td><td>7,024</td><td>699.00</td></tr> <tr><td>2023</td><td>2023-660001647</td><td>MORTON, BOBBY D &amp; ALICE LOUISE</td><td>71</td><td>70,824</td><td>1000</td><td>6,790</td><td>683.00</td></tr> <tr><td>2022</td><td>2022-660001647</td><td>MORTON, BOBBY D &amp; ALICE LOUISE</td><td>71</td><td>69,536</td><td>1000</td><td>6,649</td><td>674.00</td></tr> <tr><td>2021</td><td>2021-660001647</td><td>MORTON, BOBBY D &amp; ALICE LOUISE</td><td>71</td><td>69,415</td><td>1000</td><td>6,635</td><td>677.00</td></tr> <tr><td>2020</td><td>2020-660001647</td><td>MORTON, BOBBY D &amp; ALICE LOUISE</td><td>71</td><td>70,995</td><td>1000</td><td>6,744</td><td>696.00</td></tr> <tr><td>2019</td><td>2019-660001647</td><td>MORTON, BOBBY D &amp; ALICE LOUISE</td><td>71</td><td>68,350</td><td>1000</td><td>6,518</td><td>685.00</td></tr> <tr><td>2018</td><td>2018-660001647</td><td>MORTON, BOBBY D &amp; ALICE LOUISE</td><td>71</td><td>74,255</td><td>1000</td><td>7,168</td><td>743.00</td></tr> <tr><td>2017</td><td>2017-660001647</td><td>MORTON, BOBBY D &amp; ALICE LOUISE</td><td>71</td><td>73,570</td><td>1000</td><td>6,941</td><td>728.00</td></tr> <tr><td>2016</td><td>2016-660001647</td><td>MORTON, BOBBY D &amp; ALICE LOUISE</td><td>71</td><td>71,420</td><td>1000</td><td>6,710</td><td>715.00</td></tr> <tr><td>2015</td><td>2015-660001647</td><td>MORTON, BOBBY D &amp; ALICE LOUISE</td><td>71</td><td>69,770</td><td>1000</td><td>6,485</td><td>684.00</td></tr> <tr><td>2014</td><td>2014-660001647</td><td>MORTON, BOBBY D &amp; ALICE LOUISE</td><td>71</td><td>71,283</td><td>1000</td><td>6,267</td><td>681.00</td></tr> <tr><td>2013</td><td>2013-660001647</td><td>MORTON, BOB D</td><td>71</td><td>68,102</td><td>1000</td><td>6,056</td><td>649.00</td></tr> </tbody> </table>	Tax Year	Statement Number	Billed Owner	Tax Area	Total Value	Exemptions	Taxable Value	Billed Tax	2025	2025-660001647	MORTON, BOBBY D & ALICE LOUISE	71	125,703	1000	10,732	1,040.00	2024	2024-660001647	MORTON, BOBBY D & ALICE LOUISE	71	75,128	1000	7,024	699.00	2023	2023-660001647	MORTON, BOBBY D & ALICE LOUISE	71	70,824	1000	6,790	683.00	2022	2022-660001647	MORTON, BOBBY D & ALICE LOUISE	71	69,536	1000	6,649	674.00	2021	2021-660001647	MORTON, BOBBY D & ALICE LOUISE	71	69,415	1000	6,635	677.00	2020	2020-660001647	MORTON, BOBBY D & ALICE LOUISE	71	70,995	1000	6,744	696.00	2019	2019-660001647	MORTON, BOBBY D & ALICE LOUISE	71	68,350	1000	6,518	685.00	2018	2018-660001647	MORTON, BOBBY D & ALICE LOUISE	71	74,255	1000	7,168	743.00	2017	2017-660001647	MORTON, BOBBY D & ALICE LOUISE	71	73,570	1000	6,941	728.00	2016	2016-660001647	MORTON, BOBBY D & ALICE LOUISE	71	71,420	1000	6,710	715.00	2015	2015-660001647	MORTON, BOBBY D & ALICE LOUISE	71	69,770	1000	6,485	684.00	2014	2014-660001647	MORTON, BOBBY D & ALICE LOUISE	71	71,283	1000	6,267	681.00	2013	2013-660001647	MORTON, BOB D	71	68,102	1000	6,056	649.00
Tax Year	Statement Number	Billed Owner	Tax Area	Total Value	Exemptions	Taxable Value	Billed Tax																																																																																																									
2025	2025-660001647	MORTON, BOBBY D & ALICE LOUISE	71	125,703	1000	10,732	1,040.00																																																																																																									
2024	2024-660001647	MORTON, BOBBY D & ALICE LOUISE	71	75,128	1000	7,024	699.00																																																																																																									
2023	2023-660001647	MORTON, BOBBY D & ALICE LOUISE	71	70,824	1000	6,790	683.00																																																																																																									
2022	2022-660001647	MORTON, BOBBY D & ALICE LOUISE	71	69,536	1000	6,649	674.00																																																																																																									
2021	2021-660001647	MORTON, BOBBY D & ALICE LOUISE	71	69,415	1000	6,635	677.00																																																																																																									
2020	2020-660001647	MORTON, BOBBY D & ALICE LOUISE	71	70,995	1000	6,744	696.00																																																																																																									
2019	2019-660001647	MORTON, BOBBY D & ALICE LOUISE	71	68,350	1000	6,518	685.00																																																																																																									
2018	2018-660001647	MORTON, BOBBY D & ALICE LOUISE	71	74,255	1000	7,168	743.00																																																																																																									
2017	2017-660001647	MORTON, BOBBY D & ALICE LOUISE	71	73,570	1000	6,941	728.00																																																																																																									
2016	2016-660001647	MORTON, BOBBY D & ALICE LOUISE	71	71,420	1000	6,710	715.00																																																																																																									
2015	2015-660001647	MORTON, BOBBY D & ALICE LOUISE	71	69,770	1000	6,485	684.00																																																																																																									
2014	2014-660001647	MORTON, BOBBY D & ALICE LOUISE	71	71,283	1000	6,267	681.00																																																																																																									
2013	2013-660001647	MORTON, BOB D	71	68,102	1000	6,056	649.00																																																																																																									



# Rogers

## Assessment Property Record Card for Tax Year 2026

Data provided by LISA DELOZIER County Assessor

Date 04/17/2026  
 Time 05:06:58  
 Page 2

<b>Lot Data</b> - FOYIL SEQUOYAH AREA (UNITS BUILDABLE)	
Lot Size	
Lot Count	
Units Buildable	
Non-Ag Acres	0
Topography	
Street Access	
Utilities	
Amenities	LAND QUALITY
Method	Units-Buildable
Base Lot Value	
Factor Value	
Adjustments	
Lot Value	



<b>Residential Data</b>	
Type	1 Single Family Residence
Condition	3 - Average
Quality	2.5 - Fair
Architecture	TRAD TRADITIONAL
Style	100% One Story
Exterior Wall	100% Frame, Siding, Wood
Base/Total Area	1,768 / 1,768
Style	100% One Story
HVAC	100% Forced Air Furnace
Roof Cover	1 Composition Shingle
Area on Slab	1,768
Fixture/RghIn	4 /
Bed/F/H Bath	2 / 1.0 /
Basement Area	
Garage Type	528 Carport - Shed Roof
Remodel	
Year/Eff Age	1952 / 56

<b>GRM Approach</b>	
GRM Code	
Gross Rent	0.00
Indicated Value	

<b>Multiple Regression</b>	
MRA Code	
Adjusted R	
Indicated Value	

<b>Direct Comparables</b>	
Selection Model	1 Res
Adjustment Model	A2 AO Test
Comparables	
Indicated Value	

<b>Cost Approach</b>		<b>Manual : 01/2025</b>	
Base Cost	92.17	Total Misc Impr	+ 1,445
Roofing Adj	+ 4.27	Garage Cost	+ 6,415
Subfloor Adj	+ -1.19	Total RCN	= 191,697
Heat/Cool Adj	+ 5.57	Depreciation ( 62%)	- 118,852
Plumbing Adj	+ 3.16	Lump Sums	+ 5,752
Basement Adj	+ 0.00	RCNLD	= 78,597
Adj Base Cost	= 103.98	Lot Value	+ 78,597
Total Area	x 1,768	Indicated Value	= 78,597
Adjusted Cost	= 183,837	Value Per SqFt	44.46

<b>Value Reconciliation</b>	
Selected Approach	Cost Approach
Improvements	78,597
Lot Value	
Indicated Value	78,597 44.46 Per SqFt
Agland Value	3,840
Site Improvements	35,074
Total Value	117,511 66.47 Total Value Per SqFt

<b>Miscellaneous Improvements</b>								
Code	Description	Sketch ID	Size	Year	Units	Unit Cost	Depr	Value
WODO	WOOD DECK - OPEN	4449	28x16		448	16.05	20%	5,752
PRCH	SLAB PORCH - COVERED	4450	12x5		60	24.08		1,445



# Rogers

## Assessment Property Record Card for Tax Year 2026

Data provided by LISA DELOZIER County Assessor

Date 04/17/2026  
 Time 05:06:58  
 Page 3

Sketch Image

660001647

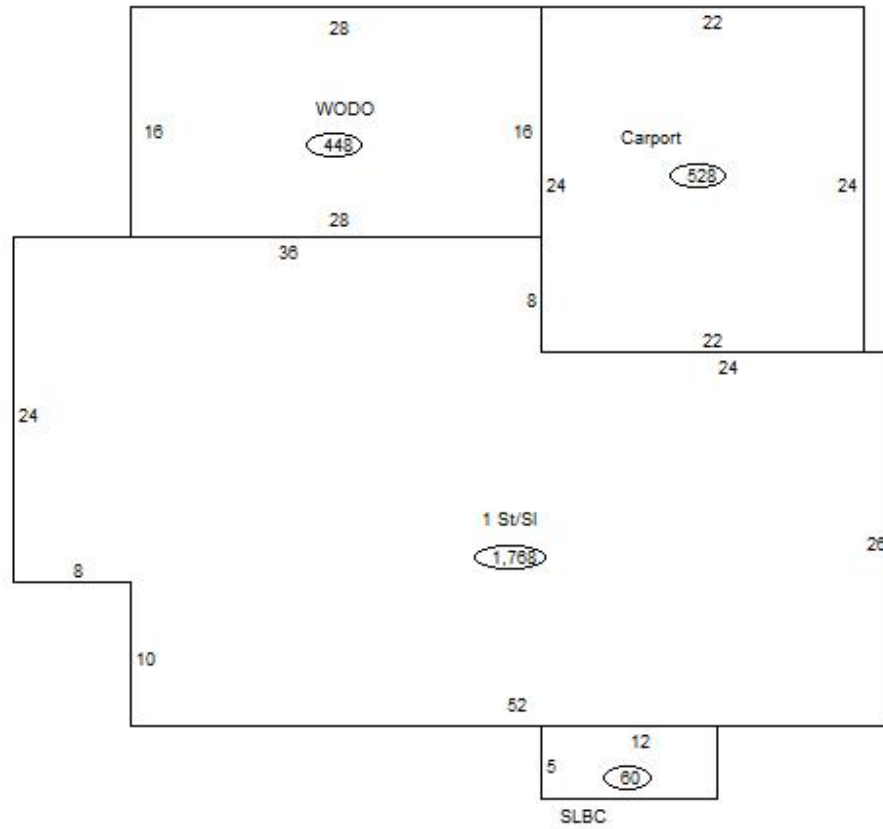

### Sketch Vector Information

Sequence	Code	Type	Built Over	Scale	Section Label	Base Area	Multiplier	Total Area
1	R	1	Slab	13	1 St/SI	1,768	1.000	1,768
2	G	4		13	Carport	528	1.000	528
3	M	WODO		13	WODO	448	1.000	448
4	M	PRCH		13	SLBC	60	1.000	60
<b>Total Building Area</b>						<b>1,768</b>		<b>1,768</b>



# Rogers

## Assessment Property Record Card for Tax Year 2026

Data provided by LISA DELOZIER County Assessor

Date 04/17/2026  
 Time 05:06:58  
 Page 4

660001647

### Outbuildings/Site Improvements

Building Image	Code	Description	Dimensions	Floor	Roofing	Total Units
	BNGP	Barn - General Purpose	30x40x10	Concrete	Formed Metal	1,200
	Qual 3	Cond 3	Year 2023	Eff Age 2		
<b>Valuation Summary</b>		<b>Modifier Total</b>	<b>RCN</b>	<b>Depr (3% Phys/ % Func)</b>		<b>RCNLD</b>
Base Cost (26.95 x 1,200)		32,340		32,340	970	31,370
	SHDS	SHED	10x16x8	Plank	Formed Metal	160
	Qual 2	Cond 2	Year 2015	Eff Age 11		
<b>Valuation Summary</b>		<b>Modifier Total</b>	<b>RCN</b>	<b>Depr (100% Phys/ % Func)</b>		<b>RCNLD</b>
Base Cost (19.51 x 160)		3,122		3,122	3,122	
	SHDS	Shed - Small	12x10x8	Plank	Composition Shingle	120
	Qual 2	Cond 2	Year 2015	Eff Age 11		
<b>Valuation Summary</b>		<b>Modifier Total</b>	<b>RCN</b>	<b>Depr (100% Phys/ % Func)</b>		<b>RCNLD</b>
Base Cost (21.77 x 120)		2,612		2,612	2,612	
	CPDT	CARPORT - DETACHED	22x28x8	Concrete	Formed Metal	616
	Qual 3	Cond 3	Year 2010	Eff Age 12		
<b>Valuation Summary</b>		<b>Modifier Total</b>	<b>RCN</b>	<b>Depr (52% Phys/ % Func)</b>		<b>RCNLD</b>
Base Cost (8.70 x 616)		5,359		5,359	2,787	2,572
	SHDS	Shed - Small	12x16x8	Plank	Formed Metal	192
	Qual 2	Cond 2	Year 2000	Eff Age 26		
<b>Valuation Summary</b>		<b>Modifier Total</b>	<b>RCN</b>	<b>Depr (70% Phys/ % Func)</b>		<b>RCNLD</b>
Base Cost (19.66 x 192)		3,775		3,775	2,643	1,132



# Rogers

## Assessment Property Record Card for Tax Year 2026

Data provided by LISA DELOZIER County Assessor

Date 04/17/2026  
Time 05:06:58  
Page 5

### Agland Inventory

660001647

Soi	Description	Land Use	LPI	Adj Type	Adj Code	Acres	Use/Acre	Mkt/Acre	Use Value	Market Value
DNB	DENNIS SILT LOAM 1-3% SLO	NTV PST	80			20.000	192	192	3,840	3,840
<b>NTV PST Totals</b>						20.000			3,840	3,840
<b>Total Agland</b>						20.000			3,840	3,840