



Rogers

Assessment Property Record Card for Tax Year 2026

Data provided by LISA DELOZIER County Assessor

Date 04/17/2026
Time 03:18:00
Page 1

Assessment Data					Primary Image																																																																																																																				
Account 660001660 Parcel ID 22N17E-02-4-00000-000-0000 Cadastral ID 02-22-17-02900 Property Type REAL - Real Property Property Class RR VI Area 2 Tax Area 71 - CHELSEA RURAL/FOYIL FIRE Name ID 86654 NICKERSON, SUZANNA 13801 S 4239 RD CLAREMORE OK 74017-0000 Parcel Location Situs 13801 S 4239 RD Subdivision Lot/Block / Parcel Size 3.42 - Acres Sec/Twn/Rng 2 / 22 / 17 / 4 Neighborhood 4070 - FOYIL SEQUOYAH AREA School District S003 - CHELSEA SCHOOLS																																																																																																																									
Legal Description Lat/Long: 36.41183903 -95.45417031																																																																																																																									
Building Permits					<table border="1"> <thead> <tr> <th>Number</th> <th>Description</th> <th>Opened</th> <th>Closed</th> <th>Amount</th> </tr> </thead> <tbody> <tr> <td>R8</td> <td>R8-NICKERSON OWNS `07 DWIDE</td> <td>07/2007</td> <td>11/2007</td> <td></td> </tr> </tbody> </table>					Number	Description	Opened	Closed	Amount	R8	R8-NICKERSON OWNS `07 DWIDE	07/2007	11/2007																																																																																																							
Number	Description	Opened	Closed	Amount																																																																																																																					
R8	R8-NICKERSON OWNS `07 DWIDE	07/2007	11/2007																																																																																																																						
Exemptions					Sale History																																																																																																																				
<table border="1"> <thead> <tr> <th>Code</th> <th>Type</th> <th>Active</th> <th>Maximum</th> <th>Exemption</th> </tr> </thead> <tbody> <tr> <td>H</td> <td>Homestead</td> <td>Yes</td> <td>1,000</td> <td>1,000</td> </tr> </tbody> </table>					Code	Type	Active	Maximum	Exemption	H	Homestead	Yes	1,000	1,000	<table border="1"> <thead> <tr> <th>Bk/Pg</th> <th>Grantor</th> <th>Date</th> <th>Price</th> <th>Code</th> </tr> </thead> <tbody> <tr> <td>964/123</td> <td>ALLISON, EVELYN</td> <td>08/01/1994</td> <td>18,000</td> <td>Yes</td> </tr> </tbody> </table>					Bk/Pg	Grantor	Date	Price	Code	964/123	ALLISON, EVELYN	08/01/1994	18,000	Yes																																																																																												
Code	Type	Active	Maximum	Exemption																																																																																																																					
H	Homestead	Yes	1,000	1,000																																																																																																																					
Bk/Pg	Grantor	Date	Price	Code																																																																																																																					
964/123	ALLISON, EVELYN	08/01/1994	18,000	Yes																																																																																																																					
Parcel Valuation																																																																																																																									
<table border="1"> <thead> <tr> <th>Source</th> <th>REAL</th> <th>Fair Cash</th> <th>Capped</th> <th>Asmnt Level</th> <th>Assessed</th> <th>Levy Rate</th> <th>95.740</th> <th>Current Tax</th> </tr> </thead> <tbody> <tr> <td>Remove Cap</td> <td>0</td> <td>Land Value 58,985</td> <td>51,784</td> <td>11%</td> <td>5,696</td> <td>Assessed</td> <td>13,540</td> <td>1,296.32</td> </tr> <tr> <td>Year Frozen</td> <td>0</td> <td>Improvements 7,624</td> <td>7,624</td> <td></td> <td>839</td> <td>Penalty</td> <td>0</td> <td></td> </tr> <tr> <td>Uncapped Value</td> <td>0</td> <td>Mobile Home 63,679</td> <td>63,679</td> <td></td> <td>7,005</td> <td>Exemption</td> <td>1,000</td> <td>-82.00</td> </tr> <tr> <td>TIF Project ID</td> <td>0</td> <td>Total Value 130,288</td> <td>123,087</td> <td></td> <td>13,540</td> <td>Total Taxable</td> <td>12,540</td> <td>1,214.00</td> </tr> </tbody> </table>		Source	REAL	Fair Cash	Capped	Asmnt Level	Assessed	Levy Rate	95.740	Current Tax	Remove Cap	0	Land Value 58,985	51,784	11%	5,696	Assessed	13,540	1,296.32	Year Frozen	0	Improvements 7,624	7,624		839	Penalty	0		Uncapped Value	0	Mobile Home 63,679	63,679		7,005	Exemption	1,000	-82.00	TIF Project ID	0	Total Value 130,288	123,087		13,540	Total Taxable	12,540	1,214.00																																																																											
Source	REAL	Fair Cash	Capped	Asmnt Level	Assessed	Levy Rate	95.740	Current Tax																																																																																																																	
Remove Cap	0	Land Value 58,985	51,784	11%	5,696	Assessed	13,540	1,296.32																																																																																																																	
Year Frozen	0	Improvements 7,624	7,624		839	Penalty	0																																																																																																																		
Uncapped Value	0	Mobile Home 63,679	63,679		7,005	Exemption	1,000	-82.00																																																																																																																	
TIF Project ID	0	Total Value 130,288	123,087		13,540	Total Taxable	12,540	1,214.00																																																																																																																	
Assessment History																																																																																																																									
<table border="1"> <thead> <tr> <th>Tax Year</th> <th>Statement Number</th> <th>Billed Owner</th> <th>Tax Area</th> <th>Total Value</th> <th>Exemptions</th> <th>Taxable Value</th> <th>Billed Tax</th> </tr> </thead> <tbody> <tr><td>2025</td><td>2025-660001660</td><td>NICKERSON, SUZANNA</td><td>71</td><td>132,546</td><td>1000</td><td>12,146</td><td>1,176.00</td></tr> <tr><td>2024</td><td>2024-660001660</td><td>NICKERSON, SUZANNA</td><td>71</td><td>136,361</td><td>1000</td><td>11,763</td><td>1,161.00</td></tr> <tr><td>2023</td><td>2023-660001660</td><td>NICKERSON, KINNITH F JR &</td><td>71</td><td>122,018</td><td>1000</td><td>11,391</td><td>1,137.00</td></tr> <tr><td>2022</td><td>2022-660001660</td><td>NICKERSON, KINNITH F JR &</td><td>71</td><td>116,562</td><td>1000</td><td>11,030</td><td>1,107.00</td></tr> <tr><td>2021</td><td>2021-660001660</td><td>NICKERSON, KINNITH F JR &</td><td>71</td><td>117,861</td><td>1000</td><td>10,679</td><td>1,081.00</td></tr> <tr><td>2020</td><td>2020-660001660</td><td>NICKERSON, KINNITH F JR &</td><td>71</td><td>108,756</td><td>1000</td><td>10,340</td><td>1,059.00</td></tr> <tr><td>2019</td><td>2019-660001660</td><td>NICKERSON, KINNITH F JR &</td><td>71</td><td>100,083</td><td>1000</td><td>10,009</td><td>1,042.00</td></tr> <tr><td>2018</td><td>2018-660001660</td><td>NICKERSON, KINNITH F JR &</td><td>71</td><td>102,996</td><td>1000</td><td>10,329</td><td>1,064.00</td></tr> <tr><td>2017</td><td>2017-660001660</td><td>NICKERSON, KINNITH F JR &</td><td>71</td><td>102,149</td><td>1000</td><td>10,209</td><td>1,062.00</td></tr> <tr><td>2016</td><td>2016-660001660</td><td>NICKERSON, KINNITH F JR &</td><td>71</td><td>104,419</td><td>1000</td><td>9,883</td><td>1,045.00</td></tr> <tr><td>2015</td><td>2015-660001660</td><td>NICKERSON, KINNITH F JR &</td><td>71</td><td>96,049</td><td>1000</td><td>9,565</td><td>1,000.00</td></tr> <tr><td>2014</td><td>2014-660001660</td><td>NICKERSON, KINNITH F JR &</td><td>71</td><td>93,373</td><td>1000</td><td>9,271</td><td>1,000.00</td></tr> <tr><td>2013</td><td>2013-660001660</td><td>NICKERSON, KINNITH F JR &</td><td>71</td><td>93,373</td><td>1000</td><td>9,271</td><td>986.00</td></tr> </tbody> </table>										Tax Year	Statement Number	Billed Owner	Tax Area	Total Value	Exemptions	Taxable Value	Billed Tax	2025	2025-660001660	NICKERSON, SUZANNA	71	132,546	1000	12,146	1,176.00	2024	2024-660001660	NICKERSON, SUZANNA	71	136,361	1000	11,763	1,161.00	2023	2023-660001660	NICKERSON, KINNITH F JR &	71	122,018	1000	11,391	1,137.00	2022	2022-660001660	NICKERSON, KINNITH F JR &	71	116,562	1000	11,030	1,107.00	2021	2021-660001660	NICKERSON, KINNITH F JR &	71	117,861	1000	10,679	1,081.00	2020	2020-660001660	NICKERSON, KINNITH F JR &	71	108,756	1000	10,340	1,059.00	2019	2019-660001660	NICKERSON, KINNITH F JR &	71	100,083	1000	10,009	1,042.00	2018	2018-660001660	NICKERSON, KINNITH F JR &	71	102,996	1000	10,329	1,064.00	2017	2017-660001660	NICKERSON, KINNITH F JR &	71	102,149	1000	10,209	1,062.00	2016	2016-660001660	NICKERSON, KINNITH F JR &	71	104,419	1000	9,883	1,045.00	2015	2015-660001660	NICKERSON, KINNITH F JR &	71	96,049	1000	9,565	1,000.00	2014	2014-660001660	NICKERSON, KINNITH F JR &	71	93,373	1000	9,271	1,000.00	2013	2013-660001660	NICKERSON, KINNITH F JR &	71	93,373	1000	9,271	986.00
Tax Year	Statement Number	Billed Owner	Tax Area	Total Value	Exemptions	Taxable Value	Billed Tax																																																																																																																		
2025	2025-660001660	NICKERSON, SUZANNA	71	132,546	1000	12,146	1,176.00																																																																																																																		
2024	2024-660001660	NICKERSON, SUZANNA	71	136,361	1000	11,763	1,161.00																																																																																																																		
2023	2023-660001660	NICKERSON, KINNITH F JR &	71	122,018	1000	11,391	1,137.00																																																																																																																		
2022	2022-660001660	NICKERSON, KINNITH F JR &	71	116,562	1000	11,030	1,107.00																																																																																																																		
2021	2021-660001660	NICKERSON, KINNITH F JR &	71	117,861	1000	10,679	1,081.00																																																																																																																		
2020	2020-660001660	NICKERSON, KINNITH F JR &	71	108,756	1000	10,340	1,059.00																																																																																																																		
2019	2019-660001660	NICKERSON, KINNITH F JR &	71	100,083	1000	10,009	1,042.00																																																																																																																		
2018	2018-660001660	NICKERSON, KINNITH F JR &	71	102,996	1000	10,329	1,064.00																																																																																																																		
2017	2017-660001660	NICKERSON, KINNITH F JR &	71	102,149	1000	10,209	1,062.00																																																																																																																		
2016	2016-660001660	NICKERSON, KINNITH F JR &	71	104,419	1000	9,883	1,045.00																																																																																																																		
2015	2015-660001660	NICKERSON, KINNITH F JR &	71	96,049	1000	9,565	1,000.00																																																																																																																		
2014	2014-660001660	NICKERSON, KINNITH F JR &	71	93,373	1000	9,271	1,000.00																																																																																																																		
2013	2013-660001660	NICKERSON, KINNITH F JR &	71	93,373	1000	9,271	986.00																																																																																																																		



Rogers

Assessment Property Record Card for Tax Year 2026

Data provided by LISA DELOZIER County Assessor

Date 04/17/2026
 Time 03:18:00
 Page 2

Lot Data	Square-Foot - NBHD 4070 #1	Primary Image
Lot Size		
Lot Count		
Units Buildable	3.42	
Non-Ag Acres	3.4164	
Topography		
Street Access		
Utilities		
Amenities	LAND QUALITY	
	0	
	0	
Method	Square-Foot	
Base Lot Value	148,820.00 x .40 = 58,985	
Factor Value		
Adjustments	1.0000	
Lot Value	58,985	

Residential Data	
Type	
Condition	-
Quality	-
Architecture	
Style	
Exterior Wall	
Base/Total Area	/
Style	
HVAC	
Roof Cover	
Area on Slab	
Fixture/RghIn	/
Bed/F/H Bath	//
Basement Area	
Garage Type	
Remodel	
Year/Eff Age	/

\\tsclient\TCASEY\CASEY BOOTH VISUAL INSPECTION\2020-9- 9/23/2020

GRM Approach	
GRM Code	
Gross Rent	0.00
Indicated Value	

Multiple Regression	
MRA Code	
Adjusted R	
Indicated Value	

Direct Comparables	
Selection Model	1 Res
Adjustment Model	A2 AO Test
Comparables	
Indicated Value	

Cost Approach				Manual : 01/2025			
Base Cost	0.00	Total Misc Impr	+	0			
Roofing Adj	+ 0.00	Garage Cost	+				
Subfloor Adj	+ 0.00	Total RCN	=	0			
Heat/Cool Adj	+ 0.00	Depreciation (0%)	-	0			
Plumbing Adj	+ 0.00	Lump Sums	+	0			
Basement Adj	+ 0.00	RCNLD	=				
Adj Base Cost	= 0.00	Lot Value	+	58,985			
Total Area	x	Indicated Value	=	58,985			
Adjusted Cost	= 0	Value Per SqFt		0.00			

Value Reconciliation			
Selected Approach	Cost Approach		
Improvements			
Lot Value	58,985		
Indicated Value	58,985	0.00	Per SqFt
Agland Value			
Site Improvements			
Total Value	58,985	0.00	Total Value Per SqFt

Miscellaneous Improvements								
Code	Description	Sketch ID	Size	Year	Units	Unit Cost	Depr	Value



Rogers

Assessment Property Record Card for Tax Year 2026

Data provided by LISA DELOZIER County Assessor

Date 04/17/2026
Time 03:18:00
Page 3

660001660

Outbuildings/Site Improvements

Building Image	Code	Description	Dimensions	Floor	Roofing	Total Units
	SHDS SHED		8x10x8	Plank	Formed Metal	80
	Qual 2	Cond 2	Year 2000	Eff Age 26		
Valuation Summary		Modifier Total	RCN	Depr (100% Phys/ % Func)		RCNLD
Base Cost (24.71 x 80)		1,977		1,977	1,977	
SHDS Shed - Small			10x8x8	Concrete	Composition Shingle	80
Qual 3	Cond 2	Year 2000	Eff Age 26			
Valuation Summary		Modifier Total	RCN	Depr (100% Phys/ % Func)		RCNLD
Base Cost (28.49 x 80)		2,279		2,279	2,279	



Rogers

Assessment Property Record Card for Tax Year 2026

Data provided by LISA DELOZIER County Assessor

Date 04/17/2026
 Time 03:18:01
 Page 4

Lot Data	
Lot Size	-
Lot Count	
Units Buildable	
Non-Ag Acres	
Topography	
Street Access	
Utilities	
Amenities	LAND QUALITY
Method	
Base Lot Value	
Factor Value	
Adjustments	
Lot Value	



Residential Data	
Type	6 Mobile Home 60 x 31
Condition	4 - Good
Quality	4.5 - Good
Architecture	6 MS ADJ
Style	100% Double Wide
Exterior Wall	100% Frame, Siding, Vinyl
Base/Total Area	1,860 / 1,860
Style	100% Double Wide
HVAC	100% Warmed & Cooled Air
Roof Cover	1 Composition Shingle
Area on Slab	0
Fixture/RghIn	/
Bed/F/H Bath	3 / 2.0 /
Basement Area	
Garage Type	
Remodel	
Year/Eff Age	2007 / 11

GRM Approach	
GRM Code	
Gross Rent	0.00
Indicated Value	

Multiple Regression	
MRA Code	
Adusted R	
Indicated Value	

Direct Comparables	
Selection Model	1 Res
Adjustment Model	A2 AO Test
Comparables	
Indicated Value	

Cost Approach				Manual : 01/2025	
Base Cost	41.34	Total Misc Impr	+	0	
Roofing Adj	+ 3.75	Garage Cost	+		
Subfloor Adj	+ 0.00	Total RCN	=	106,132	
Heat/Cool Adj	+ 3.47	Depreciation (40%)	-	42,453	
Plumbing Adj	+ 8.50	Lump Sums	+	7,624	
Basement Adj	+ 0.00	RCNLD	=	71,303	
Adj Base Cost	= 57.06	Lot Value	+		
Total Area	x 1,860	Indicated Value	=	71,303	
Adjusted Cost	= 106,132	Value Per SqFt		38.33	

Value Reconciliation			
Selected Approach	Cost Approach		
Improvements	71,303		
Lot Value			
Indicated Value	71,303	38.33	Per SqFt
Agland Value			
Site Improvements			
Total Value	71,303	38.33	Total Value Per SqFt

Miscellaneous Improvements								
Code	Description	Sketch ID	Size	Year	Units	Unit Cost	Depr	Value
WODC	Wood Deck - Covered	163311	16x8		128	59.56		7,624
WODO	Wood Deck - Open	163312	10x8		80	37.27	100%	



Rogers

Assessment Property Record Card for Tax Year 2026

Data provided by LISA DELOZIER County Assessor

Date 04/17/2026
Time 03:18:01
Page 5

Sketch Image

660001660

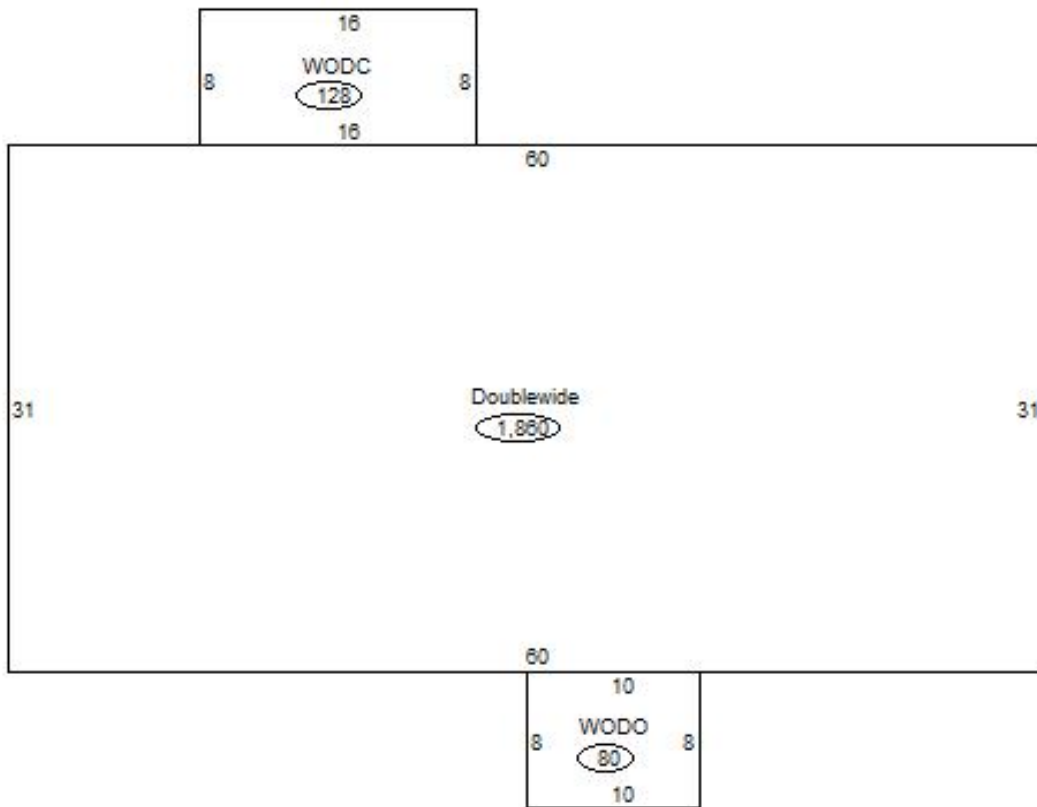

Sketch Vector Information

Sequence	Code	Type	Built Over	Scale	Section Label	Base Area	Multiplier	Total Area
1	R	14		13	Doublewide	1,860	1.000	1,860
2	M	WODC		13	WODC	128	1.000	128
3	M	WODO		13	WODO	80	1.000	80
Total Building Area						1,860		1,860