



Rogers

Assessment Property Record Card for Tax Year 2026

Data provided by LISA DELOZIER County Assessor

Date 04/17/2026
Time 05:06:26
Page 1

Assessment Data					Primary Image				
Account	660001797				<p>\\tsclient\C\Users\Randy Necessary\Pictures\101_0924\IMG_0045. 9/24/2021</p>				
Parcel ID	000000-00-0-00960-001-0004								
Cadastral ID	03-19-16-01700								
Property Type	REAL - Real Property								
Property Class	RRP	VI Area	3						
Tax Area	2 - INOLA RURAL								
Name ID	167994								
ANTHONY, JOYCE A									
13754 E 590 RD									
INOLA OK 74036-0000									
Parcel Location									
Situs	13754 E 590 RD								
Subdivision	YEAGERS SUNNY SLOPE II								
Lot/Block	0004 / 0001	Parcel Size	1 - Lots						
Sec/Twn/Rng	3 / 19 / 16 / 5								
Neighborhood	1057 - R-V03-SE INOLA								
School District	S005 - INOLA SCHOOLS								
Legal Description									
Lat/Long: 36.16191620 -95.58635094									
LOT 4 BLOCK 1 YEAGERS SUNNY SLOPE 2									
Building Permits									
Number	Description	Opened	Closed	Amount					
Exemptions									
Code	Type	Active	Maximum	Exemption					
H	Homestead	Yes	1,000	1,000					
Sale History									
Bk/Pg	Grantor	Date	Price	Code					
2625/585	PIERCE, SAMUEL PAUL	04/06/2017	0	WB					
1588/279	PIERCE, RUBY I	05/14/2004	0	4					
Parcel Valuation									
Source	REAL	Fair Cash	Capped	Asmnt Level	Assessed	Levy Rate	80.060	Current Tax	
Remove Cap	0	Land Value	27,364	20,585	11%	2,264	Assessed	15,585 1,247.74	
Year Frozen	0	Improvements	150,573	121,096		13,321	Penalty	0	
Uncapped Value	0	Mobile Home	0	0		0	Exemption	1,000 -80.00	
TIF Project ID	0	Total Value	177,937	141,681		15,585	Total Taxable	14,585 1,168.00	
Assessment History									
Tax Year	Statement Number	Billed Owner	Tax Area	Total Value	Exemptions	Taxable Value	Billed Tax		
2025	2025-660001797	ANTHONY, JOYCE A	2	144,934	1000	14,130	1,131.00		
2024	2024-660001797	ANTHONY, JOYCE A	2	152,876	1000	13,691	1,101.00		
2023	2023-660001797	ANTHONY, JOYCE A	2	129,661	1000	13,263	1,068.00		
2022	2022-660001797	ANTHONY, JOYCE A	2	127,776	0	14,055	1,140.00		
2021	2021-660001797	ANTHONY, JOYCE A	2	135,816	0	14,940	1,197.00		
2020	2020-660001797	ANTHONY, JOYCE A	2	133,506	0	14,686	1,186.00		
2019	2019-660001797	ANTHONY, JOYCE A	2	130,923	0	14,402	1,190.00		
2018	2018-660001797	ANTHONY, JOYCE A	2	136,691	0	13,766	1,149.00		
2017	2017-660001797	ANTHONY, JOYCE A	2	135,466	0	13,110	1,103.00		
2016	2016-660001797	PIERCE, SAMUEL PAUL	2	131,900	0	12,485	1,062.00		
2015	2015-660001797	PIERCE, SAMUEL PAUL	2	130,788	0	11,892	1,032.00		
2014	2014-660001797	PIERCE, SAMUEL PAUL	2	131,905	0	11,325	1,017.00		
2013	2013-660001797	PIERCE, SAMUEL PAUL	2	115,073	0	10,786	908.00		



Rogers

Assessment Property Record Card for Tax Year 2026

Data provided by LISA DELOZIER County Assessor

Date 04/17/2026
Time 05:06:27
Page 2

Lot Data	Square-Foot - NBHD 1057 #1	Primary Image
Lot Size		
Lot Count		
Units Buildable	1	
Non-Ag Acres	1.5128	
Topography		
Street Access		
Utilities		
Amenities	LAND QUALITY	
	0	
	0	
Method	Square-Foot	
Base Lot Value	65,897.00 x .42 = 27,364	
Factor Value		
Adjustments	1.0000	
Lot Value	27,364	

Residential Data	
Type	1 Single Family Residence
Condition	3 - Average
Quality	3 - Average
Architecture	TRAD TRADITIONAL
Style	100% One Story
Exterior Wall	90% Veneer, Masonry 10% Frame, Siding, Wood
Base/Total Area	1,913 / 1,913
Style	100% One Story
HVAC	100% Warmed & Cooled Air
Roof Cover	1 Composition Shingle
Area on Slab	1,913
Fixture/RghIn	8 /
Bed/F/H Bath	3 / 2.0 /
Basement Area	
Garage Type	557 Attached Garage - Finished
Remodel	
Year/Eff Age	1973 / 40



\\tsclient\C\Users\Randy Necessary\Pictures\101_0924\IMG_0045. 9/24/2021

GRM Approach	
GRM Code	
Gross Rent	0.00
Indicated Value	

Multiple Regression			
MRA Code	1	Test	
Adusted R	0.8445		
Indicated Value	210,924	110.26	Per SqFt

Direct Comparables	
Selection Model	A Adam Test
Adjustment Model	1 2022 Residential
Comparables	2
Indicated Value	188,460 Per SqFt

Cost Approach				Manual : 01/2025			
Base Cost	105.21	Total Misc Impr	+	15,950			
Roofing Adj	+ 4.64	Garage Cost	+	21,717			
Subfloor Adj	+ -2.43	Total RCN	=	278,839			
Heat/Cool Adj	+ 12.64	Depreciation (46%)	-	128,266			
Plumbing Adj	+ 6.01	Lump Sums	+	0			
Basement Adj	+ 0.00	RCNLD	=	150,573			
Adj Base Cost	= 126.07	Lot Value	+	27,364			
Total Area	x 1,913	Indicated Value	=	177,937			
Adjusted Cost	= 241,172	Value Per SqFt		93.01			

Value Reconciliation			
Selected Approach	Cost Approach		
Improvements	150,573		
Lot Value	27,364		
Indicated Value	177,937	93.01	Per SqFt
Agland Value			
Site Improvements			
Total Value	177,937	93.01	Total Value Per SqFt

Miscellaneous Improvements								
Code	Description	Sketch ID	Size	Year	Units	Unit Cost	Depr	Value
FPR1	FIREPLACE - RESIDENTIAL 1 STORY	0		1	1	5,615.40		5,615
PRCH	SLAB PORCH - COVERED	4650		180	180	26.36		4,745
PATO	SLAB PORCH - OPEN	4651	65x10		650	8.60		5,590



Rogers
Assessment Property Record Card for Tax Year 2026

Data provided by LISA DELOZIER County Assessor

Date 04/17/2026
 Time 05:06:27
 Page 3

Sketch Image

660001797

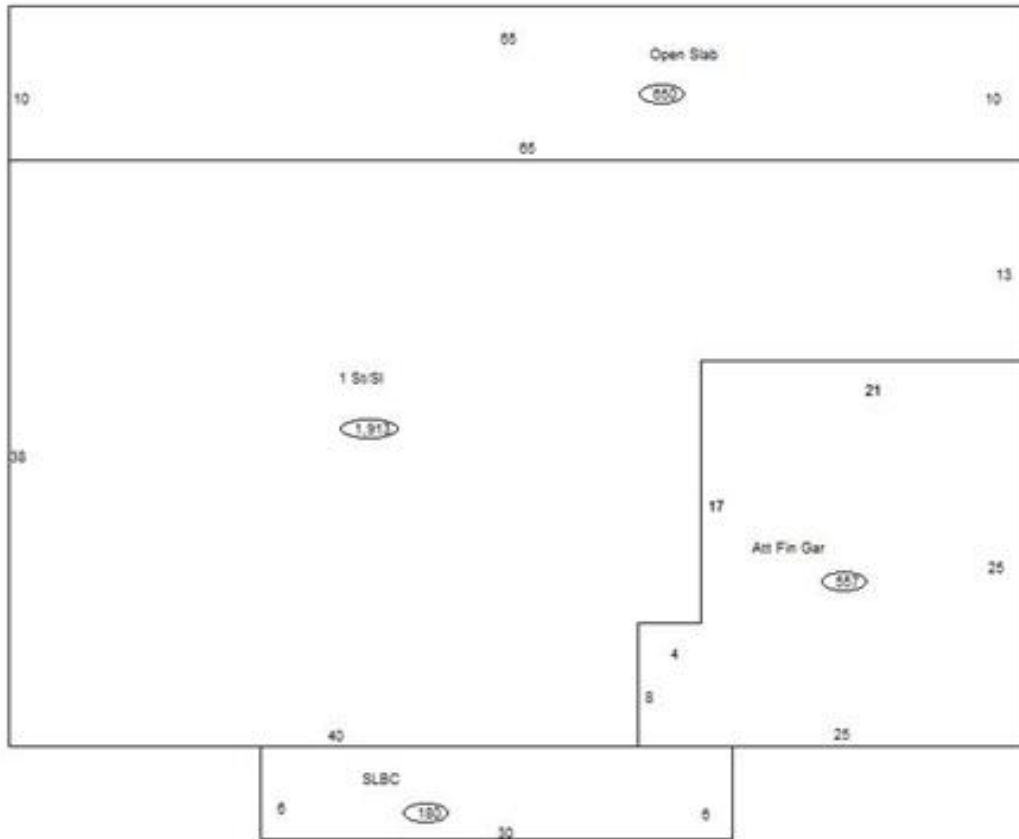

Sketch Vector Information

Sequence	Code	Type	Built Over	Scale	Section Label	Base Area	Multiplier	Total Area
1	R	1	Slab	10	1 St/SI	1,913	1.000	1,913
2	G	5		10	Att Fin Gar	557	1.000	557
3	M	PRCH		10	SLBC	180	1.000	180
4	M	PATO		10	Open Slab	650	1.000	650
Total Building Area						1,913		1,913