



Rogers

Assessment Property Record Card for Tax Year 2026

Data provided by LISA DELOZIER County Assessor

Date 04/17/2026
Time 03:18:36
Page 1

Assessment Data					Primary Image				
Account	660001805				 <p>\\tsclient\C\Users\Randy Necessary\Pictures\101_0927\IMG_0048. 9/27/2021</p>				
Parcel ID	000000-00-0-00960-001-0011								
Cadastral ID	03-19-16-01770								
Property Type	REAL - Real Property								
Property Class	RRP	VI Area	3						
Tax Area	2 - INOLA RURAL								
Name ID	310244								
RODGERS, GARY & HANNAH									
13652 E YEAGERS WAY INOLA OK 74036-0000									
Parcel Location									
Situs	13652 E YEAGERS WAY								
Subdivision	YEAGERS SUNNY SLOPE II								
Lot/Block	0011 / 0001	Parcel Size	1 - Lots						
Sec/Twn/Rng	3 / 19 / 16 / 5								
Neighborhood	1057 - R-V03-SE INOLA								
School District	S005 - INOLA SCHOOLS								
Legal Description Lat/Long: 36.16095633 -95.59018906									
Building Permits									
LOT 11 BLOCK 1 YEAGERS SUNNY SLOPE 2									
Number	Description	Opened	Closed	Amount					
5633	NEW HOUSE	06/1999	05/2000						
Exemptions									
Code	Type	Active	Maximum	Exemption					
H	Homestead	No	1,000						
Sale History									
Bk/Pg	Grantor	Date	Price	Code					
2344/563	STOUT, DEBRA DEANNE	07/18/2013	150,000	YES					
1754/300	MORTGAGE CLEARING CORP	02/28/2006	98,000	YES					
1690/625	THACKER, CHESTER CLINTON &	06/14/2005	0	16					
1151/863	LEMAR HOMES INC	01/15/1999	8,000	Yes					
1112/357	MCGINNIS, HERBERT G &	04/23/1998	4,000	No					
519/170	VANHOSEN, RICHARD	06/24/1977	2,566	No					
Parcel Valuation									
Source	REAL	Fair Cash	Capped	Asmnt Level	Assessed	Levy Rate	80.060	Current Tax	
Remove Cap	2014	Land Value	26,134	26,134	11%	2,875	Assessed	23,316 1,866.68	
Year Frozen	0	Improvements	197,804	185,831		20,441	Penalty	0	
Uncapped Value	0	Mobile Home	0	0		0	Exemption	0 0.00	
TIF Project ID	0	Total Value	223,938	211,965		23,316	Total Taxable	23,316 1,867.00	
Assessment History									
Tax Year	Statement Number	Billed Owner	Tax Area	Total Value	Exemptions	Taxable Value	Billed Tax		
2025	2025-660001805	RODGERS, GARY & HANNAH	2	201,872	0	22,206	1,778.00		
2024	2024-660001805	RODGERS, GARY & HANNAH	2	214,407	0	21,448	1,725.00		
2023	2023-660001805	RODGERS, GARY & HANNAH	2	186,914	0	20,426	1,645.00		
2022	2022-660001805	RODGERS, GARY & HANNAH	2	183,073	0	19,454	1,578.00		
2021	2021-660001805	RODGERS, GARY & HANNAH	2	168,431	0	18,527	1,485.00		
2020	2020-660001805	RODGERS, GARY & HANNAH	2	168,613	0	18,452	1,491.00		
2019	2019-660001805	RODGERS, GARY & HANNAH	2	159,757	0	17,573	1,452.00		
2018	2018-660001805	RODGERS, GARY & HANNAH	2	164,738	0	18,121	1,513.00		
2017	2017-660001805	RODGERS, GARY & HANNAH	2	158,359	0	17,419	1,466.00		
2016	2016-660001805	RODGERS, GARY & HANNAH	2	154,208	0	16,963	1,443.00		
2015	2015-660001805	RODGERS, GARY & HANNAH	2	149,045	0	16,395	1,423.00		
2014	2014-660001805	RODGERS, GARY & HANNAH	2	150,355	0	16,539	1,485.00		
2013	2013-660001805	RODGERS, GARY & HANNAH	2	137,407	1000	13,995	1,179.00		



Rogers

Assessment Property Record Card for Tax Year 2026

Data provided by LISA DELOZIER County Assessor

Date 04/17/2026
Time 03:18:36
Page 2

Lot Data		Square-Foot - NBHD 1057 #1		Primary Image				
Lot Size						\\tsclient\C\Users\Randy Necessary\Pictures\101_0927\IMG_0048. 9/27/2021		
Lot Count								
Units Buildable	1							
Non-Ag Acres	1.3998							
Topography								
Street Access								
Utilities								
Amenities	LAND QUALITY							0
								0
Method	Square-Foot							
Base Lot Value	60,975.00 x .43 = 26,134							
Factor Value								
Adjustments	1.0000							
Lot Value	26,134							
Residential Data				GRM Approach				
Type	1 Single Family Residence			GRM Code				
Condition	3 - Average			Gross Rent	0.00			
Quality	3 - Average			Indicated Value				
Architecture	TRAD TRADITIONAL			Multiple Regression				
Style	100% One Story			MRA Code	1 Test			
Exterior Wall	100% Veneer, Masonry			Adusted R	0.8445			
Base/Total Area	1,919 / 1,919			Indicated Value	194,666	101.44	Per SqFt	
Style	100% One Story			Direct Comparables				
HVAC	100% Warmed & Cooled Air			Selection Model	A Adam Test			
Roof Cover	1 Composition Shingle			Adjustment Model	1 2022 Residential			
Area on Slab	1,919			Comparables				
Fixture/RghIn	11 /			Indicated Value				
Bed/F/H Bath	3 / 2.0 /			Value Reconciliation				
Basement Area				Selected Approach	Cost Approach			
Garage Type				Improvements	191,564			
Remodel				Lot Value	26,134			
Year/Eff Age	1999 / 20			Indicated Value	217,698	113.44	Per SqFt	
Cost Approach		Manual : 01/2025		Agland Value				
Base Cost	103.09	Total Misc Impr	+ 1,072	Site Improvements	6,240			
Roofing Adj	+ 4.50	Garage Cost	+ 1,072	Total Value	223,938	116.70	Total Value Per SqFt	
Subfloor Adj	+ -2.14	Total RCN	= 243,211					
Heat/Cool Adj	+ 12.64	Depreciation (23%)	- 55,939					
Plumbing Adj	+ 8.09	Lump Sums	+ 4,292					
Basement Adj	+ 0.00	RCNLD	= 191,564					
Adj Base Cost	= 126.18	Lot Value	+ 26,134					
Total Area	x 1,919	Indicated Value	= 217,698					
Adjusted Cost	= 242,139	Value Per SqFt	113.44					
Miscellaneous Improvements								
Code	Description	Sketch ID	Size	Year	Units	Unit Cost	Depr	Value
PRCH	SLAB PORCH - COVERED	4674	8x5		40	26.80		1,072
WODO	WOOD DECK - OPEN	4675	20x10		200	22.05	30%	3,087
WODO	Wood Deck - Open	153322	8x5		40	30.13		1,205



Rogers

Assessment Property Record Card for Tax Year 2026

Data provided by LISA DELOZIER County Assessor

Date 04/17/2026
 Time 03:18:36
 Page 3

Sketch Image

660001805

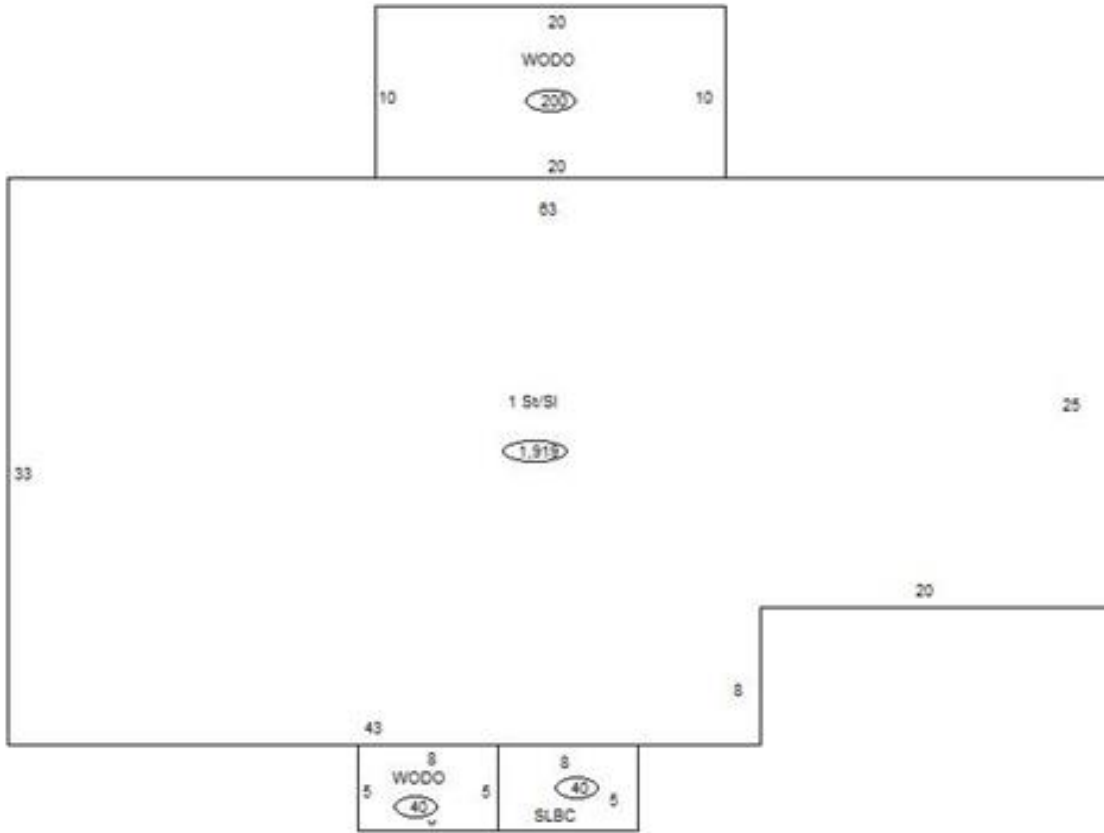

Sketch Vector Information

Sequence	Code	Type	Built Over	Scale	Section Label	Base Area	Multiplier	Total Area
1	R	1	Slab	10	1 St/Sl	1,919	1.000	1,919
2	M	PRCH		10	SLBC	40	1.000	40
3	M	WODO		10	WODO	200	1.000	200
4	M	WODO		10	WODO	40	1.000	40
Total Building Area						1,919		1,919



Rogers

Assessment Property Record Card for Tax Year 2026

Data provided by LISA DELOZIER County Assessor

Date 04/17/2026
Time 03:18:36
Page 4

660001805

Outbuildings/Site Improvements

Building Image	Code	Description	Dimensions	Floor	Roofing	Total Units
	CPDT	Carport - Detached	20x25x8	Concrete	Formed Metal	500
	Qual 3	Cond 3	Year 2010	Eff Age 12		

	Valuation Summary	Modifier Total	RCN	Depr (52% Phys/ % Func)	RCNLD
	Base Cost (9.09 x 500)	4,545		4,545	2,182

	SHDS	Shed - Small	24x20x8	Concrete	Composition Shingle	480
	Qual 4	Cond 3	Year 2000	Eff Age 20		

	Valuation Summary	Modifier Total	RCN	Depr (59% Phys/ % Func)	RCNLD
	Base Cost (20.62 x 480)	9,898		9,898	4,058