



Rogers

Assessment Property Record Card for Tax Year 2026

Data provided by LISA DELOZIER County Assessor

Date 04/17/2026
 Time 08:48:39
 Page 1

Assessment Data					Primary Image																																																	
Account 660001809 Parcel ID 000000-00-0-00960-001-0015 Cadastral ID 03-19-16-01810 Property Type REAL - Real Property Property Class RRP VI Area 3 Tax Area 2 - INOLA RURAL Name ID 300953 GREEN, BARRETT & RACHEAL 13752 E YEAGERS WAY INOLA OK 74036-0000 Parcel Location Situs 13752 E YEAGERS WAY Subdivision YEAGERS SUNNY SLOPE II Lot/Block 0015 / 0001 Parcel Size 1 - Lots Sec/Twn/Rng 3 / 19 / 16 / 5 Neighborhood 1057 - R-V03-SE INOLA School District S005 - INOLA SCHOOLS					<p>\\tsclient\C\Users\Randy Necessary\Pictures\101_0927\IMG_0034. 9/27/2021</p>																																																	
Legal Description Lat/Long: 36.16095901 -95.58762603																																																						
LOT 15 BLOCK 1 YEAGERS SUNNY SLOPE 2					Building Permits <table border="1"> <thead> <tr> <th>Number</th> <th>Description</th> <th>Opened</th> <th>Closed</th> <th>Amount</th> </tr> </thead> <tbody> <tr> <td> </td> <td> </td> <td> </td> <td> </td> <td> </td> </tr> </tbody> </table>					Number	Description	Opened	Closed	Amount																																								
Number	Description	Opened	Closed	Amount																																																		
Exemptions					Sale History																																																	
Code	Type	Active	Maximum	Exemption	Bk/Pg	Grantor	Date	Price	Code																																													
					2046/841	MCGHEE, MATTHEW A &	07/17/2009	123,000	YES																																													
					1115/711	RASH, WILLIAM CLAYTON	06/03/1998	83,500	Yes																																													
					889/890	LAMBERT, LINDA SUE	08/20/1992	40,000	Yes																																													
Parcel Valuation					<table border="1"> <thead> <tr> <th>Source</th> <th>REAL</th> <th>Fair Cash</th> <th>Capped</th> <th>Asmnt Level</th> <th>Assessed</th> <th>Levy Rate</th> <th>80.060</th> <th>Current Tax</th> </tr> </thead> <tbody> <tr> <td>Remove Cap</td> <td>2010</td> <td>Land Value 25,962</td> <td>25,962</td> <td>11%</td> <td>2,856</td> <td>Assessed</td> <td>15,775</td> <td>1,262.95</td> </tr> <tr> <td>Year Frozen</td> <td>0</td> <td>Improvements 144,206</td> <td>117,438</td> <td> </td> <td>12,919</td> <td>Penalty</td> <td>0</td> <td> </td> </tr> <tr> <td>Uncapped Value</td> <td>0</td> <td>Mobile Home 0</td> <td>0</td> <td> </td> <td>0</td> <td>Exemption</td> <td>0</td> <td>0.00</td> </tr> <tr> <td>TIF Project ID</td> <td>0</td> <td>Total Value 170,168</td> <td>143,400</td> <td> </td> <td>15,775</td> <td>Total Taxable</td> <td>15,775</td> <td>1,263.00</td> </tr> </tbody> </table>					Source	REAL	Fair Cash	Capped	Asmnt Level	Assessed	Levy Rate	80.060	Current Tax	Remove Cap	2010	Land Value 25,962	25,962	11%	2,856	Assessed	15,775	1,262.95	Year Frozen	0	Improvements 144,206	117,438		12,919	Penalty	0		Uncapped Value	0	Mobile Home 0	0		0	Exemption	0	0.00	TIF Project ID	0	Total Value 170,168	143,400		15,775	Total Taxable	15,775	1,263.00
Source	REAL	Fair Cash	Capped	Asmnt Level	Assessed	Levy Rate	80.060	Current Tax																																														
Remove Cap	2010	Land Value 25,962	25,962	11%	2,856	Assessed	15,775	1,262.95																																														
Year Frozen	0	Improvements 144,206	117,438		12,919	Penalty	0																																															
Uncapped Value	0	Mobile Home 0	0		0	Exemption	0	0.00																																														
TIF Project ID	0	Total Value 170,168	143,400		15,775	Total Taxable	15,775	1,263.00																																														
Assessment History																																																						
Tax Year	Statement Number	Billed Owner	Tax Area	Total Value	Exemptions	Taxable Value	Billed Tax																																															
2025	2025-660001809	GREEN, BARRETT &	2	136,572	0	15,023	1,203.00																																															
2024	2024-660001809	GREEN, BARRETT &	2	146,741	0	15,089	1,213.00																																															
2023	2023-660001809	GREEN, BARRETT &	2	130,642	0	14,371	1,157.00																																															
2022	2022-660001809	GREEN, BARRETT &	2	128,995	0	14,189	1,151.00																																															
2021	2021-660001809	GREEN, BARRETT &	2	132,842	0	14,613	1,171.00																																															
2020	2020-660001809	GREEN, BARRETT &	2	130,599	0	14,366	1,160.00																																															
2019	2019-660001809	GREEN, BARRETT &	2	125,135	0	13,765	1,137.00																																															
2018	2018-660001809	GREEN, BARRETT &	2	129,798	0	14,278	1,192.00																																															
2017	2017-660001809	GREEN, BARRETT &	2	128,787	0	14,167	1,192.00																																															
2016	2016-660001809	GREEN, BARRETT &	2	125,475	0	13,802	1,174.00																																															
2015	2015-660001809	GREEN, BARRETT &	2	123,275	0	13,560	1,177.00																																															
2014	2014-660001809	GREEN, BARRETT &	2	125,466	0	13,662	1,227.00																																															
2013	2013-660001809	GREEN, BARRETT &	2	118,282	0	13,011	1,096.00																																															



Rogers

Assessment Property Record Card for Tax Year 2026

Data provided by LISA DELOZIER County Assessor

Date 04/17/2026
 Time 08:48:40
 Page 2

Lot Data	Square-Foot - NBHD 1057 #1	Primary Image
Lot Size		
Lot Count		
Units Buildable	1	
Non-Ag Acres	1.384	
Topography		
Street Access		
Utilities		
Amenities	LAND QUALITY	
	0	
	0	
Method	Square-Foot	
Base Lot Value	60,286.00 x .43 = 25,962	
Factor Value		
Adjustments	1.0000	
Lot Value	25,962	

\\tsclient\C\Users\Randy Necessary\Pictures\101_0927\IMG_0034. 9/27/2021

Residential Data	
Type	1 Single Family Residence
Condition	4 - Good
Quality	3 - Average
Architecture	TRAD TRADITIONAL
Style	100% One Story
Exterior Wall	60% Veneer, Masonry 40% Frame, Plywood or Ha
Base/Total Area	1,302 / 1,302
Style	100% One Story
HVAC	100% Warmed & Cooled Air
Roof Cover	1 Composition Shingle
Area on Slab	1,302
Fixture/RghIn	7 /
Bed/F/H Bath	3 / 1.5 /
Basement Area	
Garage Type	504 Attached Garage - Finished
Remodel	RMA -
Year/Eff Age	1973 / 29

GRM Approach

GRM Code	
Gross Rent	0.00
Indicated Value	

Multiple Regression

MRA Code	1 Test
Adusted R	0.8445
Indicated Value	164,890 126.64 Per SqFt

Direct Comparables

Selection Model	A Adam Test
Adjustment Model	1 2022 Residential
Comparables	
Indicated Value	

Value Reconciliation

Selected Approach	Cost Approach
Improvements	140,524
Lot Value	25,962
Indicated Value	166,486 127.87 Per SqFt
Agland Value	
Site Improvements	3,682
Total Value	170,168 130.70 Total Value Per SqFt

Cost Approach				Manual : 01/2025			
Base Cost	112.90	Total Misc Impr	+	22,351			
Roofing Adj	+ 5.13	Garage Cost	+	20,094			
Subfloor Adj	+ -2.43	Total RCN	=	219,569			
Heat/Cool Adj	+ 12.64	Depreciation (36%)	-	79,045			
Plumbing Adj	+ 7.80	Lump Sums	+	0			
Basement Adj	+ 0.00	RCNLD	=	140,524			
Adj Base Cost	= 136.04	Lot Value	+	25,962			
Total Area	x 1,302	Indicated Value	=	166,486			
Adjusted Cost	= 177,124	Value Per SqFt		127.87			

Miscellaneous Improvements

Code	Description	Sketch ID	Size	Year	Units	Unit Cost	Depr	Value
FPR1	FIREPLACE - RESIDENTIAL 1 STORY	0		1	1	5,615.40		5,615
EPSW	ENCLOSED PORCH - SOLID WALL	4692		102	102	69.97		7,137
PRCH	SLAB PORCH - COVERED	4693	16x12		192	26.33		5,055
CPDT	Carport - Detached	4694	20x20		400	11.36		4,544



Rogers

Assessment Property Record Card for Tax Year 2026

Data provided by LISA DELOZIER County Assessor

Date 04/17/2026
 Time 08:48:40
 Page 3

Sketch Image

660001809

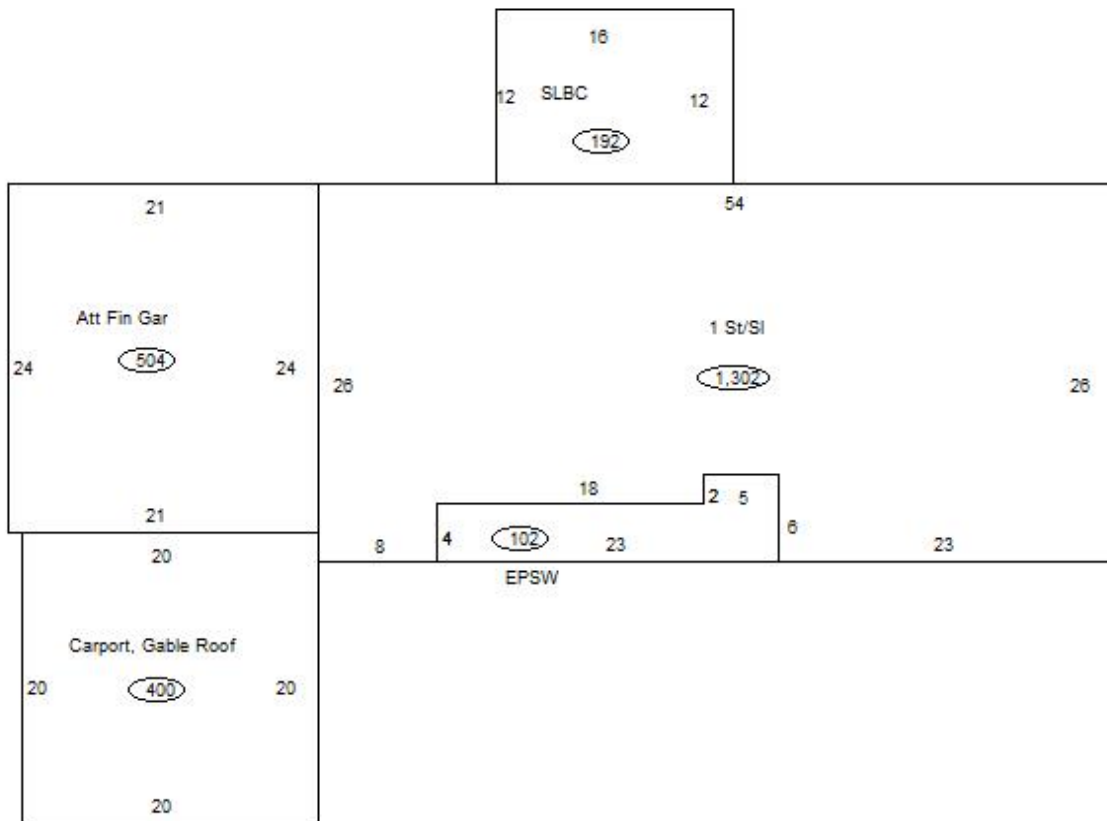

Sketch Vector Information

Sequence	Code	Type	Built Over	Scale	Section Label	Base Area	Multiplier	Total Area
1	R	1	Slab	13	1 St/SI	1,302	1.000	1,302
2	G	5		13	Att Fin Gar	504	1.000	504
3	M	EPSW		13	EPSW	102	1.000	102
4	M	PRCH		13	SLBC	192	1.000	192
5	G	3		13	Carport, Gable Roof	400	1.000	400
Total Building Area						1,302		1,302



Rogers

Assessment Property Record Card for Tax Year 2026

Data provided by LISA DELOZIER County Assessor

Date 04/17/2026
Time 08:48:40
Page 4

660001809

Outbuildings/Site Improvements

Building Image	Code	Description	Dimensions	Floor	Roofing	Total Units
	SHDS	Shed - Small	10x20x7	Plank	Composition Shingle	200
	Qual	3	Cond 3	Year 1990	Eff Age 27	

Valuation Summary	Modifier Total	RCN	Depr (71% Phys/ % Func)	RCNLD
Base Cost (23.63 x 200)	4,726		4,726	3,355
				1,371

	SHDS	Shed - Small	16x24x10	Plank	Composition Shingle	384
	Qual	3	Cond 3	Year 1990	Eff Age 27	

Valuation Summary	Modifier Total	RCN	Depr (71% Phys/ % Func)	RCNLD
Base Cost (20.75 x 384)	7,968		7,968	5,657
				2,311