



Rogers

Assessment Property Record Card for Tax Year 2026

Data provided by LISA DELOZIER County Assessor

Date 04/17/2026
 Time 04:14:04
 Page 1

Assessment Data					Primary Image																																																																																																																				
Account 660002257 Parcel ID 000000-00-0-00216-007-0008 Cadastral ID 03-21-14-01940 Property Type REAL - Real Property Property Class RRP VI Area 4 Tax Area 16 - OWASSO/COLL FIRE Name ID 132544 BLADES, ELAINE 14932 E 121ST PL N COLLINSVILLE OK 74021-0000 Parcel Location Situs 14932 E 121ST PL N Subdivision COUNTRY FARE SUB Lot/Block 0008 / 0007 Parcel Size 1 - Lots Sec/Twn/Rng 3 / 21 / 14 / 5 Neighborhood 1047 - R-V04-SW OWASSO School District S021 - OWASSO SCHOOLS					<p>\\tsclient\T\LOGAN\LOGAN RESIDENTIAL VI\2022-6-29\IMG_003 7/1/2022</p>																																																																																																																				
Legal Description Lot/Long: 36.32962943 -95.80606928 LOT 8 BLOCK 7 COUNTRY FARE SUB																																																																																																																									
Exemptions <table border="1"> <thead> <tr> <th>Code</th> <th>Type</th> <th>Active</th> <th>Maximum</th> <th>Exemption</th> </tr> </thead> <tbody> <tr> <td>H</td> <td>Homestead</td> <td>Yes</td> <td>1,000</td> <td>1,000</td> </tr> </tbody> </table>					Code	Type	Active	Maximum	Exemption	H	Homestead	Yes	1,000	1,000	Building Permits <table border="1"> <thead> <tr> <th>Number</th> <th>Description</th> <th>Opened</th> <th>Closed</th> <th>Amount</th> </tr> </thead> <tbody> <tr> <td> </td> <td> </td> <td> </td> <td> </td> <td> </td> </tr> </tbody> </table>					Number	Description	Opened	Closed	Amount																																																																																																	
Code	Type	Active	Maximum	Exemption																																																																																																																					
H	Homestead	Yes	1,000	1,000																																																																																																																					
Number	Description	Opened	Closed	Amount																																																																																																																					
Parcel Valuation <table border="1"> <thead> <tr> <th>Source</th> <th>REAL</th> <th>Fair Cash</th> <th>Capped</th> <th>Asmnt Level</th> <th>Assessed</th> <th>Levy Rate</th> <th>97.960</th> <th>Current Tax</th> </tr> </thead> <tbody> <tr> <td>Remove Cap</td> <td>0</td> <td>Land Value 61,487</td> <td>18,380</td> <td>11%</td> <td>2,022</td> <td>Assessed</td> <td>3,482</td> <td>341.10</td> </tr> <tr> <td>Year Frozen</td> <td>0</td> <td>Improvements 2,880</td> <td>299</td> <td></td> <td>33</td> <td>Penalty</td> <td>0</td> <td></td> </tr> <tr> <td>Uncapped Value</td> <td>0</td> <td>Mobile Home 15,569</td> <td>12,969</td> <td></td> <td>1,427</td> <td>Exemption</td> <td>1,000</td> <td>-98.00</td> </tr> <tr> <td>TIF Project ID</td> <td>0</td> <td>Total Value 79,936</td> <td>31,648</td> <td></td> <td>3,482</td> <td>Total Taxable</td> <td>2,482</td> <td>243.00</td> </tr> </tbody> </table>					Source	REAL	Fair Cash	Capped	Asmnt Level	Assessed	Levy Rate	97.960	Current Tax	Remove Cap	0	Land Value 61,487	18,380	11%	2,022	Assessed	3,482	341.10	Year Frozen	0	Improvements 2,880	299		33	Penalty	0		Uncapped Value	0	Mobile Home 15,569	12,969		1,427	Exemption	1,000	-98.00	TIF Project ID	0	Total Value 79,936	31,648		3,482	Total Taxable	2,482	243.00	Sale History <table border="1"> <thead> <tr> <th>Bk/Pg</th> <th>Grantor</th> <th>Date</th> <th>Price</th> <th>Code</th> </tr> </thead> <tbody> <tr> <td> </td> <td> </td> <td> </td> <td> </td> <td> </td> </tr> </tbody> </table>					Bk/Pg	Grantor	Date	Price	Code																																																														
Source	REAL	Fair Cash	Capped	Asmnt Level	Assessed	Levy Rate	97.960	Current Tax																																																																																																																	
Remove Cap	0	Land Value 61,487	18,380	11%	2,022	Assessed	3,482	341.10																																																																																																																	
Year Frozen	0	Improvements 2,880	299		33	Penalty	0																																																																																																																		
Uncapped Value	0	Mobile Home 15,569	12,969		1,427	Exemption	1,000	-98.00																																																																																																																	
TIF Project ID	0	Total Value 79,936	31,648		3,482	Total Taxable	2,482	243.00																																																																																																																	
Bk/Pg	Grantor	Date	Price	Code																																																																																																																					
Assessment History <table border="1"> <thead> <tr> <th>Tax Year</th> <th>Statement Number</th> <th>Billed Owner</th> <th>Tax Area</th> <th>Total Value</th> <th>Exemptions</th> <th>Taxable Value</th> <th>Billed Tax</th> </tr> </thead> <tbody> <tr><td>2025</td><td>2025-660002257</td><td>BLADES, ELAINE</td><td>16</td><td>79,475</td><td>1000</td><td>2,380</td><td>233.00</td></tr> <tr><td>2024</td><td>2024-660002257</td><td>BLADES, ELAINE</td><td>16</td><td>64,039</td><td>1000</td><td>2,282</td><td>219.00</td></tr> <tr><td>2023</td><td>2023-660002257</td><td>BLADES, ELAINE</td><td>16</td><td>36,037</td><td>1000</td><td>2,186</td><td>205.00</td></tr> <tr><td>2022</td><td>2022-660002257</td><td>BLADES, ELAINE</td><td>16</td><td>37,215</td><td>1000</td><td>2,094</td><td>205.00</td></tr> <tr><td>2021</td><td>2021-660002257</td><td>BLADES, ELAINE</td><td>16</td><td>37,496</td><td>1000</td><td>2,004</td><td>194.00</td></tr> <tr><td>2020</td><td>2020-660002257</td><td>BLADES, ELAINE</td><td>16</td><td>31,137</td><td>1000</td><td>1,915</td><td>185.00</td></tr> <tr><td>2019</td><td>2019-660002257</td><td>BLADES, ELAINE</td><td>16</td><td>32,054</td><td>1000</td><td>1,830</td><td>177.00</td></tr> <tr><td>2018</td><td>2018-660002257</td><td>BLADES, ELAINE</td><td>16</td><td>36,404</td><td>1000</td><td>1,749</td><td>163.00</td></tr> <tr><td>2017</td><td>2017-660002257</td><td>BLADES, ELAINE</td><td>16</td><td>36,086</td><td>1000</td><td>1,668</td><td>157.00</td></tr> <tr><td>2016</td><td>2016-660002257</td><td>BLADES, ELAINE</td><td>16</td><td>34,744</td><td>1000</td><td>1,591</td><td>150.00</td></tr> <tr><td>2015</td><td>2015-660002257</td><td>BLADES, ELAINE</td><td>16</td><td>34,955</td><td>1000</td><td>1,516</td><td>144.00</td></tr> <tr><td>2014</td><td>2014-660002257</td><td>BLADES, ELAINE</td><td>16</td><td>22,202</td><td>1000</td><td>1,442</td><td>138.00</td></tr> <tr><td>2013</td><td>2013-660002257</td><td>BLADES, ELAINE</td><td>16</td><td>22,074</td><td>1000</td><td>1,428</td><td>134.00</td></tr> </tbody> </table>										Tax Year	Statement Number	Billed Owner	Tax Area	Total Value	Exemptions	Taxable Value	Billed Tax	2025	2025-660002257	BLADES, ELAINE	16	79,475	1000	2,380	233.00	2024	2024-660002257	BLADES, ELAINE	16	64,039	1000	2,282	219.00	2023	2023-660002257	BLADES, ELAINE	16	36,037	1000	2,186	205.00	2022	2022-660002257	BLADES, ELAINE	16	37,215	1000	2,094	205.00	2021	2021-660002257	BLADES, ELAINE	16	37,496	1000	2,004	194.00	2020	2020-660002257	BLADES, ELAINE	16	31,137	1000	1,915	185.00	2019	2019-660002257	BLADES, ELAINE	16	32,054	1000	1,830	177.00	2018	2018-660002257	BLADES, ELAINE	16	36,404	1000	1,749	163.00	2017	2017-660002257	BLADES, ELAINE	16	36,086	1000	1,668	157.00	2016	2016-660002257	BLADES, ELAINE	16	34,744	1000	1,591	150.00	2015	2015-660002257	BLADES, ELAINE	16	34,955	1000	1,516	144.00	2014	2014-660002257	BLADES, ELAINE	16	22,202	1000	1,442	138.00	2013	2013-660002257	BLADES, ELAINE	16	22,074	1000	1,428	134.00
Tax Year	Statement Number	Billed Owner	Tax Area	Total Value	Exemptions	Taxable Value	Billed Tax																																																																																																																		
2025	2025-660002257	BLADES, ELAINE	16	79,475	1000	2,380	233.00																																																																																																																		
2024	2024-660002257	BLADES, ELAINE	16	64,039	1000	2,282	219.00																																																																																																																		
2023	2023-660002257	BLADES, ELAINE	16	36,037	1000	2,186	205.00																																																																																																																		
2022	2022-660002257	BLADES, ELAINE	16	37,215	1000	2,094	205.00																																																																																																																		
2021	2021-660002257	BLADES, ELAINE	16	37,496	1000	2,004	194.00																																																																																																																		
2020	2020-660002257	BLADES, ELAINE	16	31,137	1000	1,915	185.00																																																																																																																		
2019	2019-660002257	BLADES, ELAINE	16	32,054	1000	1,830	177.00																																																																																																																		
2018	2018-660002257	BLADES, ELAINE	16	36,404	1000	1,749	163.00																																																																																																																		
2017	2017-660002257	BLADES, ELAINE	16	36,086	1000	1,668	157.00																																																																																																																		
2016	2016-660002257	BLADES, ELAINE	16	34,744	1000	1,591	150.00																																																																																																																		
2015	2015-660002257	BLADES, ELAINE	16	34,955	1000	1,516	144.00																																																																																																																		
2014	2014-660002257	BLADES, ELAINE	16	22,202	1000	1,442	138.00																																																																																																																		
2013	2013-660002257	BLADES, ELAINE	16	22,074	1000	1,428	134.00																																																																																																																		



Rogers

Assessment Property Record Card for Tax Year 2026

Data provided by LISA DELOZIER County Assessor

Date 04/17/2026
 Time 04:14:04
 Page 2

Lot Data		Square-Foot - NBHD 1047 #1		Primary Image			
Lot Size							
Lot Count							
Units Buildable	1						
Non-Ag Acres	0.6448						
Topography							
Street Access							
Utilities							
Amenities		0					
		0					
Method	Square-Foot						
Base Lot Value	28,089.00 x 2.19 = 61,487						
Factor Value							
Adjustments	1.0000						
Lot Value	61,487						
Residential Data				GRM Approach			
Type				GRM Code			
Condition	0 -			Gross Rent	0.00		
Quality	0 -			Indicated Value			
Architecture				Multiple Regression			
Style				MRA Code			
Exterior Wall				Adjusted R			
Base/Total Area /				Indicated Value			
Style				Direct Comparables			
HVAC				Selection Model	A Adam Test		
Roof Cover				Adjustment Model	1 2022 Residential		
Area on Slab				Comparables			
Fixture/RghIn /				Indicated Value			
Bed/F/H Bath / /				Value Reconciliation			
Basement Area				Selected Approach	Cost Approach		
Garage Type				Improvements			
Remodel				Lot Value	61,487		
Year/Eff Age /				Indicated Value	61,487	0.00	Per SqFt
				Agland Value			
				Site Improvements	2,880		
				Total Value	64,367	0.00	Total Value Per SqFt
Cost Approach				Manual : 01/2025			
Base Cost	0.00	Total Misc Impr	+ 0				
Roofing Adj	+ 0.00	Garage Cost	+ 0				
Subfloor Adj	+ 0.00	Total RCN	= 0				
Heat/Cool Adj	+ 0.00	Depreciation (0%)	- 0				
Plumbing Adj	+ 0.00	Lump Sums	+ 0				
Basement Adj	+ 0.00	RCNLD	= 0				
Adj Base Cost	= 0.00	Lot Value	+ 61,487				
Total Area	x	Indicated Value	= 61,487				
Adjusted Cost	= 0	Value Per SqFt	0.00				
Miscellaneous Improvements							
Code	Description	Sketch ID	Size	Year	Units	Unit Cost	Depr Value



Rogers

Assessment Property Record Card for Tax Year 2026

Data provided by LISA DELOZIER County Assessor

Date 04/17/2026
Time 04:14:04
Page 3

660002257

Outbuildings/Site Improvements

Building Image	Code	Description	Dimensions	Floor	Roofing	Total Units
	DTGF	DETACHED GARAGE FAIR	0x0x0			720
	Qual 2	Cond 3	Year	Eff Age		
		Valuation Summary	Modifier Total	RCN	Depr (75% Phys/ % Func)	RCNLD
		Base Cost (16.00 x 720)	11,520	11,520	8,640	2,880



Rogers

Assessment Property Record Card for Tax Year 2026

Data provided by LISA DELOZIER County Assessor

Date 04/17/2026
Time 04:14:05
Page 4

Lot Data	Square-Foot - NBHD 1047 #1	Primary Image
Lot Size Lot Count Units Buildable Non-Ag Acres Topography Street Access Utilities Amenities Method Square-Foot Base Lot Value Factor Value Adjustments Lot Value		

Residential Data	
Type	6 Mobile Home 58 x 26
Condition	3 - Average
Quality	3 - Average
Architecture	6 MS ADJ
Style	100% Double Wide
Exterior Wall	100% Frame, Siding, Vinyl
Base/Total Area	1,508 / 1,508
Style	100% Double Wide
HVAC	100% Warmed & Cooled Air
Roof Cover	1 Composition Shingle
Area on Slab	0
Fixture/RghIn	/
Bed/F/H Bath	/ /
Basement Area	
Garage Type	
Remodel	
Year/Eff Age	1972 / 41

\\tsclient\T\LOGAN\LOGAN RESIDENTIAL VI\2022-6-29\IMG_003 7/1/2022	
--	--

GRM Approach	
GRM Code	
Gross Rent	0.00
Indicated Value	

Multiple Regression	
MRA Code	
Adjusted R	
Indicated Value	

Direct Comparables	
Selection Model	A Adam Test
Adjustment Model	1 2022 Residential
Comparables	
Indicated Value	

Cost Approach				Manual : 01/2025			
Base Cost	33.74	Total Misc Impr	+ 8,010				
Roofing Adj	+ 2.63	Garage Cost	+ 0				
Subfloor Adj	+ 0.00	Total RCN	= 77,845				
Heat/Cool Adj	+ 2.88	Depreciation (80%)	- 62,276				
Plumbing Adj	+ 7.06	Lump Sums	+ 0				
Basement Adj	+ 0.00	RCNLD	= 15,569				
Adj Base Cost	= 46.31	Lot Value	+ 0				
Total Area	x 1,508	Indicated Value	= 15,569				
Adjusted Cost	= 69,835	Value Per SqFt	10.32				

Value Reconciliation			
Selected Approach	Cost Approach		
Improvements	15,569		
Lot Value			
Indicated Value	15,569	10.32	Per SqFt
Agland Value			
Site Improvements			
Total Value	15,569	10.32	Total Value Per SqFt

Miscellaneous Improvements								
Code	Description	Sketch ID	Size	Year	Units	Unit Cost	Depr	Value
PRCH	SLAB PORCH - COVERED	5972	32x11		352	15.54		5,470
PATO	SLAB PORCH - OPEN	5973	34x8		272	9.34		2,540



Rogers

Assessment Property Record Card for Tax Year 2026

Data provided by LISA DELOZIER County Assessor

Date 04/17/2026

Time 04:14:05

Page 5

Sketch Image

660002257

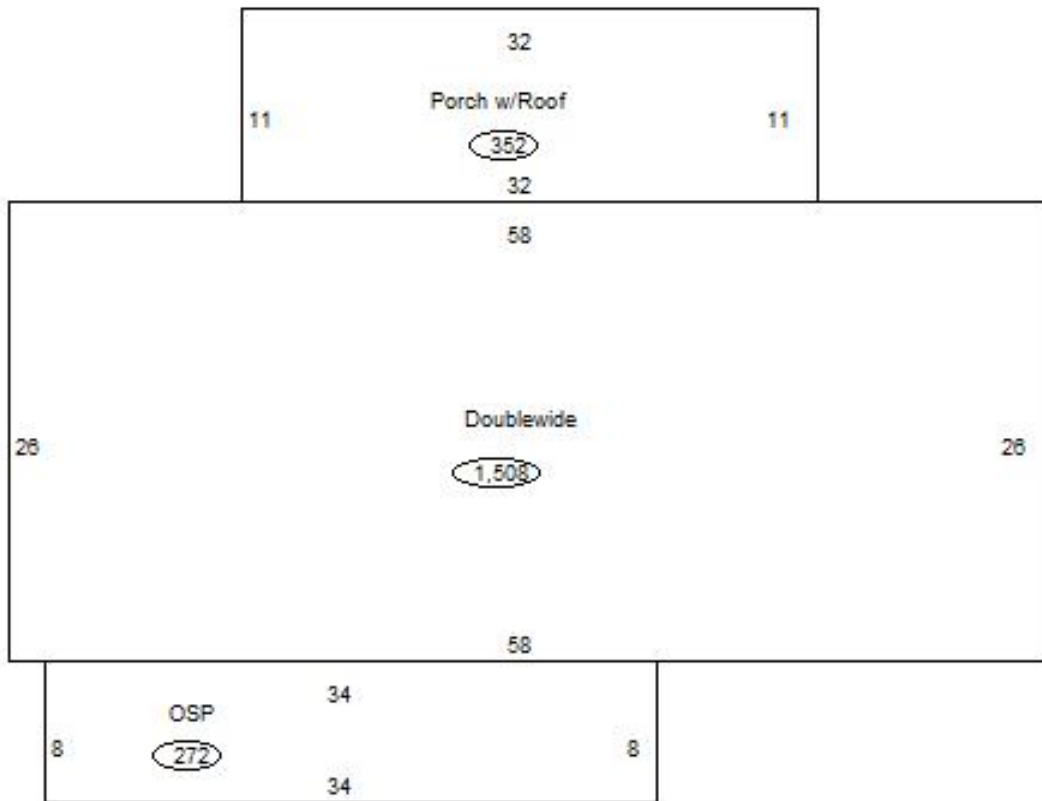

Sketch Vector Information

Sequence	Code	Type	Built Over	Scale	Section Label	Base Area	Multiplier	Total Area
1	R	14		13	Doublewide	1,508	1.000	1,508
2	M	PRCH		13	SLBC	352	1.000	352
3	M	PATO		13	Open Slab	272	1.000	272
Total Building Area						1,508		1,508