



Rogers

Assessment Property Record Card for Tax Year 2026

Data provided by LISA DELOZIER County Assessor

Date 04/18/2026
 Time 07:58:45
 Page 1

Assessment Data				Primary Image															
Account 660002326 Parcel ID 21N16E-03-3-00000-000-0000 Cadastral ID 03-21-16-00810 Property Type REAL - Real Property Property Class UR VI Area 1 Tax Area 17 - CLAREMORE OT Name ID 336107 HALVORSEN, MARGIE DEANN & RANDY SCOTT 608 1/2 E BLUE STARR DR CLAREMORE OK 74017-0000 Parcel Location Situs 00608 1 2 BLUE STARR DR Subdivision Lot/Block / Parcel Size .45 - Acres Sec/Twn/Rng 3 / 21 / 16 / 3 Neighborhood 2116 - UNPLATTED School District S001 - CLAREMORE SCHOOLS				<p>\\tsclient\T\LOGAN\LOGAN RESIDENTIAL VI\2023-3-30\IMG_0001 3/30/2023</p>															
Legal Description Lat/Long: 36.32227569 -95.59319254																			
E 75', W 1127.4', N 264', S 297.5' S2 SW				Building Permits <table border="1"> <thead> <tr> <th>Number</th> <th>Description</th> <th>Opened</th> <th>Closed</th> <th>Amount</th> </tr> </thead> <tbody> <tr> <td colspan="5"> </td> </tr> </tbody> </table>						Number	Description	Opened	Closed	Amount					
Number	Description	Opened	Closed	Amount															
Exemptions				Sale History															
Code	Type	Active	Maximum	Exemption	Bk/Pg	Grantor	Date	Price	Code										
HV	Veteran	No	99,999		/	FRESWICK, DAVID II &	09/27/2021	300,000	YES										
H	Homestead	No	1,000		/	PRESCOTT, WILLIAM E &	09/30/2020	263,000	YES										
					2680/40	ROSS, BOBBY DEAN & LINDA SUE	12/08/2017	197,500	YES										
					1167/20	WAREHIME, LELAND R &	04/19/1999	122,000	Yes										
					955/579	SELLER	04/29/1994	0	No										
					819/456			10,000	No										
Parcel Valuation																			
Source	REAL		Fair Cash	Capped	Asmnt Level	Assessed	Levy Rate	92.430	Current Tax										
Remove Cap	2022	Land Value	18,725	18,725	11%	2,060	Assessed	29,378	2,715.41										
Year Frozen	0	Improvements	248,346	248,346		27,318	Penalty	0											
Uncapped Value	0	Mobile Home	0	0		0	Exemption	0	0.00										
TIF Project ID	0	Total Value	267,071	267,071		29,378	Total Taxable	29,378	2,715.00										
Assessment History																			
Tax Year	Statement Number	Billed Owner			Tax Area	Total Value	Exemptions	Taxable Value	Billed Tax										
2025	2025-660002326	HALVORSEN, MARGIE DEANN &			17	257,999	0	28,380	2,623.00										
2024	2024-660002326	HALVORSEN, MARGIE DEANN &			17	273,742	0	30,112	2,783.00										
2023	2023-660002326	HALVORSEN, MARGIE DEANN &			17	300,000	0	33,000	3,023.00										
2022	2022-660002326	HALVORSEN, MARGIE DEANN &			17	300,000	0	33,000	3,055.00										
2021	2021-660002326	FRESWICK, DAVID II &			17	260,351	0	28,639	2,529.00										
2020	2020-660002326	PRESCOTT, WILLIAM E &			17	212,786	1000	21,075	1,930.00										
2019	2019-660002326	PRESCOTT, WILLIAM E &			17	194,836	1000	20,432	1,892.00										
2018	2018-660002326	PRESCOTT, WILLIAM E &			17	198,455	1000	20,830	1,925.00										
2017	2017-660002326	ROSS, BOBBY DEAN & LINDA SUE			17	182,443	0	20,069	1,843.00										
2016	2016-660002326	ROSS, BOBBY DEAN & LINDA SUE			17	177,491	0	19,462	1,827.00										
2015	2015-660002326	ROSS, BOBBY DEAN & LINDA SUE			17	173,238	0	18,535	1,672.00										
2014	2014-660002326	ROSS, BOBBY DEAN & LINDA SUE			17	176,881	17652		.00										
2013	2013-660002326	ROSS, BOBBY DEAN & LINDA SUE			17	165,877	1000	16,138	1,477.00										



Rogers

Assessment Property Record Card for Tax Year 2026

Data provided by LISA DELOZIER County Assessor

Date 04/18/2026
 Time 07:58:45
 Page 2

Lot Data		Square-Foot - NBHD 2116 #1	
Lot Size			
Lot Count			
Units Buildable	1		
Non-Ag Acres	0.4885		
Topography			
Street Access			
Utilities			
Amenities	LAND QUALITY	0	
		0	
Method	Square-Foot		
Base Lot Value	21,278.00 x .88 = 18,725		
Factor Value			
Adjustments	1.0000		
Lot Value	18,725		



\\tsclient\T\LOGAN\LOGAN RESIDENTIAL VI\2023-3-30\IMG_0001 3/30/2023

Residential Data	
Type	1 Single Family Residence
Condition	3 - Average
Quality	4 - Good
Architecture	
Style	100% 1 1/2 Story Finished
Exterior Wall	90% Frame, Siding, Vinyl 10% Veneer, Masonry
Base/Total Area	1,279 / 2,023
Style	100% 1 1/2 Story Finished
HVAC	100% Warmed & Cooled Air
Roof Cover	1 Composition Shingle
Area on Slab	1,279
Fixture/RghIn	11 /
Bed/F/H Bath	3 / 2.0 /
Basement Area	
Garage Type	546 Attached Garage - Unfinished
Remodel	RMA -
Year/Eff Age	1990 / 18

GRM Approach	
GRM Code	
Gross Rent	0.00
Indicated Value	

Multiple Regression			
MRA Code	1 Test		
Adusted R	0.8445		
Indicated Value	284,166	140.47	Per SqFt

Direct Comparables	
Selection Model	A Adam Test
Adjustment Model	NewTest
Comparables	
Indicated Value	

Cost Approach		Manual : 01/2025	
Base Cost	101.30	Total Misc Impr	+ 11,499
Roofing Adj	+ 4.21	Garage Cost	+ 26,011
Subfloor Adj	+ -3.30	Total RCN	= 297,263
Heat/Cool Adj	+ 16.31	Depreciation (20%)	- 59,453
Plumbing Adj	+ 9.88	Lump Sums	+ 10,536
Basement Adj	+ 0.00	RCNLD	= 248,346
Adj Base Cost	= 128.40	Lot Value	+ 18,725
Total Area	x 2,023	Indicated Value	= 267,071
Adjusted Cost	= 259,753	Value Per SqFt	132.02

Value Reconciliation			
Selected Approach	Cost Approach		
Improvements	248,346		
Lot Value	18,725		
Indicated Value	267,071	132.02	Per SqFt
Agland Value			
Site Improvements			
Total Value	267,071	132.02	Total Value Per SqFt

Miscellaneous Improvements								
Code	Description	Sketch ID	Size	Year	Units	Unit Cost	Depr	Value
FPR1	FIREPLACE - RESIDENTIAL 1 STORY	0		1	1	7,243.87		7,244
PRCH	SLAB PORCH - COVERED	6148	8x8		64	32.99		2,111
PRCH	SLAB PORCH - COVERED	6149	13x5		65	32.99		2,144
WODC	WOOD DECK - COVERED	144843	20x12		240	43.90		10,536



Rogers
Assessment Property Record Card for Tax Year 2026

Data provided by LISA DELOZIER County Assessor

Date 04/18/2026
 Time 07:58:45
 Page 3

Sketch Image

660002326

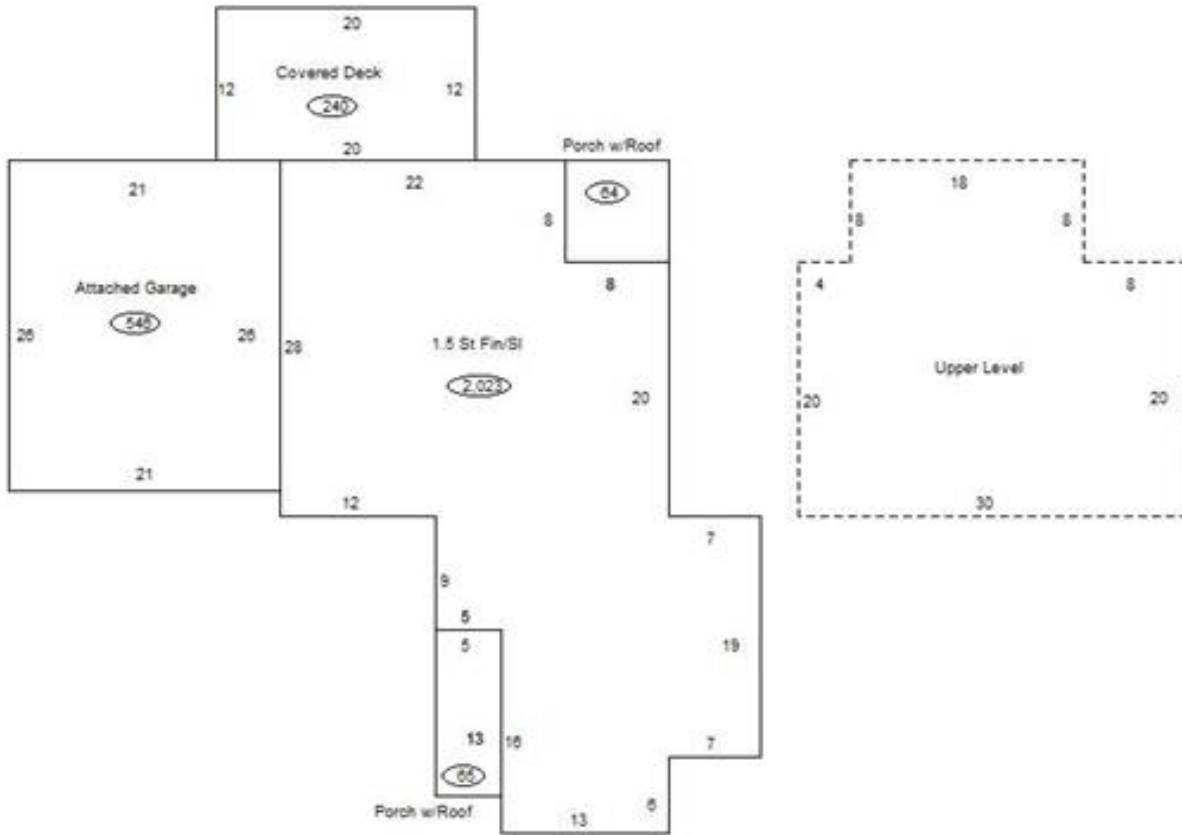

Sketch Vector Information

Sequence	Code	Type	Built Over	Scale	Section Label	Base Area	Multiplier	Total Area
1	R	5	Slab	13	1.5 St Fin/Sl	1,279	1.582	2,023
2	G	1		13	Attached Garage	546	1.000	546
3	M	PRCH		13	SLBC	64	1.000	64
4	M	PRCH		13	SLBC	65	1.000	65
5	U	^UL	Overhang	13	Upper Level	744	1.000	744
6	M	WODC		13	WODC	240	1.000	240
Total Building Area						1,279		2,023