



Rogers

Assessment Property Record Card for Tax Year 2026

Data provided by LISA DELOZIER County Assessor

Date 04/17/2026
 Time 03:19:36
 Page 1

Assessment Data					Primary Image																																																																																																																				
Account 660002343 Parcel ID 21N16E-03-2-00000-000-0000 Cadastral ID 03-21-16-02700 Property Type REAL - Real Property Property Class RR VI Area 1 Tax Area 18 - CLAREMORE RURAL/W/O FIRE Name ID 338377 KROEKER, LEE 19072 S QUINTON WAY CLAREMORE OK 74017-0000 Parcel Location Situs 19072 QUINTON WAY Subdivision Lot/Block / Parcel Size 3 - Acres Sec/Twn/Rng 3 / 21 / 16 / 2 Neighborhood 2116 - UNPLATTED School District S001 - CLAREMORE SCHOOLS					<p>\\tsclient\T\LOGAN\LOGAN RESIDENTIAL VI\2023-3-30\IMG_002: 3/30/2023</p>																																																																																																																				
Legal Description Lat/Long: 36.33551509 -95.58904563																																																																																																																									
Legal Description TR IN LOT 3 BEG: 226' W NE/C LOT 3; S 578.34'; W 226'; N 578.34'; E 226' TO POB					Building Permits <table border="1"> <thead> <tr> <th>Number</th> <th>Description</th> <th>Opened</th> <th>Closed</th> <th>Amount</th> </tr> </thead> <tbody> <tr> <td> </td> <td> </td> <td> </td> <td> </td> <td> </td> </tr> </tbody> </table>					Number	Description	Opened	Closed	Amount																																																																																																											
Number	Description	Opened	Closed	Amount																																																																																																																					
Exemptions <table border="1"> <thead> <tr> <th>Code</th> <th>Type</th> <th>Active</th> <th>Maximum</th> <th>Exemption</th> </tr> </thead> <tbody> <tr> <td>H</td> <td>Homestead</td> <td>No</td> <td>1,000</td> <td> </td> </tr> </tbody> </table>					Code	Type	Active	Maximum	Exemption	H	Homestead	No	1,000		Sale History <table border="1"> <thead> <tr> <th>Bk/Pg</th> <th>Grantor</th> <th>Date</th> <th>Price</th> <th>Code</th> </tr> </thead> <tbody> <tr> <td>/</td> <td>YORK, MELISSA & JAMES</td> <td>05/19/2022</td> <td>255,000</td> <td>YES</td> </tr> <tr> <td>2581/885</td> <td>QUINTON, MELBA J</td> <td>09/30/2016</td> <td>166,670</td> <td>YES</td> </tr> </tbody> </table>					Bk/Pg	Grantor	Date	Price	Code	/	YORK, MELISSA & JAMES	05/19/2022	255,000	YES	2581/885	QUINTON, MELBA J	09/30/2016	166,670	YES																																																																																							
Code	Type	Active	Maximum	Exemption																																																																																																																					
H	Homestead	No	1,000																																																																																																																						
Bk/Pg	Grantor	Date	Price	Code																																																																																																																					
/	YORK, MELISSA & JAMES	05/19/2022	255,000	YES																																																																																																																					
2581/885	QUINTON, MELBA J	09/30/2016	166,670	YES																																																																																																																					
Parcel Valuation <table border="1"> <thead> <tr> <th>Source</th> <th>REAL</th> <th>Fair Cash</th> <th>Capped</th> <th>Asmnt Level</th> <th>Assessed</th> <th>Levy Rate</th> <th>92.430</th> <th>Current Tax</th> </tr> </thead> <tbody> <tr> <td>Remove Cap</td> <td>2023</td> <td>Land Value 66,461</td> <td>66,461</td> <td>11%</td> <td>7,311</td> <td>Assessed</td> <td>31,288</td> <td>2,891.95</td> </tr> <tr> <td>Year Frozen</td> <td>2014</td> <td>Improvements 217,971</td> <td>217,971</td> <td> </td> <td>23,977</td> <td>Penalty</td> <td>0</td> <td> </td> </tr> <tr> <td>Uncapped Value</td> <td>0</td> <td>Mobile Home 0</td> <td>0</td> <td> </td> <td>0</td> <td>Exemption</td> <td>0</td> <td>0.00</td> </tr> <tr> <td>TIF Project ID</td> <td>0</td> <td>Total Value 284,432</td> <td>284,432</td> <td> </td> <td>31,288</td> <td>Total Taxable</td> <td>31,288</td> <td>2,892.00</td> </tr> </tbody> </table>										Source	REAL	Fair Cash	Capped	Asmnt Level	Assessed	Levy Rate	92.430	Current Tax	Remove Cap	2023	Land Value 66,461	66,461	11%	7,311	Assessed	31,288	2,891.95	Year Frozen	2014	Improvements 217,971	217,971		23,977	Penalty	0		Uncapped Value	0	Mobile Home 0	0		0	Exemption	0	0.00	TIF Project ID	0	Total Value 284,432	284,432		31,288	Total Taxable	31,288	2,892.00																																																																			
Source	REAL	Fair Cash	Capped	Asmnt Level	Assessed	Levy Rate	92.430	Current Tax																																																																																																																	
Remove Cap	2023	Land Value 66,461	66,461	11%	7,311	Assessed	31,288	2,891.95																																																																																																																	
Year Frozen	2014	Improvements 217,971	217,971		23,977	Penalty	0																																																																																																																		
Uncapped Value	0	Mobile Home 0	0		0	Exemption	0	0.00																																																																																																																	
TIF Project ID	0	Total Value 284,432	284,432		31,288	Total Taxable	31,288	2,892.00																																																																																																																	
Assessment History <table border="1"> <thead> <tr> <th>Tax Year</th> <th>Statement Number</th> <th>Billed Owner</th> <th>Tax Area</th> <th>Total Value</th> <th>Exemptions</th> <th>Taxable Value</th> <th>Billed Tax</th> </tr> </thead> <tbody> <tr><td>2025</td><td>2025-660002343</td><td>KROEKER, LEE</td><td>18</td><td>281,444</td><td>0</td><td>30,925</td><td>2,858.00</td></tr> <tr><td>2024</td><td>2024-660002343</td><td>KROEKER, LEE</td><td>18</td><td>294,045</td><td>0</td><td>29,452</td><td>2,722.00</td></tr> <tr><td>2023</td><td>2023-660002343</td><td>KROEKER, LEE</td><td>18</td><td>255,000</td><td>0</td><td>28,051</td><td>2,569.00</td></tr> <tr><td>2022</td><td>2022-660002343</td><td>KROEKER, LEE</td><td>18</td><td>170,566</td><td>1000</td><td>17,763</td><td>1,644.00</td></tr> <tr><td>2021</td><td>2021-660002343</td><td>YORK, MELISSA & JAMES</td><td>18</td><td>177,475</td><td>1000</td><td>17,950</td><td>1,585.00</td></tr> <tr><td>2020</td><td>2020-660002343</td><td>YORK, MELISSA & JAMES</td><td>18</td><td>173,926</td><td>1000</td><td>17,398</td><td>1,593.00</td></tr> <tr><td>2019</td><td>2019-660002343</td><td>YORK, MELISSA & JAMES</td><td>18</td><td>162,382</td><td>0</td><td>17,862</td><td>1,654.00</td></tr> <tr><td>2018</td><td>2018-660002343</td><td>YORK, MELISSA & JAMES</td><td>18</td><td>167,961</td><td>0</td><td>18,475</td><td>1,707.00</td></tr> <tr><td>2017</td><td>2017-660002343</td><td>YORK, MELISSA & JAMES</td><td>18</td><td>166,679</td><td>0</td><td>18,334</td><td>1,682.00</td></tr> <tr><td>2016</td><td>2016-660002343</td><td>QUINTON, MELBA J</td><td>18</td><td>203,081</td><td>1000</td><td>17,453</td><td>1,636.00</td></tr> <tr><td>2015</td><td>2015-660002343</td><td>QUINTON, MELBA J</td><td>18</td><td>197,027</td><td>1000</td><td>17,453</td><td>1,571.00</td></tr> <tr><td>2014</td><td>2014-660002343</td><td>QUINTON, MELBA J</td><td>18</td><td>201,954</td><td>1000</td><td>17,453</td><td>1,618.00</td></tr> <tr><td>2013</td><td>2013-660002343</td><td>QUINTON, MELBA J</td><td>18</td><td>191,501</td><td>1000</td><td>16,916</td><td>1,548.00</td></tr> </tbody> </table>										Tax Year	Statement Number	Billed Owner	Tax Area	Total Value	Exemptions	Taxable Value	Billed Tax	2025	2025-660002343	KROEKER, LEE	18	281,444	0	30,925	2,858.00	2024	2024-660002343	KROEKER, LEE	18	294,045	0	29,452	2,722.00	2023	2023-660002343	KROEKER, LEE	18	255,000	0	28,051	2,569.00	2022	2022-660002343	KROEKER, LEE	18	170,566	1000	17,763	1,644.00	2021	2021-660002343	YORK, MELISSA & JAMES	18	177,475	1000	17,950	1,585.00	2020	2020-660002343	YORK, MELISSA & JAMES	18	173,926	1000	17,398	1,593.00	2019	2019-660002343	YORK, MELISSA & JAMES	18	162,382	0	17,862	1,654.00	2018	2018-660002343	YORK, MELISSA & JAMES	18	167,961	0	18,475	1,707.00	2017	2017-660002343	YORK, MELISSA & JAMES	18	166,679	0	18,334	1,682.00	2016	2016-660002343	QUINTON, MELBA J	18	203,081	1000	17,453	1,636.00	2015	2015-660002343	QUINTON, MELBA J	18	197,027	1000	17,453	1,571.00	2014	2014-660002343	QUINTON, MELBA J	18	201,954	1000	17,453	1,618.00	2013	2013-660002343	QUINTON, MELBA J	18	191,501	1000	16,916	1,548.00
Tax Year	Statement Number	Billed Owner	Tax Area	Total Value	Exemptions	Taxable Value	Billed Tax																																																																																																																		
2025	2025-660002343	KROEKER, LEE	18	281,444	0	30,925	2,858.00																																																																																																																		
2024	2024-660002343	KROEKER, LEE	18	294,045	0	29,452	2,722.00																																																																																																																		
2023	2023-660002343	KROEKER, LEE	18	255,000	0	28,051	2,569.00																																																																																																																		
2022	2022-660002343	KROEKER, LEE	18	170,566	1000	17,763	1,644.00																																																																																																																		
2021	2021-660002343	YORK, MELISSA & JAMES	18	177,475	1000	17,950	1,585.00																																																																																																																		
2020	2020-660002343	YORK, MELISSA & JAMES	18	173,926	1000	17,398	1,593.00																																																																																																																		
2019	2019-660002343	YORK, MELISSA & JAMES	18	162,382	0	17,862	1,654.00																																																																																																																		
2018	2018-660002343	YORK, MELISSA & JAMES	18	167,961	0	18,475	1,707.00																																																																																																																		
2017	2017-660002343	YORK, MELISSA & JAMES	18	166,679	0	18,334	1,682.00																																																																																																																		
2016	2016-660002343	QUINTON, MELBA J	18	203,081	1000	17,453	1,636.00																																																																																																																		
2015	2015-660002343	QUINTON, MELBA J	18	197,027	1000	17,453	1,571.00																																																																																																																		
2014	2014-660002343	QUINTON, MELBA J	18	201,954	1000	17,453	1,618.00																																																																																																																		
2013	2013-660002343	QUINTON, MELBA J	18	191,501	1000	16,916	1,548.00																																																																																																																		



Rogers

Assessment Property Record Card for Tax Year 2026

Data provided by LISA DELOZIER County Assessor

Date 04/17/2026
 Time 03:19:36
 Page 2

Lot Data		Square-Foot - NBHD 2116 #1	
Lot Size			
Lot Count			
Units Buildable	1		
Non-Ag Acres	3.0287		
Topography			
Street Access			
Utilities			
Amenities	LAND QUALITY	0	
		0	
Method	Square-Foot		
Base Lot Value	131,930.00 x .50 = 66,461		
Factor Value			
Adjustments	1.0000		
Lot Value	66,461		



\\tsclient\T\LOGAN\LOGAN RESIDENTIAL VI\2023-3-30\IMG_002: 3/30/2023

Residential Data	
Type	1 Single Family Residence
Condition	4.5 - Good
Quality	4.5 - Good
Architecture	
Style	100% 1 1/2 Story Finished
Exterior Wall	90% Veneer, Stone 10% Frame, Siding, Wood
Base/Total Area	1,692 / 2,472
Style	100% 1 1/2 Story Finished
HVAC	100% Warmed & Cooled Air
Roof Cover	1 Composition Shingle
Area on Slab	1,692
Fixture/RghIn	14 /
Bed/F/H Bath	3 / 2.5 /
Basement Area	
Garage Type	588 Attached Garage - Unfinished
Remodel	
Year/Eff Age	1976 / 27

GRM Approach	
GRM Code	
Gross Rent	0.00
Indicated Value	

Multiple Regression			
MRA Code	1 Test		
Adusted R	0.8445		
Indicated Value	348,526	140.99	Per SqFt

Direct Comparables	
Selection Model	A Adam Test
Adjustment Model	NewTest
Comparables	
Indicated Value	

Cost Approach		Manual : 01/2025	
Base Cost	114,58	Total Misc Impr	+ 25,784
Roofing Adj	+ 4.58	Garage Cost	+ 29,341
Subfloor Adj	+ -3.33	Total RCN	= 411,266
Heat/Cool Adj	+ 17.38	Depreciation (47%)	- 193,295
Plumbing Adj	+ 10.86	Lump Sums	+ 0
Basement Adj	+ 0.00	RCNLD	= 217,971
Adj Base Cost	= 144.07	Lot Value	+ 66,461
Total Area	x 2,472	Indicated Value	= 284,432
Adjusted Cost	= 356,141	Value Per SqFt	115.06

Value Reconciliation			
Selected Approach	Cost Approach		
Improvements	217,971		
Lot Value	66,461		
Indicated Value	284,432	115.06	Per SqFt
Agland Value			
Site Improvements			
Total Value	284,432	115.06	Total Value Per SqFt

Miscellaneous Improvements								
Code	Description	Sketch ID	Size	Year	Units	Unit Cost	Depr	Value
FPR1	FIREPLACE - RESIDENTIAL 1 STORY	0		1	1	7,721.18		7,721
PRCH	SLAB PORCH - COVERED	6181		112	112	36.22		4,057
PRCH	SLAB PORCH - COVERED	6182	24x12		288	35.25		10,152
EPKS	ENCLOSED PORCH - KNEEWALL SCREEN	144846	12x8		96	40.15		3,854



Rogers

Assessment Property Record Card for Tax Year 2026

Data provided by LISA DELOZIER County Assessor

Date 04/17/2026
 Time 03:19:36
 Page 3

Sketch Image

660002343

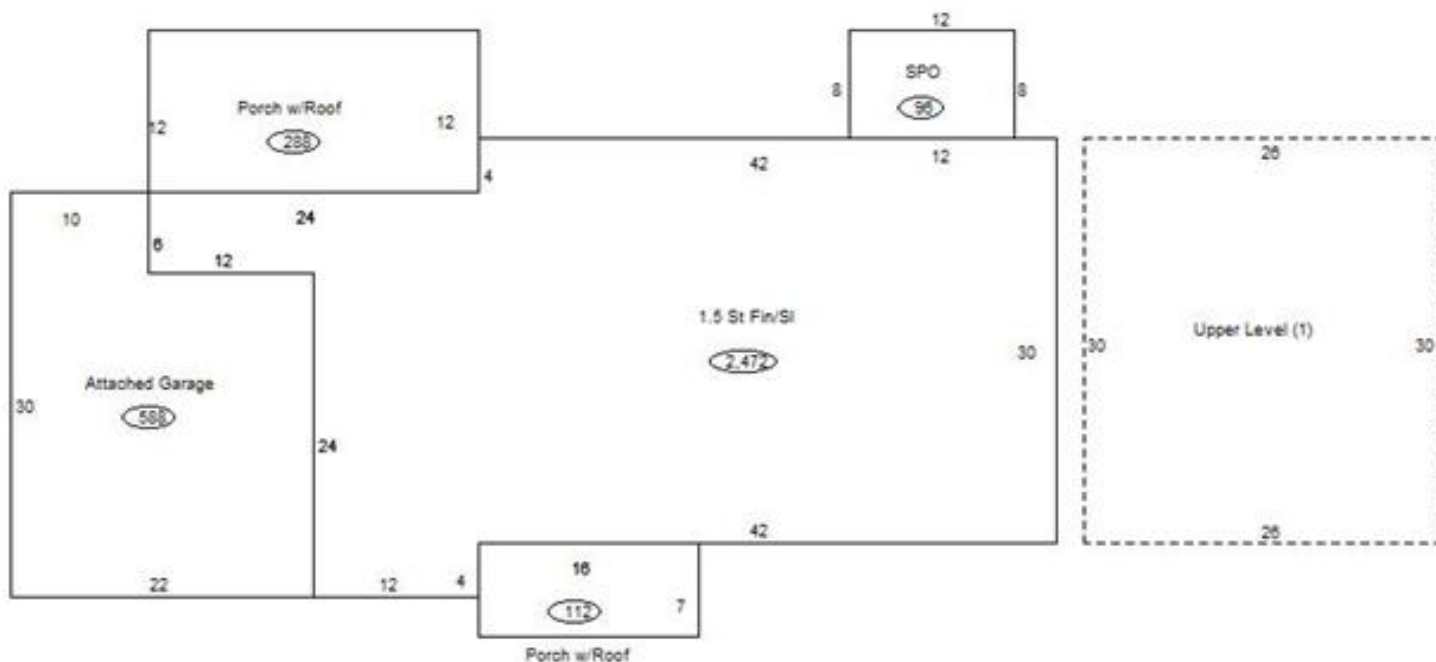

Sketch Vector Information

Sequence	Code	Type	Built Over	Scale	Section Label	Base Area	Multiplier	Total Area
1	R	5	Slab	13	1.5 St Fin/Sl	1,692	1.461	2,472
2	G	1		13	Attached Garage	588	1.000	588
3	M	PRCH		13	SLBC	112	1.000	112
4	M	PRCH		13	SLBC	288	1.000	288
5	U	^UL		13	Upper Level (1)	780	1.000	780
6	M	EPKS		13	Screen Porch	96	1.000	96
Total Building Area						1,692		2,472