



# Rogers

## Assessment Property Record Card for Tax Year 2026

Data provided by LISA DELOZIER County Assessor

Date 04/18/2026  
 Time 06:59:53  
 Page 1

Assessment Data					Primary Image									
Account	660002347													
Parcel ID	21N16E-03-2-00000-000-0000													
Cadastral ID	03-21-16-03100													
Property Type	REAL - Real Property													
Property Class	RR	VI Area 1												
Tax Area	18 - CLAREMORE RURAL/W/O FIRE													
Name ID	310741													
KING, MARILYN R														
19055 S QUINTON WAY CLAREMORE OK 74017-0000														
Parcel Location														
Situs	19055 QUINTON WAY													
Subdivision														
Lot/Block	/	Parcel Size	1 - Acres											
Sec/Twn/Rng	3 / 21 / 16 / 2													
Neighborhood	2116 - UNPLATTED													
School District	S001 - CLAREMORE SCHOOLS													
Legal Description Lat/Long: 36.33550476 -95.58825056														
TR IN GOVT LOT 3 DESC AS: BEG AT NE/C OF LOT 3; TH S 192.96' TO POB; TH S 192.96'; TH W 226'; TH N 192.95'; TH E 226' TO POB DESCRIBED IN WD 1563-620 ALSO PREVIOUSLY DESCRIBED AS S 192.96' N 385.915' E 226' LOT 3														
Building Permits														
<table border="1"> <thead> <tr> <th>Number</th> <th>Description</th> <th>Opened</th> <th>Closed</th> <th>Amount</th> </tr> </thead> <tbody> <tr> <td></td> <td></td> <td></td> <td></td> <td></td> </tr> </tbody> </table>					Number	Description	Opened	Closed	Amount					
Number	Description	Opened	Closed	Amount										
Exemptions														
Code	Type	Active	Maximum	Exemption	Sale History									
H	Homestead	Yes	1,000	1,000	Bk/Pg	Grantor	Date	Price	Code					
					2359/68	PETERMAN, LUTHER J &	09/25/2013	0	4					
					2169/104	BRINKER, GLENDENE TRUSTEE	04/27/2011	0	4					
					1563/620	BRINKER, JOE E	02/02/2004	0	4					
					1169/838	DENNIS, GLENDENE (BRINKER)	05/03/1999	0	No					
Parcel Valuation														
Source	REAL		Fair Cash	Capped	Asmnt Level	Assessed	Levy Rate	92.430	Current Tax					
Remove Cap	0	Land Value	39,145	25,868	11%	2,845	Assessed	19,859	1,835.57					
Year Frozen	2017	Improvements	234,071	154,679		17,014	Penalty	0						
Uncapped Value	0	Mobile Home	0	0		0	Exemption	1,000	-93.00					
TIF Project ID	0	Total Value	273,216	180,547		19,859	Total Taxable	18,859	1,743.00					
Assessment History														
Tax Year	Statement Number	Billed Owner			Tax Area	Total Value	Exemptions	Taxable Value	Billed Tax					
2025	2025-660002347	KING, MARILYN R			18	246,680	1000	18,860	1,743.00					
2024	2024-660002347	KING, MARILYN R			18	270,425	1000	18,860	1,743.00					
2023	2023-660002347	KING, MARILYN R			18	232,862	1000	18,860	1,728.00					
2022	2022-660002347	KING, MARILYN R			18	231,281	1000	18,860	1,746.00					
2021	2021-660002347	KING, MARILYN R			18	222,087	1000	18,861	1,665.00					
2020	2020-660002347	KING, MARILYN R			18	220,799	1000	18,861	1,727.00					
2019	2019-660002347	KING, MARILYN R			18	209,843	1000	18,860	1,747.00					
2018	2018-660002347	KING, MARILYN R			18	216,313	1000	18,860	1,743.00					
2017	2017-660002347	KING, MARILYN R			18	214,560	1000	18,860	1,730.00					
2016	2016-660002347	KING, MARILYN R			18	209,163	1000	18,282	1,714.00					
2015	2015-660002347	KING, MARILYN R			18	196,628	1000	17,720	1,595.00					
2014	2014-660002347	KING, MARILYN R			18	201,808	1000	17,175	1,593.00					
2013	2013-660002347	KING, MARILYN R			18	191,190	1000	16,646	1,523.00					



# Rogers

## Assessment Property Record Card for Tax Year 2026

Data provided by LISA DELOZIER County Assessor

Date 04/18/2026  
 Time 06:59:54  
 Page 2

Lot Data	Square-Foot - NBHD 2116 #1	Primary Image
<b>Lot Size</b> <b>Lot Count</b> <b>Units Buildable</b> 1 <b>Non-Ag Acres</b> 1.0424 <b>Topography</b> <b>Street Access</b> <b>Utilities</b> <b>Amenities</b> LAND QUALITY 0 0 <b>Method</b> Square-Foot <b>Base Lot Value</b> 45,406.00 x .86 = 39,145 <b>Factor Value</b> <b>Adjustments</b> 1.0000 <b>Lot Value</b> 39,145		

Residential Data	
<b>Type</b>	1 Single Family Residence
<b>Condition</b>	3 - Average
<b>Quality</b>	3.5 - Average
<b>Architecture</b>	
<b>Style</b>	100% 1 1/2 Story Finished
<b>Exterior Wall</b>	100% Veneer, Masonry
<b>Base/Total Area</b>	1,824 / 2,592
<b>Style</b>	100% 1 1/2 Story Finished
<b>HVAC</b>	100% Warmed & Cooled Air
<b>Roof Cover</b>	1 Composition Shingle
<b>Area on Slab</b>	1,824
<b>Fixture/RghIn</b>	14 /
<b>Bed/F/H Bath</b>	4 / 2.5 /
<b>Basement Area</b>	
<b>Garage Type</b>	576 Attached Garage - Unfinished
<b>Remodel</b>	
<b>Year/Eff Age</b>	1976 / 38



\\tsclient\T\LOGAN\LOGAN RESIDENTIAL VI\2023-3-30\IMG\_002! 3/30/2023

GRM Approach	
<b>GRM Code</b>	
<b>Gross Rent</b>	0.00
<b>Indicated Value</b>	

Multiple Regression			
<b>MRA Code</b>	1	Test	
<b>Adusted R</b>	0.8445		
<b>Indicated Value</b>	322,626	124.47	Per SqFt

Direct Comparables	
<b>Selection Model</b>	A Adam Test
<b>Adjustment Model</b>	NewTest
<b>Comparables</b>	
<b>Indicated Value</b>	

Cost Approach				Manual : 01/2025			
<b>Base Cost</b>	100.18	<b>Total Misc Impr</b>	+ 33,824				
<b>Roofing Adj</b>	+ 3.86	<b>Garage Cost</b>	+ 22,205				
<b>Subfloor Adj</b>	+ -2.47	<b>Total RCN</b>	= 379,174				
<b>Heat/Cool Adj</b>	+ 14.47	<b>Depreciation ( 45%)</b>	- 170,628				
<b>Plumbing Adj</b>	+ 8.63	<b>Lump Sums</b>	+ 0				
<b>Basement Adj</b>	+ 0.00	<b>RCNLD</b>	= 208,546				
<b>Adj Base Cost</b>	= 124.67	<b>Lot Value</b>	+ 39,145				
<b>Total Area</b>	x 2,592	<b>Indicated Value</b>	= 247,691				
<b>Adjusted Cost</b>	= 323,145	<b>Value Per SqFt</b>	95.56				

Value Reconciliation			
<b>Selected Approach</b>	Cost Approach		
<b>Improvements</b>	208,546		
<b>Lot Value</b>	39,145		
<b>Indicated Value</b>	247,691	95.56	Per SqFt
<b>Agland Value</b>			
<b>Site Improvements</b>	25,525		
<b>Total Value</b>	273,216	105.41	Total Value Per SqFt

Miscellaneous Improvements								
Code	Description	Sketch ID	Size	Year	Units	Unit Cost	Depr	Value
FPR1	FIREPLACE - RESIDENTIAL 1 STORY	0		1	1	6,429.63		6,430
PRCH	SLAB PORCH - COVERED	6198	20x4		80	29.27		2,342
EPSW	ENCLOSED PORCH - SOLID WALL	6199	24x14		336	74.56		25,052



**Rogers**  
**Assessment Property Record Card for Tax Year 2026**

Data provided by LISA DELOZIER County Assessor

Date 04/18/2026  
 Time 06:59:54  
 Page 3

Sketch Image

660002347

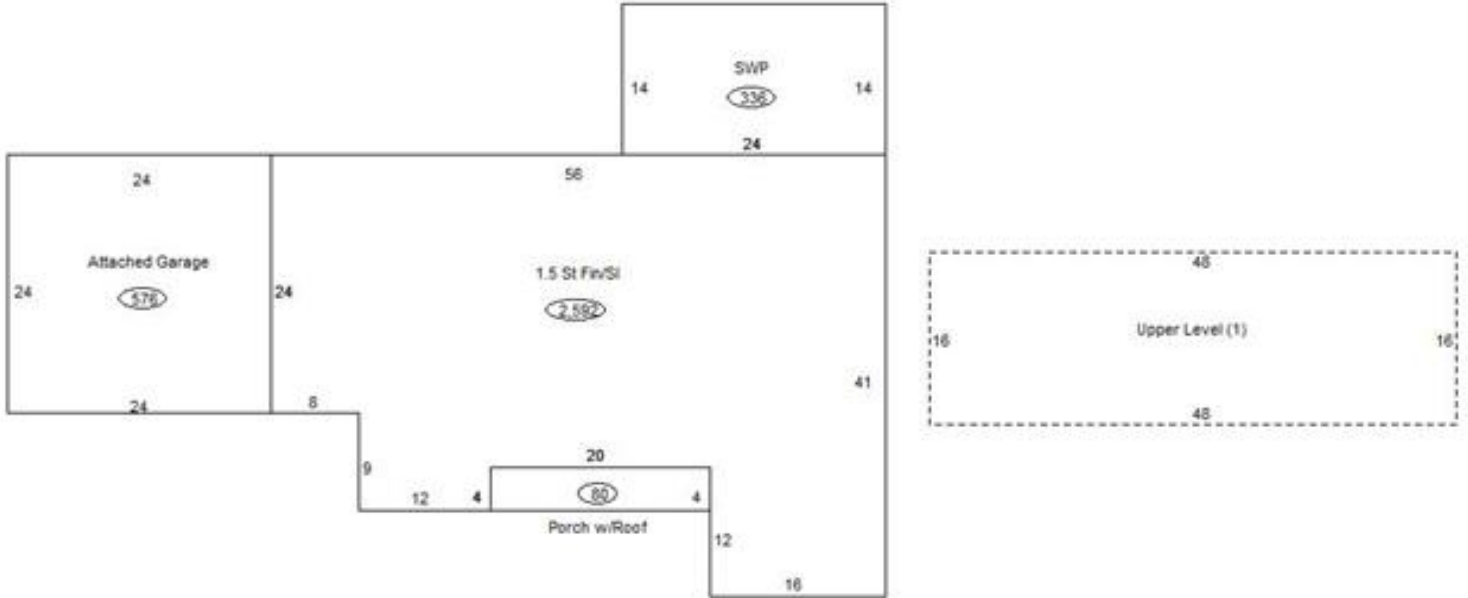

**Sketch Vector Information**

Sequence	Code	Type	Built Over	Scale	Section Label	Base Area	Multiplier	Total Area
1	R	5	Slab	13	1.5 St Fin/Sl	1,824	1.421	2,592
2	G	1		13	Attached Garage	576	1.000	576
3	M	PRCH		13	SLBC	80	1.000	80
4	M	EPSW		13	EPSW	336	1.000	336
5	U	^UL		13	Upper Level (1)	768	1.000	768
<b>Total Building Area</b>						1,824		2,592



# Rogers

## Assessment Property Record Card for Tax Year 2026

Data provided by LISA DELOZIER County Assessor

Date 04/18/2026  
Time 06:59:54  
Page 4

660002347

### Outbuildings/Site Improvements

Building Image	Code	Description	Dimensions	Floor	Roofing	Total Units
	UTIL	SHOP BUILDING	0x0x0			960
	Qual 2	Cond 3	Year	Eff Age		
<b>Valuation Summary</b>		<b>Modifier Total</b>	<b>RCN</b>	<b>Depr (15% Phys/ % Func)</b>	<b>RCNLD</b>	
Base Cost (31.28 x 960)		30,029	30,029	4,504	25,525	