



# Rogers

## Assessment Property Record Card for Tax Year 2026

Data provided by LISA DELOZIER County Assessor

Date 04/17/2026  
Time 03:19:42  
Page 1

Assessment Data					Primary Image																																																																																																																				
<b>Account</b> 660002353 <b>Parcel ID</b> 000000-00-0-10429-001-0004 <b>Cadastral ID</b> 03-21-16-03530 <b>Property Type</b> REAL - Real Property <b>Property Class</b> URP VI Area 1 <b>Tax Area</b> 17 - CLAREMORE OT <b>Name ID</b> 93414 OSBORNE, GLORIA  2950 WEBER RD CLAREMORE OK 74017-0000  <b>Parcel Location</b> <b>Situs</b> 02950 WEBER RD <b>Subdivision</b> LAKE PARK ESTATES <b>Lot/Block</b> 0004 / 0001 <b>Parcel Size</b> 1 - Lots <b>Sec/Twn/Rng</b> 3 / 21 / 16 / 5 <b>Neighborhood</b> 1173 - R-V01-SE CLAREMORE <b>School District</b> S001 - CLAREMORE SCHOOLS																																																																																																																									
<b>Legal Description</b> Lot/Long: 36.33590819 -95.58665436																																																																																																																									
<b>Building Permits</b>					<table border="1"> <thead> <tr> <th>Number</th> <th>Description</th> <th>Opened</th> <th>Closed</th> <th>Amount</th> </tr> </thead> <tbody> <tr> <td colspan="5"> </td> </tr> </tbody> </table>					Number	Description	Opened	Closed	Amount																																																																																																											
Number	Description	Opened	Closed	Amount																																																																																																																					
<b>Exemptions</b>					<b>Sale History</b>																																																																																																																				
<table border="1"> <thead> <tr> <th>Code</th> <th>Type</th> <th>Active</th> <th>Maximum</th> <th>Exemption</th> </tr> </thead> <tbody> <tr> <td>H</td> <td>Homestead</td> <td>Yes</td> <td>1,000</td> <td>1,000</td> </tr> </tbody> </table>					Code	Type	Active	Maximum	Exemption	H	Homestead	Yes	1,000	1,000	<table border="1"> <thead> <tr> <th>Bk/Pg</th> <th>Grantor</th> <th>Date</th> <th>Price</th> <th>Code</th> </tr> </thead> <tbody> <tr> <td>/</td> <td>OSBORNE, MIKE &amp;</td> <td>08/13/2019</td> <td>0</td> <td>4</td> </tr> <tr> <td>836/221</td> <td></td> <td></td> <td>77,000</td> <td>No</td> </tr> </tbody> </table>					Bk/Pg	Grantor	Date	Price	Code	/	OSBORNE, MIKE &	08/13/2019	0	4	836/221			77,000	No																																																																																							
Code	Type	Active	Maximum	Exemption																																																																																																																					
H	Homestead	Yes	1,000	1,000																																																																																																																					
Bk/Pg	Grantor	Date	Price	Code																																																																																																																					
/	OSBORNE, MIKE &	08/13/2019	0	4																																																																																																																					
836/221			77,000	No																																																																																																																					
<b>Parcel Valuation</b>																																																																																																																									
<table border="1"> <thead> <tr> <th>Source</th> <th>REAL</th> <th>Fair Cash</th> <th>Capped</th> <th>Asmnt Level</th> <th>Assessed</th> <th>Levy Rate</th> <th>92.430</th> <th>Current Tax</th> </tr> </thead> <tbody> <tr> <td>Remove Cap</td> <td>0</td> <td>Land Value 75,802</td> <td>42,439</td> <td>11%</td> <td>4,668</td> <td>Assessed</td> <td>16,288</td> <td>1,505.50</td> </tr> <tr> <td>Year Frozen</td> <td>2012</td> <td>Improvements 188,680</td> <td>105,636</td> <td></td> <td>11,620</td> <td>Penalty</td> <td>0</td> <td></td> </tr> <tr> <td>Uncapped Value</td> <td>0</td> <td>Mobile Home 0</td> <td>0</td> <td></td> <td>0</td> <td>Exemption</td> <td>1,000</td> <td>-92.00</td> </tr> <tr> <td>TIF Project ID</td> <td>0</td> <td>Total Value 264,482</td> <td>148,075</td> <td></td> <td>16,288</td> <td>Total Taxable</td> <td>15,288</td> <td>1,413.00</td> </tr> </tbody> </table>		Source	REAL	Fair Cash	Capped	Asmnt Level	Assessed	Levy Rate	92.430	Current Tax	Remove Cap	0	Land Value 75,802	42,439	11%	4,668	Assessed	16,288	1,505.50	Year Frozen	2012	Improvements 188,680	105,636		11,620	Penalty	0		Uncapped Value	0	Mobile Home 0	0		0	Exemption	1,000	-92.00	TIF Project ID	0	Total Value 264,482	148,075		16,288	Total Taxable	15,288	1,413.00	<b>Assessment History</b>																																																																										
Source	REAL	Fair Cash	Capped	Asmnt Level	Assessed	Levy Rate	92.430	Current Tax																																																																																																																	
Remove Cap	0	Land Value 75,802	42,439	11%	4,668	Assessed	16,288	1,505.50																																																																																																																	
Year Frozen	2012	Improvements 188,680	105,636		11,620	Penalty	0																																																																																																																		
Uncapped Value	0	Mobile Home 0	0		0	Exemption	1,000	-92.00																																																																																																																	
TIF Project ID	0	Total Value 264,482	148,075		16,288	Total Taxable	15,288	1,413.00																																																																																																																	
<table border="1"> <thead> <tr> <th>Tax Year</th> <th>Statement Number</th> <th>Billed Owner</th> <th>Tax Area</th> <th>Total Value</th> <th>Exemptions</th> <th>Taxable Value</th> <th>Billed Tax</th> </tr> </thead> <tbody> <tr><td>2025</td><td>2025-660002353</td><td>OSBORNE, GLORIA</td><td>17</td><td>261,103</td><td>1000</td><td>15,289</td><td>1,413.00</td></tr> <tr><td>2024</td><td>2024-660002353</td><td>OSBORNE, GLORIA</td><td>17</td><td>262,548</td><td>1000</td><td>15,289</td><td>1,413.00</td></tr> <tr><td>2023</td><td>2023-660002353</td><td>OSBORNE, GLORIA</td><td>17</td><td>191,955</td><td>1000</td><td>15,288</td><td>1,400.00</td></tr> <tr><td>2022</td><td>2022-660002353</td><td>OSBORNE, GLORIA</td><td>17</td><td>191,948</td><td>1000</td><td>15,288</td><td>1,415.00</td></tr> <tr><td>2021</td><td>2021-660002353</td><td>OSBORNE, GLORIA</td><td>17</td><td>199,732</td><td>1000</td><td>15,289</td><td>1,350.00</td></tr> <tr><td>2020</td><td>2020-660002353</td><td>OSBORNE, GLORIA</td><td>17</td><td>198,683</td><td>1000</td><td>15,289</td><td>1,400.00</td></tr> <tr><td>2019</td><td>2019-660002353</td><td>OSBORNE, GLORIA</td><td>17</td><td>188,653</td><td>1000</td><td>15,289</td><td>1,416.00</td></tr> <tr><td>2018</td><td>2018-660002353</td><td>OSBORNE, MIKE &amp;</td><td>17</td><td>194,480</td><td>1000</td><td>15,288</td><td>1,413.00</td></tr> <tr><td>2017</td><td>2017-660002353</td><td>OSBORNE, MIKE &amp;</td><td>17</td><td>192,864</td><td>1000</td><td>15,288</td><td>1,404.00</td></tr> <tr><td>2016</td><td>2016-660002353</td><td>OSBORNE, MIKE &amp;</td><td>17</td><td>187,786</td><td>1000</td><td>15,288</td><td>1,435.00</td></tr> <tr><td>2015</td><td>2015-660002353</td><td>OSBORNE, MIKE &amp;</td><td>17</td><td>182,841</td><td>1000</td><td>15,288</td><td>1,379.00</td></tr> <tr><td>2014</td><td>2014-660002353</td><td>OSBORNE, MIKE &amp;</td><td>17</td><td>188,219</td><td>1000</td><td>15,288</td><td>1,418.00</td></tr> <tr><td>2013</td><td>2013-660002353</td><td>OSBORNE, MIKE &amp;</td><td>17</td><td>177,809</td><td>1000</td><td>15,288</td><td>1,399.00</td></tr> </tbody> </table>										Tax Year	Statement Number	Billed Owner	Tax Area	Total Value	Exemptions	Taxable Value	Billed Tax	2025	2025-660002353	OSBORNE, GLORIA	17	261,103	1000	15,289	1,413.00	2024	2024-660002353	OSBORNE, GLORIA	17	262,548	1000	15,289	1,413.00	2023	2023-660002353	OSBORNE, GLORIA	17	191,955	1000	15,288	1,400.00	2022	2022-660002353	OSBORNE, GLORIA	17	191,948	1000	15,288	1,415.00	2021	2021-660002353	OSBORNE, GLORIA	17	199,732	1000	15,289	1,350.00	2020	2020-660002353	OSBORNE, GLORIA	17	198,683	1000	15,289	1,400.00	2019	2019-660002353	OSBORNE, GLORIA	17	188,653	1000	15,289	1,416.00	2018	2018-660002353	OSBORNE, MIKE &	17	194,480	1000	15,288	1,413.00	2017	2017-660002353	OSBORNE, MIKE &	17	192,864	1000	15,288	1,404.00	2016	2016-660002353	OSBORNE, MIKE &	17	187,786	1000	15,288	1,435.00	2015	2015-660002353	OSBORNE, MIKE &	17	182,841	1000	15,288	1,379.00	2014	2014-660002353	OSBORNE, MIKE &	17	188,219	1000	15,288	1,418.00	2013	2013-660002353	OSBORNE, MIKE &	17	177,809	1000	15,288	1,399.00
Tax Year	Statement Number	Billed Owner	Tax Area	Total Value	Exemptions	Taxable Value	Billed Tax																																																																																																																		
2025	2025-660002353	OSBORNE, GLORIA	17	261,103	1000	15,289	1,413.00																																																																																																																		
2024	2024-660002353	OSBORNE, GLORIA	17	262,548	1000	15,289	1,413.00																																																																																																																		
2023	2023-660002353	OSBORNE, GLORIA	17	191,955	1000	15,288	1,400.00																																																																																																																		
2022	2022-660002353	OSBORNE, GLORIA	17	191,948	1000	15,288	1,415.00																																																																																																																		
2021	2021-660002353	OSBORNE, GLORIA	17	199,732	1000	15,289	1,350.00																																																																																																																		
2020	2020-660002353	OSBORNE, GLORIA	17	198,683	1000	15,289	1,400.00																																																																																																																		
2019	2019-660002353	OSBORNE, GLORIA	17	188,653	1000	15,289	1,416.00																																																																																																																		
2018	2018-660002353	OSBORNE, MIKE &	17	194,480	1000	15,288	1,413.00																																																																																																																		
2017	2017-660002353	OSBORNE, MIKE &	17	192,864	1000	15,288	1,404.00																																																																																																																		
2016	2016-660002353	OSBORNE, MIKE &	17	187,786	1000	15,288	1,435.00																																																																																																																		
2015	2015-660002353	OSBORNE, MIKE &	17	182,841	1000	15,288	1,379.00																																																																																																																		
2014	2014-660002353	OSBORNE, MIKE &	17	188,219	1000	15,288	1,418.00																																																																																																																		
2013	2013-660002353	OSBORNE, MIKE &	17	177,809	1000	15,288	1,399.00																																																																																																																		



# Rogers

## Assessment Property Record Card for Tax Year 2026

Data provided by LISA DELOZIER County Assessor

Date 04/17/2026  
Time 03:19:42  
Page 2

Lot Data	Square-Foot - NBHD 1173 #1	Primary Image
<b>Lot Size</b> <b>Lot Count</b> <b>Units Buildable</b> 1 <b>Non-Ag Acres</b> 0.9668 <b>Topography</b> <b>Street Access</b> <b>Utilities</b> <b>Amenities</b> LAND QUALITY 0 0 <b>Method</b> Square-Foot <b>Base Lot Value</b> 42,112.00 x 1.80 = 75,802 <b>Factor Value</b> <b>Adjustments</b> 1.0000 <b>Lot Value</b> 75,802		

Residential Data	
<b>Type</b>	1 Single Family Residence
<b>Condition</b>	3 - Average
<b>Quality</b>	3 - Average
<b>Architecture</b>	R3 Res Nbhd 3
<b>Style</b>	100% One Story
<b>Exterior Wall</b>	50% Veneer, Stone 50% Frame, Siding, Vinyl
<b>Base/Total Area</b>	2,292 / 2,292
<b>Style</b>	100% One Story
<b>HVAC</b>	100% Warmed & Cooled Air
<b>Roof Cover</b>	1 Composition Shingle
<b>Area on Slab</b>	2,292
<b>Fixture/RghIn</b>	11 /
<b>Bed/F/H Bath</b>	3 / 2.0 /
<b>Basement Area</b>	
<b>Garage Type</b>	1,214 Attached Garage - Unfinished
<b>Remodel</b>	
<b>Year/Eff Age</b>	1980 / 35

GRM Approach
<b>GRM Code</b> <b>Gross Rent</b> 0.00 <b>Indicated Value</b>

Multiple Regression
<b>MRA Code</b> 1 Test <b>Adusted R</b> 0.8445 <b>Indicated Value</b> 303,950 132.61 Per SqFt

Direct Comparables
<b>Selection Model</b> A Adam Test <b>Adjustment Model</b> 1 2022 Residential <b>Comparables</b> 2 <b>Indicated Value</b> 299,280 Per SqFt

Cost Approach		Manual : 01/2025	
<b>Base Cost</b>	100.48	<b>Total Misc Impr</b>	+ 15,159
<b>Roofing Adj</b>	+ 4.46	<b>Garage Cost</b>	+ 36,165
<b>Subfloor Adj</b>	+ -2.32	<b>Total RCN</b>	= 331,017
<b>Heat/Cool Adj</b>	+ 12.64	<b>Depreciation ( 43%)</b>	- 142,337
<b>Plumbing Adj</b>	+ 6.77	<b>Lump Sums</b>	+ 0
<b>Basement Adj</b>	+ 0.00	<b>RCNLD</b>	= 188,680
<b>Adj Base Cost</b>	= 122.03	<b>Lot Value</b>	+ 75,802
<b>Total Area</b>	x 2,292	<b>Indicated Value</b>	= 264,482
<b>Adjusted Cost</b>	= 279,693	<b>Value Per SqFt</b>	115.39

Value Reconciliation
<b>Selected Approach</b> Cost Approach <b>Improvements</b> 188,680 <b>Lot Value</b> 75,802 <b>Indicated Value</b> 264,482 115.39 Per SqFt <b>Agland Value</b> <b>Site Improvements</b> <b>Total Value</b> 264,482 115.39 Total Value Per SqFt

Miscellaneous Improvements								
Code	Description	Sketch ID	Size	Year	Units	Unit Cost	Depr	Value
FPR1	FIREPLACE - RESIDENTIAL 1 STORY	0		1	1	5,615.40		5,615
PRCH	SLAB PORCH - COVERED	6221	7x4		28	26.84		752
PRCH	SLAB PORCH - COVERED	6222	340		340	25.86		8,792



# Rogers

## Assessment Property Record Card for Tax Year 2026

Data provided by LISA DELOZIER County Assessor

Date 04/17/2026  
 Time 03:19:42  
 Page 3

### Sketch Image

660002353

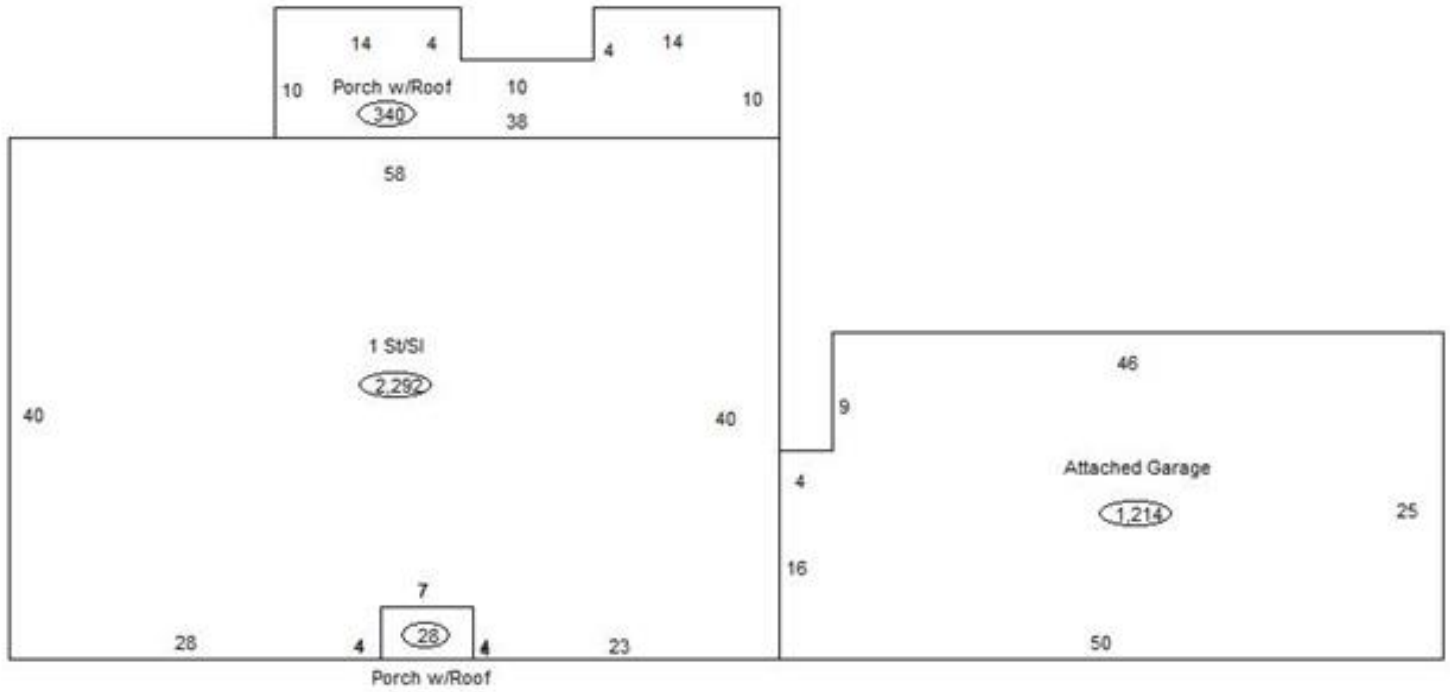

### Sketch Vector Information

Sequence	Code	Type	Built Over	Scale	Section Label	Base Area	Multiplier	Total Area
1	R	1	Slab	13	1 St/SI	2,292	1.000	2,292
2	G	1		13	Attached Garage	1,214	1.000	1,214
3	M	PRCH		13	SLBC	28	1.000	28
4	M	PRCH		13	SLBC	340	1.000	340
<b>Total Building Area</b>						2,292		2,292



# Rogers

## Assessment Property Record Card for Tax Year 2026

Data provided by LISA DELOZIER County Assessor

Date 04/17/2026  
Time 03:19:42  
Page 4

660002353

### Outbuildings/Site Improvements

Building Image	Code	Description	Dimensions	Floor	Roofing	Total Units
	STF	STG FAIR	0x0x0			
	Qual	2	Cond	Year	Eff Age	
<b>Valuation Summary</b>			<b>Modifier Total</b>	<b>RCN</b>	<b>Depr (0% Phys/ % Func)</b>	<b>RCNLD</b>
		Base Cost (4.68 x )				