



# Rogers

## Assessment Property Record Card for Tax Year 2026

Data provided by LISA DELOZIER County Assessor

Date 04/17/2026  
 Time 08:49:44  
 Page 1

Assessment Data					Primary Image																																																																																																																				
<b>Account</b> 660002386 <b>Parcel ID</b> 000000-00-0-10429-003-0015 <b>Cadastral ID</b> 03-21-16-03860 <b>Property Type</b> REAL - Real Property <b>Property Class</b> URP VI Area 1 <b>Tax Area</b> 17 - CLAREMORE OT <b>Name ID</b> 347590 MCCUTCHAN, PAULA & JAMIE ROLF  1295 EASY ST CLAREMORE OK 74017-0000  <b>Parcel Location</b> <b>Situs</b> 01295 EASY ST <b>Subdivision</b> LAKE PARK ESTATES <b>Lot/Block</b> 0015 / 0003 <b>Parcel Size</b> 1 - Lots <b>Sec/Twn/Rng</b> 3 / 21 / 16 / 5 <b>Neighborhood</b> 1173 - R-V01-SE CLAREMORE <b>School District</b> S001 - CLAREMORE SCHOOLS																																																																																																																									
<b>Legal Description</b> Lot/Long: 36.33313840 -95.58310401																																																																																																																									
<b>Legal Description</b> LOT 15 BLOCK 3 LAKE PARK ESTATES					<b>Building Permits</b> <table border="1"> <thead> <tr> <th>Number</th> <th>Description</th> <th>Opened</th> <th>Closed</th> <th>Amount</th> </tr> </thead> <tbody> <tr> <td> </td> <td> </td> <td> </td> <td> </td> <td> </td> </tr> </tbody> </table>					Number	Description	Opened	Closed	Amount																																																																																																											
Number	Description	Opened	Closed	Amount																																																																																																																					
<b>Exemptions</b> <table border="1"> <thead> <tr> <th>Code</th> <th>Type</th> <th>Active</th> <th>Maximum</th> <th>Exemption</th> </tr> </thead> <tbody> <tr> <td>HV</td> <td>Veteran</td> <td>Yes</td> <td>999,999</td> <td>42,900</td> </tr> <tr> <td>H</td> <td>Homestead</td> <td>No</td> <td>1,000</td> <td> </td> </tr> </tbody> </table>					Code	Type	Active	Maximum	Exemption	HV	Veteran	Yes	999,999	42,900	H	Homestead	No	1,000		<b>Sale History</b> <table border="1"> <thead> <tr> <th>Bk/Pg</th> <th>Grantor</th> <th>Date</th> <th>Price</th> <th>Code</th> </tr> </thead> <tbody> <tr> <td>/</td> <td>CAMPBELL, WILLIAM H &amp;</td> <td>07/07/2025</td> <td>390,000</td> <td>YES</td> </tr> </tbody> </table>					Bk/Pg	Grantor	Date	Price	Code	/	CAMPBELL, WILLIAM H &	07/07/2025	390,000	YES																																																																																							
Code	Type	Active	Maximum	Exemption																																																																																																																					
HV	Veteran	Yes	999,999	42,900																																																																																																																					
H	Homestead	No	1,000																																																																																																																						
Bk/Pg	Grantor	Date	Price	Code																																																																																																																					
/	CAMPBELL, WILLIAM H &	07/07/2025	390,000	YES																																																																																																																					
<b>Parcel Valuation</b> <table border="1"> <thead> <tr> <th>Source</th> <th>REAL</th> <th>Fair Cash</th> <th>Capped</th> <th>Asmnt Level</th> <th>Assessed</th> <th>Levy Rate</th> <th>92.430</th> <th>Current Tax</th> </tr> </thead> <tbody> <tr> <td>Remove Cap</td> <td>2026</td> <td>Land Value</td> <td>131,525</td> <td>131,525</td> <td>11%</td> <td>14,468</td> <td>Assessed</td> <td>42,900 3,965.25</td> </tr> <tr> <td>Year Frozen</td> <td>0</td> <td>Improvements</td> <td>258,476</td> <td>258,476</td> <td> </td> <td>28,432</td> <td>Penalty</td> <td>0</td> </tr> <tr> <td>Uncapped Value</td> <td>0</td> <td>Mobile Home</td> <td>0</td> <td>0</td> <td> </td> <td>0</td> <td>Exemption</td> <td>42,900 -3,965.00</td> </tr> <tr> <td>TIF Project ID</td> <td>0</td> <td>Total Value</td> <td>390,001</td> <td>390,001</td> <td> </td> <td>42,900</td> <td>Total Taxable</td> <td>0 0.00</td> </tr> </tbody> </table>										Source	REAL	Fair Cash	Capped	Asmnt Level	Assessed	Levy Rate	92.430	Current Tax	Remove Cap	2026	Land Value	131,525	131,525	11%	14,468	Assessed	42,900 3,965.25	Year Frozen	0	Improvements	258,476	258,476		28,432	Penalty	0	Uncapped Value	0	Mobile Home	0	0		0	Exemption	42,900 -3,965.00	TIF Project ID	0	Total Value	390,001	390,001		42,900	Total Taxable	0 0.00																																																																			
Source	REAL	Fair Cash	Capped	Asmnt Level	Assessed	Levy Rate	92.430	Current Tax																																																																																																																	
Remove Cap	2026	Land Value	131,525	131,525	11%	14,468	Assessed	42,900 3,965.25																																																																																																																	
Year Frozen	0	Improvements	258,476	258,476		28,432	Penalty	0																																																																																																																	
Uncapped Value	0	Mobile Home	0	0		0	Exemption	42,900 -3,965.00																																																																																																																	
TIF Project ID	0	Total Value	390,001	390,001		42,900	Total Taxable	0 0.00																																																																																																																	
<b>Assessment History</b> <table border="1"> <thead> <tr> <th>Tax Year</th> <th>Statement Number</th> <th>Billed Owner</th> <th>Tax Area</th> <th>Total Value</th> <th>Exemptions</th> <th>Taxable Value</th> <th>Billed Tax</th> </tr> </thead> <tbody> <tr><td>2025</td><td>2025-660002386</td><td>MCCUTCHAN, PAULA &amp;</td><td>17</td><td>304,015</td><td>1000</td><td>27,464</td><td>2,538.00</td></tr> <tr><td>2024</td><td>2024-660002386</td><td>CAMPBELL, WILLIAM H &amp;</td><td>17</td><td>308,889</td><td>1000</td><td>26,634</td><td>2,462.00</td></tr> <tr><td>2023</td><td>2023-660002386</td><td>CAMPBELL, WILLIAM H &amp;</td><td>17</td><td>243,904</td><td>1000</td><td>25,829</td><td>2,366.00</td></tr> <tr><td>2022</td><td>2022-660002386</td><td>CAMPBELL, WILLIAM H &amp;</td><td>17</td><td>239,398</td><td>1000</td><td>25,049</td><td>2,319.00</td></tr> <tr><td>2021</td><td>2021-660002386</td><td>CAMPBELL, WILLIAM H &amp;</td><td>17</td><td>229,913</td><td>1000</td><td>24,290</td><td>2,145.00</td></tr> <tr><td>2020</td><td>2020-660002386</td><td>CAMPBELL, WILLIAM H &amp;</td><td>17</td><td>228,374</td><td>1000</td><td>23,555</td><td>2,157.00</td></tr> <tr><td>2019</td><td>2019-660002386</td><td>CAMPBELL, WILLIAM H &amp;</td><td>17</td><td>216,729</td><td>1000</td><td>22,840</td><td>2,115.00</td></tr> <tr><td>2018</td><td>2018-660002386</td><td>CAMPBELL, WILLIAM H &amp;</td><td>17</td><td>225,580</td><td>1000</td><td>23,814</td><td>2,200.00</td></tr> <tr><td>2017</td><td>2017-660002386</td><td>CAMPBELL, WILLIAM H &amp;</td><td>17</td><td>223,429</td><td>1000</td><td>23,577</td><td>2,165.00</td></tr> <tr><td>2016</td><td>2016-660002386</td><td>CAMPBELL, WILLIAM H &amp;</td><td>17</td><td>217,728</td><td>1000</td><td>22,870</td><td>2,147.00</td></tr> <tr><td>2015</td><td>2015-660002386</td><td>CAMPBELL, WILLIAM H &amp;</td><td>17</td><td>210,682</td><td>1000</td><td>22,175</td><td>2,000.00</td></tr> <tr><td>2014</td><td>2014-660002386</td><td>CAMPBELL, WILLIAM H &amp;</td><td>17</td><td>212,541</td><td>1000</td><td>21,684</td><td>2,011.00</td></tr> <tr><td>2013</td><td>2013-660002386</td><td>CAMPBELL, WILLIAM H &amp;</td><td>17</td><td>200,212</td><td>1000</td><td>21,023</td><td>1,924.00</td></tr> </tbody> </table>										Tax Year	Statement Number	Billed Owner	Tax Area	Total Value	Exemptions	Taxable Value	Billed Tax	2025	2025-660002386	MCCUTCHAN, PAULA &	17	304,015	1000	27,464	2,538.00	2024	2024-660002386	CAMPBELL, WILLIAM H &	17	308,889	1000	26,634	2,462.00	2023	2023-660002386	CAMPBELL, WILLIAM H &	17	243,904	1000	25,829	2,366.00	2022	2022-660002386	CAMPBELL, WILLIAM H &	17	239,398	1000	25,049	2,319.00	2021	2021-660002386	CAMPBELL, WILLIAM H &	17	229,913	1000	24,290	2,145.00	2020	2020-660002386	CAMPBELL, WILLIAM H &	17	228,374	1000	23,555	2,157.00	2019	2019-660002386	CAMPBELL, WILLIAM H &	17	216,729	1000	22,840	2,115.00	2018	2018-660002386	CAMPBELL, WILLIAM H &	17	225,580	1000	23,814	2,200.00	2017	2017-660002386	CAMPBELL, WILLIAM H &	17	223,429	1000	23,577	2,165.00	2016	2016-660002386	CAMPBELL, WILLIAM H &	17	217,728	1000	22,870	2,147.00	2015	2015-660002386	CAMPBELL, WILLIAM H &	17	210,682	1000	22,175	2,000.00	2014	2014-660002386	CAMPBELL, WILLIAM H &	17	212,541	1000	21,684	2,011.00	2013	2013-660002386	CAMPBELL, WILLIAM H &	17	200,212	1000	21,023	1,924.00
Tax Year	Statement Number	Billed Owner	Tax Area	Total Value	Exemptions	Taxable Value	Billed Tax																																																																																																																		
2025	2025-660002386	MCCUTCHAN, PAULA &	17	304,015	1000	27,464	2,538.00																																																																																																																		
2024	2024-660002386	CAMPBELL, WILLIAM H &	17	308,889	1000	26,634	2,462.00																																																																																																																		
2023	2023-660002386	CAMPBELL, WILLIAM H &	17	243,904	1000	25,829	2,366.00																																																																																																																		
2022	2022-660002386	CAMPBELL, WILLIAM H &	17	239,398	1000	25,049	2,319.00																																																																																																																		
2021	2021-660002386	CAMPBELL, WILLIAM H &	17	229,913	1000	24,290	2,145.00																																																																																																																		
2020	2020-660002386	CAMPBELL, WILLIAM H &	17	228,374	1000	23,555	2,157.00																																																																																																																		
2019	2019-660002386	CAMPBELL, WILLIAM H &	17	216,729	1000	22,840	2,115.00																																																																																																																		
2018	2018-660002386	CAMPBELL, WILLIAM H &	17	225,580	1000	23,814	2,200.00																																																																																																																		
2017	2017-660002386	CAMPBELL, WILLIAM H &	17	223,429	1000	23,577	2,165.00																																																																																																																		
2016	2016-660002386	CAMPBELL, WILLIAM H &	17	217,728	1000	22,870	2,147.00																																																																																																																		
2015	2015-660002386	CAMPBELL, WILLIAM H &	17	210,682	1000	22,175	2,000.00																																																																																																																		
2014	2014-660002386	CAMPBELL, WILLIAM H &	17	212,541	1000	21,684	2,011.00																																																																																																																		
2013	2013-660002386	CAMPBELL, WILLIAM H &	17	200,212	1000	21,023	1,924.00																																																																																																																		



# Rogers

## Assessment Property Record Card for Tax Year 2026

Data provided by LISA DELOZIER County Assessor

Date 04/17/2026  
Time 08:49:44  
Page 2

Lot Data	Square-Foot - NBHD 1173 #1	Primary Image
Lot Size		
Lot Count		
Units Buildable	1	
Non-Ag Acres	0.9997	
Topography		
Street Access		
Utilities		
Amenities	LAND QUALITY	
	0	
	0	
Method	Square-Foot	
Base Lot Value	43,545.00 x 1.80 = 78,381	
Factor Value		
Adjustments	1.6780	
Lot Value	131,525	

Residential Data	
Type	1 Single Family Residence
Condition	3.5 - Average
Quality	4 - Good
Architecture	R3 Res Nbhd 3
Style	100% 1 1/2 Story Finished
Exterior Wall	100% Veneer, Masonry
Base/Total Area	2,728 / 2,868
Style	100% 1 1/2 Story Finished
HVAC	100% Warmed & Cooled Air
Roof Cover	1 Composition Shingle
Area on Slab	2,728
Fixture/RghIn	14 /
Bed/F/H Bath	3 / 2.5 /
Basement Area	
Garage Type	576 Attached Garage - Unfinished
Remodel	
Year/Eff Age	1979 / 32

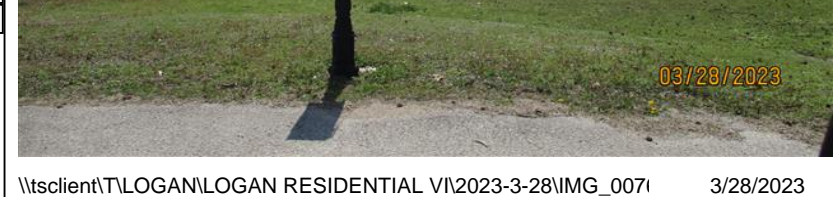

\\tsclient\T\LOGAN\LOGAN RESIDENTIAL VI\2023-3-28\IMG\_007I 3/28/2023

GRM Approach	
GRM Code	
Gross Rent	0.00
Indicated Value	

Multiple Regression			
MRA Code	1	Test	
Adusted R	0.8445		
Indicated Value	372,267	129.80	Per SqFt

Direct Comparables			
Selection Model	A	Adam Test	
Adjustment Model	1	2022 Residential	
Comparables	5		
Indicated Value	333,750		Per SqFt

Cost Approach				Manual : 01/2025			
Base Cost	103.29	Total Misc Impr	+	9,472			
Roofing Adj	+ 5.46	Garage Cost	+	27,101			
Subfloor Adj	+ -4.23	Total RCN	=	408,294			
Heat/Cool Adj	+ 16.31	Depreciation ( 40%)	-	163,318			
Plumbing Adj	+ 8.78	Lump Sums	+	0			
Basement Adj	+ 0.00	RCNLD	=	244,976			
Adj Base Cost	= 129.61	Lot Value	+	131,525			
Total Area	x 2,868	Indicated Value	=	376,501			
Adjusted Cost	= 371,721	Value Per SqFt		131.28			

Value Reconciliation			
Selected Approach	Cost Approach		
Improvements	244,976		
Lot Value	131,525		
Indicated Value	376,501	131.28	Per SqFt
Agland Value			
Site Improvements	13,500		
Total Value	390,001	135.98	Total Value Per SqFt

Miscellaneous Improvements								
Code	Description	Sketch ID	Size	Year	Units	Unit Cost	Depr	Value
FPR1	FIREPLACE - RESIDENTIAL 1 STORY	0		1	1	7,243.87		7,244
PRCH	SLAB PORCH - COVERED	6380	8x2		16	33.14		530
PATO	SLAB PORCH - OPEN	6381	15x8		120	14.15		1,698



# Rogers

## Assessment Property Record Card for Tax Year 2026

Data provided by LISA DELOZIER County Assessor

Date 04/17/2026  
 Time 08:49:44  
 Page 3

### Sketch Image

660002386

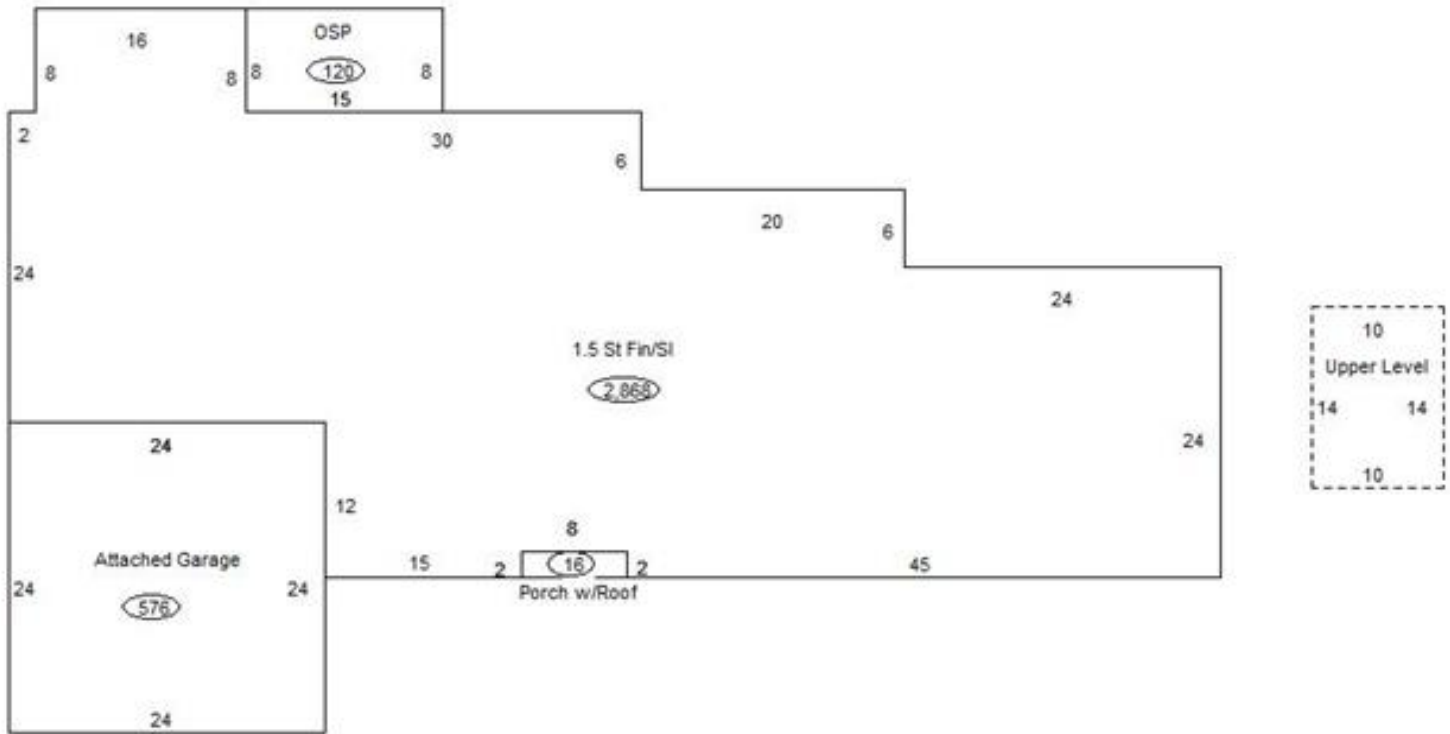

### Sketch Vector Information

Sequence	Code	Type	Built Over	Scale	Section Label	Base Area	Multiplier	Total Area
1	R	5	Slab	13	1.5 St Fin/Sl	2,728	1.051	2,868
2	G	1		13	Attached Garage	576	1.000	576
3	U	^UL	Overhang	13	Upper Level	140	1.000	140
4	M	PRCH		13	SLBC	16	1.000	16
5	M	PATO		13	Open Slab	120	1.000	120
<b>Total Building Area</b>						<b>2,728</b>		<b>2,868</b>



# Rogers

## Assessment Property Record Card for Tax Year 2026

Data provided by LISA DELOZIER County Assessor

Date 04/17/2026  
 Time 08:49:44  
 Page 4

660002386

### Outbuildings/Site Improvements

Building Image	Code	Description	Dimensions	Floor	Roofing	Total Units
	SG	SWIM-GUNITE	0x0x0			1
	Qual 3	Cond 3	Year	Eff Age		
		<b>Valuation Summary</b>	<b>Modifier Total</b>	<b>RCN</b>	<b>Depr (55% Phys/ % Func)</b>	<b>RCNLD</b>
		Base Cost (30,000.00 x 1)	30,000	30,000	16,500	13,500
	STF	STG FAIR	0x0x0			
	Qual 2	Cond	Year	Eff Age		
		<b>Valuation Summary</b>	<b>Modifier Total</b>	<b>RCN</b>	<b>Depr (0% Phys/ % Func)</b>	<b>RCNLD</b>
		Base Cost (4.68 x )				