



# Rogers

## Assessment Property Record Card for Tax Year 2026

Data provided by LISA DELOZIER County Assessor

Date 04/17/2026  
 Time 03:11:10  
 Page 1

Assessment Data					Primary Image																																																																																																																				
<b>Account</b> 660002400 <b>Parcel ID</b> 000000-00-0-10285-001-0006 <b>Cadastral ID</b> 03-21-16-04660 <b>Property Type</b> REAL - Real Property <b>Property Class</b> URP VI Area 1 <b>Tax Area</b> 17 - CLAREMORE OT <b>Name ID</b> 340359 WALDSCHMIDT, STEVE & DIANNA INTER VIVOS TRUST  1601 NE OAKRIDGE DR CLAREMORE OK 74017-0000  <b>Parcel Location</b> <b>Situs</b> 01601 OAK RIDGE DR <b>Subdivision</b> OAK RIDGE ESTATES I <b>Lot/Block</b> 0006 / 0001 <b>Parcel Size</b> 1 - Lots <b>Sec/Twn/Rng</b> 3 / 21 / 16 / 5 <b>Neighborhood</b> 1173 - R-V01-SE CLAREMORE <b>School District</b> S001 - CLAREMORE SCHOOLS																																																																																																																									
<b>Legal Description</b> Lat/Long: 36.32432892 -95.59132729																																																																																																																									
<b>Legal Description</b> Lot 6 Block 1 OAK RIDGE ESTATES I					<b>Building Permits</b> <table border="1"> <thead> <tr> <th>Number</th> <th>Description</th> <th>Opened</th> <th>Closed</th> <th>Amount</th> </tr> </thead> <tbody> <tr> <td> </td> <td> </td> <td> </td> <td> </td> <td> </td> </tr> </tbody> </table>					Number	Description	Opened	Closed	Amount																																																																																																											
Number	Description	Opened	Closed	Amount																																																																																																																					
<b>Exemptions</b> <table border="1"> <thead> <tr> <th>Code</th> <th>Type</th> <th>Active</th> <th>Maximum</th> <th>Exemption</th> </tr> </thead> <tbody> <tr> <td>H</td> <td>Homestead</td> <td>No</td> <td>1,000</td> <td> </td> </tr> </tbody> </table>					Code	Type	Active	Maximum	Exemption	H	Homestead	No	1,000		<b>Sale History</b> <table border="1"> <thead> <tr> <th>Bk/Pg</th> <th>Grantor</th> <th>Date</th> <th>Price</th> <th>Code</th> </tr> </thead> <tbody> <tr> <td>/</td> <td>WILLHOITE, MARY LEOTA</td> <td>12/07/2022</td> <td>410,000</td> <td>YES</td> </tr> <tr> <td>/</td> <td>WILLHOITE, MARY LEOTA-TRUSTEE</td> <td>09/12/2022</td> <td>0</td> <td>4</td> </tr> <tr> <td>/</td> <td>WILLHOITE, MARY LEOTA</td> <td>01/14/2022</td> <td>0</td> <td>WB</td> </tr> <tr> <td>2472/833</td> <td>WILLHOITE, JOHN D &amp;</td> <td>05/12/2015</td> <td>0</td> <td>4</td> </tr> <tr> <td>1577/501</td> <td>DOPP, DAVID V &amp;</td> <td>04/05/2004</td> <td>210,000</td> <td>YES</td> </tr> <tr> <td>845/303</td> <td> </td> <td> </td> <td>155,000</td> <td>No</td> </tr> </tbody> </table>					Bk/Pg	Grantor	Date	Price	Code	/	WILLHOITE, MARY LEOTA	12/07/2022	410,000	YES	/	WILLHOITE, MARY LEOTA-TRUSTEE	09/12/2022	0	4	/	WILLHOITE, MARY LEOTA	01/14/2022	0	WB	2472/833	WILLHOITE, JOHN D &	05/12/2015	0	4	1577/501	DOPP, DAVID V &	04/05/2004	210,000	YES	845/303			155,000	No																																																																			
Code	Type	Active	Maximum	Exemption																																																																																																																					
H	Homestead	No	1,000																																																																																																																						
Bk/Pg	Grantor	Date	Price	Code																																																																																																																					
/	WILLHOITE, MARY LEOTA	12/07/2022	410,000	YES																																																																																																																					
/	WILLHOITE, MARY LEOTA-TRUSTEE	09/12/2022	0	4																																																																																																																					
/	WILLHOITE, MARY LEOTA	01/14/2022	0	WB																																																																																																																					
2472/833	WILLHOITE, JOHN D &	05/12/2015	0	4																																																																																																																					
1577/501	DOPP, DAVID V &	04/05/2004	210,000	YES																																																																																																																					
845/303			155,000	No																																																																																																																					
<b>Parcel Valuation</b> <table border="1"> <thead> <tr> <th>Source</th> <th>REAL</th> <th>Fair Cash</th> <th>Capped</th> <th>Asmnt Level</th> <th>Assessed</th> <th>Levy Rate</th> <th>92.430</th> <th>Current Tax</th> </tr> </thead> <tbody> <tr> <td>Remove Cap</td> <td>2023</td> <td>Land Value 140,341</td> <td>140,341</td> <td>11%</td> <td>15,438</td> <td>Assessed</td> <td>45,162</td> <td>4,174.32</td> </tr> <tr> <td>Year Frozen</td> <td>0</td> <td>Improvements 270,221</td> <td>270,221</td> <td> </td> <td>29,724</td> <td>Penalty</td> <td>0</td> <td> </td> </tr> <tr> <td>Uncapped Value</td> <td>0</td> <td>Mobile Home 0</td> <td>0</td> <td> </td> <td>0</td> <td>Exemption</td> <td>0</td> <td>0.00</td> </tr> <tr> <td>TIF Project ID</td> <td>0</td> <td>Total Value 410,562</td> <td>410,562</td> <td> </td> <td>45,162</td> <td>Total Taxable</td> <td>45,162</td> <td>4,174.00</td> </tr> </tbody> </table>										Source	REAL	Fair Cash	Capped	Asmnt Level	Assessed	Levy Rate	92.430	Current Tax	Remove Cap	2023	Land Value 140,341	140,341	11%	15,438	Assessed	45,162	4,174.32	Year Frozen	0	Improvements 270,221	270,221		29,724	Penalty	0		Uncapped Value	0	Mobile Home 0	0		0	Exemption	0	0.00	TIF Project ID	0	Total Value 410,562	410,562		45,162	Total Taxable	45,162	4,174.00																																																																			
Source	REAL	Fair Cash	Capped	Asmnt Level	Assessed	Levy Rate	92.430	Current Tax																																																																																																																	
Remove Cap	2023	Land Value 140,341	140,341	11%	15,438	Assessed	45,162	4,174.32																																																																																																																	
Year Frozen	0	Improvements 270,221	270,221		29,724	Penalty	0																																																																																																																		
Uncapped Value	0	Mobile Home 0	0		0	Exemption	0	0.00																																																																																																																	
TIF Project ID	0	Total Value 410,562	410,562		45,162	Total Taxable	45,162	4,174.00																																																																																																																	
<b>Assessment History</b> <table border="1"> <thead> <tr> <th>Tax Year</th> <th>Statement Number</th> <th>Billed Owner</th> <th>Tax Area</th> <th>Total Value</th> <th>Exemptions</th> <th>Taxable Value</th> <th>Billed Tax</th> </tr> </thead> <tbody> <tr><td>2025</td><td>2025-660002400</td><td>WALDSCHMIDT, STEVE &amp; DIANNA</td><td>17</td><td>409,059</td><td>0</td><td>44,997</td><td>4,159.00</td></tr> <tr><td>2024</td><td>2024-660002400</td><td>WALDSCHMIDT, STEVE &amp; DIANNA</td><td>17</td><td>410,000</td><td>0</td><td>45,100</td><td>4,168.00</td></tr> <tr><td>2023</td><td>2023-660002400</td><td>WALDSCHMIDT, STEVE &amp; DIANNA</td><td>17</td><td>410,000</td><td>0</td><td>45,100</td><td>4,131.00</td></tr> <tr><td>2022</td><td>2022-660002400</td><td>WILLHOITE, MARY LEOTA</td><td>17</td><td>244,733</td><td>1000</td><td>25,921</td><td>2,400.00</td></tr> <tr><td>2021</td><td>2021-660002400</td><td>WILLHOITE, MARY LEOTA</td><td>17</td><td>254,331</td><td>1000</td><td>26,976</td><td>2,382.00</td></tr> <tr><td>2020</td><td>2020-660002400</td><td>WILLHOITE, MARY LEOTA</td><td>17</td><td>250,159</td><td>1000</td><td>26,517</td><td>2,428.00</td></tr> <tr><td>2019</td><td>2019-660002400</td><td>WILLHOITE, MARY LEOTA</td><td>17</td><td>267,169</td><td>1000</td><td>28,389</td><td>2,629.00</td></tr> <tr><td>2018</td><td>2018-660002400</td><td>WILLHOITE, MARY LEOTA</td><td>17</td><td>277,957</td><td>1000</td><td>29,179</td><td>2,696.00</td></tr> <tr><td>2017</td><td>2017-660002400</td><td>WILLHOITE, MARY LEOTA</td><td>17</td><td>275,633</td><td>1000</td><td>28,300</td><td>2,599.00</td></tr> <tr><td>2016</td><td>2016-660002400</td><td>WILLHOITE, MARY LEOTA</td><td>17</td><td>268,338</td><td>1000</td><td>27,446</td><td>2,576.00</td></tr> <tr><td>2015</td><td>2015-660002400</td><td>WILLHOITE, MARY LEOTA</td><td>17</td><td>282,694</td><td>1000</td><td>26,618</td><td>2,401.00</td></tr> <tr><td>2014</td><td>2014-660002400</td><td>WILLHOITE, JOHN D &amp;</td><td>17</td><td>284,952</td><td>1000</td><td>25,814</td><td>2,394.00</td></tr> <tr><td>2013</td><td>2013-660002400</td><td>WILLHOITE, JOHN D &amp;</td><td>17</td><td>268,472</td><td>1000</td><td>25,033</td><td>2,291.00</td></tr> </tbody> </table>										Tax Year	Statement Number	Billed Owner	Tax Area	Total Value	Exemptions	Taxable Value	Billed Tax	2025	2025-660002400	WALDSCHMIDT, STEVE & DIANNA	17	409,059	0	44,997	4,159.00	2024	2024-660002400	WALDSCHMIDT, STEVE & DIANNA	17	410,000	0	45,100	4,168.00	2023	2023-660002400	WALDSCHMIDT, STEVE & DIANNA	17	410,000	0	45,100	4,131.00	2022	2022-660002400	WILLHOITE, MARY LEOTA	17	244,733	1000	25,921	2,400.00	2021	2021-660002400	WILLHOITE, MARY LEOTA	17	254,331	1000	26,976	2,382.00	2020	2020-660002400	WILLHOITE, MARY LEOTA	17	250,159	1000	26,517	2,428.00	2019	2019-660002400	WILLHOITE, MARY LEOTA	17	267,169	1000	28,389	2,629.00	2018	2018-660002400	WILLHOITE, MARY LEOTA	17	277,957	1000	29,179	2,696.00	2017	2017-660002400	WILLHOITE, MARY LEOTA	17	275,633	1000	28,300	2,599.00	2016	2016-660002400	WILLHOITE, MARY LEOTA	17	268,338	1000	27,446	2,576.00	2015	2015-660002400	WILLHOITE, MARY LEOTA	17	282,694	1000	26,618	2,401.00	2014	2014-660002400	WILLHOITE, JOHN D &	17	284,952	1000	25,814	2,394.00	2013	2013-660002400	WILLHOITE, JOHN D &	17	268,472	1000	25,033	2,291.00
Tax Year	Statement Number	Billed Owner	Tax Area	Total Value	Exemptions	Taxable Value	Billed Tax																																																																																																																		
2025	2025-660002400	WALDSCHMIDT, STEVE & DIANNA	17	409,059	0	44,997	4,159.00																																																																																																																		
2024	2024-660002400	WALDSCHMIDT, STEVE & DIANNA	17	410,000	0	45,100	4,168.00																																																																																																																		
2023	2023-660002400	WALDSCHMIDT, STEVE & DIANNA	17	410,000	0	45,100	4,131.00																																																																																																																		
2022	2022-660002400	WILLHOITE, MARY LEOTA	17	244,733	1000	25,921	2,400.00																																																																																																																		
2021	2021-660002400	WILLHOITE, MARY LEOTA	17	254,331	1000	26,976	2,382.00																																																																																																																		
2020	2020-660002400	WILLHOITE, MARY LEOTA	17	250,159	1000	26,517	2,428.00																																																																																																																		
2019	2019-660002400	WILLHOITE, MARY LEOTA	17	267,169	1000	28,389	2,629.00																																																																																																																		
2018	2018-660002400	WILLHOITE, MARY LEOTA	17	277,957	1000	29,179	2,696.00																																																																																																																		
2017	2017-660002400	WILLHOITE, MARY LEOTA	17	275,633	1000	28,300	2,599.00																																																																																																																		
2016	2016-660002400	WILLHOITE, MARY LEOTA	17	268,338	1000	27,446	2,576.00																																																																																																																		
2015	2015-660002400	WILLHOITE, MARY LEOTA	17	282,694	1000	26,618	2,401.00																																																																																																																		
2014	2014-660002400	WILLHOITE, JOHN D &	17	284,952	1000	25,814	2,394.00																																																																																																																		
2013	2013-660002400	WILLHOITE, JOHN D &	17	268,472	1000	25,033	2,291.00																																																																																																																		



# Rogers

## Assessment Property Record Card for Tax Year 2026

Data provided by LISA DELOZIER County Assessor

Date 04/17/2026  
 Time 03:11:10  
 Page 2

Lot Data		Square-Foot - NBHD 1173 #1	
Lot Size			
Lot Count			
Units Buildable	1		
Non-Ag Acres	2.3706		
Topography			
Street Access			
Utilities			
Amenities	LAND QUALITY	0	0
Method	Square-Foot		
Base Lot Value	103,263.00 x 1.18 =	121,730	
Factor Value			
Adjustments	1.1529		
Lot Value	140,341		



\\tsclient\T\LOGAN\LOGAN RESIDENTIAL VI\2023-3-28\IMG\_0001 3/28/2023

Residential Data	
Type	1 Single Family Residence
Condition	3 - Average
Quality	4 - Good
Architecture	
Style	100% One Story
Exterior Wall	90% Veneer, Masonry 10% Frame, Siding, Wood
Base/Total Area	2,659 / 2,659
Style	100% One Story
HVAC	100% Warmed & Cooled Air
Roof Cover	1 Composition Shingle
Area on Slab	2,659
Fixture/RghIn	14 /
Bed/F/H Bath	3 / 2.0 / 1.0
Basement Area	
Garage Type	644 Attached Garage - Unfinished
Remodel	
Year/Eff Age	1989 / 28

GRM Approach	
GRM Code	
Gross Rent	0.00
Indicated Value	

Multiple Regression			
MRA Code	1	Test	
Adusted R	0.8445		
Indicated Value	354,284	133.24	Per SqFt

Direct Comparables			
Selection Model	A	Adam Test	
Adjustment Model	1	2022 Residential	
Comparables	5		
Indicated Value	356,900		Per SqFt

Cost Approach		Manual : 01/2025	
Base Cost	111.10	Total Misc Impr	+ 18,737
Roofing Adj	+ 5.75	Garage Cost	+ 29,727
Subfloor Adj	+ -4.51	Total RCN	= 415,725
Heat/Cool Adj	+ 16.31	Depreciation ( 35%)	- 145,504
Plumbing Adj	+ 9.47	Lump Sums	+ 0
Basement Adj	+ 0.00	RCNLD	= 270,221
Adj Base Cost	= 138.12	Lot Value	+ 140,341
Total Area	x 2,659	Indicated Value	= 410,562
Adjusted Cost	= 367,261	Value Per SqFt	154.40

Value Reconciliation			
Selected Approach	Cost Approach		
Improvements	270,221		
Lot Value	140,341		
Indicated Value	410,562	154.40	Per SqFt
Agland Value			
Site Improvements			
Total Value	410,562	154.40	Total Value Per SqFt

Miscellaneous Improvements								
Code	Description	Sketch ID	Size	Year	Units	Unit Cost	Depr	Value
FPR1	FIREPLACE - RESIDENTIAL 1 STORY	0		1	1	7,243.87		7,244
PRCH	SLAB PORCH - COVERED	6424	8x5		40	33.07		1,323
PRCH	SLAB PORCH - COVERED	6425	319		319	31.88		10,170



**Rogers**  
**Assessment Property Record Card for Tax Year 2026**

Data provided by LISA DELOZIER County Assessor

Date 04/17/2026  
 Time 03:11:10  
 Page 3

Sketch Image

660002400

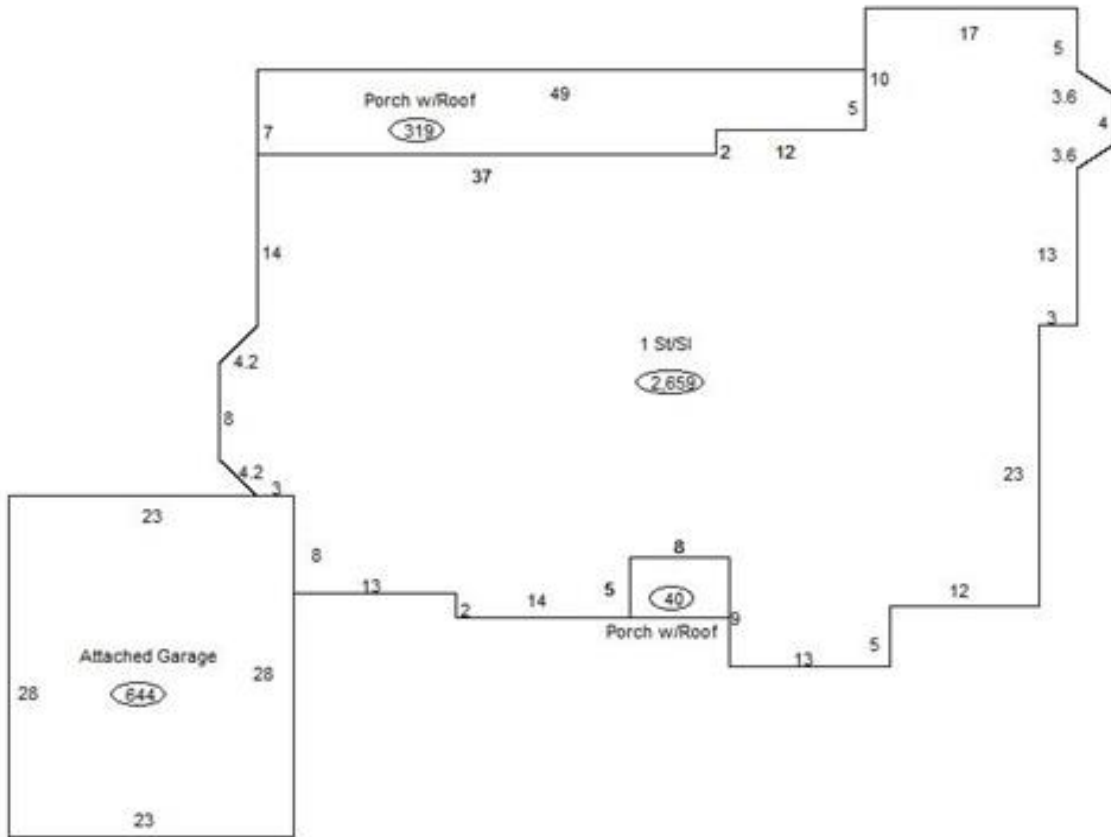

**Sketch Vector Information**

Sequence	Code	Type	Built Over	Scale	Section Label	Base Area	Multiplier	Total Area
1	R	1	Slab	13	1 St/Sl	2,659	1.000	2,659
2	G	1		13	Attached Garage	644	1.000	644
3	M	PRCH		13	SLBC	40	1.000	40
4	M	PRCH		13	SLBC	319	1.000	319
<b>Total Building Area</b>						2,659		2,659