



# Rogers

## Assessment Property Record Card for Tax Year 2026

Data provided by LISA DELOZIER County Assessor

Date 04/17/2026  
 Time 05:14:40  
 Page 1

Assessment Data					Primary Image																																																																																																																				
<b>Account</b> 660002427 <b>Parcel ID</b> 000000-00-0-10285-001-0033 <b>Cadastral ID</b> 03-21-16-04930 <b>Property Type</b> REAL - Real Property <b>Property Class</b> URP VI Area 1 <b>Tax Area</b> 17 - CLAREMORE OT <b>Name ID</b> 285707 ALDERSON, PENNY TRUST  1007 OAK RIDGE CIR CLAREMORE OK 74017-0000  <b>Parcel Location</b> <b>Situs</b> 01007 OAK RIDGE CIR <b>Subdivision</b> OAK RIDGE ESTATES I <b>Lot/Block</b> 0033 / 0001 <b>Parcel Size</b> 1 - Lots <b>Sec/Twn/Rng</b> 3 / 21 / 16 / 5 <b>Neighborhood</b> 1173 - R-V01-SE CLAREMORE <b>School District</b> S001 - CLAREMORE SCHOOLS																																																																																																																									
<b>Legal Description</b> Lat/Long: 36.32220748 -95.58989503																																																																																																																									
<b>Building Permits</b>					<table border="1"> <thead> <tr> <th>Number</th> <th>Description</th> <th>Opened</th> <th>Closed</th> <th>Amount</th> </tr> </thead> <tbody> <tr> <td colspan="5"> </td> </tr> </tbody> </table>					Number	Description	Opened	Closed	Amount																																																																																																											
Number	Description	Opened	Closed	Amount																																																																																																																					
<b>Exemptions</b>					<b>Sale History</b>																																																																																																																				
<table border="1"> <thead> <tr> <th>Code</th> <th>Type</th> <th>Active</th> <th>Maximum</th> <th>Exemption</th> </tr> </thead> <tbody> <tr> <td colspan="5"> </td> </tr> </tbody> </table>					Code	Type	Active	Maximum	Exemption						<table border="1"> <thead> <tr> <th>Bk/Pg</th> <th>Grantor</th> <th>Date</th> <th>Price</th> <th>Code</th> </tr> </thead> <tbody> <tr> <td>/</td> <td>ALDERSON, PENNY</td> <td>11/29/2018</td> <td>0</td> <td>4</td> </tr> <tr> <td>1596/730</td> <td>ARROTT, JOHN L &amp;</td> <td>06/09/2004</td> <td>219,000</td> <td>YES</td> </tr> <tr> <td>831/207</td> <td></td> <td></td> <td>165,000</td> <td>No</td> </tr> </tbody> </table>					Bk/Pg	Grantor	Date	Price	Code	/	ALDERSON, PENNY	11/29/2018	0	4	1596/730	ARROTT, JOHN L &	06/09/2004	219,000	YES	831/207			165,000	No																																																																																		
Code	Type	Active	Maximum	Exemption																																																																																																																					
Bk/Pg	Grantor	Date	Price	Code																																																																																																																					
/	ALDERSON, PENNY	11/29/2018	0	4																																																																																																																					
1596/730	ARROTT, JOHN L &	06/09/2004	219,000	YES																																																																																																																					
831/207			165,000	No																																																																																																																					
<b>Parcel Valuation</b>																																																																																																																									
<table border="1"> <thead> <tr> <th>Source</th> <th>REAL</th> <th>Fair Cash</th> <th>Capped</th> <th>Asmnt Level</th> <th>Assessed</th> <th>Levy Rate</th> <th>92.430</th> <th>Current Tax</th> </tr> </thead> <tbody> <tr> <td>Remove Cap</td> <td>2005</td> <td>Land Value</td> <td>82,288</td> <td>44,252</td> <td>11%</td> <td>4,868</td> <td>Assessed</td> <td>33,855</td> </tr> <tr> <td>Year Frozen</td> <td>0</td> <td>Improvements</td> <td>263,514</td> <td>263,514</td> <td></td> <td>28,987</td> <td>Penalty</td> <td>0</td> </tr> <tr> <td>Uncapped Value</td> <td>0</td> <td>Mobile Home</td> <td>0</td> <td>0</td> <td></td> <td>0</td> <td>Exemption</td> <td>0.00</td> </tr> <tr> <td>TIF Project ID</td> <td>0</td> <td>Total Value</td> <td>345,802</td> <td>307,766</td> <td></td> <td>33,855</td> <td>Total Taxable</td> <td>33,855</td> </tr> </tbody> </table>		Source	REAL	Fair Cash	Capped	Asmnt Level	Assessed	Levy Rate	92.430	Current Tax	Remove Cap	2005	Land Value	82,288	44,252	11%	4,868	Assessed	33,855	Year Frozen	0	Improvements	263,514	263,514		28,987	Penalty	0	Uncapped Value	0	Mobile Home	0	0		0	Exemption	0.00	TIF Project ID	0	Total Value	345,802	307,766		33,855	Total Taxable	33,855																																																																											
Source	REAL	Fair Cash	Capped	Asmnt Level	Assessed	Levy Rate	92.430	Current Tax																																																																																																																	
Remove Cap	2005	Land Value	82,288	44,252	11%	4,868	Assessed	33,855																																																																																																																	
Year Frozen	0	Improvements	263,514	263,514		28,987	Penalty	0																																																																																																																	
Uncapped Value	0	Mobile Home	0	0		0	Exemption	0.00																																																																																																																	
TIF Project ID	0	Total Value	345,802	307,766		33,855	Total Taxable	33,855																																																																																																																	
<b>Assessment History</b>																																																																																																																									
<table border="1"> <thead> <tr> <th>Tax Year</th> <th>Statement Number</th> <th>Billed Owner</th> <th>Tax Area</th> <th>Total Value</th> <th>Exemptions</th> <th>Taxable Value</th> <th>Billed Tax</th> </tr> </thead> <tbody> <tr><td>2025</td><td>2025-660002427</td><td>ALDERSON, PENNY TRUST</td><td>17</td><td>343,979</td><td>0</td><td>32,242</td><td>2,980.00</td></tr> <tr><td>2024</td><td>2024-660002427</td><td>ALDERSON, PENNY TRUST</td><td>17</td><td>350,890</td><td>0</td><td>30,707</td><td>2,838.00</td></tr> <tr><td>2023</td><td>2023-660002427</td><td>ALDERSON, PENNY TRUST</td><td>17</td><td>265,861</td><td>0</td><td>29,245</td><td>2,679.00</td></tr> <tr><td>2022</td><td>2022-660002427</td><td>ALDERSON, PENNY TRUST</td><td>17</td><td>269,067</td><td>0</td><td>29,597</td><td>2,740.00</td></tr> <tr><td>2021</td><td>2021-660002427</td><td>ALDERSON, PENNY TRUST</td><td>17</td><td>277,214</td><td>0</td><td>30,494</td><td>2,693.00</td></tr> <tr><td>2020</td><td>2020-660002427</td><td>ALDERSON, PENNY TRUST</td><td>17</td><td>272,593</td><td>0</td><td>29,985</td><td>2,746.00</td></tr> <tr><td>2019</td><td>2019-660002427</td><td>ALDERSON, PENNY TRUST</td><td>17</td><td>261,689</td><td>0</td><td>28,786</td><td>2,666.00</td></tr> <tr><td>2018</td><td>2018-660002427</td><td>ALDERSON, HAROLD G &amp;</td><td>17</td><td>271,638</td><td>0</td><td>29,880</td><td>2,761.00</td></tr> <tr><td>2017</td><td>2017-660002427</td><td>ALDERSON, HAROLD G &amp;</td><td>17</td><td>269,350</td><td>0</td><td>29,629</td><td>2,721.00</td></tr> <tr><td>2016</td><td>2016-660002427</td><td>ALDERSON, HAROLD G &amp;</td><td>17</td><td>262,149</td><td>0</td><td>28,836</td><td>2,707.00</td></tr> <tr><td>2015</td><td>2015-660002427</td><td>ALDERSON, HAROLD G &amp;</td><td>17</td><td>254,539</td><td>0</td><td>27,999</td><td>2,525.00</td></tr> <tr><td>2014</td><td>2014-660002427</td><td>ALDERSON, HAROLD G &amp;</td><td>17</td><td>256,631</td><td>0</td><td>27,874</td><td>2,585.00</td></tr> <tr><td>2013</td><td>2013-660002427</td><td>ALDERSON, HAROLD G &amp;</td><td>17</td><td>241,333</td><td>0</td><td>26,547</td><td>2,429.00</td></tr> </tbody> </table>										Tax Year	Statement Number	Billed Owner	Tax Area	Total Value	Exemptions	Taxable Value	Billed Tax	2025	2025-660002427	ALDERSON, PENNY TRUST	17	343,979	0	32,242	2,980.00	2024	2024-660002427	ALDERSON, PENNY TRUST	17	350,890	0	30,707	2,838.00	2023	2023-660002427	ALDERSON, PENNY TRUST	17	265,861	0	29,245	2,679.00	2022	2022-660002427	ALDERSON, PENNY TRUST	17	269,067	0	29,597	2,740.00	2021	2021-660002427	ALDERSON, PENNY TRUST	17	277,214	0	30,494	2,693.00	2020	2020-660002427	ALDERSON, PENNY TRUST	17	272,593	0	29,985	2,746.00	2019	2019-660002427	ALDERSON, PENNY TRUST	17	261,689	0	28,786	2,666.00	2018	2018-660002427	ALDERSON, HAROLD G &	17	271,638	0	29,880	2,761.00	2017	2017-660002427	ALDERSON, HAROLD G &	17	269,350	0	29,629	2,721.00	2016	2016-660002427	ALDERSON, HAROLD G &	17	262,149	0	28,836	2,707.00	2015	2015-660002427	ALDERSON, HAROLD G &	17	254,539	0	27,999	2,525.00	2014	2014-660002427	ALDERSON, HAROLD G &	17	256,631	0	27,874	2,585.00	2013	2013-660002427	ALDERSON, HAROLD G &	17	241,333	0	26,547	2,429.00
Tax Year	Statement Number	Billed Owner	Tax Area	Total Value	Exemptions	Taxable Value	Billed Tax																																																																																																																		
2025	2025-660002427	ALDERSON, PENNY TRUST	17	343,979	0	32,242	2,980.00																																																																																																																		
2024	2024-660002427	ALDERSON, PENNY TRUST	17	350,890	0	30,707	2,838.00																																																																																																																		
2023	2023-660002427	ALDERSON, PENNY TRUST	17	265,861	0	29,245	2,679.00																																																																																																																		
2022	2022-660002427	ALDERSON, PENNY TRUST	17	269,067	0	29,597	2,740.00																																																																																																																		
2021	2021-660002427	ALDERSON, PENNY TRUST	17	277,214	0	30,494	2,693.00																																																																																																																		
2020	2020-660002427	ALDERSON, PENNY TRUST	17	272,593	0	29,985	2,746.00																																																																																																																		
2019	2019-660002427	ALDERSON, PENNY TRUST	17	261,689	0	28,786	2,666.00																																																																																																																		
2018	2018-660002427	ALDERSON, HAROLD G &	17	271,638	0	29,880	2,761.00																																																																																																																		
2017	2017-660002427	ALDERSON, HAROLD G &	17	269,350	0	29,629	2,721.00																																																																																																																		
2016	2016-660002427	ALDERSON, HAROLD G &	17	262,149	0	28,836	2,707.00																																																																																																																		
2015	2015-660002427	ALDERSON, HAROLD G &	17	254,539	0	27,999	2,525.00																																																																																																																		
2014	2014-660002427	ALDERSON, HAROLD G &	17	256,631	0	27,874	2,585.00																																																																																																																		
2013	2013-660002427	ALDERSON, HAROLD G &	17	241,333	0	26,547	2,429.00																																																																																																																		



# Rogers

## Assessment Property Record Card for Tax Year 2026

Data provided by LISA DELOZIER County Assessor

Date 04/17/2026  
Time 05:14:40  
Page 2

Lot Data	Square-Foot - NBHD 1173 #1	Primary Image
<b>Lot Size</b> <b>Lot Count</b> <b>Units Buildable</b> 1 <b>Non-Ag Acres</b> 1.1048 <b>Topography</b> <b>Street Access</b> <b>Utilities</b> <b>Amenities</b> LAND QUALITY 0 0 <b>Method</b> Square-Foot <b>Base Lot Value</b> 48,125.00 x 1.71 = 82,288 <b>Factor Value</b> <b>Adjustments</b> 1.0000 <b>Lot Value</b> 82,288		
<b>Residential Data</b> <b>Type</b> 1 Single Family Residence <b>Condition</b> 3 - Average <b>Quality</b> 3.5 - Average <b>Architecture</b> R3 Res Nbhd 3 <b>Style</b> 100% One Story <b>Exterior Wall</b> 75% Veneer, Masonry 25% Frame, Siding, Wood <b>Base/Total Area</b> 2,689 / 2,689 <b>Style</b> 100% One Story <b>HVAC</b> 100% Warmed & Cooled Air <b>Roof Cover</b> 1 Composition Shingle <b>Area on Slab</b> 2,689 <b>Fixture/RghIn</b> 14 / <b>Bed/F/H Bath</b> 3 / 2.5 / <b>Basement Area</b> <b>Garage Type</b> 857 Attached Garage - Unfinished <b>Remodel</b> <b>Year/Eff Age</b> 1989 / 28		

\\tsclient\T\LOGAN\LOGAN RESIDENTIAL VI\2023-3-28\IMG\_003: 3/28/2023

GRM Approach	
<b>GRM Code</b>	
<b>Gross Rent</b>	0.00
<b>Indicated Value</b>	

Multiple Regression			
<b>MRA Code</b>	1	Test	
<b>Adusted R</b>	0.8445		
<b>Indicated Value</b>	343,272	127.66	Per SqFt

Direct Comparables			
<b>Selection Model</b>	A	Adam Test	
<b>Adjustment Model</b>	1	2022 Residential	
<b>Comparables</b>	5		
<b>Indicated Value</b>	381,470		Per SqFt

Value Reconciliation			
<b>Selected Approach</b>	Cost Approach		
<b>Improvements</b>	263,514		
<b>Lot Value</b>	82,288		
<b>Indicated Value</b>	345,802	128.60	Per SqFt
<b>Agland Value</b>			
<b>Site Improvements</b>			
<b>Total Value</b>	345,802	128.60	Total Value Per SqFt

Cost Approach				Manual : 01/2025			
<b>Base Cost</b>	105.35	<b>Total Misc Impr</b>	+ 14,808				
<b>Roofing Adj</b>	+ 5.11	<b>Garage Cost</b>	+ 31,889				
<b>Subfloor Adj</b>	+ -3.30	<b>Total RCN</b>	= 396,106				
<b>Heat/Cool Adj</b>	+ 14.47	<b>Depreciation ( 35%)</b>	- 138,637				
<b>Plumbing Adj</b>	+ 8.31	<b>Lump Sums</b>	+ 6,045				
<b>Basement Adj</b>	+ 0.00	<b>RCNLD</b>	= 263,514				
<b>Adj Base Cost</b>	= 129.94	<b>Lot Value</b>	+ 82,288				
<b>Total Area</b>	x 2,689	<b>Indicated Value</b>	= 345,802				
<b>Adjusted Cost</b>	= 349,409	<b>Value Per SqFt</b>	128.60				

Miscellaneous Improvements								
Code	Description	Sketch ID	Size	Year	Units	Unit Cost	Depr	Value
FPR1	FIREPLACE - RESIDENTIAL 1 STORY	0		1	1	6,429.63		6,430
PATO	SLAB PORCH - OPEN	6564		202	202	11.85		2,394
WODO	WOOD DECK - OPEN	6565		336	336	19.14	6%	6,045
PRCH	SLAB PORCH - COVERED	6566		208	208	28.77		5,984



# Rogers

## Assessment Property Record Card for Tax Year 2026

Data provided by LISA DELOZIER County Assessor

Date 04/17/2026  
 Time 05:14:40  
 Page 3

### Sketch Image

660002427

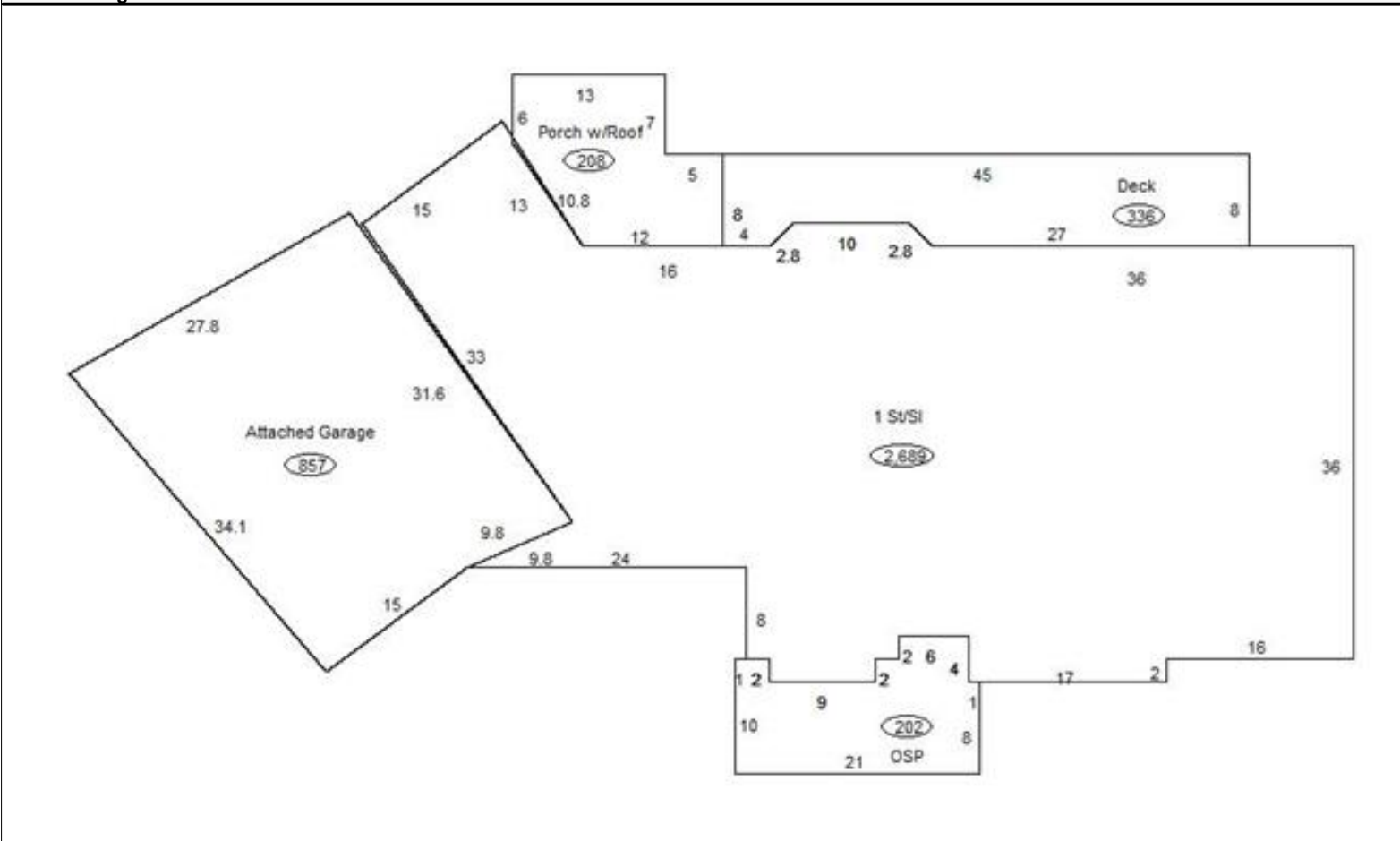

### Sketch Vector Information

Sequence	Code	Type	Built Over	Scale	Section Label	Base Area	Multiplier	Total Area
1	R	1	Slab	13	1 St/SI	2,689	1.000	2,689
2	G	1		13	Attached Garage	857	1.000	857
3	M	PATO		13	Open Slab	202	1.000	202
4	M	WODO		13	WODO	336	1.000	336
5	M	PRCH		13	SLBC	208	1.000	208
<b>Total Building Area</b>						<b>2,689</b>		<b>2,689</b>