



# Rogers

## Assessment Property Record Card for Tax Year 2026

Data provided by LISA DELOZIER County Assessor

Date 04/17/2026  
 Time 04:14:21  
 Page 1

Assessment Data					Primary Image																																																																																																																				
<b>Account</b> 660002496 <b>Parcel ID</b> 22N17E-03-1-00000-000-0000 <b>Cadastral ID</b> 03-22-17-00240 <b>Property Type</b> REAL - Real Property <b>Property Class</b> RR VI Area 2 <b>Tax Area</b> 70 - FOYIL RURAL/FOYIL FIRE <b>Name ID</b> 285879 STRAHM, BRADFORD E &  RHONDA A 13320 S 4230 RD CLAREMORE OK 74017-0000																																																																																																																									
<b>Parcel Location</b> <b>Situs</b> 13320 S 4230 RD <b>Subdivision</b> <b>Lot/Block</b> / <b>Parcel Size</b> 4.75 - Acres <b>Sec/Twn/Rng</b> 3 / 22 / 17 / 1 <b>Neighborhood</b> 4070 - FOYIL SEQUOYAH AREA <b>School District</b> S007 - FOYIL SCHOOLS																																																																																																																									
<b>Legal Description</b> Lat/Long: 36.41834553 -95.47263389 S2 NE SE NE LESS S 15' THEREOF					<b>Building Permits</b> <table border="1"> <thead> <tr> <th>Number</th> <th>Description</th> <th>Opened</th> <th>Closed</th> <th>Amount</th> </tr> </thead> <tbody> <tr> <td>CV21</td> <td>CV23-POSS MED MARI GROWER</td> <td>04/2021</td> <td>03/2022</td> <td></td> </tr> <tr> <td>R18</td> <td>R19-POSS NEW STRUCTURE</td> <td>05/2015</td> <td>12/2018</td> <td></td> </tr> </tbody> </table>					Number	Description	Opened	Closed	Amount	CV21	CV23-POSS MED MARI GROWER	04/2021	03/2022		R18	R19-POSS NEW STRUCTURE	05/2015	12/2018																																																																																																		
Number	Description	Opened	Closed	Amount																																																																																																																					
CV21	CV23-POSS MED MARI GROWER	04/2021	03/2022																																																																																																																						
R18	R19-POSS NEW STRUCTURE	05/2015	12/2018																																																																																																																						
<b>Exemptions</b> <table border="1"> <thead> <tr> <th>Code</th> <th>Type</th> <th>Active</th> <th>Maximum</th> <th>Exemption</th> </tr> </thead> <tbody> <tr> <td>H</td> <td>Homestead</td> <td>Yes</td> <td>1,000</td> <td>1,000</td> </tr> </tbody> </table>					Code	Type	Active	Maximum	Exemption	H	Homestead	Yes	1,000	1,000	<b>Sale History</b> <table border="1"> <thead> <tr> <th>Bk/Pg</th> <th>Grantor</th> <th>Date</th> <th>Price</th> <th>Code</th> </tr> </thead> <tbody> <tr> <td>1601/156</td> <td>DRIVER, GARY L</td> <td>07/02/2004</td> <td>52,500</td> <td>YES</td> </tr> <tr> <td>1306/591</td> <td>BAIDEN, TAMMY K</td> <td>07/25/2001</td> <td>38,000</td> <td>YES</td> </tr> <tr> <td>1281/100</td> <td>MALONEY, BENNIE RAY</td> <td>04/09/2001</td> <td>0</td> <td>No</td> </tr> <tr> <td>777/101</td> <td></td> <td></td> <td>12,500</td> <td>No</td> </tr> </tbody> </table>					Bk/Pg	Grantor	Date	Price	Code	1601/156	DRIVER, GARY L	07/02/2004	52,500	YES	1306/591	BAIDEN, TAMMY K	07/25/2001	38,000	YES	1281/100	MALONEY, BENNIE RAY	04/09/2001	0	No	777/101			12,500	No																																																																													
Code	Type	Active	Maximum	Exemption																																																																																																																					
H	Homestead	Yes	1,000	1,000																																																																																																																					
Bk/Pg	Grantor	Date	Price	Code																																																																																																																					
1601/156	DRIVER, GARY L	07/02/2004	52,500	YES																																																																																																																					
1306/591	BAIDEN, TAMMY K	07/25/2001	38,000	YES																																																																																																																					
1281/100	MALONEY, BENNIE RAY	04/09/2001	0	No																																																																																																																					
777/101			12,500	No																																																																																																																					
<b>Parcel Valuation</b> <table border="1"> <thead> <tr> <th>Source</th> <th>REAL</th> <th>Fair Cash</th> <th>Capped</th> <th>Asmnt Level</th> <th>Assessed</th> <th>Levy Rate</th> <th>101.660</th> <th>Current Tax</th> </tr> </thead> <tbody> <tr> <td>Remove Cap</td> <td>2005</td> <td>Land Value 73,873</td> <td>44,963</td> <td>11%</td> <td>4,946</td> <td>Assessed</td> <td>25,583</td> <td>2,600.77</td> </tr> <tr> <td>Year Frozen</td> <td>0</td> <td>Improvements 222,445</td> <td>187,607</td> <td></td> <td>20,637</td> <td>Penalty</td> <td>0</td> <td></td> </tr> <tr> <td>Uncapped Value</td> <td>0</td> <td>Mobile Home 0</td> <td>0</td> <td></td> <td>0</td> <td>Exemption</td> <td>1,000</td> <td>-89.00</td> </tr> <tr> <td>TIF Project ID</td> <td>0</td> <td>Total Value 296,318</td> <td>232,570</td> <td></td> <td>25,583</td> <td>Total Taxable</td> <td>24,583</td> <td>2,512.00</td> </tr> </tbody> </table>										Source	REAL	Fair Cash	Capped	Asmnt Level	Assessed	Levy Rate	101.660	Current Tax	Remove Cap	2005	Land Value 73,873	44,963	11%	4,946	Assessed	25,583	2,600.77	Year Frozen	0	Improvements 222,445	187,607		20,637	Penalty	0		Uncapped Value	0	Mobile Home 0	0		0	Exemption	1,000	-89.00	TIF Project ID	0	Total Value 296,318	232,570		25,583	Total Taxable	24,583	2,512.00																																																																			
Source	REAL	Fair Cash	Capped	Asmnt Level	Assessed	Levy Rate	101.660	Current Tax																																																																																																																	
Remove Cap	2005	Land Value 73,873	44,963	11%	4,946	Assessed	25,583	2,600.77																																																																																																																	
Year Frozen	0	Improvements 222,445	187,607		20,637	Penalty	0																																																																																																																		
Uncapped Value	0	Mobile Home 0	0		0	Exemption	1,000	-89.00																																																																																																																	
TIF Project ID	0	Total Value 296,318	232,570		25,583	Total Taxable	24,583	2,512.00																																																																																																																	
<b>Assessment History</b> <table border="1"> <thead> <tr> <th>Tax Year</th> <th>Statement Number</th> <th>Billed Owner</th> <th>Tax Area</th> <th>Total Value</th> <th>Exemptions</th> <th>Taxable Value</th> <th>Billed Tax</th> </tr> </thead> <tbody> <tr><td>2025</td><td>2025-660002496</td><td>STRAHM, BRADFORD E &amp;</td><td>70</td><td>292,679</td><td>1000</td><td>23,838</td><td>2,437.00</td></tr> <tr><td>2024</td><td>2024-660002496</td><td>STRAHM, BRADFORD E &amp;</td><td>70</td><td>303,170</td><td>1000</td><td>23,114</td><td>2,423.00</td></tr> <tr><td>2023</td><td>2023-660002496</td><td>STRAHM, BRADFORD E &amp;</td><td>70</td><td>236,364</td><td>1000</td><td>22,412</td><td>2,350.00</td></tr> <tr><td>2022</td><td>2022-660002496</td><td>STRAHM, BRADFORD E &amp;</td><td>70</td><td>234,416</td><td>1000</td><td>21,730</td><td>2,288.00</td></tr> <tr><td>2021</td><td>2021-660002496</td><td>STRAHM, BRADFORD E &amp;</td><td>70</td><td>211,826</td><td>1000</td><td>21,068</td><td>2,161.00</td></tr> <tr><td>2020</td><td>2020-660002496</td><td>STRAHM, BRADFORD E &amp;</td><td>70</td><td>198,898</td><td>1000</td><td>20,426</td><td>2,179.00</td></tr> <tr><td>2019</td><td>2019-660002496</td><td>STRAHM, BRADFORD E &amp;</td><td>70</td><td>189,103</td><td>1000</td><td>19,801</td><td>2,120.00</td></tr> <tr><td>2018</td><td>2018-660002496</td><td>STRAHM, BRADFORD E &amp;</td><td>70</td><td>193,108</td><td>1000</td><td>20,242</td><td>2,127.00</td></tr> <tr><td>2017</td><td>2017-660002496</td><td>STRAHM, BRADFORD E &amp;</td><td>70</td><td>46,131</td><td>1000</td><td>4,075</td><td>443.00</td></tr> <tr><td>2016</td><td>2016-660002496</td><td>STRAHM, BRADFORD E &amp;</td><td>70</td><td>45,907</td><td>1000</td><td>4,050</td><td>455.00</td></tr> <tr><td>2015</td><td>2015-660002496</td><td>STRAHM, BRADFORD E &amp;</td><td>70</td><td>46,161</td><td>1000</td><td>3,922</td><td>437.00</td></tr> <tr><td>2014</td><td>2014-660002496</td><td>STRAHM, BRADFORD E &amp;</td><td>70</td><td>43,444</td><td>1000</td><td>3,780</td><td>416.00</td></tr> <tr><td>2013</td><td>2013-660002496</td><td>STRAHM, BRADFORD E &amp;</td><td>70</td><td>43,444</td><td>1000</td><td>3,780</td><td>406.00</td></tr> </tbody> </table>										Tax Year	Statement Number	Billed Owner	Tax Area	Total Value	Exemptions	Taxable Value	Billed Tax	2025	2025-660002496	STRAHM, BRADFORD E &	70	292,679	1000	23,838	2,437.00	2024	2024-660002496	STRAHM, BRADFORD E &	70	303,170	1000	23,114	2,423.00	2023	2023-660002496	STRAHM, BRADFORD E &	70	236,364	1000	22,412	2,350.00	2022	2022-660002496	STRAHM, BRADFORD E &	70	234,416	1000	21,730	2,288.00	2021	2021-660002496	STRAHM, BRADFORD E &	70	211,826	1000	21,068	2,161.00	2020	2020-660002496	STRAHM, BRADFORD E &	70	198,898	1000	20,426	2,179.00	2019	2019-660002496	STRAHM, BRADFORD E &	70	189,103	1000	19,801	2,120.00	2018	2018-660002496	STRAHM, BRADFORD E &	70	193,108	1000	20,242	2,127.00	2017	2017-660002496	STRAHM, BRADFORD E &	70	46,131	1000	4,075	443.00	2016	2016-660002496	STRAHM, BRADFORD E &	70	45,907	1000	4,050	455.00	2015	2015-660002496	STRAHM, BRADFORD E &	70	46,161	1000	3,922	437.00	2014	2014-660002496	STRAHM, BRADFORD E &	70	43,444	1000	3,780	416.00	2013	2013-660002496	STRAHM, BRADFORD E &	70	43,444	1000	3,780	406.00
Tax Year	Statement Number	Billed Owner	Tax Area	Total Value	Exemptions	Taxable Value	Billed Tax																																																																																																																		
2025	2025-660002496	STRAHM, BRADFORD E &	70	292,679	1000	23,838	2,437.00																																																																																																																		
2024	2024-660002496	STRAHM, BRADFORD E &	70	303,170	1000	23,114	2,423.00																																																																																																																		
2023	2023-660002496	STRAHM, BRADFORD E &	70	236,364	1000	22,412	2,350.00																																																																																																																		
2022	2022-660002496	STRAHM, BRADFORD E &	70	234,416	1000	21,730	2,288.00																																																																																																																		
2021	2021-660002496	STRAHM, BRADFORD E &	70	211,826	1000	21,068	2,161.00																																																																																																																		
2020	2020-660002496	STRAHM, BRADFORD E &	70	198,898	1000	20,426	2,179.00																																																																																																																		
2019	2019-660002496	STRAHM, BRADFORD E &	70	189,103	1000	19,801	2,120.00																																																																																																																		
2018	2018-660002496	STRAHM, BRADFORD E &	70	193,108	1000	20,242	2,127.00																																																																																																																		
2017	2017-660002496	STRAHM, BRADFORD E &	70	46,131	1000	4,075	443.00																																																																																																																		
2016	2016-660002496	STRAHM, BRADFORD E &	70	45,907	1000	4,050	455.00																																																																																																																		
2015	2015-660002496	STRAHM, BRADFORD E &	70	46,161	1000	3,922	437.00																																																																																																																		
2014	2014-660002496	STRAHM, BRADFORD E &	70	43,444	1000	3,780	416.00																																																																																																																		
2013	2013-660002496	STRAHM, BRADFORD E &	70	43,444	1000	3,780	406.00																																																																																																																		



# Rogers

## Assessment Property Record Card for Tax Year 2026

Data provided by LISA DELOZIER County Assessor

Date 04/17/2026  
 Time 04:14:22  
 Page 2

Lot Data		Square-Foot - NBHD 4070 #1
Lot Size		
Lot Count		
Units Buildable	1	
Non-Ag Acres	0	
Topography		
Street Access		
Utilities		
Amenities	LAND QUALITY	0
		0
Method	Square-Foot	
Base Lot Value	208,373.00 x .35 = 73,873	
Factor Value		
Adjustments	1.0000	
Lot Value	73,873	



\\tsclient\TCASEY\CASEY BOOTH VISUAL INSPECTION\2020-9- 9/28/2020

Residential Data	
Type	1 Single Family Residence
Condition	2 - Fair
Quality	2 - Fair
Architecture	MTL METAL HOME
Style	100% One Story
Exterior Wall	100% Frame, Siding, Metal
Base/Total Area	2,304 / 2,304
Style	100% One Story
HVAC	100% Warmed & Cooled Air
Roof Cover	4 Metal, Preformed
Area on Slab	0
Fixture/RghIn	14 /
Bed/F/H Bath	5 / 2.0 / 1.0
Basement Area	
Garage Type	
Remodel	
Year/Eff Age	2017 / 9

GRM Approach	
GRM Code	
Gross Rent	0.00
Indicated Value	

Multiple Regression	
MRA Code	1 Test
Adusted R	0.8445
Indicated Value	197,536 85.74 Per SqFt

Direct Comparables	
Selection Model	1 Res
Adjustment Model	A2 AO Test
Comparables	
Indicated Value	

Cost Approach		Manual : 01/2025	
Base Cost	76.64	Total Misc Impr	+ 0
Roofing Adj	+ 4.07	Garage Cost	+ 0
Subfloor Adj	+ 2.10	Total RCN	= 230,446
Heat/Cool Adj	+ 10.30	Depreciation ( 11%)	- 25,349
Plumbing Adj	+ 6.91	Lump Sums	+ 8,327
Basement Adj	+ 0.00	RCNLD	= 213,424
Adj Base Cost	= 100.02	Lot Value	+ 73,873
Total Area	x 2,304	Indicated Value	= 287,297
Adjusted Cost	= 230,446	Value Per SqFt	124.69

Value Reconciliation	
Selected Approach	Cost Approach
Improvements	213,424
Lot Value	73,873
Indicated Value	287,297 124.69 Per SqFt
Agland Value	
Site Improvements	9,021
Total Value	296,318 128.61 Total Value Per SqFt

Miscellaneous Improvements								
Code	Description	Sketch ID	Size	Year	Units	Unit Cost	Depr	Value
WODO	WOOD DECK - OPEN	135926	20x10		200	19.66		3,932
WODC	WOOD DECK - COVERED	148160	12x10		120	40.69	10%	4,395



# Rogers

## Assessment Property Record Card for Tax Year 2026

Data provided by LISA DELOZIER County Assessor

Date 04/17/2026

Time 04:14:22

Page 3

### Sketch Image

660002496

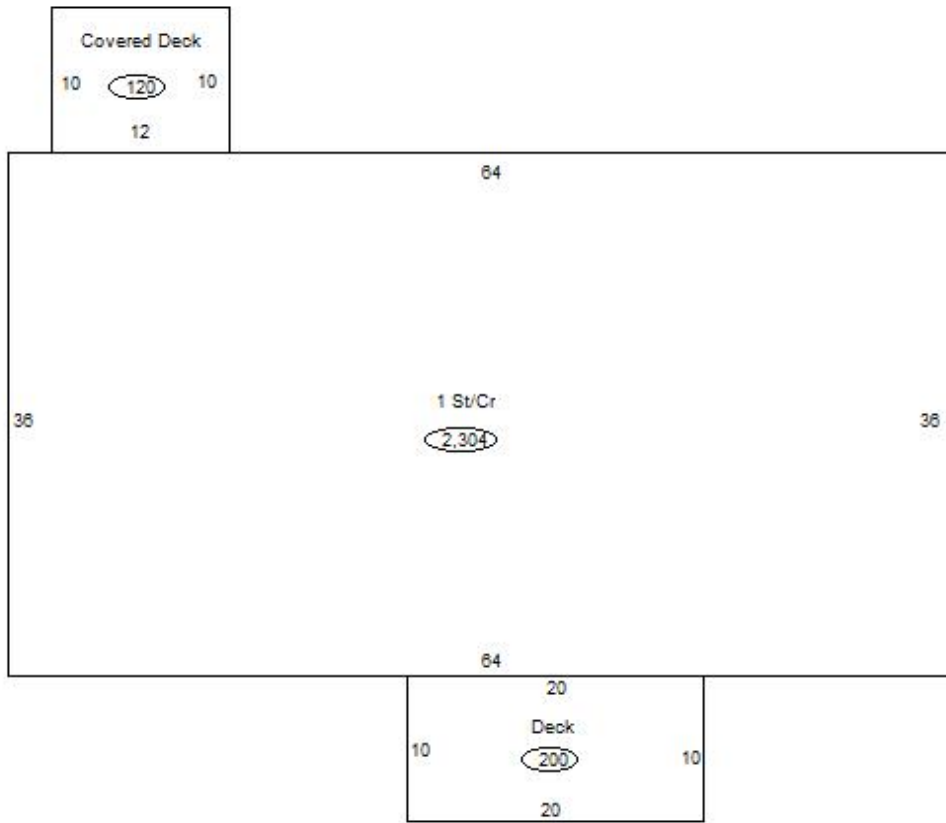

### Sketch Vector Information

Sequence	Code	Type	Built Over	Scale	Section Label	Base Area	Multiplier	Total Area
1	R	1	Crawl	13	1 St/Cr	2,304	1.000	2,304
2	M	WODO		13	WODO	200	1.000	200
3	M	WODC		13	WODC	120	1.000	120
<b>Total Building Area</b>						2,304		2,304



# Rogers

## Assessment Property Record Card for Tax Year 2026

Data provided by LISA DELOZIER County Assessor

Date 04/17/2026  
Time 04:14:22  
Page 4

660002496

### Outbuildings/Site Improvements

Building Image	Code	Description	Dimensions	Floor	Roofing	Total Units
	SHDS SHED		32x9x8	Plank	Formed Metal	288
	Qual 3	Cond 3	Year 2017	Eff Age 7		
	<b>Valuation Summary</b>		<b>Modifier Total</b>	<b>RCN</b>	<b>Depr (32% Phys/ % Func)</b>	<b>RCNLD</b>
	Base Cost (22.15 x 288)		6,379		6,379	2,041
	BNGP BARN		12x20x12	Dirt	Formed Metal	240
	Qual 3	Cond 3	Year 2015	Eff Age 8		
	<b>Valuation Summary</b>		<b>Modifier Total</b>	<b>RCN</b>	<b>Depr (15% Phys/ % Func)</b>	<b>RCNLD</b>
	Base Cost (22.96 x 240)		5,510		5,510	827