



Rogers

Assessment Property Record Card for Tax Year 2026

Data provided by LISA DELOZIER County Assessor

Date 04/17/2026
Time 13:12:57
Page 1

Assessment Data					Primary Image																																																																																																															
Account 660002497 Parcel ID 22N17E-03-1-00000-000-0000 Cadastral ID 03-22-17-00250 Property Type REAL - Real Property Property Class DNT VI Area 2 Tax Area 70 - FOYIL RURAL/FOYIL FIRE Name ID 2144 HOUSING AUTHORITY OF THE DELAWARE TRIBE OF INDIANS PO BOX 334 CHELSEA OK 74016-0334 Parcel Location Situs 13240 S 4230 RD Subdivision Lot/Block / Parcel Size 1.5 - Acres Sec/Twn/Rng 3 / 22 / 17 / 1 Neighborhood 4070 - FOYIL SEQUOYAH AREA School District S007 - FOYIL SCHOOLS																																																																																																																				
Legal Description Lat/Long: 36.41905218 -95.47260524 N 150' E 217.80' N/2 N/2 SE/4 NE/4 AND W 217.80' E 435.60' S 150' OF THE N/2 N/2 SE/4 NE/4																																																																																																																				
Exemptions <table border="1"> <thead> <tr> <th>Code</th> <th>Type</th> <th>Active</th> <th>Maximum</th> <th>Exemption</th> </tr> </thead> <tbody> <tr> <td></td> <td></td> <td></td> <td></td> <td></td> </tr> </tbody> </table>					Code	Type	Active	Maximum	Exemption						Building Permits <table border="1"> <thead> <tr> <th>Number</th> <th>Description</th> <th>Opened</th> <th>Closed</th> <th>Amount</th> </tr> </thead> <tbody> <tr> <td></td> <td></td> <td></td> <td></td> <td></td> </tr> </tbody> </table>					Number	Description	Opened	Closed	Amount																																																																																												
Code	Type	Active	Maximum	Exemption																																																																																																																
Number	Description	Opened	Closed	Amount																																																																																																																
Parcel Valuation <table border="1"> <thead> <tr> <th>Source</th> <th>REAL</th> <th>Fair Cash</th> <th>Capped</th> <th>Asmnt Level</th> <th>Assessed</th> <th>Levy Rate</th> <th>101.660</th> <th>Current Tax</th> </tr> </thead> <tbody> <tr> <td>Remove Cap</td> <td>0</td> <td>Land Value 33,759</td> <td>0</td> <td>11%</td> <td>0</td> <td>Assessed</td> <td>0</td> <td>0.00</td> </tr> <tr> <td>Year Frozen</td> <td>0</td> <td>Improvements 223,866</td> <td>0</td> <td></td> <td>0</td> <td>Penalty</td> <td>0</td> <td></td> </tr> <tr> <td>Uncapped Value</td> <td>0</td> <td>Mobile Home 0</td> <td>0</td> <td></td> <td>0</td> <td>Exemption</td> <td>0</td> <td>0.00</td> </tr> <tr> <td>TIF Project ID</td> <td>0</td> <td>Total Value 257,625</td> <td>0</td> <td></td> <td>0</td> <td>Total Taxable</td> <td>0</td> <td>0.00</td> </tr> </tbody> </table>					Source	REAL	Fair Cash	Capped	Asmnt Level	Assessed	Levy Rate	101.660	Current Tax	Remove Cap	0	Land Value 33,759	0	11%	0	Assessed	0	0.00	Year Frozen	0	Improvements 223,866	0		0	Penalty	0		Uncapped Value	0	Mobile Home 0	0		0	Exemption	0	0.00	TIF Project ID	0	Total Value 257,625	0		0	Total Taxable	0	0.00	Sale History <table border="1"> <thead> <tr> <th>Bk/Pg</th> <th>Grantor</th> <th>Date</th> <th>Price</th> <th>Code</th> </tr> </thead> <tbody> <tr> <td>802/313</td> <td></td> <td></td> <td>10,500</td> <td>No</td> </tr> </tbody> </table>					Bk/Pg	Grantor	Date	Price	Code	802/313			10,500	No																																																				
Source	REAL	Fair Cash	Capped	Asmnt Level	Assessed	Levy Rate	101.660	Current Tax																																																																																																												
Remove Cap	0	Land Value 33,759	0	11%	0	Assessed	0	0.00																																																																																																												
Year Frozen	0	Improvements 223,866	0		0	Penalty	0																																																																																																													
Uncapped Value	0	Mobile Home 0	0		0	Exemption	0	0.00																																																																																																												
TIF Project ID	0	Total Value 257,625	0		0	Total Taxable	0	0.00																																																																																																												
Bk/Pg	Grantor	Date	Price	Code																																																																																																																
802/313			10,500	No																																																																																																																
Assessment History <table border="1"> <thead> <tr> <th>Tax Year</th> <th>Statement Number</th> <th>Billed Owner</th> <th>Tax Area</th> <th>Total Value</th> <th>Exemptions</th> <th>Taxable Value</th> <th>Billed Tax</th> </tr> </thead> <tbody> <tr><td>2025</td><td>2025-660002497</td><td>HOUSING AUTHORITY OF THE</td><td>70</td><td>268,312</td><td>0</td><td></td><td>.00</td></tr> <tr><td>2024</td><td>2024-660002497</td><td>HOUSING AUTHORITY OF THE</td><td>70</td><td>198,263</td><td>0</td><td></td><td>.00</td></tr> <tr><td>2023</td><td>2023-660002497</td><td>HOUSING AUTHORITY OF THE</td><td>70</td><td>180,351</td><td>0</td><td></td><td>.00</td></tr> <tr><td>2022</td><td>2022-660002497</td><td>HOUSING AUTHORITY OF THE</td><td>70</td><td>193,117</td><td>0</td><td></td><td>.00</td></tr> <tr><td>2021</td><td>2021-660002497</td><td>HOUSING AUTHORITY OF THE</td><td>70</td><td>193,117</td><td>0</td><td></td><td>.00</td></tr> <tr><td>2020</td><td>2020-660002497</td><td>HOUSING AUTHORITY OF THE</td><td>70</td><td>182,504</td><td>0</td><td></td><td>.00</td></tr> <tr><td>2019</td><td>2019-660002497</td><td>HOUSING AUTHORITY OF THE</td><td>70</td><td>175,184</td><td>0</td><td></td><td>.00</td></tr> <tr><td>2018</td><td>2018-660002497</td><td>HOUSING AUTHORITY OF THE</td><td>70</td><td>180,780</td><td>0</td><td></td><td>.00</td></tr> <tr><td>2017</td><td>2017-660002497</td><td>HOUSING AUTHORITY OF THE</td><td>70</td><td>179,193</td><td>0</td><td></td><td>.00</td></tr> <tr><td>2016</td><td>2016-660002497</td><td>HOUSING AUTHORITY OF THE</td><td>70</td><td>174,388</td><td>0</td><td></td><td>.00</td></tr> <tr><td>2015</td><td>2015-660002497</td><td>HOUSING AUTHORITY OF THE</td><td>70</td><td>168,709</td><td>0</td><td></td><td>.00</td></tr> <tr><td>2014</td><td>2014-660002497</td><td>HOUSING AUTHORITY OF THE</td><td>70</td><td>167,869</td><td>0</td><td></td><td>.00</td></tr> <tr><td>2013</td><td>2013-660002497</td><td>HOUSING AUTHORITY OF THE</td><td>70</td><td>159,008</td><td>0</td><td></td><td>.00</td></tr> </tbody> </table>					Tax Year	Statement Number	Billed Owner	Tax Area	Total Value	Exemptions	Taxable Value	Billed Tax	2025	2025-660002497	HOUSING AUTHORITY OF THE	70	268,312	0		.00	2024	2024-660002497	HOUSING AUTHORITY OF THE	70	198,263	0		.00	2023	2023-660002497	HOUSING AUTHORITY OF THE	70	180,351	0		.00	2022	2022-660002497	HOUSING AUTHORITY OF THE	70	193,117	0		.00	2021	2021-660002497	HOUSING AUTHORITY OF THE	70	193,117	0		.00	2020	2020-660002497	HOUSING AUTHORITY OF THE	70	182,504	0		.00	2019	2019-660002497	HOUSING AUTHORITY OF THE	70	175,184	0		.00	2018	2018-660002497	HOUSING AUTHORITY OF THE	70	180,780	0		.00	2017	2017-660002497	HOUSING AUTHORITY OF THE	70	179,193	0		.00	2016	2016-660002497	HOUSING AUTHORITY OF THE	70	174,388	0		.00	2015	2015-660002497	HOUSING AUTHORITY OF THE	70	168,709	0		.00	2014	2014-660002497	HOUSING AUTHORITY OF THE	70	167,869	0		.00	2013	2013-660002497	HOUSING AUTHORITY OF THE	70	159,008	0		.00
Tax Year	Statement Number	Billed Owner	Tax Area	Total Value	Exemptions	Taxable Value	Billed Tax																																																																																																													
2025	2025-660002497	HOUSING AUTHORITY OF THE	70	268,312	0		.00																																																																																																													
2024	2024-660002497	HOUSING AUTHORITY OF THE	70	198,263	0		.00																																																																																																													
2023	2023-660002497	HOUSING AUTHORITY OF THE	70	180,351	0		.00																																																																																																													
2022	2022-660002497	HOUSING AUTHORITY OF THE	70	193,117	0		.00																																																																																																													
2021	2021-660002497	HOUSING AUTHORITY OF THE	70	193,117	0		.00																																																																																																													
2020	2020-660002497	HOUSING AUTHORITY OF THE	70	182,504	0		.00																																																																																																													
2019	2019-660002497	HOUSING AUTHORITY OF THE	70	175,184	0		.00																																																																																																													
2018	2018-660002497	HOUSING AUTHORITY OF THE	70	180,780	0		.00																																																																																																													
2017	2017-660002497	HOUSING AUTHORITY OF THE	70	179,193	0		.00																																																																																																													
2016	2016-660002497	HOUSING AUTHORITY OF THE	70	174,388	0		.00																																																																																																													
2015	2015-660002497	HOUSING AUTHORITY OF THE	70	168,709	0		.00																																																																																																													
2014	2014-660002497	HOUSING AUTHORITY OF THE	70	167,869	0		.00																																																																																																													
2013	2013-660002497	HOUSING AUTHORITY OF THE	70	159,008	0		.00																																																																																																													



Rogers

Assessment Property Record Card for Tax Year 2026

Data provided by LISA DELOZIER County Assessor

Date 04/17/2026
 Time 13:12:58
 Page 2

Lot Data		Square-Foot - NBHD 4070 #1
Lot Size		
Lot Count		
Units Buildable		
Non-Ag Acres	0	
Topography		
Street Access		
Utilities		
Amenities	LAND QUALITY	0
Method	Square-Foot	
Base Lot Value	65,340.00 x .52 =	33,759
Factor Value		
Adjustments	1.0000	
Lot Value		33,759

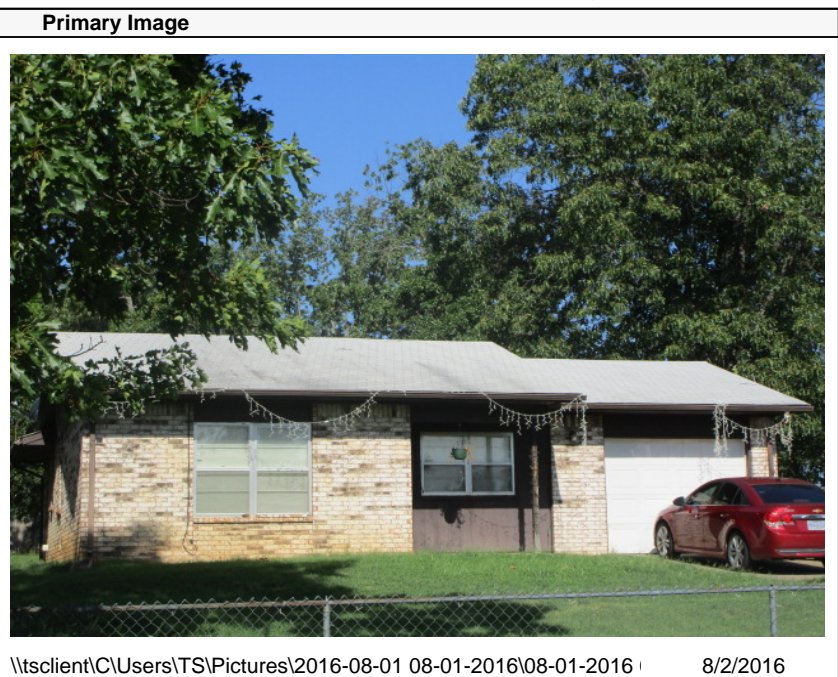

\\tsclient\C\Users\TS\Pictures\2016-08-01 08-01-2016\08-01-2016 8/2/2016

Residential Data	
Type	1 Single Family Residence
Condition	3 - Average
Quality	2.5 - Fair
Architecture	TRAD TRADITIONAL
Style	100% One Story
Exterior Wall	100% Veneer, Masonry
Base/Total Area	1,231 / 1,231
Style	100% One Story
HVAC	100% Warmed & Cooled Air
Roof Cover	1 Composition Shingle
Area on Slab	1,231
Fixture/RghIn	4 /
Bed/F/H Bath	3 / 1.0 /
Basement Area	
Garage Type	276 Attached Garage - Unfinished
Remodel	
Year/Eff Age	1989 / 28

GRM Approach	
GRM Code	
Gross Rent	0.00
Indicated Value	

Multiple Regression			
MRA Code	1	Test	
Adusted R	0.8445		
Indicated Value	135,923	110.42	Per SqFt

Direct Comparables	
Selection Model	1 Res
Adjustment Model	A2 AO Test
Comparables	
Indicated Value	

Cost Approach		Manual : 01/2025	
Base Cost	109.59	Total Misc Impr	+ 1,787
Roofing Adj	+ 4.63	Garage Cost	+ 9,014
Subfloor Adj	+ -1.20	Total RCN	= 169,637
Heat/Cool Adj	+ 11.47	Depreciation (38%)	- 64,462
Plumbing Adj	+ 4.54	Lump Sums	+ 0
Basement Adj	+ 0.00	RCNLD	= 105,175
Adj Base Cost	= 129.03	Lot Value	+ 33,759
Total Area	x 1,231	Indicated Value	= 138,934
Adjusted Cost	= 158,836	Value Per SqFt	112.86

Value Reconciliation			
Selected Approach	Cost Approach		
Improvements	105,175		
Lot Value	33,759		
Indicated Value	138,934	112.86	Per SqFt
Agland Value			
Site Improvements			
Total Value	138,934	112.86	Total Value Per SqFt

Miscellaneous Improvements								
Code	Description	Sketch ID	Size	Year	Units	Unit Cost	Depr	Value
PRCH	Porch	6670		24	24	24.19		581
PRCH	SLAB PORCH - COVERED	6671	10x5		50	24.11		1,206



Rogers

Assessment Property Record Card for Tax Year 2026

Data provided by LISA DELOZIER County Assessor

Date 04/17/2026

Time 13:12:58

Page 3

Sketch Image

660002497

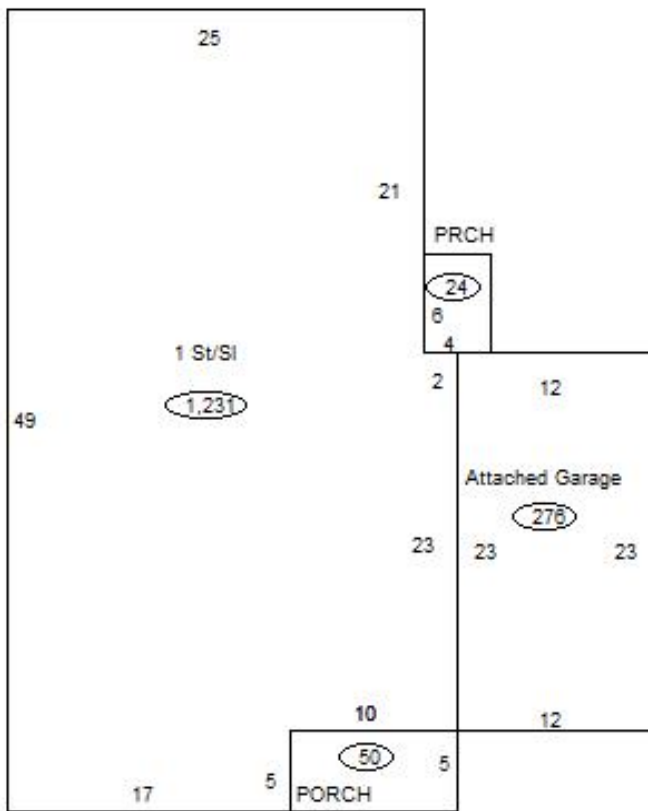

Sketch Vector Information

Sequence	Code	Type	Built Over	Scale	Section Label	Base Area	Multiplier	Total Area
1	R	1	Slab	13	1 St/Sl	1,231	1.000	1,231
2	G	1		13	Attached Garage	276	1.000	276
3	M	PRCH		13	PRCH	24	1.000	24
4	M	PRCH		13	PORCH	50	1.000	50
Total Building Area						1,231		1,231



Rogers

Assessment Property Record Card for Tax Year 2026

Data provided by LISA DELOZIER County Assessor

Date 04/17/2026
 Time 13:12:58
 Page 4

Lot Data	
Lot Size	-
Lot Count	
Units Buildable	1
Non-Ag Acres	0
Topography	
Street Access	
Utilities	
Amenities	LAND QUALITY
Method	
Base Lot Value	
Factor Value	
Adjustments	
Lot Value	



\\tsclient\TCASEY\CASEY BOOTH VISUAL INSPECTION\2020-9- 9/28/2020

Residential Data	
Type	1 Single Family Residence
Condition	3 - Average
Quality	3 - Average
Architecture	TRAD TRADITIONAL
Style	100% One Story
Exterior Wall	100% Veneer, Masonry
Base/Total Area	1,231 / 1,231
Style	100% One Story
HVAC	100% Warmed & Cooled Air
Roof Cover	1 Composition Shingle
Area on Slab	1,231
Fixture/RghIn	4 /
Bed/F/H Bath	3 / 1.0 /
Basement Area	
Garage Type	276 Attached Garage - Finished
Remodel	
Year/Eff Age	1989 / 28

GRM Approach

GRM Code	
Gross Rent	0.00
Indicated Value	

Multiple Regression

MRA Code	1 Test
Adusted R	0.8445
Indicated Value	151,026 122.69 Per SqFt

Direct Comparables

Selection Model	1 Res
Adjustment Model	A2 AO Test
Comparables	
Indicated Value	

Value Reconciliation

Selected Approach	Cost Approach
Improvements	118,691
Lot Value	
Indicated Value	118,691 96.42 Per SqFt
Agland Value	
Site Improvements	
Total Value	118,691 96.42 Total Value Per SqFt

Cost Approach				Manual : 01/2025			
Base Cost	116.78	Total Misc Impr	+ 644				
Roofing Adj	+ 5.10	Garage Cost	+ 13,151				
Subfloor Adj	+ -2.39	Total RCN	= 182,602				
Heat/Cool Adj	+ 12.64	Depreciation (35%)	- 63,911				
Plumbing Adj	+ 5.00	Lump Sums	+ 0				
Basement Adj	+ 0.00	RCNLD	= 118,691				
Adj Base Cost	= 137.13	Lot Value	+ 118,691				
Total Area	x 1,231	Indicated Value	= 118,691				
Adjusted Cost	= 168,807	Value Per SqFt	96.42				

Miscellaneous Improvements

Code	Description	Sketch ID	Size	Year	Units	Unit Cost	Depr	Value
PRCH	SLAB PORCH - COVERED	6674	6x4		24	26.85		644



Rogers

Assessment Property Record Card for Tax Year 2026

Data provided by LISA DELOZIER County Assessor

Date 04/17/2026

Time 13:12:58

Page 5

Sketch Image

660002497

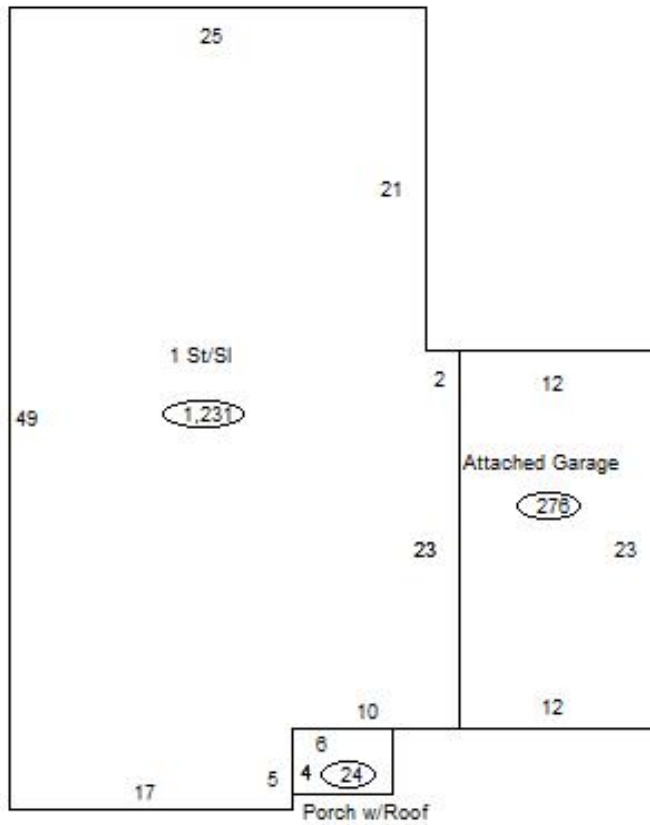

Sketch Vector Information

Sequence	Code	Type	Built Over	Scale	Section Label	Base Area	Multiplier	Total Area
1	R	1	Slab	13	1 St/Sl	1,231	1.000	1,231
2	G	1		13	Attached Garage	276	1.000	276
3	M	PRCH		13	SLBC	24	1.000	24
Total Building Area						1,231		1,231