



# Rogers

## Assessment Property Record Card for Tax Year 2026

Data provided by LISA DELOZIER County Assessor

Date 04/17/2026  
Time 17:43:56  
Page 1

Assessment Data					Primary Image																																																																																																																				
<b>Account</b> 660002547 <b>Parcel ID</b> 23N14E-03-4-00000-000-0000 <b>Cadastral ID</b> 03-23-14-00900 <b>Property Type</b> REAL - Real Property <b>Property Class</b> RA VI Area 2 <b>Tax Area</b> 10 - OOLOGAH RURAL/NW FIRE <b>Name ID</b> 336321 RUDISAIL, DENTON A  7650 S 4050 RD TALALA OK 74080-0000  <b>Parcel Location</b> <b>Situs</b> 07650 S 4050 RD <b>Subdivision</b> <b>Lot/Block</b> / <b>Parcel Size</b> 10 - Acres <b>Sec/Twn/Rng</b> 3 / 23 / 14 / 4 <b>Neighborhood</b> 4030 - OOLOGAH RURAL <b>School District</b> S004 - OOLOGAH SCHOOLS																																																																																																																									
<b>Legal Description</b> Lat/Long: 36.50144567 -95.79777926																																																																																																																									
<b>Building Permits</b>					<table border="1"> <thead> <tr> <th>Number</th> <th>Description</th> <th>Opened</th> <th>Closed</th> <th>Amount</th> </tr> </thead> <tbody> <tr> <td colspan="5"> </td> </tr> </tbody> </table>					Number	Description	Opened	Closed	Amount																																																																																																											
Number	Description	Opened	Closed	Amount																																																																																																																					
<b>Exemptions</b>					<b>Sale History</b>																																																																																																																				
<table border="1"> <thead> <tr> <th>Code</th> <th>Type</th> <th>Active</th> <th>Maximum</th> <th>Exemption</th> </tr> </thead> <tbody> <tr> <td>H</td> <td>Homestead</td> <td>Yes</td> <td>1,000</td> <td>1,000</td> </tr> </tbody> </table>					Code	Type	Active	Maximum	Exemption	H	Homestead	Yes	1,000	1,000	<table border="1"> <thead> <tr> <th>Bk/Pg</th> <th>Grantor</th> <th>Date</th> <th>Price</th> <th>Code</th> </tr> </thead> <tbody> <tr> <td>/</td> <td>RUDISAIL, DENNIS A</td> <td>09/09/2021</td> <td>0</td> <td>4</td> </tr> <tr> <td>997/250</td> <td>STRICKLAND, DANNY E</td> <td>07/27/1995</td> <td>45,000</td> <td>Yes</td> </tr> </tbody> </table>					Bk/Pg	Grantor	Date	Price	Code	/	RUDISAIL, DENNIS A	09/09/2021	0	4	997/250	STRICKLAND, DANNY E	07/27/1995	45,000	Yes																																																																																							
Code	Type	Active	Maximum	Exemption																																																																																																																					
H	Homestead	Yes	1,000	1,000																																																																																																																					
Bk/Pg	Grantor	Date	Price	Code																																																																																																																					
/	RUDISAIL, DENNIS A	09/09/2021	0	4																																																																																																																					
997/250	STRICKLAND, DANNY E	07/27/1995	45,000	Yes																																																																																																																					
<b>Parcel Valuation</b>																																																																																																																									
<table border="1"> <thead> <tr> <th>Source</th> <th>REAL</th> <th>Fair Cash</th> <th>Capped</th> <th>Asmnt Level</th> <th>Assessed</th> <th>Levy Rate</th> <th>108.182</th> <th>Current Tax</th> </tr> </thead> <tbody> <tr> <td>Remove Cap</td> <td>0</td> <td>Land Value 1,438</td> <td>1,438</td> <td>11%</td> <td>158</td> <td>Assessed</td> <td>7,060</td> <td>763.76</td> </tr> <tr> <td>Year Frozen</td> <td>0</td> <td>Improvements 95,160</td> <td>62,743</td> <td></td> <td>6,902</td> <td>Penalty</td> <td>0</td> <td></td> </tr> <tr> <td>Uncapped Value</td> <td>0</td> <td>Mobile Home 0</td> <td>0</td> <td></td> <td>0</td> <td>Exemption</td> <td>1,000</td> <td>-94.00</td> </tr> <tr> <td>TIF Project ID</td> <td>0</td> <td>Total Value 96,598</td> <td>64,181</td> <td></td> <td>7,060</td> <td>Total Taxable</td> <td>6,060</td> <td>670.00</td> </tr> </tbody> </table>		Source	REAL	Fair Cash	Capped	Asmnt Level	Assessed	Levy Rate	108.182	Current Tax	Remove Cap	0	Land Value 1,438	1,438	11%	158	Assessed	7,060	763.76	Year Frozen	0	Improvements 95,160	62,743		6,902	Penalty	0		Uncapped Value	0	Mobile Home 0	0		0	Exemption	1,000	-94.00	TIF Project ID	0	Total Value 96,598	64,181		7,060	Total Taxable	6,060	670.00																																																																											
Source	REAL	Fair Cash	Capped	Asmnt Level	Assessed	Levy Rate	108.182	Current Tax																																																																																																																	
Remove Cap	0	Land Value 1,438	1,438	11%	158	Assessed	7,060	763.76																																																																																																																	
Year Frozen	0	Improvements 95,160	62,743		6,902	Penalty	0																																																																																																																		
Uncapped Value	0	Mobile Home 0	0		0	Exemption	1,000	-94.00																																																																																																																	
TIF Project ID	0	Total Value 96,598	64,181		7,060	Total Taxable	6,060	670.00																																																																																																																	
<b>Assessment History</b>																																																																																																																									
<table border="1"> <thead> <tr> <th>Tax Year</th> <th>Statement Number</th> <th>Billed Owner</th> <th>Tax Area</th> <th>Total Value</th> <th>Exemptions</th> <th>Taxable Value</th> <th>Billed Tax</th> </tr> </thead> <tbody> <tr><td>2025</td><td>2025-660002547</td><td>RUDISAIL, DENTON A</td><td>10</td><td>89,685</td><td>1000</td><td>5,855</td><td>647.00</td></tr> <tr><td>2024</td><td>2024-660002547</td><td>RUDISAIL, DENTON A</td><td>10</td><td>94,783</td><td>1000</td><td>5,655</td><td>606.00</td></tr> <tr><td>2023</td><td>2023-660002547</td><td>RUDISAIL, DENTON A</td><td>10</td><td>69,456</td><td>1000</td><td>5,461</td><td>582.00</td></tr> <tr><td>2022</td><td>2022-660002547</td><td>RUDISAIL, DENTON A</td><td>10</td><td>69,277</td><td>1000</td><td>5,273</td><td>560.00</td></tr> <tr><td>2021</td><td>2021-660002547</td><td>RUDISAIL, DENNIS A</td><td>10</td><td>56,541</td><td>1000</td><td>5,090</td><td>544.00</td></tr> <tr><td>2020</td><td>2020-660002547</td><td>RUDISAIL, DENNIS A</td><td>10</td><td>57,388</td><td>1000</td><td>4,913</td><td>534.00</td></tr> <tr><td>2019</td><td>2019-660002547</td><td>RUDISAIL, DENNIS A</td><td>10</td><td>52,189</td><td>1000</td><td>4,741</td><td>506.00</td></tr> <tr><td>2018</td><td>2018-660002547</td><td>RUDISAIL, DENNIS A</td><td>10</td><td>56,650</td><td>1000</td><td>5,231</td><td>576.00</td></tr> <tr><td>2017</td><td>2017-660002547</td><td>RUDISAIL, DENNIS A</td><td>10</td><td>103,614</td><td>1000</td><td>8,709</td><td>1,003.00</td></tr> <tr><td>2016</td><td>2016-660002547</td><td>RUDISAIL, DENNIS A</td><td>10</td><td>102,083</td><td>1000</td><td>8,426</td><td>887.00</td></tr> <tr><td>2015</td><td>2015-660002547</td><td>RUDISAIL, DENNIS A</td><td>10</td><td>98,670</td><td>1000</td><td>8,151</td><td>811.00</td></tr> <tr><td>2014</td><td>2014-660002547</td><td>RUDISAIL, DENNIS A</td><td>10</td><td>99,384</td><td>1000</td><td>7,885</td><td>784.00</td></tr> <tr><td>2013</td><td>2013-660002547</td><td>RUDISAIL, DENNIS A</td><td>10</td><td>97,353</td><td>1000</td><td>7,627</td><td>733.00</td></tr> </tbody> </table>										Tax Year	Statement Number	Billed Owner	Tax Area	Total Value	Exemptions	Taxable Value	Billed Tax	2025	2025-660002547	RUDISAIL, DENTON A	10	89,685	1000	5,855	647.00	2024	2024-660002547	RUDISAIL, DENTON A	10	94,783	1000	5,655	606.00	2023	2023-660002547	RUDISAIL, DENTON A	10	69,456	1000	5,461	582.00	2022	2022-660002547	RUDISAIL, DENTON A	10	69,277	1000	5,273	560.00	2021	2021-660002547	RUDISAIL, DENNIS A	10	56,541	1000	5,090	544.00	2020	2020-660002547	RUDISAIL, DENNIS A	10	57,388	1000	4,913	534.00	2019	2019-660002547	RUDISAIL, DENNIS A	10	52,189	1000	4,741	506.00	2018	2018-660002547	RUDISAIL, DENNIS A	10	56,650	1000	5,231	576.00	2017	2017-660002547	RUDISAIL, DENNIS A	10	103,614	1000	8,709	1,003.00	2016	2016-660002547	RUDISAIL, DENNIS A	10	102,083	1000	8,426	887.00	2015	2015-660002547	RUDISAIL, DENNIS A	10	98,670	1000	8,151	811.00	2014	2014-660002547	RUDISAIL, DENNIS A	10	99,384	1000	7,885	784.00	2013	2013-660002547	RUDISAIL, DENNIS A	10	97,353	1000	7,627	733.00
Tax Year	Statement Number	Billed Owner	Tax Area	Total Value	Exemptions	Taxable Value	Billed Tax																																																																																																																		
2025	2025-660002547	RUDISAIL, DENTON A	10	89,685	1000	5,855	647.00																																																																																																																		
2024	2024-660002547	RUDISAIL, DENTON A	10	94,783	1000	5,655	606.00																																																																																																																		
2023	2023-660002547	RUDISAIL, DENTON A	10	69,456	1000	5,461	582.00																																																																																																																		
2022	2022-660002547	RUDISAIL, DENTON A	10	69,277	1000	5,273	560.00																																																																																																																		
2021	2021-660002547	RUDISAIL, DENNIS A	10	56,541	1000	5,090	544.00																																																																																																																		
2020	2020-660002547	RUDISAIL, DENNIS A	10	57,388	1000	4,913	534.00																																																																																																																		
2019	2019-660002547	RUDISAIL, DENNIS A	10	52,189	1000	4,741	506.00																																																																																																																		
2018	2018-660002547	RUDISAIL, DENNIS A	10	56,650	1000	5,231	576.00																																																																																																																		
2017	2017-660002547	RUDISAIL, DENNIS A	10	103,614	1000	8,709	1,003.00																																																																																																																		
2016	2016-660002547	RUDISAIL, DENNIS A	10	102,083	1000	8,426	887.00																																																																																																																		
2015	2015-660002547	RUDISAIL, DENNIS A	10	98,670	1000	8,151	811.00																																																																																																																		
2014	2014-660002547	RUDISAIL, DENNIS A	10	99,384	1000	7,885	784.00																																																																																																																		
2013	2013-660002547	RUDISAIL, DENNIS A	10	97,353	1000	7,627	733.00																																																																																																																		



# Rogers

## Assessment Property Record Card for Tax Year 2026

Data provided by LISA DELOZIER County Assessor

Date 04/17/2026  
Time 17:43:56  
Page 2

Lot Data	Square-Foot - NBHD 4030 #1	Primary Image
Lot Size		
Lot Count		
Units Buildable	1	
Non-Ag Acres	0	
Topography		
Street Access		
Utilities		
Amenities	LAND QUALITY 4	
Method	Square-Foot	
Base Lot Value		
Factor Value		
Adjustments		
Lot Value		

Residential Data	
Type	1 Single Family Residence
Condition	3 - Average
Quality	2.5 - Fair
Architecture	
Style	100% One Story
Exterior Wall	40% Veneer, Stone 60% Frame, Siding, Vinyl
Base/Total Area	1,308 / 1,308
Style	100% One Story
HVAC	100% Warmed & Cooled Air
Roof Cover	1 Composition Shingle
Area on Slab	0
Fixture/RghIn	4 /
Bed/F/H Bath	3 / 1.0 /
Basement Area	
Garage Type	
Remodel	
Year/Eff Age	1960 / 50

\\tsclient\A\TOMMY DUNLAP\New folder (337)\IMG_0006.JPG	2/23/2024
---	-----------

GRM Approach	
GRM Code	
Gross Rent	0.00
Indicated Value	

Multiple Regression	
MRA Code	
Adjusted R	
Indicated Value	

Direct Comparables	
Selection Model	A Adam Test
Adjustment Model	A2 AO Test
Comparables	
Indicated Value	

Cost Approach				Manual : 01/2025			
Base Cost	104.57	Total Misc Impr	+ 1,540				
Roofing Adj	+ 4.56	Garage Cost	+ 1,540				
Subfloor Adj	+ 1.16	Total RCN	= 166,387				
Heat/Cool Adj	+ 11.47	Depreciation ( 57%)	- 94,841				
Plumbing Adj	+ 4.27	Lump Sums	+ 2,185				
Basement Adj	+ 0.00	RCNLD	= 73,731				
Adj Base Cost	= 126.03	Lot Value	+ 73,731				
Total Area	x 1,308	Indicated Value	= 73,731				
Adjusted Cost	= 164,847	Value Per SqFt	56.37				

Value Reconciliation			
Selected Approach	Cost Approach		
Improvements	73,731		
Lot Value			
Indicated Value	73,731	56.37	Per SqFt
Agland Value	1,438		
Site Improvements	21,429		
Total Value	96,598	73.85	Total Value Per SqFt

Miscellaneous Improvements								
Code	Description	Sketch ID	Size	Year	Units	Unit Cost	Depr	Value
PRCH	SLAB PORCH - COVERED	6759	16x4		64	24.07		1,540
WODO	WOOD DECK - OPEN	6760	20x8		160	22.76	40%	2,185



# Rogers

## Assessment Property Record Card for Tax Year 2026

Data provided by LISA DELOZIER County Assessor

Date 04/17/2026

Time 17:43:56

Page 3

Sketch Image

660002547

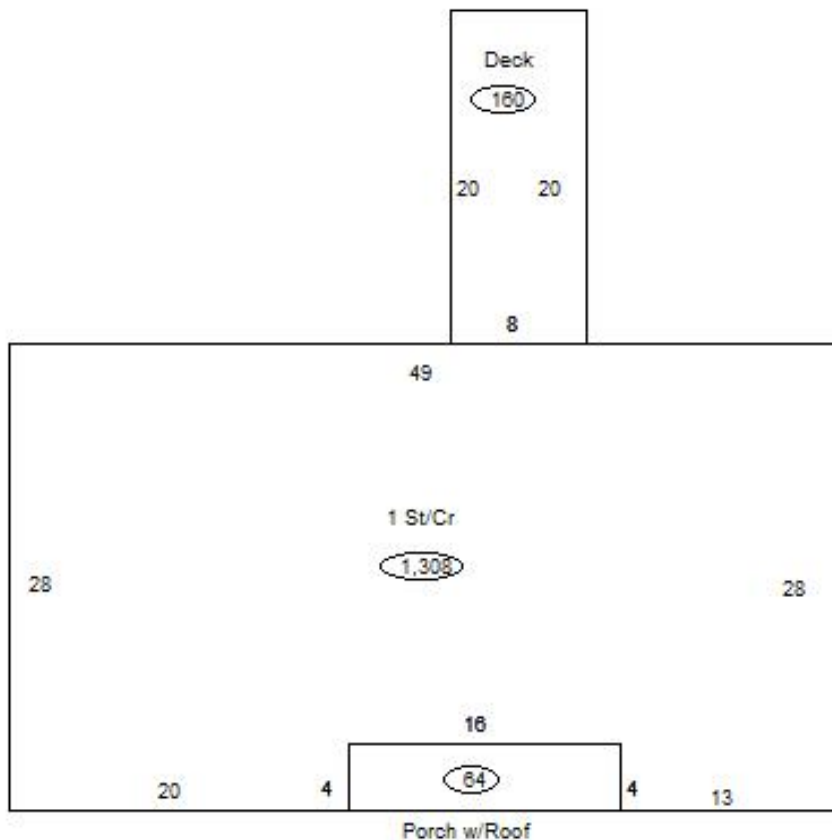

### Sketch Vector Information

Sequence	Code	Type	Built Over	Scale	Section Label	Base Area	Multiplier	Total Area
1	R	1	Crawl	13	1 St/Cr	1,308	1.000	1,308
2	M	PRCH		13	SLBC	64	1.000	64
3	M	WODO		13	WODO	160	1.000	160
<b>Total Building Area</b>						1,308		1,308



# Rogers



## Assessment Property Record Card for Tax Year 2026

Data provided by LISA DELOZIER County Assessor

Date 04/17/2026  
Time 17:43:56  
Page 4

660002547

### Outbuildings/Site Improvements

Building Image	Code	Description	Dimensions	Floor	Roofing	Total Units	
	UTIL	SHOP BUILDING	0x0x0			1,176	
	Qual 2	Cond 3	Year		Eff Age		
	<b>Valuation Summary</b>		<b>Modifier Total</b>	<b>RCN</b>	<b>Depr (40% Phys/ % Func)</b>	<b>RCNLD</b>	
	Base Cost (30.37 x 1,176)		35,715		35,715	14,286	21,429
	STF	STG FAIR	0x0x0				
	Qual 2	Cond	Year		Eff Age		
	<b>Valuation Summary</b>		<b>Modifier Total</b>	<b>RCN</b>	<b>Depr (100% Phys/ % Func)</b>	<b>RCNLD</b>	
	Base Cost (4.68 x )						
	STF	STG FAIR	0x0x0				
	Qual 2	Cond	Year		Eff Age		
	<b>Valuation Summary</b>		<b>Modifier Total</b>	<b>RCN</b>	<b>Depr (100% Phys/ % Func)</b>	<b>RCNLD</b>	
	Base Cost (4.68 x )						



# Rogers

## Assessment Property Record Card for Tax Year 2026

Data provided by LISA DELOZIER County Assessor

Date 04/17/2026  
Time 17:43:57  
Page 5

### Agland Inventory

660002547

Soi	Description	Land Use	LPI	Adj Type	Adj Code	Acres	Use/Acre	Mkt/Acre	Use Value	Market Value
CMB	CLAREMORE SILT LOAM 0-3%	IMP PST	45			5.760	126	126	726	726
DBC	DENNIS-BATES COMPLEX 2-5%	IMP PST	60			4.240	168	168	712	712
<b>IMP PST Totals</b>						10.000			1,438	1,438
<b>Total Agland</b>						10.000			1,438	1,438