



Rogers

Assessment Property Record Card for Tax Year 2026

Data provided by LISA DELOZIER County Assessor

Date 04/17/2026
 Time 16:14:45
 Page 1

Assessment Data					Primary Image																																																																																																																				
Account 660002710 Parcel ID 000000-00-0-50010-009-0010 Cadastral ID 04-19-17-02710 Property Type REAL - Real Property Property Class URP VI Area 3 Tax Area 19 - INOLA OT Name ID 148904 WORTHEAN, JERRY DON PO BOX 871 INOLA OK 74036-0000 Parcel Location Situs 00117 E COMMERCIAL Subdivision INOLA O T Lot/Block 0010 / 0009 Parcel Size 4 - Lots Sec/Twn/Rng 4 / 19 / 17 / 5 Neighborhood 1205 - R-V03-SE INOLA School District S005 - INOLA SCHOOLS					<p>660002710 11/10/25</p> <p>660002710_001.JPG 11/13/2025</p>																																																																																																																				
Legal Description Lot/Long: 36.15296786 -95.50681906 LOTS 7,8,9 & 10 BLOCK 9 INOLA O T																																																																																																																									
Exemptions <table border="1"> <thead> <tr> <th>Code</th> <th>Type</th> <th>Active</th> <th>Maximum</th> <th>Exemption</th> </tr> </thead> <tbody> <tr> <td>H</td> <td>Homestead</td> <td>Yes</td> <td>1,000</td> <td>1,000</td> </tr> <tr> <td>PD</td> <td>Add-Homestead</td> <td>Yes</td> <td>1,000</td> <td>1,000</td> </tr> </tbody> </table>					Code	Type	Active	Maximum	Exemption	H	Homestead	Yes	1,000	1,000	PD	Add-Homestead	Yes	1,000	1,000	Building Permits <table border="1"> <thead> <tr> <th>Number</th> <th>Description</th> <th>Opened</th> <th>Closed</th> <th>Amount</th> </tr> </thead> <tbody> <tr> <td>R17</td> <td>R17-NEW 30X50 SHOP</td> <td>01/2015</td> <td>12/2016</td> <td>10,000</td> </tr> <tr> <td>R13</td> <td>R13-METAL 30X40 SOMETHING</td> <td>04/2011</td> <td>11/2012</td> <td>5,000</td> </tr> </tbody> </table>					Number	Description	Opened	Closed	Amount	R17	R17-NEW 30X50 SHOP	01/2015	12/2016	10,000	R13	R13-METAL 30X40 SOMETHING	04/2011	11/2012	5,000																																																																																		
Code	Type	Active	Maximum	Exemption																																																																																																																					
H	Homestead	Yes	1,000	1,000																																																																																																																					
PD	Add-Homestead	Yes	1,000	1,000																																																																																																																					
Number	Description	Opened	Closed	Amount																																																																																																																					
R17	R17-NEW 30X50 SHOP	01/2015	12/2016	10,000																																																																																																																					
R13	R13-METAL 30X40 SOMETHING	04/2011	11/2012	5,000																																																																																																																					
Parcel Valuation <table border="1"> <thead> <tr> <th>Source</th> <th>REAL</th> <th>Fair Cash</th> <th>Capped</th> <th>Asmnt Level</th> <th>Assessed</th> <th>Levy Rate</th> <th>80.060</th> <th>Current Tax</th> </tr> </thead> <tbody> <tr> <td>Remove Cap</td> <td>0</td> <td>Land Value 32,905</td> <td>23,159</td> <td>11%</td> <td>2,547</td> <td>Assessed</td> <td>7,737</td> <td>619.42</td> </tr> <tr> <td>Year Frozen</td> <td>2014</td> <td>Improvements 67,029</td> <td>47,175</td> <td></td> <td>5,190</td> <td>Penalty</td> <td>0</td> <td></td> </tr> <tr> <td>Uncapped Value</td> <td>0</td> <td>Mobile Home 0</td> <td>0</td> <td></td> <td>0</td> <td>Exemption</td> <td>2,000</td> <td>-160.00</td> </tr> <tr> <td>TIF Project ID</td> <td>0</td> <td>Total Value 99,934</td> <td>70,334</td> <td></td> <td>7,737</td> <td>Total Taxable</td> <td>5,737</td> <td>459.00</td> </tr> </tbody> </table>					Source	REAL	Fair Cash	Capped	Asmnt Level	Assessed	Levy Rate	80.060	Current Tax	Remove Cap	0	Land Value 32,905	23,159	11%	2,547	Assessed	7,737	619.42	Year Frozen	2014	Improvements 67,029	47,175		5,190	Penalty	0		Uncapped Value	0	Mobile Home 0	0		0	Exemption	2,000	-160.00	TIF Project ID	0	Total Value 99,934	70,334		7,737	Total Taxable	5,737	459.00	Sale History <table border="1"> <thead> <tr> <th>Bk/Pg</th> <th>Grantor</th> <th>Date</th> <th>Price</th> <th>Code</th> </tr> </thead> <tbody> <tr> <td></td> <td></td> <td></td> <td></td> <td></td> </tr> </tbody> </table>					Bk/Pg	Grantor	Date	Price	Code																																																														
Source	REAL	Fair Cash	Capped	Asmnt Level	Assessed	Levy Rate	80.060	Current Tax																																																																																																																	
Remove Cap	0	Land Value 32,905	23,159	11%	2,547	Assessed	7,737	619.42																																																																																																																	
Year Frozen	2014	Improvements 67,029	47,175		5,190	Penalty	0																																																																																																																		
Uncapped Value	0	Mobile Home 0	0		0	Exemption	2,000	-160.00																																																																																																																	
TIF Project ID	0	Total Value 99,934	70,334		7,737	Total Taxable	5,737	459.00																																																																																																																	
Bk/Pg	Grantor	Date	Price	Code																																																																																																																					
Assessment History <table border="1"> <thead> <tr> <th>Tax Year</th> <th>Statement Number</th> <th>Billed Owner</th> <th>Tax Area</th> <th>Total Value</th> <th>Exemptions</th> <th>Taxable Value</th> <th>Billed Tax</th> </tr> </thead> <tbody> <tr><td>2025</td><td>2025-660002710</td><td>WORTHEAN, JERRY DON</td><td>19</td><td>97,407</td><td>2000</td><td>5,736</td><td>459.00</td></tr> <tr><td>2024</td><td>2024-660002710</td><td>WORTHEAN, JERRY DON</td><td>19</td><td>98,087</td><td>2000</td><td>5,737</td><td>461.00</td></tr> <tr><td>2023</td><td>2023-660002710</td><td>WORTHEAN, JERRY DON</td><td>19</td><td>70,529</td><td>2000</td><td>5,737</td><td>462.00</td></tr> <tr><td>2022</td><td>2022-660002710</td><td>WORTHEAN, JERRY DON</td><td>19</td><td>71,898</td><td>2000</td><td>5,737</td><td>465.00</td></tr> <tr><td>2021</td><td>2021-660002710</td><td>WORTHEAN, JERRY DON</td><td>19</td><td>77,078</td><td>2000</td><td>5,737</td><td>460.00</td></tr> <tr><td>2020</td><td>2020-660002710</td><td>WORTHEAN, JERRY DON</td><td>19</td><td>75,817</td><td>2000</td><td>5,737</td><td>463.00</td></tr> <tr><td>2019</td><td>2019-660002710</td><td>WORTHEAN, JERRY DON</td><td>19</td><td>75,208</td><td>2000</td><td>5,737</td><td>474.00</td></tr> <tr><td>2018</td><td>2018-660002710</td><td>WORTHEAN, JERRY DON</td><td>19</td><td>85,524</td><td>2000</td><td>5,737</td><td>479.00</td></tr> <tr><td>2017</td><td>2017-660002710</td><td>WORTHEAN, JERRY DON</td><td>19</td><td>83,049</td><td>2000</td><td>5,511</td><td>464.00</td></tr> <tr><td>2016</td><td>2016-660002710</td><td>WORTHEAN, JERRY DON</td><td>19</td><td>79,626</td><td>2000</td><td>5,511</td><td>469.00</td></tr> <tr><td>2015</td><td>2015-660002710</td><td>WORTHEAN, JERRY DON</td><td>19</td><td>80,870</td><td>2000</td><td>5,512</td><td>478.00</td></tr> <tr><td>2014</td><td>2014-660002710</td><td>WORTHEAN, JERRY DON</td><td>19</td><td>84,266</td><td>2000</td><td>5,512</td><td>495.00</td></tr> <tr><td>2013</td><td>2013-660002710</td><td>WORTHEAN, JERRY DON</td><td>19</td><td>83,819</td><td>2000</td><td>5,293</td><td>446.00</td></tr> </tbody> </table>										Tax Year	Statement Number	Billed Owner	Tax Area	Total Value	Exemptions	Taxable Value	Billed Tax	2025	2025-660002710	WORTHEAN, JERRY DON	19	97,407	2000	5,736	459.00	2024	2024-660002710	WORTHEAN, JERRY DON	19	98,087	2000	5,737	461.00	2023	2023-660002710	WORTHEAN, JERRY DON	19	70,529	2000	5,737	462.00	2022	2022-660002710	WORTHEAN, JERRY DON	19	71,898	2000	5,737	465.00	2021	2021-660002710	WORTHEAN, JERRY DON	19	77,078	2000	5,737	460.00	2020	2020-660002710	WORTHEAN, JERRY DON	19	75,817	2000	5,737	463.00	2019	2019-660002710	WORTHEAN, JERRY DON	19	75,208	2000	5,737	474.00	2018	2018-660002710	WORTHEAN, JERRY DON	19	85,524	2000	5,737	479.00	2017	2017-660002710	WORTHEAN, JERRY DON	19	83,049	2000	5,511	464.00	2016	2016-660002710	WORTHEAN, JERRY DON	19	79,626	2000	5,511	469.00	2015	2015-660002710	WORTHEAN, JERRY DON	19	80,870	2000	5,512	478.00	2014	2014-660002710	WORTHEAN, JERRY DON	19	84,266	2000	5,512	495.00	2013	2013-660002710	WORTHEAN, JERRY DON	19	83,819	2000	5,293	446.00
Tax Year	Statement Number	Billed Owner	Tax Area	Total Value	Exemptions	Taxable Value	Billed Tax																																																																																																																		
2025	2025-660002710	WORTHEAN, JERRY DON	19	97,407	2000	5,736	459.00																																																																																																																		
2024	2024-660002710	WORTHEAN, JERRY DON	19	98,087	2000	5,737	461.00																																																																																																																		
2023	2023-660002710	WORTHEAN, JERRY DON	19	70,529	2000	5,737	462.00																																																																																																																		
2022	2022-660002710	WORTHEAN, JERRY DON	19	71,898	2000	5,737	465.00																																																																																																																		
2021	2021-660002710	WORTHEAN, JERRY DON	19	77,078	2000	5,737	460.00																																																																																																																		
2020	2020-660002710	WORTHEAN, JERRY DON	19	75,817	2000	5,737	463.00																																																																																																																		
2019	2019-660002710	WORTHEAN, JERRY DON	19	75,208	2000	5,737	474.00																																																																																																																		
2018	2018-660002710	WORTHEAN, JERRY DON	19	85,524	2000	5,737	479.00																																																																																																																		
2017	2017-660002710	WORTHEAN, JERRY DON	19	83,049	2000	5,511	464.00																																																																																																																		
2016	2016-660002710	WORTHEAN, JERRY DON	19	79,626	2000	5,511	469.00																																																																																																																		
2015	2015-660002710	WORTHEAN, JERRY DON	19	80,870	2000	5,512	478.00																																																																																																																		
2014	2014-660002710	WORTHEAN, JERRY DON	19	84,266	2000	5,512	495.00																																																																																																																		
2013	2013-660002710	WORTHEAN, JERRY DON	19	83,819	2000	5,293	446.00																																																																																																																		



Rogers

Assessment Property Record Card for Tax Year 2026

Data provided by LISA DELOZIER County Assessor

Date 04/17/2026
 Time 16:14:45
 Page 2

Lot Data	Square-Foot - NBHD 1205 #1	Primary Image
Lot Size		
Lot Count	0	
Units Buildable	14000	
Non-Ag Acres	0.3214	
Topography		
Street Access		
Utilities		
Amenities	LAND QUALITY	
	0	
	0	
Method	Square-Foot	
Base Lot Value	14,002.00 x 2.35 = 32,905	
Factor Value		
Adjustments	1.0000	
Lot Value	32,905	

Residential Data	
Type	1 Single Family Residence
Condition	3 - Average
Quality	1.5 - Low
Architecture	TRAD TRADITIONAL
Style	100% One Story
Exterior Wall	100% Masonry, Concrete Block
Base/Total Area	1,528 / 1,528
Style	100% One Story
HVAC	100% Warmed & Cooled Air
Roof Cover	1 Composition Shingle
Area on Slab	1,528
Fixture/RghIn	12 /
Bed/F/H Bath	3 / 1.0 / 1.0
Basement Area	
Garage Type	
Remodel	RMA -
Year/Eff Age	1949 / 58

GRM Approach	
GRM Code	
Gross Rent	0.00
Indicated Value	

Multiple Regression	
MRA Code	1 Test
Adusted R	0.8445
Indicated Value	65,742 43.02 Per SqFt

Direct Comparables	
Selection Model	A Adam Test
Adjustment Model	1 2022 Residential
Comparables	
Indicated Value	

Cost Approach				Manual : 01/2025			
Base Cost	80.90	Total Misc Impr	+ 9,716				
Roofing Adj	+ 3.79	Garage Cost	+ 0				
Subfloor Adj	+ 0.00	Total RCN	= 167,421				
Heat/Cool Adj	+ 9.89	Depreciation (65%)	- 108,824				
Plumbing Adj	+ 8.63	Lump Sums	+ 0				
Basement Adj	+ 0.00	RCNLD	= 58,597				
Adj Base Cost	= 103.21	Lot Value	+ 32,905				
Total Area	x 1,528	Indicated Value	= 91,502				
Adjusted Cost	= 157,705	Value Per SqFt	59.88				

Value Reconciliation	
Selected Approach	Cost Approach
Improvements	58,597
Lot Value	32,905
Indicated Value	91,502 59.88 Per SqFt
Agland Value	
Site Improvements	8,432
Total Value	99,934 65.40 Total Value Per SqFt

Miscellaneous Improvements								
Code	Description	Sketch ID	Size	Year	Units	Unit Cost	Depr	Value
FPR1	FIREPLACE - RESIDENTIAL 1 STORY	0		1	1	4,394.05		4,394
PRCH	SLAB PORCH - COVERED	6974	20x8		160	20.10		3,216
PRCH	SLAB PORCH - COVERED	6975	13x8		104	20.25		2,106



Rogers

Assessment Property Record Card for Tax Year 2026

Data provided by LISA DELOZIER County Assessor

Date 04/17/2026

Time 16:14:45

Page 3

Sketch Image

660002710

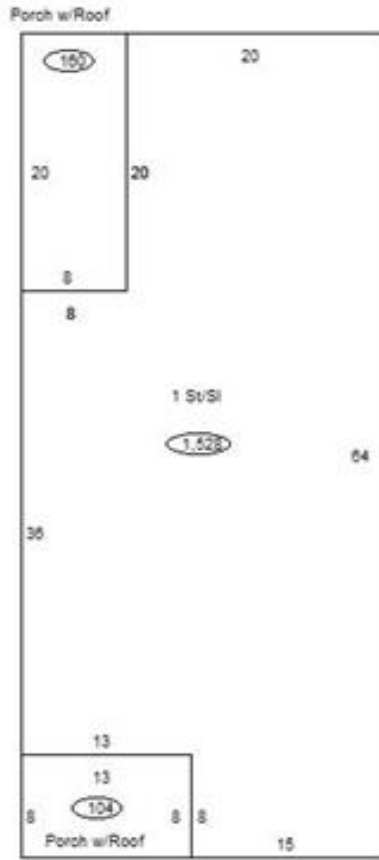

Sketch Vector Information

Sequence	Code	Type	Built Over	Scale	Section Label	Base Area	Multiplier	Total Area
1	R	1	Slab	13	1 St/SI	1,528	1.000	1,528
2	M	PRCH		13	SLBC	160	1.000	160
3	M	PRCH		13	SLBC	104	1.000	104
Total Building Area						1,528		1,528



Rogers



Assessment Property Record Card for Tax Year 2026

Data provided by LISA DELOZIER County Assessor

Date 04/17/2026
 Time 16:14:45
 Page 4

660002710

Outbuildings/Site Improvements

Building Image	Code	Description	Dimensions	Floor	Roofing	Total Units
	SHDS	Shed - Small	20x16x8	Concrete	Composition Shingle	320
	Qual	2	Cond 3	Year 1990	Eff Age 27	
	Valuation Summary		Modifier Total	RCN	Depr (71% Phys/ % Func)	RCNLD
	Base Cost (16.66 x 320)		5,331	5,331	3,785	1,546
	GRDT	Garage - Detached	30x34x8	Concrete	Composition Shingle	1,020
	Qual	2	Cond 3	Year 1980	Eff Age 35	
	Valuation Summary		Modifier Total	RCN	Depr (61% Phys/ % Func)	RCNLD
	Base Cost (17.31 x 1,020)		17,656	17,656	10,770	6,886