



Rogers

Assessment Property Record Card for Tax Year 2026

Data provided by LISA DELOZIER County Assessor

Date 04/17/2026
Time 16:56:14
Page 1

Assessment Data					Primary Image									
Account	660002724													
Parcel ID	000000-00-0-50010-012-0004													
Cadastral ID	04-19-17-02850													
Property Type	REAL - Real Property													
Property Class	URP	VI Area	3											
Tax Area	19 - INOLA OT													
Name ID	149104													
DEBOER, JOHN JR &														
LISA D PO BOX 615 INOLA OK 74036-0000														
Parcel Location														
Situs	00130 A ST SE													
Subdivision	INOLA O T													
Lot/Block	0004 / 0012	Parcel Size	1 - Lots											
Sec/Twn/Rng	4 / 19 / 17 / 5													
Neighborhood	1205 - R-V03-SE INOLA													
School District	S005 - INOLA SCHOOLS													
Legal Description Lat/Long: 36.15340744 -95.51002894														
S 80' LOT 4 BLOCK 12 INOLA O T														
Building Permits														
<table border="1"> <thead> <tr> <th>Number</th> <th>Description</th> <th>Opened</th> <th>Closed</th> <th>Amount</th> </tr> </thead> <tbody> <tr> <td colspan="5"> </td> </tr> </tbody> </table>					Number	Description	Opened	Closed	Amount					
Number	Description	Opened	Closed	Amount										
Exemptions														
Code	Type	Active	Maximum	Exemption										
H	Homestead	Yes	1,000	1,000										
Sale History														
Bk/Pg	Grantor	Date	Price	Code										
Parcel Valuation														
Source	REAL	Fair Cash	Capped	Asmnt Level	Assessed	Levy Rate	80.060	Current Tax						
Remove Cap	0	Land Value	26,322	11,146	11%	1,226	Assessed	3,259	260.92					
Year Frozen	0	Improvements	46,650	18,481		2,033	Penalty	0						
Uncapped Value	0	Mobile Home	0	0		0	Exemption	1,000	-80.00					
TIF Project ID	0	Total Value	72,972	29,627		3,259	Total Taxable	2,259	181.00					
Assessment History														
Tax Year	Statement Number	Billed Owner	Tax Area	Total Value	Exemptions	Taxable Value	Billed Tax							
2025	2025-660002724	DEBOER, JOHN JR &	19	66,203	1000	2,164	173.00							
2024	2024-660002724	DEBOER, JOHN JR &	19	66,729	1000	2,072	167.00							
2023	2023-660002724	DEBOER, JOHN JR &	19	30,440	1000	1,982	160.00							
2022	2022-660002724	DEBOER, JOHN JR &	19	30,798	1000	1,896	154.00							
2021	2021-660002724	DEBOER, JOHN JR &	19	25,560	1000	1,811	145.00							
2020	2020-660002724	DEBOER, JOHN JR &	19	25,299	1000	1,778	144.00							
2019	2019-660002724	DEBOER, JOHN JR &	19	24,524	1000	1,697	140.00							
2018	2018-660002724	DEBOER, JOHN JR &	19	26,328	1000	1,896	158.00							
2017	2017-660002724	DEBOER, JOHN JR &	19	26,335	1000	1,861	157.00							
2016	2016-660002724	DEBOER, JOHN JR &	19	25,256	1000	1,778	151.00							
2015	2015-660002724	DEBOER, JOHN JR &	19	25,429	1000	1,797	156.00							
2014	2014-660002724	DEBOER, JOHN JR &	19	25,956	1000	1,721	155.00							
2013	2013-660002724	DEBOER, JOHN JR &	19	24,262	1000	1,642	138.00							



Rogers

Assessment Property Record Card for Tax Year 2026

Data provided by LISA DELOZIER County Assessor

Date 04/17/2026
 Time 16:56:15
 Page 2

Lot Data	Square-Foot - NBHD 1205 #1	Primary Image
Lot Size Lot Count Units Buildable 11200 Non-Ag Acres 0.2571 Topography Street Access Utilities Amenities LAND QUALITY 0 0 Method Square-Foot Base Lot Value 11,201.00 x 2.35 = 26,322 Factor Value Adjustments 1.0000 Lot Value 26,322		

Residential Data	
Type	1 Single Family Residence
Condition	3 - Average
Quality	2 - Fair
Architecture	TRAD TRADITIONAL
Style	100% One Story
Exterior Wall	100% Frame, Siding, Wood
Base/Total Area	804 / 804
Style	100% One Story
HVAC	
Roof Cover	4 Metal, Preformed
Area on Slab	0
Fixture/RghIn	5 /
Bed/F/H Bath	3 / 1.0 /
Basement Area	
Garage Type	132 Attached Garage - Finished 1 Stalls
Remodel	
Year/Eff Age	1949 / 58

GRM Approach
GRM Code Gross Rent 0.00 Indicated Value

Multiple Regression
MRA Code 1 Test Adusted R 0.8445 Indicated Value 61,524 76.52 Per SqFt

Direct Comparables
Selection Model A Adam Test Adjustment Model 1 2022 Residential Comparables Indicated Value

Cost Approach				Manual : 01/2025	
Base Cost	102.92	Total Misc Impr	+	425	
Roofing Adj	+ 5.44	Garage Cost	+	4,938	
Subfloor Adj	+ 2.65	Total RCN	=	100,717	
Heat/Cool Adj	+ 0.00	Depreciation (65%)	-	65,466	
Plumbing Adj	+ 7.59	Lump Sums	+	2,197	
Basement Adj	+ 0.00	RCNLD	=	37,448	
Adj Base Cost	= 118.60	Lot Value	+	26,322	
Total Area	x 804	Indicated Value	=	63,770	
Adjusted Cost	= 95,354	Value Per SqFt		79.32	

Value Reconciliation
Selected Approach Cost Approach Improvements 37,448 Lot Value 26,322 Indicated Value 63,770 79.32 Per SqFt Agland Value Site Improvements 9,202 Total Value 72,972 90.76 Total Value Per SqFt

Miscellaneous Improvements								
Code	Description	Sketch ID	Size	Year	Units	Unit Cost	Depr	Value
PRCH	SLAB PORCH - COVERED	6998	5x4		20	21.23		425
WODO	WOOD DECK - OPEN	6999	12x8		96	24.35	6%	2,197



Rogers

Assessment Property Record Card for Tax Year 2026

Data provided by LISA DELOZIER County Assessor

Date 04/17/2026
 Time 16:56:15
 Page 3

Sketch Image

660002724

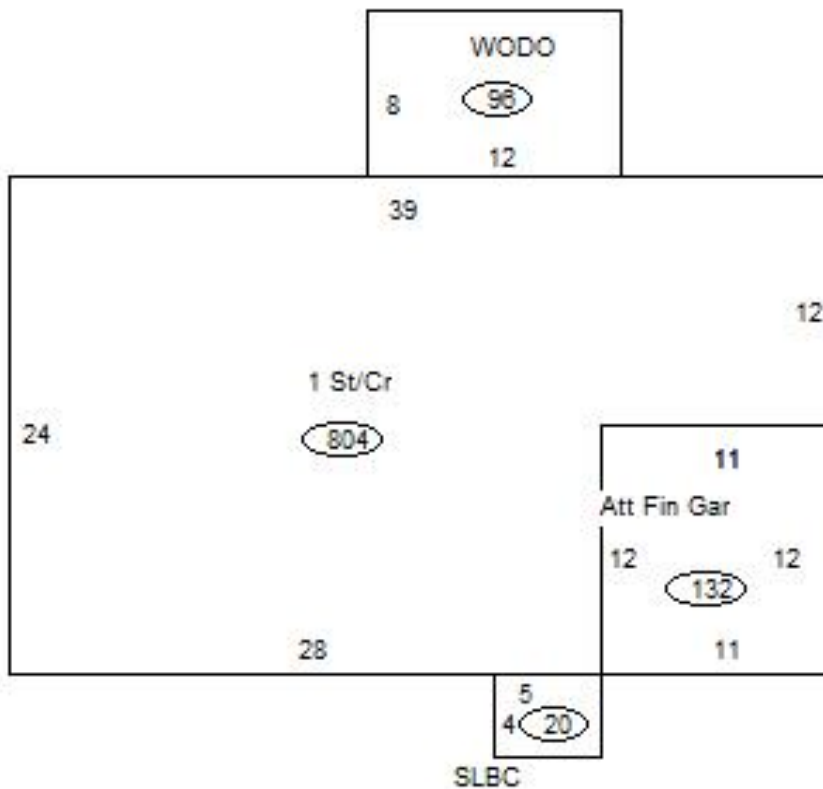

Sketch Vector Information

Sequence	Code	Type	Built Over	Scale	Section Label	Base Area	Multiplier	Total Area
1	R	1	Crawl	13	1 St/Cr	804	1.000	804
2	G	5		13	Att Fin Gar	132	1.000	132
3	M	PRCH		13	SLBC	20	1.000	20
4	M	WODO		13	WODO	96	1.000	96
Total Building Area						804		804



Rogers



Assessment Property Record Card for Tax Year 2026

Data provided by LISA DELOZIER County Assessor

Date 04/17/2026
 Time 16:56:15
 Page 4

660002724

Outbuildings/Site Improvements

Building Image	Code	Description	Dimensions	Floor	Roofing	Total Units
	UTIL	Utility Building	18x20x8	Concrete	Formed Metal	360
	Qual 2	Cond 3	Year 2010	Eff Age 12		
	Valuation Summary Base Cost (32.21 x 360) 11,596		Modifier Total	RCN 11,596	Depr (25% Phys/ % Func) 2,899	RCNLD 8,697
	SHDS	Shed - Small	10x3x5	Plank	Formed Metal	30
	Qual 2	Cond 3	Year 2010	Eff Age 12		
	Valuation Summary Base Cost (31.21 x 30) 936		Modifier Total	RCN 936	Depr (46% Phys/ % Func) 431	RCNLD 505