



# Rogers

## Assessment Property Record Card for Tax Year 2026

Data provided by LISA DELOZIER County Assessor

Date 04/17/2026  
Time 05:54:20  
Page 1

Assessment Data					Primary Image																																																																																																																				
<b>Account</b> 660002725 <b>Parcel ID</b> 000000-00-0-50010-012-0005 <b>Cadastral ID</b> 04-19-17-02860 <b>Property Type</b> REAL - Real Property <b>Property Class</b> URP VI Area 3 <b>Tax Area</b> 19 - INOLA OT <b>Name ID</b> 311920 PARKER, JACOB A & WHITNEY K  PO BOX 852 INOLA OK 74036-0000  <b>Parcel Location</b> <b>Situs</b> 00120 A ST NE <b>Subdivision</b> INOLA O T <b>Lot/Block</b> 0005 / 0012 Parcel Size 1 - Lots <b>Sec/Twn/Rng</b> 4 / 19 / 17 / 5 <b>Neighborhood</b> 1205 - R-V03-SE INOLA <b>School District</b> S005 - INOLA SCHOOLS					 <p>660002725 11/11/25</p> <p>660002725_001.JPG 11/13/2025</p>																																																																																																																				
<b>Legal Description</b> Lot/Long: 36.15320728 -95.50990318 LOT 5 BLOCK 12 INOLA O T																																																																																																																									
<b>Exemptions</b> <table border="1"> <thead> <tr> <th>Code</th> <th>Type</th> <th>Active</th> <th>Maximum</th> <th>Exemption</th> </tr> </thead> <tbody> <tr> <td>H</td> <td>Homestead</td> <td>Yes</td> <td>1,000</td> <td>1,000</td> </tr> </tbody> </table>					Code	Type	Active	Maximum	Exemption	H	Homestead	Yes	1,000	1,000	<b>Building Permits</b> <table border="1"> <thead> <tr> <th>Number</th> <th>Description</th> <th>Opened</th> <th>Closed</th> <th>Amount</th> </tr> </thead> <tbody> <tr><td> </td><td> </td><td> </td><td> </td><td> </td></tr> <tr><td> </td><td> </td><td> </td><td> </td><td> </td></tr> <tr><td> </td><td> </td><td> </td><td> </td><td> </td></tr> <tr><td> </td><td> </td><td> </td><td> </td><td> </td></tr> <tr><td> </td><td> </td><td> </td><td> </td><td> </td></tr> <tr><td> </td><td> </td><td> </td><td> </td><td> </td></tr> <tr><td> </td><td> </td><td> </td><td> </td><td> </td></tr> <tr><td> </td><td> </td><td> </td><td> </td><td> </td></tr> <tr><td> </td><td> </td><td> </td><td> </td><td> </td></tr> <tr><td> </td><td> </td><td> </td><td> </td><td> </td></tr> </tbody> </table>					Number	Description	Opened	Closed	Amount																																																																																																	
Code	Type	Active	Maximum	Exemption																																																																																																																					
H	Homestead	Yes	1,000	1,000																																																																																																																					
Number	Description	Opened	Closed	Amount																																																																																																																					
<b>Parcel Valuation</b> <table border="1"> <thead> <tr> <th>Source</th> <th>REAL</th> <th>Fair Cash</th> <th>Capped</th> <th>Asmnt Level</th> <th>Assessed</th> <th>Levy Rate</th> <th>80.060</th> <th>Current Tax</th> </tr> </thead> <tbody> <tr> <td>Remove Cap</td> <td>2015</td> <td>Land Value 32,905</td> <td>13,136</td> <td>11%</td> <td>1,445</td> <td>Assessed</td> <td>12,522</td> <td>1,002.51</td> </tr> <tr> <td>Year Frozen</td> <td>0</td> <td>Improvements 117,596</td> <td>100,699</td> <td></td> <td>11,077</td> <td>Penalty</td> <td>0</td> <td></td> </tr> <tr> <td>Uncapped Value</td> <td>0</td> <td>Mobile Home 0</td> <td>0</td> <td></td> <td>0</td> <td>Exemption</td> <td>1,000</td> <td>-81.00</td> </tr> <tr> <td>TIF Project ID</td> <td>0</td> <td>Total Value 150,501</td> <td>113,835</td> <td></td> <td>12,522</td> <td>Total Taxable</td> <td>11,522</td> <td>922.00</td> </tr> </tbody> </table>					Source	REAL	Fair Cash	Capped	Asmnt Level	Assessed	Levy Rate	80.060	Current Tax	Remove Cap	2015	Land Value 32,905	13,136	11%	1,445	Assessed	12,522	1,002.51	Year Frozen	0	Improvements 117,596	100,699		11,077	Penalty	0		Uncapped Value	0	Mobile Home 0	0		0	Exemption	1,000	-81.00	TIF Project ID	0	Total Value 150,501	113,835		12,522	Total Taxable	11,522	922.00	<b>Sale History</b> <table border="1"> <thead> <tr> <th>Bk/Pg</th> <th>Grantor</th> <th>Date</th> <th>Price</th> <th>Code</th> </tr> </thead> <tbody> <tr> <td>2392/176</td> <td>POLYMATHIC PROPERTIES INC</td> <td>03/24/2014</td> <td>92,500</td> <td>YES</td> </tr> <tr> <td>2347/580</td> <td>JPMORGAN CHASE BANK NA</td> <td>07/22/2013</td> <td>48,500</td> <td>3</td> </tr> <tr> <td>2281/567</td> <td>THORNTON, JACLYN</td> <td>10/18/2012</td> <td>0</td> <td>10</td> </tr> <tr> <td>1659/384</td> <td>WALTER MORTGAGE COMPANY</td> <td>01/29/2005</td> <td>0</td> <td>9</td> </tr> <tr> <td>1635/479</td> <td>BOST, WESLEY EARL &amp;</td> <td>09/02/2004</td> <td>0</td> <td>10</td> </tr> <tr> <td>1143/221</td> <td>DYER, TOMMY RAY &amp;</td> <td>11/21/1998</td> <td>17,500</td> <td>No</td> </tr> </tbody> </table>					Bk/Pg	Grantor	Date	Price	Code	2392/176	POLYMATHIC PROPERTIES INC	03/24/2014	92,500	YES	2347/580	JPMORGAN CHASE BANK NA	07/22/2013	48,500	3	2281/567	THORNTON, JACLYN	10/18/2012	0	10	1659/384	WALTER MORTGAGE COMPANY	01/29/2005	0	9	1635/479	BOST, WESLEY EARL &	09/02/2004	0	10	1143/221	DYER, TOMMY RAY &	11/21/1998	17,500	No																																
Source	REAL	Fair Cash	Capped	Asmnt Level	Assessed	Levy Rate	80.060	Current Tax																																																																																																																	
Remove Cap	2015	Land Value 32,905	13,136	11%	1,445	Assessed	12,522	1,002.51																																																																																																																	
Year Frozen	0	Improvements 117,596	100,699		11,077	Penalty	0																																																																																																																		
Uncapped Value	0	Mobile Home 0	0		0	Exemption	1,000	-81.00																																																																																																																	
TIF Project ID	0	Total Value 150,501	113,835		12,522	Total Taxable	11,522	922.00																																																																																																																	
Bk/Pg	Grantor	Date	Price	Code																																																																																																																					
2392/176	POLYMATHIC PROPERTIES INC	03/24/2014	92,500	YES																																																																																																																					
2347/580	JPMORGAN CHASE BANK NA	07/22/2013	48,500	3																																																																																																																					
2281/567	THORNTON, JACLYN	10/18/2012	0	10																																																																																																																					
1659/384	WALTER MORTGAGE COMPANY	01/29/2005	0	9																																																																																																																					
1635/479	BOST, WESLEY EARL &	09/02/2004	0	10																																																																																																																					
1143/221	DYER, TOMMY RAY &	11/21/1998	17,500	No																																																																																																																					
<b>Assessment History</b> <table border="1"> <thead> <tr> <th>Tax Year</th> <th>Statement Number</th> <th>Billed Owner</th> <th>Tax Area</th> <th>Total Value</th> <th>Exemptions</th> <th>Taxable Value</th> <th>Billed Tax</th> </tr> </thead> <tbody> <tr><td>2025</td><td>2025-660002725</td><td>PARKER, JACOB A &amp; WHITNEY K</td><td>19</td><td>148,155</td><td>1000</td><td>11,157</td><td>893.00</td></tr> <tr><td>2024</td><td>2024-660002725</td><td>PARKER, JACOB A &amp; WHITNEY K</td><td>19</td><td>153,221</td><td>1000</td><td>10,803</td><td>869.00</td></tr> <tr><td>2023</td><td>2023-660002725</td><td>PARKER, JACOB A &amp; WHITNEY K</td><td>19</td><td>104,176</td><td>1000</td><td>10,459</td><td>842.00</td></tr> <tr><td>2022</td><td>2022-660002725</td><td>PARKER, JACOB A &amp; WHITNEY K</td><td>19</td><td>104,177</td><td>1000</td><td>10,279</td><td>834.00</td></tr> <tr><td>2021</td><td>2021-660002725</td><td>PARKER, JACOB A &amp; WHITNEY K</td><td>19</td><td>99,554</td><td>1000</td><td>9,951</td><td>797.00</td></tr> <tr><td>2020</td><td>2020-660002725</td><td>PARKER, JACOB A &amp; WHITNEY K</td><td>19</td><td>98,984</td><td>1000</td><td>9,645</td><td>779.00</td></tr> <tr><td>2019</td><td>2019-660002725</td><td>PARKER, JACOB A &amp; WHITNEY K</td><td>19</td><td>93,959</td><td>1000</td><td>9,335</td><td>771.00</td></tr> <tr><td>2018</td><td>2018-660002725</td><td>PARKER, JACOB A &amp; WHITNEY K</td><td>19</td><td>97,880</td><td>1000</td><td>9,767</td><td>815.00</td></tr> <tr><td>2017</td><td>2017-660002725</td><td>PARKER, JACOB A &amp; WHITNEY K</td><td>19</td><td>97,045</td><td>1000</td><td>9,675</td><td>814.00</td></tr> <tr><td>2016</td><td>2016-660002725</td><td>PARKER, JACOB A &amp; WHITNEY K</td><td>19</td><td>94,413</td><td>1000</td><td>9,385</td><td>798.00</td></tr> <tr><td>2015</td><td>2015-660002725</td><td>PARKER, JACOB A &amp; WHITNEY K</td><td>19</td><td>92,576</td><td>1000</td><td>9,183</td><td>797.00</td></tr> <tr><td>2014</td><td>2014-660002725</td><td>PARKER, JACOB A &amp; WHITNEY K</td><td>19</td><td>94,315</td><td>0</td><td>10,375</td><td>932.00</td></tr> <tr><td>2013</td><td>2013-660002725</td><td>POLYMATHIC PROPERTIES INC</td><td>19</td><td>96,826</td><td>0</td><td>10,336</td><td>871.00</td></tr> </tbody> </table>										Tax Year	Statement Number	Billed Owner	Tax Area	Total Value	Exemptions	Taxable Value	Billed Tax	2025	2025-660002725	PARKER, JACOB A & WHITNEY K	19	148,155	1000	11,157	893.00	2024	2024-660002725	PARKER, JACOB A & WHITNEY K	19	153,221	1000	10,803	869.00	2023	2023-660002725	PARKER, JACOB A & WHITNEY K	19	104,176	1000	10,459	842.00	2022	2022-660002725	PARKER, JACOB A & WHITNEY K	19	104,177	1000	10,279	834.00	2021	2021-660002725	PARKER, JACOB A & WHITNEY K	19	99,554	1000	9,951	797.00	2020	2020-660002725	PARKER, JACOB A & WHITNEY K	19	98,984	1000	9,645	779.00	2019	2019-660002725	PARKER, JACOB A & WHITNEY K	19	93,959	1000	9,335	771.00	2018	2018-660002725	PARKER, JACOB A & WHITNEY K	19	97,880	1000	9,767	815.00	2017	2017-660002725	PARKER, JACOB A & WHITNEY K	19	97,045	1000	9,675	814.00	2016	2016-660002725	PARKER, JACOB A & WHITNEY K	19	94,413	1000	9,385	798.00	2015	2015-660002725	PARKER, JACOB A & WHITNEY K	19	92,576	1000	9,183	797.00	2014	2014-660002725	PARKER, JACOB A & WHITNEY K	19	94,315	0	10,375	932.00	2013	2013-660002725	POLYMATHIC PROPERTIES INC	19	96,826	0	10,336	871.00
Tax Year	Statement Number	Billed Owner	Tax Area	Total Value	Exemptions	Taxable Value	Billed Tax																																																																																																																		
2025	2025-660002725	PARKER, JACOB A & WHITNEY K	19	148,155	1000	11,157	893.00																																																																																																																		
2024	2024-660002725	PARKER, JACOB A & WHITNEY K	19	153,221	1000	10,803	869.00																																																																																																																		
2023	2023-660002725	PARKER, JACOB A & WHITNEY K	19	104,176	1000	10,459	842.00																																																																																																																		
2022	2022-660002725	PARKER, JACOB A & WHITNEY K	19	104,177	1000	10,279	834.00																																																																																																																		
2021	2021-660002725	PARKER, JACOB A & WHITNEY K	19	99,554	1000	9,951	797.00																																																																																																																		
2020	2020-660002725	PARKER, JACOB A & WHITNEY K	19	98,984	1000	9,645	779.00																																																																																																																		
2019	2019-660002725	PARKER, JACOB A & WHITNEY K	19	93,959	1000	9,335	771.00																																																																																																																		
2018	2018-660002725	PARKER, JACOB A & WHITNEY K	19	97,880	1000	9,767	815.00																																																																																																																		
2017	2017-660002725	PARKER, JACOB A & WHITNEY K	19	97,045	1000	9,675	814.00																																																																																																																		
2016	2016-660002725	PARKER, JACOB A & WHITNEY K	19	94,413	1000	9,385	798.00																																																																																																																		
2015	2015-660002725	PARKER, JACOB A & WHITNEY K	19	92,576	1000	9,183	797.00																																																																																																																		
2014	2014-660002725	PARKER, JACOB A & WHITNEY K	19	94,315	0	10,375	932.00																																																																																																																		
2013	2013-660002725	POLYMATHIC PROPERTIES INC	19	96,826	0	10,336	871.00																																																																																																																		



# Rogers

## Assessment Property Record Card for Tax Year 2026

Data provided by LISA DELOZIER County Assessor

Date 04/17/2026  
 Time 05:54:20  
 Page 2

Lot Data		Square-Foot - NBHD 1205 #1	
Lot Size			
Lot Count			
Units Buildable	14000		
Non-Ag Acres	0.3214		
Topography			
Street Access			
Utilities			
Amenities	LAND QUALITY	0	
		0	
Method	Square-Foot		
Base Lot Value	14,002.00 x 2.35 = 32,905		
Factor Value			
Adjustments	1.0000		
Lot Value	32,905		



Residential Data	
Type	1 Single Family Residence
Condition	3 - Average
Quality	2 - Fair
Architecture	TRAD TRADITIONAL
Style	100% One Story
Exterior Wall	100% Frame, Siding, Wood
Base/Total Area	1,404 / 1,404
Style	100% One Story
HVAC	100% Warmed & Cooled Air
Roof Cover	1 Composition Shingle
Area on Slab	0
Fixture/RghIn	11 /
Bed/F/H Bath	4 / 2.0 /
Basement Area	
Garage Type	
Remodel	
Year/Eff Age	2000 / 20

GRM Approach	
GRM Code	
Gross Rent	0.00
Indicated Value	

Multiple Regression			
MRA Code	1	Test	
Adusted R	0.8445		
Indicated Value	118,388	84.32	Per SqFt

Direct Comparables			
Selection Model	A	Adam Test	
Adjustment Model	1	2022 Residential	
Comparables	2		
Indicated Value	112,370		Per SqFt

Cost Approach		Manual : 01/2025	
Base Cost	85.60	Total Misc Impr	+ 2,756
Roofing Adj	+ 3.87	Garage Cost	+
Subfloor Adj	+ 2.30	Total RCN	= 158,712
Heat/Cool Adj	+ 10.30	Depreciation ( 27%)	- 42,852
Plumbing Adj	+ 9.01	Lump Sums	+ 661
Basement Adj	+ 0.00	RCNLD	= 116,521
Adj Base Cost	= 111.08	Lot Value	+ 32,905
Total Area	x 1,404	Indicated Value	= 149,426
Adjusted Cost	= 155,956	Value Per SqFt	106.43

Value Reconciliation			
Selected Approach	Cost Approach		
Improvements	116,521		
Lot Value	32,905		
Indicated Value	149,426	106.43	Per SqFt
Agland Value			
Site Improvements	1,075		
Total Value	150,501	107.19	Total Value Per SqFt

Miscellaneous Improvements								
Code	Description	Sketch ID	Size	Year	Units	Unit Cost	Depr	Value
PRCH	SLAB PORCH - COVERED	7001	22x6		132	20.88		2,756
WODO	WOOD DECK - OPEN	7002	6x4		24	27.55		661



# Rogers

## Assessment Property Record Card for Tax Year 2026

Data provided by LISA DELOZIER County Assessor

Date 04/17/2026  
 Time 05:54:21  
 Page 3

### Sketch Image

660002725

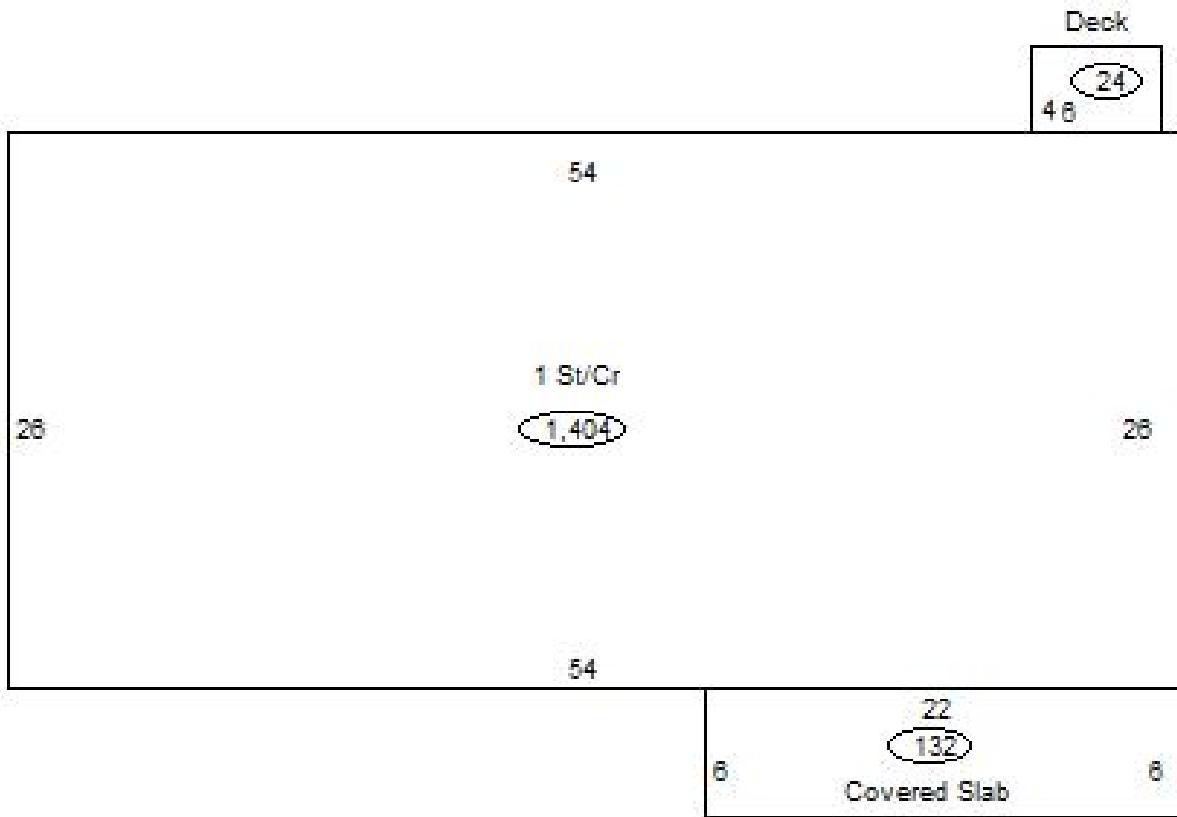

### Sketch Vector Information

Sequence	Code	Type	Built Over	Scale	Section Label	Base Area	Multiplier	Total Area
1	R	1	Crawl	13	1 St/Cr	1,404	1.000	1,404
2	M	PRCH		13	SLBC	132	1.000	132
3	M	WODO		13	WODO	24	1.000	24
<b>Total Building Area</b>						1,404		1,404



# Rogers

## Assessment Property Record Card for Tax Year 2026

Data provided by LISA DELOZIER County Assessor

Date 04/17/2026  
Time 05:54:21  
Page 4

660002725

### Outbuildings/Site Improvements

Building Image	Code	Description	Dimensions	Floor	Roofing	Total Units	
	SHDS	Shed - Small	8x10x8	Plank	Composition Shingle	80	
	Qual	2	Cond 3	Year	2010	Eff Age	12
		<b>Valuation Summary</b>	<b>Modifier Total</b>	<b>RCN</b>	<b>Depr (46% Phys/ % Func)</b>	<b>RCNLD</b>	
		Base Cost (24.87 x 80)	1,990		1,990	915	1,075