



Rogers

Assessment Property Record Card for Tax Year 2026

Data provided by LISA DELOZIER County Assessor

Date 04/17/2026
 Time 18:16:55
 Page 1

Assessment Data					Primary Image																																																																																																																				
Account 660002738 Parcel ID 000000-00-0-50010-014-0012 Cadastral ID 04-19-17-02970 Property Type REAL - Real Property Property Class UCP VI Area 3 Tax Area 19 - INOLA OT Name ID 267899 WILLIAMS, GREGORY A PO BOX 610 INOLA OK 74036-0000 Parcel Location Situs 00011 E COMMERCIAL Subdivision INOLA O T Lot/Block 0012 / 0014 Parcel Size 1.57 - Lots Sec/Twn/Rng 4 / 19 / 17 / 5 Neighborhood 5001 - TASC 2016 School District S005 - INOLA SCHOOLS					<p>660002738_001.JPG 11/13/2025</p>																																																																																																																				
Legal Description Lat/Long: 36.15176982 -95.50888635 W 110' OF LOT 11 & LOT 12 BLOCK 14 INOLA O T																																																																																																																									
Exemptions					Building Permits																																																																																																																				
<table border="1"> <thead> <tr> <th>Code</th> <th>Type</th> <th>Active</th> <th>Maximum</th> <th>Exemption</th> </tr> </thead> <tbody> <tr> <td></td> <td></td> <td></td> <td></td> <td></td> </tr> </tbody> </table>					Code	Type	Active	Maximum	Exemption						<table border="1"> <thead> <tr> <th>Number</th> <th>Description</th> <th>Opened</th> <th>Closed</th> <th>Amount</th> </tr> </thead> <tbody> <tr> <td></td> <td></td> <td></td> <td></td> <td></td> </tr> </tbody> </table>					Number	Description	Opened	Closed	Amount																																																																																																	
Code	Type	Active	Maximum	Exemption																																																																																																																					
Number	Description	Opened	Closed	Amount																																																																																																																					
<table border="1"> <thead> <tr> <th>Code</th> <th>Type</th> <th>Active</th> <th>Maximum</th> <th>Exemption</th> </tr> </thead> <tbody> <tr> <td></td> <td></td> <td></td> <td></td> <td></td> </tr> </tbody> </table>					Code	Type	Active	Maximum	Exemption						Sale History <table border="1"> <thead> <tr> <th>Bk/Pg</th> <th>Grantor</th> <th>Date</th> <th>Price</th> <th>Code</th> </tr> </thead> <tbody> <tr> <td>1102/226</td> <td>COUSPARIS, MARY ET AL</td> <td>01/14/1998</td> <td>35,000</td> <td>No</td> </tr> <tr> <td>878/349</td> <td></td> <td>03/31/1992</td> <td>0</td> <td>No</td> </tr> </tbody> </table>					Bk/Pg	Grantor	Date	Price	Code	1102/226	COUSPARIS, MARY ET AL	01/14/1998	35,000	No	878/349		03/31/1992	0	No																																																																																							
Code	Type	Active	Maximum	Exemption																																																																																																																					
Bk/Pg	Grantor	Date	Price	Code																																																																																																																					
1102/226	COUSPARIS, MARY ET AL	01/14/1998	35,000	No																																																																																																																					
878/349		03/31/1992	0	No																																																																																																																					
Parcel Valuation <table border="1"> <thead> <tr> <th>Source</th> <th>REAL</th> <th>Fair Cash</th> <th>Capped</th> <th>Asmnt Level</th> <th>Assessed</th> <th>Levy Rate</th> <th>80.060</th> <th>Current Tax</th> </tr> </thead> <tbody> <tr> <td>Remove Cap</td> <td>1999</td> <td>Land Value 8,250</td> <td>8,250</td> <td>11%</td> <td>908</td> <td>Assessed</td> <td>5,964</td> <td>477.48</td> </tr> <tr> <td>Year Frozen</td> <td>0</td> <td>Improvements 137,733</td> <td>45,961</td> <td></td> <td>5,056</td> <td>Penalty</td> <td>0</td> <td></td> </tr> <tr> <td>Uncapped Value</td> <td>0</td> <td>Mobile Home 0</td> <td>0</td> <td></td> <td>0</td> <td>Exemption</td> <td>0</td> <td>0.00</td> </tr> <tr> <td>TIF Project ID</td> <td>0</td> <td>Total Value 145,983</td> <td>54,211</td> <td></td> <td>5,964</td> <td>Total Taxable</td> <td>5,964</td> <td>477.00</td> </tr> </tbody> </table>										Source	REAL	Fair Cash	Capped	Asmnt Level	Assessed	Levy Rate	80.060	Current Tax	Remove Cap	1999	Land Value 8,250	8,250	11%	908	Assessed	5,964	477.48	Year Frozen	0	Improvements 137,733	45,961		5,056	Penalty	0		Uncapped Value	0	Mobile Home 0	0		0	Exemption	0	0.00	TIF Project ID	0	Total Value 145,983	54,211		5,964	Total Taxable	5,964	477.00																																																																			
Source	REAL	Fair Cash	Capped	Asmnt Level	Assessed	Levy Rate	80.060	Current Tax																																																																																																																	
Remove Cap	1999	Land Value 8,250	8,250	11%	908	Assessed	5,964	477.48																																																																																																																	
Year Frozen	0	Improvements 137,733	45,961		5,056	Penalty	0																																																																																																																		
Uncapped Value	0	Mobile Home 0	0		0	Exemption	0	0.00																																																																																																																	
TIF Project ID	0	Total Value 145,983	54,211		5,964	Total Taxable	5,964	477.00																																																																																																																	
Assessment History <table border="1"> <thead> <tr> <th>Tax Year</th> <th>Statement Number</th> <th>Billed Owner</th> <th>Tax Area</th> <th>Total Value</th> <th>Exemptions</th> <th>Taxable Value</th> <th>Billed Tax</th> </tr> </thead> <tbody> <tr><td>2025</td><td>2025-660002738</td><td>WILLIAMS, GREGORY A</td><td>19</td><td>152,079</td><td>0</td><td>5,680</td><td>455.00</td></tr> <tr><td>2024</td><td>2024-660002738</td><td>WILLIAMS, GREGORY A</td><td>19</td><td>93,859</td><td>0</td><td>5,409</td><td>435.00</td></tr> <tr><td>2023</td><td>2023-660002738</td><td>WILLIAMS, GREGORY A</td><td>19</td><td>113,233</td><td>0</td><td>5,152</td><td>415.00</td></tr> <tr><td>2022</td><td>2022-660002738</td><td>WILLIAMS, JEFFREY M &</td><td>19</td><td>151,073</td><td>0</td><td>4,907</td><td>398.00</td></tr> <tr><td>2021</td><td>2021-660002738</td><td>WILLIAMS, JEFFREY M &</td><td>19</td><td>42,478</td><td>0</td><td>4,673</td><td>374.00</td></tr> <tr><td>2020</td><td>2020-660002738</td><td>WILLIAMS, JEFFREY M &</td><td>19</td><td>42,478</td><td>0</td><td>4,673</td><td>377.00</td></tr> <tr><td>2019</td><td>2019-660002738</td><td>WILLIAMS, JEFFREY M &</td><td>19</td><td>42,478</td><td>0</td><td>4,673</td><td>386.00</td></tr> <tr><td>2018</td><td>2018-660002738</td><td>WILLIAMS, JEFFREY M &</td><td>19</td><td>44,435</td><td>0</td><td>4,888</td><td>408.00</td></tr> <tr><td>2017</td><td>2017-660002738</td><td>WILLIAMS, JEFFREY M &</td><td>19</td><td>44,435</td><td>0</td><td>4,888</td><td>411.00</td></tr> <tr><td>2016</td><td>2016-660002738</td><td>WILLIAMS, JEFFREY M &</td><td>19</td><td>44,435</td><td>0</td><td>4,888</td><td>416.00</td></tr> <tr><td>2015</td><td>2015-660002738</td><td>WILLIAMS, JEFFREY M &</td><td>19</td><td>66,338</td><td>0</td><td>5,077</td><td>441.00</td></tr> <tr><td>2014</td><td>2014-660002738</td><td>WILLIAMS, JEFFREY M &</td><td>19</td><td>66,338</td><td>0</td><td>4,836</td><td>434.00</td></tr> <tr><td>2013</td><td>2013-660002738</td><td>WILLIAMS, JEFFREY M &</td><td>19</td><td>41,868</td><td>0</td><td>4,605</td><td>388.00</td></tr> </tbody> </table>										Tax Year	Statement Number	Billed Owner	Tax Area	Total Value	Exemptions	Taxable Value	Billed Tax	2025	2025-660002738	WILLIAMS, GREGORY A	19	152,079	0	5,680	455.00	2024	2024-660002738	WILLIAMS, GREGORY A	19	93,859	0	5,409	435.00	2023	2023-660002738	WILLIAMS, GREGORY A	19	113,233	0	5,152	415.00	2022	2022-660002738	WILLIAMS, JEFFREY M &	19	151,073	0	4,907	398.00	2021	2021-660002738	WILLIAMS, JEFFREY M &	19	42,478	0	4,673	374.00	2020	2020-660002738	WILLIAMS, JEFFREY M &	19	42,478	0	4,673	377.00	2019	2019-660002738	WILLIAMS, JEFFREY M &	19	42,478	0	4,673	386.00	2018	2018-660002738	WILLIAMS, JEFFREY M &	19	44,435	0	4,888	408.00	2017	2017-660002738	WILLIAMS, JEFFREY M &	19	44,435	0	4,888	411.00	2016	2016-660002738	WILLIAMS, JEFFREY M &	19	44,435	0	4,888	416.00	2015	2015-660002738	WILLIAMS, JEFFREY M &	19	66,338	0	5,077	441.00	2014	2014-660002738	WILLIAMS, JEFFREY M &	19	66,338	0	4,836	434.00	2013	2013-660002738	WILLIAMS, JEFFREY M &	19	41,868	0	4,605	388.00
Tax Year	Statement Number	Billed Owner	Tax Area	Total Value	Exemptions	Taxable Value	Billed Tax																																																																																																																		
2025	2025-660002738	WILLIAMS, GREGORY A	19	152,079	0	5,680	455.00																																																																																																																		
2024	2024-660002738	WILLIAMS, GREGORY A	19	93,859	0	5,409	435.00																																																																																																																		
2023	2023-660002738	WILLIAMS, GREGORY A	19	113,233	0	5,152	415.00																																																																																																																		
2022	2022-660002738	WILLIAMS, JEFFREY M &	19	151,073	0	4,907	398.00																																																																																																																		
2021	2021-660002738	WILLIAMS, JEFFREY M &	19	42,478	0	4,673	374.00																																																																																																																		
2020	2020-660002738	WILLIAMS, JEFFREY M &	19	42,478	0	4,673	377.00																																																																																																																		
2019	2019-660002738	WILLIAMS, JEFFREY M &	19	42,478	0	4,673	386.00																																																																																																																		
2018	2018-660002738	WILLIAMS, JEFFREY M &	19	44,435	0	4,888	408.00																																																																																																																		
2017	2017-660002738	WILLIAMS, JEFFREY M &	19	44,435	0	4,888	411.00																																																																																																																		
2016	2016-660002738	WILLIAMS, JEFFREY M &	19	44,435	0	4,888	416.00																																																																																																																		
2015	2015-660002738	WILLIAMS, JEFFREY M &	19	66,338	0	5,077	441.00																																																																																																																		
2014	2014-660002738	WILLIAMS, JEFFREY M &	19	66,338	0	4,836	434.00																																																																																																																		
2013	2013-660002738	WILLIAMS, JEFFREY M &	19	41,868	0	4,605	388.00																																																																																																																		



Rogers

Assessment Property Record Card for Tax Year 2026

Data provided by LISA DELOZIER County Assessor

Date 04/17/2026
 Time 18:16:55
 Page 2

Lot Data		Primary Image		
Lot Size	0 x 0			
Lot Count	0			
Units Buildable				
Non-Ag Acres	0.13			
Topography				
Street Access				
Utilities				
Amenities	0			
	0			
Value Model	1835 COMM			
Value Method	Square-Foot			
Base Lot Value	5,500.00 x 1.25 =			6,875
Factor Value	0			
Adjustments	120%			
Lot Value	8,250			
Cost Approach		Image Information		
Manual Date	01/2025	Image ID	1116978	
Total Building Area	2,760	Image Date	11/13/2025	
Total Base Value	503,619	Name	001.JPG	
Modifier Value		Description	660002738_001.JPG	
Misc Improvements	2,219			
Replacement Cost New	505,838			
Phys/Func Depreciation Loss	()			
RCN Less Phys/Func	137,733			
Economic Depreciation				
RCNLD (All Sources)	137,733			
Depreciated Improvements				
Outbuilding Value				
Total Improvement Value	137,733			
Land Value	8,250			
Cost Approach Value	145,983	52.89/SqFt		
Income Approach		Value Reconciliation		
Potential Gross Income (PGI)		Selected Valuation Method	Cost Approach	
Vacancy & Collection Loss		Total Improvement Value		
Miscellaneous Income		Land Value	8,250	
Effective Gross Income (EGI)		Total Appraised Value	145,983 52.89/SqFt	
Total Expenses				
Net Operating Income (NOI)				
Income Capitalization Rate				
Indicated Value	0.00			



Rogers

Assessment Property Record Card for Tax Year 2026

Data provided by LISA DELOZIER County Assessor

Date 04/17/2026

Time 18:16:55

Page 3

Sketch Image

660002738

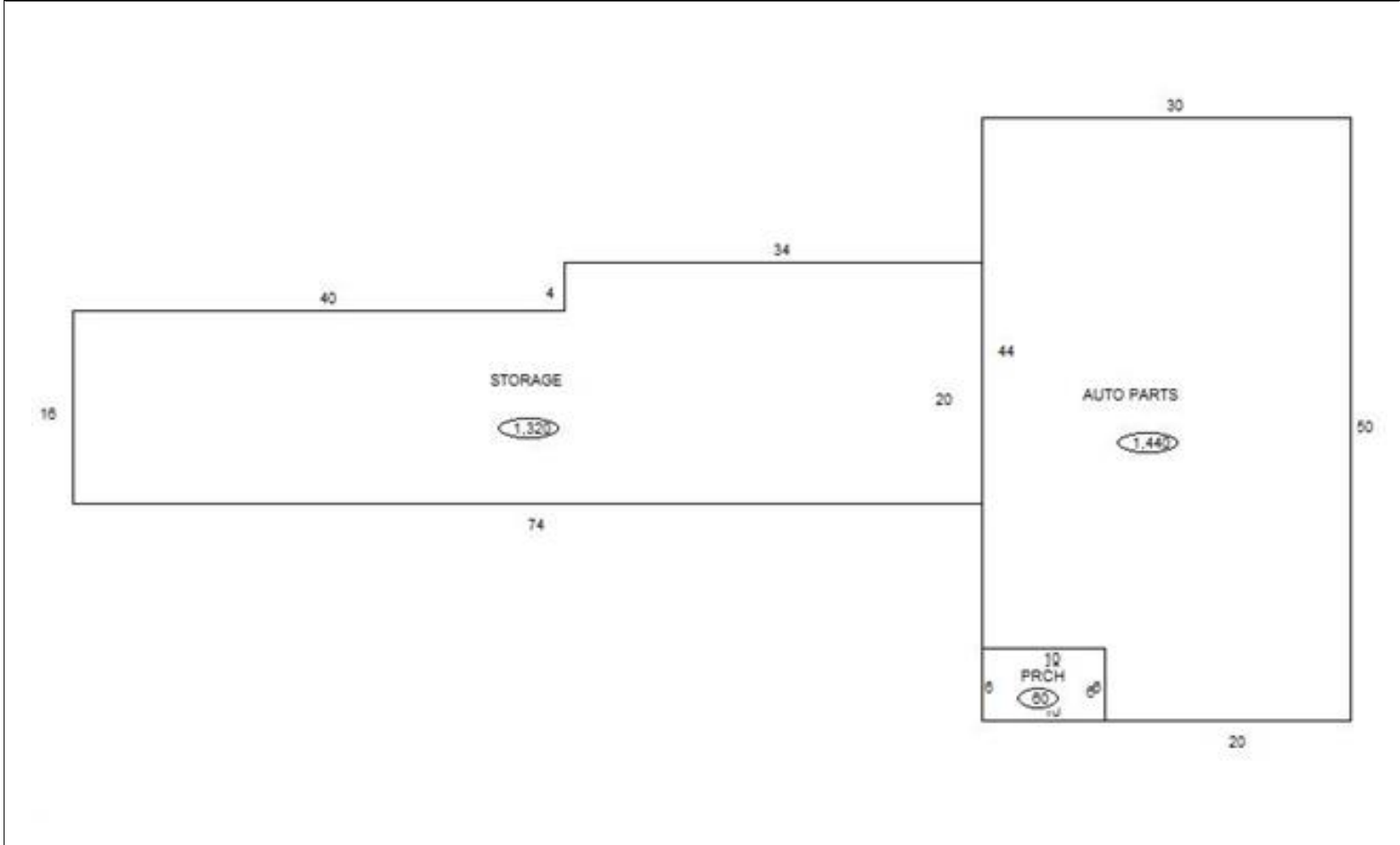

Sketch Vector Information

Sequence	Code	Type	Built Over	Scale	Section Label	Base Area	Multiplier	Total Area
1	C	353		13	AUTO PARTS	1,440	1.000	1,440
2	C	406		13	STORAGE	1,320	1.000	1,320
3	M	PRCH		13	PRCH	60	1.000	60
Total Building Area						2,760		2,760



Rogers

Assessment Property Record Card for Tax Year 2026

Data provided by LISA DELOZIER County Assessor

Date 04/17/2026
 Time 18:16:55
 Page 4

Account 660002738
 Parcel ID 000000-00-0-50010-014-0012
 Cadastral ID 04-19-17-02970

Tax Area Code 19
 Property Class UCP
 Owners Name WILLIAMS, GREGORY A

Building Data

Building ID 928
 Building Sequence 1
 Occupancy 1 353 Retail Store 100%
 Occupancy 2
 Occupancy 3
 Total Floor Area 1,440
 Average Perimeter 160
 Number Of Storys 1.00
 Average Wall Ht 8.00
 Year Built 1975
 Effective Age 33
 Construction Class 3 - Unreinforced Masonry Walls, Wood Joists
 Quality 2 - Fair
 Condition 2 - Fair
 Exterior Wall 10 - Cavity Brick
 Heating/Cooling 15 - No HVAC
 Roof Type Flat
 Roof Cover

Basement Area
 Basement Levels
 Basement Finish
 Finish Code - 1
 Finish Area - 1
 Finish Code - 2
 Finish Area - 2

Building Image



Image Information

Image Name COMREVAL 2013 3-21-2013 017.JPG
 Image Date 3/21/2013
 Image Name COMREVAL 2013 3-21-2013 017.JPG
 Description \\tsclient\C\Users\TD\Pictures\2013-03-21 COMREVAL 2013 3-21-2013\COMREVAL 2013 3-21-2013 017.JPG

Cost Calculations

Appraisal Zone 3
 Zone Description
 Base Cost 58.01
 Wall Cost 109.73
 HVAC Cost 0.00
 Basement Cost 0.00
 Total Base Cost 167.74
 Total Area 1,440
 Base RCN 241,546
 Misc Impr Value 2,219

Manual Date 01/2025
 Base Year 2026
 Modifier Value
 Total Replacement Cost 243,765
 Physical Depreciation 65%
 Functional Depreciation
 Total Depreciation 65% (158,447)
 Total RCNLD 85,318
 Lump Sums
 Total Building Value 85,318 \$ 59.25 Per SqFt

Miscellaneous Improvements

Code	Description	Year	Size	Units	Unit Cost	Depr	Value
PRCH	Porch		10x6	60	36.98		2,219
Total Misc Improvement							2,219



Rogers

Assessment Property Record Card for Tax Year 2026

Data provided by LISA DELOZIER County Assessor

Date 04/17/2026
Time 18:16:56
Page 5

Account 660002738
Parcel ID 000000-00-0-50010-014-0012
Cadastral ID 04-19-17-02970

Tax Area Code 19
Property Class UCP
Owners Name WILLIAMS, GREGORY A

Building Data

Building ID 929
Building Sequence 2
Occupancy 1 406 Storage Warehouse 100%
Occupancy 2
Occupancy 3
Total Floor Area 1,320
Average Perimeter 188
Number Of Storys 1.00
Average Wall Ht 9.00
Year Built 1954
Effective Age 47
Construction Class 3 - Unreinforced Masonry Walls, Wood Joists
Quality 2 - Fair
Condition 2 - Fair
Exterior Wall 10 - Cavity Brick
Heating/Cooling 15 - No HVAC
Roof Type Flat
Roof Cover Built/Up Tar

Basement Area
Basement Levels
Basement Finish
Finish Code - 1
Finish Area - 1
Finish Code - 2
Finish Area - 2

Building Image



Image Information

Image Name COMREVAL 2013 3-21-2013 019.JPG
Image Date 3/21/2013
Image Name COMREVAL 2013 3-21-2013 019.JPG
Description \\tsclient\C\Users\TD\Pictures\2013-03-21 COMREVAL 2013 3-21-2013\COMREVAL 2013 3-21-2013 019.JPG

Cost Calculations

Appraisal Zone 3
Zone Description
Base Cost 45.20
Wall Cost 153.34
HVAC Cost 0.00
Basement Cost 0.00
Total Base Cost 198.54
Total Area 1,320
Base RCN 262,073
Misc Impr Value

Manual Date 01/2025
Base Year 2026
Modifier Value
Total Replacement Cost 262,073
Physical Depreciation 80%
Functional Depreciation
Total Depreciation 80% (209,658)
Total RCNLD 52,415
Lump Sums
Total Building Value 52,415 \$ 39.71 Per SqFt