



Rogers

Assessment Property Record Card for Tax Year 2026

Data provided by LISA DELOZIER County Assessor

Date 04/17/2026
 Time 18:17:12
 Page 1

Assessment Data					Primary Image														
Account 660002751 Parcel ID 000000-00-0-50010-015-0014 Cadastral ID 04-19-17-03070 Property Type REAL - Real Property Property Class UCP VI Area 3 Tax Area 19 - INOLA OT Name ID 118074 BANK OF INOLA C/O RCB BANK - T BAYLESS PO BOX 189 CLAREMORE OK 74018-0189 Parcel Location Situs 00011 W COMMERCIAL ST Subdivision INOLA O T Lot/Block 0014 / 0015 Parcel Size 5 - Lots Sec/Twn/Rng 4 / 19 / 17 / 5 Neighborhood 5001 - TASC 2016 School District S005 - INOLA SCHOOLS					<p>660002751_001.JPG 11/13/2025</p>														
Legal Description Lat/Long: 36.15126805 -95.51025213																			
LOTS 10 - 14 BLOCK 15 INOLA O T					Building Permits <table border="1"> <thead> <tr> <th>Number</th> <th>Description</th> <th>Opened</th> <th>Closed</th> <th>Amount</th> </tr> </thead> <tbody> <tr> <td> </td> <td> </td> <td> </td> <td> </td> <td> </td> </tr> </tbody> </table>					Number	Description	Opened	Closed	Amount					
Number	Description	Opened	Closed	Amount															
Exemptions					Sale History														
Code	Type	Active	Maximum	Exemption	Bk/Pg	Grantor	Date	Price	Code										
Parcel Valuation																			
Source	REAL		Fair Cash	Capped	Asmnt Level	Assessed	Levy Rate	80.060	Current Tax										
Remove Cap	0	Land Value	21,875	21,875	11%	2,406	Assessed	25,693	2,056.98										
Year Frozen	0	Improvements	656,738	211,704		23,287	Penalty	0											
Uncapped Value	0	Mobile Home	0	0		0	Exemption	0	0.00										
TIF Project ID	0	Total Value	678,613	233,579		25,693	Total Taxable	25,693	2,057.00										
Assessment History																			
Tax Year	Statement Number	Billed Owner	Tax Area	Total Value	Exemptions	Taxable Value	Billed Tax												
2025	2025-660002751	BANK OF INOLA	19	509,422	0	24,471	1,959.00												
2024	2024-660002751	BANK OF INOLA	19	211,864	0	23,305	1,874.00												
2023	2023-660002751	BANK OF INOLA	19	460,539	0	50,659	4,080.00												
2022	2022-660002751	BANK OF INOLA	19	479,775	0	50,756	4,117.00												
2021	2021-660002751	BANK OF INOLA	19	464,758	0	48,339	3,873.00												
2020	2020-660002751	BANK OF INOLA	19	464,758	0	46,038	3,719.00												
2019	2019-660002751	BANK OF INOLA	19	464,758	0	43,845	3,622.00												
2018	2018-660002751	BANK OF INOLA	19	447,470	0	41,758	3,486.00												
2017	2017-660002751	BANK OF INOLA	19	447,470	0	39,769	3,346.00												
2016	2016-660002751	BANK OF INOLA	19	447,470	0	37,875	3,222.00												
2015	2015-660002751	BANK OF INOLA	19	374,804	0	36,072	3,130.00												
2014	2014-660002751	BANK OF INOLA	19	374,804	0	34,354	3,085.00												
2013	2013-660002751	BANK OF INOLA	19	297,441	0	32,719	2,756.00												



Rogers

Assessment Property Record Card for Tax Year 2026

Data provided by LISA DELOZIER County Assessor

Date 04/17/2026

Time 18:17:12

Page 3

Sketch Image

660002751

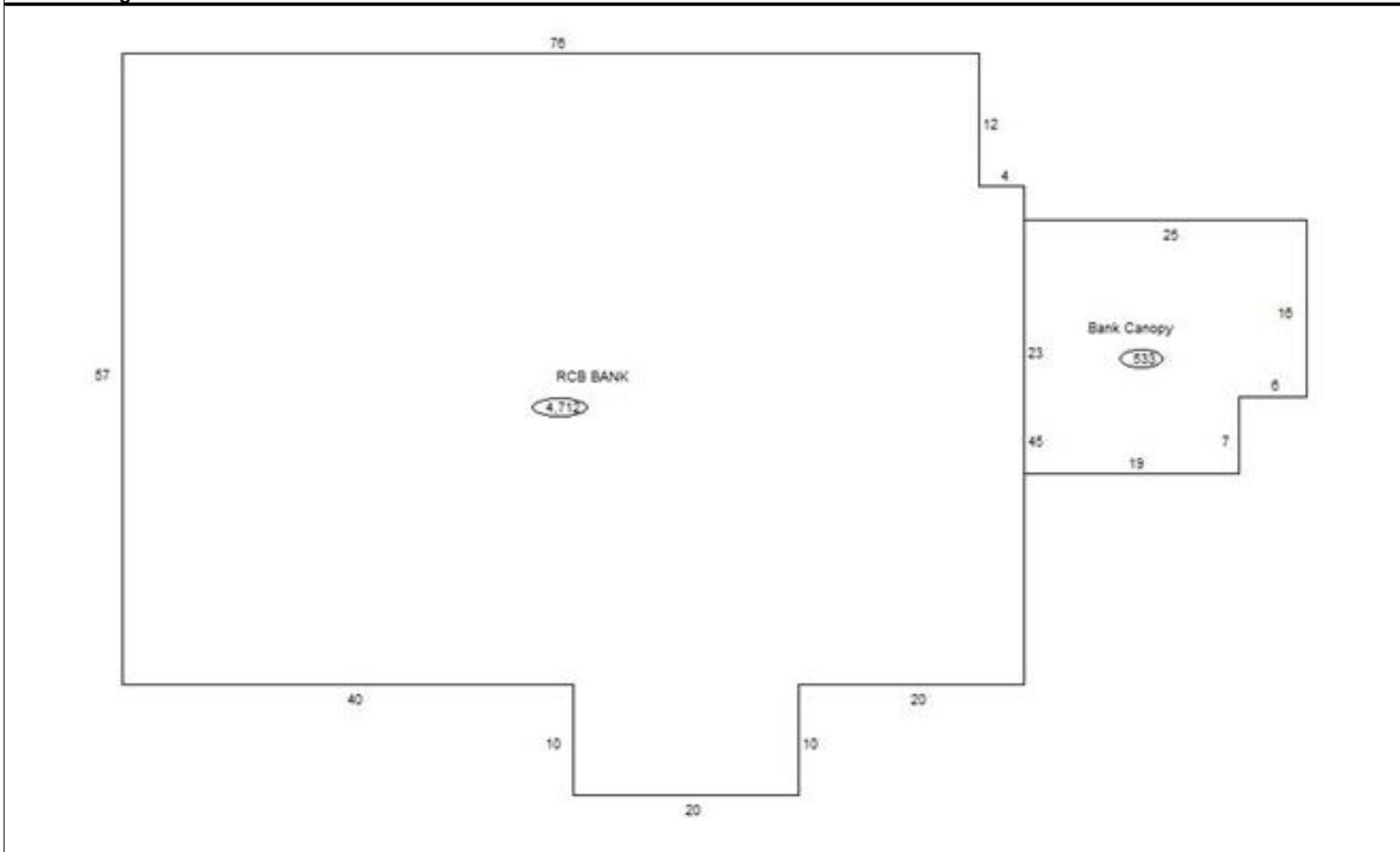

Sketch Vector Information

Sequence	Code	Type	Built Over	Scale	Section Label	Base Area	Multiplier	Total Area
1	C	304		13	RCB BANK	4,712	1.000	4,712
2	M	BKC		13	Bank Canopy	533	1.000	533
Total Building Area						4,712		4,712



Rogers

Assessment Property Record Card for Tax Year 2026

Data provided by LISA DELOZIER County Assessor

Date 04/17/2026
 Time 18:17:12
 Page 4

Account 660002751
 Parcel ID 000000-00-0-50010-015-0014
 Cadastral ID 04-19-17-03070

Tax Area Code 19
 Property Class UCP
 Owners Name BANK OF INOLA

Building Data

Building ID 933
 Building Sequence 1
 Occupancy 1 304 Bank 100%
 Occupancy 2
 Occupancy 3
 Total Floor Area 4,712
 Average Perimeter 294
 Number Of Storys 1.00
 Average Wall Ht 10.00
 Year Built 1985
 Effective Age 21
 Construction Class 2 - Heavier Wood or Steel Stud Frame
 Quality 3 - Average
 Condition 3 - Average
 Exterior Wall 82 - Stud Brick Veneer
 Heating/Cooling 8 - Warmed and Cooled Air
 Roof Type Hip
 Roof Cover Metal

Basement Area
 Basement Levels
 Basement Finish
 Finish Code - 1
 Finish Area - 1
 Finish Code - 2
 Finish Area - 2

Building Image



Image Information

Image Name COMREVAL 2013 3-22-13 090.JPG
 Image Date 3/22/2013
 Image Name COMREVAL 2013 3-22-13 090.JPG
 Description \\tsclient\C\Users\TD\Pictures\2013-03-22 COMREVAL 2013 3-22-13\COMREVAL 2013 3-22-13 090.JPG

Cost Calculations

Appraisal Zone 3
 Zone Description
 Base Cost 134.96
 Wall Cost 32.55
 HVAC Cost 13.70
 Basement Cost 0.00
 Total Base Cost 181.21
 Total Area 4,712
 Base RCN 853,862
 Misc Impr Value 21,789

Manual Date 01/2025
 Base Year 2026
 Modifier Value
 Total Replacement Cost 875,651
 Physical Depreciation 25%
 Functional Depreciation
 Total Depreciation 25% (218,913)
 Total RCNLD 656,738
 Lump Sums
 Total Building Value 656,738 \$ 139.38 Per SqFt

Miscellaneous Improvements

Code	Description	Year	Size	Units	Unit Cost	Depr	Value
BKC	Bank Canopy, Drv In		533	533	40.88		21,789
Total Misc Improvement							21,789