



Rogers

Assessment Property Record Card for Tax Year 2026

Data provided by LISA DELOZIER County Assessor

Date 04/17/2026
 Time 03:21:26
 Page 1

Assessment Data					Primary Image																																																																																																																				
Account 660002759 Parcel ID 000000-00-0-50010-016-0009 Cadastral ID 04-19-17-03160 Property Type REAL - Real Property Property Class URP VI Area 3 Tax Area 19 - INOLA OT Name ID 281360 WARD, KEITH JESSIE 15 B ST NW INOLA OK 74036-0000 Parcel Location Situs 00107 E COMMERCIAL Subdivision INOLA O T Lot/Block 0009 / 0016 Parcel Size 3 - Lots Sec/Twn/Rng 4 / 19 / 17 / 5 Neighborhood 1205 - R-V03-SE INOLA School District S005 - INOLA SCHOOLS					<p>660002759 11/11/25</p> <p>660002759_001.JPG 11/13/2025</p>																																																																																																																				
Legal Description Lat/Long: 36.15078716 -95.51123825 LOTS 6- 7 & 8 & ELY 16' OF LOT 9 BLOCK 16 INOLA O T																																																																																																																									
Exemptions <table border="1"> <thead> <tr> <th>Code</th> <th>Type</th> <th>Active</th> <th>Maximum</th> <th>Exemption</th> </tr> </thead> <tbody> <tr> <td>H</td> <td>Homestead</td> <td>No</td> <td>1,000</td> <td></td> </tr> <tr> <td>PD</td> <td>Add-Homestead</td> <td>No</td> <td>1,000</td> <td></td> </tr> </tbody> </table>					Code	Type	Active	Maximum	Exemption	H	Homestead	No	1,000		PD	Add-Homestead	No	1,000		Building Permits <table border="1"> <thead> <tr> <th>Number</th> <th>Description</th> <th>Opened</th> <th>Closed</th> <th>Amount</th> </tr> </thead> <tbody> <tr> <td></td> <td></td> <td></td> <td></td> <td></td> </tr> </tbody> </table>					Number	Description	Opened	Closed	Amount																																																																																												
Code	Type	Active	Maximum	Exemption																																																																																																																					
H	Homestead	No	1,000																																																																																																																						
PD	Add-Homestead	No	1,000																																																																																																																						
Number	Description	Opened	Closed	Amount																																																																																																																					
Parcel Valuation <table border="1"> <thead> <tr> <th>Source</th> <th>REAL</th> <th>Fair Cash</th> <th>Capped</th> <th>Asmnt Level</th> <th>Assessed</th> <th>Levy Rate</th> <th>80.060</th> <th>Current Tax</th> </tr> </thead> <tbody> <tr> <td>Remove Cap</td> <td>2015</td> <td>Land Value 29,941</td> <td>20,261</td> <td>11%</td> <td>2,229</td> <td>Assessed</td> <td>8,484</td> <td>679.23</td> </tr> <tr> <td>Year Frozen</td> <td>2005</td> <td>Improvements 62,926</td> <td>56,860</td> <td></td> <td>6,255</td> <td>Penalty</td> <td>0</td> <td></td> </tr> <tr> <td>Uncapped Value</td> <td>0</td> <td>Mobile Home 0</td> <td>0</td> <td></td> <td>0</td> <td>Exemption</td> <td>0</td> <td>0.00</td> </tr> <tr> <td>TIF Project ID</td> <td>0</td> <td>Total Value 92,867</td> <td>77,121</td> <td></td> <td>8,484</td> <td>Total Taxable</td> <td>8,484</td> <td>679.00</td> </tr> </tbody> </table>					Source	REAL	Fair Cash	Capped	Asmnt Level	Assessed	Levy Rate	80.060	Current Tax	Remove Cap	2015	Land Value 29,941	20,261	11%	2,229	Assessed	8,484	679.23	Year Frozen	2005	Improvements 62,926	56,860		6,255	Penalty	0		Uncapped Value	0	Mobile Home 0	0		0	Exemption	0	0.00	TIF Project ID	0	Total Value 92,867	77,121		8,484	Total Taxable	8,484	679.00	Sale History <table border="1"> <thead> <tr> <th>Bk/Pg</th> <th>Grantor</th> <th>Date</th> <th>Price</th> <th>Code</th> </tr> </thead> <tbody> <tr> <td>2415/197</td> <td>CRANE, MARY M</td> <td>07/25/2014</td> <td>65,000</td> <td>YES</td> </tr> <tr> <td>931/747</td> <td>CRANE, CALVIN M &</td> <td>10/08/1993</td> <td>0</td> <td>No</td> </tr> </tbody> </table>					Bk/Pg	Grantor	Date	Price	Code	2415/197	CRANE, MARY M	07/25/2014	65,000	YES	931/747	CRANE, CALVIN M &	10/08/1993	0	No																																																				
Source	REAL	Fair Cash	Capped	Asmnt Level	Assessed	Levy Rate	80.060	Current Tax																																																																																																																	
Remove Cap	2015	Land Value 29,941	20,261	11%	2,229	Assessed	8,484	679.23																																																																																																																	
Year Frozen	2005	Improvements 62,926	56,860		6,255	Penalty	0																																																																																																																		
Uncapped Value	0	Mobile Home 0	0		0	Exemption	0	0.00																																																																																																																	
TIF Project ID	0	Total Value 92,867	77,121		8,484	Total Taxable	8,484	679.00																																																																																																																	
Bk/Pg	Grantor	Date	Price	Code																																																																																																																					
2415/197	CRANE, MARY M	07/25/2014	65,000	YES																																																																																																																					
931/747	CRANE, CALVIN M &	10/08/1993	0	No																																																																																																																					
Assessment History <table border="1"> <thead> <tr> <th>Tax Year</th> <th>Statement Number</th> <th>Billed Owner</th> <th>Tax Area</th> <th>Total Value</th> <th>Exemptions</th> <th>Taxable Value</th> <th>Billed Tax</th> </tr> </thead> <tbody> <tr><td>2025</td><td>2025-660002759</td><td>WARD, KEITH JESSIE</td><td>19</td><td>84,094</td><td>0</td><td>8,079</td><td>647.00</td></tr> <tr><td>2024</td><td>2024-660002759</td><td>WARD, KEITH JESSIE</td><td>19</td><td>85,000</td><td>0</td><td>7,694</td><td>619.00</td></tr> <tr><td>2023</td><td>2023-660002759</td><td>WARD, KEITH JESSIE</td><td>19</td><td>66,621</td><td>0</td><td>7,328</td><td>590.00</td></tr> <tr><td>2022</td><td>2022-660002759</td><td>WARD, KEITH JESSIE</td><td>19</td><td>66,621</td><td>0</td><td>7,328</td><td>594.00</td></tr> <tr><td>2021</td><td>2021-660002759</td><td>WARD, KEITH JESSIE</td><td>19</td><td>66,169</td><td>0</td><td>7,278</td><td>583.00</td></tr> <tr><td>2020</td><td>2020-660002759</td><td>WARD, KEITH JESSIE</td><td>19</td><td>67,791</td><td>0</td><td>7,449</td><td>602.00</td></tr> <tr><td>2019</td><td>2019-660002759</td><td>WARD, KEITH JESSIE</td><td>19</td><td>64,499</td><td>0</td><td>7,094</td><td>586.00</td></tr> <tr><td>2018</td><td>2018-660002759</td><td>WARD, KEITH JESSIE</td><td>19</td><td>70,292</td><td>0</td><td>7,732</td><td>645.00</td></tr> <tr><td>2017</td><td>2017-660002759</td><td>WARD, KEITH JESSIE</td><td>19</td><td>69,661</td><td>0</td><td>7,662</td><td>645.00</td></tr> <tr><td>2016</td><td>2016-660002759</td><td>WARD, KEITH JESSIE</td><td>19</td><td>67,841</td><td>0</td><td>7,462</td><td>635.00</td></tr> <tr><td>2015</td><td>2015-660002759</td><td>WARD, KEITH JESSIE</td><td>19</td><td>65,720</td><td>0</td><td>7,229</td><td>627.00</td></tr> <tr><td>2014</td><td>2014-660002759</td><td>WARD, KEITH JESSIE</td><td>19</td><td>67,572</td><td>2000</td><td>2,541</td><td>228.00</td></tr> <tr><td>2013</td><td>2013-660002759</td><td>CRANE, MARY M</td><td>19</td><td>68,439</td><td>2000</td><td>2,541</td><td>214.00</td></tr> </tbody> </table>										Tax Year	Statement Number	Billed Owner	Tax Area	Total Value	Exemptions	Taxable Value	Billed Tax	2025	2025-660002759	WARD, KEITH JESSIE	19	84,094	0	8,079	647.00	2024	2024-660002759	WARD, KEITH JESSIE	19	85,000	0	7,694	619.00	2023	2023-660002759	WARD, KEITH JESSIE	19	66,621	0	7,328	590.00	2022	2022-660002759	WARD, KEITH JESSIE	19	66,621	0	7,328	594.00	2021	2021-660002759	WARD, KEITH JESSIE	19	66,169	0	7,278	583.00	2020	2020-660002759	WARD, KEITH JESSIE	19	67,791	0	7,449	602.00	2019	2019-660002759	WARD, KEITH JESSIE	19	64,499	0	7,094	586.00	2018	2018-660002759	WARD, KEITH JESSIE	19	70,292	0	7,732	645.00	2017	2017-660002759	WARD, KEITH JESSIE	19	69,661	0	7,662	645.00	2016	2016-660002759	WARD, KEITH JESSIE	19	67,841	0	7,462	635.00	2015	2015-660002759	WARD, KEITH JESSIE	19	65,720	0	7,229	627.00	2014	2014-660002759	WARD, KEITH JESSIE	19	67,572	2000	2,541	228.00	2013	2013-660002759	CRANE, MARY M	19	68,439	2000	2,541	214.00
Tax Year	Statement Number	Billed Owner	Tax Area	Total Value	Exemptions	Taxable Value	Billed Tax																																																																																																																		
2025	2025-660002759	WARD, KEITH JESSIE	19	84,094	0	8,079	647.00																																																																																																																		
2024	2024-660002759	WARD, KEITH JESSIE	19	85,000	0	7,694	619.00																																																																																																																		
2023	2023-660002759	WARD, KEITH JESSIE	19	66,621	0	7,328	590.00																																																																																																																		
2022	2022-660002759	WARD, KEITH JESSIE	19	66,621	0	7,328	594.00																																																																																																																		
2021	2021-660002759	WARD, KEITH JESSIE	19	66,169	0	7,278	583.00																																																																																																																		
2020	2020-660002759	WARD, KEITH JESSIE	19	67,791	0	7,449	602.00																																																																																																																		
2019	2019-660002759	WARD, KEITH JESSIE	19	64,499	0	7,094	586.00																																																																																																																		
2018	2018-660002759	WARD, KEITH JESSIE	19	70,292	0	7,732	645.00																																																																																																																		
2017	2017-660002759	WARD, KEITH JESSIE	19	69,661	0	7,662	645.00																																																																																																																		
2016	2016-660002759	WARD, KEITH JESSIE	19	67,841	0	7,462	635.00																																																																																																																		
2015	2015-660002759	WARD, KEITH JESSIE	19	65,720	0	7,229	627.00																																																																																																																		
2014	2014-660002759	WARD, KEITH JESSIE	19	67,572	2000	2,541	228.00																																																																																																																		
2013	2013-660002759	CRANE, MARY M	19	68,439	2000	2,541	214.00																																																																																																																		



Rogers

Assessment Property Record Card for Tax Year 2026

Data provided by LISA DELOZIER County Assessor

Date 04/17/2026
Time 03:21:26
Page 2

Lot Data	Square-Foot - NBHD 1205 #1	Primary Image
Lot Size Lot Count Units Buildable 12740 Non-Ag Acres 0.2925 Topography Street Access Utilities Amenities LAND QUALITY 0 0 Method Square-Foot Base Lot Value 12,741.00 x 2.35 = 29,941 Factor Value Adjustments 1.0000 Lot Value 29,941		

Residential Data	
Type	1 Single Family Residence
Condition	2.5 - Fair
Quality	2.5 - Fair
Architecture	TRAD TRADITIONAL
Style	100% One Story
Exterior Wall	100% Frame, Stucco
Base/Total Area	1,960 / 1,960
Style	100% One Story
HVAC	
Roof Cover	1 Composition Shingle
Area on Slab	0
Fixture/RghIn	13 /
Bed/F/H Bath	3 / 2.0 /
Basement Area	
Garage Type	
Remodel	
Year/Eff Age	1944 / 72

660002759	11/11/25
660002759_001.JPG	11/13/2025

GRM Approach	
GRM Code	
Gross Rent	0.00
Indicated Value	

Multiple Regression			
MRA Code	1	Test	
Adusted R	0.8445		
Indicated Value	126,239	64.41	Per SqFt

Direct Comparables	
Selection Model	A Adam Test
Adjustment Model	1 2022 Residential
Comparables	3
Indicated Value	84,970 Per SqFt

Value Reconciliation			
Selected Approach	Cost Approach		
Improvements	54,382		
Lot Value	29,941		
Indicated Value	84,323	43.02	Per SqFt
Agland Value			
Site Improvements	8,544		
Total Value	92,867	47.38	Total Value Per SqFt

Cost Approach				Manual : 01/2025			
Base Cost	87.99	Total Misc Impr	+ 10,358				
Roofing Adj	+ 3.98	Garage Cost	+ 0				
Subfloor Adj	+ 1.04	Total RCN	= 209,161				
Heat/Cool Adj	+ 0.00	Depreciation (74%)	- 154,779				
Plumbing Adj	+ 8.42	Lump Sums	+ 0				
Basement Adj	+ 0.00	RCNLD	= 54,382				
Adj Base Cost	= 101.43	Lot Value	+ 29,941				
Total Area	x 1,960	Indicated Value	= 84,323				
Adjusted Cost	= 198,803	Value Per SqFt	43.02				

Miscellaneous Improvements								
Code	Description	Sketch ID	Size	Year	Units	Unit Cost	Depr	Value
FPR1	FIREPLACE - RESIDENTIAL 1 STORY	0		1	1	5,095.98		5,096
PRCH	SLAB PORCH - COVERED	7032	28x8		224	23.49		5,262



Rogers

Assessment Property Record Card for Tax Year 2026

Data provided by LISA DELOZIER County Assessor

Date 04/17/2026

Time 03:21:26

Page 3

Sketch Image

660002759

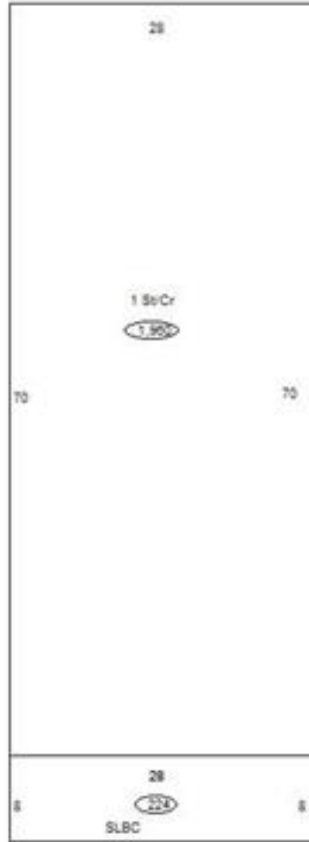

Sketch Vector Information

Sequence	Code	Type	Built Over	Scale	Section Label	Base Area	Multiplier	Total Area
1	R	1	Crawl	13	1 St/Cr	1,960	1.000	1,960
2	M	PRCH		13	SLBC	224	1.000	224
Total Building Area						1,960		1,960



Rogers

Assessment Property Record Card for Tax Year 2026

Data provided by LISA DELOZIER County Assessor

Date 04/17/2026
Time 03:21:26
Page 4

660002759

Outbuildings/Site Improvements

Building Image	Code	Description	Dimensions	Floor	Roofing	Total Units
	GRDT	Garage - Detached	27x24x8	Concrete	Composition Shingle	648
	Qual 2	Cond 3	Year 2010	Eff Age 12		
Valuation Summary		Modifier Total	RCN	Depr (25% Phys/ % Func)	RCNLD	
Base Cost (17.58 x 648)		11,392	11,392	2,848	8,544	