



# Rogers

## Assessment Property Record Card for Tax Year 2026

Data provided by LISA DELOZIER County Assessor

Date 04/17/2026  
Time 03:21:50  
Page 1

Assessment Data					Primary Image																																																																																																																				
<b>Account</b> 660002823 <b>Parcel ID</b> 000000-00-0-50010-024-0006 <b>Cadastral ID</b> 04-19-17-03770 <b>Property Type</b> REAL - Real Property <b>Property Class</b> URP VI Area 3 <b>Tax Area</b> 19 - INOLA OT <b>Name ID</b> 276682 LANDSAW, THOMAS M & JANICE TRUSTEES  416 E COMMERCIAL INOLA OK 74036-0000  <b>Parcel Location</b> <b>Situs</b> 00416 E COMMERCIAL <b>Subdivision</b> INOLA O T <b>Lot/Block</b> 0006 / 0024 <b>Parcel Size</b> 3 - Lots <b>Sec/Twn/Rng</b> 4 / 19 / 17 / 5 <b>Neighborhood</b> 1205 - R-V03-SE INOLA <b>School District</b> S005 - INOLA SCHOOLS																																																																																																																									
660002823_001.JPG 11/13/2025																																																																																																																									
<b>Legal Description</b> Lat/Long: 36.15392037 -95.50319794					<b>Building Permits</b> <table border="1"> <thead> <tr> <th>Number</th> <th>Description</th> <th>Opened</th> <th>Closed</th> <th>Amount</th> </tr> </thead> <tbody> <tr> <td colspan="5" style="height: 100px;"> </td> </tr> </tbody> </table>					Number	Description	Opened	Closed	Amount																																																																																																											
Number	Description	Opened	Closed	Amount																																																																																																																					
<b>Exemptions</b> <table border="1"> <thead> <tr> <th>Code</th> <th>Type</th> <th>Active</th> <th>Maximum</th> <th>Exemption</th> </tr> </thead> <tbody> <tr> <td>H</td> <td>Homestead</td> <td>Yes</td> <td>1,000</td> <td>1,000</td> </tr> </tbody> </table>					Code	Type	Active	Maximum	Exemption	H	Homestead	Yes	1,000	1,000	<b>Sale History</b> <table border="1"> <thead> <tr> <th>Bk/Pg</th> <th>Grantor</th> <th>Date</th> <th>Price</th> <th>Code</th> </tr> </thead> <tbody> <tr> <td>2652/63</td> <td>LANDSAW, THOMAS M &amp; JANICE</td> <td>08/03/2017</td> <td>0</td> <td>4</td> </tr> <tr> <td>1288/646</td> <td>EVANS, ROBERT L &amp; YNONNE M</td> <td>04/10/2001</td> <td>94,000</td> <td>YES</td> </tr> <tr> <td>1136/76</td> <td>BROWN, FRANCES DARLINE</td> <td>10/04/1998</td> <td>80,000</td> <td>Yes</td> </tr> <tr> <td>956/165</td> <td>SELLER</td> <td>06/23/1994</td> <td>0</td> <td>No</td> </tr> <tr> <td>834/347</td> <td></td> <td></td> <td>0</td> <td>No</td> </tr> </tbody> </table>					Bk/Pg	Grantor	Date	Price	Code	2652/63	LANDSAW, THOMAS M & JANICE	08/03/2017	0	4	1288/646	EVANS, ROBERT L & YNONNE M	04/10/2001	94,000	YES	1136/76	BROWN, FRANCES DARLINE	10/04/1998	80,000	Yes	956/165	SELLER	06/23/1994	0	No	834/347			0	No																																																																								
Code	Type	Active	Maximum	Exemption																																																																																																																					
H	Homestead	Yes	1,000	1,000																																																																																																																					
Bk/Pg	Grantor	Date	Price	Code																																																																																																																					
2652/63	LANDSAW, THOMAS M & JANICE	08/03/2017	0	4																																																																																																																					
1288/646	EVANS, ROBERT L & YNONNE M	04/10/2001	94,000	YES																																																																																																																					
1136/76	BROWN, FRANCES DARLINE	10/04/1998	80,000	Yes																																																																																																																					
956/165	SELLER	06/23/1994	0	No																																																																																																																					
834/347			0	No																																																																																																																					
<b>Parcel Valuation</b> <table border="1"> <thead> <tr> <th>Source</th> <th>REAL</th> <th>Fair Cash</th> <th>Capped</th> <th>Asmnt Level</th> <th>Assessed</th> <th>Levy Rate</th> <th>80.060</th> <th>Current Tax</th> </tr> </thead> <tbody> <tr> <td>Remove Cap</td> <td>2002</td> <td>Land Value 24,677</td> <td>11,503</td> <td>11%</td> <td>1,265</td> <td>Assessed</td> <td>13,130</td> <td>1,051.19</td> </tr> <tr> <td>Year Frozen</td> <td>0</td> <td>Improvements 134,566</td> <td>107,863</td> <td></td> <td>11,865</td> <td>Penalty</td> <td>0</td> <td></td> </tr> <tr> <td>Uncapped Value</td> <td>0</td> <td>Mobile Home 0</td> <td>0</td> <td></td> <td>0</td> <td>Exemption</td> <td>1,000</td> <td>-80.00</td> </tr> <tr> <td>TIF Project ID</td> <td>0</td> <td>Total Value 159,243</td> <td>119,366</td> <td></td> <td>13,130</td> <td>Total Taxable</td> <td>12,130</td> <td>971.00</td> </tr> </tbody> </table>										Source	REAL	Fair Cash	Capped	Asmnt Level	Assessed	Levy Rate	80.060	Current Tax	Remove Cap	2002	Land Value 24,677	11,503	11%	1,265	Assessed	13,130	1,051.19	Year Frozen	0	Improvements 134,566	107,863		11,865	Penalty	0		Uncapped Value	0	Mobile Home 0	0		0	Exemption	1,000	-80.00	TIF Project ID	0	Total Value 159,243	119,366		13,130	Total Taxable	12,130	971.00																																																																			
Source	REAL	Fair Cash	Capped	Asmnt Level	Assessed	Levy Rate	80.060	Current Tax																																																																																																																	
Remove Cap	2002	Land Value 24,677	11,503	11%	1,265	Assessed	13,130	1,051.19																																																																																																																	
Year Frozen	0	Improvements 134,566	107,863		11,865	Penalty	0																																																																																																																		
Uncapped Value	0	Mobile Home 0	0		0	Exemption	1,000	-80.00																																																																																																																	
TIF Project ID	0	Total Value 159,243	119,366		13,130	Total Taxable	12,130	971.00																																																																																																																	
<b>Assessment History</b> <table border="1"> <thead> <tr> <th>Tax Year</th> <th>Statement Number</th> <th>Billed Owner</th> <th>Tax Area</th> <th>Total Value</th> <th>Exemptions</th> <th>Taxable Value</th> <th>Billed Tax</th> </tr> </thead> <tbody> <tr><td>2025</td><td>2025-660002823</td><td>LANDSAW, THOMAS M &amp; JANICE</td><td>19</td><td>152,670</td><td>1000</td><td>11,747</td><td>940.00</td></tr> <tr><td>2024</td><td>2024-660002823</td><td>LANDSAW, THOMAS M &amp; JANICE</td><td>19</td><td>157,457</td><td>1000</td><td>11,377</td><td>915.00</td></tr> <tr><td>2023</td><td>2023-660002823</td><td>LANDSAW, THOMAS M &amp; JANICE</td><td>19</td><td>110,237</td><td>1000</td><td>11,016</td><td>887.00</td></tr> <tr><td>2022</td><td>2022-660002823</td><td>LANDSAW, THOMAS M &amp; JANICE</td><td>19</td><td>106,057</td><td>1000</td><td>10,666</td><td>865.00</td></tr> <tr><td>2021</td><td>2021-660002823</td><td>LANDSAW, THOMAS M &amp; JANICE</td><td>19</td><td>111,784</td><td>1000</td><td>11,296</td><td>905.00</td></tr> <tr><td>2020</td><td>2020-660002823</td><td>LANDSAW, THOMAS M &amp; JANICE</td><td>19</td><td>113,249</td><td>1000</td><td>11,156</td><td>901.00</td></tr> <tr><td>2019</td><td>2019-660002823</td><td>LANDSAW, THOMAS M &amp; JANICE</td><td>19</td><td>107,295</td><td>1000</td><td>10,802</td><td>892.00</td></tr> <tr><td>2018</td><td>2018-660002823</td><td>LANDSAW, THOMAS M &amp; JANICE</td><td>19</td><td>114,557</td><td>1000</td><td>11,601</td><td>968.00</td></tr> <tr><td>2017</td><td>2017-660002823</td><td>LANDSAW, THOMAS M &amp; JANICE</td><td>19</td><td>113,552</td><td>1000</td><td>11,490</td><td>967.00</td></tr> <tr><td>2016</td><td>2016-660002823</td><td>LANDSAW, THOMAS M &amp; JANICE</td><td>19</td><td>110,451</td><td>1000</td><td>11,149</td><td>949.00</td></tr> <tr><td>2015</td><td>2015-660002823</td><td>LANDSAW, THOMAS M &amp; JANICE</td><td>19</td><td>111,379</td><td>1000</td><td>11,251</td><td>976.00</td></tr> <tr><td>2014</td><td>2014-660002823</td><td>LANDSAW, THOMAS M &amp; JANICE</td><td>19</td><td>115,376</td><td>1000</td><td>10,986</td><td>986.00</td></tr> <tr><td>2013</td><td>2013-660002823</td><td>LANDSAW, THOMAS M &amp; JANICE</td><td>19</td><td>110,441</td><td>1000</td><td>10,637</td><td>896.00</td></tr> </tbody> </table>										Tax Year	Statement Number	Billed Owner	Tax Area	Total Value	Exemptions	Taxable Value	Billed Tax	2025	2025-660002823	LANDSAW, THOMAS M & JANICE	19	152,670	1000	11,747	940.00	2024	2024-660002823	LANDSAW, THOMAS M & JANICE	19	157,457	1000	11,377	915.00	2023	2023-660002823	LANDSAW, THOMAS M & JANICE	19	110,237	1000	11,016	887.00	2022	2022-660002823	LANDSAW, THOMAS M & JANICE	19	106,057	1000	10,666	865.00	2021	2021-660002823	LANDSAW, THOMAS M & JANICE	19	111,784	1000	11,296	905.00	2020	2020-660002823	LANDSAW, THOMAS M & JANICE	19	113,249	1000	11,156	901.00	2019	2019-660002823	LANDSAW, THOMAS M & JANICE	19	107,295	1000	10,802	892.00	2018	2018-660002823	LANDSAW, THOMAS M & JANICE	19	114,557	1000	11,601	968.00	2017	2017-660002823	LANDSAW, THOMAS M & JANICE	19	113,552	1000	11,490	967.00	2016	2016-660002823	LANDSAW, THOMAS M & JANICE	19	110,451	1000	11,149	949.00	2015	2015-660002823	LANDSAW, THOMAS M & JANICE	19	111,379	1000	11,251	976.00	2014	2014-660002823	LANDSAW, THOMAS M & JANICE	19	115,376	1000	10,986	986.00	2013	2013-660002823	LANDSAW, THOMAS M & JANICE	19	110,441	1000	10,637	896.00
Tax Year	Statement Number	Billed Owner	Tax Area	Total Value	Exemptions	Taxable Value	Billed Tax																																																																																																																		
2025	2025-660002823	LANDSAW, THOMAS M & JANICE	19	152,670	1000	11,747	940.00																																																																																																																		
2024	2024-660002823	LANDSAW, THOMAS M & JANICE	19	157,457	1000	11,377	915.00																																																																																																																		
2023	2023-660002823	LANDSAW, THOMAS M & JANICE	19	110,237	1000	11,016	887.00																																																																																																																		
2022	2022-660002823	LANDSAW, THOMAS M & JANICE	19	106,057	1000	10,666	865.00																																																																																																																		
2021	2021-660002823	LANDSAW, THOMAS M & JANICE	19	111,784	1000	11,296	905.00																																																																																																																		
2020	2020-660002823	LANDSAW, THOMAS M & JANICE	19	113,249	1000	11,156	901.00																																																																																																																		
2019	2019-660002823	LANDSAW, THOMAS M & JANICE	19	107,295	1000	10,802	892.00																																																																																																																		
2018	2018-660002823	LANDSAW, THOMAS M & JANICE	19	114,557	1000	11,601	968.00																																																																																																																		
2017	2017-660002823	LANDSAW, THOMAS M & JANICE	19	113,552	1000	11,490	967.00																																																																																																																		
2016	2016-660002823	LANDSAW, THOMAS M & JANICE	19	110,451	1000	11,149	949.00																																																																																																																		
2015	2015-660002823	LANDSAW, THOMAS M & JANICE	19	111,379	1000	11,251	976.00																																																																																																																		
2014	2014-660002823	LANDSAW, THOMAS M & JANICE	19	115,376	1000	10,986	986.00																																																																																																																		
2013	2013-660002823	LANDSAW, THOMAS M & JANICE	19	110,441	1000	10,637	896.00																																																																																																																		



# Rogers

## Assessment Property Record Card for Tax Year 2026

Data provided by LISA DELOZIER County Assessor

Date 04/17/2026  
 Time 03:21:50  
 Page 2

Lot Data	Square-Foot - NBHD 1205 #1	Primary Image
Lot Size		
Lot Count		
Units Buildable	10500	
Non-Ag Acres	0.2411	
Topography		
Street Access		
Utilities		
Amenities	LAND QUALITY 0	
	0	
Method	Square-Foot	
Base Lot Value	10,501.00 x 2.35 = 24,677	
Factor Value		
Adjustments	1.0000	
Lot Value	24,677	

Residential Data	
Type	1 Single Family Residence
Condition	3 - Average
Quality	3 - Average
Architecture	TRAD TRADITIONAL
Style	100% 1 1/2 Story Finished
Exterior Wall	75% Veneer, Masonry 25% Frame, Siding, Vinyl
Base/Total Area	1,513 / 2,023
Style	100% 1 1/2 Story Finished
HVAC	100% Warmed & Cooled Air
Roof Cover	1 Composition Shingle
Area on Slab	0
Fixture/RghIn	14 /
Bed/F/H Bath	4 / 2.0 / 1.0
Basement Area	
Garage Type	330 Attached Garage - Finished 2 Stalls
Remodel	
Year/Eff Age	1964 / 47

GRM Approach	
GRM Code	
Gross Rent	0.00
Indicated Value	

Multiple Regression	
MRA Code	1 Test
Adusted R	0.8445
Indicated Value	192,161 94.99 Per SqFt

Direct Comparables	
Selection Model	A Adam Test
Adjustment Model	1 2022 Residential
Comparables	7
Indicated Value	153,620 Per SqFt

Cost Approach				Manual : 01/2025			
Base Cost	94.61	Total Misc Impr	+ 19,385				
Roofing Adj	+ 3.63	Garage Cost	+ 14,890				
Subfloor Adj	+ 0.00	Total RCN	= 278,107				
Heat/Cool Adj	+ 12.64	Depreciation ( 52%)	- 144,616				
Plumbing Adj	+ 9.65	Lump Sums	+ 0				
Basement Adj	+ 0.00	RCNLD	= 133,491				
Adj Base Cost	= 120.53	Lot Value	+ 24,677				
Total Area	x 2,023	Indicated Value	= 158,168				
Adjusted Cost	= 243,832	Value Per SqFt	78.18				

Value Reconciliation	
Selected Approach	Cost Approach
Improvements	133,491
Lot Value	24,677
Indicated Value	158,168 78.18 Per SqFt
Agland Value	
Site Improvements	1,075
Total Value	159,243 78.72 Total Value Per SqFt

Miscellaneous Improvements								
Code	Description	Sketch ID	Size	Year	Units	Unit Cost	Depr	Value
FPR1	FIREPLACE - RESIDENTIAL 1 STORY	0		1	1	5,615.40		5,615
PRCH	SLAB PORCH - COVERED	7150		119	119	26.55		3,159
PRCH	SLAB PORCH - COVERED	7151	23x18		414	25.63		10,611



Sketch Image

660002823

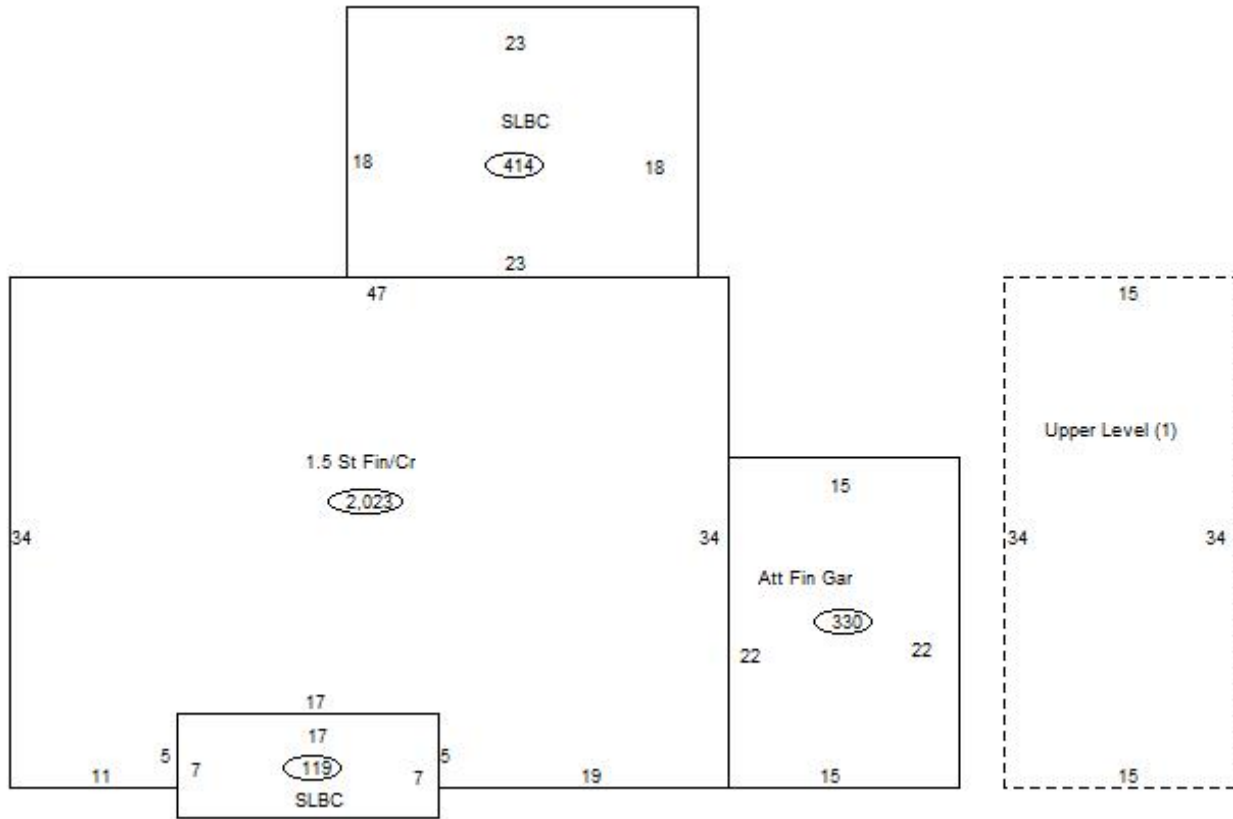

Sketch Vector Information

Sequence	Code	Type	Built Over	Scale	Section Label	Base Area	Multiplier	Total Area
1	R	5	Crawl	13	1.5 St Fin/Cr	1,513	1.337	2,023
2	G	5		13	Att Fin Gar	330	1.000	330
3	M	PRCH		13	SLBC	119	1.000	119
4	M	PRCH		13	SLBC	414	1.000	414
5	U	^UL		13	Upper Level (1)	510	1.000	510
<b>Total Building Area</b>						<b>1,513</b>		<b>2,023</b>



# Rogers

## Assessment Property Record Card for Tax Year 2026

Data provided by LISA DELOZIER County Assessor

Date 04/17/2026  
Time 03:21:50  
Page 4

660002823

### Outbuildings/Site Improvements

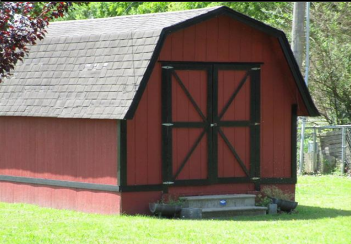
Building Image	Code	Description	Dimensions	Floor	Roofing	Total Units
	SHDS	Shed - Small	8x10x8	Plank	Composition Shingle	80
	Qual	2	Cond 3	Year	2010	Eff Age 12
		<b>Valuation Summary</b>	<b>Modifier Total</b>	<b>RCN</b>	<b>Depr (46% Phys/ % Func)</b>	<b>RCNLD</b>
		Base Cost (24.87 x 80)	1,990		1,990	915 1,075