



# Rogers

## Assessment Property Record Card for Tax Year 2026

Data provided by LISA DELOZIER County Assessor

Date 04/17/2026  
 Time 16:57:16  
 Page 1

Assessment Data					Primary Image																																																																																																																				
<b>Account</b> 660002875 <b>Parcel ID</b> 000000-00-0-50010-033-0001 <b>Cadastral ID</b> 04-19-17-04280 <b>Property Type</b> REAL - Real Property <b>Property Class</b> URP VI Area 3 <b>Tax Area</b> 19 - INOLA OT <b>Name ID</b> 347401 LONG, SHANE & ASHLEY  210 SOUTHWEST 2ND ST INOLA OK 74036-0000  <b>Parcel Location</b> <b>Situs</b> 00210 2ND ST SW <b>Subdivision</b> INOLA O T <b>Lot/Block</b> 0001 / 0033 <b>Parcel Size</b> 2 - Lots <b>Sec/Twn/Rng</b> 4 / 19 / 17 / 5 <b>Neighborhood</b> 1205 - R-V03-SE INOLA <b>School District</b> S005 - INOLA SCHOOLS					<p>660002875_001.JPG 11/13/2025</p>																																																																																																																				
<b>Legal Description</b> Lat/Long: 36.14800645 -95.50889876 LOTS 1 & 3 BLOCK 33 INOLA O T																																																																																																																									
<b>Exemptions</b> <table border="1"> <thead> <tr> <th>Code</th> <th>Type</th> <th>Active</th> <th>Maximum</th> <th>Exemption</th> </tr> </thead> <tbody> <tr> <td>H</td> <td>Homestead</td> <td>No</td> <td>1,000</td> <td></td> </tr> </tbody> </table>					Code	Type	Active	Maximum	Exemption	H	Homestead	No	1,000		<b>Building Permits</b> <table border="1"> <thead> <tr> <th>Number</th> <th>Description</th> <th>Opened</th> <th>Closed</th> <th>Amount</th> </tr> </thead> <tbody> <tr> <td></td> <td></td> <td></td> <td></td> <td></td> </tr> </tbody> </table>					Number	Description	Opened	Closed	Amount																																																																																																	
Code	Type	Active	Maximum	Exemption																																																																																																																					
H	Homestead	No	1,000																																																																																																																						
Number	Description	Opened	Closed	Amount																																																																																																																					
<b>Parcel Valuation</b> <table border="1"> <thead> <tr> <th>Source</th> <th>REAL</th> <th>Fair Cash</th> <th>Capped</th> <th>Asmnt Level</th> <th>Assessed</th> <th>Levy Rate</th> <th>80.060</th> <th>Current Tax</th> </tr> </thead> <tbody> <tr> <td>Remove Cap</td> <td>2026</td> <td>Land Value 35,432</td> <td>35,432</td> <td>11%</td> <td>3,898</td> <td>Assessed 7,165</td> <td></td> <td>573.63</td> </tr> <tr> <td>Year Frozen</td> <td>0</td> <td>Improvements 29,704</td> <td>29,704</td> <td></td> <td>3,267</td> <td>Penalty 0</td> <td></td> <td></td> </tr> <tr> <td>Uncapped Value</td> <td>0</td> <td>Mobile Home 0</td> <td>0</td> <td></td> <td>0</td> <td>Exemption 0</td> <td></td> <td>0.00</td> </tr> <tr> <td>TIF Project ID</td> <td>0</td> <td>Total Value 65,136</td> <td>65,136</td> <td></td> <td>7,165</td> <td>Total Taxable 7,165</td> <td></td> <td>574.00</td> </tr> </tbody> </table>					Source	REAL	Fair Cash	Capped	Asmnt Level	Assessed	Levy Rate	80.060	Current Tax	Remove Cap	2026	Land Value 35,432	35,432	11%	3,898	Assessed 7,165		573.63	Year Frozen	0	Improvements 29,704	29,704		3,267	Penalty 0			Uncapped Value	0	Mobile Home 0	0		0	Exemption 0		0.00	TIF Project ID	0	Total Value 65,136	65,136		7,165	Total Taxable 7,165		574.00	<b>Sale History</b> <table border="1"> <thead> <tr> <th>Bk/Pg</th> <th>Grantor</th> <th>Date</th> <th>Price</th> <th>Code</th> </tr> </thead> <tbody> <tr> <td>/</td> <td>O'DELL, LACIE &amp;</td> <td>06/17/2025</td> <td>63,000</td> <td>YES</td> </tr> <tr> <td>/</td> <td>DARDENNE, ROBERT R</td> <td>12/17/2019</td> <td>45,000</td> <td>YES</td> </tr> <tr> <td>2284/163</td> <td>FUGATE, CHAD</td> <td>11/07/2012</td> <td>49,500</td> <td>YES</td> </tr> <tr> <td>2001/485</td> <td>BANK OF OKLAHOMA NA</td> <td>01/23/2009</td> <td>43,000</td> <td>YES</td> </tr> <tr> <td>1980/200</td> <td>JOHNSON, TODD A</td> <td>09/17/2008</td> <td>0</td> <td>10</td> </tr> <tr> <td>1764/930</td> <td>BARNETT, TRAVIS W</td> <td>04/10/2006</td> <td>64,000</td> <td>YES</td> </tr> </tbody> </table>					Bk/Pg	Grantor	Date	Price	Code	/	O'DELL, LACIE &	06/17/2025	63,000	YES	/	DARDENNE, ROBERT R	12/17/2019	45,000	YES	2284/163	FUGATE, CHAD	11/07/2012	49,500	YES	2001/485	BANK OF OKLAHOMA NA	01/23/2009	43,000	YES	1980/200	JOHNSON, TODD A	09/17/2008	0	10	1764/930	BARNETT, TRAVIS W	04/10/2006	64,000	YES																																
Source	REAL	Fair Cash	Capped	Asmnt Level	Assessed	Levy Rate	80.060	Current Tax																																																																																																																	
Remove Cap	2026	Land Value 35,432	35,432	11%	3,898	Assessed 7,165		573.63																																																																																																																	
Year Frozen	0	Improvements 29,704	29,704		3,267	Penalty 0																																																																																																																			
Uncapped Value	0	Mobile Home 0	0		0	Exemption 0		0.00																																																																																																																	
TIF Project ID	0	Total Value 65,136	65,136		7,165	Total Taxable 7,165		574.00																																																																																																																	
Bk/Pg	Grantor	Date	Price	Code																																																																																																																					
/	O'DELL, LACIE &	06/17/2025	63,000	YES																																																																																																																					
/	DARDENNE, ROBERT R	12/17/2019	45,000	YES																																																																																																																					
2284/163	FUGATE, CHAD	11/07/2012	49,500	YES																																																																																																																					
2001/485	BANK OF OKLAHOMA NA	01/23/2009	43,000	YES																																																																																																																					
1980/200	JOHNSON, TODD A	09/17/2008	0	10																																																																																																																					
1764/930	BARNETT, TRAVIS W	04/10/2006	64,000	YES																																																																																																																					
<b>Assessment History</b> <table border="1"> <thead> <tr> <th>Tax Year</th> <th>Statement Number</th> <th>Billed Owner</th> <th>Tax Area</th> <th>Total Value</th> <th>Exemptions</th> <th>Taxable Value</th> <th>Billed Tax</th> </tr> </thead> <tbody> <tr><td>2025</td><td>2025-660002875</td><td>LONG, SHANE &amp; ASHLEY</td><td>19</td><td>88,675</td><td>0</td><td>6,449</td><td>516.00</td></tr> <tr><td>2024</td><td>2024-660002875</td><td>O'DELL, LACIE &amp;</td><td>19</td><td>88,590</td><td>0</td><td>6,143</td><td>494.00</td></tr> <tr><td>2023</td><td>2023-660002875</td><td>O'DELL, LACIE &amp;</td><td>19</td><td>55,160</td><td>0</td><td>5,850</td><td>471.00</td></tr> <tr><td>2022</td><td>2022-660002875</td><td>O'DELL, LACIE &amp;</td><td>19</td><td>55,161</td><td>0</td><td>5,572</td><td>452.00</td></tr> <tr><td>2021</td><td>2021-660002875</td><td>O'DELL, LACIE &amp;</td><td>19</td><td>45,618</td><td>0</td><td>5,018</td><td>402.00</td></tr> <tr><td>2020</td><td>2020-660002875</td><td>O'DELL, LACIE &amp;</td><td>19</td><td>46,344</td><td>0</td><td>5,098</td><td>412.00</td></tr> <tr><td>2019</td><td>2019-660002875</td><td>DARDENNE, ROBERT R</td><td>19</td><td>44,517</td><td>0</td><td>4,897</td><td>405.00</td></tr> <tr><td>2018</td><td>2018-660002875</td><td>DARDENNE, ROBERT R</td><td>19</td><td>47,727</td><td>0</td><td>5,250</td><td>438.00</td></tr> <tr><td>2017</td><td>2017-660002875</td><td>DARDENNE, ROBERT R</td><td>19</td><td>50,083</td><td>0</td><td>5,509</td><td>464.00</td></tr> <tr><td>2016</td><td>2016-660002875</td><td>DARDENNE, ROBERT R</td><td>19</td><td>49,059</td><td>0</td><td>5,397</td><td>459.00</td></tr> <tr><td>2015</td><td>2015-660002875</td><td>DARDENNE, ROBERT R</td><td>19</td><td>48,285</td><td>0</td><td>5,312</td><td>461.00</td></tr> <tr><td>2014</td><td>2014-660002875</td><td>DARDENNE, ROBERT R</td><td>19</td><td>49,939</td><td>0</td><td>5,494</td><td>493.00</td></tr> <tr><td>2013</td><td>2013-660002875</td><td>DARDENNE, ROBERT R</td><td>19</td><td>49,682</td><td>0</td><td>5,465</td><td>460.00</td></tr> </tbody> </table>										Tax Year	Statement Number	Billed Owner	Tax Area	Total Value	Exemptions	Taxable Value	Billed Tax	2025	2025-660002875	LONG, SHANE & ASHLEY	19	88,675	0	6,449	516.00	2024	2024-660002875	O'DELL, LACIE &	19	88,590	0	6,143	494.00	2023	2023-660002875	O'DELL, LACIE &	19	55,160	0	5,850	471.00	2022	2022-660002875	O'DELL, LACIE &	19	55,161	0	5,572	452.00	2021	2021-660002875	O'DELL, LACIE &	19	45,618	0	5,018	402.00	2020	2020-660002875	O'DELL, LACIE &	19	46,344	0	5,098	412.00	2019	2019-660002875	DARDENNE, ROBERT R	19	44,517	0	4,897	405.00	2018	2018-660002875	DARDENNE, ROBERT R	19	47,727	0	5,250	438.00	2017	2017-660002875	DARDENNE, ROBERT R	19	50,083	0	5,509	464.00	2016	2016-660002875	DARDENNE, ROBERT R	19	49,059	0	5,397	459.00	2015	2015-660002875	DARDENNE, ROBERT R	19	48,285	0	5,312	461.00	2014	2014-660002875	DARDENNE, ROBERT R	19	49,939	0	5,494	493.00	2013	2013-660002875	DARDENNE, ROBERT R	19	49,682	0	5,465	460.00
Tax Year	Statement Number	Billed Owner	Tax Area	Total Value	Exemptions	Taxable Value	Billed Tax																																																																																																																		
2025	2025-660002875	LONG, SHANE & ASHLEY	19	88,675	0	6,449	516.00																																																																																																																		
2024	2024-660002875	O'DELL, LACIE &	19	88,590	0	6,143	494.00																																																																																																																		
2023	2023-660002875	O'DELL, LACIE &	19	55,160	0	5,850	471.00																																																																																																																		
2022	2022-660002875	O'DELL, LACIE &	19	55,161	0	5,572	452.00																																																																																																																		
2021	2021-660002875	O'DELL, LACIE &	19	45,618	0	5,018	402.00																																																																																																																		
2020	2020-660002875	O'DELL, LACIE &	19	46,344	0	5,098	412.00																																																																																																																		
2019	2019-660002875	DARDENNE, ROBERT R	19	44,517	0	4,897	405.00																																																																																																																		
2018	2018-660002875	DARDENNE, ROBERT R	19	47,727	0	5,250	438.00																																																																																																																		
2017	2017-660002875	DARDENNE, ROBERT R	19	50,083	0	5,509	464.00																																																																																																																		
2016	2016-660002875	DARDENNE, ROBERT R	19	49,059	0	5,397	459.00																																																																																																																		
2015	2015-660002875	DARDENNE, ROBERT R	19	48,285	0	5,312	461.00																																																																																																																		
2014	2014-660002875	DARDENNE, ROBERT R	19	49,939	0	5,494	493.00																																																																																																																		
2013	2013-660002875	DARDENNE, ROBERT R	19	49,682	0	5,465	460.00																																																																																																																		



# Rogers

## Assessment Property Record Card for Tax Year 2026

Data provided by LISA DELOZIER County Assessor

Date 04/17/2026  
Time 16:57:17  
Page 2

Lot Data	Square-Foot - NBHD 1205 #1	Primary Image
<b>Lot Size</b> <b>Lot Count</b> <b>Units Buildable</b> 15250 <b>Non-Ag Acres</b> 0.3483 <b>Topography</b> <b>Street Access</b> <b>Utilities</b> <b>Amenities</b> LAND QUALITY 0 0 <b>Method</b> Square-Foot <b>Base Lot Value</b> 15,173.00 x 2.34 = 35,432 <b>Factor Value</b> <b>Adjustments</b> 1.0000 <b>Lot Value</b> 35,432		<p>660002875 11/12/25</p> <p>660002875_001.JPG 11/13/2025</p>

Residential Data	
<b>Type</b>	1 Single Family Residence
<b>Condition</b>	2 - Fair
<b>Quality</b>	1.5 - Low
<b>Architecture</b>	TRAD TRADITIONAL
<b>Style</b>	100% One Story
<b>Exterior Wall</b>	100% Frame, Siding, Vinyl
<b>Base/Total Area</b>	1,020 / 1,020
<b>Style</b>	100% One Story
<b>HVAC</b>	100% Warmed & Cooled Air
<b>Roof Cover</b>	1 Composition Shingle
<b>Area on Slab</b>	1,020
<b>Fixture/RghIn</b>	4 /
<b>Bed/F/H Bath</b>	3 / 1.0 /
<b>Basement Area</b>	
<b>Garage Type</b>	
<b>Remodel</b>	
<b>Year/Eff Age</b>	1954 / 72

GRM Approach
<b>GRM Code</b> <b>Gross Rent</b> 0.00 <b>Indicated Value</b>

Multiple Regression
<b>MRA Code</b> 1 Test <b>Adusted R</b> 0.8445 <b>Indicated Value</b> 42,342 41.51 Per SqFt

Direct Comparables
<b>Selection Model</b> A Adam Test <b>Adjustment Model</b> 1 2022 Residential <b>Comparables</b> <b>Indicated Value</b>

Cost Approach				Manual : 01/2025			
<b>Base Cost</b>	86.95	<b>Total Misc Impr</b>	+ 0	<b>Roofing Adj</b>	+ 4.04	<b>Garage Cost</b>	+ 0
<b>Subfloor Adj</b>	+ 0.00	<b>Total RCN</b>	= 107,712	<b>Heat/Cool Adj</b>	+ 9.89	<b>Depreciation ( 77%)</b>	- 82,938
<b>Plumbing Adj</b>	+ 4.72	<b>Lump Sums</b>	+ 4,930	<b>Basement Adj</b>	+ 0.00	<b>RCNLD</b>	= 29,704
<b>Adj Base Cost</b>	= 105.60	<b>Lot Value</b>	+ 35,432	<b>Total Area</b>	x 1,020	<b>Indicated Value</b>	= 65,136
		<b>Value Per SqFt</b>	63.86	<b>Adjusted Cost</b>	= 107,712		

Value Reconciliation
<b>Selected Approach</b> Cost Approach <b>Improvements</b> 29,704 <b>Lot Value</b> 35,432 <b>Indicated Value</b> 65,136 63.86 Per SqFt <b>Agland Value</b> <b>Site Improvements</b> <b>Total Value</b> 65,136 63.86 Total Value Per SqFt

Miscellaneous Improvements							
Code	Description	Sketch ID	Size	Year	Units	Unit Cost	Depr Value
WODO	Wood Deck - Open	7277	7x4		28	25.95	727
WODO	Wood Deck - Open	7278	5x4		20	26.08	522
WODO	Wood Deck - Open	7279	14x14		196	18.78	3,681



# Rogers

## Assessment Property Record Card for Tax Year 2026

Data provided by LISA DELOZIER County Assessor

Date 04/17/2026

Time 16:57:17

Page 3

Sketch Image

660002875

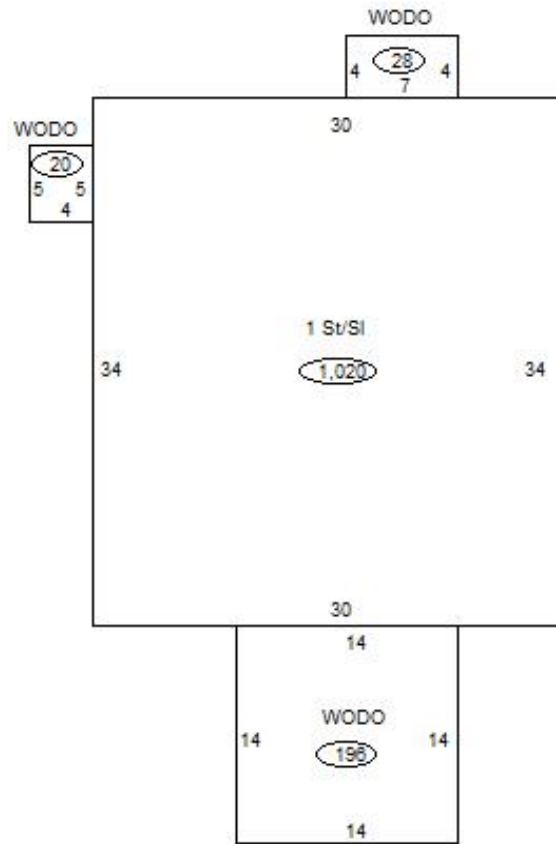

### Sketch Vector Information

Sequence	Code	Type	Built Over	Scale	Section Label	Base Area	Multiplier	Total Area
1	R	1	Slab	13	1 St/Sl	1,020	1.000	1,020
2	M	WODO		13	WODO	28	1.000	28
3	M	WODO		13	WODO	20	1.000	20
4	M	WODO		13	WODO	196	1.000	196
<b>Total Building Area</b>						1,020		1,020