



# Rogers

## Assessment Property Record Card for Tax Year 2026

Data provided by LISA DELOZIER County Assessor

Date 04/17/2026  
 Time 16:34:53  
 Page 1

Assessment Data					Primary Image														
<b>Account</b> 660002883 <b>Parcel ID</b> 000000-00-0-50010-035-0006 <b>Cadastral ID</b> 04-19-17-04360 <b>Property Type</b> REAL - Real Property <b>Property Class</b> URP VI Area 3 <b>Tax Area</b> 19 - INOLA OT <b>Name ID</b> 298414 GIBSON, STEPHANIE  225 S BROADWAY INOLA OK 74036-0000  <b>Parcel Location</b> <b>Situs</b> 00225 S BROADWAY <b>Subdivision</b> INOLA O T <b>Lot/Block</b> 0006 / 0035 <b>Parcel Size</b> 1 - Lots <b>Sec/Twn/Rng</b> 4 / 19 / 17 / 5 <b>Neighborhood</b> 1205 - R-V03-SE INOLA <b>School District</b> S005 - INOLA SCHOOLS																			
<b>Legal Description</b> Lot/Long: 36.14843295 -95.50695177																			
<b>Building Permits</b>					<table border="1"> <thead> <tr> <th>Number</th> <th>Description</th> <th>Opened</th> <th>Closed</th> <th>Amount</th> </tr> </thead> <tbody> <tr> <td colspan="5" style="height: 100px;"> </td> </tr> </tbody> </table>					Number	Description	Opened	Closed	Amount					
Number	Description	Opened	Closed	Amount															
<b>Exemptions</b>					<b>Sale History</b>														
<b>Code</b>	<b>Type</b>	<b>Active</b>	<b>Maximum</b>	<b>Exemption</b>	<b>Bk/Pg</b>	<b>Grantor</b>	<b>Date</b>	<b>Price</b>	<b>Code</b>										
					1967/88	PITTS, TERRY L &	07/15/2008	74,000	YES										
					1818/741	PITTS, MEGAN R	10/28/2006	0	4										
					1746/893	DANKER, DALE W & VANESSA D	01/27/2006	68,000	YES										
					1431/1	WILLIS, ROBERT & DORIS-YVONNE	12/11/2002	38,500	YES										
					1251/38	HONEYCUTT, CLARA WILLIS &-JOAN	10/05/2000	17,000	YES										
					977/431	HONEYCUTT, CLARA WILLIS &-JOAN	12/14/1994	0	No										
<b>Parcel Valuation</b>																			
<b>Source</b>	<b>REAL</b>		<b>Fair Cash</b>	<b>Capped</b>	<b>Asmnt Level</b>	<b>Assessed</b>	<b>Levy Rate</b>	80.060	<b>Current Tax</b>										
<b>Remove Cap</b>	2009		<b>Land Value</b>	32,905	13,066	11%	1,437	<b>Assessed</b>	2,840										
<b>Year Frozen</b>	0		<b>Improvements</b>	24,725	12,754		1,403	<b>Penalty</b>	0										
<b>Uncapped Value</b>	0		<b>Mobile Home</b>	0	0		0	<b>Exemption</b>	0										
<b>TIF Project ID</b>	0		<b>Total Value</b>	57,630	25,820		2,840	<b>Total Taxable</b>	2,840										
<b>Assessment History</b>																			
<b>Tax Year</b>	<b>Statement Number</b>	<b>Billed Owner</b>			<b>Tax Area</b>	<b>Total Value</b>	<b>Exemptions</b>	<b>Taxable Value</b>	<b>Billed Tax</b>										
2025	2025-660002883	GIBSON, STEPHANIE			19	55,556	0	2,705	217.00										
2024	2024-660002883	GIBSON, STEPHANIE			19	54,097	0	2,577	207.00										
2023	2023-660002883	GIBSON, STEPHANIE			19	31,287	0	2,454	198.00										
2022	2022-660002883	GIBSON, STEPHANIE			19	21,243	0	2,337	190.00										
2021	2021-660002883	GIBSON, STEPHANIE			19	35,919	0	3,951	317.00										
2020	2020-660002883	GIBSON, STEPHANIE			19	37,019	0	4,072	329.00										
2019	2019-660002883	GIBSON, STEPHANIE			19	36,269	0	3,990	330.00										
2018	2018-660002883	GIBSON, STEPHANIE			19	38,814	0	4,270	356.00										
2017	2017-660002883	GIBSON, STEPHANIE			19	38,547	0	4,240	357.00										
2016	2016-660002883	GIBSON, STEPHANIE			19	37,701	0	4,147	353.00										
2015	2015-660002883	GIBSON, STEPHANIE			19	37,166	0	4,088	355.00										
2014	2014-660002883	GIBSON, STEPHANIE			19	38,834	0	4,272	384.00										
2013	2013-660002883	GIBSON, STEPHANIE			19	50,899	0	5,292	446.00										



# Rogers

## Assessment Property Record Card for Tax Year 2026

Data provided by LISA DELOZIER County Assessor

Date 04/17/2026  
 Time 16:34:53  
 Page 2

Lot Data	Square-Foot - NBHD 1205 #1	Primary Image
<b>Lot Size</b> <b>Lot Count</b> <b>Units Buildable</b> 14000 <b>Non-Ag Acres</b> 0.3214 <b>Topography</b> <b>Street Access</b> <b>Utilities</b> <b>Amenities</b> LAND QUALITY 0 0 <b>Method</b> Square-Foot <b>Base Lot Value</b> 14,002.00 x 2.35 = 32,905 <b>Factor Value</b> <b>Adjustments</b> 1.0000 <b>Lot Value</b> 32,905		

Residential Data	
<b>Type</b>	1 Single Family Residence
<b>Condition</b>	1 - Low
<b>Quality</b>	2 - Fair
<b>Architecture</b>	TRAD TRADITIONAL
<b>Style</b>	100% One Story
<b>Exterior Wall</b>	100% Frame, Siding, Wood
<b>Base/Total Area</b>	897 / 897
<b>Style</b>	100% One Story
<b>HVAC</b>	100% Floor Furnace
<b>Roof Cover</b>	1 Composition Shingle
<b>Area on Slab</b>	0
<b>Fixture/RghIn</b>	5 /
<b>Bed/F/H Bath</b>	3 / 1.0 /
<b>Basement Area</b>	
<b>Garage Type</b>	408 Attached Garage - Finished 2 Stalls
<b>Remodel</b>	
<b>Year/Eff Age</b>	1954 / 101

GRM Approach
<b>GRM Code</b> <b>Gross Rent</b> 0.00 <b>Indicated Value</b>

Multiple Regression
<b>MRA Code</b> 1 Test <b>Adusted R</b> 0.8445 <b>Indicated Value</b> 85,283 95.08 Per SqFt

Direct Comparables
<b>Selection Model</b> A Adam Test <b>Adjustment Model</b> 1 2022 Residential <b>Comparables</b> 4 <b>Indicated Value</b> 97,050 Per SqFt

Cost Approach				Manual : 01/2025			
<b>Base Cost</b>	103.02	<b>Total Misc Impr</b>	+ 4,441	<b>Garage Cost</b>	+ 12,636	<b>Total RCN</b>	= 123,623
<b>Roofing Adj</b>	+ 4.62	<b>Depreciation ( 80%)</b>	- 98,898	<b>Lump Sums</b>	+ 0	<b>RCNLD</b>	= 24,725
<b>Subfloor Adj</b>	+ 2.68	<b>Lot Value</b>	+ 32,905	<b>Indicated Value</b>	= 57,630	<b>Value Per SqFt</b>	64.25
<b>Heat/Cool Adj</b>	+ 1.65						
<b>Plumbing Adj</b>	+ 6.81						
<b>Basement Adj</b>	+ 0.00						
<b>Adj Base Cost</b>	= 118.78						
<b>Total Area</b>	x 897						
<b>Adjusted Cost</b>	= 106,546						

Value Reconciliation
<b>Selected Approach</b> Cost Approach <b>Improvements</b> 24,725 <b>Lot Value</b> 32,905 <b>Indicated Value</b> 57,630 64.25 Per SqFt <b>Agland Value</b> <b>Site Improvements</b> <b>Total Value</b> 57,630 64.25 Total Value Per SqFt

Miscellaneous Improvements								
Code	Description	Sketch ID	Size	Year	Units	Unit Cost	Depr	Value
PRCH	SLAB PORCH - COVERED	7289	12x7		84	21.03		1,767
PRCH	SLAB PORCH - COVERED	7290	16x8		128	20.89		2,674



# Rogers

## Assessment Property Record Card for Tax Year 2026

Data provided by LISA DELOZIER County Assessor

Date 04/17/2026

Time 16:34:54

Page 3

Sketch Image

660002883

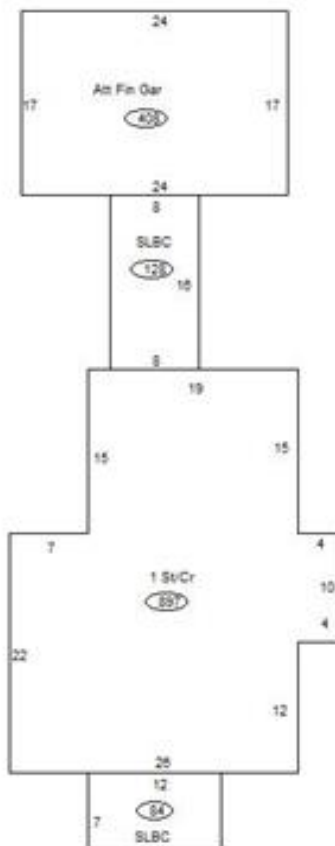

### Sketch Vector Information

Sequence	Code	Type	Built Over	Scale	Section Label	Base Area	Multiplier	Total Area
1	R	1	Crawl	13	1 St/Cr	897	1.000	897
2	M	PRCH		13	SLBC	84	1.000	84
3	M	PRCH		13	SLBC	128	1.000	128
4	G	5		13	Att Fin Gar	408	1.000	408
<b>Total Building Area</b>						897		897