



Rogers

Assessment Property Record Card for Tax Year 2026

Data provided by LISA DELOZIER County Assessor

Date 04/17/2026
Time 04:14:36
Page 1

Assessment Data					Primary Image														
Account 660002888 Parcel ID 000000-00-0-50010-036-0005 Cadastral ID 04-19-17-04400 Property Type REAL - Real Property Property Class URP VI Area 3 Tax Area 19 - INOLA OT Name ID 347658 ALEXANDER, ROBERT C & NORMA BROWN ALEXANDER 234 C ST SE INOLA OK 74036-0000 Parcel Location Situs 00234 C ST SE Subdivision INOLA O T Lot/Block 0005 / 0036 Parcel Size .5 - Lots Sec/Twn/Rng 4 / 19 / 17 / 5 Neighborhood 1205 - R-V03-SE INOLA School District S005 - INOLA SCHOOLS					<p>660002888 11/11/25</p> <p>660002888_002.JPG 11/13/2025</p>														
Legal Description Lat/Long: 36.14962636 -95.50433328																			
LOT 5 BLOCK 36 INOLA O T LESS N 48'					Building Permits <table border="1"> <thead> <tr> <th>Number</th> <th>Description</th> <th>Opened</th> <th>Closed</th> <th>Amount</th> </tr> </thead> <tbody> <tr> <td>R24 057</td> <td>NEW SFR 1344 SQ FT</td> <td>04/2024</td> <td>05/2025</td> <td>155,370</td> </tr> </tbody> </table>					Number	Description	Opened	Closed	Amount	R24 057	NEW SFR 1344 SQ FT	04/2024	05/2025	155,370
Number	Description	Opened	Closed	Amount															
R24 057	NEW SFR 1344 SQ FT	04/2024	05/2025	155,370															
Exemptions					Sale History														
Code	Type	Active	Maximum	Exemption	Bk/Pg	Grantor	Date	Price	Code										
					/	YODER, SAMUEL & MAY	07/22/2025	210,000	20										
					/	HULL, STEVEN	10/13/2023	20,000	YES										
					/	WEATHERLY, CHARLES ALAN	02/02/2022	18,000	YES										
					/	WEATHERLY, ALAN	05/17/2021	0	WB										
					2529/303	T & N PROPERTIES LLC	02/13/2016	8,000	YES										
					2482/708	DOTSON, JANICE KAY	06/27/2015	9,000	YES										
Parcel Valuation																			
Source	REAL		Fair Cash	Capped	Asmnt Level	Assessed	Levy Rate	80.060	Current Tax										
Remove Cap	2026	Land Value	33,904	33,904	11%	3,729	Assessed	11,477	918.85										
Year Frozen	0	Improvements	70,438	70,438		7,748	Penalty	0											
Uncapped Value	70,438	Mobile Home	0	0		0	Exemption	0	0.00										
TIF Project ID	0	Total Value	104,342	104,342		11,477	Total Taxable	11,477	919.00										
Assessment History																			
Tax Year	Statement Number	Billed Owner			Tax Area	Total Value	Exemptions	Taxable Value	Billed Tax										
2025	2025-660002888	ALEXANDER, ROBERT C &			19	23,585	0	2,594	208.00										
2024	2024-660002888	YODER, SAMUEL & MAY			19	22,699	0	2,497	201.00										
2023	2023-660002888	HULL, STEVEN			19	18,000	0	1,980	159.00										
2022	2022-660002888	HULL, STEVEN			19	12,416	0	1,155	94.00										
2021	2021-660002888	WEATHERLY, CHARLES ALAN			19	9,995	0	1,100	88.00										
2020	2020-660002888	WEATHERLY, ALAN			19	9,995	0	1,100	89.00										
2019	2019-660002888	WEATHERLY, ALAN			19	9,995	0	1,100	91.00										
2018	2018-660002888	WEATHERLY, ALAN			19	9,995	0	1,100	92.00										
2017	2017-660002888	WEATHERLY, ALAN			19	9,995	0	1,100	93.00										
2016	2016-660002888	WEATHERLY, ALAN			19	9,995	0	1,100	94.00										
2015	2015-660002888	T & N PROPERTIES LLC			19	19,850	1000	973	84.00										
2014	2014-660002888	DOTSON, TOMMY LEE &			19	19,734	1000	916	82.00										
2013	2013-660002888	DOTSON, TOMMY LEE &			19	16,907	1000	860	72.00										



Rogers

Assessment Property Record Card for Tax Year 2026

Data provided by LISA DELOZIER County Assessor

Date 04/17/2026
Time 04:14:36
Page 2

Lot Data	Square-Foot - NBHD 1205 #1	Primary Image
Lot Size Lot Count Units Buildable 14000 Non-Ag Acres 0.1634 Topography Street Access Utilities Amenities LAND QUALITY 0 0 Method Square-Foot Base Lot Value 7,119.00 x 2.35 = 16,730 Factor Value Adjustments 2.0265 Lot Value 33,904		

Residential Data	
Type	1 Single Family Residence
Condition	3 - Average
Quality	2.5 - Fair
Architecture	TRAD TRADITIONAL
Style	100% One Story
Exterior Wall	100% Frame, Siding, Metal
Base/Total Area	1,344 / 1,344
Style	100% One Story
HVAC	100% Warmed & Cooled Air
Roof Cover	4 Metal, Preformed
Area on Slab	1,344
Fixture/RghIn	10 /
Bed/F/H Bath	3 / 2.0 /
Basement Area	
Garage Type	
Remodel	
Year/Eff Age	2025 / 1

660002888	11/11/25
660002888_002.JPG	11/13/2025

GRM Approach	
GRM Code	
Gross Rent	0.00
Indicated Value	

Multiple Regression	
MRA Code	
Adusted R	
Indicated Value	

Direct Comparables	
Selection Model	A Adam Test
Adjustment Model	1 2022 Residential
Comparables	
Indicated Value	

Cost Approach				Manual : 01/2025			
Base Cost	93.96	Total Misc Impr	+ 18,020				
Roofing Adj	+ 5.09	Garage Cost	+ 0				
Subfloor Adj	+ -1.15	Total RCN	= 177,875				
Heat/Cool Adj	+ 11.47	Depreciation (1%)	- 1,779				
Plumbing Adj	+ 9.57	Lump Sums	+ 0				
Basement Adj	+ 0.00	RCNLD	= 176,096				
Adj Base Cost	= 118.94	Lot Value	+ 33,904				
Total Area	x 1,344	Indicated Value	= 210,000				
Adjusted Cost	= 159,855	Value Per SqFt	156.25				

Value Reconciliation			
Selected Approach	Cost Approach		
Improvements	176,096		
Lot Value	33,904		
Indicated Value	210,000	156.25	Per SqFt
Agland Value			
Site Improvements			
Total Value	210,000	156.25	Total Value Per SqFt

Miscellaneous Improvements							
Code	Description	Sketch ID	Size	Year	Units	Unit Cost	Depr Value
PRCH	Porch	172087	32x8		256	23.39	5,988
PATO	Patio - Open	181908	1480		1,480	8.13	12,032



Rogers
Assessment Property Record Card for Tax Year 2026

Data provided by LISA DELOZIER County Assessor

Date 04/17/2026
 Time 04:14:36
 Page 3

Sketch Image

660002888

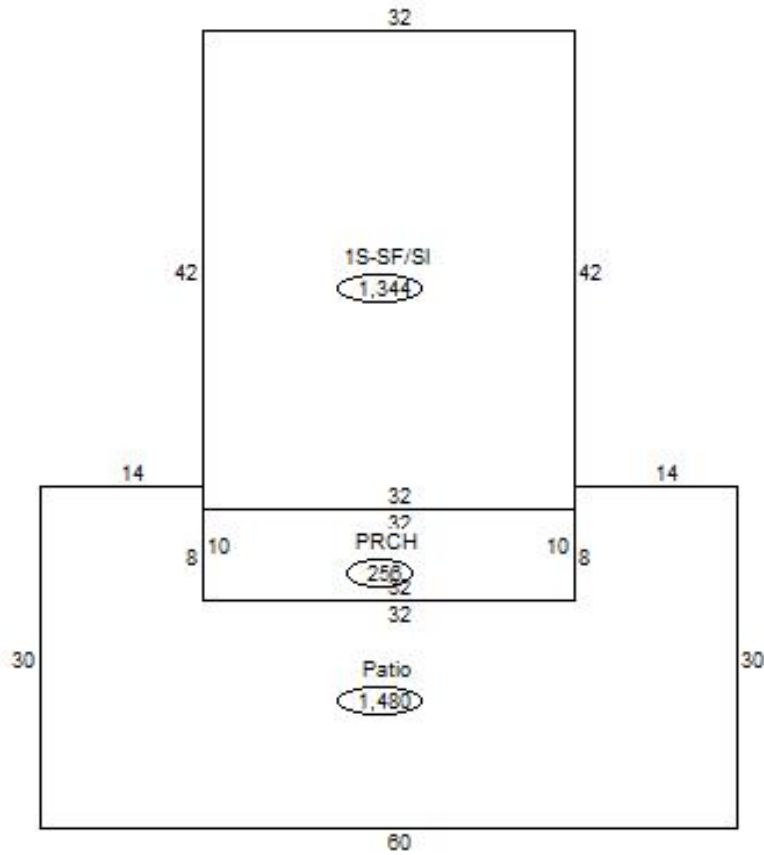

Sketch Vector Information

Sequence	Code	Type	Built Over	Scale	Section Label	Base Area	Multiplier	Total Area
1	R	1	Slab	20	1S-SF/SI	1,344	1.000	1,344
2	M	PRCH		20	PRCH	256	1.000	256
3	M	PATO		20	Patio	1,480	1.000	1,480
Total Building Area						1,344		1,344