



Rogers

Assessment Property Record Card for Tax Year 2026

Data provided by LISA DELOZIER County Assessor

Date 04/18/2026
Time 07:26:30
Page 1

Assessment Data					Primary Image																																																																																																																				
Account 660002896 Parcel ID 000000-00-0-50010-037-0005 Cadastral ID 04-19-17-04450 Property Type REAL - Real Property Property Class URP VI Area 3 Tax Area 19 - INOLA OT Name ID 333459 JOHNSON, HUNTER LEROY 206 D ST SE INOLA OK 74036-0000 Parcel Location Situs 00206 D ST Subdivision INOLA O T Lot/Block 0005 / 0037 Parcel Size 1 - Lots Sec/Twn/Rng 4 / 19 / 17 / 5 Neighborhood 1205 - R-V03-SE INOLA School District S005 - INOLA SCHOOLS					<p>660002896_001.JPG 11/13/2025</p>																																																																																																																				
Legal Description Lat/Long: 36.15029685 -95.50335873																																																																																																																									
Building Permits					<table border="1"> <thead> <tr> <th>Number</th> <th>Description</th> <th>Opened</th> <th>Closed</th> <th>Amount</th> </tr> </thead> <tbody> <tr> <td>687327</td> <td>R6 FOR NEW ADDN</td> <td>08/2005</td> <td>12/2005</td> <td>6,000</td> </tr> </tbody> </table>					Number	Description	Opened	Closed	Amount	687327	R6 FOR NEW ADDN	08/2005	12/2005	6,000																																																																																																						
Number	Description	Opened	Closed	Amount																																																																																																																					
687327	R6 FOR NEW ADDN	08/2005	12/2005	6,000																																																																																																																					
Exemptions					Sale History																																																																																																																				
<table border="1"> <thead> <tr> <th>Code</th> <th>Type</th> <th>Active</th> <th>Maximum</th> <th>Exemption</th> </tr> </thead> <tbody> <tr> <td colspan="5">N2 LOT 5 BLOCK 37 INOLA O T</td> </tr> </tbody> </table>					Code	Type	Active	Maximum	Exemption	N2 LOT 5 BLOCK 37 INOLA O T					<table border="1"> <thead> <tr> <th>Bk/Pg</th> <th>Grantor</th> <th>Date</th> <th>Price</th> <th>Code</th> </tr> </thead> <tbody> <tr> <td>/</td> <td>STONECIPHER, JOSHUA K &</td> <td>01/05/2021</td> <td>128,000</td> <td>YES</td> </tr> <tr> <td>2189/222</td> <td>SEC OF HUD</td> <td>08/15/2011</td> <td>0</td> <td>1</td> </tr> <tr> <td>2151/585</td> <td>WEATHERS, BILLY D &</td> <td>12/16/2010</td> <td>0</td> <td>10</td> </tr> <tr> <td>1849/140</td> <td>MAYO, RHONDA KAY &</td> <td>02/27/2007</td> <td>115,000</td> <td>YES</td> </tr> <tr> <td>1698/67</td> <td>PARKS, MICHAEL A</td> <td>07/22/2005</td> <td>85,500</td> <td>YES</td> </tr> <tr> <td>1136/472</td> <td>DEGIACOMO, ALAN WAYNE</td> <td>10/08/1998</td> <td>65,000</td> <td>Yes</td> </tr> </tbody> </table>					Bk/Pg	Grantor	Date	Price	Code	/	STONECIPHER, JOSHUA K &	01/05/2021	128,000	YES	2189/222	SEC OF HUD	08/15/2011	0	1	2151/585	WEATHERS, BILLY D &	12/16/2010	0	10	1849/140	MAYO, RHONDA KAY &	02/27/2007	115,000	YES	1698/67	PARKS, MICHAEL A	07/22/2005	85,500	YES	1136/472	DEGIACOMO, ALAN WAYNE	10/08/1998	65,000	Yes																																																																			
Code	Type	Active	Maximum	Exemption																																																																																																																					
N2 LOT 5 BLOCK 37 INOLA O T																																																																																																																									
Bk/Pg	Grantor	Date	Price	Code																																																																																																																					
/	STONECIPHER, JOSHUA K &	01/05/2021	128,000	YES																																																																																																																					
2189/222	SEC OF HUD	08/15/2011	0	1																																																																																																																					
2151/585	WEATHERS, BILLY D &	12/16/2010	0	10																																																																																																																					
1849/140	MAYO, RHONDA KAY &	02/27/2007	115,000	YES																																																																																																																					
1698/67	PARKS, MICHAEL A	07/22/2005	85,500	YES																																																																																																																					
1136/472	DEGIACOMO, ALAN WAYNE	10/08/1998	65,000	Yes																																																																																																																					
Parcel Valuation																																																																																																																									
<table border="1"> <thead> <tr> <th>Source</th> <th>REAL</th> <th>Fair Cash</th> <th>Capped</th> <th>Asmnt Level</th> <th>Assessed</th> <th>Levy Rate</th> <th>80.060</th> <th>Current Tax</th> </tr> </thead> <tbody> <tr> <td>Remove Cap</td> <td>2022</td> <td>Land Value 16,452</td> <td>16,452</td> <td>11%</td> <td>1,810</td> <td>Assessed</td> <td>14,045</td> <td>1,124.44</td> </tr> <tr> <td>Year Frozen</td> <td>0</td> <td>Improvements 113,074</td> <td>111,230</td> <td></td> <td>12,235</td> <td>Penalty</td> <td>0</td> <td></td> </tr> <tr> <td>Uncapped Value</td> <td>0</td> <td>Mobile Home 0</td> <td>0</td> <td></td> <td>0</td> <td>Exemption</td> <td>0</td> <td>0.00</td> </tr> <tr> <td>TIF Project ID</td> <td>0</td> <td>Total Value 129,526</td> <td>127,682</td> <td></td> <td>14,045</td> <td>Total Taxable</td> <td>14,045</td> <td>1,124.00</td> </tr> </tbody> </table>		Source	REAL	Fair Cash	Capped	Asmnt Level	Assessed	Levy Rate	80.060	Current Tax	Remove Cap	2022	Land Value 16,452	16,452	11%	1,810	Assessed	14,045	1,124.44	Year Frozen	0	Improvements 113,074	111,230		12,235	Penalty	0		Uncapped Value	0	Mobile Home 0	0		0	Exemption	0	0.00	TIF Project ID	0	Total Value 129,526	127,682		14,045	Total Taxable	14,045	1,124.00																																																																											
Source	REAL	Fair Cash	Capped	Asmnt Level	Assessed	Levy Rate	80.060	Current Tax																																																																																																																	
Remove Cap	2022	Land Value 16,452	16,452	11%	1,810	Assessed	14,045	1,124.44																																																																																																																	
Year Frozen	0	Improvements 113,074	111,230		12,235	Penalty	0																																																																																																																		
Uncapped Value	0	Mobile Home 0	0		0	Exemption	0	0.00																																																																																																																	
TIF Project ID	0	Total Value 129,526	127,682		14,045	Total Taxable	14,045	1,124.00																																																																																																																	
Assessment History																																																																																																																									
<table border="1"> <thead> <tr> <th>Tax Year</th> <th>Statement Number</th> <th>Billed Owner</th> <th>Tax Area</th> <th>Total Value</th> <th>Exemptions</th> <th>Taxable Value</th> <th>Billed Tax</th> </tr> </thead> <tbody> <tr><td>2025</td><td>2025-660002896</td><td>JOHNSON, HUNTER LEROY</td><td>19</td><td>121,602</td><td>0</td><td>13,377</td><td>1,071.00</td></tr> <tr><td>2024</td><td>2024-660002896</td><td>JOHNSON, HUNTER LEROY</td><td>19</td><td>128,477</td><td>0</td><td>14,133</td><td>1,136.00</td></tr> <tr><td>2023</td><td>2023-660002896</td><td>JOHNSON, HUNTER LEROY</td><td>19</td><td>128,000</td><td>0</td><td>14,080</td><td>1,134.00</td></tr> <tr><td>2022</td><td>2022-660002896</td><td>JOHNSON, HUNTER LEROY</td><td>19</td><td>129,757</td><td>0</td><td>14,274</td><td>1,158.00</td></tr> <tr><td>2021</td><td>2021-660002896</td><td>JOHNSON, HUNTER LEROY</td><td>19</td><td>123,085</td><td>0</td><td>13,540</td><td>1,085.00</td></tr> <tr><td>2020</td><td>2020-660002896</td><td>STONECIPHER, JOSHUA K &</td><td>19</td><td>123,831</td><td>0</td><td>13,537</td><td>1,094.00</td></tr> <tr><td>2019</td><td>2019-660002896</td><td>STONECIPHER, JOSHUA K &</td><td>19</td><td>117,197</td><td>0</td><td>12,892</td><td>1,065.00</td></tr> <tr><td>2018</td><td>2018-660002896</td><td>STONECIPHER, JOSHUA K &</td><td>19</td><td>122,486</td><td>0</td><td>13,474</td><td>1,125.00</td></tr> <tr><td>2017</td><td>2017-660002896</td><td>STONECIPHER, JOSHUA K &</td><td>19</td><td>121,389</td><td>0</td><td>13,353</td><td>1,124.00</td></tr> <tr><td>2016</td><td>2016-660002896</td><td>STONECIPHER, JOSHUA K &</td><td>19</td><td>118,005</td><td>0</td><td>12,981</td><td>1,104.00</td></tr> <tr><td>2015</td><td>2015-660002896</td><td>STONECIPHER, JOSHUA K &</td><td>19</td><td>115,359</td><td>0</td><td>12,690</td><td>1,101.00</td></tr> <tr><td>2014</td><td>2014-660002896</td><td>STONECIPHER, JOSHUA K &</td><td>19</td><td>117,695</td><td>0</td><td>12,548</td><td>1,127.00</td></tr> <tr><td>2013</td><td>2013-660002896</td><td>STONECIPHER, JOSHUA K &</td><td>19</td><td>111,734</td><td>0</td><td>11,950</td><td>1,007.00</td></tr> </tbody> </table>										Tax Year	Statement Number	Billed Owner	Tax Area	Total Value	Exemptions	Taxable Value	Billed Tax	2025	2025-660002896	JOHNSON, HUNTER LEROY	19	121,602	0	13,377	1,071.00	2024	2024-660002896	JOHNSON, HUNTER LEROY	19	128,477	0	14,133	1,136.00	2023	2023-660002896	JOHNSON, HUNTER LEROY	19	128,000	0	14,080	1,134.00	2022	2022-660002896	JOHNSON, HUNTER LEROY	19	129,757	0	14,274	1,158.00	2021	2021-660002896	JOHNSON, HUNTER LEROY	19	123,085	0	13,540	1,085.00	2020	2020-660002896	STONECIPHER, JOSHUA K &	19	123,831	0	13,537	1,094.00	2019	2019-660002896	STONECIPHER, JOSHUA K &	19	117,197	0	12,892	1,065.00	2018	2018-660002896	STONECIPHER, JOSHUA K &	19	122,486	0	13,474	1,125.00	2017	2017-660002896	STONECIPHER, JOSHUA K &	19	121,389	0	13,353	1,124.00	2016	2016-660002896	STONECIPHER, JOSHUA K &	19	118,005	0	12,981	1,104.00	2015	2015-660002896	STONECIPHER, JOSHUA K &	19	115,359	0	12,690	1,101.00	2014	2014-660002896	STONECIPHER, JOSHUA K &	19	117,695	0	12,548	1,127.00	2013	2013-660002896	STONECIPHER, JOSHUA K &	19	111,734	0	11,950	1,007.00
Tax Year	Statement Number	Billed Owner	Tax Area	Total Value	Exemptions	Taxable Value	Billed Tax																																																																																																																		
2025	2025-660002896	JOHNSON, HUNTER LEROY	19	121,602	0	13,377	1,071.00																																																																																																																		
2024	2024-660002896	JOHNSON, HUNTER LEROY	19	128,477	0	14,133	1,136.00																																																																																																																		
2023	2023-660002896	JOHNSON, HUNTER LEROY	19	128,000	0	14,080	1,134.00																																																																																																																		
2022	2022-660002896	JOHNSON, HUNTER LEROY	19	129,757	0	14,274	1,158.00																																																																																																																		
2021	2021-660002896	JOHNSON, HUNTER LEROY	19	123,085	0	13,540	1,085.00																																																																																																																		
2020	2020-660002896	STONECIPHER, JOSHUA K &	19	123,831	0	13,537	1,094.00																																																																																																																		
2019	2019-660002896	STONECIPHER, JOSHUA K &	19	117,197	0	12,892	1,065.00																																																																																																																		
2018	2018-660002896	STONECIPHER, JOSHUA K &	19	122,486	0	13,474	1,125.00																																																																																																																		
2017	2017-660002896	STONECIPHER, JOSHUA K &	19	121,389	0	13,353	1,124.00																																																																																																																		
2016	2016-660002896	STONECIPHER, JOSHUA K &	19	118,005	0	12,981	1,104.00																																																																																																																		
2015	2015-660002896	STONECIPHER, JOSHUA K &	19	115,359	0	12,690	1,101.00																																																																																																																		
2014	2014-660002896	STONECIPHER, JOSHUA K &	19	117,695	0	12,548	1,127.00																																																																																																																		
2013	2013-660002896	STONECIPHER, JOSHUA K &	19	111,734	0	11,950	1,007.00																																																																																																																		



Rogers

Assessment Property Record Card for Tax Year 2026

Data provided by LISA DELOZIER County Assessor

Date 04/18/2026
 Time 07:26:30
 Page 2

Lot Data	Square-Foot - NBHD 1205 #1	Primary Image
Lot Size Lot Count Units Buildable 7000 Non-Ag Acres 0.1607 Topography Street Access Utilities Amenities LAND QUALITY 0 0 Method Square-Foot Base Lot Value 7,001.00 x 2.35 = 16,452 Factor Value Adjustments 1.0000 Lot Value 16,452		

Residential Data	
Type	1 Single Family Residence
Condition	3 - Average
Quality	2 - Fair
Architecture	TRAD TRADITIONAL
Style	100% 1 1/2 Story Finished
Exterior Wall	100% Frame, Siding, Wood
Base/Total Area	1,040 / 1,976
Style	100% 1 1/2 Story Finished
HVAC	100% Warmed & Cooled Air
Roof Cover	1 Composition Shingle
Area on Slab	1,040
Fixture/RghIn	14 /
Bed/F/H Bath	4 / 2.0 / 1.0
Basement Area	
Garage Type	432 Attached Garage - Finished 2 Stalls
Remodel	
Year/Eff Age	1986 / 30

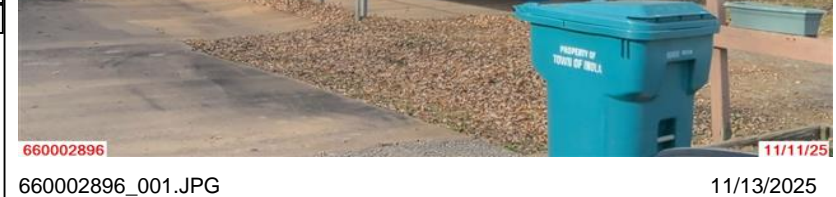

GRM Approach	
GRM Code	
Gross Rent	0.00
Indicated Value	

Multiple Regression			
MRA Code	1	Test	
Adusted R	0.8445		
Indicated Value	168,209	85.13	Per SqFt

Direct Comparables			
Selection Model	A	Adam Test	
Adjustment Model	1	2022 Residential	
Comparables	5		
Indicated Value	156,000		Per SqFt

Cost Approach				Manual : 01/2025			
Base Cost	71.11	Total Misc Impr	+	678			
Roofing Adj	+ 2.21	Garage Cost	+	13,137			
Subfloor Adj	+ 0.00	Total RCN	=	194,955			
Heat/Cool Adj	+ 10.30	Depreciation (42%)	-	81,881			
Plumbing Adj	+ 8.05	Lump Sums	+	0			
Basement Adj	+ 0.00	RCNLD	=	113,074			
Adj Base Cost	= 91.67	Lot Value	+	16,452			
Total Area	x 1,976	Indicated Value	=	129,526			
Adjusted Cost	= 181,140	Value Per SqFt		65.55			

Value Reconciliation			
Selected Approach	Cost Approach		
Improvements	113,074		
Lot Value	16,452		
Indicated Value	129,526	65.55	Per SqFt
Agland Value			
Site Improvements			
Total Value	129,526	65.55	Total Value Per SqFt

Miscellaneous Improvements								
Code	Description	Sketch ID	Size	Year	Units	Unit Cost	Depr	Value
PRCH	SLAB PORCH - COVERED	7320	8x4		32	21.19		678



Rogers
Assessment Property Record Card for Tax Year 2026

Data provided by LISA DELOZIER County Assessor

Date 04/18/2026
 Time 07:26:30
 Page 3

Sketch Image

660002896

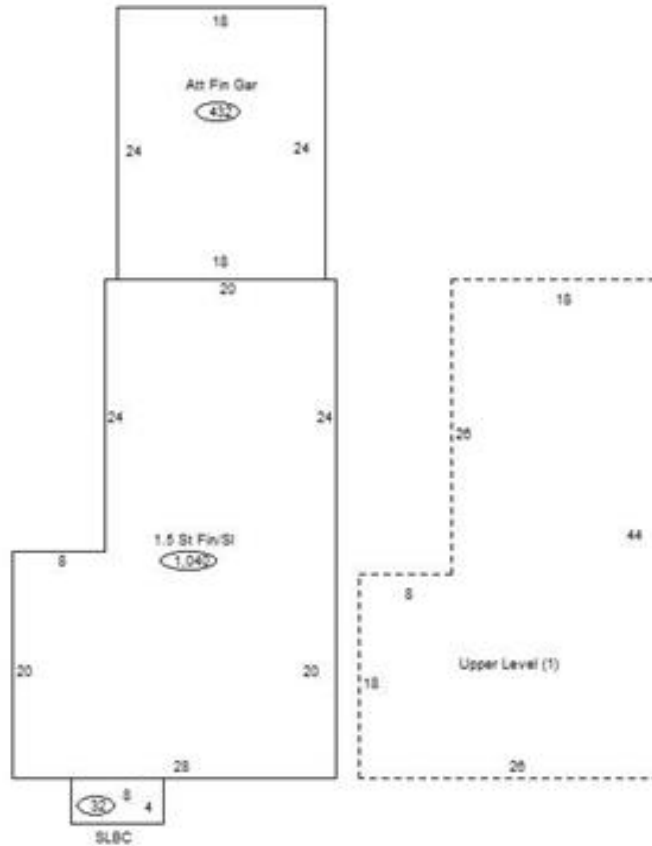

Sketch Vector Information

Sequence	Code	Type	Built Over	Scale	Section Label	Base Area	Multiplier	Total Area
1	R	5	Slab	13	1.5 St Fin/Sl	1,040	1.000	1,040
2	M	PRCH		13	SLBC	32	1.000	32
3	U	^UL		13	Upper Level (1)	936	1.000	936
4	G	5		13	Att Fin Gar	432	1.000	432
Total Building Area						1,040		1,040



Rogers

Assessment Property Record Card for Tax Year 2026

Data provided by LISA DELOZIER County Assessor

Date 04/18/2026
Time 07:26:30
Page 4

660002896

Outbuildings/Site Improvements

Building Image	Code	Description	Dimensions	Floor	Roofing	Total Units
	PCPT	Carport - Portable - NCV	18x20x8	Concrete	Formed Metal	360
	Qual	3	Cond 3	Year 2010	Eff Age 12	
Valuation Summary		Modifier Total		RCN	Depr (100% Phys/ % Func)	RCNLD
Base Cost (5.55 x 360)		1,998		1,998	1,998	