



Rogers

Assessment Property Record Card for Tax Year 2026

Data provided by LISA DELOZIER County Assessor

Date 04/17/2026
 Time 12:23:34
 Page 1

Assessment Data					Primary Image														
Account 660002948 Parcel ID 000000-00-0-50030-001-0002 Cadastral ID 04-19-17-04970 Property Type REAL - Real Property Property Class URP VI Area 3 Tax Area 19 - INOLA OT Name ID 263681 COX, KEVIN D 316 B ST NE INOLA OK 74036-0000 Parcel Location Situs 00316 B ST NE Subdivision FLEMING II Lot/Block 0002 / 0001 Parcel Size 1 - Lots Sec/Twn/Rng 4 / 19 / 17 / 5 Neighborhood 1205 - R-V03-SE INOLA School District S005 - INOLA SCHOOLS					<p>660002948_001.JPG 11/14/2025</p>														
Legal Description Lot/Long: 36.15692641 -95.51033581																			
LOT 2 BLOCK 1 FLEMING II					Building Permits <table border="1"> <thead> <tr> <th>Number</th> <th>Description</th> <th>Opened</th> <th>Closed</th> <th>Amount</th> </tr> </thead> <tbody> <tr> <td> </td> <td> </td> <td> </td> <td> </td> <td> </td> </tr> </tbody> </table>					Number	Description	Opened	Closed	Amount					
Number	Description	Opened	Closed	Amount															
Exemptions					Sale History														
Code	Type	Active	Maximum	Exemption	Bk/Pg	Grantor	Date	Price	Code										
H	Homestead	Yes	1,000	1,000	1032/326	GRIGG, BARNEY G	07/12/1996	0	No										
Parcel Valuation																			
Source	REAL		Fair Cash	Capped	Asmnt Level	Assessed	Levy Rate	80.060	Current Tax										
Remove Cap	0	Land Value	23,131	13,614	11%	1,498	Assessed	11,667	934.06										
Year Frozen	0	Improvements	142,243	92,442		10,169	Penalty	0											
Uncapped Value	0	Mobile Home	0	0		0	Exemption	1,000	-80.00										
TIF Project ID	0	Total Value	165,374	106,056		11,667	Total Taxable	10,667	854.00										
Assessment History																			
Tax Year	Statement Number	Billed Owner			Tax Area	Total Value	Exemptions	Taxable Value	Billed Tax										
2025	2025-660002948	COX, KEVIN D			19	156,500	1000	10,327	827.00										
2024	2024-660002948	COX, KEVIN D			19	175,348	1000	9,997	804.00										
2023	2023-660002948	COX, KEVIN D			19	97,057	1000	9,676	779.00										
2022	2022-660002948	COX, KEVIN D			19	95,139	1000	9,465	768.00										
2021	2021-660002948	COX, KEVIN D			19	93,402	1000	9,274	743.00										
2020	2020-660002948	COX, KEVIN D			19	94,829	1000	9,431	762.00										
2019	2019-660002948	COX, KEVIN D			19	92,850	1000	9,214	761.00										
2018	2018-660002948	COX, KEVIN D			19	100,677	1000	10,074	841.00										
2017	2017-660002948	COX, KEVIN D			19	99,815	1000	9,980	840.00										
2016	2016-660002948	COX, KEVIN D			19	97,236	1000	9,696	825.00										
2015	2015-660002948	COX, KEVIN D			19	99,679	1000	9,965	865.00										
2014	2014-660002948	COX, KEVIN D			19	103,139	1000	10,345	929.00										
2013	2013-660002948	COX, KEVIN D			19	102,120	1000	10,233	862.00										



Rogers

Assessment Property Record Card for Tax Year 2026

Data provided by LISA DELOZIER County Assessor

Date 04/17/2026
 Time 12:23:34
 Page 2

Lot Data	Square-Foot - NBHD 1205 #1	Primary Image
Lot Size		
Lot Count		
Units Buildable	1	
Non-Ag Acres	0.226	
Topography		
Street Access		
Utilities		
Amenities	LAND QUALITY	
	0	
	0	
Method	Square-Foot	
Base Lot Value	9,843.00 x 2.35 = 23,131	
Factor Value		
Adjustments	1.0000	
Lot Value	23,131	

Residential Data	
Type	1 Single Family Residence
Condition	3 - Average
Quality	2.5 - Fair
Architecture	TRAD TRADITIONAL
Style	100% One Story
Exterior Wall	100% Veneer, Masonry
Base/Total Area	1,767 / 1,767
Style	100% One Story
HVAC	100% Warmed & Cooled Air
Roof Cover	1 Composition Shingle
Area on Slab	1,767
Fixture/RghIn	12 /
Bed/F/H Bath	3 / 2.0 /
Basement Area	
Garage Type	
Remodel	
Year/Eff Age	1979 / 35

660002948	11/06/25
660002948_001.JPG	11/14/2025

GRM Approach	
GRM Code	
Gross Rent	0.00
Indicated Value	

Multiple Regression			
MRA Code	1	Test	
Adusted R	0.8445		
Indicated Value	135,374	76.61	Per SqFt

Direct Comparables			
Selection Model	A	Adam Test	
Adjustment Model	1	2022 Residential	
Comparables	6		
Indicated Value	122,090		Per SqFt

Cost Approach				Manual : 01/2025			
Base Cost	103.32	Total Misc Impr	+	28,072			
Roofing Adj	+ 4.37	Garage Cost	+				
Subfloor Adj	+ -1.15	Total RCN	=	251,880			
Heat/Cool Adj	+ 11.47	Depreciation (44%)	-	110,827			
Plumbing Adj	+ 8.65	Lump Sums	+	0			
Basement Adj	+ 0.00	RCNLD	=	141,053			
Adj Base Cost	= 126.66	Lot Value	+	23,131			
Total Area	x 1,767	Indicated Value	=	164,184			
Adjusted Cost	= 223,808	Value Per SqFt		92.92			

Value Reconciliation			
Selected Approach	Cost Approach		
Improvements	141,053		
Lot Value	23,131		
Indicated Value	164,184	92.92	Per SqFt
Agland Value			
Site Improvements	1,190		
Total Value	165,374	93.59	Total Value Per SqFt

Miscellaneous Improvements								
Code	Description	Sketch ID	Size	Year	Units	Unit Cost	Depr	Value
FPR1	FIREPLACE - RESIDENTIAL 1 STORY	0		1	1	5,095.98		5,096
EPSW	ENCLOSED PORCH - SOLID WALL	7445	16x6		96	63.01		6,049
EPSW	Enclosed Porch - Solid Wall	117944	23x12		276	61.33		16,927



Rogers

Assessment Property Record Card for Tax Year 2026

Data provided by LISA DELOZIER County Assessor

Date 04/17/2026
Time 12:23:34
Page 3

Sketch Image

660002948

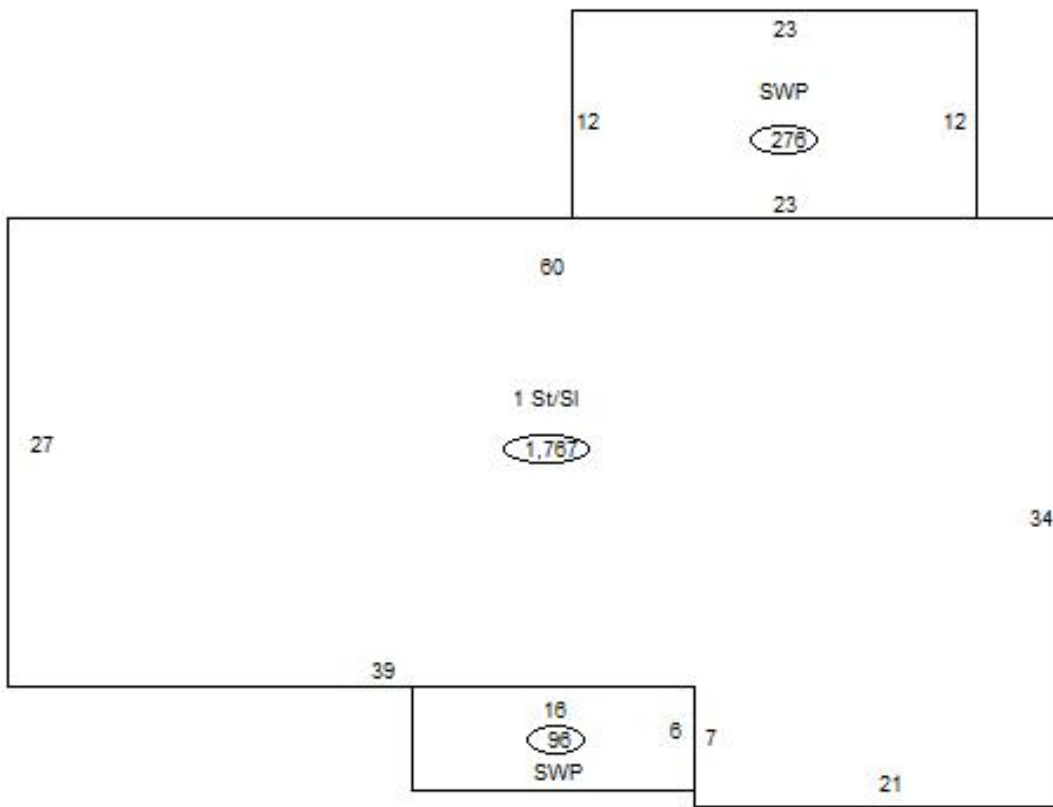

Sketch Vector Information

Sequence	Code	Type	Built Over	Scale	Section Label	Base Area	Multiplier	Total Area
1	R	1	Slab	13	1 St/SI	1,767	1.000	1,767
2	M	EPSW		13	EPSW	96	1.000	96
3	M	EPSW		13	EPSW	276	1.000	276
Total Building Area						1,767		1,767



Rogers



Assessment Property Record Card for Tax Year 2026

Data provided by LISA DELOZIER County Assessor

Date 04/17/2026
Time 12:23:34
Page 4

660002948

Outbuildings/Site Improvements

Building Image	Code	Description	Dimensions	Floor	Roofing	Total Units
	SHDS	Shed - Small	10x10x8	Plank	Composition Shingle	100
	Qual	2	Cond 3	Year 2010	Eff Age 12	
	Valuation Summary		Modifier Total	RCN	Depr (46% Phys/ % Func)	RCNLD
	Base Cost (22.03 x 100)		2,203	2,203	1,013	1,190
	BNV	Shed - Small	8x10x8			80
	Qual	1	Cond 1	Year 2000	Eff Age	
	Valuation Summary		Modifier Total	RCN	Depr (100% Phys/ % Func)	RCNLD
	Base Cost (0.00 x 80)					