



Rogers

Assessment Property Record Card for Tax Year 2026

Data provided by LISA DELOZIER County Assessor

Date 04/17/2026
 Time 04:03:04
 Page 1

Assessment Data					Primary Image																																																																																																																				
Account 660003009 Parcel ID 21N15E-04-3-00000-000-0000 Cadastral ID 04-21-15-02100 Property Type REAL - Real Property Property Class RR VI Area 4 Tax Area 7 - OWASSO/LIMESTONE FIRE Name ID 322241 BAREFOOT, THORTON A 19707 S 4090 RD CLAREMORE OK 74019-0000 Parcel Location Situs 19707 S 4090 RD Subdivision Lot/Block / Parcel Size 10 - Acres Sec/Twn/Rng 4 / 21 / 15 / 3 Neighborhood 6070 - UNPLATTED School District S021 - OWASSO SCHOOLS																																																																																																																									
Legal Description Lat/Long: 36.32649385 -95.72125540																																																																																																																									
SW NW SW					Building Permits <table border="1"> <thead> <tr> <th>Number</th> <th>Description</th> <th>Opened</th> <th>Closed</th> <th>Amount</th> </tr> </thead> <tbody> <tr> <td>R14 7071</td> <td>R14-POSS MHLL 2013 SOUTHERN NEW HOME-MOVED IN 6/2002 R4</td> <td>07/2013 11/2001</td> <td>11/2013 12/2003</td> <td> 96,000</td> </tr> </tbody> </table>					Number	Description	Opened	Closed	Amount	R14 7071	R14-POSS MHLL 2013 SOUTHERN NEW HOME-MOVED IN 6/2002 R4	07/2013 11/2001	11/2013 12/2003	 96,000																																																																																																						
Number	Description	Opened	Closed	Amount																																																																																																																					
R14 7071	R14-POSS MHLL 2013 SOUTHERN NEW HOME-MOVED IN 6/2002 R4	07/2013 11/2001	11/2013 12/2003	 96,000																																																																																																																					
Exemptions <table border="1"> <thead> <tr> <th>Code</th> <th>Type</th> <th>Active</th> <th>Maximum</th> <th>Exemption</th> </tr> </thead> <tbody> <tr> <td>HV</td> <td>Veteran</td> <td>Yes</td> <td>999,999</td> <td>48,790</td> </tr> </tbody> </table>					Code	Type	Active	Maximum	Exemption	HV	Veteran	Yes	999,999	48,790	Sale History <table border="1"> <thead> <tr> <th>Bk/Pg</th> <th>Grantor</th> <th>Date</th> <th>Price</th> <th>Code</th> </tr> </thead> <tbody> <tr> <td>2654/556</td> <td>KILPATRICK, SHELLI R & LLOYD C</td> <td>08/15/2017</td> <td>385,000</td> <td>YES</td> </tr> <tr> <td>2327/327</td> <td>CHAPMAN, CATHERINE LEE &</td> <td>04/26/2013</td> <td>244,000</td> <td>YES</td> </tr> <tr> <td>2327/324</td> <td>MOBLEY, CHESTER</td> <td>04/26/2013</td> <td>0</td> <td>4</td> </tr> <tr> <td>1306/620</td> <td>DODSON, GENEVA</td> <td>07/17/2001</td> <td>47,000</td> <td>YES</td> </tr> <tr> <td>1166/505</td> <td>HILLS, ORVAL D</td> <td>04/14/1999</td> <td>0</td> <td>No</td> </tr> </tbody> </table>					Bk/Pg	Grantor	Date	Price	Code	2654/556	KILPATRICK, SHELLI R & LLOYD C	08/15/2017	385,000	YES	2327/327	CHAPMAN, CATHERINE LEE &	04/26/2013	244,000	YES	2327/324	MOBLEY, CHESTER	04/26/2013	0	4	1306/620	DODSON, GENEVA	07/17/2001	47,000	YES	1166/505	HILLS, ORVAL D	04/14/1999	0	No																																																																								
Code	Type	Active	Maximum	Exemption																																																																																																																					
HV	Veteran	Yes	999,999	48,790																																																																																																																					
Bk/Pg	Grantor	Date	Price	Code																																																																																																																					
2654/556	KILPATRICK, SHELLI R & LLOYD C	08/15/2017	385,000	YES																																																																																																																					
2327/327	CHAPMAN, CATHERINE LEE &	04/26/2013	244,000	YES																																																																																																																					
2327/324	MOBLEY, CHESTER	04/26/2013	0	4																																																																																																																					
1306/620	DODSON, GENEVA	07/17/2001	47,000	YES																																																																																																																					
1166/505	HILLS, ORVAL D	04/14/1999	0	No																																																																																																																					
Parcel Valuation <table border="1"> <thead> <tr> <th>Source</th> <th>REAL</th> <th>Fair Cash</th> <th>Capped</th> <th>Asmnt Level</th> <th>Assessed</th> <th>Levy Rate</th> <th>108.538</th> <th>Current Tax</th> </tr> </thead> <tbody> <tr> <td>Remove Cap</td> <td>2018</td> <td>Land Value 150,268</td> <td>137,590</td> <td>11%</td> <td>15,135</td> <td>Assessed</td> <td>48,790</td> <td>5,295.57</td> </tr> <tr> <td>Year Frozen</td> <td>2005</td> <td>Improvements 328,727</td> <td>305,957</td> <td></td> <td>33,655</td> <td>Penalty</td> <td>0</td> <td></td> </tr> <tr> <td>Uncapped Value</td> <td>0</td> <td>Mobile Home 0</td> <td>0</td> <td></td> <td>0</td> <td>Exemption</td> <td>48,790</td> <td>-4,780.00</td> </tr> <tr> <td>TIF Project ID</td> <td>0</td> <td>Total Value 478,995</td> <td>443,547</td> <td></td> <td>48,790</td> <td>Total Taxable</td> <td>0</td> <td>516.00</td> </tr> </tbody> </table>										Source	REAL	Fair Cash	Capped	Asmnt Level	Assessed	Levy Rate	108.538	Current Tax	Remove Cap	2018	Land Value 150,268	137,590	11%	15,135	Assessed	48,790	5,295.57	Year Frozen	2005	Improvements 328,727	305,957		33,655	Penalty	0		Uncapped Value	0	Mobile Home 0	0		0	Exemption	48,790	-4,780.00	TIF Project ID	0	Total Value 478,995	443,547		48,790	Total Taxable	0	516.00																																																																			
Source	REAL	Fair Cash	Capped	Asmnt Level	Assessed	Levy Rate	108.538	Current Tax																																																																																																																	
Remove Cap	2018	Land Value 150,268	137,590	11%	15,135	Assessed	48,790	5,295.57																																																																																																																	
Year Frozen	2005	Improvements 328,727	305,957		33,655	Penalty	0																																																																																																																		
Uncapped Value	0	Mobile Home 0	0		0	Exemption	48,790	-4,780.00																																																																																																																	
TIF Project ID	0	Total Value 478,995	443,547		48,790	Total Taxable	0	516.00																																																																																																																	
Assessment History <table border="1"> <thead> <tr> <th>Tax Year</th> <th>Statement Number</th> <th>Billed Owner</th> <th>Tax Area</th> <th>Total Value</th> <th>Exemptions</th> <th>Taxable Value</th> <th>Billed Tax</th> </tr> </thead> <tbody> <tr><td>2025</td><td>2025-660003009</td><td>BAREFOOT, THORTON A</td><td>7</td><td>460,430</td><td>47369</td><td></td><td>501.00</td></tr> <tr><td>2024</td><td>2024-660003009</td><td>BAREFOOT, THORTON A</td><td>7</td><td>469,945</td><td>45989</td><td></td><td>657.00</td></tr> <tr><td>2023</td><td>2023-660003009</td><td>BAREFOOT, THORTON A &</td><td>7</td><td>405,910</td><td>44651</td><td></td><td>638.00</td></tr> <tr><td>2022</td><td>2022-660003009</td><td>BAREFOOT, THORTON A &</td><td>7</td><td>409,991</td><td>45099</td><td></td><td>644.00</td></tr> <tr><td>2021</td><td>2021-660003009</td><td>BAREFOOT, THORTON A &</td><td>7</td><td>415,907</td><td>45670</td><td></td><td>652.00</td></tr> <tr><td>2020</td><td>2020-660003009</td><td>BAREFOOT, THORTON A &</td><td>7</td><td>413,416</td><td>44339</td><td></td><td>633.00</td></tr> <tr><td>2019</td><td>2019-660003009</td><td>BAREFOOT, THORTON A &</td><td>7</td><td>391,347</td><td>1000</td><td>42,048</td><td>4,680.00</td></tr> <tr><td>2018</td><td>2018-660003009</td><td>BAREFOOT, THORTON A &</td><td>7</td><td>386,776</td><td>0</td><td>42,545</td><td>4,568.00</td></tr> <tr><td>2017</td><td>2017-660003009</td><td>BAREFOOT, THORTON A &</td><td>7</td><td>282,979</td><td>1000</td><td>28,712</td><td>3,125.00</td></tr> <tr><td>2016</td><td>2016-660003009</td><td>KILPATRICK, SHELLI R & LLOYD C</td><td>7</td><td>276,991</td><td>1000</td><td>27,846</td><td>3,034.00</td></tr> <tr><td>2015</td><td>2015-660003009</td><td>KILPATRICK, SHELLI R & LLOYD C</td><td>7</td><td>269,937</td><td>1000</td><td>27,006</td><td>2,961.00</td></tr> <tr><td>2014</td><td>2014-660003009</td><td>KILPATRICK, SHELLI R & LLOYD C</td><td>7</td><td>247,186</td><td>0</td><td>27,190</td><td>2,991.00</td></tr> <tr><td>2013</td><td>2013-660003009</td><td>KILPATRICK, SHELLI R & LLOYD C</td><td>7</td><td>263,962</td><td>1000</td><td>17,244</td><td>1,876.00</td></tr> </tbody> </table>										Tax Year	Statement Number	Billed Owner	Tax Area	Total Value	Exemptions	Taxable Value	Billed Tax	2025	2025-660003009	BAREFOOT, THORTON A	7	460,430	47369		501.00	2024	2024-660003009	BAREFOOT, THORTON A	7	469,945	45989		657.00	2023	2023-660003009	BAREFOOT, THORTON A &	7	405,910	44651		638.00	2022	2022-660003009	BAREFOOT, THORTON A &	7	409,991	45099		644.00	2021	2021-660003009	BAREFOOT, THORTON A &	7	415,907	45670		652.00	2020	2020-660003009	BAREFOOT, THORTON A &	7	413,416	44339		633.00	2019	2019-660003009	BAREFOOT, THORTON A &	7	391,347	1000	42,048	4,680.00	2018	2018-660003009	BAREFOOT, THORTON A &	7	386,776	0	42,545	4,568.00	2017	2017-660003009	BAREFOOT, THORTON A &	7	282,979	1000	28,712	3,125.00	2016	2016-660003009	KILPATRICK, SHELLI R & LLOYD C	7	276,991	1000	27,846	3,034.00	2015	2015-660003009	KILPATRICK, SHELLI R & LLOYD C	7	269,937	1000	27,006	2,961.00	2014	2014-660003009	KILPATRICK, SHELLI R & LLOYD C	7	247,186	0	27,190	2,991.00	2013	2013-660003009	KILPATRICK, SHELLI R & LLOYD C	7	263,962	1000	17,244	1,876.00
Tax Year	Statement Number	Billed Owner	Tax Area	Total Value	Exemptions	Taxable Value	Billed Tax																																																																																																																		
2025	2025-660003009	BAREFOOT, THORTON A	7	460,430	47369		501.00																																																																																																																		
2024	2024-660003009	BAREFOOT, THORTON A	7	469,945	45989		657.00																																																																																																																		
2023	2023-660003009	BAREFOOT, THORTON A &	7	405,910	44651		638.00																																																																																																																		
2022	2022-660003009	BAREFOOT, THORTON A &	7	409,991	45099		644.00																																																																																																																		
2021	2021-660003009	BAREFOOT, THORTON A &	7	415,907	45670		652.00																																																																																																																		
2020	2020-660003009	BAREFOOT, THORTON A &	7	413,416	44339		633.00																																																																																																																		
2019	2019-660003009	BAREFOOT, THORTON A &	7	391,347	1000	42,048	4,680.00																																																																																																																		
2018	2018-660003009	BAREFOOT, THORTON A &	7	386,776	0	42,545	4,568.00																																																																																																																		
2017	2017-660003009	BAREFOOT, THORTON A &	7	282,979	1000	28,712	3,125.00																																																																																																																		
2016	2016-660003009	KILPATRICK, SHELLI R & LLOYD C	7	276,991	1000	27,846	3,034.00																																																																																																																		
2015	2015-660003009	KILPATRICK, SHELLI R & LLOYD C	7	269,937	1000	27,006	2,961.00																																																																																																																		
2014	2014-660003009	KILPATRICK, SHELLI R & LLOYD C	7	247,186	0	27,190	2,991.00																																																																																																																		
2013	2013-660003009	KILPATRICK, SHELLI R & LLOYD C	7	263,962	1000	17,244	1,876.00																																																																																																																		



Rogers

Assessment Property Record Card for Tax Year 2026

Data provided by LISA DELOZIER County Assessor

Date 04/17/2026
 Time 04:03:05
 Page 2

Lot Data	Square-Foot - UNPLATTED (ACRES)	Primary Image
Lot Size		
Lot Count		
Units Buildable	10	
Non-Ag Acres	9.9322	
Topography		
Street Access		
Utilities		
Amenities	LAND QUALITY	
	0	
	0	
Method	Square-Foot	
Base Lot Value	432,648.00 x .35 = 150,268	
Factor Value		
Adjustments	1.0000	
Lot Value	150,268	

Residential Data	
Type	1 Single Family Residence
Condition	3 - Average
Quality	4 - Good
Architecture	
Style	100% One Story
Exterior Wall	100% Veneer, Masonry
Base/Total Area	2,476 / 2,476
Style	100% One Story
HVAC	100% Warmed & Cooled Air
Roof Cover	4 Metal, Preformed
Area on Slab	2,476
Fixture/RghIn	11 /
Bed/F/H Bath	3 / 2.0 /
Basement Area	
Garage Type	
Remodel	
Year/Eff Age	2002 / 18

\\tsclient\C\Users\Randy Necessary\Pictures\101_0329\IMG_0047. 3/30/2022

GRM Approach	
GRM Code	
Gross Rent	0.00
Indicated Value	

Multiple Regression			
MRA Code	1 Test		
Adjusted R	0.8445		
Indicated Value	319,131	128.89	Per SqFt

Direct Comparables	
Selection Model	1 Res
Adjustment Model	A2 AO Test
Comparables	
Indicated Value	

Value Reconciliation			
Selected Approach	Cost Approach		
Improvements	303,610		
Lot Value	150,268		
Indicated Value	453,878	183.31	Per SqFt
Agland Value			
Site Improvements	25,117		
Total Value	478,995	193.46	Total Value Per SqFt

Cost Approach				Manual : 01/2025			
Base Cost	109.95	Total Misc Impr	+	41,687			
Roofing Adj	+ 6.67	Garage Cost	+				
Subfloor Adj	+ -4.57	Total RCN	=	379,512			
Heat/Cool Adj	+ 16.31	Depreciation (20%)	-	75,902			
Plumbing Adj	+ 8.08	Lump Sums	+	0			
Basement Adj	+ 0.00	RCNLD	=	303,610			
Adj Base Cost	= 136.44	Lot Value	+	150,268			
Total Area	x 2,476	Indicated Value	=	453,878			
Adjusted Cost	= 337,825	Value Per SqFt		183.31			

Miscellaneous Improvements								
Code	Description	Sketch ID	Size	Year	Units	Unit Cost	Depr	Value
FPR1	FIREPLACE - RESIDENTIAL 1 STORY	0		1	1	7,243.87		7,244
PRCH	SLAB PORCH - COVERED	7593	76x8		608	30.98		18,836
PRCH	SLAB PORCH - COVERED	7594	15x8		120	32.75		3,930
PRCH	SLAB PORCH - COVERED	7595	46x8		368	31.73		11,677



Rogers

Assessment Property Record Card for Tax Year 2026

Data provided by LISA DELOZIER County Assessor

Date 04/17/2026
 Time 04:03:05
 Page 3

Sketch Image

660003009

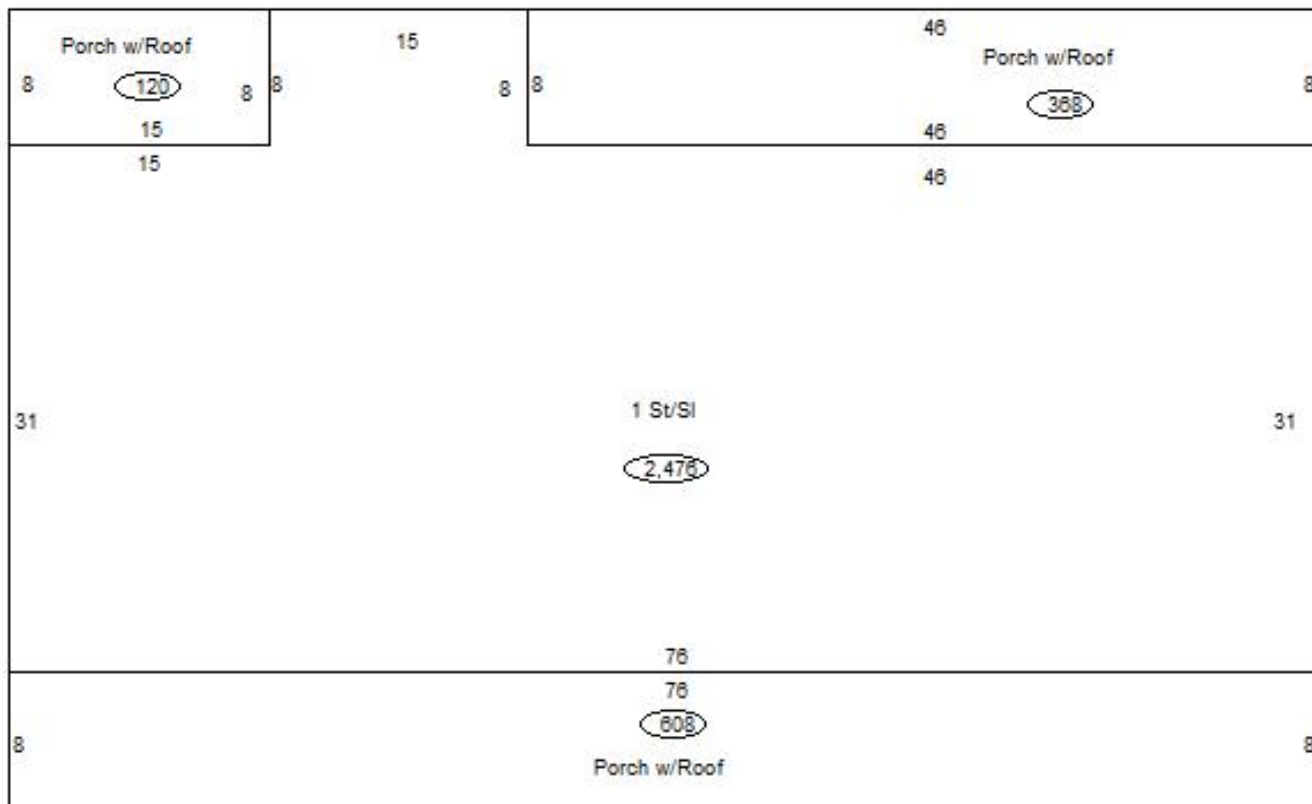

Sketch Vector Information

Sequence	Code	Type	Built Over	Scale	Section Label	Base Area	Multiplier	Total Area
1	R	1	Slab	13	1 St/Sl	2,476	1.000	2,476
2	M	PRCH		13	SLBC	608	1.000	608
3	M	PRCH		13	SLBC	120	1.000	120
4	M	PRCH		13	SLBC	368	1.000	368
Total Building Area						2,476		2,476



Rogers



Assessment Property Record Card for Tax Year 2026

Data provided by LISA DELOZIER County Assessor

Date 04/17/2026
Time 04:03:05
Page 4

660003009

Outbuildings/Site Improvements

Building Image	Code	Description	Dimensions	Floor	Roofing	Total Units
	UTIL	SHOP BUILDING	26x32x0			832
	Qual 3	Cond 3	Year 2018	Eff Age 6		
	Valuation Summary		Modifier Total	RCN	Depr (11% Phys/ % Func)	RCNLD
Base Cost (31.16 x 832)		25,925		25,925	2,852	23,073
	STF	STG FAIR	0x0x0			672
	Qual 2	Cond 3	Year	Eff Age		
	Valuation Summary		Modifier Total	RCN	Depr (35% Phys/ % Func)	RCNLD
Base Cost (4.68 x 672)		3,145		3,145	1,101	2,044