



# Rogers

## Assessment Property Record Card for Tax Year 2026

Data provided by LISA DELOZIER County Assessor

Date 04/18/2026  
Time 06:07:41  
Page 1

Assessment Data					Primary Image																																																																																																																				
<b>Account</b> 660003016 <b>Parcel ID</b> 000000-00-0-10360-001-0005 <b>Cadastral ID</b> 04-21-16-00060 <b>Property Type</b> REAL - Real Property <b>Property Class</b> UCP VI Area 1 <b>Tax Area</b> 17 - CLAREMORE OT <b>Name ID</b> 306568 RAMSEY, TIMOTHY &  JENNY PO BOX 218 CHELSEA OK 74016-0000																																																																																																																									
<b>Parcel Location</b> <b>Situs</b> 00206 E BLUE STARR DR <b>Subdivision</b> PATTERSON SUB <b>Lot/Block</b> 0005 / 0001 <b>Parcel Size</b> 1 - Lots <b>Sec/Twn/Rng</b> 4 / 21 / 16 / 5 <b>Neighborhood</b> 5001 - TASC 2016 <b>School District</b> S001 - CLAREMORE SCHOOLS																																																																																																																									
<b>Legal Description</b> Lot/Long: 36.32211410 -95.60274071					<b>REVAL 2024</b> 5/23/2023																																																																																																																				
<b>Legal Description</b> LOT 5 BLOCK 1 PATTERSON SUB					<b>Building Permits</b> <table border="1"> <thead> <tr> <th>Number</th> <th>Description</th> <th>Opened</th> <th>Closed</th> <th>Amount</th> </tr> </thead> <tbody> <tr> <td> </td> <td> </td> <td> </td> <td> </td> <td> </td> </tr> </tbody> </table>					Number	Description	Opened	Closed	Amount																																																																																																											
Number	Description	Opened	Closed	Amount																																																																																																																					
<b>Exemptions</b> <table border="1"> <thead> <tr> <th>Code</th> <th>Type</th> <th>Active</th> <th>Maximum</th> <th>Exemption</th> </tr> </thead> <tbody> <tr> <td> </td> <td> </td> <td> </td> <td> </td> <td> </td> </tr> </tbody> </table>					Code	Type	Active	Maximum	Exemption						<b>Sale History</b> <table border="1"> <thead> <tr> <th>Bk/Pg</th> <th>Grantor</th> <th>Date</th> <th>Price</th> <th>Code</th> </tr> </thead> <tbody> <tr> <td>2231/880</td> <td>HTW INC &amp;</td> <td>03/14/2012</td> <td>197,000</td> <td>YES</td> </tr> <tr> <td>1553/84</td> <td>HTW INC</td> <td>10/22/2003</td> <td>0</td> <td>4</td> </tr> <tr> <td>880/17</td> <td> </td> <td>04/15/1992</td> <td>98,000</td> <td>No</td> </tr> </tbody> </table>					Bk/Pg	Grantor	Date	Price	Code	2231/880	HTW INC &	03/14/2012	197,000	YES	1553/84	HTW INC	10/22/2003	0	4	880/17		04/15/1992	98,000	No																																																																																		
Code	Type	Active	Maximum	Exemption																																																																																																																					
Bk/Pg	Grantor	Date	Price	Code																																																																																																																					
2231/880	HTW INC &	03/14/2012	197,000	YES																																																																																																																					
1553/84	HTW INC	10/22/2003	0	4																																																																																																																					
880/17		04/15/1992	98,000	No																																																																																																																					
<b>Parcel Valuation</b> <table border="1"> <thead> <tr> <th>Source</th> <th>REAL</th> <th>Fair Cash</th> <th>Capped</th> <th>Asmnt Level</th> <th>Assessed</th> <th>Levy Rate</th> <th>92.430</th> <th>Current Tax</th> </tr> </thead> <tbody> <tr> <td>Remove Cap</td> <td>2013</td> <td>Land Value 108,000</td> <td>108,000</td> <td>11%</td> <td>11,880</td> <td>Assessed</td> <td>30,360</td> <td>2,806.17</td> </tr> <tr> <td>Year Frozen</td> <td>0</td> <td>Improvements 412,680</td> <td>167,993</td> <td> </td> <td>18,480</td> <td>Penalty</td> <td>0</td> <td> </td> </tr> <tr> <td>Uncapped Value</td> <td>0</td> <td>Mobile Home 0</td> <td>0</td> <td> </td> <td>0</td> <td>Exemption</td> <td>0</td> <td>0.00</td> </tr> <tr> <td>TIF Project ID</td> <td>0</td> <td>Total Value 520,680</td> <td>275,993</td> <td> </td> <td>30,360</td> <td>Total Taxable</td> <td>30,360</td> <td>2,806.00</td> </tr> </tbody> </table>										Source	REAL	Fair Cash	Capped	Asmnt Level	Assessed	Levy Rate	92.430	Current Tax	Remove Cap	2013	Land Value 108,000	108,000	11%	11,880	Assessed	30,360	2,806.17	Year Frozen	0	Improvements 412,680	167,993		18,480	Penalty	0		Uncapped Value	0	Mobile Home 0	0		0	Exemption	0	0.00	TIF Project ID	0	Total Value 520,680	275,993		30,360	Total Taxable	30,360	2,806.00																																																																			
Source	REAL	Fair Cash	Capped	Asmnt Level	Assessed	Levy Rate	92.430	Current Tax																																																																																																																	
Remove Cap	2013	Land Value 108,000	108,000	11%	11,880	Assessed	30,360	2,806.17																																																																																																																	
Year Frozen	0	Improvements 412,680	167,993		18,480	Penalty	0																																																																																																																		
Uncapped Value	0	Mobile Home 0	0		0	Exemption	0	0.00																																																																																																																	
TIF Project ID	0	Total Value 520,680	275,993		30,360	Total Taxable	30,360	2,806.00																																																																																																																	
<b>Assessment History</b> <table border="1"> <thead> <tr> <th>Tax Year</th> <th>Statement Number</th> <th>Billed Owner</th> <th>Tax Area</th> <th>Total Value</th> <th>Exemptions</th> <th>Taxable Value</th> <th>Billed Tax</th> </tr> </thead> <tbody> <tr><td>2025</td><td>2025-660003016</td><td>RAMSEY, TIMOTHY &amp;</td><td>17</td><td>510,917</td><td>0</td><td>28,914</td><td>2,673.00</td></tr> <tr><td>2024</td><td>2024-660003016</td><td>RAMSEY, TIMOTHY &amp;</td><td>17</td><td>250,335</td><td>0</td><td>27,537</td><td>2,545.00</td></tr> <tr><td>2023</td><td>2023-660003016</td><td>RAMSEY, TIMOTHY &amp;</td><td>17</td><td>361,739</td><td>0</td><td>30,531</td><td>2,797.00</td></tr> <tr><td>2022</td><td>2022-660003016</td><td>RAMSEY, TIMOTHY &amp;</td><td>17</td><td>361,624</td><td>0</td><td>29,077</td><td>2,692.00</td></tr> <tr><td>2021</td><td>2021-660003016</td><td>RAMSEY, TIMOTHY &amp;</td><td>17</td><td>364,457</td><td>0</td><td>27,692</td><td>2,445.00</td></tr> <tr><td>2020</td><td>2020-660003016</td><td>RAMSEY, TIMOTHY &amp;</td><td>17</td><td>364,457</td><td>0</td><td>26,374</td><td>2,415.00</td></tr> <tr><td>2019</td><td>2019-660003016</td><td>RAMSEY, TIMOTHY &amp;</td><td>17</td><td>378,354</td><td>0</td><td>25,118</td><td>2,326.00</td></tr> <tr><td>2018</td><td>2018-660003016</td><td>RAMSEY, TIMOTHY G &amp;</td><td>17</td><td>355,472</td><td>0</td><td>23,922</td><td>2,210.00</td></tr> <tr><td>2017</td><td>2017-660003016</td><td>RAMSEY, TIMOTHY G &amp;</td><td>17</td><td>355,472</td><td>0</td><td>22,783</td><td>2,092.00</td></tr> <tr><td>2016</td><td>2016-660003016</td><td>RAMSEY, TIMOTHY G &amp;</td><td>17</td><td>197,254</td><td>0</td><td>21,698</td><td>2,037.00</td></tr> <tr><td>2015</td><td>2015-660003016</td><td>RAMSEY, TIMOTHY G &amp;</td><td>17</td><td>197,254</td><td>0</td><td>21,698</td><td>1,957.00</td></tr> <tr><td>2014</td><td>2014-660003016</td><td>RAMSEY, TIMOTHY G &amp;</td><td>17</td><td>197,254</td><td>0</td><td>21,698</td><td>2,012.00</td></tr> <tr><td>2013</td><td>2013-660003016</td><td>RAMSEY, TIMOTHY G &amp;</td><td>17</td><td>197,542</td><td>0</td><td>21,730</td><td>1,988.00</td></tr> </tbody> </table>										Tax Year	Statement Number	Billed Owner	Tax Area	Total Value	Exemptions	Taxable Value	Billed Tax	2025	2025-660003016	RAMSEY, TIMOTHY &	17	510,917	0	28,914	2,673.00	2024	2024-660003016	RAMSEY, TIMOTHY &	17	250,335	0	27,537	2,545.00	2023	2023-660003016	RAMSEY, TIMOTHY &	17	361,739	0	30,531	2,797.00	2022	2022-660003016	RAMSEY, TIMOTHY &	17	361,624	0	29,077	2,692.00	2021	2021-660003016	RAMSEY, TIMOTHY &	17	364,457	0	27,692	2,445.00	2020	2020-660003016	RAMSEY, TIMOTHY &	17	364,457	0	26,374	2,415.00	2019	2019-660003016	RAMSEY, TIMOTHY &	17	378,354	0	25,118	2,326.00	2018	2018-660003016	RAMSEY, TIMOTHY G &	17	355,472	0	23,922	2,210.00	2017	2017-660003016	RAMSEY, TIMOTHY G &	17	355,472	0	22,783	2,092.00	2016	2016-660003016	RAMSEY, TIMOTHY G &	17	197,254	0	21,698	2,037.00	2015	2015-660003016	RAMSEY, TIMOTHY G &	17	197,254	0	21,698	1,957.00	2014	2014-660003016	RAMSEY, TIMOTHY G &	17	197,254	0	21,698	2,012.00	2013	2013-660003016	RAMSEY, TIMOTHY G &	17	197,542	0	21,730	1,988.00
Tax Year	Statement Number	Billed Owner	Tax Area	Total Value	Exemptions	Taxable Value	Billed Tax																																																																																																																		
2025	2025-660003016	RAMSEY, TIMOTHY &	17	510,917	0	28,914	2,673.00																																																																																																																		
2024	2024-660003016	RAMSEY, TIMOTHY &	17	250,335	0	27,537	2,545.00																																																																																																																		
2023	2023-660003016	RAMSEY, TIMOTHY &	17	361,739	0	30,531	2,797.00																																																																																																																		
2022	2022-660003016	RAMSEY, TIMOTHY &	17	361,624	0	29,077	2,692.00																																																																																																																		
2021	2021-660003016	RAMSEY, TIMOTHY &	17	364,457	0	27,692	2,445.00																																																																																																																		
2020	2020-660003016	RAMSEY, TIMOTHY &	17	364,457	0	26,374	2,415.00																																																																																																																		
2019	2019-660003016	RAMSEY, TIMOTHY &	17	378,354	0	25,118	2,326.00																																																																																																																		
2018	2018-660003016	RAMSEY, TIMOTHY G &	17	355,472	0	23,922	2,210.00																																																																																																																		
2017	2017-660003016	RAMSEY, TIMOTHY G &	17	355,472	0	22,783	2,092.00																																																																																																																		
2016	2016-660003016	RAMSEY, TIMOTHY G &	17	197,254	0	21,698	2,037.00																																																																																																																		
2015	2015-660003016	RAMSEY, TIMOTHY G &	17	197,254	0	21,698	1,957.00																																																																																																																		
2014	2014-660003016	RAMSEY, TIMOTHY G &	17	197,254	0	21,698	2,012.00																																																																																																																		
2013	2013-660003016	RAMSEY, TIMOTHY G &	17	197,542	0	21,730	1,988.00																																																																																																																		



# Rogers

## Assessment Property Record Card for Tax Year 2026

Data provided by LISA DELOZIER County Assessor

Date 04/18/2026  
 Time 06:07:41  
 Page 2

Lot Data		Primary Image	
Lot Size	x		
Lot Count			
Units Buildable			
Non-Ag Acres			
Topography			
Street Access			
Utilities			
Amenities	0		
	0		
Value Model	1835 COMM		
Value Method	Square-Foot		
Base Lot Value	15,147.00 x 1.25 =	18,934	
Factor Value	0		
Adjustments	570.4%		
Lot Value	108,000		
Cost Approach		Image Information	
Manual Date	01/2025	Image ID	1024666
Total Building Area	4,220	Image Date	5/23/2023
Total Base Value	654,438	Name	IMG_0044.JPG
Modifier Value		Description	REVAL 2024
Misc Improvements			
Replacement Cost New	654,438		
Phys/Func Depreciation Loss	()		
RCN Less Phys/Func	399,207		
Economic Depreciation			
RCNLD (All Sources)	399,207		
Depreciated Improvements			
Outbuilding Value	13,473		
Total Improvement Value	412,680		
Land Value	108,000		
Cost Approach Value	520,680	123.38/SqFt	
Income Approach		Value Reconciliation	
Potential Gross Income (PGI)		Selected Valuation Method	Cost Approach
Vacancy & Collection Loss		Total Improvement Value	13,473
Miscellaneous Income		Land Value	108,000
Effective Gross Income (EGI)		Total Appraised Value	520,680 123.38/SqFt
Total Expenses			
Net Operating Income (NOI)			
Income Capitalization Rate			
Indicated Value	0.00		



# Rogers

## Assessment Property Record Card for Tax Year 2026

Data provided by LISA DELOZIER County Assessor

Date 04/18/2026  
Time 06:07:41  
Page 3

Sketch Image

660003016

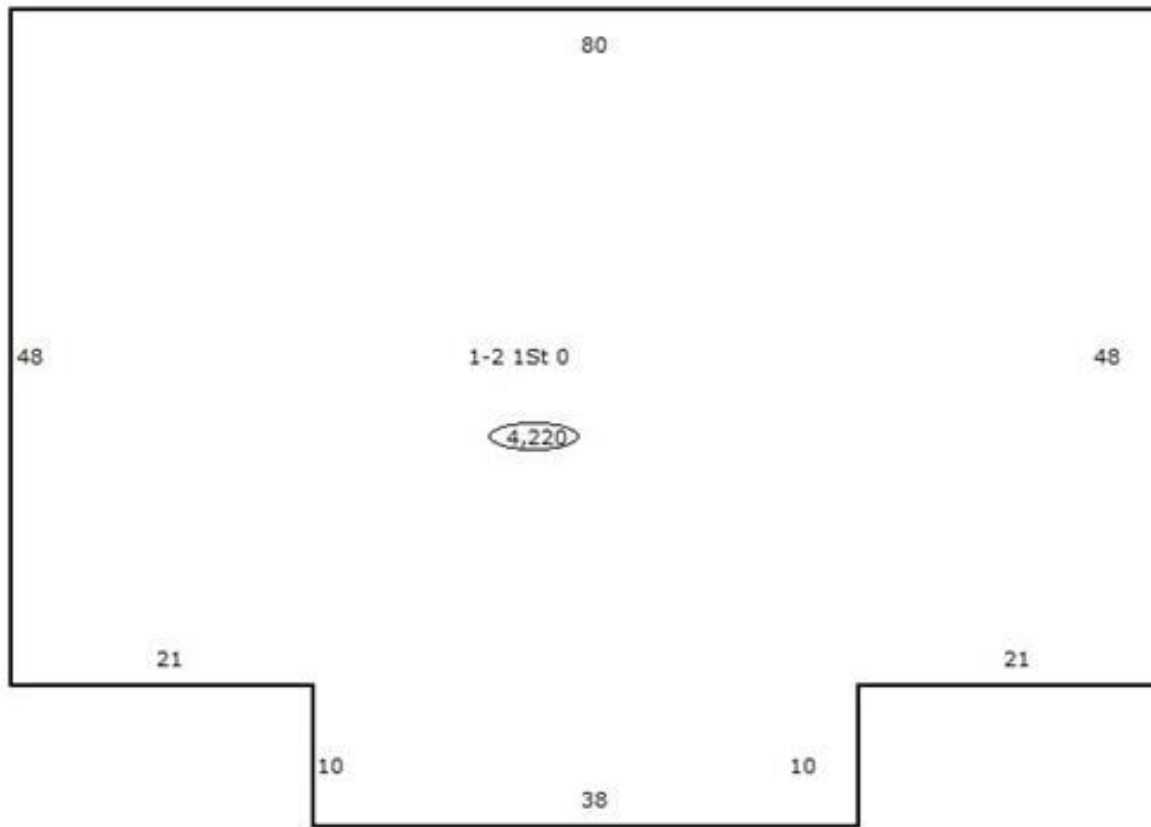

### Sketch Vector Information

Sequence	Code	Type	Built Over	Scale	Section Label	Base Area	Multiplier	Total Area
1	C	341		13	1-2 1St 0	4,220	1.000	4,220
<b>Total Building Area</b>						4,220		4,220



# Rogers

## Assessment Property Record Card for Tax Year 2026

Data provided by LISA DELOZIER County Assessor

Date 04/18/2026  
Time 06:07:41  
Page 4

Account 660003016  
Parcel ID 000000-00-0-10360-001-0005  
Cadastral ID 04-21-16-00060

Tax Area Code 17  
Property Class UCP  
Owners Name RAMSEY, TIMOTHY &

### Building Data

Building ID 623  
Building Sequence 1  
Occupancy 1 341 Medical Office 100%  
Occupancy 2  
Occupancy 3  
Total Floor Area 4,220  
Average Perimeter 276  
Number Of Storys 1.00  
Average Wall Ht 8.00  
Year Built 1975  
Effective Age 20  
Construction Class 2 - Heavier Wood or Steel Stud Frame  
Quality 3 - Average  
Condition 4 - Good  
Exterior Wall 82 - Stud Brick Veneer  
Heating/Cooling 7 - Package Unit  
Roof Type  
Roof Cover  
  
Basement Area  
Basement Levels  
Basement Finish  
Finish Code - 1  
Finish Area - 1  
Finish Code - 2  
Finish Area - 2

### Building Image



### Image Information

Image Name IMG\_0044.JPG  
Image Date 5/23/2023  
Image Name IMG\_0044.JPG  
Description REVAL 2024

### Cost Calculations

Appraisal Zone 1  
Zone Description  
Base Cost 105.68  
Wall Cost 30.24  
HVAC Cost 19.16  
Basement Cost 0.00  
Total Base Cost 155.08  
Total Area 4,220  
Base RCN 654,438  
Misc Impr Value

Manual Date 01/2025  
Base Year 2026  
Modifier Value  
Total Replacement Cost 654,438  
Physical Depreciation 39%  
Functional Depreciation  
Total Depreciation 39% (255,231)  
Total RCNLD 399,207  
Lump Sums  
Total Building Value 399,207 \$ 94.60 Per SqFt



# Rogers

## Assessment Property Record Card for Tax Year 2026

Data provided by LISA DELOZIER County Assessor

Date 04/18/2026

Time 06:07:41

Page 5

660003016

### Outbuildings/Site Improvements

Building Image	Code	Description	Dimensions	Floor	Roofing	Total Units
	PAVA	PAVING - ASPHALT	0x0x0			7,820
	<b>Qual</b>	<b>Cond</b>	<b>Year</b>	<b>Eff Age</b>		
<b>Valuation Summary</b>		<b>Modifier Total</b>	<b>RCN</b>	<b>Depr (% Phys/ % Func)</b>		<b>RCNLD</b>
Base Cost (2.81 x 7,820)			21,974	16,481		5,493
FLV		SLAB PORCH COVERED	38x16x0			12,920
<b>Qual</b>		<b>Cond</b>	<b>Year</b>	<b>Eff Age</b>		
<b>Valuation Summary</b>		<b>Modifier Total</b>	<b>RCN</b>	<b>Depr (% Phys/ % Func)</b>		<b>RCNLD</b>
Base Cost (1.00 x 12,920)			12,920	6,460		6,460
FLV		SLAB PORCH COVERED	38x16x0			3,040
<b>Qual</b>		<b>Cond</b>	<b>Year</b>	<b>Eff Age</b>		
<b>Valuation Summary</b>		<b>Modifier Total</b>	<b>RCN</b>	<b>Depr (% Phys/ % Func)</b>		<b>RCNLD</b>
Base Cost (1.00 x 3,040)			3,040	1,520		1,520
<b>Total Site Improvement Value</b>						<b>13,473</b>