



Rogers

Assessment Property Record Card for Tax Year 2026

Data provided by LISA DELOZIER County Assessor

Date 04/18/2026
 Time 07:29:11
 Page 1

Assessment Data					Primary Image																																																	
Account 660003022 Parcel ID 000000-00-0-10365-001-0005 Cadastral ID 04-21-16-00120 Property Type REAL - Real Property Property Class URP VI Area 1 Tax Area 17 - CLAREMORE OT Name ID 349537 RAY, CAMERON TODD 524 N ROSS ST SAPULPA OK 74066-0000 Parcel Location Situs 00326 E 15TH ST N Subdivision PATTERSON HEIGHTS Lot/Block 0005 / 0001 Parcel Size 1 - Lots Sec/Twn/Rng 4 / 21 / 16 / 5 Neighborhood 1172 - R-V01-SW CLAREMORE School District S001 - CLAREMORE SCHOOLS					<p>\\tsclient\T\TOMMY DUNLAP\New folder (163)\IMG_0020.JPG 4/3/2023</p>																																																	
Legal Description Lat/Long: 36.32370036 -95.59793311																																																						
Building Permits					<table border="1"> <thead> <tr> <th>Number</th> <th>Description</th> <th>Opened</th> <th>Closed</th> <th>Amount</th> </tr> </thead> <tbody> <tr> <td> </td> <td> </td> <td> </td> <td> </td> <td> </td> </tr> </tbody> </table>					Number	Description	Opened	Closed	Amount																																								
Number	Description	Opened	Closed	Amount																																																		
Exemptions					Sale History																																																	
Code	Type	Active	Maximum	Exemption	Bk/Pg	Grantor	Date	Price	Code																																													
					/	HEIDLAGE, ROBERT F JR &	02/23/2026	230,000	YES																																													
					/	HEIDLAGE, PATSY	02/05/2025	0	4																																													
					2328/528	MCCOY, WALTER D & MONTA L TRUS	05/21/2013	122,000	YES																																													
					887/845	WILLIAMS, T S &	07/24/1992	62,000	Yes																																													
Parcel Valuation					<table border="1"> <thead> <tr> <th>Source</th> <th>REAL</th> <th>Fair Cash</th> <th>Capped</th> <th>Asmnt Level</th> <th>Assessed</th> <th>Levy Rate</th> <th>92.430</th> <th>Current Tax</th> </tr> </thead> <tbody> <tr> <td>Remove Cap</td> <td>2027</td> <td>Land Value 64,617</td> <td>48,312</td> <td>11%</td> <td>5,314</td> <td>Assessed</td> <td>17,915</td> <td>1,655.88</td> </tr> <tr> <td>Year Frozen</td> <td>0</td> <td>Improvements 114,553</td> <td>114,553</td> <td></td> <td>12,601</td> <td>Penalty</td> <td>0</td> <td></td> </tr> <tr> <td>Uncapped Value</td> <td>0</td> <td>Mobile Home 0</td> <td>0</td> <td></td> <td>0</td> <td>Exemption</td> <td>0</td> <td>0.00</td> </tr> <tr> <td>TIF Project ID</td> <td>0</td> <td>Total Value 179,170</td> <td>162,865</td> <td></td> <td>17,915</td> <td>Total Taxable</td> <td>17,915</td> <td>1,656.00</td> </tr> </tbody> </table>					Source	REAL	Fair Cash	Capped	Asmnt Level	Assessed	Levy Rate	92.430	Current Tax	Remove Cap	2027	Land Value 64,617	48,312	11%	5,314	Assessed	17,915	1,655.88	Year Frozen	0	Improvements 114,553	114,553		12,601	Penalty	0		Uncapped Value	0	Mobile Home 0	0		0	Exemption	0	0.00	TIF Project ID	0	Total Value 179,170	162,865		17,915	Total Taxable	17,915	1,656.00
Source	REAL	Fair Cash	Capped	Asmnt Level	Assessed	Levy Rate	92.430	Current Tax																																														
Remove Cap	2027	Land Value 64,617	48,312	11%	5,314	Assessed	17,915	1,655.88																																														
Year Frozen	0	Improvements 114,553	114,553		12,601	Penalty	0																																															
Uncapped Value	0	Mobile Home 0	0		0	Exemption	0	0.00																																														
TIF Project ID	0	Total Value 179,170	162,865		17,915	Total Taxable	17,915	1,656.00																																														
Assessment History																																																						
Tax Year	Statement Number	Billed Owner	Tax Area	Total Value	Exemptions	Taxable Value	Billed Tax																																															
2025	2025-660003022	HEIDLAGE, ROBERT F JR &	17	178,194	0	17,062	1,577.00																																															
2024	2024-660003022	HEIDLAGE, PATSY	17	188,407	0	16,249	1,502.00																																															
2023	2023-660003022	HEIDLAGE, PATSY	17	151,091	0	15,476	1,418.00																																															
2022	2022-660003022	HEIDLAGE, PATSY	17	133,991	0	14,739	1,364.00																																															
2021	2021-660003022	HEIDLAGE, PATSY	17	137,077	0	15,078	1,331.00																																															
2020	2020-660003022	HEIDLAGE, PATSY	17	135,052	0	14,856	1,360.00																																															
2019	2019-660003022	HEIDLAGE, PATSY	17	133,594	0	14,695	1,361.00																																															
2018	2018-660003022	HEIDLAGE, PATSY	17	140,884	0	15,497	1,432.00																																															
2017	2017-660003022	HEIDLAGE, PATSY	17	139,790	0	15,219	1,398.00																																															
2016	2016-660003022	HEIDLAGE, PATSY	17	136,513	0	14,494	1,360.00																																															
2015	2015-660003022	HEIDLAGE, PATSY	17	125,494	0	13,804	1,245.00																																															
2014	2014-660003022	HEIDLAGE WILLIAMS, VICKIE	17	126,359	0	13,899	1,289.00																																															
2013	2013-660003022	HEIDLAGE, PATSY J	17	145,056	0	10,832	991.00																																															



Rogers

Assessment Property Record Card for Tax Year 2026

Data provided by LISA DELOZIER County Assessor

Date 04/18/2026
Time 07:29:11
Page 2

Lot Data	Square-Foot - NBHD 1172 #1	Primary Image
Lot Size		
Lot Count	1	
Units Buildable	1	
Non-Ag Acres	0.288	
Topography		
Street Access		
Utilities		
Amenities	LAND QUALITY	
	0	
	0	
Method	Square-Foot	
Base Lot Value	12,547.00 x 5.15 = 64,617	
Factor Value		
Adjustments	1.0000	
Lot Value	64,617	

Residential Data	
Type	1 Single Family Residence
Condition	3 - Average
Quality	2.5 - Fair
Architecture	
Style	100% One Story
Exterior Wall	100% Veneer, Masonry
Base/Total Area	1,763 / 1,763
Style	100% One Story
HVAC	100% Warmed & Cooled Air
Roof Cover	1 Composition Shingle
Area on Slab	0
Fixture/RghIn	8 /
Bed/F/H Bath	3 / 2.0 /
Basement Area	
Garage Type	550 Attached Garage - Unfinished
Remodel	
Year/Eff Age	1961 / 49



\\tsclient\T\TOMMY DUNLAP\New folder (163)\IMG_0020.JPG 4/3/2023

GRM Approach	
GRM Code	
Gross Rent	0.00
Indicated Value	

Multiple Regression			
MRA Code	1	Test	
Adusted R	0.8445		
Indicated Value	167,552	95.04	Per SqFt

Direct Comparables			
Selection Model	A	Adam Test	
Adjustment Model	1	2022 Residential	
Comparables	8		
Indicated Value	220,030		Per SqFt

Cost Approach				Manual : 01/2025			
Base Cost	103.37	Total Misc Impr	+	22,931			
Roofing Adj	+ 4.37	Garage Cost	+	14,784			
Subfloor Adj	+ 1.15	Total RCN	=	260,347			
Heat/Cool Adj	+ 11.47	Depreciation (56%)	-	145,794			
Plumbing Adj	+ 5.92	Lump Sums	+	0			
Basement Adj	+ 0.00	RCNLD	=	114,553			
Adj Base Cost	= 126.28	Lot Value	+	64,617			
Total Area	x 1,763	Indicated Value	=	179,170			
Adjusted Cost	= 222,632	Value Per SqFt		101.63			

Value Reconciliation			
Selected Approach	Cost Approach		
Improvements	114,553		
Lot Value	64,617		
Indicated Value	179,170	101.63	Per SqFt
Agland Value			
Site Improvements			
Total Value	179,170	101.63	Total Value Per SqFt

Miscellaneous Improvements								
Code	Description	Sketch ID	Size	Year	Units	Unit Cost	Depr	Value
EPSW	ENCLOSED PORCH - SOLID WALL	7614	186		186	62.10		11,551
CPDT	CARPORT - DETACHED	7616	22x20		440	10.74		4,726
PRCH	SLAB PORCH - COVERED	7617	11x7		77	24.03		1,850
PRCH	SLAB PORCH - COVERED	7618	17x12		204	23.55		4,804



Rogers
Assessment Property Record Card for Tax Year 2026
 Data provided by LISA DELOZIER County Assessor

Date 04/18/2026
 Time 07:29:11
 Page 3

Sketch Image

660003022

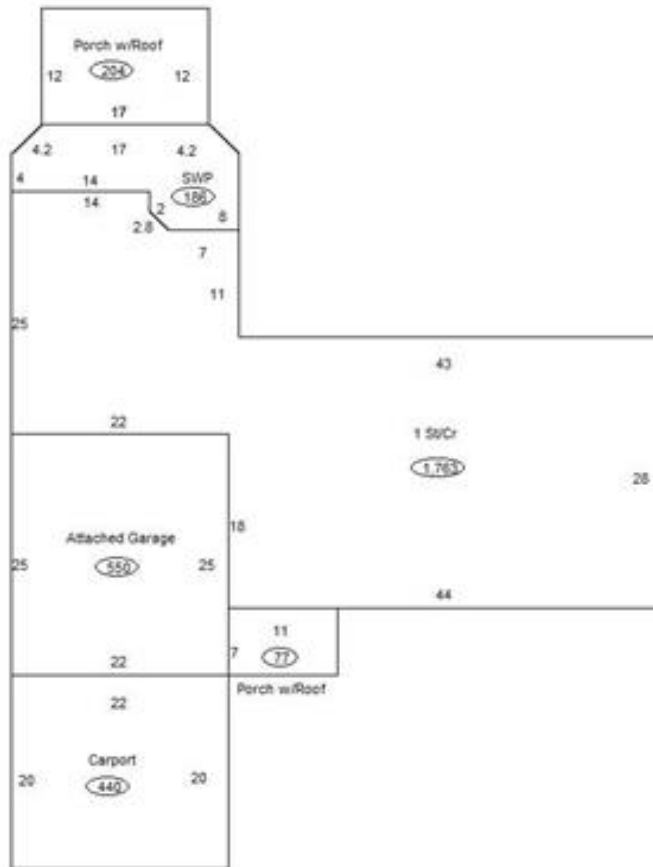

Sketch Vector Information

Sequence	Code	Type	Built Over	Scale	Section Label	Base Area	Multiplier	Total Area
1	R	1	Crawl	13	1 St/Cr	1,763	1.000	1,763
2	M	EPSW		13	EPSW	186	1.000	186
3	G	1		13	Attached Garage	550	1.000	550
4	M	CPDT		13	Carport	440	1.000	440
5	M	PRCH		13	SLBC	77	1.000	77
6	M	PRCH		13	SLBC	204	1.000	204
Total Building Area						1,763		1,763



Rogers

Assessment Property Record Card for Tax Year 2026

Data provided by LISA DELOZIER County Assessor

Date 04/18/2026
Time 07:29:11
Page 4

660003022

Outbuildings/Site Improvements

Building Image	Code	Description	Dimensions	Floor	Roofing	Total Units
	STF	STG FAIR	0x0x0			
	Qual	2	Cond	Year	Eff Age	
Valuation Summary			Modifier Total	RCN	Depr (0% Phys/ % Func)	RCNLD
		Base Cost (4.68 x)				