



Rogers

Assessment Property Record Card for Tax Year 2026

Data provided by LISA DELOZIER County Assessor

Date 04/17/2026
Time 17:32:19
Page 1

Assessment Data					Primary Image																																																																																																																				
Account 660003084 Parcel ID 21N16E-04-1-00000-000-0000 Cadastral ID 04-21-16-02300 Property Type REAL - Real Property Property Class UC VI Area 1 Tax Area 17 - CLAREMORE OT Name ID 316118 AXH REAL ESTATE LLC 401 E LOWRY RD CLAREMORE OK 74017-0000 Parcel Location Situs 00401 E LOWRY RD Subdivision Lot/Block / Parcel Size 10.72 - Acres Sec/Twn/Rng 4 / 21 / 16 / 1 Neighborhood 90000 - COMMERCIAL School District S001 - CLAREMORE SCHOOLS																																																																																																																									
Legal Description Lat/Long: 36.33510186 -95.60487897																																																																																																																									
TR LOT 2: ALL TH PT N 19.65 AC LOT 2 LYING N & W WLY ROW/L RR & ALL TH PT SW 10 AC LOT 2, LYING N & W WLY ROW/L RR, LESS TR IN SW 10 AC LOT 2, BEG: SW/C SW 10 AC LOT 2, N 0-12-30 E ALG W/L 370', E 175.85' TO PT 50' W WLY ROW/L RR, S 98.48 TO PT INTER WITH WLY ROW/L RR S 26-55 W ALG SD RR ROW/L 304. 63' TO S/L					Building Permits																																																																																																																				
					<table border="1"> <thead> <tr> <th>Number</th> <th>Description</th> <th>Opened</th> <th>Closed</th> <th>Amount</th> </tr> </thead> <tbody> <tr> <td>3928</td> <td>COMM R9-1050 SF OFFICE EXPANSIO</td> <td>04/2008</td> <td>03/2011</td> <td></td> </tr> <tr> <td>3669</td> <td>R7-(COMM) PLANT EXPANSION</td> <td>05/2006</td> <td>03/2011</td> <td></td> </tr> <tr> <td>3596</td> <td>R7-(COMM) 1800 SQ FT/1 STORY IMP</td> <td>11/2005</td> <td>03/2011</td> <td></td> </tr> </tbody> </table>					Number	Description	Opened	Closed	Amount	3928	COMM R9-1050 SF OFFICE EXPANSIO	04/2008	03/2011		3669	R7-(COMM) PLANT EXPANSION	05/2006	03/2011		3596	R7-(COMM) 1800 SQ FT/1 STORY IMP	11/2005	03/2011																																																																																													
Number	Description	Opened	Closed	Amount																																																																																																																					
3928	COMM R9-1050 SF OFFICE EXPANSIO	04/2008	03/2011																																																																																																																						
3669	R7-(COMM) PLANT EXPANSION	05/2006	03/2011																																																																																																																						
3596	R7-(COMM) 1800 SQ FT/1 STORY IMP	11/2005	03/2011																																																																																																																						
Exemptions					Sale History																																																																																																																				
<table border="1"> <thead> <tr> <th>Code</th> <th>Type</th> <th>Active</th> <th>Maximum</th> <th>Exemption</th> </tr> </thead> <tbody> <tr> <td></td> <td></td> <td></td> <td></td> <td></td> </tr> </tbody> </table>					Code	Type	Active	Maximum	Exemption						<table border="1"> <thead> <tr> <th>Bk/Pg</th> <th>Grantor</th> <th>Date</th> <th>Price</th> <th>Code</th> </tr> </thead> <tbody> <tr> <td>/</td> <td>AXH PROPERTIES LLC</td> <td>08/03/2020</td> <td>7,803,000</td> <td>5</td> </tr> <tr> <td>1738/46</td> <td>AXH AIR-COOLERS LLC</td> <td>12/21/2005</td> <td>0</td> <td>5</td> </tr> <tr> <td>1658/523</td> <td>VALTIMET INC</td> <td>02/24/2005</td> <td>1,450,000</td> <td>YES</td> </tr> <tr> <td>1434/706</td> <td>NII REAL ESTATE HOLDING-CORP</td> <td>12/20/2002</td> <td>0</td> <td>16</td> </tr> <tr> <td>1130/462</td> <td>PREMIERE PIPE & TUBE GROUP-INC</td> <td>05/21/1998</td> <td>1,800,000</td> <td>05</td> </tr> <tr> <td>1130/460</td> <td>ALLEGHENY LUDLUM CORP</td> <td>02/28/1998</td> <td>1,800,000</td> <td>05</td> </tr> </tbody> </table>					Bk/Pg	Grantor	Date	Price	Code	/	AXH PROPERTIES LLC	08/03/2020	7,803,000	5	1738/46	AXH AIR-COOLERS LLC	12/21/2005	0	5	1658/523	VALTIMET INC	02/24/2005	1,450,000	YES	1434/706	NII REAL ESTATE HOLDING-CORP	12/20/2002	0	16	1130/462	PREMIERE PIPE & TUBE GROUP-INC	05/21/1998	1,800,000	05	1130/460	ALLEGHENY LUDLUM CORP	02/28/1998	1,800,000	05																																																																			
Code	Type	Active	Maximum	Exemption																																																																																																																					
Bk/Pg	Grantor	Date	Price	Code																																																																																																																					
/	AXH PROPERTIES LLC	08/03/2020	7,803,000	5																																																																																																																					
1738/46	AXH AIR-COOLERS LLC	12/21/2005	0	5																																																																																																																					
1658/523	VALTIMET INC	02/24/2005	1,450,000	YES																																																																																																																					
1434/706	NII REAL ESTATE HOLDING-CORP	12/20/2002	0	16																																																																																																																					
1130/462	PREMIERE PIPE & TUBE GROUP-INC	05/21/1998	1,800,000	05																																																																																																																					
1130/460	ALLEGHENY LUDLUM CORP	02/28/1998	1,800,000	05																																																																																																																					
Parcel Valuation																																																																																																																									
<table border="1"> <thead> <tr> <th>Source</th> <th>REAL</th> <th>Fair Cash</th> <th>Capped</th> <th>Asmnt Level</th> <th>Assessed</th> <th>Levy Rate</th> <th>92.430</th> <th>Current Tax</th> </tr> </thead> <tbody> <tr> <td>Remove Cap</td> <td></td> <td>214,400</td> <td>214,400</td> <td>11%</td> <td>23,584</td> <td>Assessed</td> <td>856,991</td> <td>79,211.68</td> </tr> <tr> <td>Year Frozen</td> <td>0</td> <td>Improvements</td> <td>13,359,944</td> <td>7,576,424</td> <td>833,407</td> <td>Penalty</td> <td>0</td> <td></td> </tr> <tr> <td>Uncapped Value</td> <td>0</td> <td>Mobile Home</td> <td>0</td> <td>0</td> <td>0</td> <td>Exemption</td> <td>0</td> <td>0.00</td> </tr> <tr> <td>TIF Project ID</td> <td>0</td> <td>Total Value</td> <td>13,574,344</td> <td>7,790,824</td> <td>856,991</td> <td>Total Taxable</td> <td>856,991</td> <td>79,212.00</td> </tr> </tbody> </table>		Source	REAL	Fair Cash	Capped	Asmnt Level	Assessed	Levy Rate	92.430	Current Tax	Remove Cap		214,400	214,400	11%	23,584	Assessed	856,991	79,211.68	Year Frozen	0	Improvements	13,359,944	7,576,424	833,407	Penalty	0		Uncapped Value	0	Mobile Home	0	0	0	Exemption	0	0.00	TIF Project ID	0	Total Value	13,574,344	7,790,824	856,991	Total Taxable	856,991	79,212.00																																																																											
Source	REAL	Fair Cash	Capped	Asmnt Level	Assessed	Levy Rate	92.430	Current Tax																																																																																																																	
Remove Cap		214,400	214,400	11%	23,584	Assessed	856,991	79,211.68																																																																																																																	
Year Frozen	0	Improvements	13,359,944	7,576,424	833,407	Penalty	0																																																																																																																		
Uncapped Value	0	Mobile Home	0	0	0	Exemption	0	0.00																																																																																																																	
TIF Project ID	0	Total Value	13,574,344	7,790,824	856,991	Total Taxable	856,991	79,212.00																																																																																																																	
Assessment History																																																																																																																									
<table border="1"> <thead> <tr> <th>Tax Year</th> <th>Statement Number</th> <th>Billed Owner</th> <th>Tax Area</th> <th>Total Value</th> <th>Exemptions</th> <th>Taxable Value</th> <th>Billed Tax</th> </tr> </thead> <tbody> <tr><td>2025</td><td>2025-660003084</td><td>AXH REAL ESTATE LLC</td><td>17</td><td>13,987,926</td><td>0</td><td>816,182</td><td>75,440.00</td></tr> <tr><td>2024</td><td>2024-660003084</td><td>AXH REAL ESTATE LLC</td><td>17</td><td>7,066,508</td><td>0</td><td>777,316</td><td>71,840.00</td></tr> <tr><td>2023</td><td>2023-660003084</td><td>AXH REAL ESTATE LLC</td><td>17</td><td>12,987,951</td><td>0</td><td>1,099,859</td><td>100,747.00</td></tr> <tr><td>2022</td><td>2022-660003084</td><td>AXH REAL ESTATE LLC</td><td>17</td><td>12,935,265</td><td>0</td><td>1,047,484</td><td>96,966.00</td></tr> <tr><td>2021</td><td>2021-660003084</td><td>AXH REAL ESTATE LLC</td><td>17</td><td>10,610,243</td><td>0</td><td>997,604</td><td>88,088.00</td></tr> <tr><td>2020</td><td>2020-660003084</td><td>AXH REAL ESTATE LLC</td><td>17</td><td>10,610,243</td><td>0</td><td>950,099</td><td>87,001.00</td></tr> <tr><td>2019</td><td>2019-660003084</td><td>AXH PROPERTIES LLC</td><td>120</td><td>10,697,168</td><td>0</td><td>904,856</td><td>83,808.00</td></tr> <tr><td>2018</td><td>2018-660003084</td><td>AXH PROPERTIES LLC</td><td>120</td><td>9,958,476</td><td>0</td><td>861,768</td><td>79,627.00</td></tr> <tr><td>2017</td><td>2017-660003084</td><td>A X H PROPERTIES LLC</td><td>120</td><td>9,958,476</td><td>0</td><td>820,732</td><td>75,376.00</td></tr> <tr><td>2016</td><td>2016-660003084</td><td>A X H PROPERTIES LLC</td><td>17</td><td>5,215,480</td><td>0</td><td>477,034</td><td>44,774.00</td></tr> <tr><td>2015</td><td>2015-660003084</td><td>A X H PROPERTIES LLC</td><td>120</td><td>4,130,161</td><td>0</td><td>454,318</td><td>40,975.00</td></tr> <tr><td>2014</td><td>2014-660003084</td><td>A X H PROPERTIES LLC</td><td>17</td><td>3,933,862</td><td>0</td><td>432,725</td><td>40,127.00</td></tr> <tr><td>2013</td><td>2013-660003084</td><td>A X H PROPERTIES LLC</td><td>17</td><td>3,933,862</td><td>0</td><td>432,725</td><td>39,598.00</td></tr> </tbody> </table>										Tax Year	Statement Number	Billed Owner	Tax Area	Total Value	Exemptions	Taxable Value	Billed Tax	2025	2025-660003084	AXH REAL ESTATE LLC	17	13,987,926	0	816,182	75,440.00	2024	2024-660003084	AXH REAL ESTATE LLC	17	7,066,508	0	777,316	71,840.00	2023	2023-660003084	AXH REAL ESTATE LLC	17	12,987,951	0	1,099,859	100,747.00	2022	2022-660003084	AXH REAL ESTATE LLC	17	12,935,265	0	1,047,484	96,966.00	2021	2021-660003084	AXH REAL ESTATE LLC	17	10,610,243	0	997,604	88,088.00	2020	2020-660003084	AXH REAL ESTATE LLC	17	10,610,243	0	950,099	87,001.00	2019	2019-660003084	AXH PROPERTIES LLC	120	10,697,168	0	904,856	83,808.00	2018	2018-660003084	AXH PROPERTIES LLC	120	9,958,476	0	861,768	79,627.00	2017	2017-660003084	A X H PROPERTIES LLC	120	9,958,476	0	820,732	75,376.00	2016	2016-660003084	A X H PROPERTIES LLC	17	5,215,480	0	477,034	44,774.00	2015	2015-660003084	A X H PROPERTIES LLC	120	4,130,161	0	454,318	40,975.00	2014	2014-660003084	A X H PROPERTIES LLC	17	3,933,862	0	432,725	40,127.00	2013	2013-660003084	A X H PROPERTIES LLC	17	3,933,862	0	432,725	39,598.00
Tax Year	Statement Number	Billed Owner	Tax Area	Total Value	Exemptions	Taxable Value	Billed Tax																																																																																																																		
2025	2025-660003084	AXH REAL ESTATE LLC	17	13,987,926	0	816,182	75,440.00																																																																																																																		
2024	2024-660003084	AXH REAL ESTATE LLC	17	7,066,508	0	777,316	71,840.00																																																																																																																		
2023	2023-660003084	AXH REAL ESTATE LLC	17	12,987,951	0	1,099,859	100,747.00																																																																																																																		
2022	2022-660003084	AXH REAL ESTATE LLC	17	12,935,265	0	1,047,484	96,966.00																																																																																																																		
2021	2021-660003084	AXH REAL ESTATE LLC	17	10,610,243	0	997,604	88,088.00																																																																																																																		
2020	2020-660003084	AXH REAL ESTATE LLC	17	10,610,243	0	950,099	87,001.00																																																																																																																		
2019	2019-660003084	AXH PROPERTIES LLC	120	10,697,168	0	904,856	83,808.00																																																																																																																		
2018	2018-660003084	AXH PROPERTIES LLC	120	9,958,476	0	861,768	79,627.00																																																																																																																		
2017	2017-660003084	A X H PROPERTIES LLC	120	9,958,476	0	820,732	75,376.00																																																																																																																		
2016	2016-660003084	A X H PROPERTIES LLC	17	5,215,480	0	477,034	44,774.00																																																																																																																		
2015	2015-660003084	A X H PROPERTIES LLC	120	4,130,161	0	454,318	40,975.00																																																																																																																		
2014	2014-660003084	A X H PROPERTIES LLC	17	3,933,862	0	432,725	40,127.00																																																																																																																		
2013	2013-660003084	A X H PROPERTIES LLC	17	3,933,862	0	432,725	39,598.00																																																																																																																		



Rogers

Assessment Property Record Card for Tax Year 2026

Data provided by LISA DELOZIER County Assessor

Date 04/17/2026

Time 17:32:19

Page 3

Sketch Image

660003084

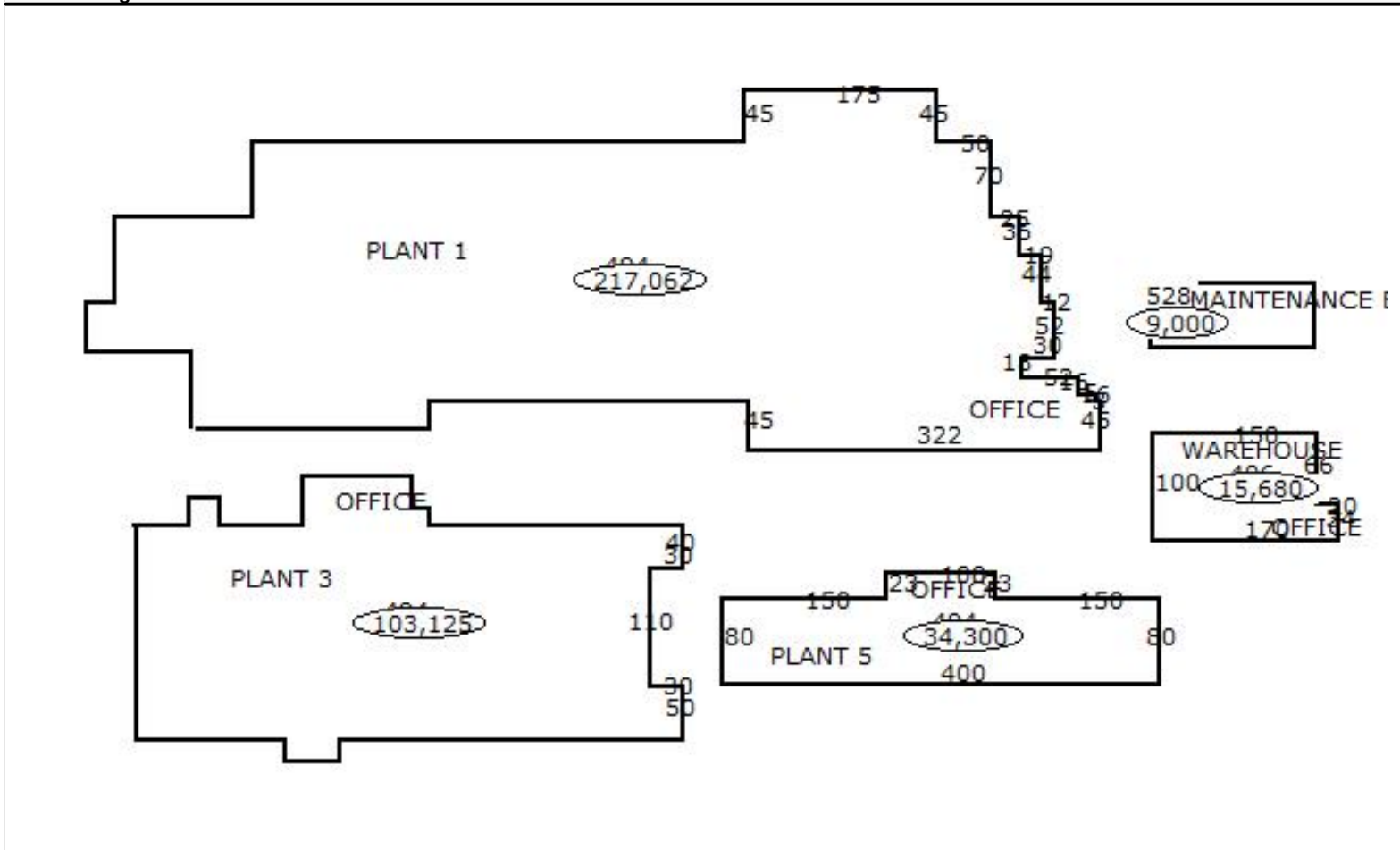

Sketch Vector Information

Sequence	Code	Type	Built Over	Scale	Section Label	Base Area	Multiplier	Total Area
1	C	494		200	494	217,062	1.000	217,062
2	C	528		200	528	9,000	1.000	9,000
3	N	0		200	PLANT 1		0.000	
4	N	0		200	MAINTENANCE BLDG		0.000	
5	C	494		200	494	103,125	1.000	103,125
6	N	0		200	PLANT 3		0.000	
7	C	494		200	494	34,300	1.000	34,300
8	N	0		200	PLANT 5		0.000	
9	C	406		200	406	15,680	1.000	15,680
10	N	0		200	WAREHOUSE		0.000	
11	N	0		200	OFFICE		0.000	
12	N	0		200	OFFICE		0.000	
13	N	0		200	OFFICE		0.000	
14	N	0		200	OFFICE		0.000	
Total Building Area						379,167		379,167



Rogers

Assessment Property Record Card for Tax Year 2026

Data provided by LISA DELOZIER County Assessor

Date 04/17/2026
Time 17:32:19
Page 4

Account 660003084
Parcel ID 21N16E-04-1-00000-000-0000
Cadastral ID 04-21-16-02300

Tax Area Code 17
Property Class UC
Owners Name AXH REAL ESTATE LLC

Building Data

Building ID 4081
Building Sequence 1
Occupancy 1 406 Storage Warehouse 100%
Occupancy 2
Occupancy 3
Total Floor Area 15,680
Average Perimeter 540
Number Of Storys 1.00
Average Wall Ht 31.00
Year Built 2015
Effective Age 6
Construction Class 7 - Pre-Engineered Steel Frame
Quality 3 - Average
Condition 3 - Average
Exterior Wall 82 - Stud Brick Veneer
Heating/Cooling
Roof Type Flat
Roof Cover
Basement Area
Basement Levels
Basement Finish
Finish Code - 1
Finish Area - 1
Finish Code - 2
Finish Area - 2

Building Image



Image Information

Image Name IMG_0001.JPG
Image Date 11/6/2023
Image Name IMG_0001.JPG
Description REVAL 2024

Cost Calculations

Appraisal Zone 1
Zone Description
Base Cost 48.44
Wall Cost 39.91
HVAC Cost 8.34
Basement Cost 0.00
Total Base Cost 96.69
Total Area 15,680
Base RCN 1,516,099
Misc Impr Value

Manual Date 01/2025
Base Year 2026
Modifier Value
Total Replacement Cost 1,516,099
Physical Depreciation 6%
Functional Depreciation 14%
Total Depreciation 19% (288,059)
Total RCNLD 1,228,040
Lump Sums
Total Building Value 1,228,040 \$ 78.32 Per SqFt

Building Modifiers

Code	Description	Units - 1	Units - 2	Units - 3	Modifier Value
611	Package Unit	Area/Percent	680		10,744
606	Radiant Space Heaters	Area/Percent	15000		119,971
Total Modifier Value					130,715



Rogers

Assessment Property Record Card for Tax Year 2026

Data provided by LISA DELOZIER County Assessor

Date 04/17/2026
Time 17:32:20
Page 5

Account 660003084
Parcel ID 21N16E-04-1-00000-000-0000
Cadastral ID 04-21-16-02300

Tax Area Code 17
Property Class UC
Owners Name AXH REAL ESTATE LLC

Building Data

Building ID 4080
Building Sequence 2
Occupancy 1 494 Industrials, Light Mftg. 100%
Occupancy 2
Occupancy 3
Total Floor Area 34,300
Average Perimeter 1,006
Number Of Storys 1.00
Average Wall Ht 31.00
Year Built 2015
Effective Age 6
Construction Class 7 - Pre-Engineered Steel Frame
Quality 3 - Average
Condition 3 - Average
Exterior Wall 82 - Stud Brick Veneer
Heating/Cooling
Roof Type
Roof Cover
Basement Area
Basement Levels
Basement Finish
Finish Code - 1
Finish Area - 1
Finish Code - 2
Finish Area - 2

Building Image



Image Information

Image Name IMG_0001.JPG
Image Date 11/6/2023
Image Name IMG_0001.JPG
Description REVAL 2024

Cost Calculations

Appraisal Zone 1
Zone Description
Base Cost 63.57
Wall Cost 33.99
HVAC Cost 10.21
Basement Cost 0.00
Total Base Cost 107.77
Total Area 34,300
Base RCN 3,696,511
Misc Impr Value

Manual Date 01/2025
Base Year 2026
Modifier Value
Total Replacement Cost 3,696,511
Physical Depreciation 8%
Functional Depreciation 35%
Total Depreciation 40% (1,478,604)
Total RCNLD 2,217,907
Lump Sums
Total Building Value 2,217,907 \$ 64.66 Per SqFt

Building Modifiers

Code	Description	Units - 1	Units - 2	Units - 3	Modifier Value
611	Package Unit	Area/Percent	2300		48,788
606	Radiant Space Heaters	Area/Percent	32000		301,446
Total Modifier Value					350,234



Rogers

Assessment Property Record Card for Tax Year 2026

Data provided by LISA DELOZIER County Assessor

Date 04/17/2026
Time 17:32:20
Page 6

Account 660003084
Parcel ID 21N16E-04-1-00000-000-0000
Cadastral ID 04-21-16-02300

Tax Area Code 17
Property Class UC
Owners Name AXH REAL ESTATE LLC

Building Data

Building ID 4079
Building Sequence 3
Occupancy 1 494 Industrials, Light Mftg. 100%
Occupancy 2
Occupancy 3
Total Floor Area 103,125
Average Perimeter 1,640
Number Of Storys 1.00
Average Wall Ht 28.00
Year Built 1973
Effective Age 27
Construction Class 7 - Pre-Engineered Steel Frame
Quality 3 - Average
Condition 3 - Average
Exterior Wall 88 - Stud Metal Siding
Heating/Cooling
Roof Type
Roof Cover Metal

Basement Area
Basement Levels
Basement Finish
Finish Code - 1
Finish Area - 1
Finish Code - 2
Finish Area - 2

Building Image

Image Information

Image Name
Image Date
Image Name
Description

Cost Calculations

Appraisal Zone 1
Zone Description
Base Cost 63.68
Wall Cost 9.12
HVAC Cost 9.79
Basement Cost 0.00
Total Base Cost 82.59
Total Area 103,125
Base RCN 8,517,094
Misc Impr Value

Manual Date 01/2025
Base Year 2026
Modifier Value
Total Replacement Cost 8,517,094
Physical Depreciation 61%
Functional Depreciation 30%
Total Depreciation 73% (6,217,479)
Total RCNLD 2,299,615
Lump Sums
Total Building Value 2,299,615 \$ 22.30 Per SqFt

Building Modifiers

Code	Description	Units - 1	Units - 2	Units - 3	Modifier Value
612	Warmed and Cooled Air	Area/Percent	4725		83,789
606	Radiant Space Heaters	Area/Percent	98400		925,805
Total Modifier Value					1,009,594



Rogers

Assessment Property Record Card for Tax Year 2026

Data provided by LISA DELOZIER County Assessor

Date 04/17/2026
Time 17:32:20
Page 7

Account 660003084
Parcel ID 21N16E-04-1-00000-000-0000
Cadastral ID 04-21-16-02300

Tax Area Code 17
Property Class UC
Owners Name AXH REAL ESTATE LLC

Building Data

Building ID 2756
Building Sequence 4
Occupancy 1 494 Industrials, Light Mftg. 100%
Occupancy 2
Occupancy 3
Total Floor Area 217,062
Average Perimeter 2,616
Number Of Storys 1.00
Average Wall Ht 20.00
Year Built 1981
Effective Age 23
Construction Class 7 - Pre-Engineered Steel Frame
Quality 3 - Average
Condition 3 - Average
Exterior Wall 88 - Stud Metal Siding
Heating/Cooling 7 - Package Unit
Roof Type
Roof Cover

Basement Area
Basement Levels
Basement Finish
Finish Code - 1
Finish Area - 1
Finish Code - 2
Finish Area - 2

Building Image

Image Information

Image Name
Image Date
Image Name
Description

Cost Calculations

Appraisal Zone 1
Zone Description
Base Cost 63.72
Wall Cost 5.00
HVAC Cost 20.32
Basement Cost 0.00
Total Base Cost 89.04
Total Area 217,062
Base RCN 19,327,200
Misc Impr Value

Manual Date 01/2025
Base Year 2026
Modifier Value
Total Replacement Cost 19,327,200
Physical Depreciation 48%
Functional Depreciation 35%
Total Depreciation 66% (12,755,952)
Total RCNLD 6,571,248
Lump Sums
Total Building Value 6,571,248 \$ 30.27 Per SqFt



Rogers

Assessment Property Record Card for Tax Year 2026

Data provided by LISA DELOZIER County Assessor

Date 04/17/2026
Time 17:32:20
Page 8

Account 660003084
Parcel ID 21N16E-04-1-00000-000-0000
Cadastral ID 04-21-16-02300

Tax Area Code 17
Property Class UC
Owners Name AXH REAL ESTATE LLC

Building Data

Building ID 2757
Building Sequence 5
Occupancy 1 528 Service Repair Garage 100%
Occupancy 2
Occupancy 3
Total Floor Area 9,000
Average Perimeter 420
Number Of Storys 1.00
Average Wall Ht 24.00
Year Built 2011
Effective Age 8
Construction Class 7 - Pre-Engineered Steel Frame
Quality 3 - Average
Condition 3 - Average
Exterior Wall 88 - Stud Metal Siding
Heating/Cooling 11 - Radiant Space Heaters
Roof Type
Roof Cover Metal

Basement Area
Basement Levels
Basement Finish
Finish Code - 1
Finish Area - 1
Finish Code - 2
Finish Area - 2

Building Image



Image Information

Image Name IMG_0001.JPG
Image Date 11/6/2023
Image Name IMG_0001.JPG
Description REVAL 2024

Cost Calculations

Appraisal Zone 1
Zone Description
Base Cost 56.81
Wall Cost 23.06
HVAC Cost 7.97
Basement Cost 0.00
Total Base Cost 87.84
Total Area 9,000
Base RCN 790,560
Misc Impr Value

Manual Date 01/2025
Base Year 2026
Modifier Value
Total Replacement Cost 790,560
Physical Depreciation 16%
Functional Depreciation
Total Depreciation 16% (126,490)
Total RCNLD 664,070
Lump Sums
Total Building Value 664,070 \$ 73.79 Per SqFt



Rogers

Assessment Property Record Card for Tax Year 2026

Data provided by LISA DELOZIER County Assessor

Date 04/17/2026

Time 17:32:20

Page 9

660003084

Outbuildings/Site Improvements

Building Image	Code	Description	Dimensions	Floor	Roofing	Total Units
	FLV	HOIST 26@10 TON	0x0x0			219,050
	Qual	Cond	Year	Eff Age		
		Valuation Summary	Modifier Total	RCN	Depr (% Phys/ % Func)	RCNLD
		Base Cost (1.00 x 219,050)		219,050	162,097	56,953
	FLV	PAINT ROOM 10X80	0x0x0			16,000
	Qual	Cond	Year	Eff Age		
		Valuation Summary	Modifier Total	RCN	Depr (% Phys/ % Func)	RCNLD
		Base Cost (1.00 x 16,000)		16,000	8,000	8,000
	FLV	HOIST 2@7 1/2 TON	0x0x0			13,420
	Qual	Cond	Year	Eff Age		
		Valuation Summary	Modifier Total	RCN	Depr (% Phys/ % Func)	RCNLD
		Base Cost (1.00 x 13,420)		13,420	9,931	3,489
	FLV	HOIST 4@5 TON	0x0x0			19,760
	Qual	Cond	Year	Eff Age		
		Valuation Summary	Modifier Total	RCN	Depr (% Phys/ % Func)	RCNLD
		Base Cost (1.00 x 19,760)		19,760	14,622	5,138
	FLV	CRNEWAY 2X425@\$145	0x0x0			123,250
	Qual	Cond	Year	Eff Age		
		Valuation Summary	Modifier Total	RCN	Depr (% Phys/ % Func)	RCNLD
		Base Cost (1.00 x 123,250)		123,250	91,205	32,045
	FLV	TROLLEY 9@80X\$35	0x0x0			25,200
	Qual	Cond	Year	Eff Age		
		Valuation Summary	Modifier Total	RCN	Depr (% Phys/ % Func)	RCNLD
		Base Cost (1.00 x 25,200)		25,200	18,648	6,552
	FLV	MTL CANOPY 8X60	0x0x0			7,488
	Qual	Cond	Year	Eff Age		
		Valuation Summary	Modifier Total	RCN	Depr (% Phys/ % Func)	RCNLD
		Base Cost (1.00 x 7,488)		7,488	674	6,814



Rogers

Assessment Property Record Card for Tax Year 2026

Data provided by LISA DELOZIER County Assessor

Date 04/17/2026
Time 17:32:20
Page 10

FLV CS UNDER CNPY 8X60 0x0x0 2,764
Qual Cond Year Eff Age

Valuation Summary Modifier Total RCN Depr (% Phys/ % Func) RCNLD
Base Cost (1.00 x 2,764) 2,764 249 2,515

FLV CRANEWAY 300@\$145 0x0x0 43,500
Qual Cond Year Eff Age

Valuation Summary Modifier Total RCN Depr (% Phys/ % Func) RCNLD
Base Cost (1.00 x 43,500) 43,500 3,915 39,585

FLV TROLLEY 120@\$35 0x0x0 4,200
Qual Cond Year Eff Age

Valuation Summary Modifier Total RCN Depr (% Phys/ % Func) RCNLD
Base Cost (1.00 x 4,200) 4,200 378 3,822

FLV CRANEWAY (4)-NOT USED-NCV 0x0x0
Qual Cond Year Eff Age

Valuation Summary Modifier Total RCN Depr (% Phys/ % Func) RCNLD
Base Cost (1.00 x)

FLV CONC PAVING 6" 27081SF 0x0x0 113,740
Qual Cond Year Eff Age

Valuation Summary Modifier Total RCN Depr (% Phys/ % Func) RCNLD
Base Cost (1.00 x 113,740) 113,740 81,893 31,847

FLV ASPHALT PAVING 72900SF 0x0x0 115,182
Qual Cond Year Eff Age

Valuation Summary Modifier Total RCN Depr (% Phys/ % Func) RCNLD
Base Cost (1.00 x 115,182) 115,182 82,931 32,251

FLV HOIST-10 TON (1) 0x0x0 8,425
Qual Cond Year Eff Age

Valuation Summary Modifier Total RCN Depr (% Phys/ % Func) RCNLD
Base Cost (1.00 x 8,425) 8,425 6,066 2,359



Rogers

Assessment Property Record Card for Tax Year 2026

Data provided by LISA DELOZIER County Assessor

Date 04/17/2026
Time 17:32:20
Page 11

FLV	HOIST 5 TON (4)	0x0x0			19,760
Qual	Cond	Year	Eff Age		

Valuation Summary	Modifier Total	RCN	Depr (% Phys/ % Func)	RCNLD
Base Cost (1.00 x 19,760)		19,760	14,227	5,533

FLV	HOIST 6 TON (6)	0x0x0			31,020
Qual	Cond	Year	Eff Age		

Valuation Summary	Modifier Total	RCN	Depr (% Phys/ % Func)	RCNLD
Base Cost (1.00 x 31,020)		31,020	22,334	8,686

FLV	CRANEWAY 2000'@\$145	0x0x0			290,000
Qual	Cond	Year	Eff Age		

Valuation Summary	Modifier Total	RCN	Depr (% Phys/ % Func)	RCNLD
Base Cost (1.00 x 290,000)		290,000	208,800	81,200

FLV	TROLLEY 12@200X\$35	0x0x0			84,000
Qual	Cond	Year	Eff Age		

Valuation Summary	Modifier Total	RCN	Depr (% Phys/ % Func)	RCNLD
Base Cost (1.00 x 84,000)		84,000	60,480	23,520

FLV	MTL CANOPY 29X52	0x0x0			23,525
Qual	Cond	Year	Eff Age		

Valuation Summary	Modifier Total	RCN	Depr (% Phys/ % Func)	RCNLD
Base Cost (1.00 x 23,525)		23,525	16,938	6,587

FLV	CS UNDER CNPY 29X52	0x0x0			8,686
Qual	Cond	Year	Eff Age		

Valuation Summary	Modifier Total	RCN	Depr (% Phys/ % Func)	RCNLD
Base Cost (1.00 x 8,686)		8,686	6,254	2,432

FLV	MTL CANOPY 30X110	0x0x0			51,480
Qual	Cond	Year	Eff Age		

Valuation Summary	Modifier Total	RCN	Depr (% Phys/ % Func)	RCNLD
Base Cost (1.00 x 51,480)		51,480	37,066	14,414



Rogers

Assessment Property Record Card for Tax Year 2026

Data provided by LISA DELOZIER County Assessor

Date 04/17/2026
Time 17:32:20
Page 12

FLV	CS UNDER CNPY 30X110	0x0x0			19,008
Qual	Cond	Year	Eff Age		

Valuation Summary	Modifier Total	RCN	Depr (% Phys/ % Func)	RCNLD
Base Cost (1.00 x 19,008)		19,008	13,686	5,322

Total Site Improvement Value	379,064
-------------------------------------	----------------