



Rogers

Assessment Property Record Card for Tax Year 2026

Data provided by LISA DELOZIER County Assessor

Date 04/17/2026
Time 03:24:42
Page 1

Assessment Data					Primary Image																																																																																																																				
Account 660003112 Parcel ID 000000-00-0-10435-004-0005 Cadastral ID 04-21-16-02940 Property Type REAL - Real Property Property Class URP VI Area 1 Tax Area 17 - CLAREMORE OT Name ID 50164 BERGDORF, HARVEY LYNN & KILA SUE- TRUSTEES BERGDORF FAMILY REVOC TRUST 16802 E THOMAS DR CLAREMORE OK 74017-0000																																																																																																																									
Parcel Location Situs 01501 N CHOCTAW PL Subdivision STONEGATE Lot/Block 0005 / 0004 Parcel Size 1 - Lots Sec/Twn/Rng 4 / 21 / 16 / 5 Neighborhood 1172 - R-V01-SW CLAREMORE School District S001 - CLAREMORE SCHOOLS																																																																																																																									
Legal Description Lot/Long: 36.32374431 -95.60156909 LOT 5 BLOCK 4 STONEGATE					Building Permits <table border="1"> <thead> <tr> <th>Number</th> <th>Description</th> <th>Opened</th> <th>Closed</th> <th>Amount</th> </tr> </thead> <tbody> <tr> <td> </td> <td> </td> <td> </td> <td> </td> <td> </td> </tr> </tbody> </table>					Number	Description	Opened	Closed	Amount																																																																																																											
Number	Description	Opened	Closed	Amount																																																																																																																					
Exemptions <table border="1"> <thead> <tr> <th>Code</th> <th>Type</th> <th>Active</th> <th>Maximum</th> <th>Exemption</th> </tr> </thead> <tbody> <tr> <td>H</td> <td>Homestead</td> <td>Yes</td> <td>1,000</td> <td>1,000</td> </tr> </tbody> </table>					Code	Type	Active	Maximum	Exemption	H	Homestead	Yes	1,000	1,000	Sale History <table border="1"> <thead> <tr> <th>Bk/Pg</th> <th>Grantor</th> <th>Date</th> <th>Price</th> <th>Code</th> </tr> </thead> <tbody> <tr> <td>/</td> <td>RAMON, DEBORAH I WEST</td> <td>02/27/2026</td> <td>275,000</td> <td>22</td> </tr> <tr> <td>/</td> <td>HALL, PEGGY M &</td> <td>09/30/2020</td> <td>178,000</td> <td>YES</td> </tr> <tr> <td>1330/902</td> <td>PRATT, JO ANN</td> <td>10/24/2001</td> <td>150,000</td> <td>YES</td> </tr> <tr> <td>1176/419</td> <td>WEST, WILMA LEE</td> <td>06/11/1999</td> <td>126,000</td> <td>Yes</td> </tr> </tbody> </table>					Bk/Pg	Grantor	Date	Price	Code	/	RAMON, DEBORAH I WEST	02/27/2026	275,000	22	/	HALL, PEGGY M &	09/30/2020	178,000	YES	1330/902	PRATT, JO ANN	10/24/2001	150,000	YES	1176/419	WEST, WILMA LEE	06/11/1999	126,000	Yes																																																																													
Code	Type	Active	Maximum	Exemption																																																																																																																					
H	Homestead	Yes	1,000	1,000																																																																																																																					
Bk/Pg	Grantor	Date	Price	Code																																																																																																																					
/	RAMON, DEBORAH I WEST	02/27/2026	275,000	22																																																																																																																					
/	HALL, PEGGY M &	09/30/2020	178,000	YES																																																																																																																					
1330/902	PRATT, JO ANN	10/24/2001	150,000	YES																																																																																																																					
1176/419	WEST, WILMA LEE	06/11/1999	126,000	Yes																																																																																																																					
Parcel Valuation <table border="1"> <thead> <tr> <th>Source</th> <th>REAL</th> <th>Fair Cash</th> <th>Capped</th> <th>Asmnt Level</th> <th>Assessed</th> <th>Levy Rate</th> <th>92.430</th> <th>Current Tax</th> </tr> </thead> <tbody> <tr> <td>Remove Cap</td> <td>2027</td> <td>Land Value 65,410</td> <td>52,905</td> <td>11%</td> <td>5,820</td> <td>Assessed</td> <td>20,477</td> <td>1,892.69</td> </tr> <tr> <td>Year Frozen</td> <td>2023</td> <td>Improvements 164,743</td> <td>133,246</td> <td></td> <td>14,657</td> <td>Penalty</td> <td>0</td> <td></td> </tr> <tr> <td>Uncapped Value</td> <td>0</td> <td>Mobile Home 0</td> <td>0</td> <td></td> <td>0</td> <td>Exemption</td> <td>1,000</td> <td>-93.00</td> </tr> <tr> <td>TIF Project ID</td> <td>0</td> <td>Total Value 230,153</td> <td>186,151</td> <td></td> <td>20,477</td> <td>Total Taxable</td> <td>19,477</td> <td>1,800.00</td> </tr> </tbody> </table>										Source	REAL	Fair Cash	Capped	Asmnt Level	Assessed	Levy Rate	92.430	Current Tax	Remove Cap	2027	Land Value 65,410	52,905	11%	5,820	Assessed	20,477	1,892.69	Year Frozen	2023	Improvements 164,743	133,246		14,657	Penalty	0		Uncapped Value	0	Mobile Home 0	0		0	Exemption	1,000	-93.00	TIF Project ID	0	Total Value 230,153	186,151		20,477	Total Taxable	19,477	1,800.00																																																																			
Source	REAL	Fair Cash	Capped	Asmnt Level	Assessed	Levy Rate	92.430	Current Tax																																																																																																																	
Remove Cap	2027	Land Value 65,410	52,905	11%	5,820	Assessed	20,477	1,892.69																																																																																																																	
Year Frozen	2023	Improvements 164,743	133,246		14,657	Penalty	0																																																																																																																		
Uncapped Value	0	Mobile Home 0	0		0	Exemption	1,000	-93.00																																																																																																																	
TIF Project ID	0	Total Value 230,153	186,151		20,477	Total Taxable	19,477	1,800.00																																																																																																																	
Assessment History <table border="1"> <thead> <tr> <th>Tax Year</th> <th>Statement Number</th> <th>Billed Owner</th> <th>Tax Area</th> <th>Total Value</th> <th>Exemptions</th> <th>Taxable Value</th> <th>Billed Tax</th> </tr> </thead> <tbody> <tr><td>2025</td><td>2025-660003112</td><td>RAMON, DEBORAH I WEST</td><td>17</td><td>224,655</td><td>1000</td><td>19,477</td><td>1,800.00</td></tr> <tr><td>2024</td><td>2024-660003112</td><td>RAMON, DEBORAH I WEST</td><td>17</td><td>240,432</td><td>1000</td><td>19,477</td><td>1,800.00</td></tr> <tr><td>2023</td><td>2023-660003112</td><td>RAMON, DEBORAH I WEST</td><td>17</td><td>193,282</td><td>1000</td><td>19,477</td><td>1,784.00</td></tr> <tr><td>2022</td><td>2022-660003112</td><td>RAMON, DEBORAH I WEST</td><td>17</td><td>180,730</td><td>1000</td><td>18,880</td><td>1,748.00</td></tr> <tr><td>2021</td><td>2021-660003112</td><td>RAMON, DEBORAH I WEST</td><td>17</td><td>182,718</td><td>1000</td><td>19,099</td><td>1,686.00</td></tr> <tr><td>2020</td><td>2020-660003112</td><td>RAMON, DEBORAH I WEST</td><td>17</td><td>160,123</td><td>1000</td><td>10,730</td><td>983.00</td></tr> <tr><td>2019</td><td>2019-660003112</td><td>HALL, RONALD RAY & PEGGY M</td><td>17</td><td>156,043</td><td>1000</td><td>10,729</td><td>994.00</td></tr> <tr><td>2018</td><td>2018-660003112</td><td>HALL, RONALD RAY & PEGGY M</td><td>17</td><td>162,585</td><td>1000</td><td>10,729</td><td>991.00</td></tr> <tr><td>2017</td><td>2017-660003112</td><td>HALL, RONALD RAY & PEGGY M</td><td>17</td><td>161,301</td><td>1000</td><td>10,730</td><td>985.00</td></tr> <tr><td>2016</td><td>2016-660003112</td><td>HALL, RONALD RAY & PEGGY M</td><td>17</td><td>157,417</td><td>1000</td><td>10,729</td><td>1,007.00</td></tr> <tr><td>2015</td><td>2015-660003112</td><td>HALL, RONALD RAY & PEGGY M</td><td>17</td><td>156,209</td><td>1000</td><td>10,730</td><td>968.00</td></tr> <tr><td>2014</td><td>2014-660003112</td><td>HALL, RONALD RAY & PEGGY M</td><td>17</td><td>157,421</td><td>1000</td><td>10,729</td><td>995.00</td></tr> <tr><td>2013</td><td>2013-660003112</td><td>HALL, RONALD RAY & PEGGY M</td><td>17</td><td>150,878</td><td>1000</td><td>10,729</td><td>982.00</td></tr> </tbody> </table>										Tax Year	Statement Number	Billed Owner	Tax Area	Total Value	Exemptions	Taxable Value	Billed Tax	2025	2025-660003112	RAMON, DEBORAH I WEST	17	224,655	1000	19,477	1,800.00	2024	2024-660003112	RAMON, DEBORAH I WEST	17	240,432	1000	19,477	1,800.00	2023	2023-660003112	RAMON, DEBORAH I WEST	17	193,282	1000	19,477	1,784.00	2022	2022-660003112	RAMON, DEBORAH I WEST	17	180,730	1000	18,880	1,748.00	2021	2021-660003112	RAMON, DEBORAH I WEST	17	182,718	1000	19,099	1,686.00	2020	2020-660003112	RAMON, DEBORAH I WEST	17	160,123	1000	10,730	983.00	2019	2019-660003112	HALL, RONALD RAY & PEGGY M	17	156,043	1000	10,729	994.00	2018	2018-660003112	HALL, RONALD RAY & PEGGY M	17	162,585	1000	10,729	991.00	2017	2017-660003112	HALL, RONALD RAY & PEGGY M	17	161,301	1000	10,730	985.00	2016	2016-660003112	HALL, RONALD RAY & PEGGY M	17	157,417	1000	10,729	1,007.00	2015	2015-660003112	HALL, RONALD RAY & PEGGY M	17	156,209	1000	10,730	968.00	2014	2014-660003112	HALL, RONALD RAY & PEGGY M	17	157,421	1000	10,729	995.00	2013	2013-660003112	HALL, RONALD RAY & PEGGY M	17	150,878	1000	10,729	982.00
Tax Year	Statement Number	Billed Owner	Tax Area	Total Value	Exemptions	Taxable Value	Billed Tax																																																																																																																		
2025	2025-660003112	RAMON, DEBORAH I WEST	17	224,655	1000	19,477	1,800.00																																																																																																																		
2024	2024-660003112	RAMON, DEBORAH I WEST	17	240,432	1000	19,477	1,800.00																																																																																																																		
2023	2023-660003112	RAMON, DEBORAH I WEST	17	193,282	1000	19,477	1,784.00																																																																																																																		
2022	2022-660003112	RAMON, DEBORAH I WEST	17	180,730	1000	18,880	1,748.00																																																																																																																		
2021	2021-660003112	RAMON, DEBORAH I WEST	17	182,718	1000	19,099	1,686.00																																																																																																																		
2020	2020-660003112	RAMON, DEBORAH I WEST	17	160,123	1000	10,730	983.00																																																																																																																		
2019	2019-660003112	HALL, RONALD RAY & PEGGY M	17	156,043	1000	10,729	994.00																																																																																																																		
2018	2018-660003112	HALL, RONALD RAY & PEGGY M	17	162,585	1000	10,729	991.00																																																																																																																		
2017	2017-660003112	HALL, RONALD RAY & PEGGY M	17	161,301	1000	10,730	985.00																																																																																																																		
2016	2016-660003112	HALL, RONALD RAY & PEGGY M	17	157,417	1000	10,729	1,007.00																																																																																																																		
2015	2015-660003112	HALL, RONALD RAY & PEGGY M	17	156,209	1000	10,730	968.00																																																																																																																		
2014	2014-660003112	HALL, RONALD RAY & PEGGY M	17	157,421	1000	10,729	995.00																																																																																																																		
2013	2013-660003112	HALL, RONALD RAY & PEGGY M	17	150,878	1000	10,729	982.00																																																																																																																		



Rogers

Assessment Property Record Card for Tax Year 2026

Data provided by LISA DELOZIER County Assessor

Date 04/17/2026
Time 03:24:42
Page 2

Lot Data	Square-Foot - NBHD 1172 #1	Primary Image
Lot Size Lot Count 1 Units Buildable 1 Non-Ag Acres 0.2916 Topography Street Access Utilities Amenities LAND QUALITY 0 0 Method Square-Foot Base Lot Value 12,701.00 x 5.15 = 65,410 Factor Value Adjustments 1.0000 Lot Value 65,410		 <p>\\tsclient\T\TOMMY DUNLAP\New folder (166)\IMG_0084.JPG 4/6/2023</p>

Residential Data	
Type	1 Single Family Residence
Condition	3 - Average
Quality	3 - Average
Architecture	
Style	100% One Story
Exterior Wall	100% Veneer, Masonry
Base/Total Area	2,089 / 2,089
Style	100% One Story
HVAC	100% Warmed & Cooled Air
Roof Cover	1 Composition Shingle
Area on Slab	2,089
Fixture/RghIn	8 /
Bed/F/H Bath	3 / 2.5 /
Basement Area	
Garage Type	483 Attached Garage - Unfinished 2 Stalls
Remodel	
Year/Eff Age	1971 / 41

GRM Approach

GRM Code	
Gross Rent	0.00
Indicated Value	

Multiple Regression

MRA Code	1 Test
Adusted R	0.8445
Indicated Value	215,514 103.17 Per SqFt

Direct Comparables

Selection Model	A Adam Test
Adjustment Model	1 2022 Residential
Comparables	8
Indicated Value	232,040 Per SqFt

Value Reconciliation

Selected Approach	Cost Approach
Improvements	164,743
Lot Value	65,410
Indicated Value	230,153 110.17 Per SqFt
Agland Value	
Site Improvements	
Total Value	230,153 110.17 Total Value Per SqFt

Cost Approach Manual : 01/2025

Base Cost	106.42	Total Misc Impr	+	29,991
Roofing Adj	+ 4.65	Garage Cost	+	15,499
Subfloor Adj	+ -2.19	Total RCN	=	310,835
Heat/Cool Adj	+ 12.64	Depreciation (47%)	-	146,092
Plumbing Adj	+ 5.50	Lump Sums	+	0
Basement Adj	+ 0.00	RCNLD	=	164,743
Adj Base Cost	= 127.02	Lot Value	+	65,410
Total Area	x 2,089	Indicated Value	=	230,153
Adjusted Cost	= 265,345	Value Per SqFt		110.17

Miscellaneous Improvements

Code	Description	Sketch ID	Size	Year	Units	Unit Cost	Depr	Value
FPR1	FIREPLACE - RESIDENTIAL 1 STORY	0		1	1	5,615.40		5,615
EPSW	ENCLOSED PORCH - SOLID WALL	7893		274	274	68.55		18,783
PRCH	SLAB PORCH - COVERED	7894		213	213	26.26		5,593



Rogers

Assessment Property Record Card for Tax Year 2026

Data provided by LISA DELOZIER County Assessor

Date 04/17/2026
 Time 03:24:42
 Page 3

Sketch Image

660003112

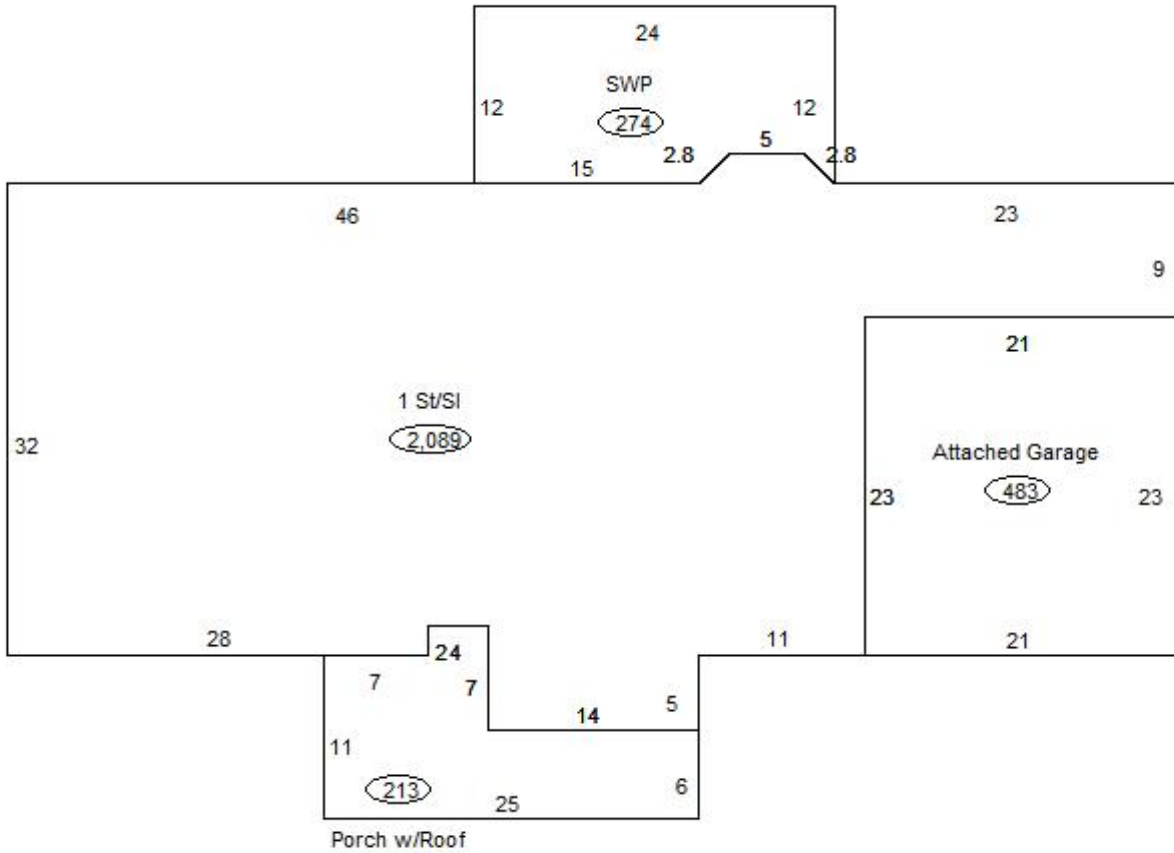

Sketch Vector Information

Sequence	Code	Type	Built Over	Scale	Section Label	Base Area	Multiplier	Total Area
1	R	1	Slab	13	1 St/SI	2,089	1.000	2,089
2	G	1		13	Attached Garage	483	1.000	483
3	M	EPSW		13	EPSW	274	1.000	274
4	M	PRCH		13	SLBC	213	1.000	213
Total Building Area						2,089		2,089