



# Rogers

## Assessment Property Record Card for Tax Year 2026

Data provided by LISA DELOZIER County Assessor

Date 04/17/2026  
 Time 04:03:16  
 Page 1

Assessment Data					Primary Image																																																	
<b>Account</b> 660003152 <b>Parcel ID</b> 000000-00-0-10205-001-0001 <b>Cadastral ID</b> 04-21-16-03340 <b>Property Type</b> REAL - Real Property <b>Property Class</b> URP VI Area 1 <b>Tax Area</b> 17 - CLAREMORE OT <b>Name ID</b> 324914 ROBERTS, ANNA M  1229 CHERRINGTON AVE CLAREMORE OK 74017-0000  <b>Parcel Location</b> <b>Situs</b> 01229 CHERRINGTON <b>Subdivision</b> JAYCEE <b>Lot/Block</b> 0001 / 0001 <b>Parcel Size</b> 1 - Lots <b>Sec/Twn/Rng</b> 4 / 21 / 16 / 5 <b>Neighborhood</b> 1162 - R-V01-SW CLAREMORE <b>School District</b> S001 - CLAREMORE SCHOOLS					 <p>\\tsclient\T\TOMMY DUNLAP\New folder (167)\IMG_0044.JPG 4/10/2023</p>																																																	
<b>Legal Description</b> Lot/Long: 36.32352819 -95.60687333																																																						
LOT 1 BLOCK 1 JAYCEE					<b>Building Permits</b> <table border="1"> <thead> <tr> <th>Number</th> <th>Description</th> <th>Opened</th> <th>Closed</th> <th>Amount</th> </tr> </thead> <tbody> <tr> <td> </td> <td> </td> <td> </td> <td> </td> <td> </td> </tr> </tbody> </table>					Number	Description	Opened	Closed	Amount																																								
Number	Description	Opened	Closed	Amount																																																		
<b>Exemptions</b>					<b>Sale History</b>																																																	
<b>Code</b>	<b>Type</b>	<b>Active</b>	<b>Maximum</b>	<b>Exemption</b>	<b>Bk/Pg</b>	<b>Grantor</b>	<b>Date</b>	<b>Price</b>	<b>Code</b>																																													
H	Homestead	No	1,000		2719/611	JOHNSON, CLAUDE JEANNE TRUSTEE	06/22/2018	85,000	YES																																													
<b>Parcel Valuation</b>					<table border="1"> <thead> <tr> <th>Source</th> <th>REAL</th> <th>Fair Cash</th> <th>Capped</th> <th>Asmnt Level</th> <th>Assessed</th> <th>Levy Rate</th> <th>92.430</th> <th>Current Tax</th> </tr> </thead> <tbody> <tr> <td>Remove Cap</td> <td>2019</td> <td>Land Value</td> <td>52,838</td> <td>41,058</td> <td>11%</td> <td>4,516</td> <td>Assessed</td> <td>12,191 1,126.81</td> </tr> <tr> <td>Year Frozen</td> <td>2005</td> <td>Improvements</td> <td>69,770</td> <td>69,770</td> <td> </td> <td>7,675</td> <td>Penalty</td> <td>0</td> </tr> <tr> <td>Uncapped Value</td> <td>0</td> <td>Mobile Home</td> <td>0</td> <td>0</td> <td> </td> <td>0</td> <td>Exemption</td> <td>0 0.00</td> </tr> <tr> <td>TIF Project ID</td> <td>0</td> <td>Total Value</td> <td>122,608</td> <td>110,828</td> <td> </td> <td>12,191</td> <td>Total Taxable</td> <td>12,191 1,127.00</td> </tr> </tbody> </table>					Source	REAL	Fair Cash	Capped	Asmnt Level	Assessed	Levy Rate	92.430	Current Tax	Remove Cap	2019	Land Value	52,838	41,058	11%	4,516	Assessed	12,191 1,126.81	Year Frozen	2005	Improvements	69,770	69,770		7,675	Penalty	0	Uncapped Value	0	Mobile Home	0	0		0	Exemption	0 0.00	TIF Project ID	0	Total Value	122,608	110,828		12,191	Total Taxable	12,191 1,127.00
Source	REAL	Fair Cash	Capped	Asmnt Level	Assessed	Levy Rate	92.430	Current Tax																																														
Remove Cap	2019	Land Value	52,838	41,058	11%	4,516	Assessed	12,191 1,126.81																																														
Year Frozen	2005	Improvements	69,770	69,770		7,675	Penalty	0																																														
Uncapped Value	0	Mobile Home	0	0		0	Exemption	0 0.00																																														
TIF Project ID	0	Total Value	122,608	110,828		12,191	Total Taxable	12,191 1,127.00																																														
<b>Assessment History</b>																																																						
<b>Tax Year</b>	<b>Statement Number</b>	<b>Billed Owner</b>			<b>Tax Area</b>	<b>Total Value</b>	<b>Exemptions</b>	<b>Taxable Value</b>	<b>Billed Tax</b>																																													
2025	2025-660003152	ROBERTS, ANNA M			17	122,319	0	11,611	1,073.00																																													
2024	2024-660003152	ROBERTS, ANNA M			17	121,170	0	11,058	1,022.00																																													
2023	2023-660003152	ROBERTS, ANNA M			17	108,143	0	10,532	965.00																																													
2022	2022-660003152	ROBERTS, ANNA M			17	91,180	0	10,030	928.00																																													
2021	2021-660003152	ROBERTS, ANNA M			17	91,129	0	10,024	885.00																																													
2020	2020-660003152	ROBERTS, ANNA M			17	92,233	0	10,146	929.00																																													
2019	2019-660003152	ROBERTS, ANNA M			17	88,703	0	9,757	904.00																																													
2018	2018-660003152	ROBERTS, ANNA M			17	94,657	1000	6,374	589.00																																													
2017	2017-660003152	JOHNSON, CLAUDE JEANNE TRUSTEE			17	94,009	1000	6,374	585.00																																													
2016	2016-660003152	JOHNSON, CLAUDE JEANNE TRUSTEE			17	92,014	1000	6,374	598.00																																													
2015	2015-660003152	JOHNSON, CLAUDE JEANNE TRUSTEE			17	90,342	1000	6,375	575.00																																													
2014	2014-660003152	JOHNSON, CLAUDE JEANNE TRUSTEE			17	92,964	1000	6,374	591.00																																													
2013	2013-660003152	JOHNSON, CLAUDE JEANNE TRUSTEE			17	90,093	1000	6,374	583.00																																													



# Rogers

## Assessment Property Record Card for Tax Year 2026

Data provided by LISA DELOZIER County Assessor

Date 04/17/2026  
Time 04:03:16  
Page 2

Lot Data	Square-Foot - NBHD 1162 #1	Primary Image
Lot Size		
Lot Count	1	
Units Buildable	1	
Non-Ag Acres	0.2226	
Topography		
Street Access		
Utilities		
Amenities	LAND QUALITY	
	0	
	0	
Method	Square-Foot	
Base Lot Value	9,695.00 x 5.45 = 52,838	
Factor Value		
Adjustments	1.0000	
Lot Value	52,838	

Residential Data	
Type	1 Single Family Residence
Condition	3 - Average
Quality	2 - Fair
Architecture	R3 Res Nbhd 3
Style	100% One Story
Exterior Wall	10% Veneer, Masonry 90% Frame, Siding, Vinyl
Base/Total Area	1,518 / 1,518
Style	100% One Story
HVAC	100% Warmed & Cooled Air
Roof Cover	1 Composition Shingle
Area on Slab	1,518
Fixture/RghIn	8 /
Bed/F/H Bath	3 / 2.0 /
Basement Area	
Garage Type	360 Carport - Gable Roof
Remodel	
Year/Eff Age	1960 / 50

\\tsclient\T\TOMMY DUNLAP\New folder (167)\IMG\_0044.JPG 4/10/2023

GRM Approach	
GRM Code	
Gross Rent	0.00
Indicated Value	

Multiple Regression			
MRA Code	1	Test	
Adusted R	0.8445		
Indicated Value	116,122	76.50	Per SqFt

Direct Comparables			
Selection Model	A	Adam Test	
Adjustment Model	1	2022 Residential	
Comparables	6		
Indicated Value	164,590		Per SqFt

Cost Approach				Manual : 01/2025			
Base Cost	88.09	Total Misc Impr	+	3,083			
Roofing Adj	+ 3.95	Garage Cost	+	2,354			
Subfloor Adj	+ 0.00	Total RCN	=	170,170			
Heat/Cool Adj	+ 10.30	Depreciation ( 59%)	-	100,400			
Plumbing Adj	+ 6.18	Lump Sums	+	0			
Basement Adj	+ 0.00	RCNLD	=	69,770			
Adj Base Cost	= 108.52	Lot Value	+	52,838			
Total Area	x 1,518	Indicated Value	=	122,608			
Adjusted Cost	= 164,733	Value Per SqFt		80.77			

Value Reconciliation			
Selected Approach	Cost Approach		
Improvements	69,770		
Lot Value	52,838		
Indicated Value	122,608	80.77	Per SqFt
Agland Value			
Site Improvements			
Total Value	122,608	80.77	Total Value Per SqFt

Miscellaneous Improvements								
Code	Description	Sketch ID	Size	Year	Units	Unit Cost	Depr	Value
PRCH	SLAB PORCH - COVERED	8052	116		116	20.93		2,428
PATO	SLAB PORCH - OPEN	8053	64		64	10.24		655



# Rogers

## Assessment Property Record Card for Tax Year 2026

Data provided by LISA DELOZIER County Assessor

Date 04/17/2026

Time 04:03:16

Page 3

### Sketch Image

660003152

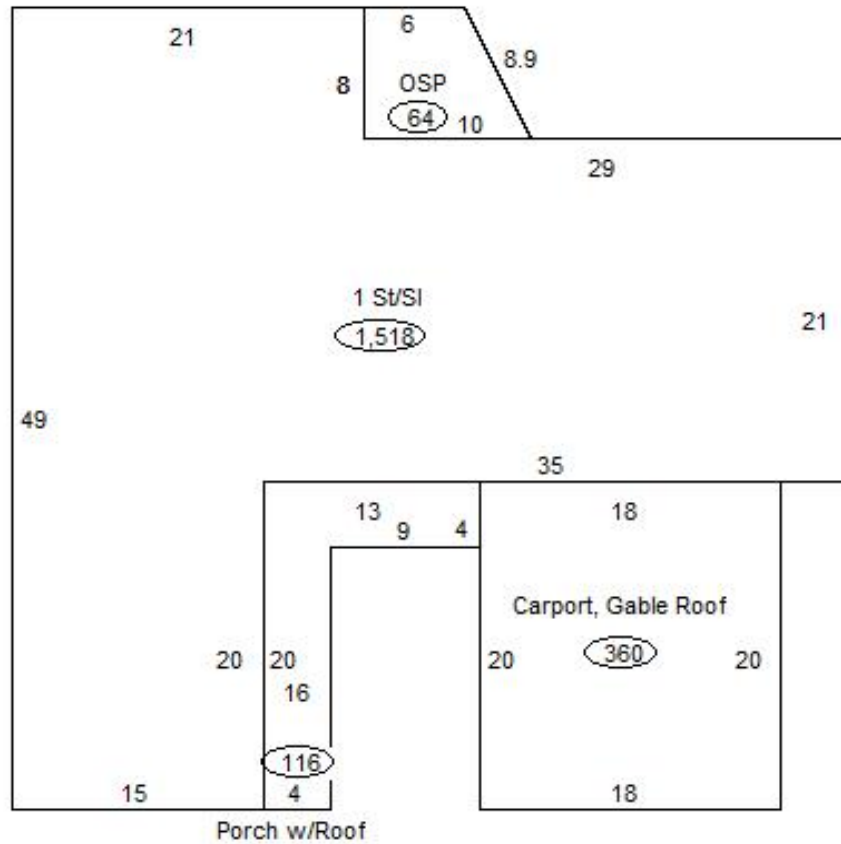

### Sketch Vector Information

Sequence	Code	Type	Built Over	Scale	Section Label	Base Area	Multiplier	Total Area
1	R	1	Slab	13	1 St/Sl	1,518	1.000	1,518
2	G	3		13	Carport, Gable Roof	360	1.000	360
3	M	PRCH		13	SLBC	116	1.000	116
4	M	PATO		13	Open Slab	64	1.000	64
<b>Total Building Area</b>						<b>1,518</b>		<b>1,518</b>



# Rogers

## Assessment Property Record Card for Tax Year 2026

Data provided by LISA DELOZIER County Assessor

Date 04/17/2026  
Time 04:03:16  
Page 4

660003152

### Outbuildings/Site Improvements

Building Image	Code	Description	Dimensions	Floor	Roofing	Total Units
	STF	STG FAIR	0x0x0			
	Qual	2	Cond	Year	Eff Age	
<b>Valuation Summary</b>		<b>Modifier Total</b>	<b>RCN</b>	<b>Depr (0% Phys/ % Func)</b>	<b>RCNLD</b>	
Base Cost (4.68 x )						