



# Rogers

## Assessment Property Record Card for Tax Year 2026

Data provided by LISA DELOZIER County Assessor

Date 04/17/2026  
Time 03:26:20  
Page 1

Assessment Data					Primary Image									
Account	660003186													
Parcel ID	000000-00-0-10240-002-0004													
Cadastral ID	04-21-16-03680													
Property Type	REAL - Real Property													
Property Class	URP	VI Area	1											
Tax Area	17 - CLAREMORE OT													
Name ID	70124													
BRIDWELL, MARY J														
TRUSTEE														
321 E 17TH ST CLAREMORE OK 74017-0000														
Parcel Location														
Situs	00321 E 17TH ST N													
Subdivision	MARLAR													
Lot/Block	0004 / 0002	Parcel Size	1 - Lots											
Sec/Twn/Rng	4 / 21 / 16 / 5													
Neighborhood	1172 - R-V01-SW CLAREMORE													
School District	S001 - CLAREMORE SCHOOLS													
Legal Description Lat/Long: 36.32484155 -95.59824177														
Building Permits														
LOT 4 BLOCK 2 MARLAR														
<table border="1"> <thead> <tr> <th>Number</th> <th>Description</th> <th>Opened</th> <th>Closed</th> <th>Amount</th> </tr> </thead> <tbody> <tr> <td> </td> <td> </td> <td> </td> <td> </td> <td> </td> </tr> </tbody> </table>					Number	Description	Opened	Closed	Amount					
Number	Description	Opened	Closed	Amount										
Exemptions														
Sale History														
Code	Type	Active	Maximum	Exemption	Bk/Pg	Grantor	Date	Price	Code					
H	Homestead	Yes	1,000	1,000	2484/57	BRIDWELL, JOHN RALPH & MARY J	06/09/2015	0	4					
Parcel Valuation														
Source	REAL	Fair Cash	Capped	Asmnt Level	Assessed	Levy Rate	92.430	Current Tax						
Remove Cap	0	Land Value	57,072	21,996	11%	2,420	Assessed	6,620	611.89					
Year Frozen	2005	Improvements	99,073	38,184		4,200	Penalty	0						
Uncapped Value	0	Mobile Home	0	0		0	Exemption	1,000	-93.00					
TIF Project ID	0	Total Value	156,145	60,180		6,620	Total Taxable	5,620	519.00					
Assessment History														
Tax Year	Statement Number	Billed Owner	Tax Area	Total Value	Exemptions	Taxable Value	Billed Tax							
2025	2025-660003186	BRIDWELL, MARY J	17	154,818	1000	5,619	519.00							
2024	2024-660003186	BRIDWELL, MARY J	17	157,697	1000	5,620	519.00							
2023	2023-660003186	BRIDWELL, MARY J	17	131,178	1000	5,620	515.00							
2022	2022-660003186	BRIDWELL, MARY J	17	111,553	1000	5,620	520.00							
2021	2021-660003186	BRIDWELL, MARY J	17	119,048	1000	5,619	496.00							
2020	2020-660003186	BRIDWELL, MARY J	17	117,303	1000	5,620	515.00							
2019	2019-660003186	BRIDWELL, MARY J	17	114,982	1000	5,619	520.00							
2018	2018-660003186	BRIDWELL, MARY J	17	121,073	1000	5,620	519.00							
2017	2017-660003186	BRIDWELL, MARY J	17	120,148	1000	5,620	516.00							
2016	2016-660003186	BRIDWELL, MARY J	17	117,357	1000	5,620	527.00							
2015	2015-660003186	BRIDWELL, MARY J	17	116,493	1000	5,620	507.00							
2014	2014-660003186	BRIDWELL, JOHN RALPH & MARY J	17	117,365	1000	5,620	521.00							
2013	2013-660003186	BRIDWELL, JOHN RALPH & MARY J	17	112,172	1000	5,619	514.00							



# Rogers

## Assessment Property Record Card for Tax Year 2026

Data provided by LISA DELOZIER County Assessor

Date 04/17/2026  
Time 03:26:20  
Page 2

Lot Data	Square-Foot - NBHD 1172 #1	Primary Image
Lot Size		
Lot Count	1	
Units Buildable	1	
Non-Ag Acres	0.2544	
Topography		
Street Access		
Utilities		
Amenities	LAND QUALITY	
	0	
	0	
Method	Square-Foot	
Base Lot Value	11,082.00 x 5.15 = 57,072	
Factor Value		
Adjustments	1.0000	
Lot Value	57,072	

Residential Data	
Type	1 Single Family Residence
Condition	3 - Average
Quality	2.5 - Fair
Architecture	R3 Res Nbhd 3
Style	100% One Story
Exterior Wall	100% Veneer, Masonry
Base/Total Area	1,406 / 1,406
Style	100% One Story
HVAC	100% Warmed & Cooled Air
Roof Cover	1 Composition Shingle
Area on Slab	0
Fixture/RghIn	8 /
Bed/F/H Bath	3 / 2.0 /
Basement Area	
Garage Type	525 Attached Garage - Unfinished
Remodel	
Year/Eff Age	1969 / 43

\\tsclient\T\TOMMY DUNLAP\New folder (167)\IMG_0067.JPG		4/10/2023
---	--	-----------

GRM Approach	
GRM Code	
Gross Rent	0.00
Indicated Value	

Multiple Regression			
MRA Code	1	Test	
Adusted R	0.8445		
Indicated Value	150,017	106.70	Per SqFt

Direct Comparables	
Selection Model	A Adam Test
Adjustment Model	1 2022 Residential
Comparables	8
Indicated Value	182,770
	Per SqFt

Cost Approach				Manual : 01/2025	
Base Cost	103.92	Total Misc Impr	+	7,456	
Roofing Adj	+ 4.40	Garage Cost	+	14,259	
Subfloor Adj	+ 1.15	Total RCN	=	202,189	
Heat/Cool Adj	+ 11.47	Depreciation ( 51%)	-	103,116	
Plumbing Adj	+ 7.42	Lump Sums	+	0	
Basement Adj	+ 0.00	RCNLD	=	99,073	
Adj Base Cost	= 128.36	Lot Value	+	57,072	
Total Area	x 1,406	Indicated Value	=	156,145	
Adjusted Cost	= 180,474	Value Per SqFt		111.06	

Value Reconciliation			
Selected Approach	Cost Approach		
Improvements	99,073		
Lot Value	57,072		
Indicated Value	156,145	111.06	Per SqFt
Agland Value			
Site Improvements			
Total Value	156,145	111.06	Total Value Per SqFt

Miscellaneous Improvements								
Code	Description	Sketch ID	Size	Year	Units	Unit Cost	Depr	Value
PRCH	SLAB PORCH - COVERED	8177	6x6		36	24.16		870
PRCH	SLAB PORCH - COVERED	8178	18x12		216	23.51		5,078
PATO	SLAB PORCH - OPEN	8179	12x12		144	10.47		1,508



# Rogers

## Assessment Property Record Card for Tax Year 2026

Data provided by LISA DELOZIER County Assessor

Date 04/17/2026  
 Time 03:26:20  
 Page 3

### Sketch Image

660003186

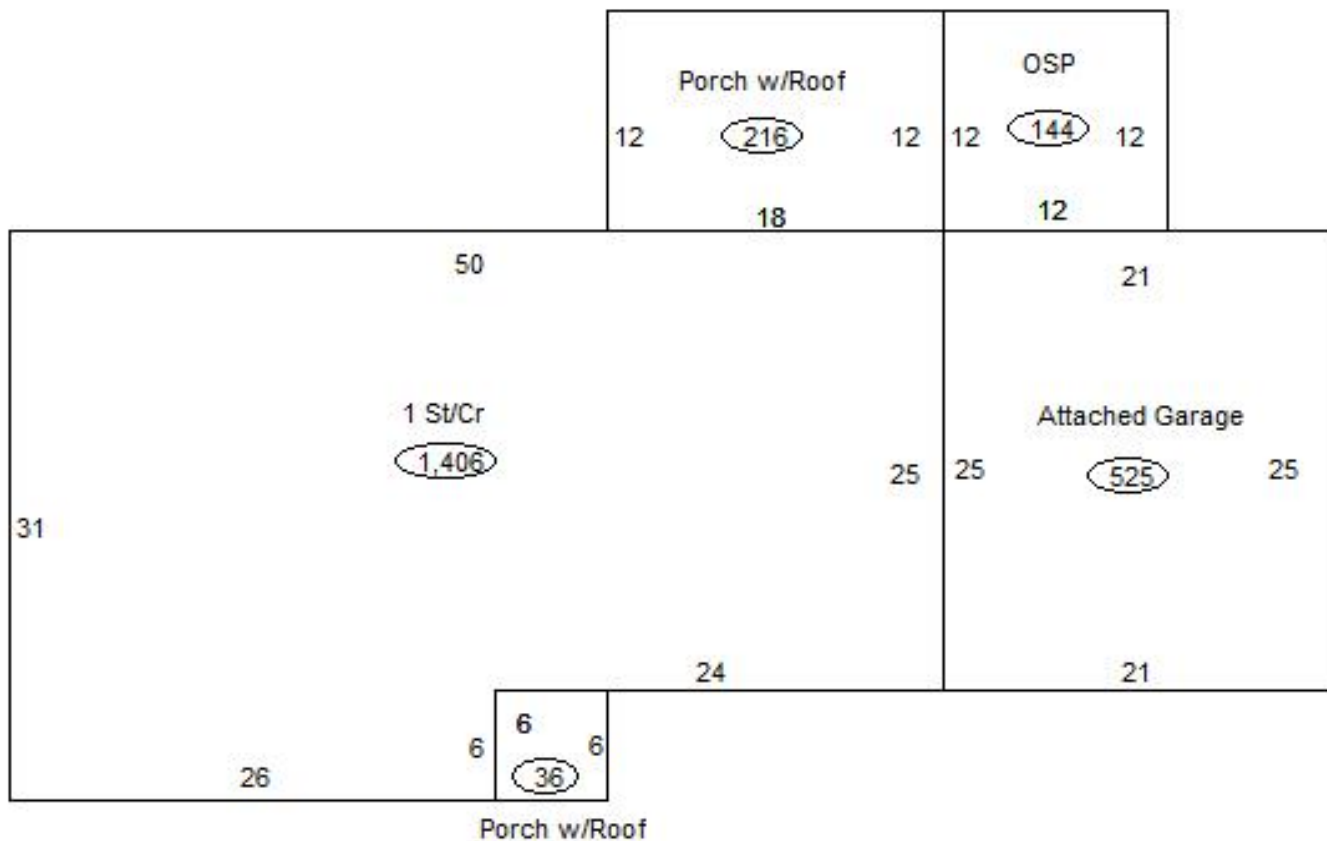

### Sketch Vector Information

Sequence	Code	Type	Built Over	Scale	Section Label	Base Area	Multiplier	Total Area
1	R	1	Crawl	13	1 St/Cr	1,406	1.000	1,406
2	G	1		13	Attached Garage	525	1.000	525
3	M	PRCH		13	SLBC	36	1.000	36
4	M	PRCH		13	SLBC	216	1.000	216
5	M	PATO		13	Open Slab	144	1.000	144
<b>Total Building Area</b>						1,406		1,406



# Rogers

## Assessment Property Record Card for Tax Year 2026

Data provided by LISA DELOZIER County Assessor

Date 04/17/2026  
Time 03:26:20  
Page 4

660003186

### Outbuildings/Site Improvements

Building Image	Code	Description	Dimensions	Floor	Roofing	Total Units
	STF	STG FAIR	0x0x0			
	Qual	2	Cond	Year	Eff Age	
<b>Valuation Summary</b>			<b>Modifier Total</b>	<b>RCN</b>	<b>Depr (0% Phys/ % Func)</b>	<b>RCNLD</b>
Base Cost (4.68 x )						