



Rogers

Assessment Property Record Card for Tax Year 2026

Data provided by LISA DELOZIER County Assessor

Date 04/18/2026
Time 06:11:13
Page 1

Assessment Data					Primary Image																																																																																																																				
Account 660003279 Parcel ID 21N16E-04-2-00000-000-0000 Cadastral ID 04-21-16-09900 Property Type REAL - Real Property Property Class UC VI Area 1 Tax Area 17 - CLAREMORE OT Name ID 88994 HUGHES TOOL CO PO BOX 4740 HOUSTON TX 77210-4740 Parcel Location Situs 02210 E L ANDERSON BLVD Subdivision Lot/Block / Parcel Size 16.74 - Acres Sec/Twn/Rng 4 / 21 / 16 / 2 Neighborhood 5001 - TASC 2016 School District S001 - CLAREMORE SCHOOLS																																																																																																																									
Legal Description Lat/Long: 36.32999890 -95.60912120										REVAL 2024 11/6/2023																																																																																																															
Legal Description TR "D" BEG: NW/C S2 S2 NW; E ALG N/L SD S2 S2 NW 1004.25' TO C/L OF GRDA EASE. WHICH IS TRUE POB; CONT E ALG SD N/L 1341.97' TO W ROW/L OF ST L RR/ROW; S 26-55' W ALG SD ROW/L 836.06'; TH CUR TO L RAD 75') 231.77'; TH CUR TO R (R 45') 59.32'; N 89-54 W 488 33'; N 406.16' W ALG N/L DEDICATED RD 437.14'; TO					Building Permits <table border="1"> <thead> <tr> <th>Number</th> <th>Description</th> <th>Opened</th> <th>Closed</th> <th>Amount</th> </tr> </thead> <tbody> <tr> <td>R12</td> <td>CABLE PLANT ADD-ONS</td> <td>09/2010</td> <td>11/2013</td> <td></td> </tr> </tbody> </table>					Number	Description	Opened	Closed	Amount	R12	CABLE PLANT ADD-ONS	09/2010	11/2013																																																																																																							
Number	Description	Opened	Closed	Amount																																																																																																																					
R12	CABLE PLANT ADD-ONS	09/2010	11/2013																																																																																																																						
Exemptions <table border="1"> <thead> <tr> <th>Code</th> <th>Type</th> <th>Active</th> <th>Maximum</th> <th>Exemption</th> </tr> </thead> <tbody> <tr> <td></td> <td></td> <td></td> <td></td> <td></td> </tr> </tbody> </table>					Code	Type	Active	Maximum	Exemption						Sale History <table border="1"> <thead> <tr> <th>Bk/Pg</th> <th>Grantor</th> <th>Date</th> <th>Price</th> <th>Code</th> </tr> </thead> <tbody> <tr> <td></td> <td></td> <td></td> <td></td> <td></td> </tr> </tbody> </table>					Bk/Pg	Grantor	Date	Price	Code																																																																																																	
Code	Type	Active	Maximum	Exemption																																																																																																																					
Bk/Pg	Grantor	Date	Price	Code																																																																																																																					
Parcel Valuation <table border="1"> <thead> <tr> <th>Source</th> <th>REAL</th> <th>Fair Cash</th> <th>Capped</th> <th>Asmnt Level</th> <th>Assessed</th> <th>Levy Rate</th> <th>92.430</th> <th>Current Tax</th> </tr> </thead> <tbody> <tr> <td>Remove Cap</td> <td>0</td> <td>Land Value 132,566</td> <td>132,566</td> <td>11%</td> <td>14,582</td> <td>Assessed</td> <td>306,722</td> <td>28,350.31</td> </tr> <tr> <td>Year Frozen</td> <td>0</td> <td>Improvements 7,433,348</td> <td>2,655,811</td> <td></td> <td>292,140</td> <td>Penalty</td> <td>0</td> <td></td> </tr> <tr> <td>Uncapped Value</td> <td>0</td> <td>Mobile Home 0</td> <td>0</td> <td></td> <td>0</td> <td>Exemption</td> <td>0</td> <td>0.00</td> </tr> <tr> <td>TIF Project ID</td> <td>0</td> <td>Total Value 7,565,914</td> <td>2,788,377</td> <td></td> <td>306,722</td> <td>Total Taxable</td> <td>306,722</td> <td>28,350.00</td> </tr> </tbody> </table>										Source	REAL	Fair Cash	Capped	Asmnt Level	Assessed	Levy Rate	92.430	Current Tax	Remove Cap	0	Land Value 132,566	132,566	11%	14,582	Assessed	306,722	28,350.31	Year Frozen	0	Improvements 7,433,348	2,655,811		292,140	Penalty	0		Uncapped Value	0	Mobile Home 0	0		0	Exemption	0	0.00	TIF Project ID	0	Total Value 7,565,914	2,788,377		306,722	Total Taxable	306,722	28,350.00																																																																			
Source	REAL	Fair Cash	Capped	Asmnt Level	Assessed	Levy Rate	92.430	Current Tax																																																																																																																	
Remove Cap	0	Land Value 132,566	132,566	11%	14,582	Assessed	306,722	28,350.31																																																																																																																	
Year Frozen	0	Improvements 7,433,348	2,655,811		292,140	Penalty	0																																																																																																																		
Uncapped Value	0	Mobile Home 0	0		0	Exemption	0	0.00																																																																																																																	
TIF Project ID	0	Total Value 7,565,914	2,788,377		306,722	Total Taxable	306,722	28,350.00																																																																																																																	
Assessment History <table border="1"> <thead> <tr> <th>Tax Year</th> <th>Statement Number</th> <th>Billed Owner</th> <th>Tax Area</th> <th>Total Value</th> <th>Exemptions</th> <th>Taxable Value</th> <th>Billed Tax</th> </tr> </thead> <tbody> <tr><td>2025</td><td>2025-660003279</td><td>HUGHES TOOL CO</td><td>17</td><td>7,722,285</td><td>0</td><td>292,116</td><td>27,000.00</td></tr> <tr><td>2024</td><td>2024-660003279</td><td>HUGHES TOOL CO</td><td>17</td><td>2,529,141</td><td>0</td><td>278,206</td><td>25,712.00</td></tr> <tr><td>2023</td><td>2023-660003279</td><td>HUGHES TOOL CO</td><td>17</td><td>6,544,437</td><td>0</td><td>719,888</td><td>65,942.00</td></tr> <tr><td>2022</td><td>2022-660003279</td><td>HUGHES TOOL CO</td><td>17</td><td>6,780,320</td><td>0</td><td>745,835</td><td>69,042.00</td></tr> <tr><td>2021</td><td>2021-660003279</td><td>HUGHES TOOL CO</td><td>17</td><td>6,734,572</td><td>0</td><td>740,803</td><td>65,413.00</td></tr> <tr><td>2020</td><td>2020-660003279</td><td>HUGHES TOOL CO</td><td>17</td><td>7,712,102</td><td>0</td><td>817,710</td><td>74,878.00</td></tr> <tr><td>2019</td><td>2019-660003279</td><td>HUGHES TOOL CO</td><td>17</td><td>7,238,881</td><td>0</td><td>778,772</td><td>72,130.00</td></tr> <tr><td>2018</td><td>2018-660003279</td><td>HUGHES TOOL CO</td><td>17</td><td>6,742,616</td><td>0</td><td>741,688</td><td>68,532.00</td></tr> <tr><td>2017</td><td>2017-660003279</td><td>HUGHES TOOL CO</td><td>17</td><td>6,742,616</td><td>0</td><td>732,405</td><td>67,264.00</td></tr> <tr><td>2016</td><td>2016-660003279</td><td>HUGHES TOOL CO</td><td>17</td><td>6,523,866</td><td>0</td><td>588,379</td><td>55,225.00</td></tr> <tr><td>2015</td><td>2015-660003279</td><td>HUGHES TOOL CO</td><td>17</td><td>5,094,197</td><td>0</td><td>560,362</td><td>50,539.00</td></tr> <tr><td>2014</td><td>2014-660003279</td><td>HUGHES TOOL CO</td><td>17</td><td>5,094,197</td><td>0</td><td>560,362</td><td>51,962.00</td></tr> <tr><td>2013</td><td>2013-660003279</td><td>HUGHES TOOL CO</td><td>17</td><td>5,094,197</td><td>0</td><td>560,362</td><td>51,278.00</td></tr> </tbody> </table>										Tax Year	Statement Number	Billed Owner	Tax Area	Total Value	Exemptions	Taxable Value	Billed Tax	2025	2025-660003279	HUGHES TOOL CO	17	7,722,285	0	292,116	27,000.00	2024	2024-660003279	HUGHES TOOL CO	17	2,529,141	0	278,206	25,712.00	2023	2023-660003279	HUGHES TOOL CO	17	6,544,437	0	719,888	65,942.00	2022	2022-660003279	HUGHES TOOL CO	17	6,780,320	0	745,835	69,042.00	2021	2021-660003279	HUGHES TOOL CO	17	6,734,572	0	740,803	65,413.00	2020	2020-660003279	HUGHES TOOL CO	17	7,712,102	0	817,710	74,878.00	2019	2019-660003279	HUGHES TOOL CO	17	7,238,881	0	778,772	72,130.00	2018	2018-660003279	HUGHES TOOL CO	17	6,742,616	0	741,688	68,532.00	2017	2017-660003279	HUGHES TOOL CO	17	6,742,616	0	732,405	67,264.00	2016	2016-660003279	HUGHES TOOL CO	17	6,523,866	0	588,379	55,225.00	2015	2015-660003279	HUGHES TOOL CO	17	5,094,197	0	560,362	50,539.00	2014	2014-660003279	HUGHES TOOL CO	17	5,094,197	0	560,362	51,962.00	2013	2013-660003279	HUGHES TOOL CO	17	5,094,197	0	560,362	51,278.00
Tax Year	Statement Number	Billed Owner	Tax Area	Total Value	Exemptions	Taxable Value	Billed Tax																																																																																																																		
2025	2025-660003279	HUGHES TOOL CO	17	7,722,285	0	292,116	27,000.00																																																																																																																		
2024	2024-660003279	HUGHES TOOL CO	17	2,529,141	0	278,206	25,712.00																																																																																																																		
2023	2023-660003279	HUGHES TOOL CO	17	6,544,437	0	719,888	65,942.00																																																																																																																		
2022	2022-660003279	HUGHES TOOL CO	17	6,780,320	0	745,835	69,042.00																																																																																																																		
2021	2021-660003279	HUGHES TOOL CO	17	6,734,572	0	740,803	65,413.00																																																																																																																		
2020	2020-660003279	HUGHES TOOL CO	17	7,712,102	0	817,710	74,878.00																																																																																																																		
2019	2019-660003279	HUGHES TOOL CO	17	7,238,881	0	778,772	72,130.00																																																																																																																		
2018	2018-660003279	HUGHES TOOL CO	17	6,742,616	0	741,688	68,532.00																																																																																																																		
2017	2017-660003279	HUGHES TOOL CO	17	6,742,616	0	732,405	67,264.00																																																																																																																		
2016	2016-660003279	HUGHES TOOL CO	17	6,523,866	0	588,379	55,225.00																																																																																																																		
2015	2015-660003279	HUGHES TOOL CO	17	5,094,197	0	560,362	50,539.00																																																																																																																		
2014	2014-660003279	HUGHES TOOL CO	17	5,094,197	0	560,362	51,962.00																																																																																																																		
2013	2013-660003279	HUGHES TOOL CO	17	5,094,197	0	560,362	51,278.00																																																																																																																		



Rogers

Assessment Property Record Card for Tax Year 2026

Data provided by LISA DELOZIER County Assessor

Date 04/18/2026
 Time 06:11:13
 Page 2

Lot Data		Primary Image	
Lot Size	0 x 0		
Lot Count	0		
Units Buildable	260190		
Non-Ag Acres	0		
Topography			
Street Access			
Utilities			
Amenities	0		
	0		
Value Model	1835 COMM		
Value Method	Square-Foot		
Base Lot Value	260,190.00 x .51 = 132,566		
Factor Value	0		
Adjustments			
Lot Value	132,566		
Cost Approach		Image Information	
Manual Date	01/2025	Image ID	1034417
Total Building Area	204,315	Image Date	11/6/2023
Total Base Value	16,636,102	Name	IMG_0010.JPG
Modifier Value	521,920	Description	REVAL 2024
Misc Improvements			
Replacement Cost New	17,158,022		
Phys/Func Depreciation Loss	()		
RCN Less Phys/Func	7,270,379		
Economic Depreciation			
RCNLD (All Sources)	7,270,379		
Depreciated Improvements			
Outbuilding Value	162,969		
Total Improvement Value	7,433,348		
Land Value	132,566		
Cost Approach Value	7,565,914 37.03/SqFt		
Income Approach		Value Reconciliation	
Potential Gross Income (PGI)		Selected Valuation Method	Cost Approach
Vacancy & Collection Loss		Total Improvement Value	162,969
Miscellaneous Income		Land Value	132,566
Effective Gross Income (EGI)		Total Appraised Value	7,565,914 37.03/SqFt
Total Expenses			
Net Operating Income (NOI)			
Income Capitalization Rate			
Indicated Value	0.00		



Rogers

Assessment Property Record Card for Tax Year 2026

Data provided by LISA DELOZIER County Assessor

Date 04/18/2026
Time 06:11:13
Page 3

Sketch Image

660003279

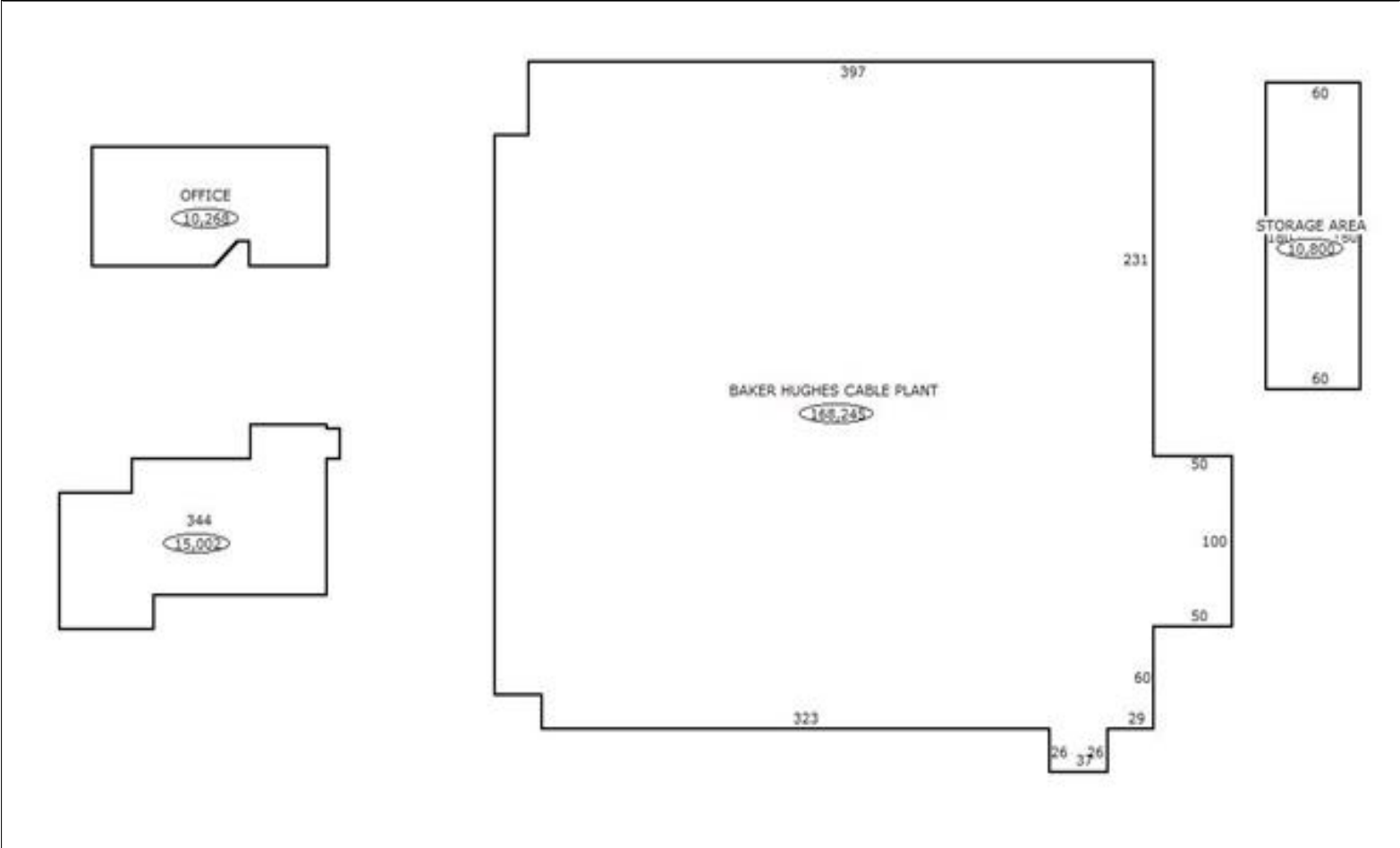

Sketch Vector Information

Sequence	Code	Type	Built Over	Scale	Section Label	Base Area	Multiplier	Total Area
1	C	494		77	BAKER HUGHES CABLE PLANT	168,245	1.000	168,245
2	C	344		77	OFFICE	10,268	1.000	10,268
3	C	406		77	STORAGE AREA	10,800	1.000	10,800
4	C	344		77	344	15,002	1.000	15,002
Total Building Area						204,315		204,315



Rogers

Assessment Property Record Card for Tax Year 2026

Data provided by LISA DELOZIER County Assessor

Date 04/18/2026
 Time 06:11:13
 Page 4

Account 660003279
 Parcel ID 21N16E-04-2-00000-000-0000
 Cadastral ID 04-21-16-09900

Tax Area Code 17
 Property Class UC
 Owners Name HUGHES TOOL CO

Building Data

Building ID 3189
 Building Sequence 1
 Occupancy 1 494 Industrials, Light Mftg. 100%
 Occupancy 2
 Occupancy 3
 Total Floor Area 168,245
 Average Perimeter 1,772
 Number Of Storys 1.00
 Average Wall Ht 25.00
 Year Built 1984
 Effective Age 21
 Construction Class 7 - Pre-Engineered Steel Frame
 Quality 2 - Fair
 Condition 3 - Average
 Exterior Wall 88 - Stud Metal Siding
 Heating/Cooling 7 - Package Unit
 Roof Type
 Roof Cover

Basement Area
 Basement Levels
 Basement Finish
 Finish Code - 1
 Finish Area - 1
 Finish Code - 2
 Finish Area - 2

Building Image



Image Information

Image Name IMG_0010.JPG
 Image Date 11/6/2023
 Image Name IMG_0010.JPG
 Description REVAL 2024

Cost Calculations

Appraisal Zone 1
 Zone Description
 Base Cost 55.67
 Wall Cost 4.87
 HVAC Cost 17.48
 Basement Cost 0.00
 Total Base Cost 78.02
 Total Area 168,245
 Base RCN 13,126,475
 Misc Impr Value

Manual Date 01/2025
 Base Year 2026
 Modifier Value 445,849
 Total Replacement Cost 13,572,324
 Physical Depreciation 42%
 Functional Depreciation 26%
 Total Depreciation 57% (7,736,225)
 Total RCNLD 5,836,099
 Lump Sums
 Total Building Value 5,836,099 \$ 34.69 Per SqFt

Building Modifiers

Code	Description	Units - 1	Units - 2	Units - 3	Modifier Value
683	Wet Sprinklers	Sprinkled Area	168245		445,849
Total Modifier Value					445,849



Rogers

Assessment Property Record Card for Tax Year 2026

Data provided by LISA DELOZIER County Assessor

Date 04/18/2026
 Time 06:11:13
 Page 5

Account 660003279
 Parcel ID 21N16E-04-2-00000-000-0000
 Cadastral ID 04-21-16-09900

Tax Area Code 17
 Property Class UC
 Owners Name HUGHES TOOL CO

Building Data

Building ID 3190
 Building Sequence 2
 Occupancy 1 344 Office Building 100%
 Occupancy 2
 Occupancy 3
 Total Floor Area 10,268
 Average Perimeter 461
 Number Of Storys 1.00
 Average Wall Ht 15.00
 Year Built 1984
 Effective Age 21
 Construction Class 2 - Heavier Wood or Steel Stud Frame
 Quality 2 - Fair
 Condition 3 - Average
 Exterior Wall 88 - Stud Metal Siding
 Heating/Cooling 8 - Warmed and Cooled Air
 Roof Type
 Roof Cover
 Basement Area
 Basement Levels
 Basement Finish
 Finish Code - 1
 Finish Area - 1
 Finish Code - 2
 Finish Area - 2

Building Image



Image Information

Image Name IMG_0010.JPG
 Image Date 11/6/2023
 Image Name IMG_0010.JPG
 Description REVAL 2024

Cost Calculations

Appraisal Zone 1
 Zone Description
 Base Cost 78.89
 Wall Cost 18.76
 HVAC Cost 14.54
 Basement Cost 0.00
 Total Base Cost 112.19
 Total Area 10,268
 Base RCN 1,151,967
 Misc Impr Value

Manual Date 01/2025
 Base Year 2026
 Modifier Value 31,215
 Total Replacement Cost 1,183,182
 Physical Depreciation 32%
 Functional Depreciation 41%
 Total Depreciation 60% (709,909)
 Total RCNLD 473,273
 Lump Sums
 Total Building Value 473,273 \$ 46.09 Per SqFt

Building Modifiers

Code	Description	Units - 1	Units - 2	Units - 3	Modifier Value
683	Wet Sprinklers	Sprinkled Area	10268		31,215
Total Modifier Value					31,215



Rogers

Assessment Property Record Card for Tax Year 2026

Data provided by LISA DELOZIER County Assessor

Date 04/18/2026
Time 06:11:13
Page 6

Account 660003279
Parcel ID 21N16E-04-2-00000-000-0000
Cadastral ID 04-21-16-09900

Tax Area Code 17
Property Class UC
Owners Name HUGHES TOOL CO

Building Data

Building ID 3191
Building Sequence 3
Occupancy 1 406 Storage Warehouse 100%
Occupancy 2
Occupancy 3
Total Floor Area 10,800
Average Perimeter 480
Number Of Storys 1.00
Average Wall Ht 30.00
Year Built 1994
Effective Age 16
Construction Class 7 - Pre-Engineered Steel Frame
Quality 2 - Fair
Condition 3 - Average
Exterior Wall 88 - Stud Metal Siding
Heating/Cooling 15 - No HVAC
Roof Type
Roof Cover Metal

Basement Area
Basement Levels
Basement Finish
Finish Code - 1
Finish Area - 1
Finish Code - 2
Finish Area - 2

Building Image



Image Information

Image Name IMG_0010.JPG
Image Date 11/6/2023
Image Name IMG_0010.JPG
Description REVAL 2024

Cost Calculations

Appraisal Zone 1
Zone Description
Base Cost 42.46
Wall Cost 24.53
HVAC Cost 0.00
Basement Cost 0.00
Total Base Cost 66.99
Total Area 10,800
Base RCN 723,492
Misc Impr Value

Manual Date 01/2025
Base Year 2026
Modifier Value
Total Replacement Cost 723,492
Physical Depreciation 28%
Functional Depreciation 44%
Total Depreciation 60% (434,095)
Total RCNLD 289,397
Lump Sums
Total Building Value 289,397 \$ 26.80 Per SqFt



Rogers

Assessment Property Record Card for Tax Year 2026

Data provided by LISA DELOZIER County Assessor

Date 04/18/2026
Time 06:11:13
Page 7

Account 660003279
Parcel ID 21N16E-04-2-00000-000-0000
Cadastral ID 04-21-16-09900

Tax Area Code 17
Property Class UC
Owners Name HUGHES TOOL CO

Building Data

Building ID 3192
Building Sequence 4
Occupancy 1 344 Office Building 100%
Occupancy 2
Occupancy 3
Total Floor Area 15,002
Average Perimeter 598
Number Of Storys 1.00
Average Wall Ht 20.00
Year Built 1990
Effective Age 18
Construction Class 7 - Pre-Engineered Steel Frame
Quality 2 - Fair
Condition 3 - Average
Exterior Wall 88 - Stud Metal Siding
Heating/Cooling 7 - Package Unit
Roof Type
Roof Cover

Basement Area
Basement Levels
Basement Finish
Finish Code - 1
Finish Area - 1
Finish Code - 2
Finish Area - 2

Building Image



Image Information

Image Name IMG_0010.JPG
Image Date 11/6/2023
Image Name IMG_0010.JPG
Description REVAL 2024

Cost Calculations

Appraisal Zone 1
Zone Description
Base Cost 76.07
Wall Cost 14.88
HVAC Cost 17.98
Basement Cost 0.00
Total Base Cost 108.93
Total Area 15,002
Base RCN 1,634,168
Misc Impr Value

Manual Date 01/2025
Base Year 2026
Modifier Value 44,856
Total Replacement Cost 1,679,024
Physical Depreciation 26%
Functional Depreciation 46%
Total Depreciation 60% (1,007,414)
Total RCNLD 671,610
Lump Sums
Total Building Value 671,610 \$ 44.77 Per SqFt

Building Modifiers

Code	Description	Units - 1	Units - 2	Units - 3	Modifier Value
683	Wet Sprinklers	Sprinkled Area	15002		44,856
Total Modifier Value					44,856



Rogers

Assessment Property Record Card for Tax Year 2026

Data provided by LISA DELOZIER County Assessor

Date 04/18/2026

Time 06:11:13

Page 8

660003279

Outbuildings/Site Improvements

Building Image	Code	Description	Dimensions	Floor	Roofing	Total Units
	FLV	HOIST 2 TON (2)	0x0x0			5,660
	Qual	Cond	Year	Eff Age		
		Valuation Summary	Modifier Total	RCN	Depr (% Phys/ % Func)	RCNLD
		Base Cost (1.00 x 5,660)		5,660	1,868	3,792
	FLV	TROLLEY 120'	0x0x0			3,600
	Qual	Cond	Year	Eff Age		
		Valuation Summary	Modifier Total	RCN	Depr (% Phys/ % Func)	RCNLD
		Base Cost (1.00 x 3,600)		3,600	1,188	2,412
	FLV	CRANEWAY 200'	0x0x0			11,400
	Qual	Cond	Year	Eff Age		
		Valuation Summary	Modifier Total	RCN	Depr (% Phys/ % Func)	RCNLD
		Base Cost (1.00 x 11,400)		11,400	3,762	7,638
	FLV	SIGN	0x0x0			8,000
	Qual	Cond	Year	Eff Age		
		Valuation Summary	Modifier Total	RCN	Depr (% Phys/ % Func)	RCNLD
		Base Cost (1.00 x 8,000)		8,000		8,000
	FLV	SEC EQUIP-1 MON 1 CAMERA	0x0x0			5,460
	Qual	Cond	Year	Eff Age		
		Valuation Summary	Modifier Total	RCN	Depr (% Phys/ % Func)	RCNLD
		Base Cost (1.00 x 5,460)		5,460	1,802	3,658
	FLV	SEC EQUIP ADDN CAMERAS (22)	0x0x0			53,760
	Qual	Cond	Year	Eff Age		
		Valuation Summary	Modifier Total	RCN	Depr (% Phys/ % Func)	RCNLD
		Base Cost (1.00 x 53,760)		53,760	17,741	36,019
	FLV	ABGR TANK 8000 GAL	0x0x0			63,700
	Qual	Cond	Year	Eff Age		
		Valuation Summary	Modifier Total	RCN	Depr (% Phys/ % Func)	RCNLD
		Base Cost (1.00 x 63,700)		63,700	35,035	28,665



Rogers

Assessment Property Record Card for Tax Year 2026

Data provided by LISA DELOZIER County Assessor

Date 04/18/2026
Time 06:11:13
Page 9

FLV	MTL RESERVOIR 8000 GAL	0x0x0			6,400
Qual	Cond	Year	Eff Age		

Valuation Summary	Modifier Total	RCN	Depr (% Phys/ % Func)	RCNLD
Base Cost (1.00 x 6,400)		6,400	3,520	2,880

FLV	LOAD LEVELERS (2)	0x0x0			1,490
Qual	Cond	Year	Eff Age		

Valuation Summary	Modifier Total	RCN	Depr (% Phys/ % Func)	RCNLD
Base Cost (1.00 x 1,490)		1,490	820	670

FLV	LOADING WELL 32X53	0x0x0			22,048
Qual	Cond	Year	Eff Age		

Valuation Summary	Modifier Total	RCN	Depr (% Phys/ % Func)	RCNLD
Base Cost (1.00 x 22,048)		22,048	12,126	9,922

FLV	FR STG	0x0x0			800
Qual	Cond	Year	Eff Age		

Valuation Summary	Modifier Total	RCN	Depr (% Phys/ % Func)	RCNLD
Base Cost (1.00 x 800)		800		800

FLV	UB4-S 7X30	0x0x0			2,410
Qual	Cond	Year	Eff Age		

Valuation Summary	Modifier Total	RCN	Depr (% Phys/ % Func)	RCNLD
Base Cost (1.00 x 2,410)		2,410	1,326	1,084

FLV	MTL CANOPY 22X38	0x0x0			10,450
Qual	Cond	Year	Eff Age		

Valuation Summary	Modifier Total	RCN	Depr (% Phys/ % Func)	RCNLD
Base Cost (1.00 x 10,450)		10,450	5,748	4,702

FLV	CS UNDER CNPY 22X38	0x0x0			4,815
Qual	Cond	Year	Eff Age		

Valuation Summary	Modifier Total	RCN	Depr (% Phys/ % Func)	RCNLD
Base Cost (1.00 x 4,815)		4,815	2,648	2,167



Rogers

Assessment Property Record Card for Tax Year 2026

Data provided by LISA DELOZIER County Assessor

Date 04/18/2026
 Time 06:11:13
 Page 10

FLV	MTL CANOPY 50X30		0x0x0		18,750
Qual	Cond	Year	Eff Age		

Valuation Summary	Modifier Total	RCN	Depr (% Phys/ % Func)	RCNLD
Base Cost (1.00 x 18,750)		18,750	10,313	8,437

FLV	CS UNDER CNPY 50X30		0x0x0		8,640
Qual	Cond	Year	Eff Age		

Valuation Summary	Modifier Total	RCN	Depr (% Phys/ % Func)	RCNLD
Base Cost (1.00 x 8,640)		8,640	4,752	3,888

FLV	MTL CANOPY 3916SF		0x0x0		48,950
Qual	Cond	Year	Eff Age		

Valuation Summary	Modifier Total	RCN	Depr (% Phys/ % Func)	RCNLD
Base Cost (1.00 x 48,950)		48,950	26,923	22,027

FLV	CS UNDER CNPY 3916SF		0x0x0		22,556
Qual	Cond	Year	Eff Age		

Valuation Summary	Modifier Total	RCN	Depr (% Phys/ % Func)	RCNLD
Base Cost (1.00 x 22,556)		22,556	12,406	10,150

FLV	MTL CANOPY 22X20		0x0x0		5,764
Qual	Cond	Year	Eff Age		

Valuation Summary	Modifier Total	RCN	Depr (% Phys/ % Func)	RCNLD
Base Cost (1.00 x 5,764)		5,764	1,556	4,208

FLV	CS UNDER 22X20		0x0x0		2,534
Qual	Cond	Year	Eff Age		

Valuation Summary	Modifier Total	RCN	Depr (% Phys/ % Func)	RCNLD
Base Cost (1.00 x 2,534)		2,534	684	1,850

Total Site Improvement Value	162,969
-------------------------------------	----------------